

YAKIMA TRACKS

TOOLS REQUIRED:
 adjustable end wrench
 1/2" wrench
 1/8" Allen wrench
 center punch
 hammer
 electric drill
 1/8" drill bit
 9/32" drill bit
 touch-up paint

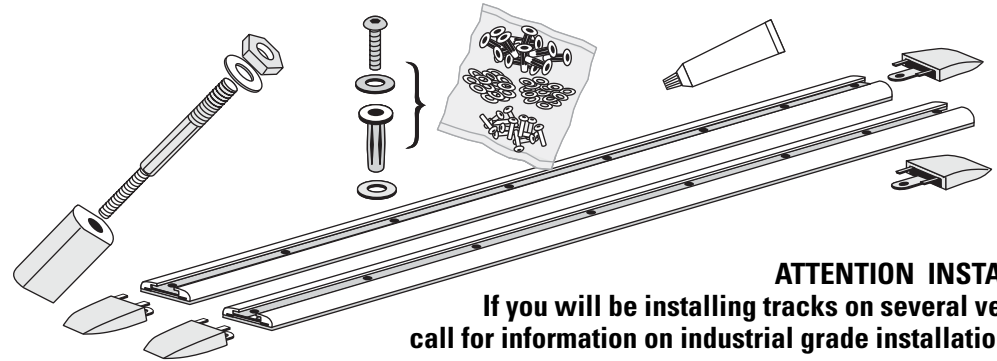

ATTENTION INSTALLERS:
 If you will be installing tracks on several vehicles,
 call for information on industrial grade installation tools.

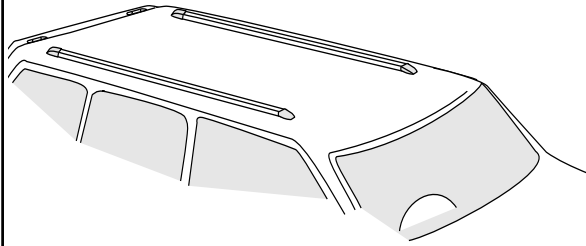
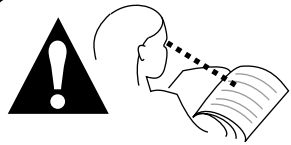

REFER TO THE TRACK FIT SHEET for track placement and important details about your vehicle!

1

Align tracks and position track ends according to information in the track fit sheet.

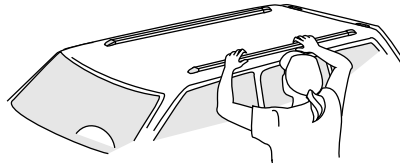

2

Outline rear hole through track.

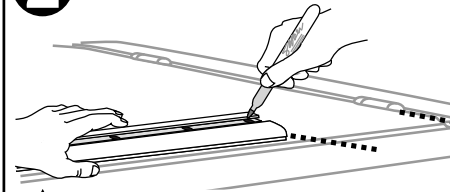

! Track base is loose and can slide. Be sure it is aligned to track.

3

Remove track.

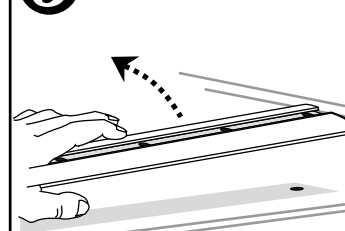

4

Punch center of mark for drilling.

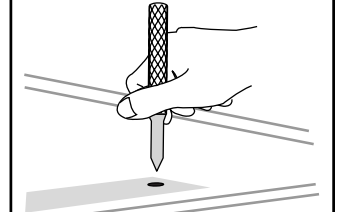

DO NOT DRILL DEEPER THAN 1/4". Use a drill stop to prevent drilling through vehicle's interior liner. If you do not have a stop, use tape and mark bit 1/4" from tip.

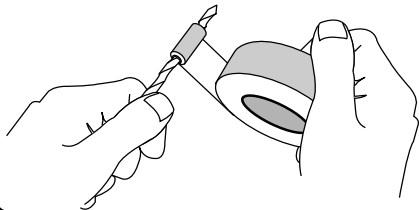

Wear goggles when drilling!



5

Drill 1/8" pilot hole

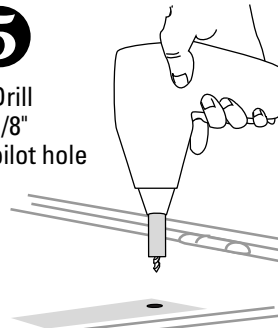

6

Drill 9/32" hole

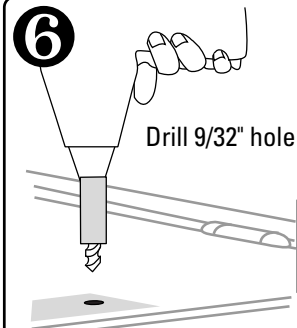

Carefully blow away debris

7

Seal edges of hole with enamel base paint. Allow to dry.

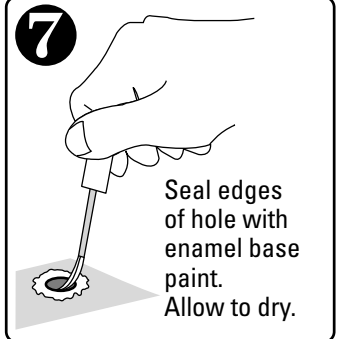

8

Attach soft rubber washers onto Plusnuts®.

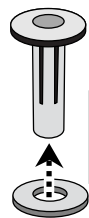

Attach Plusnut® and washer to tool as shown.

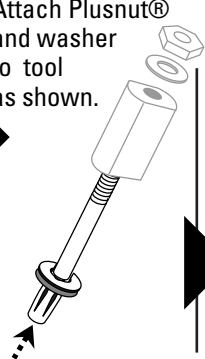

Attach nut with washer onto Plusnut® tool.

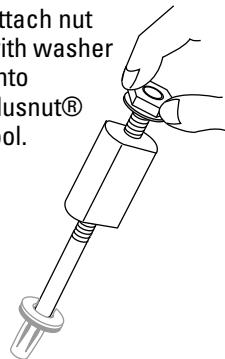

Note: Washer should be flat against Plusnut® head.

9

Set into hole.

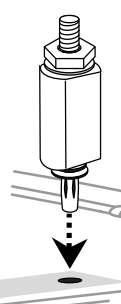

Tighten nut on tool using 1/2" wrench and adjustable end or 7/16" wrench.

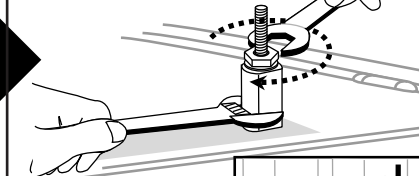

Tighten only until there is a noticeable increase in the force.

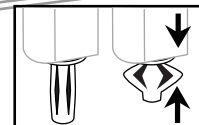

10

Remove flaring tool: Use adjustable end wrench to unscrew post from Plusnut®.

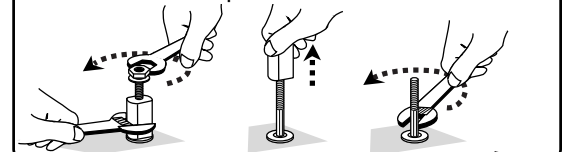

Reassemble tool for next Plusnut®.

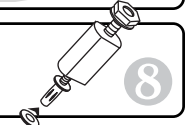

8

11 Place track on roof aligning hole.

12 Install bolt loosely.

13 Outline front hole.

Before marking—
REFER TO
TRACK FIT SHEET
for track alignment.

14

Pivot the track
to install front Plusnut®
Loosen bolt if necessary.

15 Center punch, pilot, drill, clear, seal, install Plusnut® INTO FRONT HOLE.
(Steps 4 through 10)

Never
punch or drill
through track.

16 Install front bolt through track into Plusnut®.

17 READ YOUR TRACK FIT SHEET
for your vehicle's
correct drilling points.

Carefully mark and drill only the correct
holes for your specific vehicle.

18 Loosen bolts and remove track
from vehicle.

19 Center punch, pilot, drill, clear, install
Plusnuts® (Steps 4 through 10).

20 Apply a generous amount of silicone
sealant into the Plusnut® opening.

WARNING: Direct contact of uncured sealant irritates eyes and may irritate skin. Over exposure to vapor may irritate eyes, nose and throat. Avoid eye and skin contact. Use with adequate ventilation. Do not handle contact lenses with sealant on hands. In case of eye contact, flush with water for 15 minutes. Obtain medical attention. In case of skin contact, remove from skin and flush with water. Sealant releases acetic acid (vinegar-like odor) during cure.

21 Slide nut plates from your tower kit into
track (2 per tower / 4 per track).

Attach end caps before attaching tracks to roof.

22 With track on car, attach bolts and hard washers
through track into Plusnuts®.

Do not use washers
on bolts at each end
of tracks.

NOTE: There may be extra Plusnuts®
because not all holes in the tracks will be used.

**SECOND
TRACK
INSTALLATION:
Repeat entire
instruction
beginning at**

1

Congratulations!
Install your towers
& mount your
accessories for your
next sporting
adventure!