

# YAKIMA Q 103

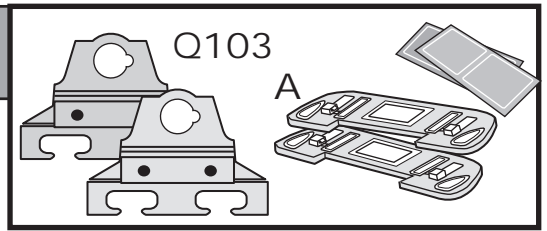

This Yakima application is a little different than the Q clips referred to in your Q Tower instructions. The M2 measurement (front bar) and M4 measurement (rear bar) are not necessary because these vehicles have mounting posts installed by the car maker and are not adjustable.

## Before you begin—

Find the mounting posts under the rubber trim on your vehicle. The front and rear posts are located approximately 6 and 36 inches from your windshield, respectively.

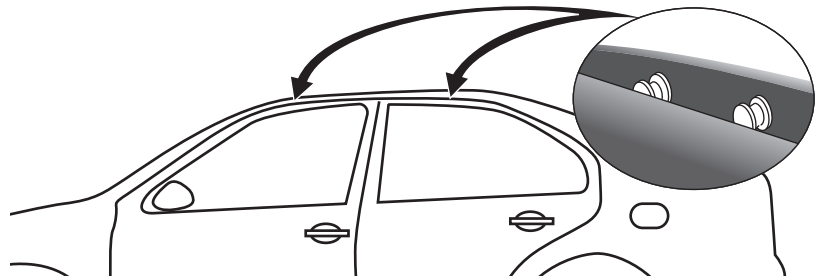

**1** Attach towers to front and rear crossbars using the M1 and M3 measurements listed below. Follow steps 1–6 in your Q Tower instructions.

YEAR	MAKE/MODEL	M1 (front)	M3 (rear)	NOTES
99-06	VW Golf/GTI 3dr	35-1/4"	NOTE	54, 61, 82, 114, 132, 144, 156, 191, 197
99-06	VW Golf 5dr	35"	32-1/4"	61, 82, 132, 144, 187, 191, 197
99-05	VW Jetta 4dr	35-1/4"	32-1/2"	54, 61, 82, 144, 187, 191, 197
07-10	VW City Golf 5dr	35"	32-1/2"	54, 61, 82, 132, 144, 182, 187, 191, 197
07-09	VW City Jetta 4dr	35"	32-1/2"	54, 61, 82, 144, 182, 187, 191, 197

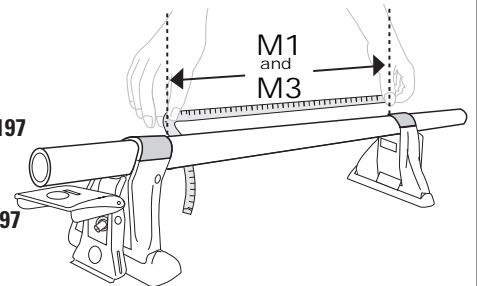

**NOTE:** Follow the Q-34 instructions for rear clips.

**2** With car doors open, gently place front bar assembly over front mounting posts and rear bar assembly over rear mounting posts.

Center racks so the distance from door frame to Tower base is equal on both sides of car.

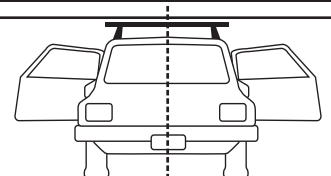

**3** Install Clips. Follow steps 9 and 10 in your Q Tower instructions.

**4** Pull back rubber trim to reveal a pair of front mounting posts.

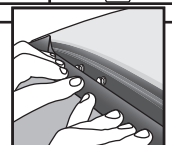

**5** Slide Clip Tower assemblies down onto the posts as pictured.

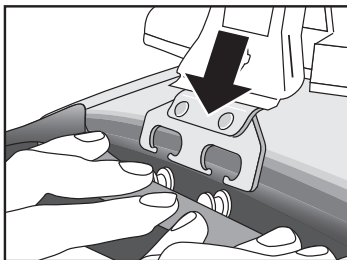

**6** Slide Clip Tower assemblies FORWARD until they stop. Repeat steps 4 and 5 on other 3 Towers.

FRONT of car

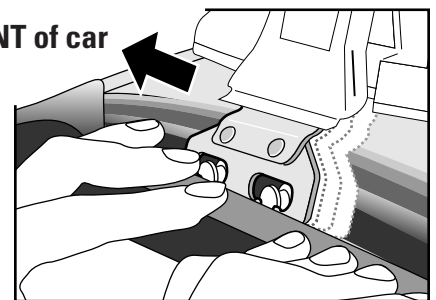

**Check to ensure clips remain in forward position. Tighten rack frequently. Failure to do so can cause ejection. Remove Rack when not in use to prevent damage to the internal door trim.**



**TIGHTEN and TEST each Tower as directed in steps 11-15 in the Q Tower instructions.**



## 61

The roof, rubber/chrome door seals and/or trim may deform or be damaged under prolonged contact with any roof rack towers and/or clips. Do not over-tighten or overload the rack. Remove rack when not in use.

## 82

Any load extending beyond the length of the roof (except luggage boxes) must be secured to both the front and rear of the vehicle, in addition to the rack.

## 54

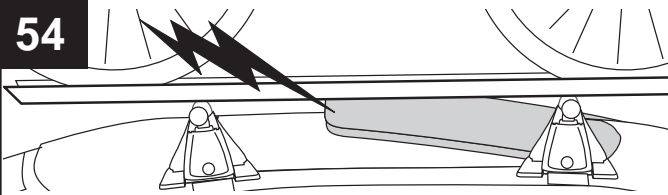

When open, the sunroof may interfere with some accessories.

## 114

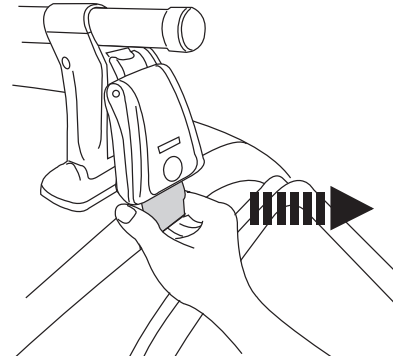

Check clips after installing. Grab each clip and try to pull them hard away from your vehicle, twice. If the clip moves after the second pull, tighten the adjustment post. If the clip still moves after the second pull, recheck your measurements between the towers and adjust if necessary. Check clip again.

## 144

Roof mounted antenna may need to be removed to prevent interference with long loads, boxes.

## 132

Any load/mount extending beyond the rear hatch seam may cause interference.



**156**

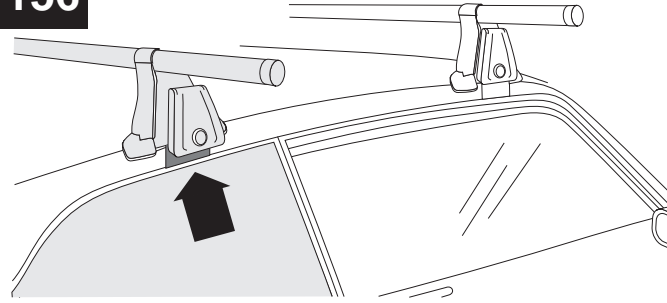

Place rear clip in gap above rear, side window.

**182**

This fit requires the use of Volkswagen factory mounting posts. To locate, pull back rubber seal from doorframe. If posts are not present, you must first purchase part #1J0-810-768-C from your Volkswagen dealer before performing rack installation.

**187**

Boa bike mount will not work due to crossbar spread limitations.

**191**

StrapThang limited to 2 surf/sail boards. Boards must be stacked - DO NOT carry side by side.

**197**

Foam blocks limit capacity to one boat per vehicle.