

# YAKIMA Q32

## CLIPS / PADS

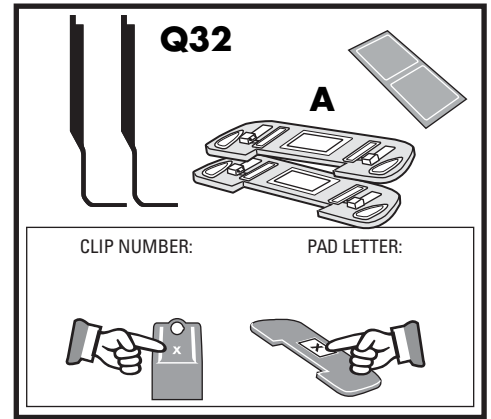
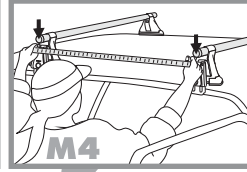
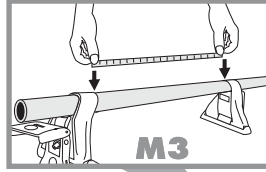
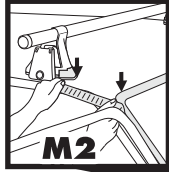
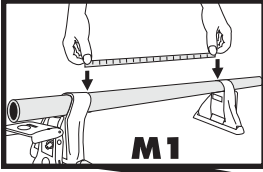

		<b>M1</b>	<b>M2</b>	<b>M3</b>	<b>M4</b>	
<b>BUICK</b>						
Electra/Park Ave Sedan	85-90	Q31-A 44"	4"	Q32-A 43-3/4"	36"	37
Electra/Park Ave Sedan <b>Max Crossbar Spread</b>	85-90	Q31-A 44"	4"	Q32-A 44-3/8"	44"	37
<b>CHEVROLET</b>						
Blazer, Full Size 2dr <b>with Q Stretch Kit</b>	79-91	Q30-A 49-1/2"	3"	Q32-A 50-3/4"	36"	
Monte Carlo	81-88	Q31-A 43-1/4"	3"	Q32-A 43-1/8"	24"	36, 37, 102, 103, 104
Monte Carlo <b>with Q Stretch Kit</b>	81-88	Q31-A 43-1/4"	3"	Q32-A 43-1/8"	36"	36, 37
<b>CHRYSLER</b>						
Fifth Avenue	88-89	Q31-A 42"	5"	Q32-A 41-7/8"	32"	37
<b>FORD</b>						
Bronco II	83-90	Q32-A 43-3/4"	4"	Q32-A 43-1/2"	18"	21,101
Festiva	87-93	Q32-A 32-3/8"	4"	Q32-A 31-5/8"	18"	101,114
LTD Crown Victoria 4dr	79-91	Q32-A 42-1/4"	4"	Q32-A 43-3/8"	36"	37
Mustang Coupe <b>with Q Stretch Kit</b>	87-93	Q31-A 39-1/4"	3"	Q32-A 37-3/4"	36"	36,113
Mustang Hatchback <b>with Q Stretch Kit</b>	87-93	Q31-A 38-7/8"	4"	Q32-A 38-3/8"	30"	113
<b>GMC</b>						
Jimmy, Full Size 2dr <b>with Q Stretch Kit</b>	79-91	Q30-A 49-1/2"	3"	Q32-A 50-3/4"	36"	
<b>HONDA</b>						
Accord 2dr	79-85	Q31-A 35-1/4"	5"	Q32-A 36"	30"	
Accord Sedan	79-85	Q31-A 35-1/4"	7"	Q32-A 35-1/8"	32"	
<b>INFINITI</b>						
Q45	90-96	Q31-A 42-1/2"	5"	Q32-A 41-3/8"	36"	
<b>LAND ROVER</b>						
Range Rover Classic	87-95	Q32-A 50-5/8"	6"	Q32-A 50-5/8"	36"	
Range Rover Classic <b>Max Crossbar Spread</b>	87-95	Q32-A 50-5/8"	6"	Q32-A 50-7/8"	69"	

Look at the notes that apply to your vehicle.

# YAKIMA Q32

## CLIPS / PADS

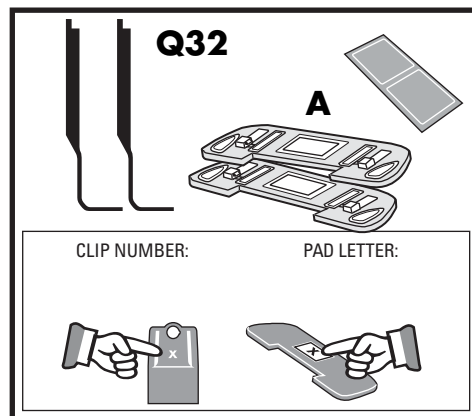
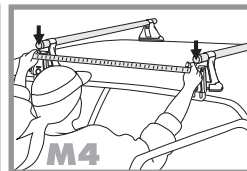
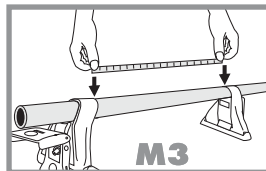
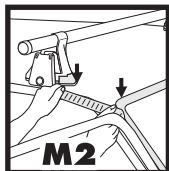
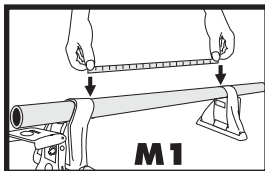

Look at the notes that apply to your vehicle.

<b>MAZDA</b>						
3 4dr with Q Stretch Kit	04-05	<b>M1</b> Q34-A 40-3/4"	<b>M2</b> 6"	<b>M3</b> Q32-A 39-3/8"	<b>M4</b> 32"	54,114,144
323 2dr with Q Stretch Kit	90-93	Q5-A 36-5/8"	6"	Q32-A 34-5/8"	36"	114,161
MX-6 with Q Stretch Kit	88-92	Q31-A 38-1/4"	6"	Q32-A 36-3/8"	30"	61
<b>MERCEDES</b>						
190 Sedan	84-93	Q31-A 38-1/8"	4"	Q32-A 36-7/8"	30"	
240/280/300 Class Sedan	79-85	Q32-A 42-1/4"	6"	Q32-A 41-3/8"	36"	
260 /300 E/300 D/400 E	86-93	Q32-A 39-1/2"	5"	Q32-A 39"	30"	114
400 SEL/500 SEL/600 SEL	92-93	Q30-A 44-1/4"	6"	Q32-A 42-3/8"	36"	
C Class Sedan	94-00	Q31-A 39-7/8"	4"	Q32-A 37-3/4"	30"	61
E300/E320/E420/E500 Sedan	94-95	Q31-A 40-5/8"	4"	Q32-A 39"	32"	61
E Class Sedan	96-02	Q31-A 40"	6"	Q32-A 39-3/4"	30"	114
<b>MERCURY</b>						
Grand Marquis 2dr	79-85	Q31-A 42-3/4"	4"	Q32-A 42-3/4"	20"	101,114
Lynx 2dr Hatchback	81-87	Q31-A 36-3/4"	3"	Q32-A 35-3/4"	36"	115
Lynx 2dr Hatchback Max Crossbar Spread	81-87	Q31-A 36-3/4"	3"	Q32-A 35-1/2"	42"	115
<b>NISSAN/DATSUN</b>						
280 ZX with Q Stretch Kit	79-83	Q31-A 37-3/4"	4"	Q32-A 38-1/2"	22"	36,101
Sentra 2dr Hatchback	87-88	Q31-A 34-3/4"	4"	Q32-A 34"	18"	101
Stanza 4dr Liftback	82-86	Q31-A 35-1/8"	4"	Q32-A 34-3/8"	34"	
<b>OLDSMOBILE</b>						
98 Regency Sedan	85-90	Q31-A 44"	5"	Q32-A 43-3/4"	36"	37,113
98 Regency Sedan Max Crossbar Spread	85-90	Q31-A 44"	5"	Q32-A 44-3/8"	44"	37,113

# YAKIMA Q32

## CLIPS / PADS

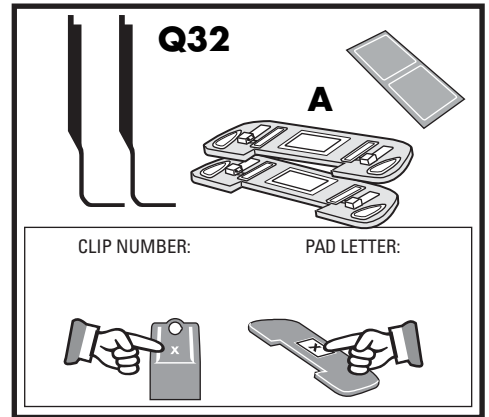
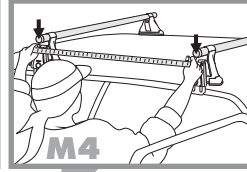
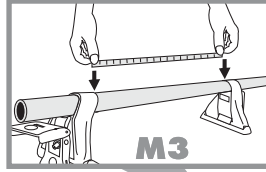
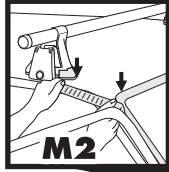
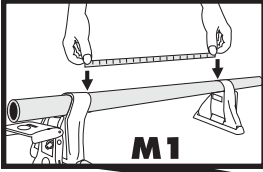





Look at the notes that apply to your vehicle.

<b>OLDSMOBILE</b>		<b>M1</b>	<b>M2</b>	<b>M3</b>	<b>M4</b>	
Delta 88/ Regency 98 2dr	79-85	Q31-A 44-1/2"	2"	Q32-A 44-7/8"	28"	102,103,104
Touring Sedan	87-91	Q31-A 43-3/4"	6"	Q32-A 44-3/8"	36"	
<b>PONTIAC</b>						
Grand Prix 2dr	79-87	Q31-A 43-3/8"	3"	Q32-A 43"	24"	102,103 104,113
<b>SUBARU</b>						
Hatchback	80-89	Q32-A 36-1/4"	4"	Q32-A 36"	36"	
Hatchback Max Crossbar Spread	80-89	Q32-A 36-1/4"	4"	Q32-A 36"	39"	
<b>TOYOTA</b>						
Camry Sedan	83-86	Q32-A 37-1/2"	4"	Q32-A 37"	36"	
Celica 2dr Hatchback	79-85	Q32-A 35-3/8"	2"	Q32-A 35-5/8"	18"	101
Corolla Sedan	84-87	Q31-A 36-7/8"	4"	Q32-A 35"	36"	
MR-2 (Hardtop Only) with Q Stretch Kit	85-89	Q30-A 36-1/2"	4"	Q32-A 35-1/8"	19"	36,101
Paseo	96-97	Q31-A 37-3/8"	5"	Q32-A 37"	18"	54,61,101
Paseo with Q Stretch Kit	96-97	Q31-A 37-3/8"	5"	Q32-A 37"	24"	54,61,102 103,104
Pickup, Std. Cab	84-88	Q32-A 39-3/4"	4"	Q32-A 39-1/2"	16"	78,100
Prius	01-03	Q31-A 40-3/4"	9-1/2"	Q32-A 40-1/8"	28"	102,103 104,114,157
RAV4 4dr.	96-00	Q32-A 36"	6"	Q32-A 36"	36"	41,114
Tercel 2dr	95-98	Q32-A 33-1/4"	6"	Q32-A 32-1/4"	20"	101
Tercel 2dr with Q Stretch Kit	95-98	Q32-A 33-1/4"	6"	Q32-A 32-1/4"	36"	
Tercel 4dr	95-97	Q32-A 33-1/4"	5"	Q32-A 32-1/4"	30"	
<b>VOLKSWAGEN</b>						
Golf 4dr	85-92	Q32-A 33-7/8"	6"	Q32-A 33-1/2"	36"	61,78
Golf/GTI 2dr	85-92	Q32-A 34-1/8"	5"	Q32-A 33-5/8"	18"	101

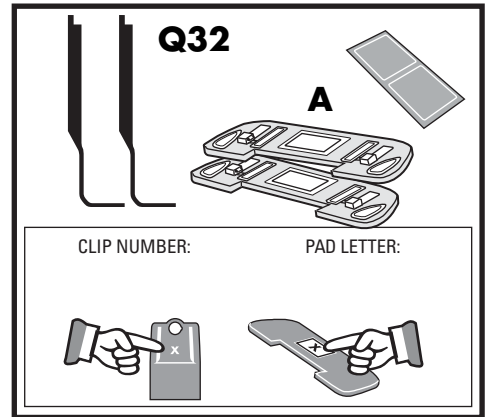
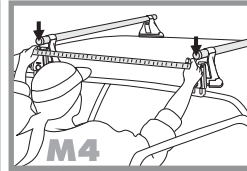
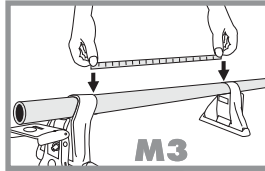
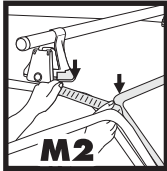
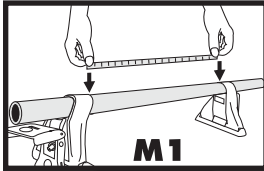
# YAKIMA Q32

## CLIPS / PADS



						
<b>VOLKSWAGEN</b>	<b>M1</b>	<b>M2</b>	<b>M3</b>	<b>M4</b>		
Jetta 2dr	85-92	Q32-A 34-1/2"	4"	Q32-A 33-3/4"	18"	61,101
Jetta 2dr with Q Stretch Kit	85-92	Q32-A 34-1/2"	4"	Q32-A 33-3/4"	36"	61
Jetta 4dr	85-92	Q32-A 34-3/8"	6"	Q32-A 33-1/4"	36"	61
<b>VOLVO</b>						
240/260 Wagons	79-93	Q32-A 41-1/8"	6"	Q32-A 41-1/2"	36"	41
240/260 Wagons Max Crossbar Spread	79-93	Q32-A 41-1/8"	6"	Q32-A 40-5/8"	82"	41

Look at the notes that apply to your vehicle.



**21**

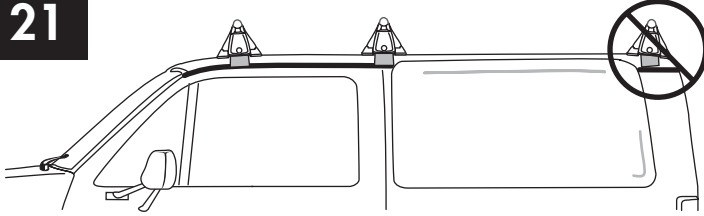

Do not use non-structural drip rail on rear of Bronco II.

**36**

Yakima racks are not recommended for convertible tops, T-tops or any type of removable roof panels.

**37**

Do not install racks on vinyl-covered roofs. Crossbar spread figures refer to models without vinyl.

**41**

The factory luggage carrier may interfere with some accessories.

**54**

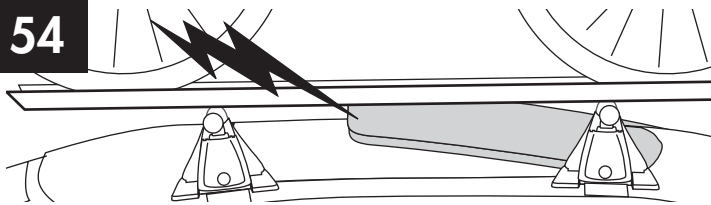

When open, the sunroof may interfere with some accessories.

**61**

The rubber door seals and/or trim may deform or be damaged under prolonged contact with any roof rack towers and/or clips. Remove rack when not in use.

**78**

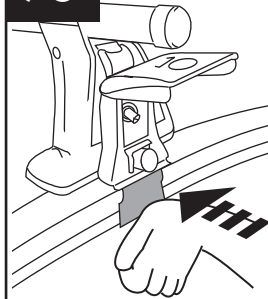

Press firmly against the lower portion of the clip while tightening the rack. This will properly locate the clip over the internal raingutter.

**100**

Up to two bicycles may be carried on this vehicle.

**101**

Surf/sailboard length is limited to 8' or less on this vehicle.





**102** Surf/sailboard length is limited to 10' or less on this vehicle.

**103** Kayaks must be carried with HullyRollers, LandShark, Mako Saddles, or HullRaisers on this vehicle.

**113** The roof and/or trim is very soft. Do not overtighten or overload the rack.

**114**

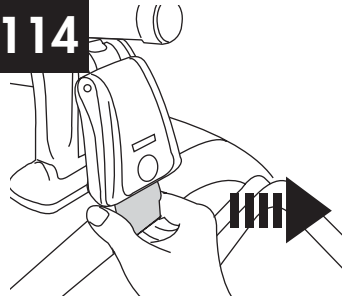

Caution! Check clips after installing. Grab each clip and try to pull them away from your vehicle. Pull hard! If the clip moves tighten the adjustment post. If the clip still moves, recheck your measurements between the towers and adjust if necessary. Check clip again.

**115**

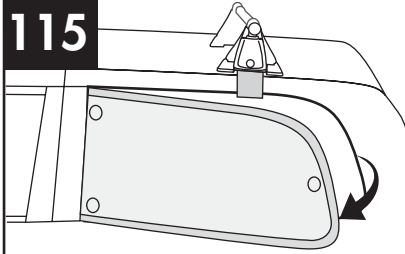

Install rear clips with rear windows opened.

**157**

Place clips into depressions in door frames.

**161**

Do not exceed maximum weight of 125 lbs./56 kg.

