

WeatherTech®

No-Drill MudFlap

Installation Instructions

Thank you for purchasing the WeatherTech® No-Drill MudFlap. Please read this installation guide to thoroughly familiarize yourself with the steps to install the MudFlap on your vehicle. When properly installed, the WeatherTech® No-Drill MudFlap will provide you with years of protection.

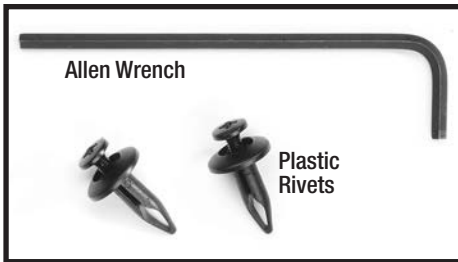

Hardware Included

Your MudFlap kit includes an Allen Wrench and the plastic push rivets pictured here.

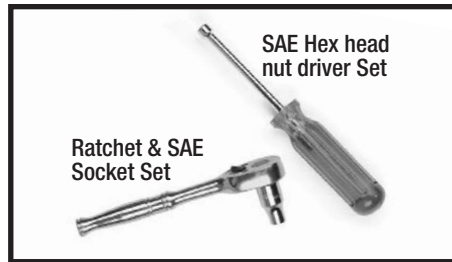

Tools Needed

You need one of the tools pictured here to complete the installation.

WARNING!
The MudFlap is designed to fit vehicles with standard size wheels and tires. Installation of mud flaps on vehicles with aftermarket wheels or oversize tires may interfere with the MudFlap and will void the warranty and may damage the MudFlap or the vehicle.

1 Start by thoroughly washing your vehicle. Take care to remove all dirt, debris, and stains from each fender in the areas corresponding to where the MudFlaps will be installed.

2 Begin driver's side MudFlap installation by parking the vehicle on level ground with wheels turned fully to the left.



Remove the hex-head screw located in the position indicated in the photo. Do not lose this screw, as you will need it to complete the MudFlap installation.

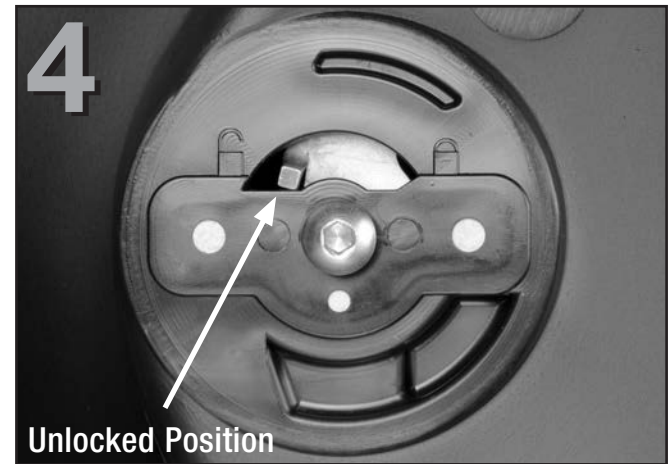

Identify the driver's side MudFlap by locating the "LH" mark located centrally in the recessed cavity on the tire side of the MudFlap. Ensure that the QuickTurn™ fastener is in the fully unlocked position using the Allen wrench provided.

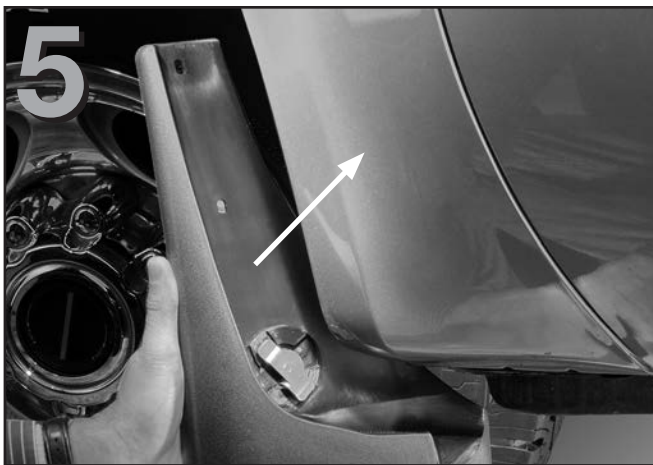

5 Position the smooth surfaced portion of the MudFlap so that it contours firmly against the fender as shown. **IMPORTANT** - Ensure that the QuickTurn™ fastener remains in the fully unlocked position during this step.



6 Press the MudFlap against the fender for a tight fit. Insert and snug the hex-head screw removed in step 3. **IMPORTANT** - Do not fully tighten at this time.

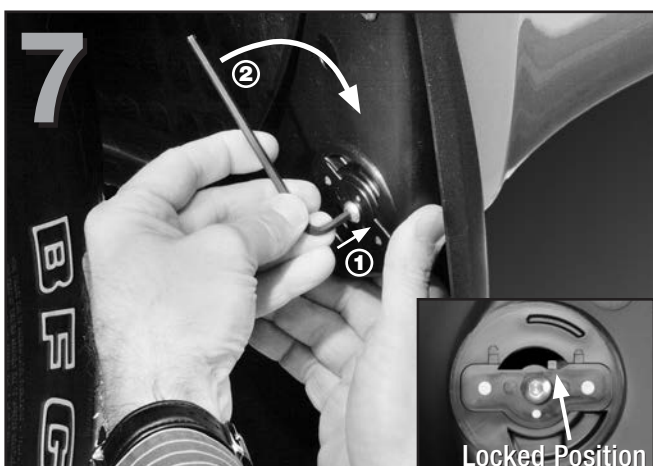

7 First ensure that the QuickTurn™ fastener is positioned properly by pressing in the direction indicated by arrow 1. Then, hand tighten the QuickTurn™ fastener (arrow 2). Verify that the QuickTurn™ fastener is in the fully locked position.

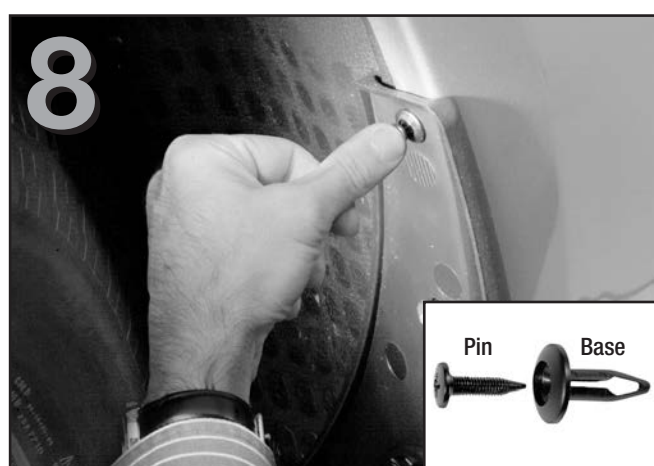

8 Prepare the plastic rivet for installation by removing the pin from the base. Insert the base fully into the top hole of the MudFlap and through the existing hole in the vehicle. Insert the pin into the base and press firmly to secure the rivet.

9 Tighten the hex-head screw that was originally removed in step 3 and then started in step 6. Take care not to overtighten the screw.



10 Begin passenger side installation by parking the vehicle on a level surface with the wheels turned fully to the right. Repeat steps 3-9.

Congratulations!
Your new WeatherTech® No-Drill MudFlaps have been installed!

WeatherTech®

No-Drill MudFlap

Installation Instructions

Thank you for purchasing the WeatherTech® No-Drill MudFlap. Please read this installation guide to thoroughly familiarize yourself with the steps to install the MudFlap on your vehicle. When properly installed, the WeatherTech® No-Drill MudFlap will provide you with years of protection.

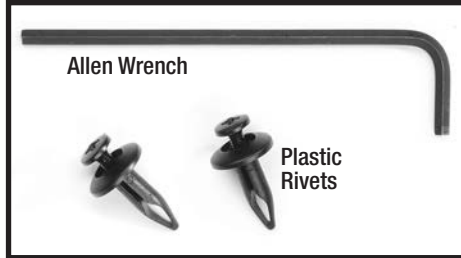

Hardware Included

Your MudFlap kit includes an Allen Wrench and the plastic push rivets pictured here.

WARNING!

The MudFlap is designed to fit vehicles with standard size wheels and tires. Installation of mud flaps on vehicles with aftermarket wheels or oversize tires may interfere with the MudFlap and will void the warranty and may damage the MudFlap or the vehicle.

- 1** Start by thoroughly washing your vehicle. Take care to remove all dirt, debris, and stains from each fender in the areas corresponding to where the MudFlaps will be installed.

- 2** Begin driver's side MudFlap installation by parking the vehicle on level ground. Begin with the left side.

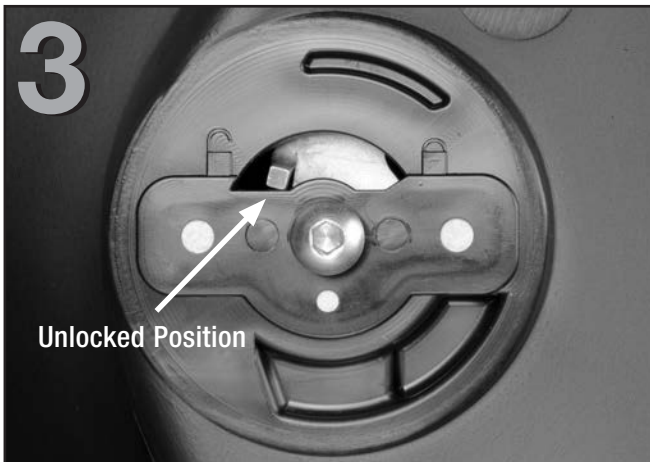

Identify the driver's side MudFlap by locating the "LH" mark located centrally in the recessed cavity on the tire side of the MudFlap. Ensure that the QuickTurn™ fasteners are in the fully unlocked position using the Allen wrench provided.



Position the smooth surfaced portion of the MudFlap so that it contours firmly against the fender as shown.

IMPORTANT - Ensure that the QuickTurn™ fasteners remains in the fully unlocked position during this step.



First ensure that the QuickTurn™ fasteners are positioned properly by pressing in the direction indicated by arrow 1. Then, hand tighten the bottom QuickTurn™ fastener (arrow 2). Verify that this QuickTurn™ fastener is in the fully locked position.



Repeat this process with the top QuickTurn™ fastener.



Prepare the plastic rivet for installation by removing the pin from the base. Insert the base fully into the top hole of the MudFlap and through the existing hole in the vehicle. Insert the pin into the base and press firmly to secure the rivet.



9 Begin passenger side installation by parking the vehicle on a level surface. Repeat steps 3-7.

Congratulations!
Your new WeatherTech® No-Drill MudFlaps
have been installed!