



VAN SOLUTIONS
FOR THE WAY YOU WORK™

EZGlide2™

INSTALLATION MANUAL



Model 2291-3-01



ATTENTION: PLEASE READ AND UNDERSTAND ALL INSTRUCTIONS AND WARNINGS BEFORE ASSEMBLING, INSTALLING OR USING THIS PRODUCT.

⚠ CAUTION

Be safe - always wear protective eye wear to keep debris out of your eyes when installing WEATHER GUARD® Van Products

⚠ WARNING

Prior to drilling, check under vehicle for fuel, tanks, fuel lines, brake lines, electric wires, etc. To avoid cutting or puncturing them. Do not use Blind Fasteners in these areas.

Tools Needed

- THREADLOCKER COMPOUND
- 1/2" SOCKET AND/OR WRENCH
- 3/16" HEX KEY/DRIVER
- 1/4" HEX KEY/DRIVER
- 2X 9/16 SOCKET AND/OR WRENCH
- 7/16" SOCKET AND/OR WRENCH
- SAW RECOMMENDED FOR RAM PROMASTER 118" WHEELBASE
- DRILL WITH 21/64" DRILL BIT RECOMMENDED FOR RAM PROMASTER 118" WHEELBASE
- TORQUE SETTABLE DRIVER OR TORQUE WRENCH.
- IMPACT WRENCH (OPTIONAL)

BEFORE YOU BEGIN

The EZGLIDE2™ drop-down ladder rack is designed to use Weather Guard Mounting Channel kits to provide the best support for your ladders and to take advantage of OEM provided roof mounting points. If you have not already installed the mounting channel kit to the van roof, install it now before proceeding.

EZ GLIDE2 PARTS LIST

DESCRIPTION	QTY
DROP DOWN W/SLIDE	1
FIXED DROP DOWN	1
89" CONNECTING TUBE	1
REAR DRIVE TUBE	1
REAR COUPLING	1
MOUNTING FOOT	4
VERTICAL LADDER STOP	4
DAMPER	2
TELESCOPIC HANDLE	1
70" CROSS-MEMBER	2
SLIDE LADDER HOOK	1
FIXED LADDER HOOK	1

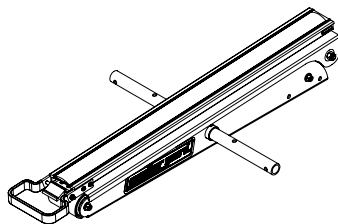

DROP DOWN W/ SLIDE

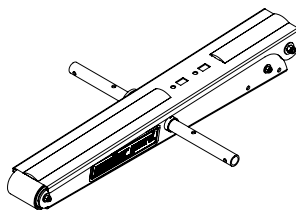

FIXED DROP DOWN

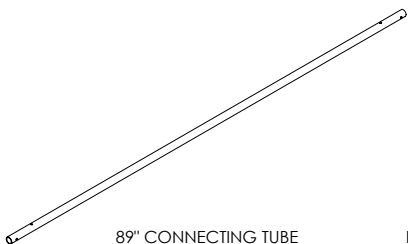

89" CONNECTING TUBE



REAR DRIVE TUBE



REAR COUPLING



MOUNTING FOOT

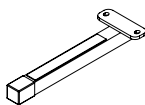

VERTICAL LADDER STOP

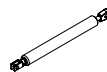

DAMPER

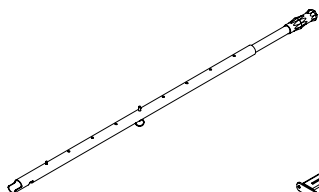

TELESCOPING HANDLE

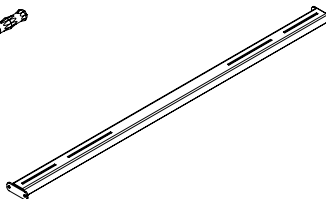

70" CROSSMEMBER

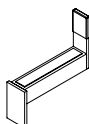

SLIDE LADDER HOOK

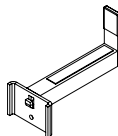

FIXED LADDER HOOK

DESCRIPTION	QTY
5/16" WASHER	38
5/16 x 1-3/4" BOLT	6
5/16 x 2" SCREW	8
RED CAP	1
1" SPACER	4
5/16 NYLON LOCK NUT	30
3/8 WASHER	1
3/8 x 7/8" BOLT	1
3/8 NYLON LOCK NUT	1
STUD PLATE	4
1/4 WASHER	8
1/4 NYLON LOCK NUT	8
COUPLING BUSHING	1
CLEVIS PIN	1
5/16 x 3/4" CARRIAGE BOLT	16
E-CLIP	2
DAMPER ROD	2
LADDER HOOK SUPPORT	2
5/16 x 3" SCREW	2
SPRING CLIP	2
5/16 x 1-1/4" BOLT	4
CURVED MOUNTING BRACKET	4
MOUNTING FOOT BOLT PLATE	4



5/16" WASHER



5/16X1-3/4" BOLT



5/16X2" SCREW

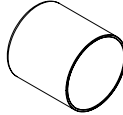

RED CAP



1" SPACER



5/16" NYLON LOCK NUT



3/8" WASHER



3/8X5/8" BOLT



3/8" NYLON LOCK NUT

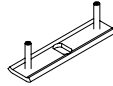

STUD PLATE



1/4" WASHER



1/4" NYLON LOCK NUT

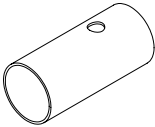

COUPLING BUSHING

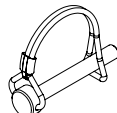

CLEVIS PIN



5/16X3/4" CARRIAGE BOLT



E-CLIP

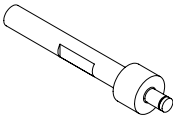

DAMPER ROD

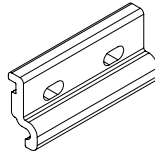

LADDER HOOK SUPPORT

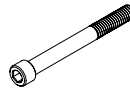

5/16X3" SCREW



SPRING CLIP



5/16X1-1/4" BOLT

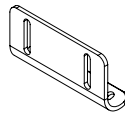

CURVED MOUNTING BRACKET

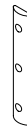

MOUNTING FOOT BOLT PLATE

STEP 2 - INSTALL LADDER HOOKS

Using 2-5/16x3" screws, 2-5/16" nuts, and 2-ladder hook supports, install the slide ladder hook on the slide down unit. The hook should be located according to the diagram but may be adjusted depending on ladder dimensions and user preference. Torque nuts to 17 ft-lbs.

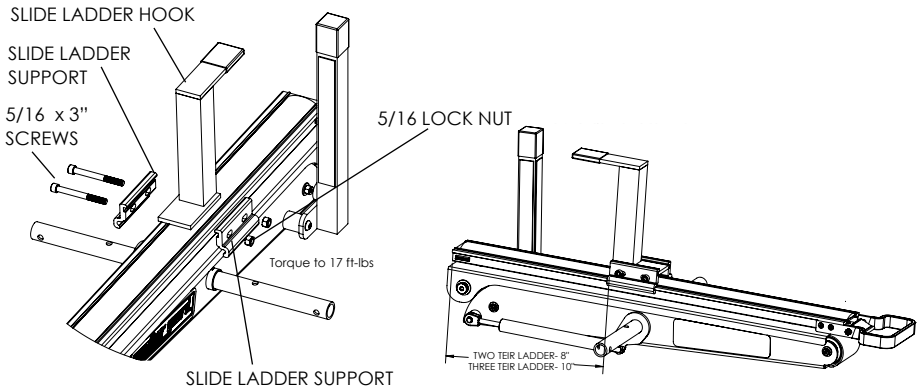

Using 1-3/8x5/8" bolt, 1-3/8" nylon lock nut, and 2-3/8" washers install the fixed ladder hook to the drop down unit. The hook should be located according to the diagram, but may be adjusted depending on ladder dimensions and user preference. Torque nut to 30 ft-lbs.

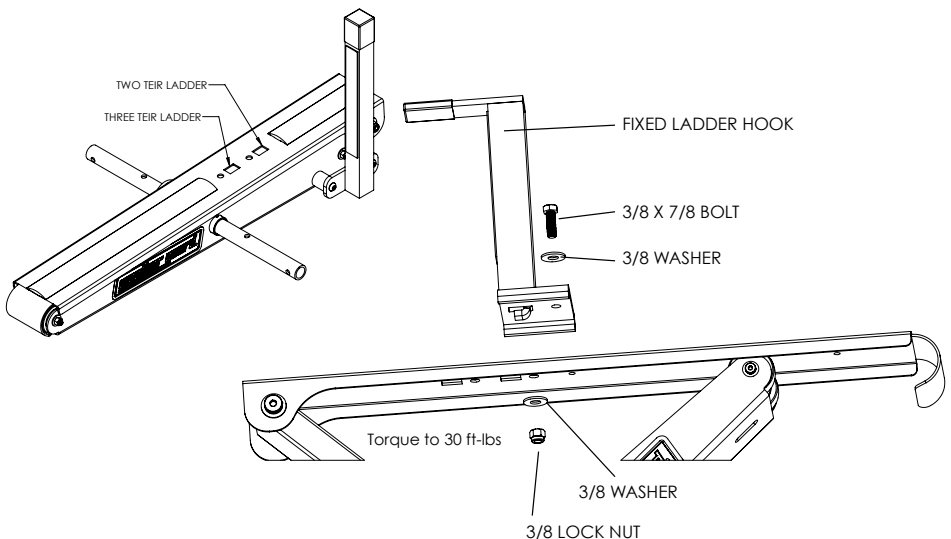



STEP 3 - MOUNT MOUNTING FEET TO CROSS MEMBERS

Only use one carriage bolt, washer, and nut per mounting foot.

Using 1-5/16x3/4" carriage bolt, 1-5/16" washer, and 1-5/16" nylon lock nut per mounting foot, install two mounting feet per cross member. Please refer to the table and diagram for mounting foot location and orientation.

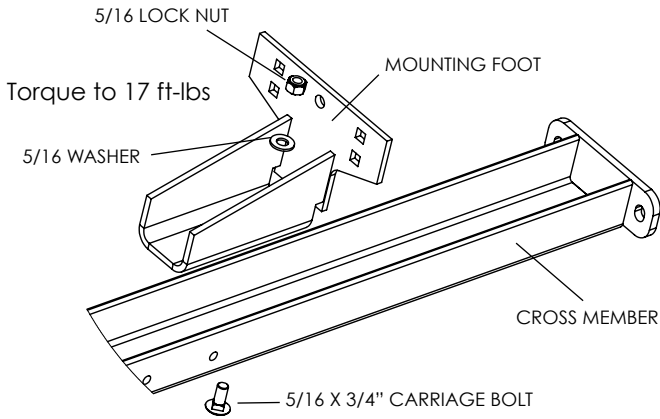

INSTALL MOUNTING FEET ACCORDING TO TABLE

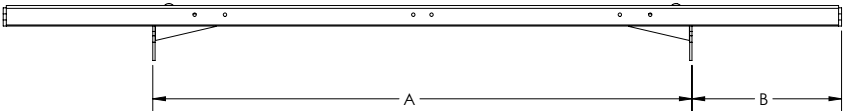

MOUNTING FOOT DISTANCE		
VEHICLE	DIM "A"	DIM "B"
FORD TRANSIT	55-1/2"	6-3/4"
RAM PROMASTER	59-5/8"	4-5/8"
NISSAN NV200	59-3/8"	4-13/16"
MERCEDES-BENZ SPRINTER	53-1/4"	7-7/8"

STEP 4 - INSTALL CURVED MOUNTING BRACKETS

Using 2-5/16X3/4" carriage bolt, 2-5/16" washer, and 2-5/16" nylon lock nut per mounting foot install a curved mounting bracket to each mounting foot. Torque nuts to 17 ft-lbs.

If using an impact driver to torque nuts, it is recommended that the carriage bolt orientation be reversed to engage the square cut outs in the mounting foot.

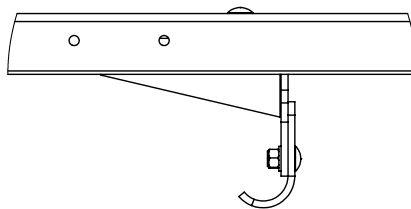
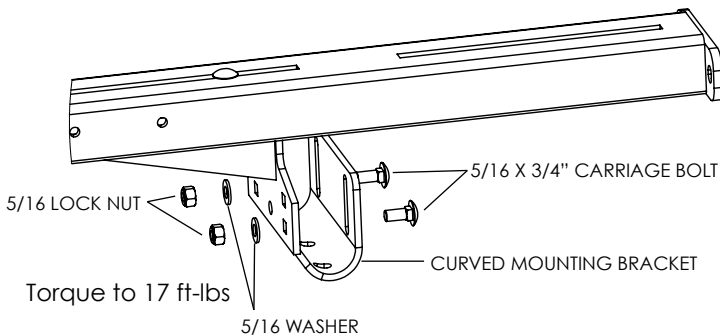

Most vehicle installations will benefit from having the lowest installed height with the mounting bracket lining up with the start of the curve on the curved mounting bracket. Due to vehicle roof curvatures some adjustment for final assembly height may be required after the crossmembers are installed on the roof.



STEP 5 - INSTALL DROP DOWN MECHANISMS TO CROSS MEMBERS

Using 2-5/16x3/4" carriage bolt, 2-5/16" washer, and 2-5/16" nylon lock nut per drop down mechanism, install each drop down mechanism to the cross members. The end of the bottom bracket on the drop down mechanism should line up with the end of the cross member. Torque nuts to 17 ft-lbs.

On single side installations, there will be one drop down mechanism per cross member. On dual drop down setups, you may install two mechanisms per cross member.

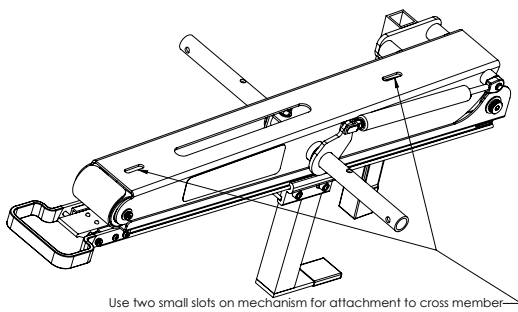
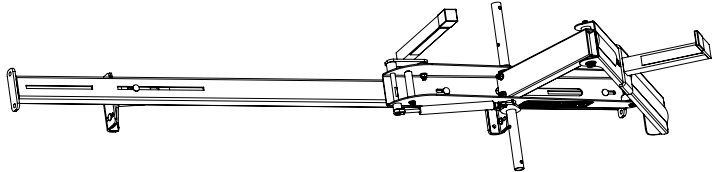

Use two small slots on mechanism for attachment to cross member

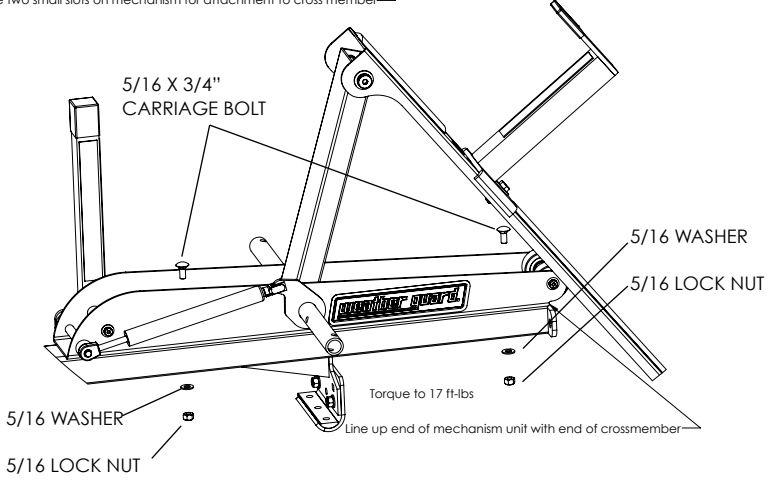

STEP 6 - MOUNT REAR CROSS MEMBERS TO VEHICLE

Slide two stud plates per mounting channel into mounting channel if not already done. If installing a dual setup with 3 cross members, 3 stud plates will be used per mounting channel. Using 2-1/4" washers, 2-1/4" nylon lock nuts, and 1 mounting foot bolt plate per mounting foot, install the rear cross member on the mounting channel. The cross member that has the slide down mechanism should be installed in the rear position.

The EZ GLIDE2 can be installed on either the street side or curb side of the van. Decide which side to install the drop-down before mounting it to the vehicle.

Locate the cross member approximately 1-3" from the end of the mounting channel and hand tighten each 1/4" nut. The 1/4" nuts will need to be kept loose until step 7 is complete.

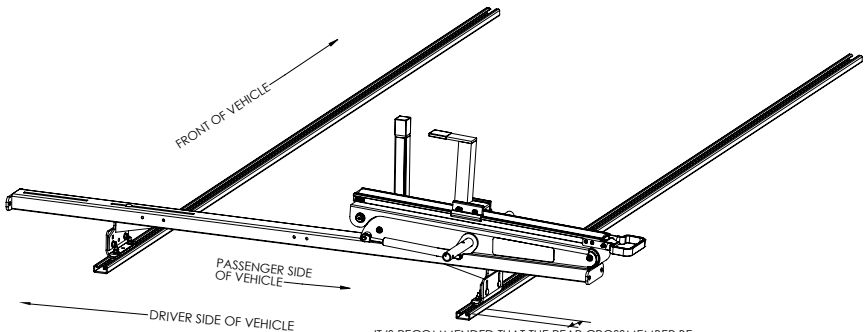
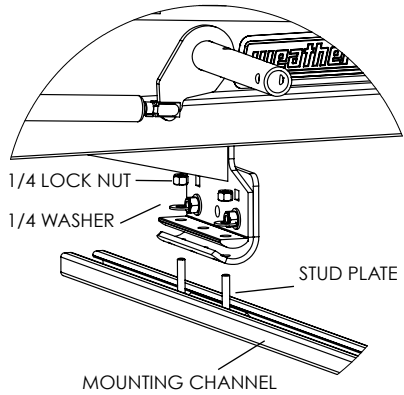

IT IS RECOMMENDED THAT THE REAR CROSSMEMBER BE LOCATED APPROXIMATELY 1-3" FROM THE REAR OF THE MOUNTING CHANNEL

**STEP 6B – 158” WHEELBASE RAM PROMASTER
MOUNT REAR CROSS MEMBERS TO VEHICLE**

The 2113-0-01 mounting channel kit is used on RAM Promaster vans. For 159” wheel-base and the 159” wheel-base extended versions, the rear cross-member is mounted directly to the mounting point closest to the rear of the van. The front cross-member and center cross-members, if used, mount to the channels as shown in Step 6.

If not already installed, fit the mounting bracket around the rear mounting post on the Promaster roof. Place the mounting foot against the bracket and clamp in place using 5/16 bolt and mounting clamp as shown.

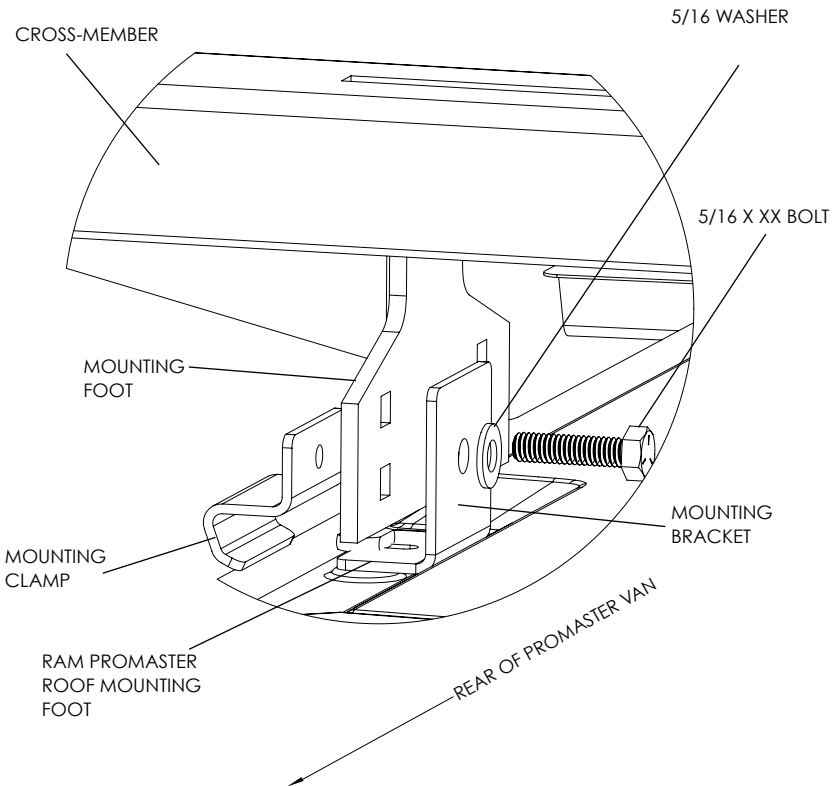

STEP 7 - INSTALL CENTER CONNECTING TUBE AND FRONT CROSS MEMBER

Rotate and position the connecting tube on the drive tube until all 4 mounting holes line up. Using 2-5/16x1-3/4" bolts, 4-5/16" washers, and 2-5/16" nuts, install the connecting tube. Torque 5/16 nuts to 17 ft-lbs.

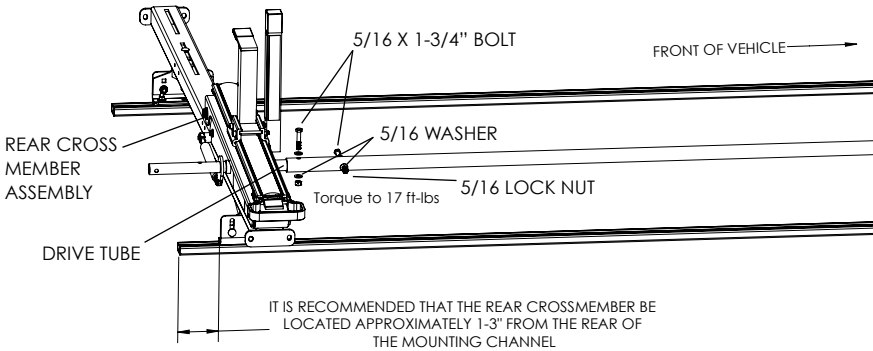

Using 2-5/16x1-3/4" bolts, 4-5/16" washers, and 2-5/16" nuts, install the connecting tube on the front drive tube. Rotate and position the center connecting tube until all 4 mounting holes line up and then drop cross member onto stud plates. Torque 5/16 nuts to 17 ft-lbs.

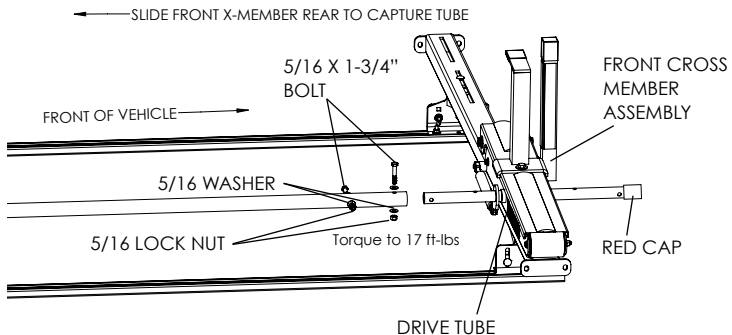

On Ford Transit installations it is ok to place the curved mounting bracket on top of the mounting channel end caps and pinch them between the mounting channels.

STEP 8 - INSTALL REAR DRIVE TUBE

Using 2-5/16x1-3/4" bolts, 4-5/16" washers, and 2-5/16" nylon lock nuts, install the drive tube to the rear drop down mechanism. Rotate and position tube until all 4 mounting holes line up and torque nuts to 17 ft-lbs.

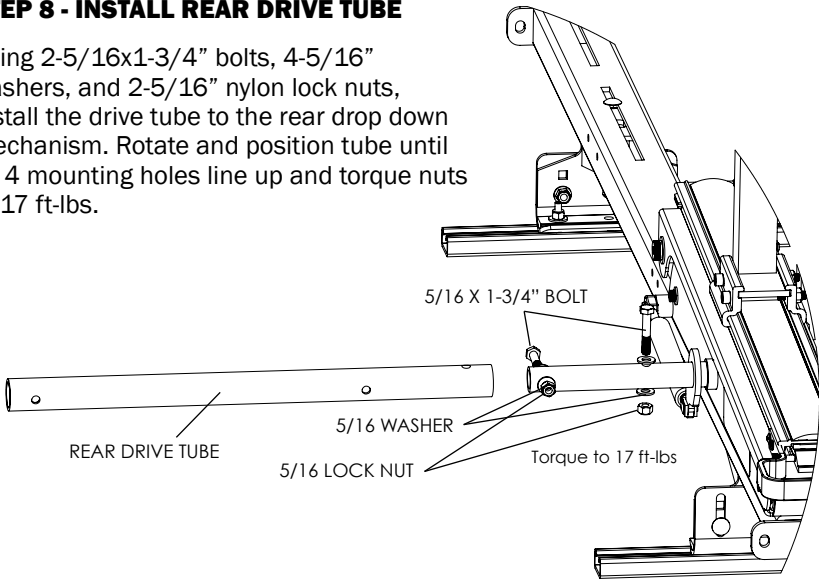

STEP 9 - INSTALL REAR COUPLING

Install the rear coupling to the drive tube using the coupling bushing and clevis pin. The coupling should be installed with the red cap on top and the open end pointing AWAY from the center of the van.

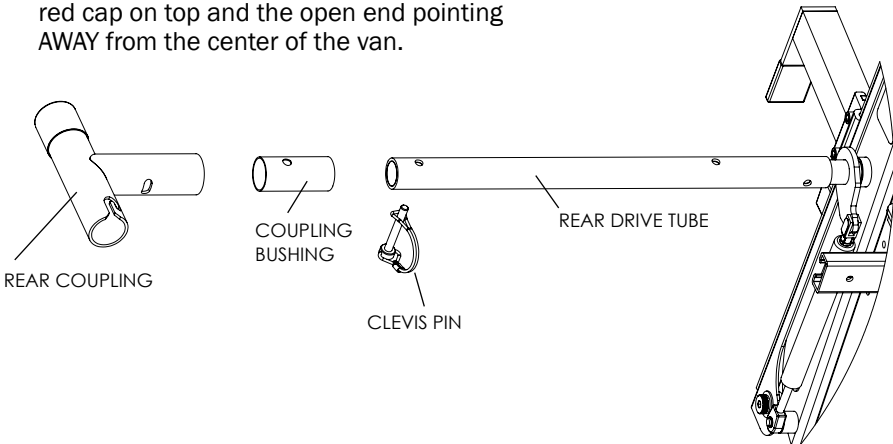

STEP 10 - POSITION AND SECURE LADDER RACK ASSEMBLY

Insert the handle into the rear coupler and ensure there is sufficient clearance between the back of the vehicle and the handle for full rotation. If more or less clearance is desired slide the rack forward or backwards in the mounting channels. Once the desired position is found, torque all 1/4" nuts to 8 ft-lbs to lock the position of the rack.

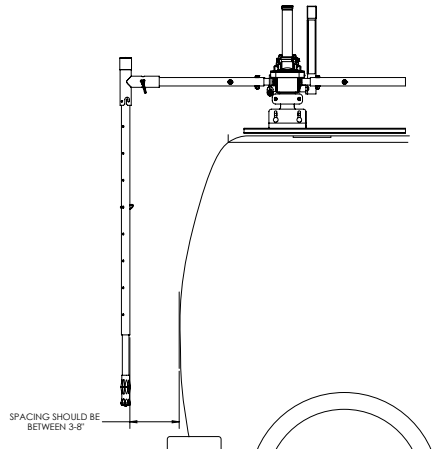

STEP 11 - INSTALL ACCESSORY VERTICAL LADDER STOPS

Using 2-5/16x1-1/4" bolts, 4- 5/16" washers, and 2-5/16" nylon lock nuts per vertical ladder stop, install 1 vertical ladder stop at the end of each cross member. Torque nuts to 17 ft-lbs.

If a dual side setup was installed do not install the ladder stops.

Your drop down ladder rack also includes two spring clips that may be installed to the inside of the van, that allow the handle to be safely stored when the handle is not in use.

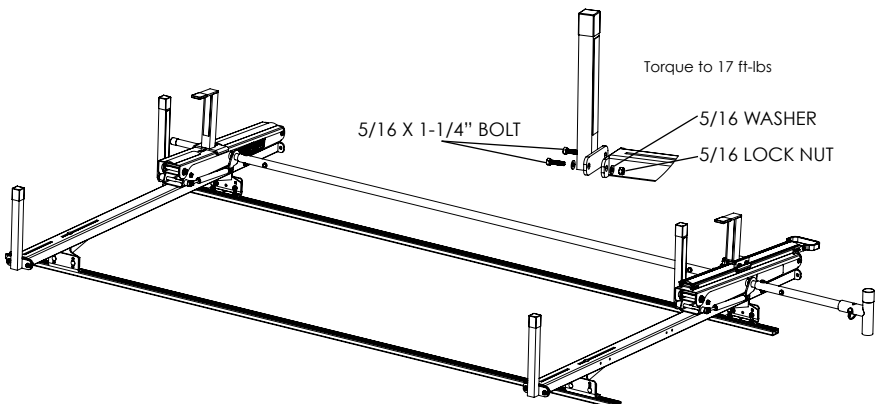



2291-3-01 EZGLIDE2™ SERVICE PARTS

PART NO	DESCRIPTION	FITS MODEL NUMBER
70500	REPLACEMENT BOLT KIT FOR MODEL 2291-3-01 EZGLIDE2™ DROP-DOWN VAN RACK	2291-3-01
70509	REPLACEMENT BUSHING KIT FOR EZGLIDE2™ EXTENDABLE DROP-DOWN MECHANISM	2291-3-01, 2295-3-01, 2297-3-01
70510	REPLACEMENT HANDLE KIT FOR EZGLIDE2™ EXTENDABLE DROP-DOWN MECHANISM	2291-3-01, 2295-3-01, 2297-3-01
70511	REPLACEMENT 89" CONNECTING TUBE FOR EZGLIDE2™ DROP-DOWN VAN RACK	2291-3-01, 2295-3-01, 2271-3-01, 2275-3-01
70512	REPLACEMENT 70" CONNECTING TUBE FOR EZGLIDE2™ DROP-DOWN VAN RACK	
70513	REPLACEMENT 36" CONNECTING TUBE FOR EZGLIDE2™ DROP-DOWN VAN RACK	
70514	REPLACEMENT LADDER STOP KIT FOR EZGLIDE2™ DROP-DOWN VAN RACK	ALL MODELS
70515	REPLACEMENT LADDER HOOK KIT FOR EZGLIDE2™ FIXED DROP-DOWN MECHANISM	ALL MODELS
70516	REPLACEMENT LADDER HOOK KIT FOR EZGLIDE2™ EXTENDABLE DROP-DOWN MECHANISM	2291-3-01, 2295-3-01, 2297-3-01
70518	REPLACEMENT BOLT KIT FOR MOUNTING CHANNEL KIT, 102 IN	2102-0-01
70519	REPLACEMENT BOLT KIT FOR MOUNTING CHANNEL KIT, 113 IN	2113-0-01
70520	REPLACEMENT RED PLASTIC CAP KIT FOR EZGLIDE2™ DROP-DOWN VAN RACK	ALL MODELS
70521	REPLACEMENT REAR HANDLE KIT FOR EZGLIDE2™ DROP-DOWN VAN RACK	ALL MODELS
70522	REPLACEMENT RUB STRIP KIT FOR EZGLIDE2™ FIXED DROP-DOWN MECHANISM	ALL MODELS
70523	REPLACEMENT RUB STRIP KIT FOR EZGLIDE2™ EXTENDABLE DROP-DOWN MECHANISM	2291-3-01, 2295-3-01, 2297-3-01
70524	REPLACEMENT DAMPER FOR EZGLIDE2™ DROP-DOWN VAN RACK	ALL MODELS
70531	REPLACEMENT EZGLIDE2™ EXTENDABLE DROP-DOWN MECHANISM	2291-3-01, 2295-3-01, 2297-3-01
70532	REPLACEMENT EZGLIDE2™ FIXED DROP-DOWN MECHANISM	ALL MODELS
70533	REPLACEMENT BUSHING KIT FOR EZGLIDE2™ DROP-DOWN VAN RACK	ALL MODELS