

# ***T-RAC G2***

## **Installation Instructions**

# Accessories

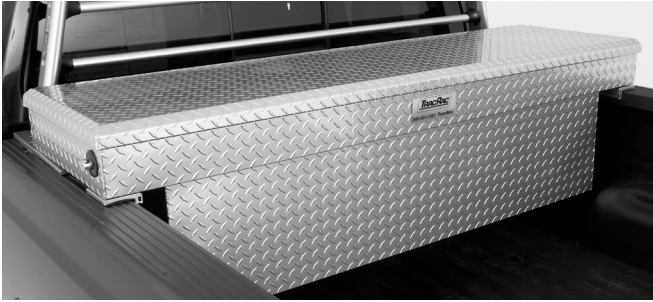

TracBox - Full size, TracRac Silver Powder Coat Finish, Crossover Toolbox.

**Features:**

- Weatherproof Seals
- Dual Push Button Shocks
- Heavy Duty Gas Shocks
- 2 Stage Rotary Latch
- Foam Filled Lid
- 5 Compartment Sliding Tray

**Dimensions:**

- L: 70 in. W: 20 in. H 20 in.



Kayak Rack Kit - Complete with all of the mounting hardware. The Kayak Kit has felt lined rear saddles and rubber front saddles for easy loading and a secure fit.

Plastic Loop Tiedowns  
Qty: 2 Tiedowns



Aluminium Die-Case CrossBar Tiedowns  
Qty: 2 Tiedowns



Bike Mount - the bike mount works with all bicycles with a removable front tire.

Part #	Description
25250	TracBox - Full Size, Crossover, Powder Coated Toolbox
41000	<a href="#">Toolbox Mount Kit</a>
25110	Aluminum Crossbar Tiedowns (Qty: 2)
44400	Plastic Loop Crossbar Tiedowns (Qty: 4)
44300	Kayak Mount Kit
25411	Bike Mount Kit

# Installation Instructions

**These instructions will guide you through the 3 main component assemblies:**

1. Upright units
2. Cross bars
3. Clamp units

*Please reference the drawing below for a general overview.*

**Tool you will need:**

- 7/32" Allen Key
- 3/16" Allen Key
- 9/16" Socket & Socket Wrench
- Tape Measure
- Recommended: Torque Wrench, 7/32" Allen Drive Bit, Drill (non-impact)

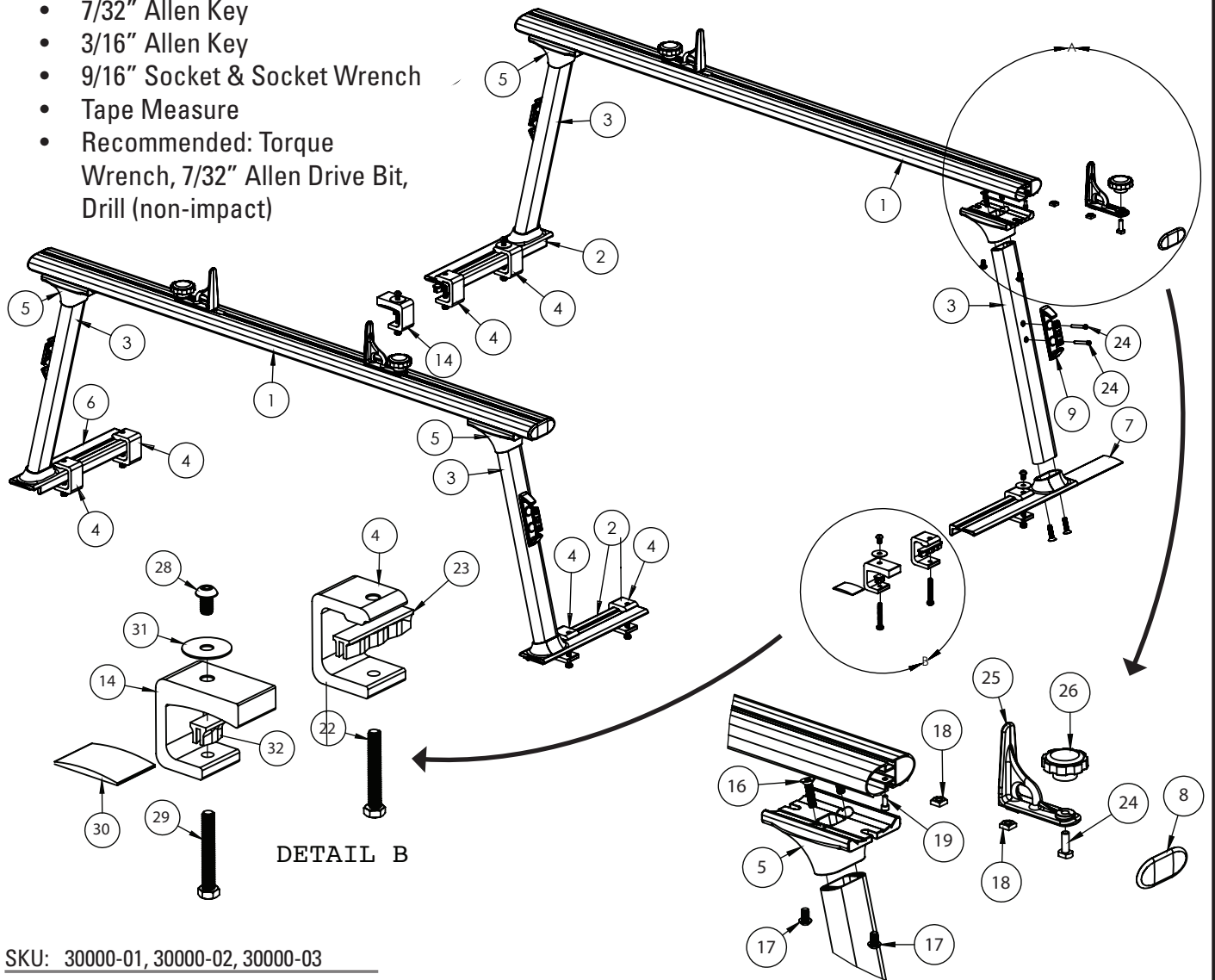

SKU: 30000-01, 30000-02, 30000-03

ITEM NO.	PART NUMBER	DESCRIPTION	01/QTY.
1	01-30008-01,02	P/C.DOUBLE T-SLOT CROSSBAR, ROUTERED	2
2	01-30009	ASM. UPRIGHT BASE, LF/RR	2
3	01-30001-01,02,03	ASM. MODULAR UPRIGHT, T-RAC	4
4	01-27029	P/C. TB FRONT MOUNT	8
5	01-27012	P/C. MODULAR SADDLE	4
6	01-30010	ASM. UPRIGHT BASE, RF/LR	2
7	RX-11034-3	SHIM, ROUNDED	4
8	01-27023	P/C. DOUBLE/TRIPLE CROSSBAR ENDCAP	4
9	01-27046	P/C. UPRIGHT CLEAT	4
10	01-27015	HARDWARE BAG - CLAMPS	1
11	01-27016	HARDWARE BAG - UPRIGHT/SADDLE	1
12	01-22757	CROSSBARTIEDOWN BAG (2 PAIR)	1
13	01-30005	HARDWARE BAG - CLEATS	1
14	01-27032	P/C. TB REAR MOUNT	2
15	01-30006	HARDWARE BAG - TB MOUNT	1

DETAIL A

# Hardware

## 01-27016 Hardware Bag-1

Upright/Saddle Hardware

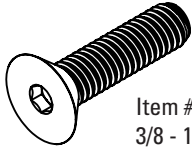

Item # 16  
3/8 - 16 x 1.5"  
Flat Head Cap Screw  
(FHCS)  
Qty - 16



Item # 17  
3/8 - 16 x .625"  
Button Head Cap  
Screw (BHCS)  
Qty - 8

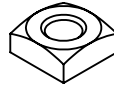

Item # 18  
3/8 - 16  
Square Nut  
Qty - 8

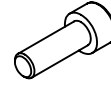

Item # 19  
M6-1  
Socket Head Cap  
Screw (SHCS)  
Qty - 4

## 01-27015 Hardware Bag-2

Clamp Hardware

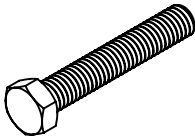

Item # 22  
3/8 - 16 x 2.5"  
Hex Head Cap Screw  
(HHCS)  
Qty - 8

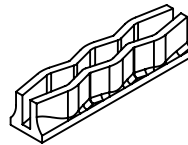

Item # 23  
3.0"  
U - Channel  
Qty - 8

## 01-22757 Hardware Bag-3

Aluminum Tie-down Hardware

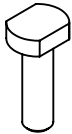

Item # 24  
3/8 - 16 x 1.125"  
Qty: 4

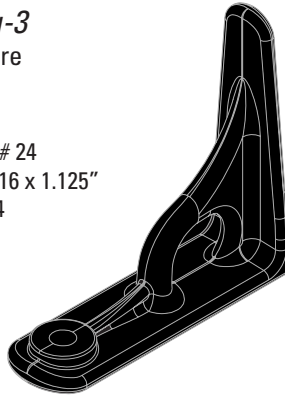

Item # 25  
Die-Cast Aluminum  
Crossbar Tiedown  
Qty:4

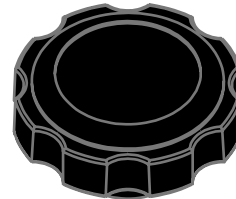

Item # 26  
Tiedown Knob  
Qty:4

## 01-30005 Hardware Bag-4

Aluminum Cleat Hardware

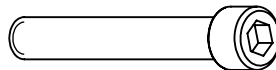

Item # 27  
1/4-20x 1.75"  
Socket Head Cap Screw (SHCS)  
Qty - 8

## 01-30006 Hardware Bag-5

Toolbox Mount Kit



Item # 28  
3/8 - 16 x .625"  
Button Head Cap Screw (BHCS)  
Qty - 4

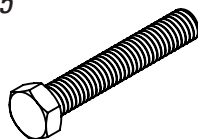

Item # 29  
3/8 - 16 x 2.5"  
Hex Head Cap Screw  
(HHCS)  
Qty - 2

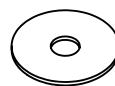

Item # 31  
3/8 - .045  
Stainless Steel Washer  
Qty - 4

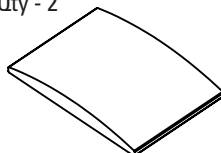

Item # 30  
Plastic Shim  
Qty - 2



Item # 32  
7/8"  
Clamp Foot  
Qty - 2

# Part 1 - Uprights

## Step 1

### Upright Assembly

1. First take the upright (Item 3) and insert it into a modular saddle (Item 5).
2. Bolt the saddle through the top by using two 3/8"-16 FHCS (Item 16) and tighten using a 7/32" Allen Key (or 7/32" Allen Drive Bit) **Torque the 3/8" -16 FHCS to 32 ft-lbs.** We recommend threading both flat head cap screw initially by hand to ensure that you don't cross thread the bolt.

 **When tightening the 3/8" FHCS ensure that the Allen Key is fully seated in the bolt so that it will not strip**

3. Now take the upright and saddle and bolt it to the modular base (Item 2)
4. For the other front upright repeat steps one through four, except use Item 6 in Step 3.

**NOTE:** Item 2 and Item 6 are mirror images of each other. Reference the packing checklist to confirm what part to use.

5. Repeat Steps 1-4 on the rear uprights
6. With the upright, saddle and base assembled, secure one of the upright cleats (Item 9) with two 1/4"-20 SHCS (Item 27) to the upright. **Torque the 1/4"-20 SHCS to 6 ft-lbs.**
7. Repeat Step 7 on each of the uprights.

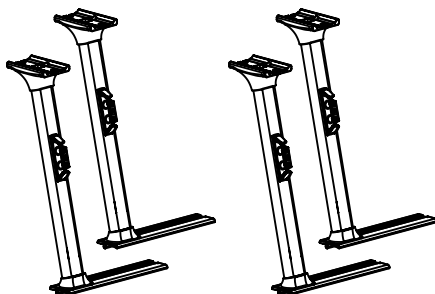

When Step 1 is complete, you will have 4 uprights.

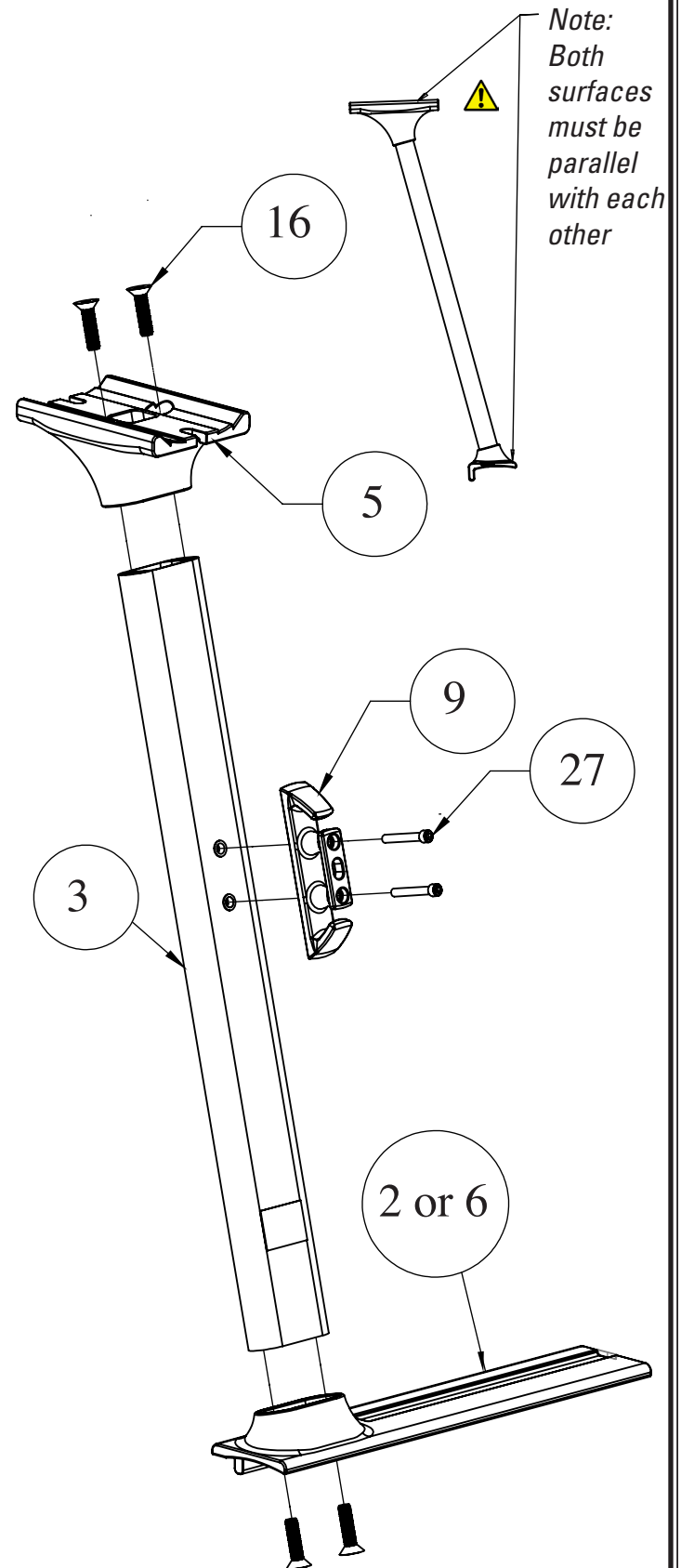

# Part 2 - Cross Bars

## Step 2

### Crossbar Assembly

1. Take the double T-Slot crossbar (Item 1) and insert four square nuts (Item 18) into the bottom T-Slot. **Reference Figure 2.1, 2.2 & 2.3**
2. Insert a T-bolt (Item 24) through the bottom of the cross bar tie-down (Item 25) and slide the unit into the top track of the crossbar so that both the bolt and the tiedown are locked into the t-track.
3. Thread a crossbar tiedown knob (Item 26) onto the T-Bolts (Item 24) and tighten in a desired location. Repeat with the other tiedown so that they face one another as in Figure 2.1.
4. Insert the Crossbar End Cap with the flat mounting surface facing down into the end of the crossbar. Using the clearance hole on the bottom of the crossbar and the M6 SHCS (Item 19). Tighten down the M6 SHCS using the 3/16" Allen Key. Repeat on the opposite side. Reference Figure 3.1
5. Repeat steps 1-4 for the remaining crossbar.

Figure 2.1

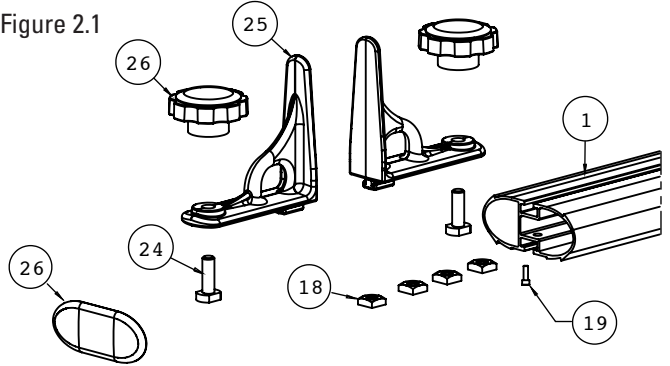

Figure 2.3

Crossbar End View

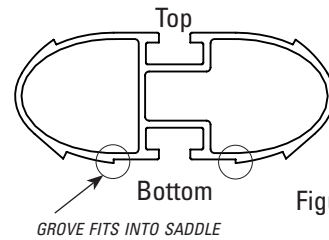

Figure 2.2

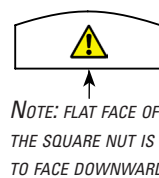
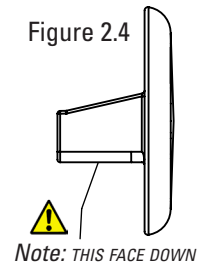

Figure 2.4



## Step 3

### Front & Rear Crossbar Installation

1. Now place the assembled crossbar on top of the assembled uprights. Make sure the crossbar is right side up. Reference Figure 2.3
2. Slide the Square Nuts (Item 18) so that they are directly above the slotted hole in the saddle. Insert the 3/8 BHCS (Item 17) into the Square Nuts (Item 18) and tighten the cap screws, using a 7/32" Allen Key or (7/32" Allen Drive Bit) Do not fully torque the screws until Step 8 of the Truck Installation  
**Note: Make sure that the BHCS sits completely within the recessed area of the saddle casting. See Figure 3.2**
3. Repeat Steps 1 and 2 for the opposite upright.
4. Repeat Steps 1-3 for the remaining crossbar.

Figure 3.1

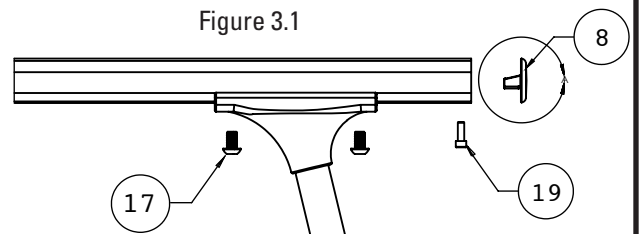
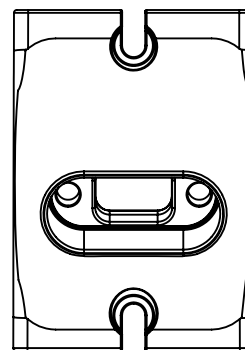

Figure 3.2



# Part 3 - Clamps & Truck Installation

## Step 4

⚠ We recommend that you apply Loc-Tite (red) to any thread that is engaged with the clamp.

⚠ HHCS (Item 22) should be re-torqued every 5000 miles.

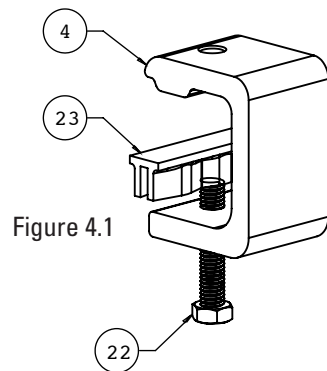

Figure 4.1

⚠ Note: clamp feet must be used to ensure proper tension between the rack and the truck bed and prevent damage

## Base Clamp Assembly

1. Take a TB Front Clamp (Item 4) and thread a 3/8"-16 HHCS (Item 22) through the bottom as shown.
2. Now take a C channel clamp foot (Item 23) and place it on top of the 3/8" HHCS as shown.
3. Repeat steps one and two for the remaining seven clamps.

## Step 5

NOTE: BE SURE TO KEEP THE RUBBER SHIM UNDER THE BASE WHEN TIGHTENING THE CLAMPS

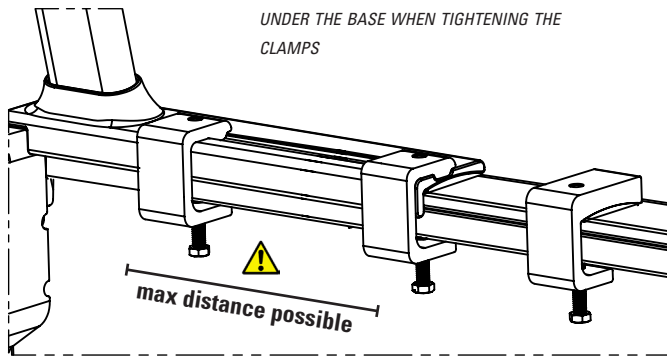

Figure 5.1

## Front Upright and Base Clamp Assembly

1. Now take the rounded shims (Item 7) and place them on the sidewalls of your truck approximately where the uprights will sit.

*The front uprights will be directly behind the rear window. Place the unit as far forward as possible*

2. Place the front uprights on top of the rounded shims (Item 7) making sure that the rubber shims are completely under the bases.
3. With one pair of uprights now on the truck, they must be secured using two Modular Clamps (Item 4). When positioning the clamps make sure they are **spaced as far apart as possible**.
4. First torque the clamps on either side of the rack towards the cab, then follow with the other two clamps towards the rear of the truck. **Torque down the HHCS to 14 lb-ft using a 9/16" socket and a torque wrench.**

## Rear Upright and Base Clamp Assembly

*The rear uprights should sit as far towards the tailgate as possible without the base hanging off the back of the bed rail, while maximizing the distance between the clamps (note step 6)*

5. Place the rear uprights on top of the rounded shims (Item 7) making sure that the rubber shims are completely under the bases.
6. With the second pair of uprights now on the truck they must be secured using two of the previously assembled (Item 4) clamps (2 per upright). When positioning the clamps make sure they are **spaced at least 7 5/16 inches apart. Any less of a distance will reduce the load capacity of the rack. You may adjust the position of the rack on the bed to ensure that this distance can be achieved**
7. Repeat step 4
8. Finally with the uprights secured you now want to take a measuring tape and center your crossbars. Once centered use your 7/32" Allen Driver to fully secure your crossbars. **Torque the BHCS to 27 ft-lbs.**

⚠ When tightening the 3/8" button head cap screws ensure that the Allen Driver is fully seated in the bolt so that it will not strip

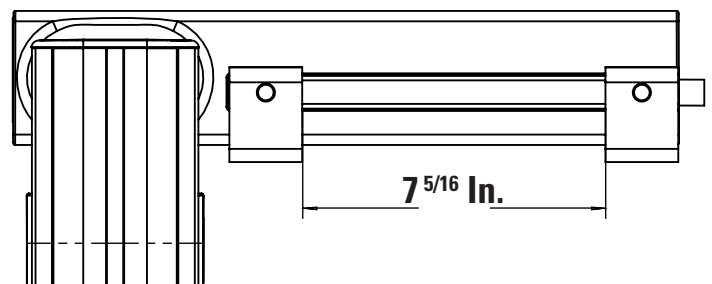

## Part 4 - Toolbox Mount

If you have a toolbox, we have included a damage-free toolbox as a *complimentary accessory* for your T-Rac G2. The following instruction will guide you through mounting your toolbox. If you do not have a toolbox, please keep the mounts in case you decide to add one later on.

1. First, take on of the TB Rear Mounts (Item 14) and thread a 3/8"-16 HHCS (Item 29) in through the bottom of the clamp. (Figure 6.1)
2. Take the C-Channel Clamp Foot (Item 32) and place it on top of the 3/8" HHCS (Figure 6.1)
3. Repeat Steps 1 & 2 for the opposite TB Rear Mount.
4. Place the Rounded Shims (Item 30) on the sidewall of your truck, approximately 4" to 5" behind the upright bases as illustrated (Figure 5.1)
5. Mount the assembled clamps (Step 1-3) onto the rounded shims and **torque down the HHCS to 14 lb-ft using a 9/16" socket and torque wrench.**
6. Place your toolbox on top of the clamps and secure it by using the 3/8" washer (Item 31) and the 3/8"-16 BHCS (Item 28). **Torque the BHCS to 27 ft-lbs.**

**⚠ Note:** When positioning the toolbox, please note that there is sufficient clearance for the lid to open so that it does not scratch the uprights.

**⚠ IMPORTANT:** If your toolbox does not come with pre-drilled holes/slots that line up with the threaded clamps, you will need to position you toolbox in the desired location, mark the necessary hole locations, remove the toolbox and then drill either a 13/32" or 7/16" clearance hole. After the holes are drilled you will be able to mount your toolbox.

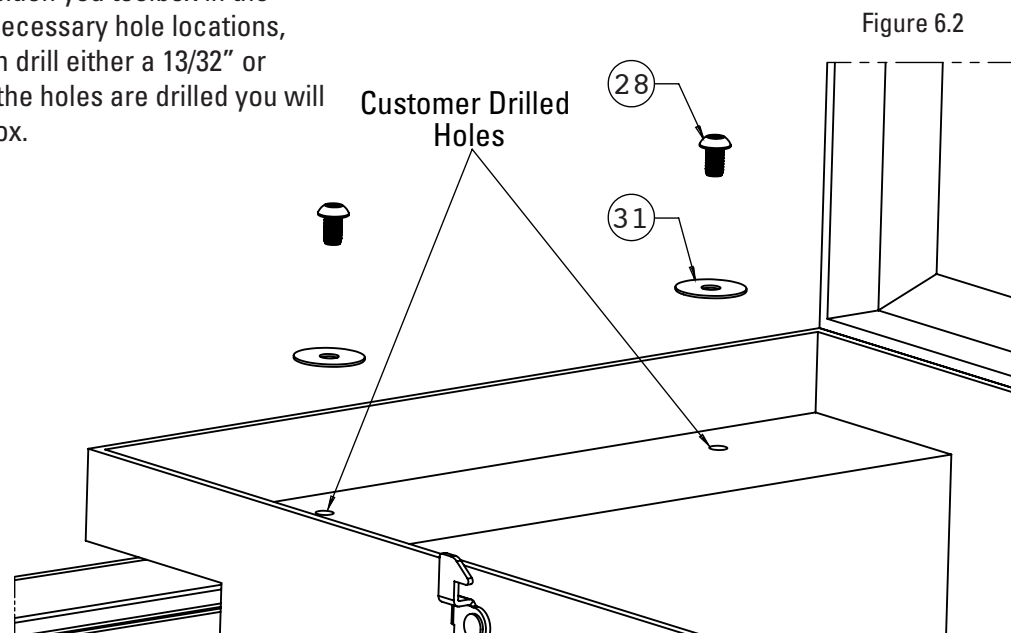
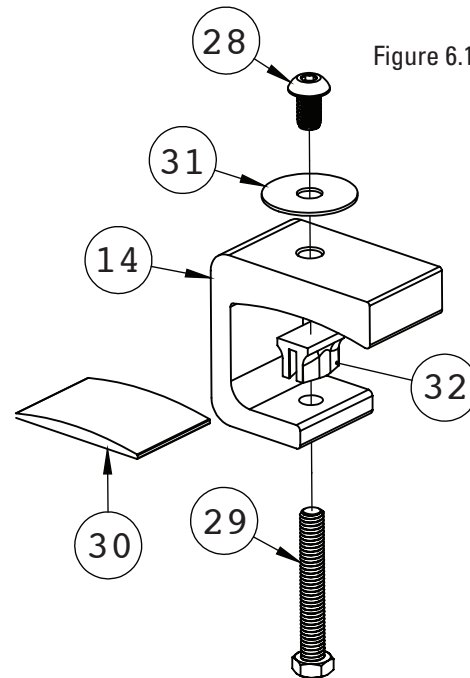



# Toyota Tacoma Mount Installation

## Tacoma Installation (Clamp Set)

1. Remove the plastic end-caps from the factory installed rails, front and back.
2. Take the Tacoma mount clamp and partially thread a 3/8"-16 hex head cap screw through the tapped hole located on the bottom of the clamp.
3. Slide two clamps into each factory installed rail from the back end of the truck and replace the rear end-caps.
4. Slide two clamps into each factory installed rail from the front end of the truck and replace the front end-caps.
5. With the clamps retained in the track now slide 2 of them on each upright base, the clamps should be spaced as far a part as possible.
6. With the base in the desired location place a 3" U channel on top of the hex head cap screws. Reference the placement of the uprights from the included installation book.
7. Torque the hex head cap screws down to 14 lb-ft using a 9/16" open end wrench.

- *Note: The 3" U Channel and 3/8"-16 Hex Head Cap Screw are included with the original rack hardware.*

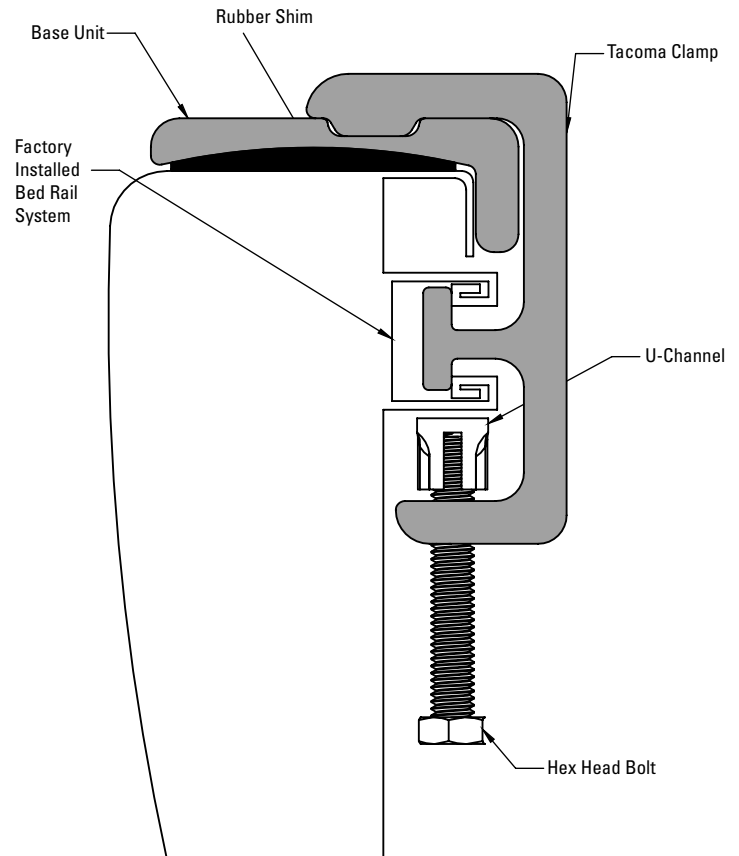

# Toyota Tacoma Toolbox Installation

1. Remove the plastic end-caps from the factory installed rails, front and back.
2. Take the Tacoma Tool Box Mount Clamp and partially thread a 3/8" -16 hex head cap screw through the tapped hole located on the bottom of the clamp.
3. Slide two clamps into each factory installed rail from the back end of the truck and replace the rear end-caps.
4. Slide three clamps into each factory installed rail from the front end of the truck and replace the front end-caps.
5. With the clamps retained in the track now slide 2 of them on each upright base, with the base in the desired location place a 3" U channel on top of the hex head caps screws.
6. Place a rubber shim and tool box shim under the two remaining clamps along with a 7/8" U channel on top of the hex head caps screws.
7. Torque the hex head cap screws down to 14 lb-ft using a 9/16" open end wrench.
8. Follow the remaining steps in Part 4 of directions above to install the toolbox.

- *The 3" U Channel and 3/8"-16 Hex Head Cap Screw are included with the original rack hardware.*

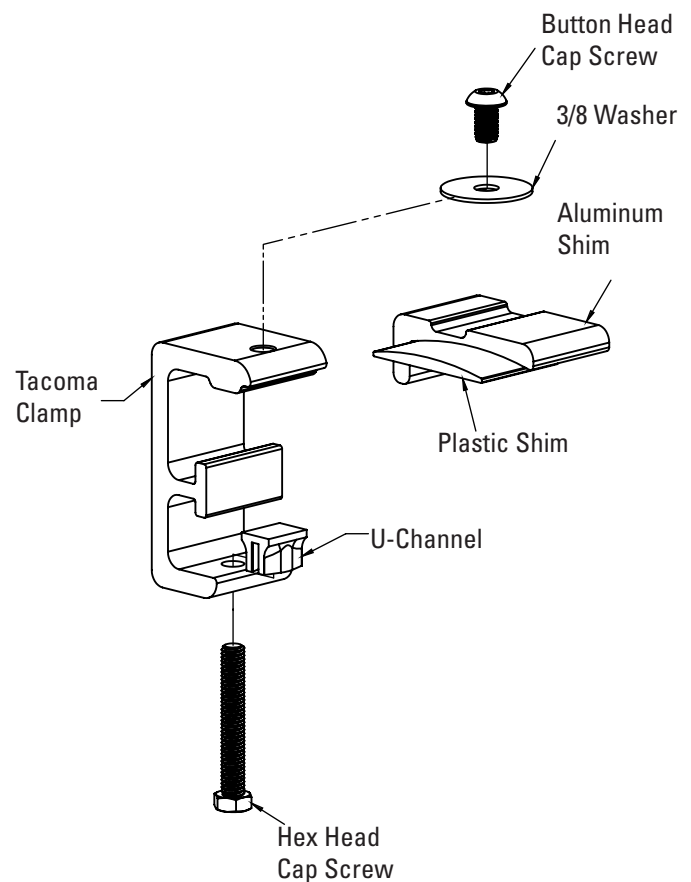

## When Complete

