

EN = North American English

EN PARTS INCLUDED

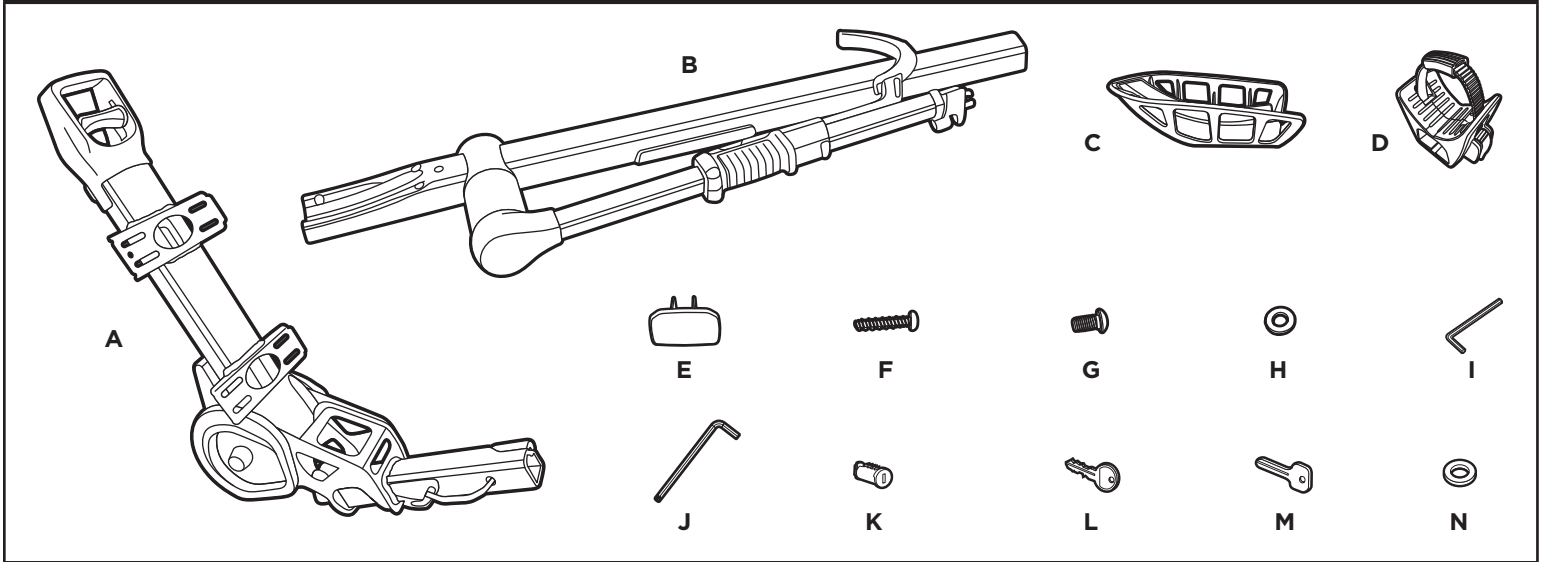

EN part	EN description	EN qty.
A	EN main stinger assembly	1
B	EN bike trays with ratchet arms	2
C	EN front wheel holder	2
D	EN rear wheel holder assembly	2
E	EN tray end cap	2
F	EN 4mm self tapping screw	10
G	EN 5mm button head screw	8
H	EN M8 washer	8
I	EN 4mm Allen wrench	1
J	EN 5mm Allen wrench with ball end	1
K	EN lock cylinders	3
L	EN keys / ES llaves	2
M	EN change key	1
N	EN M6 washer	2

EN

WARNINGS / LIMITATIONS:

- Fits 20-29" wheeled bikes and tires up to 5" wide.
- The 9034 model for a 2" hitch will carry up to 60lbs per tray, or 120lbs total. With the 2 bike add-on installed, the total max weight is 160lbs.
- The 9035 model for a 1.25" hitch will carry up to 60lbs per tray, or 100lbs total.
- Carries bikes with wheelbases up to 50.5"
- Check tightness of all bolts and knobs periodically.
- Not intended for off-road use.
- Check straps for wear and replace if worn.
- Not intended for tandems or recumbents.
- Your vehicle must be equipped with a 2" or 1-1/4" receiver hitch.
- DO NOT INSTALL on a trailer or other towed vehicle.
- The maximum capacity for class 1 hitches is 2 bikes.
- DO NOT USE product with bike that has tire fenders. This prevents a secure grip of the front wheel by the Ratchet Arm Bike Hook.
- Load heaviest bike closest to vehicle and lightest bike last
- Remove rack before entering an automatic car wash.
- Do not transport bicycles with attached baby seats, panniers, disc wheels, or full bike covers.
- It is the user's responsibility to ensure compliance with all federal, state and local laws when using any Thule product.
- Drive slowly over speed bumps 5-10mph (8-16 kph) max.

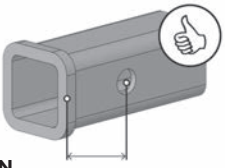

EN Minimum 1.5"

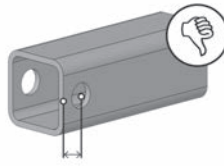

EN Not acceptable if distance is less than 1.5"

EN

- For both safety and performance, Thule requires the distance from the center of the hitch pin hole to the face of the receiver be at least 1.5 inches.

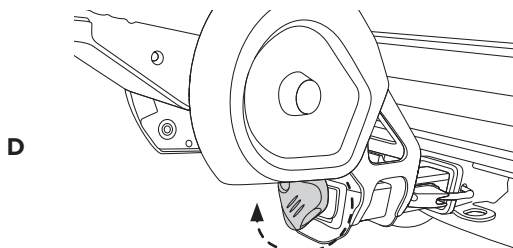
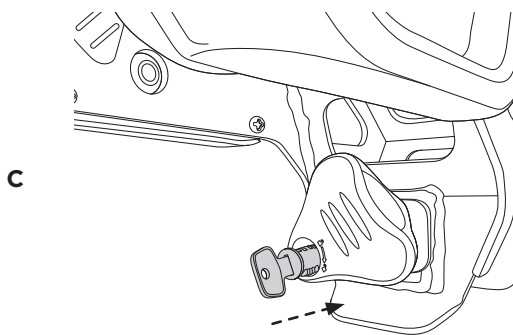
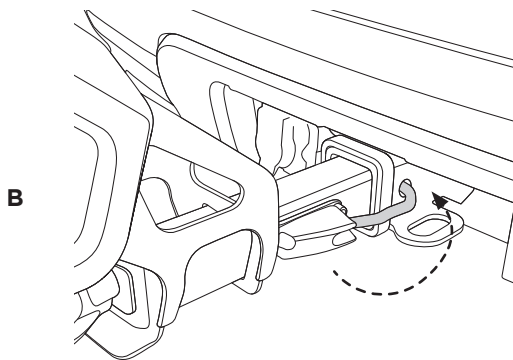
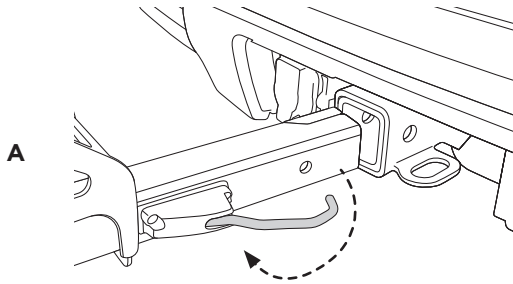
**EN**

IMPORTANT: Before attempting to install rack, measure your vehicle's hitch to be sure this rack will fit your vehicle. Refer to the instructions on the first page.

- A. Before inserting stinger assembly, first pull back the Auto Pin so that it stays in the open position.
- B. Slide stinger into hitch until the hole in the stinger is aligned with the hole in the hitch. Push Auto Pin closed so that it engages with hole in the stinger. If you cannot close the Auto Pin correctly, **THEN YOU CANNOT USE THE RACK.**
- C. Using the "change key", install the lock cylinder into the lock knob.
- D. Firmly turn the knob clockwise to tighten the rack in the receiver. When finished, grasp the rack and shake it side to side to ensure it is secure to the vehicle. If the rack is loose in the receiver, further tighten the knob.
- E. Check knob tightness periodically during first 200 miles of use.

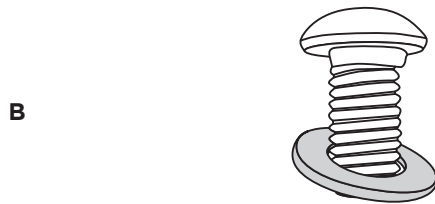
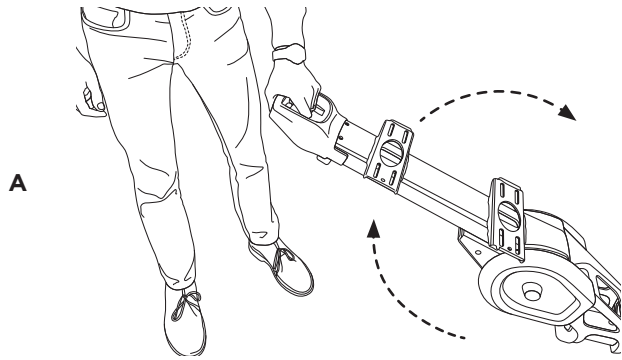

EN ratchet arm pivot

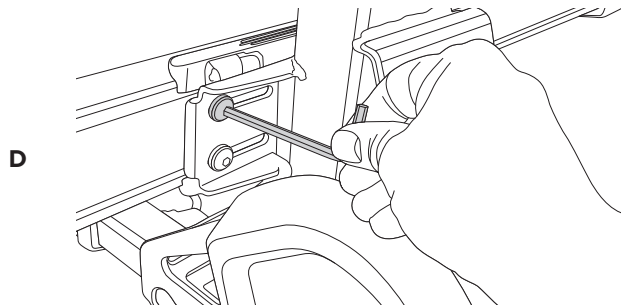
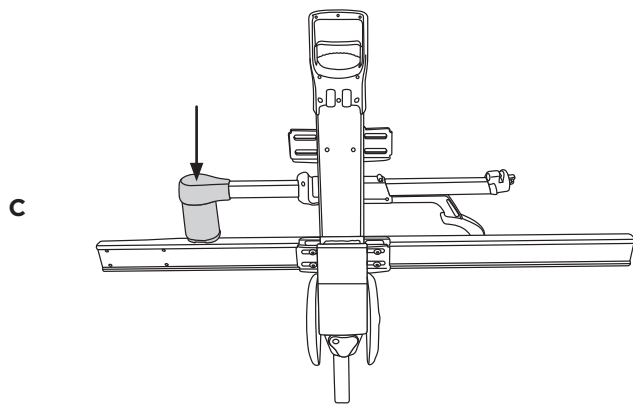

EN

- A. Pull HitchSwitch lever and rotate mast to vertical position.
- B. Pre-assemble each 5mm screw and washer as shown.
- C. Install first tray as shown in image C, with the ratchet arm pivot located on the driver's side of the vehicle. The threaded inserts of the tray should align with the slots in the attachment plates.
- D. Tighten each 5mm screw using the 5mm Allen wrench with ball end provided. For easier Allen wrench clearance -position threaded inserts all the way to one side of the slot and loosely thread screws. Then slide tray so that opposite side inserts align with outer edge of slot and loosely thread screws. Center tray assembly in slots and tighten. For easier/faster installation, use a ratchet with a 5mm head. Repeat process for second tray, however, reverse the orientation so that the ratchet arm pivot is on the passenger side of vehicle.

E

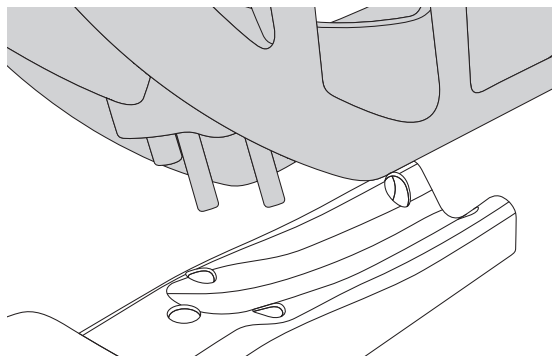
**EN**

- E. Install each front wheel holder using the five holes in each bike tray for alignment.
- F. Secure each wheel holder to the trays using four 4mm self tapping screws per wheel holder. Do not over-tighten.
- G. Slide each rear wheel holder onto each tray so that the buckle faces up/away from the vehicle.
- H. Install each end cap into each tray using a 4mm self tapping screw and M6 washer. Do not over-tighten.

F

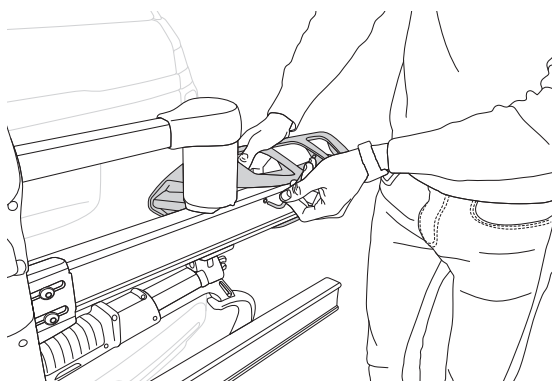

G

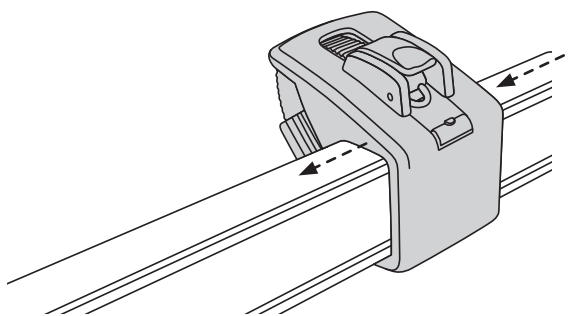

H

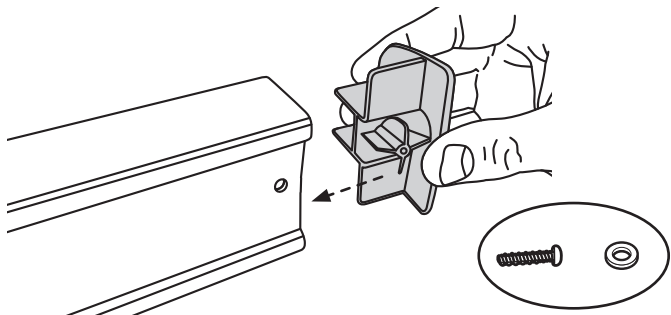

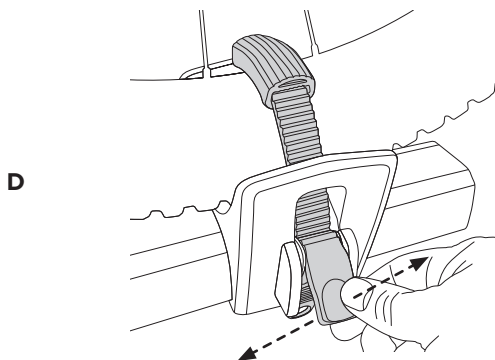
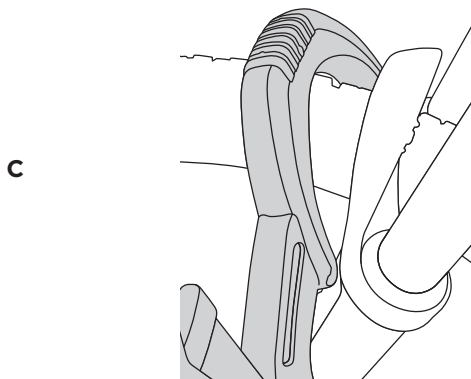
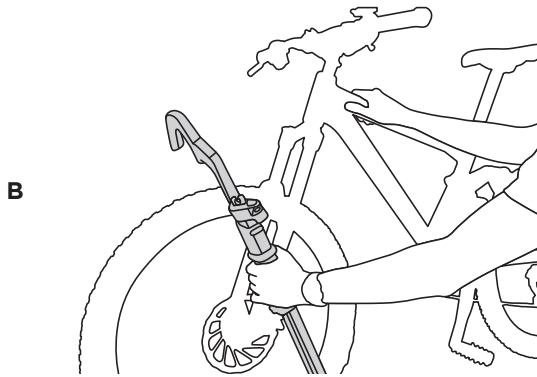
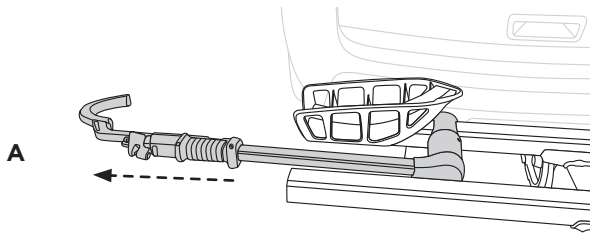
**EN**

- A. Begin by pressing grey ratchet trigger to fully extend arm out and away from vehicle.
- B. Load first bike in tray nearest to the vehicle with wheels in their respective holders.
- C. While holding bike with one hand, rotate ratchet arm up and over the front wheel. Then pull the arm down so that the V-notched hook is firmly seated against the tire.
- D. Secure rear wheel by inserting strap into pump buckle and ratcheting it down.

WARNING: The V-notched hook must be positioned no more than 1" away from your bicycle's front brake or fork crown. **FAILURE TO DO SO MAY RESULT IN LOSS OF BICYCLE.**

NOTE: The ratchet arm is only designed to secure the front wheel of a bicycle. Do not attempt to secure the ratchet arm to your bike's rear wheel or frame top tube.

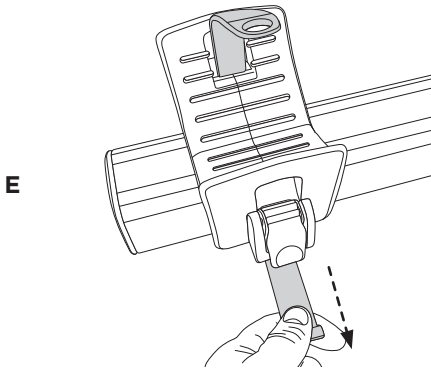
**EN**

- E. For “fat bike” and “plus sized” tires, first remove the rear wheel strap as shown.
- F. Then re-route the strap as shown so that your length of usable strap is increased. No modifications need to be made to the front wheel holder to accommodate these wheel sizes.
- G. FIT TIP: If you run into clearance issues between the handlebars and saddles of your bikes, the bike trays can be adjusted 3” left to right by loosening the 5mm bolts and readjusting.
- H. FIT TIP: Be sure to re-tighten and periodically check the security of these bolts.

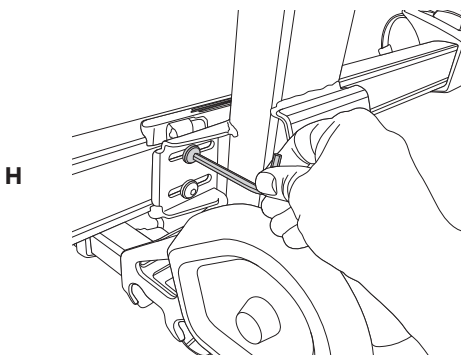
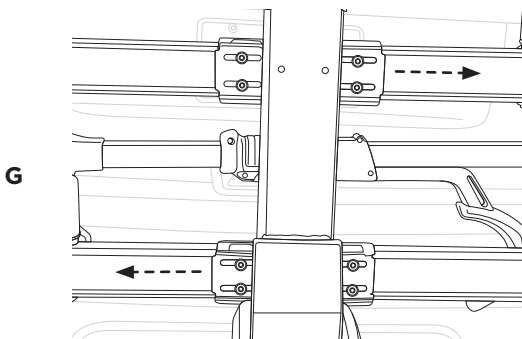
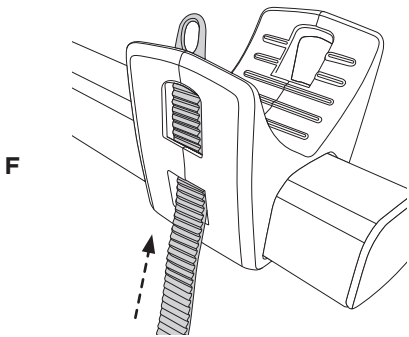

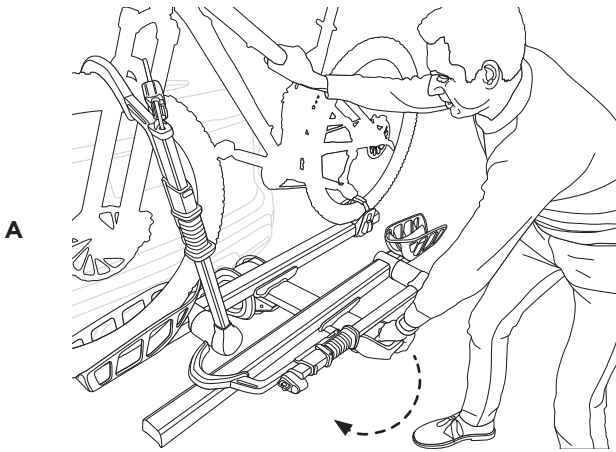
**EN**

- A. If you need to access the rear of your vehicle with bikes mounted, you can do so by tilting the carrier down. Just pull on the HitchSwitch lever and allow the carrier to tilt down until it stops. We find it helpful to control the carrier as it tilts down by using your other hand to brace the bikes as the rack drops down.
- B. When traveling without bikes, carrier can be rotated into vertical position by pulling the HitchSwitch lever and tilting it towards the vehicle.

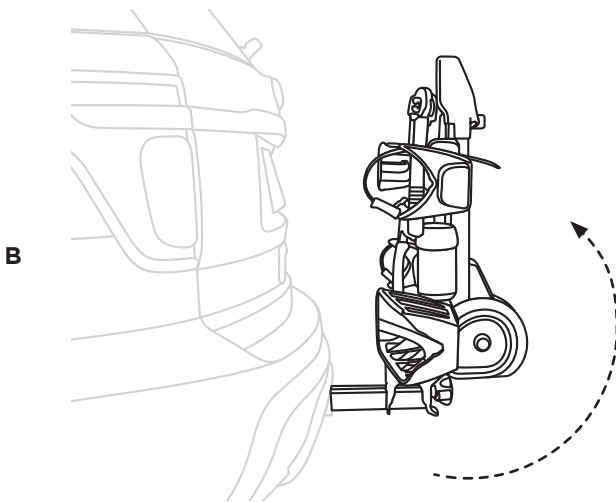

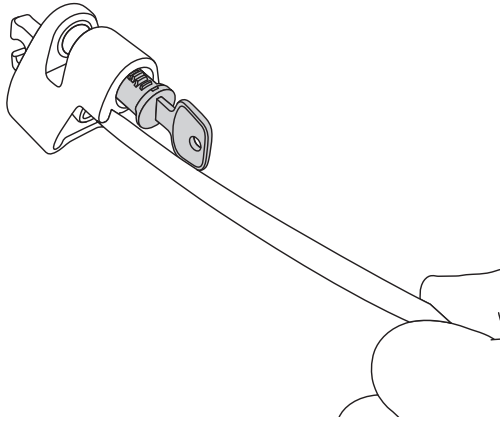

A

EN

- A. Using the “change key”, insert the lock cylinder into the lock housing as shown.
- B. Route cable through front wheel and/or frame of bike, and lock it using keys. NOTE: This lock is meant as “theft prevention” only. We advise against leaving your bike unattended for extended periods of time (hotel parking lots, shopping malls, etc.).

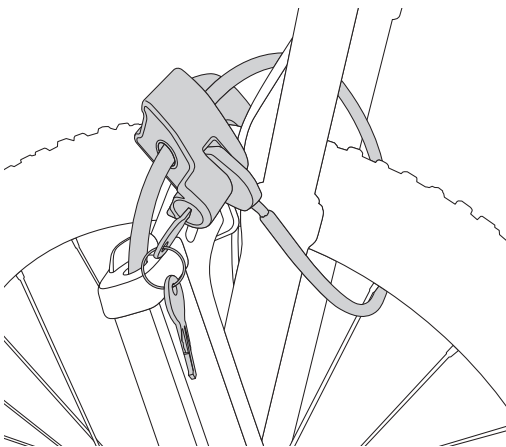

B

THULE RACK GUIDELINES

When using Thule Load carriers and accessories, the user must understand the precautions. The points listed below will assist you in using the rack system and will encourage safety.

- For quality fits and safety, use only the recommended rack or accessory as stated in Thule's current Fit Guide. Do not assume a rack will fit, always check the current Fit Guide when obtaining a new vehicle.
- The maximum load specified in the assembly instructions is not to be exceeded. However, this limit is always subordinate to the maximum load recommended by the manufacturer of the car itself. It is always the lower maximum recommended load that applies. **Max roof load = load carrier weight + any fitted carrier accessories + the weight of the load itself.**
- Always make sure all doors are open when mounting a roof rack system. Make sure all knobs, bolts, screws, straps, and locks are firmly attached, tightened and locked before every trip. Knobs, bolts, screws, straps and locks must be periodically inspected for signs of wear, corrosion, and fatigue. Check your load at stops during the trip to ensure continued fastening security.
- Check local and state laws governing projection of objects beyond the perimeter of a vehicle. Be aware of the width and height of your cargo since low clearance branches, bridges, and parking garages can affect the load. All cargo will affect the vehicle's driving behavior. Never drive with any lock, knob or rack in an open or unlocked position. All long loads such as, but not limited to, sailboards, surfboards, kayaks, canoes, and lumber must be tied down front and rear to the bumpers or tow hooks of the vehicle.
- Remove your Thule rack and accessories when they are not in use and before entering automatic car washes.
- All locks must be turned and moved periodically to ensure smooth operation. Use graphite or dry lubricant to help this. Thule locks are designed to deter vandalism and theft but should not be considered theft proof. Remove valuable gear if your vehicle is unattended for an extended period. Place at least one key in the glove compartment.
- For safety to your vehicle and rack system, obey all posted speed limits and traffic cautions. Adapt your speed to the conditions of the road and the load being carried.
- Do not use Thule load carriers and accessories for purposes other than those for which they were designed. Do not exceed their carrying capacity. Failure to follow these guidelines or the product's instructions will void the warranty.
- All loads must be secured using the provided straps.
- Consult with your Thule dealer if you have any questions regarding the operations and limits of Thule products. Review all instructions and warranty information carefully.
- Not for use on trailers or towed vehicles.
- Not for offroad use.
- Keep bicycle tires away from hot exhaust.

THULE CAR RACK SYSTEMS LIMITED LIFETIME WARRANTY

THULE will warranty all THULE brand car rack systems and its accessories manufactured by THULE during the time that an original retail purchaser owns the product. This warranty terminates if a purchaser transfers the product to any other person.

Subject to the limitations and exclusions described in this warranty, THULE will remedy defects in materials or workmanship by repairing or replacing, at its option, a defective product without charge for parts or labor. In addition, THULE may elect, at its option, not to repair or replace a defective product but rather issue to a purchaser a refund equal to the purchase price paid for the product or a credit to be used toward the purchase of a new THULE load carrier system.

No warranty is given for defects caused by normal wear and tear, cosmetic rust, scratches, accidents, unlawful vehicle operation, or modification of, or any types of repair of, a load carrier system other than those authorized by THULE.

No warranty is given for defects resulting from conditions beyond THULE's control including, but not limited to, misuse, overloading, or failure to assemble, mount or use the product in accordance with THULE's written instructions or guidelines included with the product or made available to the purchaser.

In the event that a product is defective, the purchaser should contact the THULE dealer from whom the product was purchased or an Authorized Thule Service Center. If the dealer or Authorized Thule Service Center is not able to correct the defect, the purchaser should contact THULE in writing or by phone using the contact information listed at the bottom of this page.

In the event that a product needs to be returned to THULE, a THULE technician at the address or telephone number listed below will provide the purchaser with the appropriate mailing address and any additional instructions. Please note that the purchaser will be responsible for the cost of mailing the product to THULE and that proof of purchase in the form of an original purchase invoice or receipt and a detailed description of the defect must be included in the mailing.

DISCLAIMER OF LIABILITY
REPAIR OR REPLACEMENT OF A DEFECTIVE PRODUCT OR THE ISSUANCE OF A REFUND OR CREDIT (AS DETERMINED BY THULE) IS A PURCHASER'S EXCLUSIVE REMEDY UNDER THIS WARRANTY. DAMAGE TO A PURCHASER'S VEHICLE, CARGO AND/OR TO ANY OTHER PERSON OR PROPERTY IS EXCLUDED.

THIS WARRANTY IS EXPRESSLY MADE IN LIEU OF ANY AND ALL OTHER WARRANTIES, EXPRESS OR IMPLIED, INCLUDING THE WARRANTIES OF MERCHANTABILITY AND FITNESS FOR A PARTICULAR PURPOSE.

THULE'S SOLE LIABILITY TO ANY PURCHASER IS LIMITED TO THE REMEDY SET FORTH ABOVE. IN NO EVENT WILL THULE BE LIABLE FOR ANY LOST PROFITS, LOST SALES, OR FOR ANY CONSEQUENTIAL, DIRECT, INDIRECT, INCIDENTAL, SPECIAL, EXEMPLARY, OR PUNITIVE DAMAGES OR FOR ANY OTHER DAMAGES OF ANY KIND OR NATURE.

SOME STATES DO NOT ALLOW THE EXCLUSION OR LIMITATION OF INCIDENTAL OR CONSEQUENTIAL DAMAGES, SO THE ABOVE LIMITATIONS MAY NOT BE APPLICABLE.

THIS WARRANTY GIVES YOU SPECIFIC LEGAL RIGHTS, AND YOU MAY ALSO HAVE OTHER RIGHTS WHICH VARY FROM STATE TO STATE.