

PARTS INCLUDED

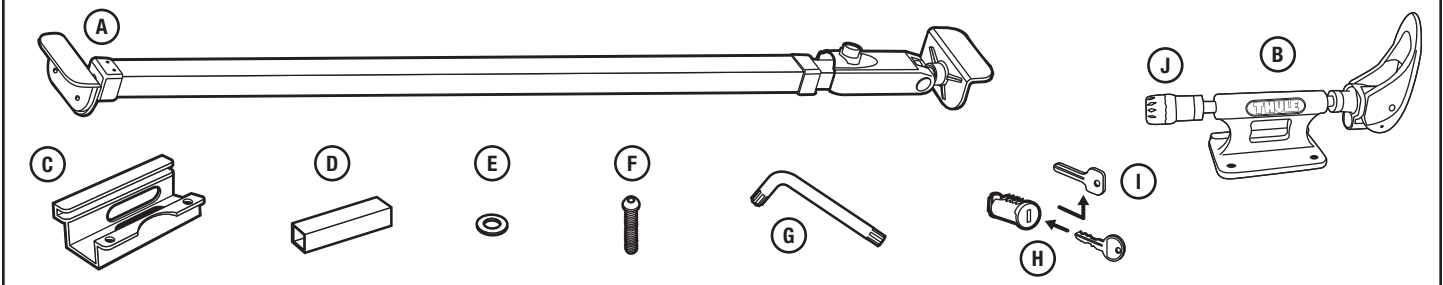

part	description	part number	qty
A	bed bar	—	1
B	low-rider fork blocks	853-5278	2
C	underbar plate	853-5279	2
D	rubber spacer	853-5351	2
E	washer M6	951-0612-54	4
F	tamper proof screw M6	853-5269	4
G	tamper proof wrench	853-5270-02	1
H	lock cylinders and keys	—	3
I	change key	853-1251	1
J	fork clamping skewer	752-0943001	2

COMPATIBILITIES / RESTRICTIONS

- Bike must come equipped with a quick release front skewer.
- Measure the dimensions of your bike's fork dropouts. This carrier is not compatible with fork dropouts less than 4 mm or greater than 12 mm thick. Dropouts must be 100 mm apart.
- If your fork has a unique feature or design that prevents your using the carrier in accordance with these instructions, do not use the carrier. An upright carrier should be used.
- Due to their wind resistance, it is not recommended to carry disk wheels or wheels with covers on Thule bike or wheel carriers.
- Failure to properly install, adjust, use and maintain the quick release mechanism on this carrier may result in damage to the vehicle and bike as well as serious personal injury.
- Any modification to bike dropouts can cause insufficient fork mount clamping pressure and may result in damage or loss of bike.
- Bed width must be more than 47 3/4" and less than 72" wide.
- Not compatible with tandem or recumbent bikes.
- Will not work on trucks with over the rail bedliners.

1

PRE-ASSEMBLY

a

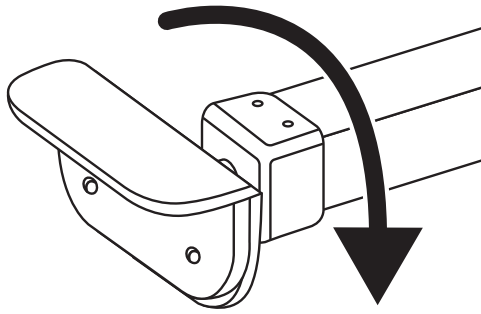

- Make sure threaded rail foot is completely screwed in.

b

- Depress security button underneath of Bed Bar.

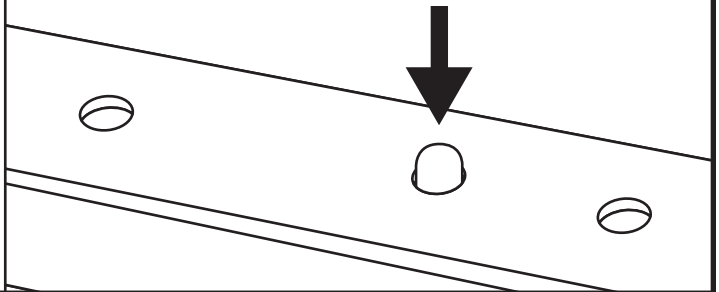

c

- Extend until rail feet touch inside edge of truck bed side walls.

- Ensure security button is engaged in a hole.

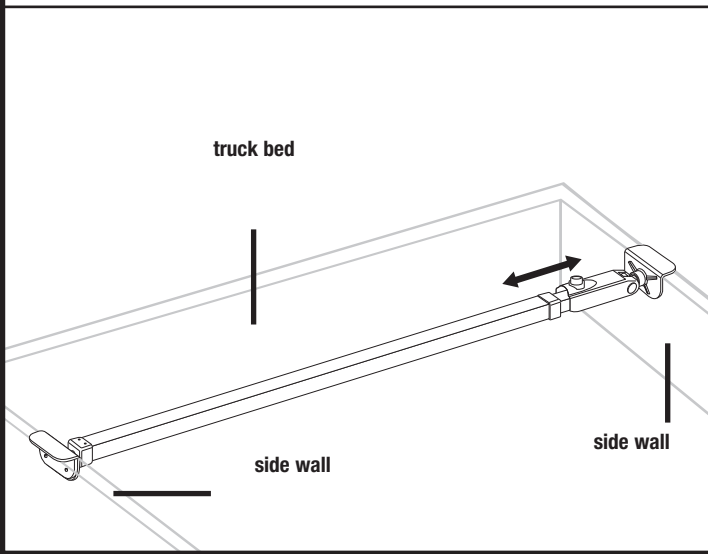
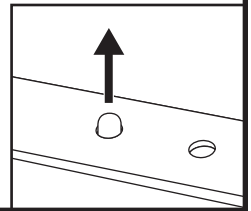

2

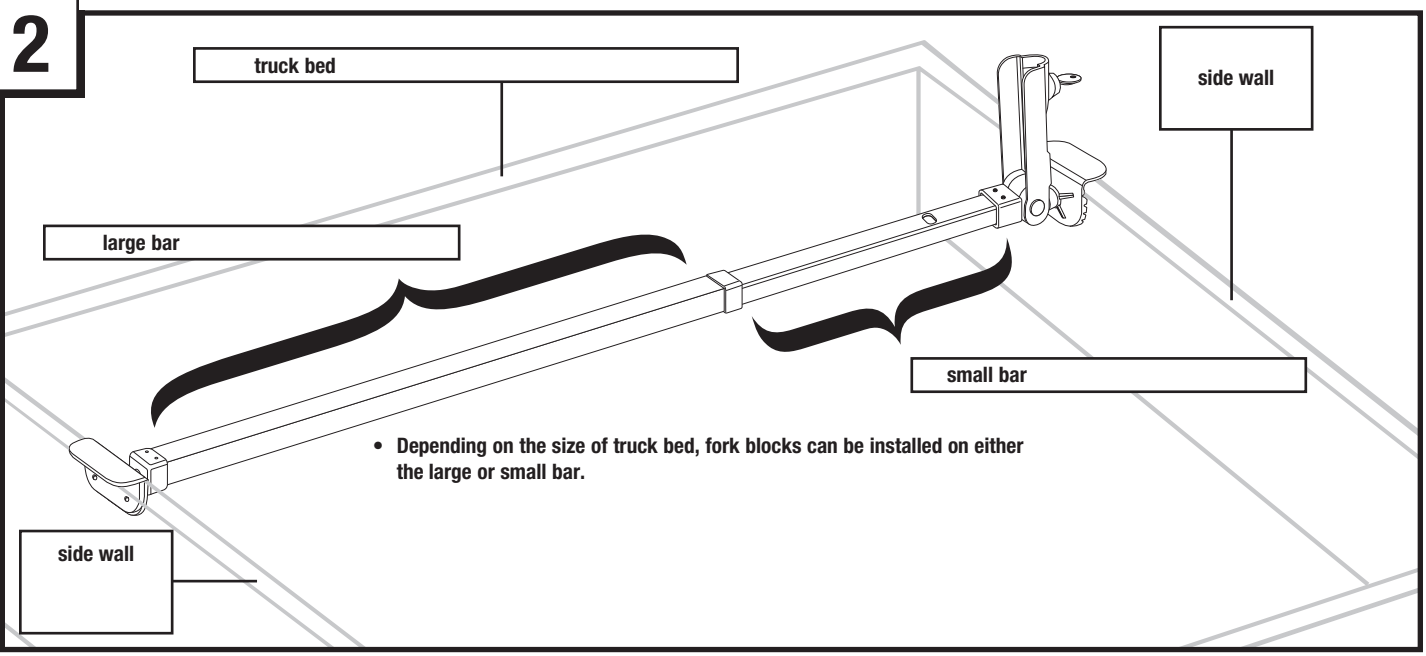

- Depending on the size of truck bed, fork blocks can be installed on either the large or small bar.

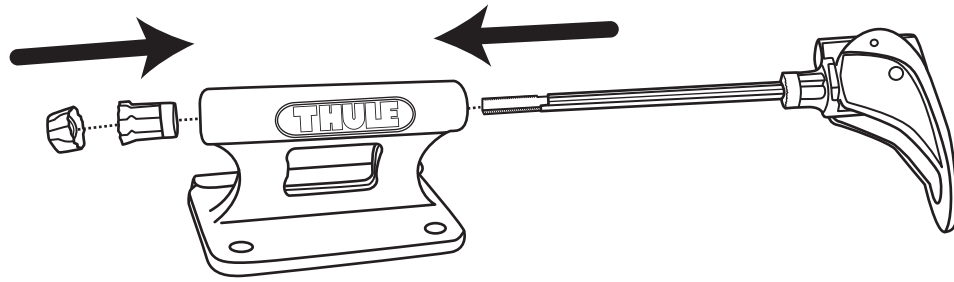
3

- Unscrew the ratcheting nut and nut body off the end of the skewer as shown. Slide skewer rod through channel in fork block. If loading bike from the side of the truck, lever should face that side for easier loading. Re-attach skewer ratcheting nut and body. The skewer rod and ratcheting nut have a rectangular slot that must be aligned.

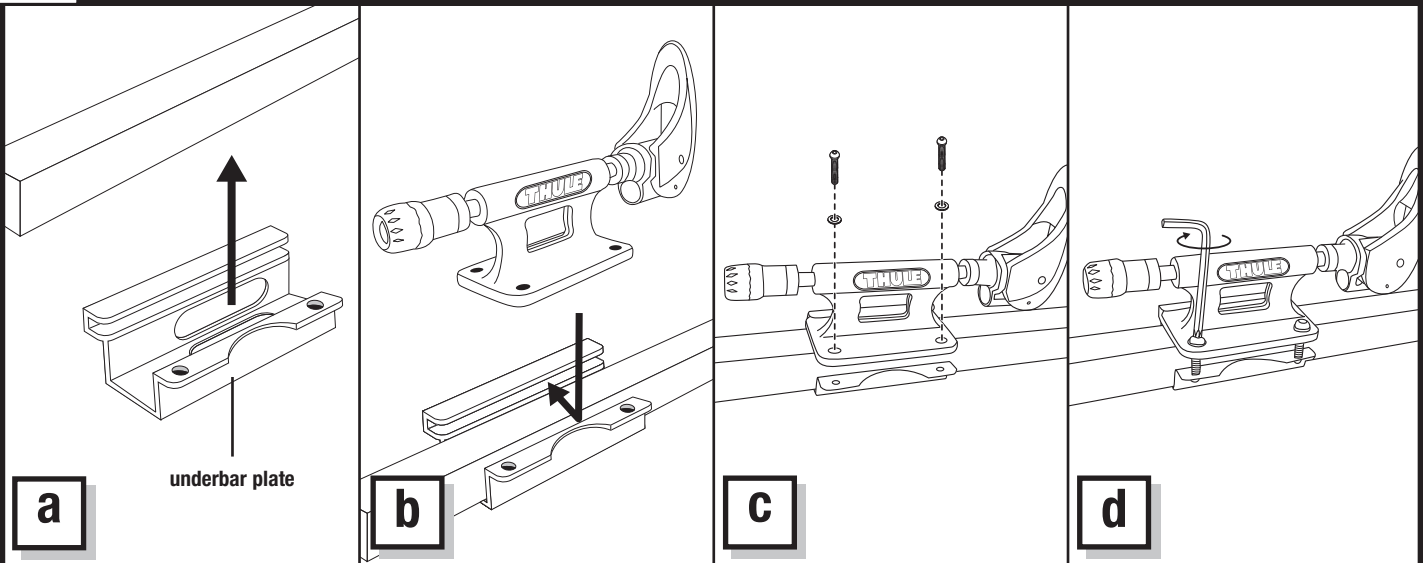
4**FOR LARGE BAR MOUNTING****a**

underbar plate

b**c****d**

- Blocks can be installed on top or sides of bed bar.

- Tighten screws snugly.

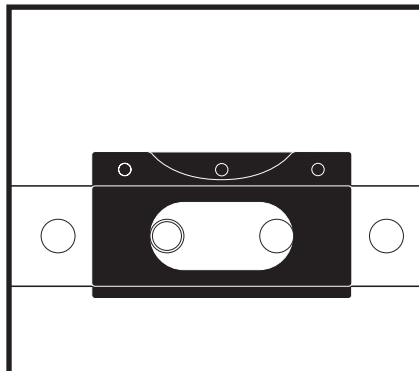

- For convenience position underbar plate and fork block so that it straddles adjustment holes underneath bed bar.

5

FOR SMALL BAR MOUNTING

- Remove Bed-Rider from truck bed.

- Depress button

- Slide tubes apart.

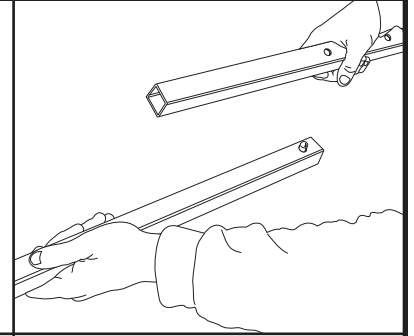

- Slide rubber spacer over tube to the desired position.

- Water can be used on bar to help slide spacer.

- A white talc residue from the manufacturing process has been left on the rubber spacer to help slide into position. Once assembled it can be wiped off with water.

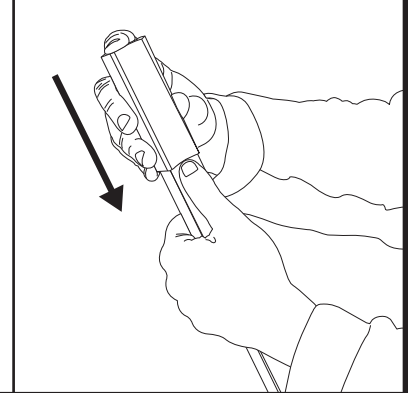

- Reassemble telescoping tubes together.

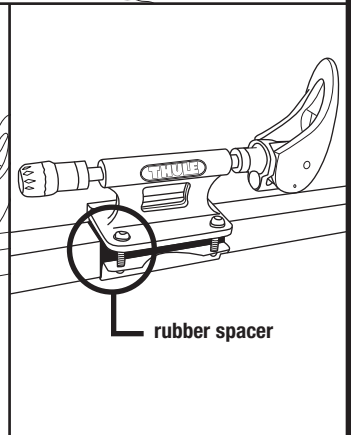
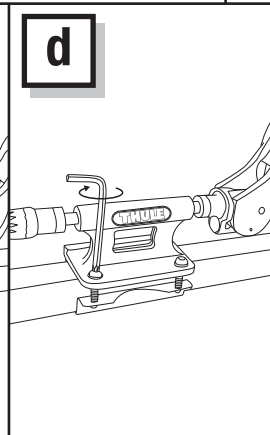
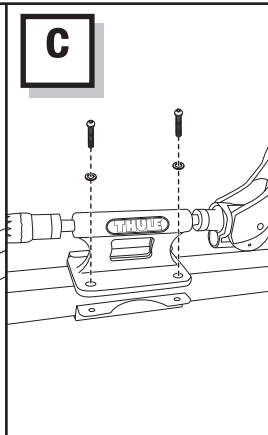
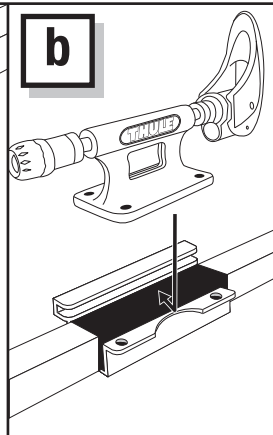
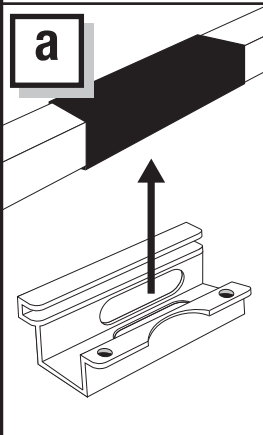
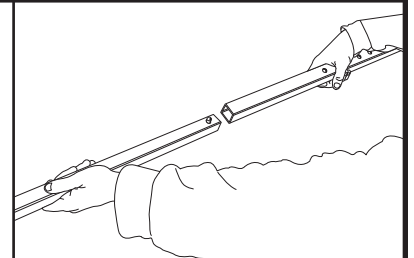

- Assemble block on rubber spacer.

- Blocks can be installed on top or sides of bed bar.

- Tighten screws snugly.

S

- Make sure the underbar plate is positioned around the rubber spacer.

6

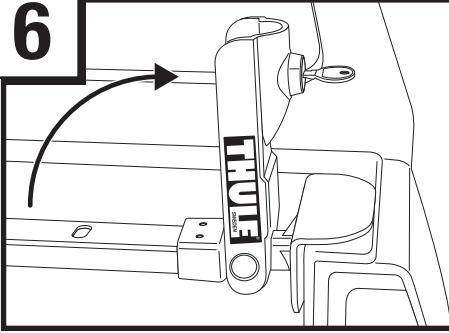

- Open cam handle.

7

- Rotate bar to tighten until snug in bed.

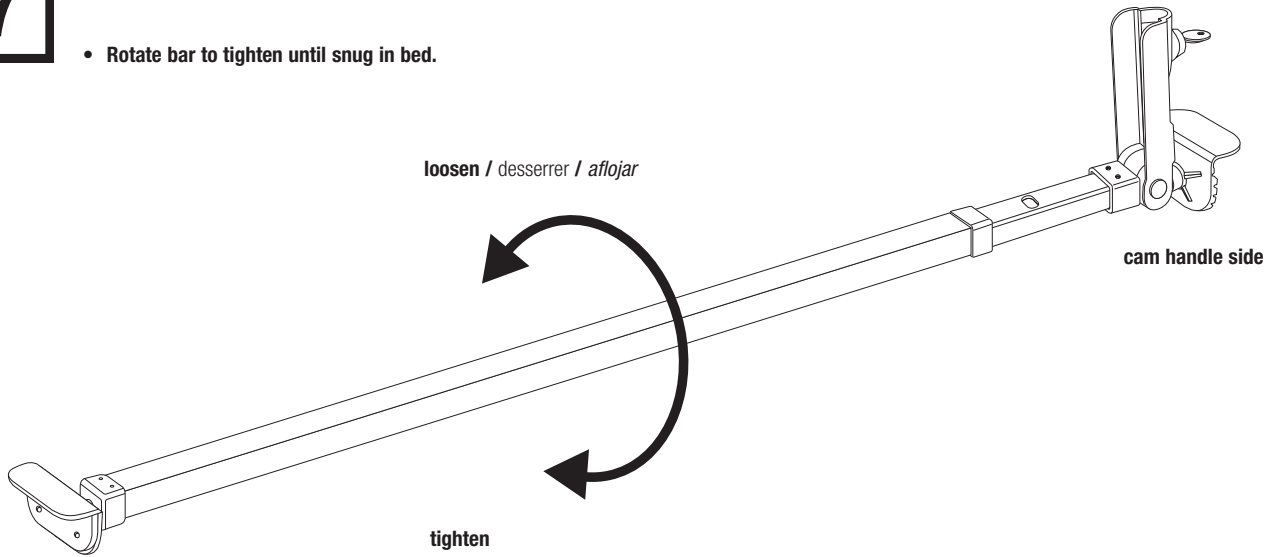

Over tightening can cause damage to truck bed. Do not over tighten before closing cam handle.



8

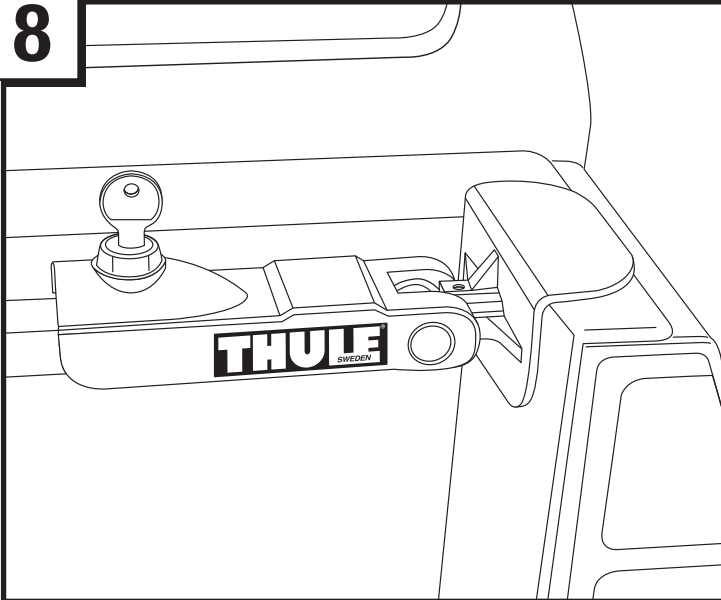

- Close cam handle.
- Test fit by pulling on bar to check security.
- If fit is too loose repeat steps 5 – 7.
- If fit is ok – lock this cam handle in position.

9

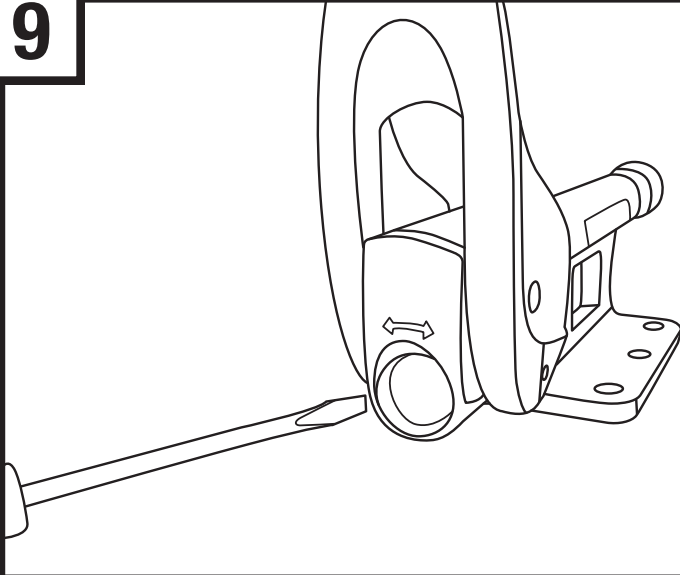

- To add lock cylinder to skewer, first remove black plug cap with a flat head screwdriver either by leveraging it from the front or by pushing it out from behind.

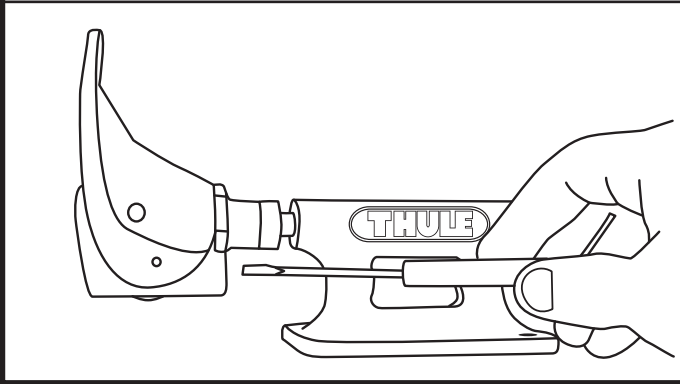

10

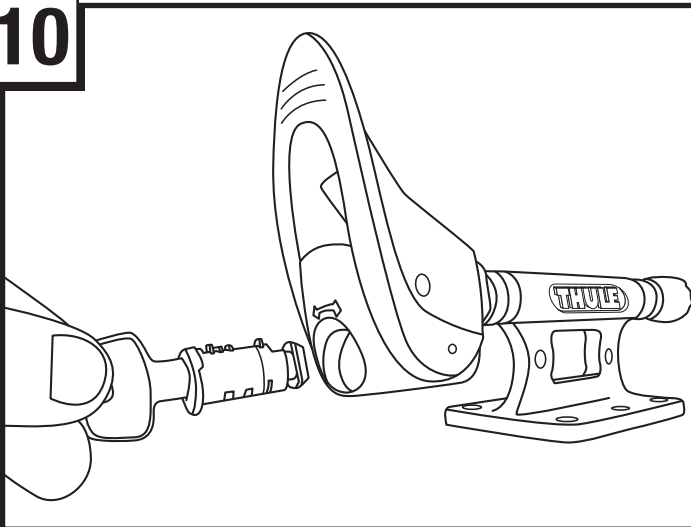

- To install lock cylinder, insert change key into lock cylinder and push cylinder into lock core slot on end of skewer. Remove change key. Use lock key to lock the cylinder.

11

BIKE INSTALLATION

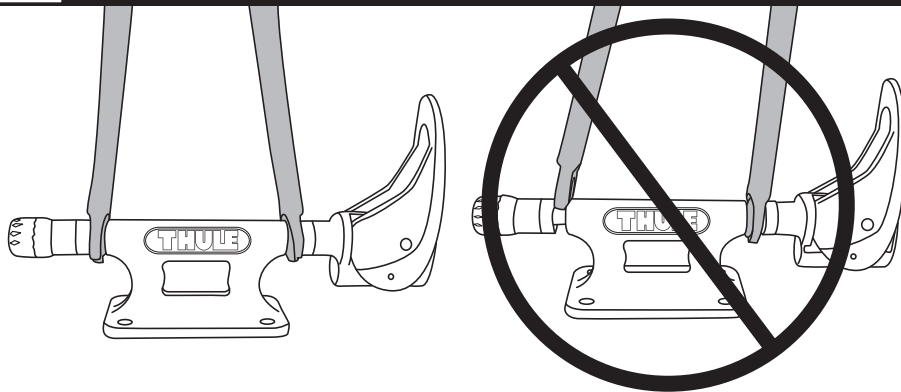

- Set the bicycle forks onto the skewer.

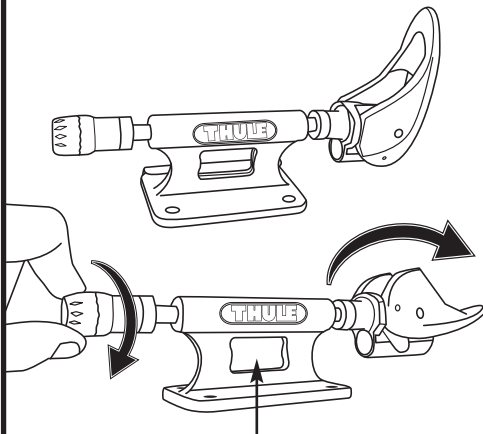

538(XT) Cable Lock access hole.

- With lever open, tighten nut until the lever closes with some resistance.
- Loosen or tighten the as needed so that lever closes with some resistance.
- For added security, use our 6-Foot Braided Steel Cable Lock (#538(XT), sold separately).

Test security by tugging at forks. If forks can move out of the skewer, open lever and tighten the nut slightly.
Close lever again with firm pressure Repeat if necessary

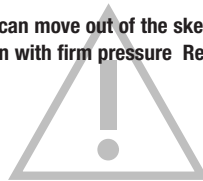

12

TO RELEASE FORKS

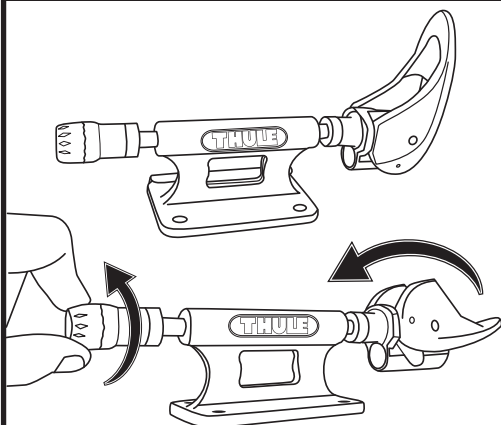

- Open lever and loosen nut.

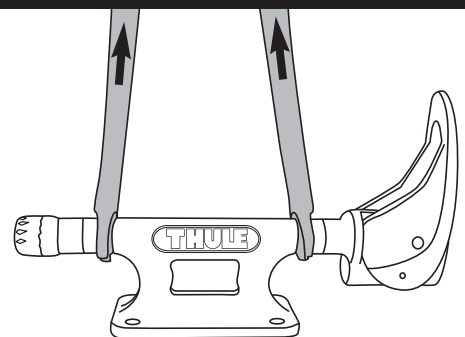

- Lift forks straight out.