

EN = North American English

EN PARTS INCLUDED

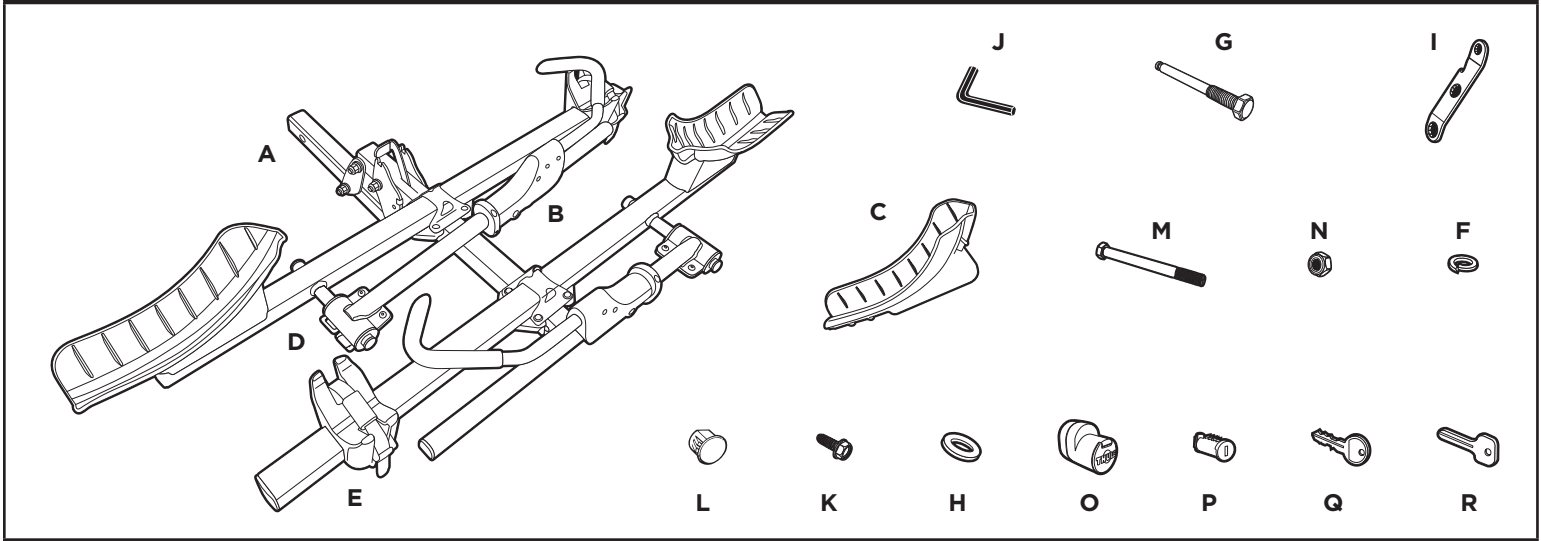

EN part	EN description	EN qty.
A	EN hitch and backbone assembly T2 2"	1
B	EN locking ratchet arm assembly	2
C	EN wheel tray molded T2	2
D	EN spar and pivot tube	2
E	EN rear wheel retention device	2
F	EN lockwasher 12mm id	1
G	EN STL2 hitch lock pin	1
H	EN washer 12mm id 24mm od	9
I	EN hitch tool	2
J	EN hex key M5	1
K	EN 5/16" x 1" slotted cutting bolt	4
L	EN lock plug	4
M	EN hex bolt 1/2 unc-13	4

EN PARTS INCLUDED (CONTINUED)

EN part	EN description	EN qty.
N	EN 1/2 - 13 lock nut	4
O	EN STL2 hitch lock	1
P	EN lock cylinder	1
Q	EN locking key	3
R	EN change key	1

EN

TOOLS REQUIRED:

- 2 - Thule Tools (included)
- 1 - 5mm Allen Wrench (included)
- 1 - Flat Head Screwdriver

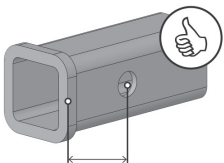

EN Minimum 1.5"

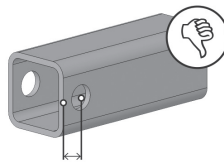

EN Not acceptable if distance is less than 1.5"

EN

- For both safety and performance, Thule requires the distance from the center of the hitch pin hole to the face of the receiver be at least 1.5 inches.

EN

WARNINGS / LIMITATIONS:

- Fits 20-29" wheels up to 5" wide tires.
- Carries up to 60lbs per tray with a 2" hitch and 160lbs total with a 2 bike add-on (4 bikes max.)
- Carries up to 60lbs per tray with a 1-1/4" hitch and 100lbs total (2 bikes max.)
- Carries bikes with wheelbases up to 48"
- Check tightness of all bolts and knobs periodically.
- Not intended for off-road use.
- Check straps for wear and replace if worn.
- Not intended for tandems or recumbents.
- Your vehicle must be equipped with a 2" or 1-1/4" receiver hitch.
- **DO NOT INSTALL** on a trailer or other towed vehicle.
- The maximum capacity for class 1 hitches is 2 bikes.
- **DO NOT USE** product with bike that has tire fenders. This prevents snug hook grip on tire.
- Load heaviest bike closest to vehicle and lightest bike last.
- Remove rack before entering an automatic car wash.
- Do not transport bicycles with attached baby seats, panniers, wheel covers or full bike covers.
- It is the user's responsibility to ensure compliance with all federal, state and local laws when using any Thule product.
- Drive slowly over speed bumps 5-10mph (8-16 kph) max.
- **WARNING:**
Set screw located on underside of the main backbone must remain installed. If screw is not in place there is the risk the bike tray can slide off the rack if not tightened properly. See step 4 for further clarification.

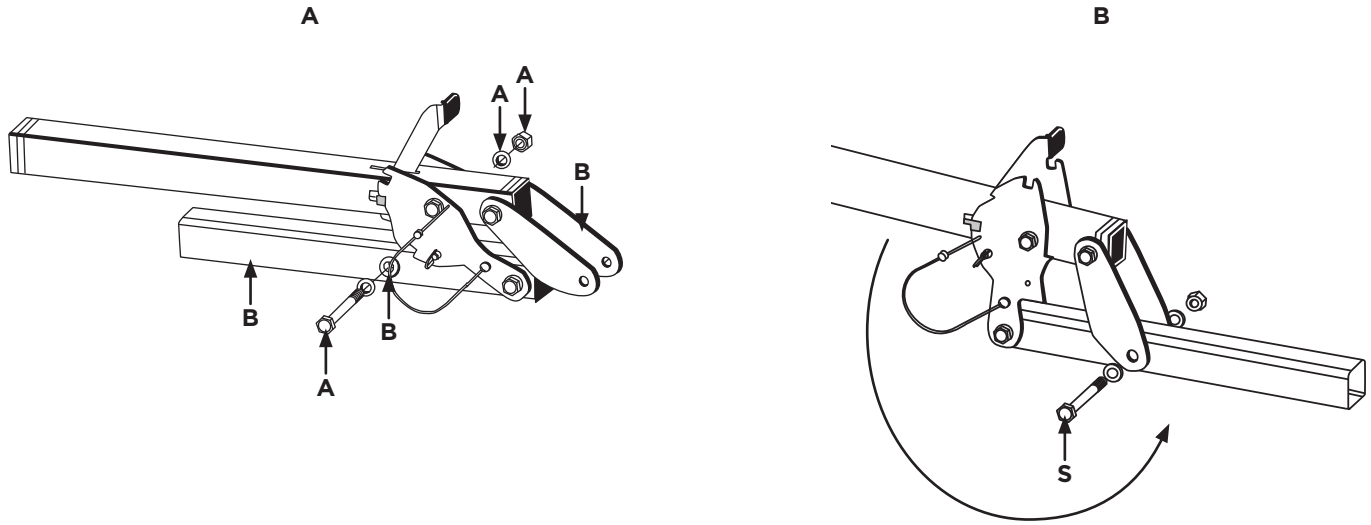
**EN**

- A. Remove the bolt, nut and washer from the rear linkage bars using the 2 Thule tools provided.
- B. Swing the hitch base 180 degrees and line up the bushings in the middle hole with the linkage bars.
- C. Replace the bolt, nut and washers and tighten firmly using Thule tools provided.

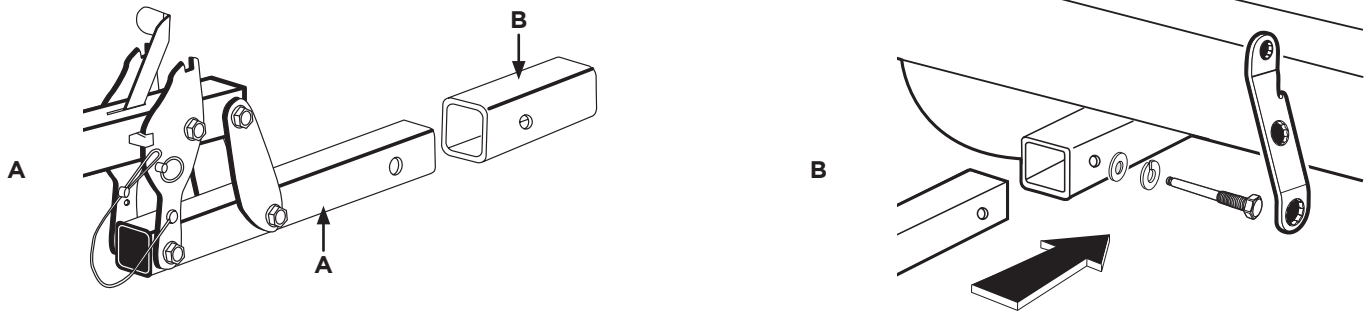
2**EN**

A. Insert hitch base (A) into vehicle's hitch receiver (B).

B. Insert STL2 receiver bolt, 12mm lock washer and 12mm flat washer as illustrated and tighten firmly using the Thule tools provided.

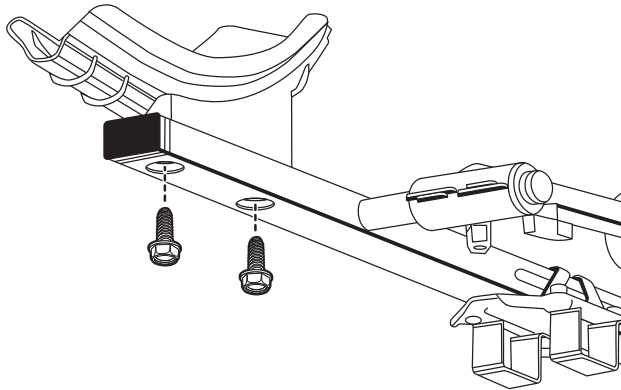
3**EN**

- Insert the wheel trays into the spar tube as illustrated. Tighten firmly using a 1/2 (one-half inch) socket wrench.

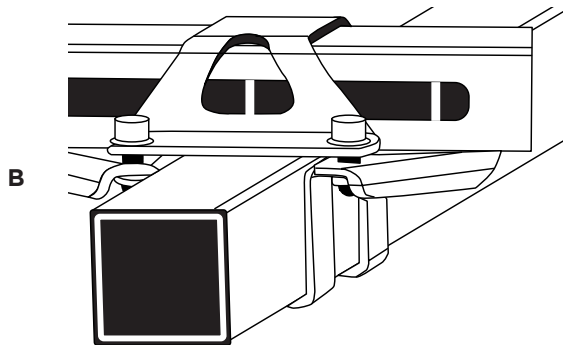
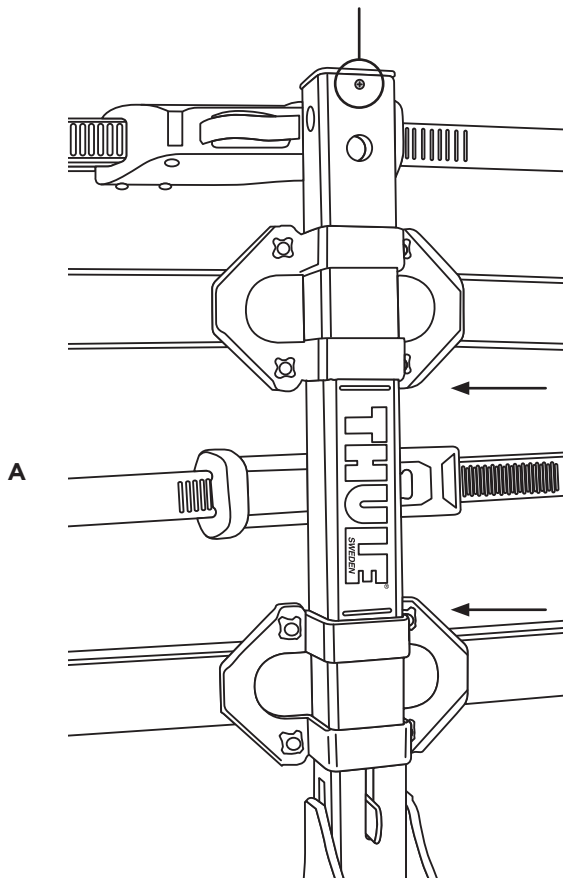
4**EN** safety set screw**EN**

- Loosen all 4 bracket bolts with 5mm hex wrench.
- Slide the first bike mount assembly oriented with the front wheel cradle on the driver's side of the vehicle onto the backbone of the rack.
- Position the tray so that the bracket lines up just beyond the E of the Thule logo (fig. A) and the centerline on the side of the spar tube shows through the cutout in the bracket (fig. B).
- Tighten all 4 bolts with the 5mm Allen wrench until the lower bracket wings touch the bottom of the spar tube. (fig. B) Fasteners must be tight and should be checked periodically with rack use.
- Repeat 1-4 with second bike mount assembly oriented with the wheel cradle on the passenger side. Line the bracket up just before the T of the Thule logo (fig. A) and center it with the center line mark (fig. B).

WARNING: Safety set screw must remain installed at all times. If you need to remove it to add the 2 bike extension, the screw must be reinstalled after it has been removed.

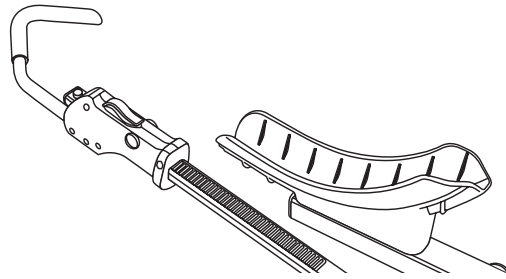
**EN**

- Rotate the support arm forward. While grabbing the grip assembly on the support arm, depress the gray trigger and slide the hook to the end of the support arm as illustrated.

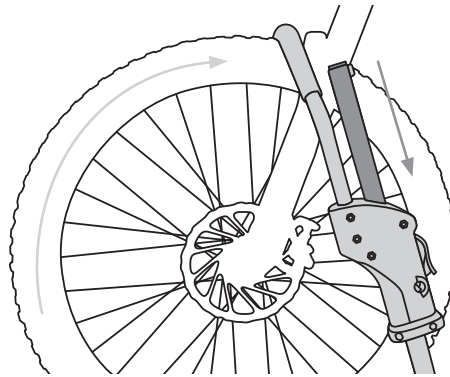
**EN**

- Place bike in first tray nearest to the vehicle with the front wheel in the wheel cradle and rear wheel in the rear wheel holder.
- While holding the bike with one hand, rotate the support arm up until it sits within 1" of the bicycle brake or fork crown.
- Ratchet the arm tightly against the wheel. You should hear a minimum of 2 clicks past initial contact with the tire.

WARNING:

The support arm V-notch must be firmly seated against the tire and brake or fork. Failure to do so may result in bike instability. Always shake your bike to ensure the hook is fully seated.

7

A

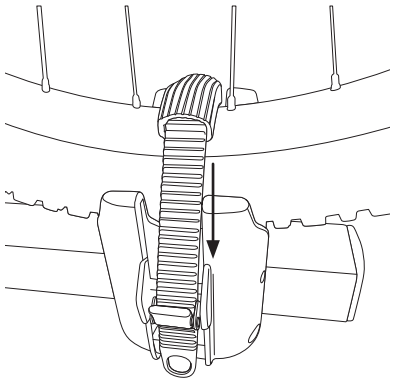

EN

- A. Secure rear wheel by inserting strap into buckle and pulling down firmly.
- B. For “fat bike” and “plus sized” tires, first remove the rear wheel strap as shown.
- C. Then re-route the strap as shown so that your length of usable strap is increased. No modifications need to be made to the front wheel holder to accommodate these wheel sizes.

B

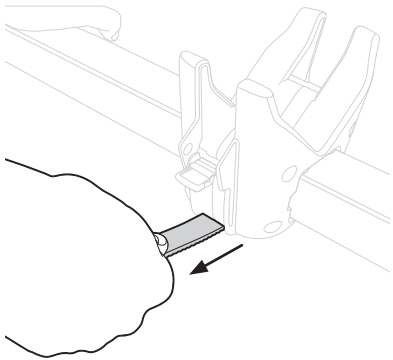

C

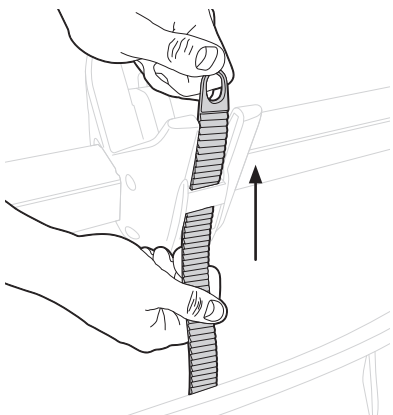

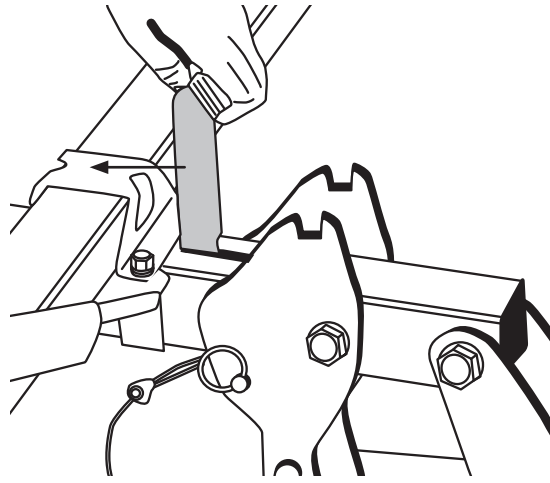
**EN**

- With bikes unloaded, pull release lever away from vehicle and lift rack toward vehicle (fig. A).
- Carrier will "click" into stowed position (fig. B).

WARNING: "Folding for Storage," may be hindered by spare tires and other rear of car features. Ensure that there is adequate clearance when installed on vehicle and carrier is in locked position before travel.

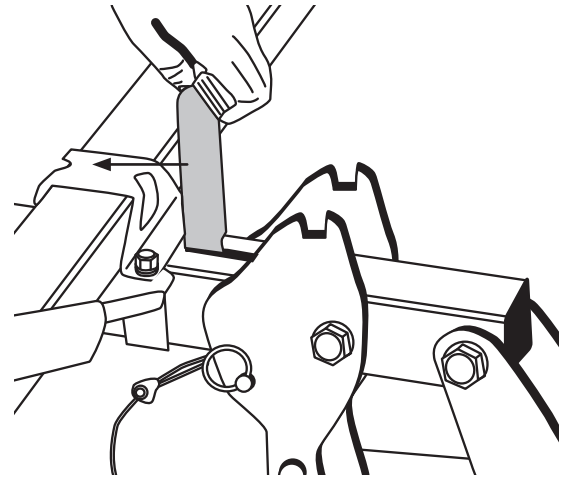
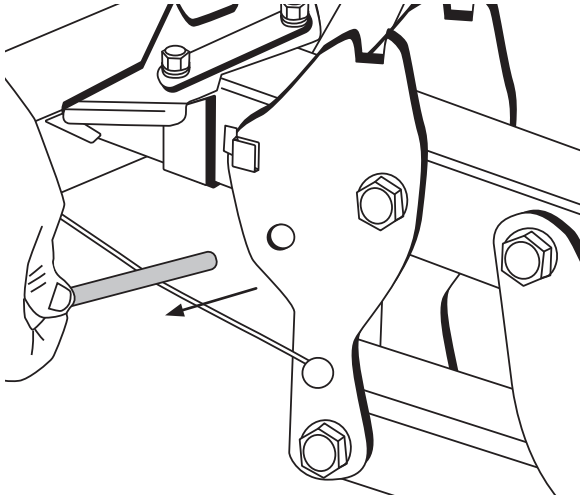
**EN**

- Pull safety pin from linkage bar as illustrated.
- Pull release lever away from vehicle and lower carrier to stop position. See step 8 (fig. A)

WARNING: Carrier will drop rapidly under weight of load. It is strongly recommended to support weight of carrier when lowering. Keep hands and other objects clear of linkage during operation of this feature.

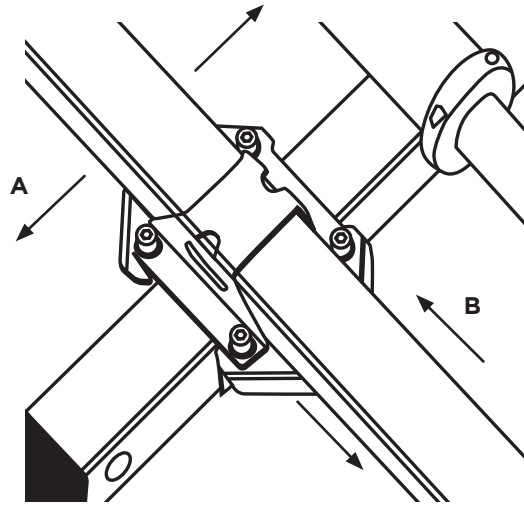
**EN**

- Adjusting rack to prevent bike interference with each other or with car.

A. Pitch - Distance Between Bikes - To adjust pitch, loosen all 4 bracket bolts and slide the tray in or out. Re-tighten bolts to secure tray.

B. Offset - Side to Side Distance - To adjust offset, loosen all 4 bracket bolts and slide tray left or right. Re-tighten bolts to secure tray.

NOTE: Do not slide the tray past offset limit marks on either side of the bracket or failure may occur.

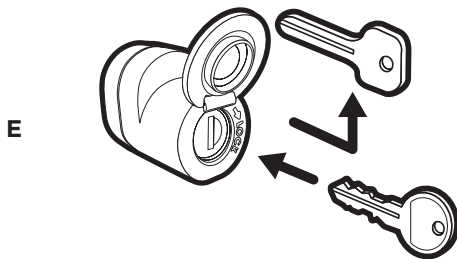
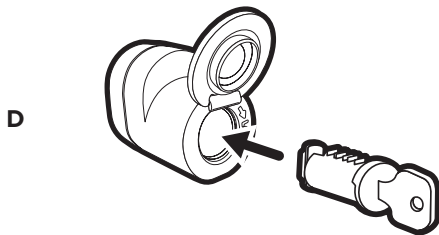
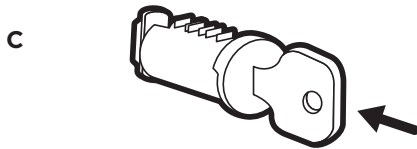
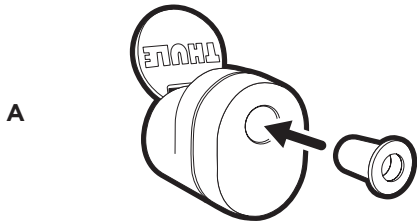
**EN**

- A. Remove and discard plug.
- B. Open cover.
- C. Insert change key into lock cylinder.
- D. Insert cylinder into STL2 lock housing.
- E. Remove change key. Insert locking key.

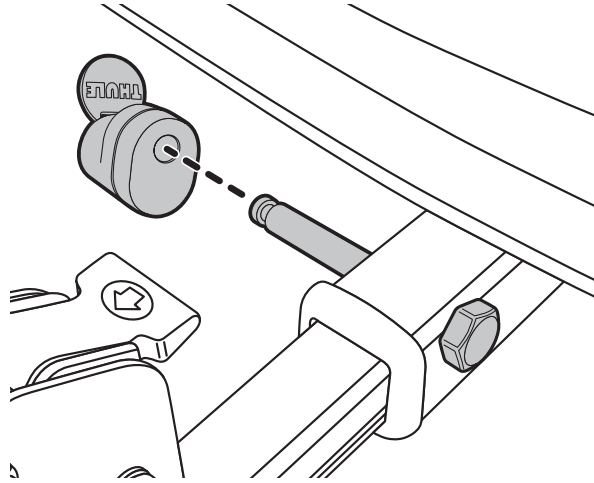
**EN**

- Slide STL2 onto hitch pin, keeping key vertical.
- Turn key clock wise to lock, remove key.
- Close cover.

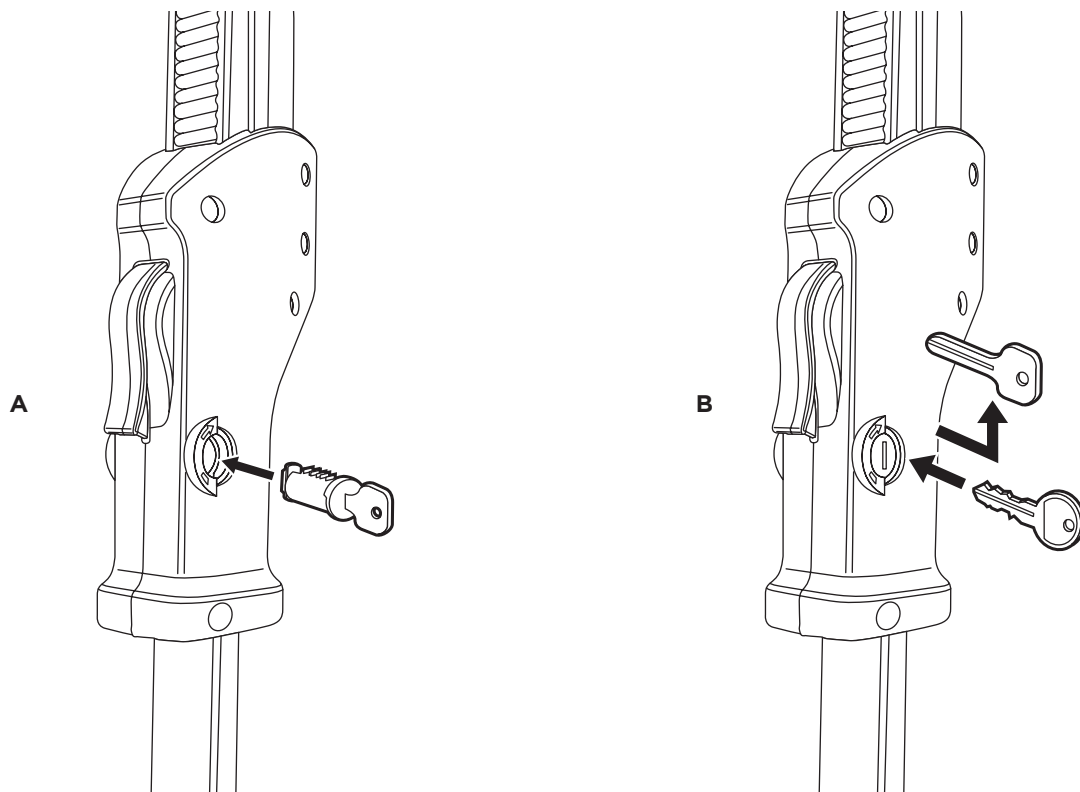
**EN**

A. Insert change key into lock cylinder. Insert lock cylinder into lock cylinder slot.

B. Remove change key, insert key to lock and unlock.

- Insert lock plug on opposite side of grip, into the lock cylinder.

WARNING: Ensure ratchet arm is fully engaged to bicycle wheel before locking.

THULE RACK GUIDELINES

When using Thule Load carriers and accessories, the user must understand the precautions. The points listed below will assist you in using the rack system and will encourage safety.

- For quality fits and safety, use only the recommended rack or accessory as stated in Thule's current Fit Guide. Do not assume a rack will fit, always check the current Fit Guide when obtaining a new vehicle.
- The maximum load specified in the assembly instructions is not to be exceeded. However, this limit is always subordinate to the maximum load recommended by the manufacturer of the car itself. It is always the lower maximum recommended load that applies. **Max roof load = load carrier weight + any fitted carrier accessories + the weight of the load itself.**
- Always make sure all doors are open when mounting a roof rack system. Make sure all knobs, bolts, screws, straps, and locks are firmly attached, tightened and locked before every trip. Knobs, bolts, screws, straps and locks must be periodically inspected for signs of wear, corrosion, and fatigue. Check your load at stops during the trip to ensure continued fastening security.
- Check local and state laws governing projection of objects beyond the perimeter of a vehicle. Be aware of the width and height of your cargo since low clearance branches, bridges, and parking garages can affect the load. All cargo will affect the vehicle's driving behavior. Never drive with any lock, knob or rack in an open or unlocked position. All long loads such as, but not limited to, sailboards, surfboards, kayaks, canoes, and lumber must be tied down front and rear to the bumpers or tow hooks of the vehicle.
- Remove your Thule rack and accessories when they are not in use and before entering automatic car washes.
- All locks must be turned and moved periodically to ensure smooth operation. Use graphite or dry lubricant to help this. Thule locks are designed to deter vandalism and theft but should not be considered theft proof. Remove valuable gear if your vehicle is unattended for an extended period. Place at least one key in the glove compartment.
- For safety to your vehicle and rack system, obey all posted speed limits and traffic cautions. Adapt your speed to the conditions of the road and the load being carried.
- Do not use Thule load carriers and accessories for purposes other than those for which they were designed. Do not exceed their carrying capacity. Failure to follow these guidelines or the product's instructions will void the warranty.
- All loads must be secured using the provided straps.
- Consult with your Thule dealer if you have any questions regarding the operations and limits of Thule products. Review all instructions and warranty information carefully.
- Not for use on trailers or towed vehicles.
- Not for offroad use.
- Keep bicycle tires away from hot exhaust.

THULE CAR RACK SYSTEMS LIMITED LIFETIME WARRANTY

THULE will warranty all THULE brand car rack systems and its accessories manufactured by THULE during the time that an original retail purchaser owns the product. This warranty terminates if a purchaser transfers the product to any other person.

Subject to the limitations and exclusions described in this warranty, THULE will remedy defects in materials or workmanship by repairing or replacing, at its option, a defective product without charge for parts or labor. In addition, THULE may elect, at its option, not to repair or replace a defective product but rather issue to a purchaser a refund equal to the purchase price paid for the product or a credit to be used toward the purchase of a new THULE load carrier system.

No warranty is given for defects caused by normal wear and tear, cosmetic rust, scratches, accidents, unlawful vehicle operation, or modification of, or any types of repair of, a load carrier system other than those authorized by THULE.

No warranty is given for defects resulting from conditions beyond THULE's control including, but not limited to, misuse, overloading, or failure to assemble, mount or use the product in accordance with THULE's written instructions or guidelines included with the product or made available to the purchaser.

In the event that a product is defective, the purchaser should contact the THULE dealer from whom the product was purchased or an Authorized Thule Service Center. If the dealer or Authorized Thule Service Center is not able to correct the defect, the purchaser should contact THULE in writing or by phone using the contact information listed at the bottom of this page.

In the event that a product needs to be returned to THULE, a THULE technician at the address or telephone number listed below will provide the purchaser with the appropriate mailing address and any additional instructions. Please note that the purchaser will be responsible for the cost of mailing the product to THULE and that proof of purchase in the form of an original purchase invoice or receipt and a detailed description of the defect must be included in the mailing.

DISCLAIMER OF LIABILITY
REPAIR OR REPLACEMENT OF A DEFECTIVE PRODUCT OR THE ISSUANCE OF A REFUND OR CREDIT (AS DETERMINED BY THULE) IS A PURCHASER'S EXCLUSIVE REMEDY UNDER THIS WARRANTY. DAMAGE TO A PURCHASER'S VEHICLE, CARGO AND/OR TO ANY OTHER PERSON OR PROPERTY IS EXCLUDED.

THIS WARRANTY IS EXPRESSLY MADE IN LIEU OF ANY AND ALL OTHER WARRANTIES, EXPRESS OR IMPLIED, INCLUDING THE WARRANTIES OF MERCHANTABILITY AND FITNESS FOR A PARTICULAR PURPOSE.

THULE'S SOLE LIABILITY TO ANY PURCHASER IS LIMITED TO THE REMEDY SET FORTH ABOVE. IN NO EVENT WILL THULE BE LIABLE FOR ANY LOST PROFITS, LOST SALES, OR FOR ANY CONSEQUENTIAL, DIRECT, INDIRECT, INCIDENTAL, SPECIAL, EXEMPLARY, OR PUNITIVE DAMAGES OR FOR ANY OTHER DAMAGES OF ANY KIND OR NATURE.

SOME STATES DO NOT ALLOW THE EXCLUSION OR LIMITATION OF INCIDENTAL OR CONSEQUENTIAL DAMAGES, SO THE ABOVE LIMITATIONS MAY NOT BE APPLICABLE.

THIS WARRANTY GIVES YOU SPECIFIC LEGAL RIGHTS, AND YOU MAY ALSO HAVE OTHER RIGHTS WHICH VARY FROM STATE TO STATE.