

# Kit 1510

**HONDA Pilot**, 5-dr SUV, \*06-08, 09–**HONDA**

**Ridgeline**, 4-dr Quad Cab, \*06-08, 09–

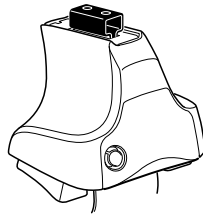

**754** Rapid System  
**480R** Rapid Traverse (North America)

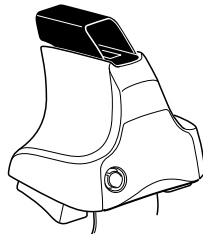
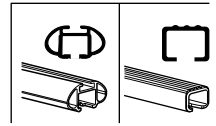

**480** Traverse (North America)

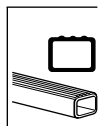

- 754 Rapid System: x1 (box), x4 (cubes), x4 (754 Rapid Traverse (North America) units), x4 (screws)
- 480R Rapid Traverse (North America): x1 (ruler), x4 (480R Rapid Traverse (North America) units), x4 (screws)
- 480 Traverse (North America): x1 (ruler), x4 (480 Traverse (North America) units), x4 (screws)

- Bar: x2
- Hardware: x2 (23 mm), x2 (23 mm), x4 (screws), x4 (nuts)
- Hardware: x1 (17 mm), x2 (23 mm), x2 (23 mm), x2 (nuts)
- Hardware: x2 (North America), x2 (North America)

- Foot: x4 (578)
- Foot: x4 (182)
- Diagram: x1 (R/R, L/R, F/L, B/L)

1

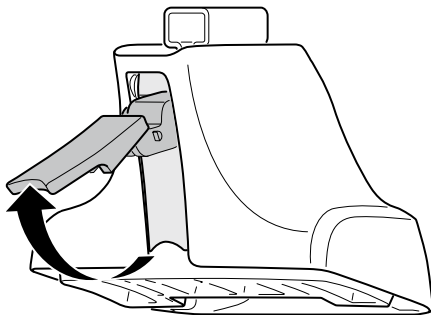

2



754 Rapid System  
480R Rapid Traverse  
(North America)

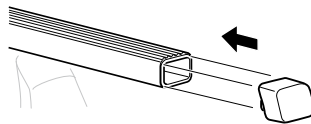
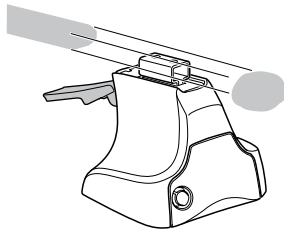

x4

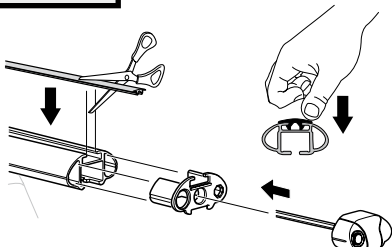
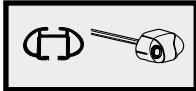

x4

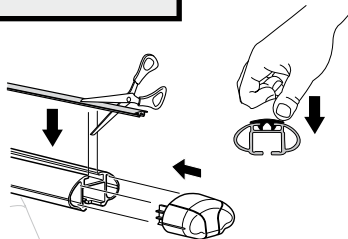
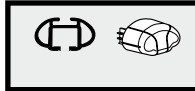

x4



480 Traverse  
(North America)

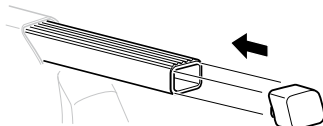
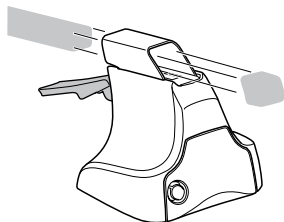

x4

**3**

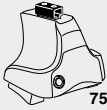

**754** Rapid System

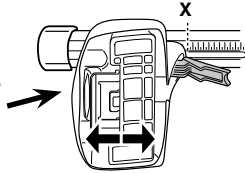

	<b>X</b>
<b>HONDA Pilot, 5-dr SUV, *06-08</b>	<b>56</b>
<b>HONDA Pilot, 5-dr SUV, *09–</b>	<b>58,5</b>
<b>HONDA Ridgeline, 4-dr Quad Cab, *06-08</b>	<b>56</b>
<b>HONDA Ridgeline, 4-dr Quad Cab, *09–</b>	<b>58,5</b>

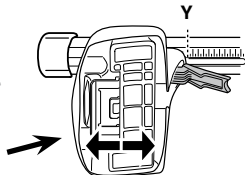

	<b>Y</b>
<b>HONDA Pilot, 5-dr SUV, *06-08</b>	<b>53,5</b>
<b>HONDA Pilot, 5-dr SUV, *09–</b>	<b>59,5</b>
<b>HONDA Ridgeline, 4-dr Quad Cab, *06-08</b>	<b>53,5</b>
<b>HONDA Ridgeline, 4-dr Quad Cab, *09–</b>	<b>59,5</b>

**3**



**480R** Rapid Traverse



**480** Traverse



**(North America)**

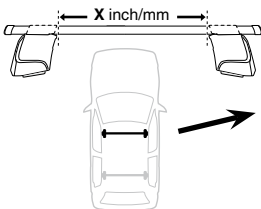

	<b>X inch</b>	<b>X mm</b>
<b>HONDA Pilot, 5-dr SUV, *06-08</b>	<b>47 1/2"</b>	<b>1211 mm</b>
<b>HONDA Pilot, 5-dr SUV, *09–</b>	<b>48 3/4"</b>	<b>1237 mm</b>
<b>HONDA Ridgeline, 4-dr Quad Cab, *06-08</b>	<b>47 1/2"</b>	<b>1211 mm</b>
<b>HONDA Ridgeline, 4-dr Quad Cab, *09–</b>	<b>48 3/4"</b>	<b>1237 mm</b>

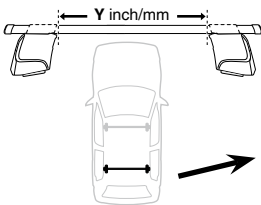

	<b>Y inch</b>	<b>Y mm</b>
<b>HONDA Pilot, 5-dr SUV, *06-08</b>	<b>46 3/4"</b>	<b>1186 mm</b>
<b>HONDA Pilot, 5-dr SUV, *09–</b>	<b>49 1/8"</b>	<b>1247 mm</b>
<b>HONDA Ridgeline, 4-dr Quad Cab, *06-08</b>	<b>46 3/4"</b>	<b>1186 mm</b>
<b>HONDA Ridgeline, 4-dr Quad Cab, *09–</b>	<b>49 1/8"</b>	<b>1247 mm</b>

**4**

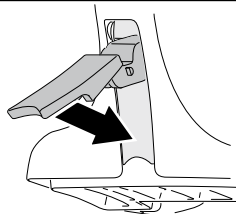

5

HONDA Pilot, 5-dr SUV, \*06-08, 09-

HONDA Ridgeline, 4-dr Quad Cab, \*06-08, 09-

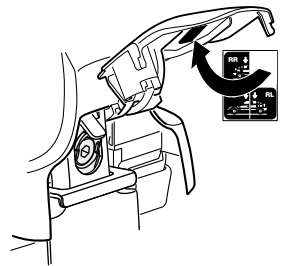
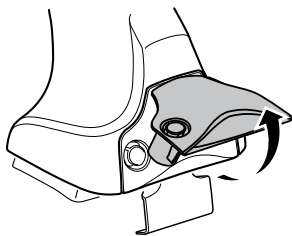
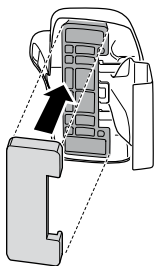
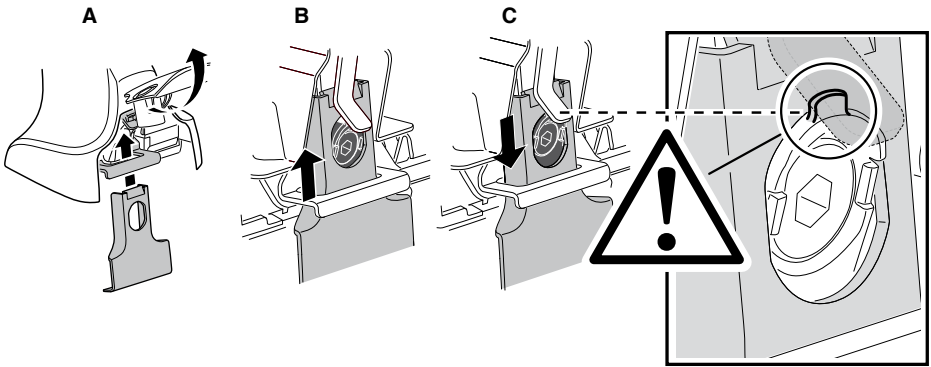
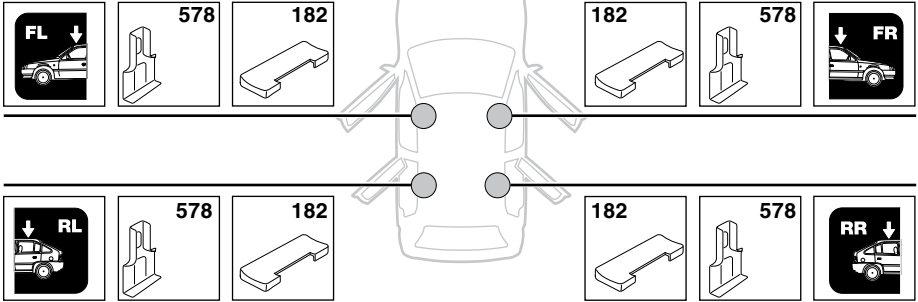

6

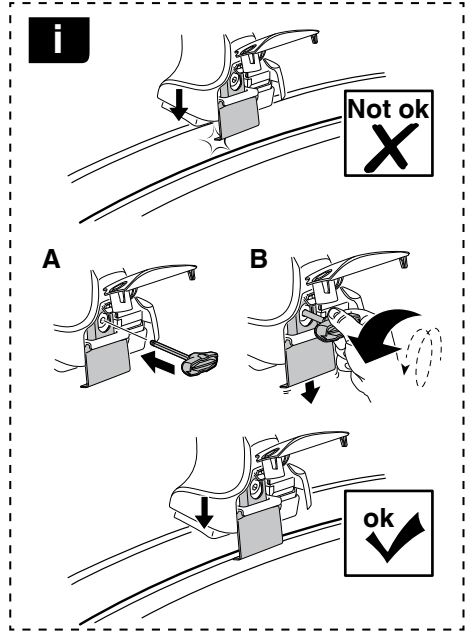
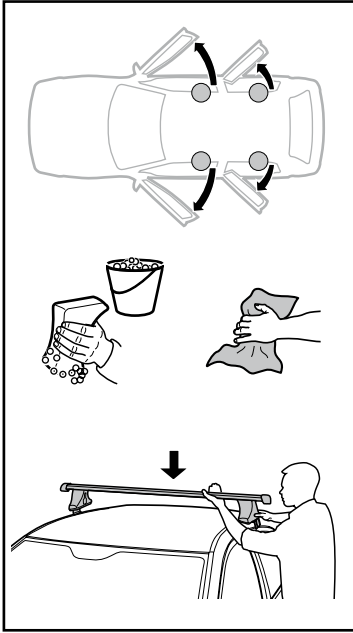

	X mm	Y mm	X inch	Y inch
HONDA Pilot, 5-dr SUV, *06-08, 09-	260 mm	750 mm	10 1/4"	29 1/2"
HONDA Ridgeline, 4-dr Quad Cab, *06-08, 09-	260 mm	750 mm	10 1/4"	29 1/2"

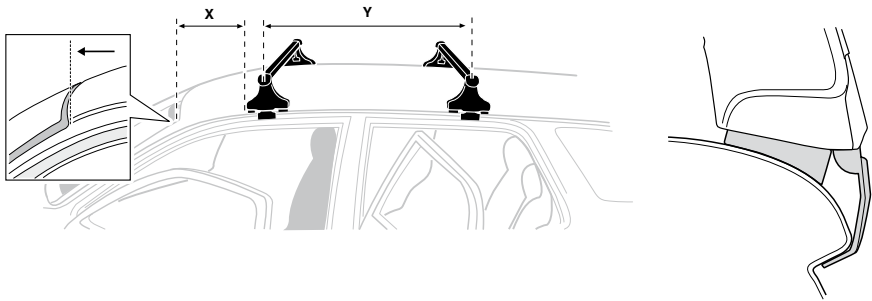

7

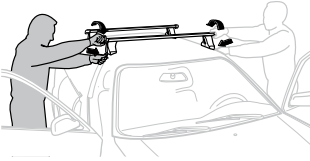

**GB/US** Tighten alternately  
**D** Die Schrauben abwechselnd anziehen  
**F** Serrer alternativement chaque côté  
**NL** Afwisselend aan de linker- en de rechterkant aandraaien  
**I** Alternare il serraggio delle viti  
**E** Apertar alternativamente  
**PT** Aperte alternadamente  
**S** Dra åt växelvis  
**FIN** Kierrä vuorotellen  
**EST** Pinguldage vaheldumisi  
**LAT** Pievelciēt pamišus  
**LIT** Užsukinėkite pakaitomis  
**PL** Śruby dokręcaj naprzemiennie  
**RU** Затягивайте попеременно

**CZ** Pokrétla bagażnika dokręcaj dokręcaj naprzemiennie.  
**SK** Doťahujte striedavo  
**SLO** Privijajte izmenično.  
**HR** Naizmjenično zategnite  
**HU** Egymástól függetlenül szorítandó  
**GR** Σφιγγετε εναλλάξ  
**TR** Dönüşümlü sıkın

**中文** 交替拧紧

**한국어** 번갈아 가며 조이십시오.

**日本語** 交互に締め付けてください。

**ไทย** ช้อนในแบบสลับ

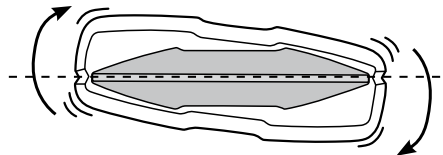
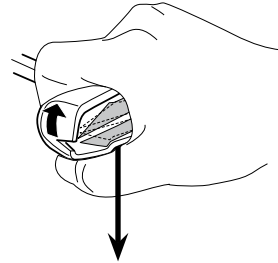
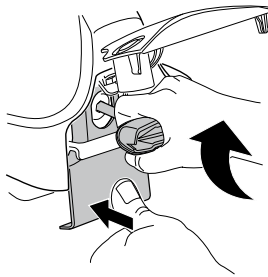
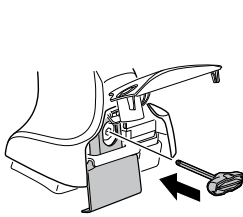

≈ 3 Nm

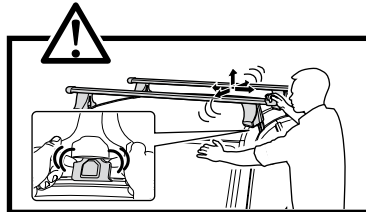
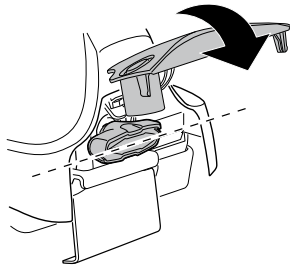

8



x1  
17 mm

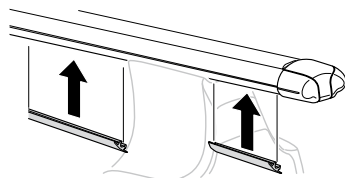

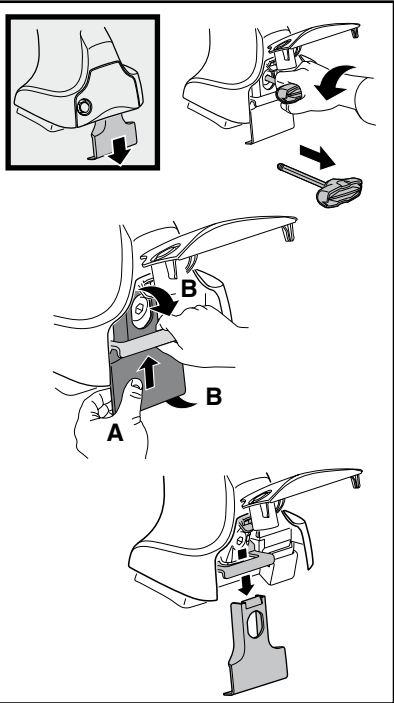
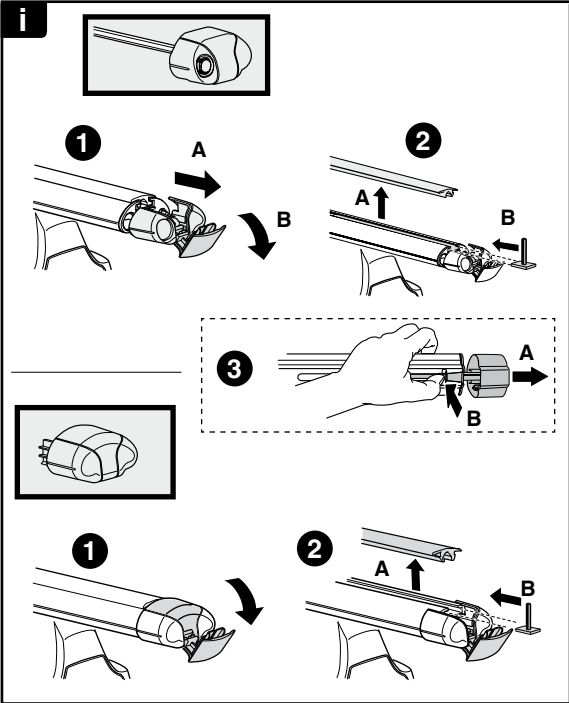
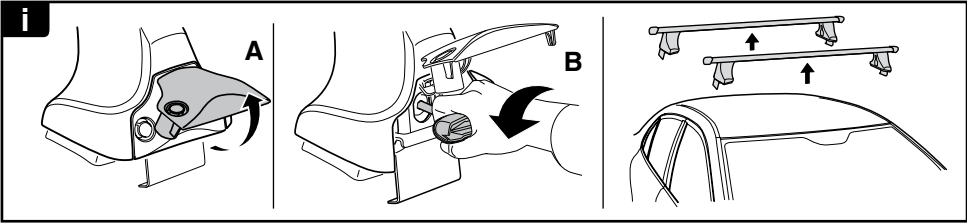

**THULE**  
SWEDEN  
**ONE  
KEY  
SYSTEM**

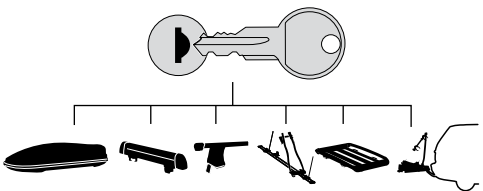

- 544 (x4)
- 596 (x6)
- 588 (x8)
- NA 510 (x10)
- EUR 452 (x12)
- ASIA

