

Kit 1482

SCION xB, 5-dr Hatchback, *08–
TOYOTA Corolla Rumion, 5-dr Hatchback, 07–

480R
754

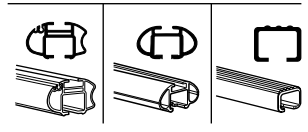
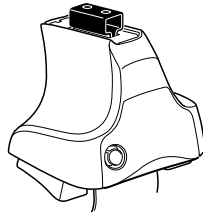

480

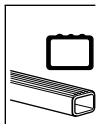
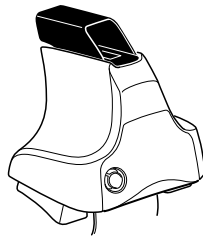

750

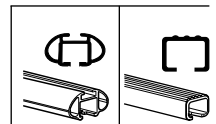
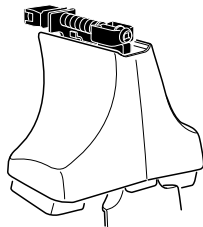

Max. 60 kg
Max. 132 lbs

+

x1

x4

x4

x4

x4

x1

x4

x4

x4

x1

x4

x4

x2 x2 x2 x4	x2	x2 x2 x4 x4	x2 x2	x2

← **964** x 2

← **965** x 2

← **146** x 4

x 1

Kit

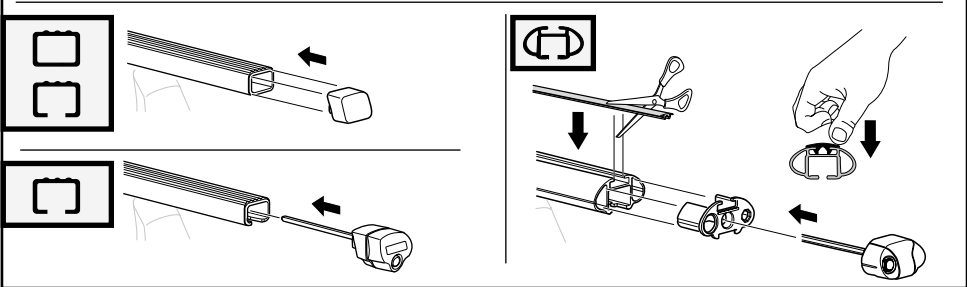
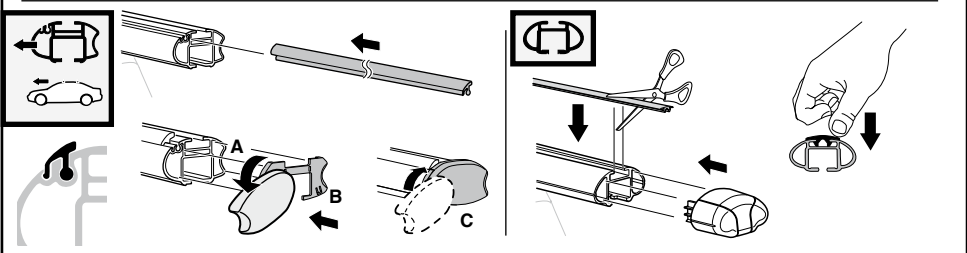
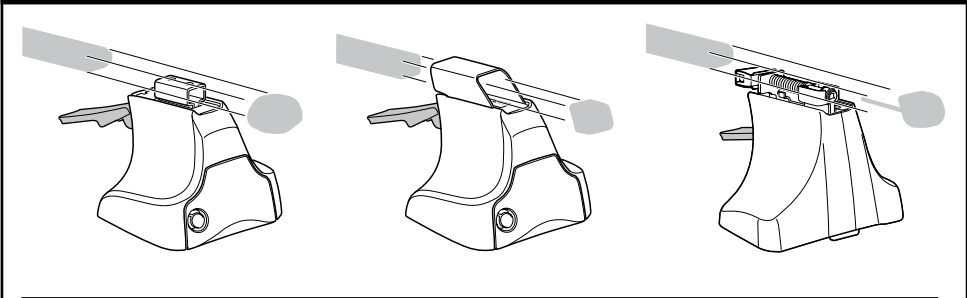
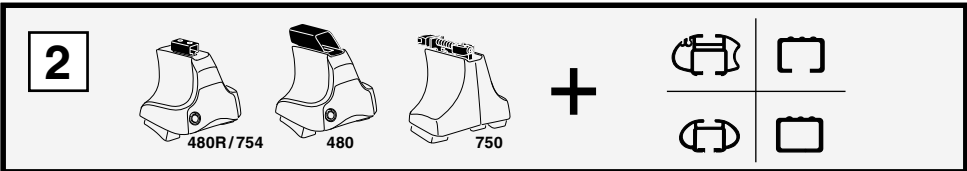
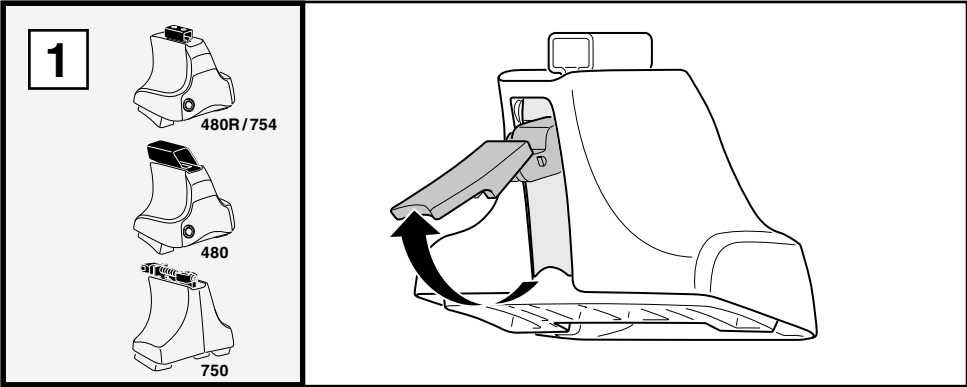

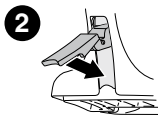
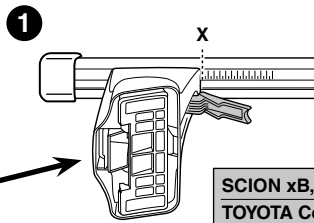
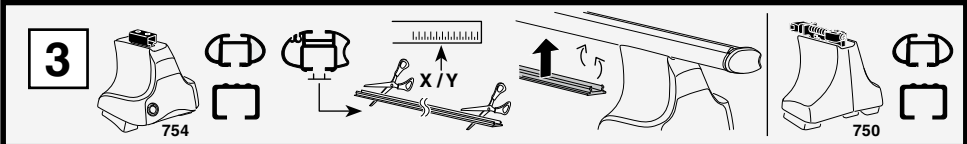

	X
SCION xB, 5-dr Hatchback, *08-	50
TOYOTA Corolla Rumion, 5-dr Hatchback, 07-	50

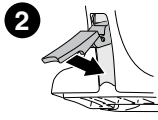
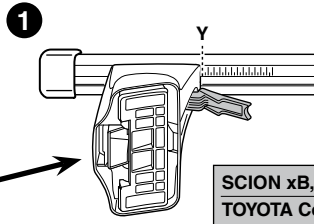

	Y
SCION xB, 5-dr Hatchback, *08-	46,5
TOYOTA Corolla Rumion, 5-dr Hatchback, 07-	46,5

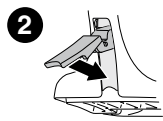
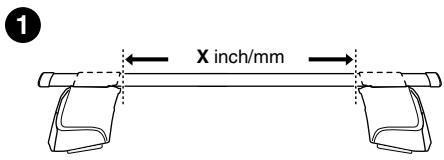
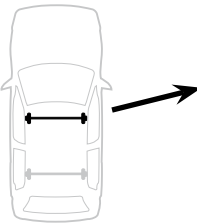
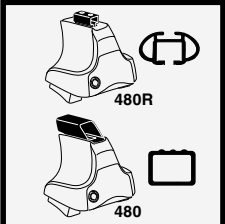

	X inch	X mm
SCION xB, 5-dr Hatchback, *08-	45 ³ / ₈ "	1151 mm
TOYOTA Corolla Rumion, 5-dr Hatchback, 07-	45 ³ / ₈ "	1151 mm

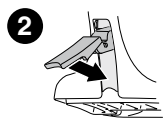
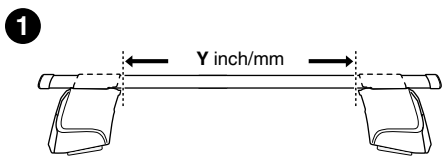
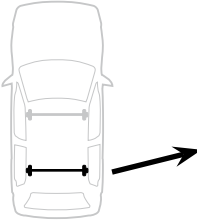

	Y inch	Y mm
SCION xB, 5-dr Hatchback, *08-	43 ⁷ / ₈ "	1116 mm
TOYOTA Corolla Rumion, 5-dr Hatchback, 07-	43 ⁷ / ₈ "	1116 mm

4

SCION xB, 5-dr Hatchback, *08-
TOYOTA Corolla Rumion, 5-dr Hatchback, 07-

146



965



146



965



146



964



146



964

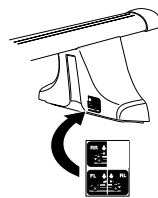
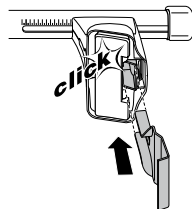
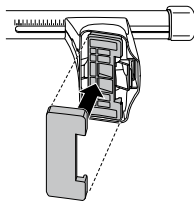
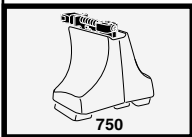
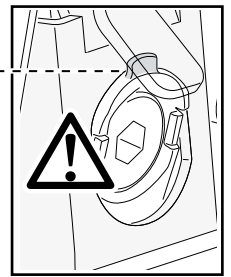
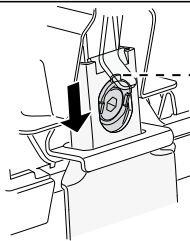
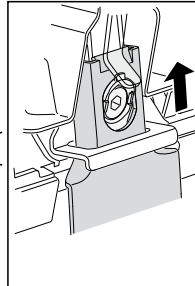
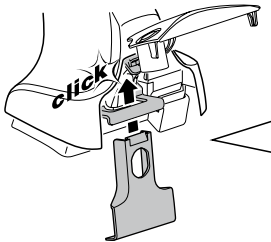
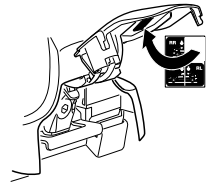
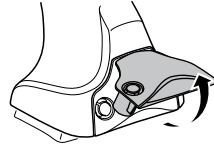
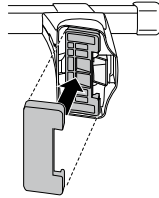
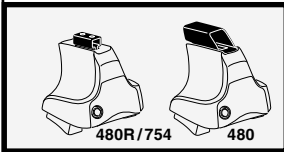

5

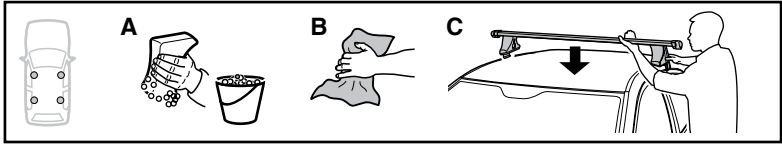

	X mm	Y mm	X inch	Y inch
SCION xB, 5-dr Hatchback, *08-	530 mm	700 mm	20 ⁷ / ₈ "	27 ¹ / ₂ "
TOYOTA Corolla Rumion, 5-dr Hatchback, 07-	530 mm	700 mm	20 ⁷ / ₈ "	27 ¹ / ₂ "

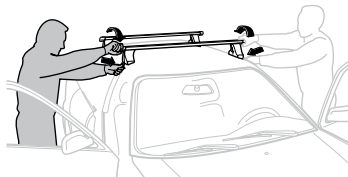
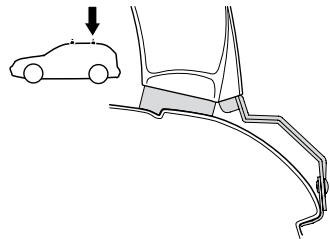
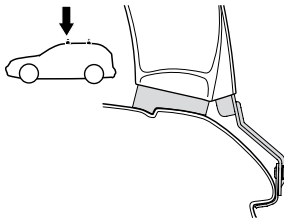
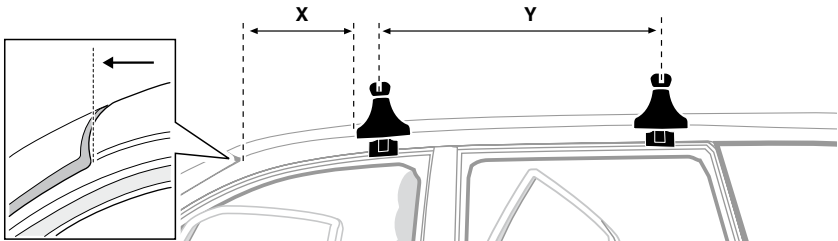

GB/US Tighten alternately

D Die Schrauben abwechselnd anziehen

F Serrer alternativement chaque côté

NL Afwisselend aan de linker- en de rechterkant aandraaien

I Alternare il serraggio delle viti

E Serrare alternativamente

PT Aperte alternadamente

S Dra åt växelvis

FIN Kierrä vuorotellen

EST Pinguldage vaheldumisi

LAT Pielieciet pamišus

LIT Užsukinėkite pakaitomis

PL Śruby dokręcaj naprzemiennie

RU Затягивайте попеременно

CZ Pokręťta багаžníka dokręcaj dokręcaj naprzemiennie.

SK Doťahujte striedavo

SLO Privijajte izmenično.

HR Naizmjenično zategnite

HU Egymástól függetlenül szorítandó

GR Σφιγγετε εναλλάξ

TR Dönüşümlü sıkın

中文 交替拧紧

한국어 번갈아 가며 조이십시오.

日本語 交互に締め付けてください。

ไทย ชั้นโนแบบสลับ

6

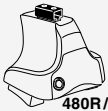

480R/754



480

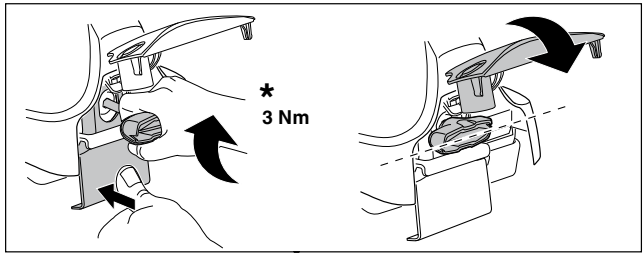
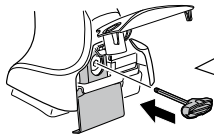

*
3 Nm

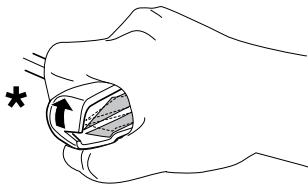

*

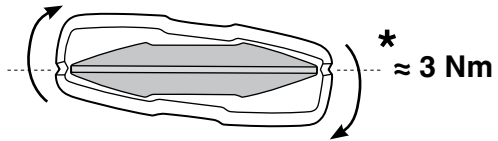

*
≈ 3 Nm

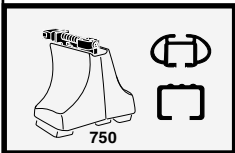
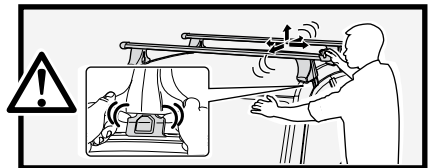

750

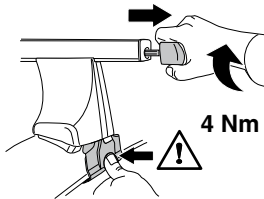

4 Nm

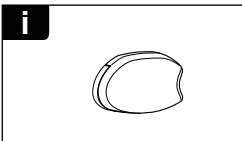
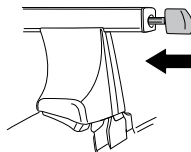

i

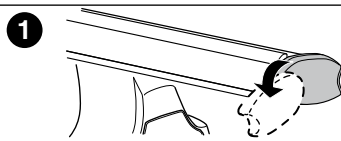

1

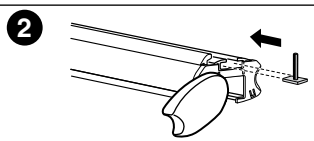

2

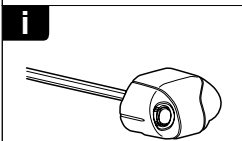

i

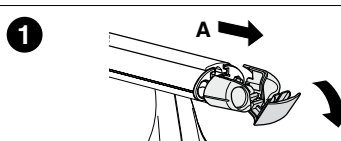

1

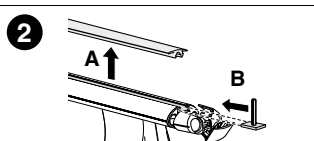

2

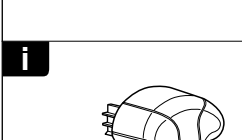

i

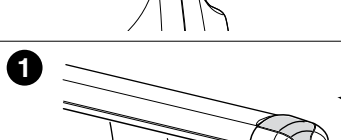

1

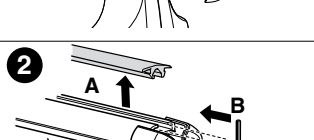

2

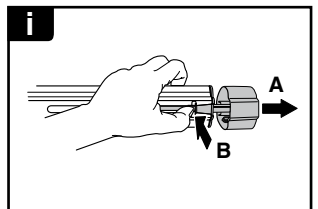
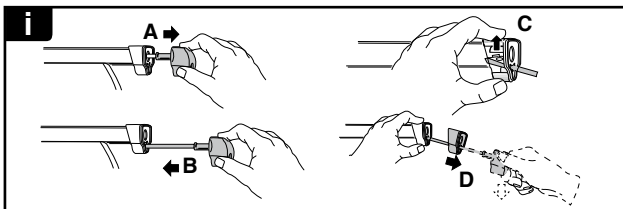
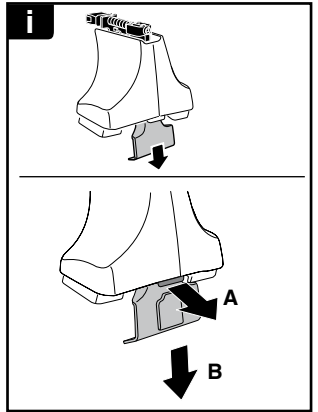
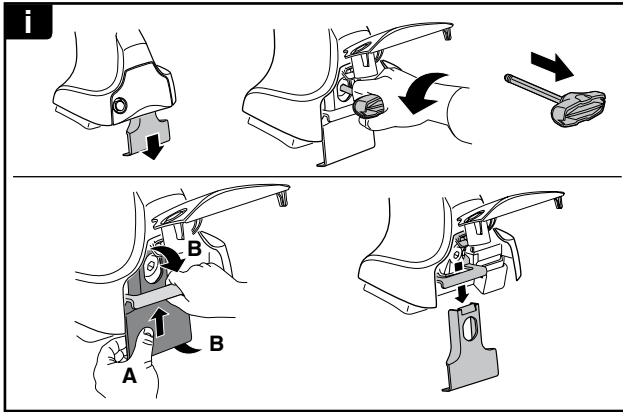
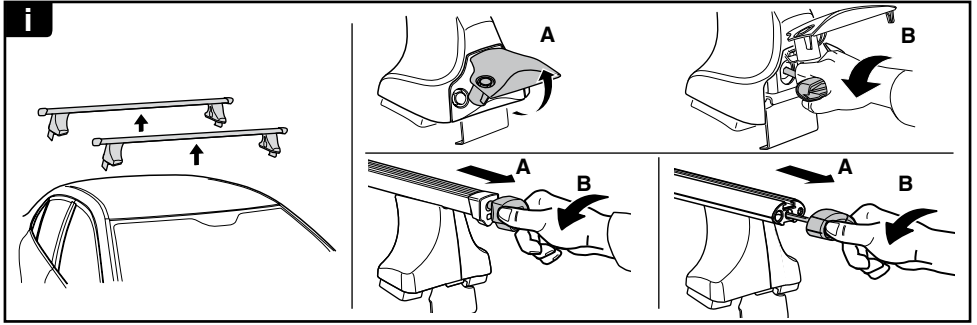

THULE
SWEDEN
**ONE
KEY
SYSTEM**

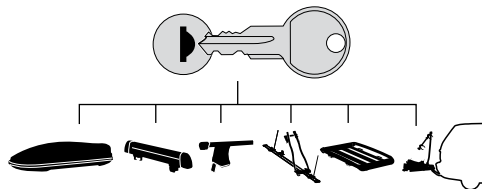

- 544 (x4)
- 596 (x6)
- 588 (x8)
- NA 510 (x10)
- EUR 452 (x12)
- ASIA

