

Kit 1193

VOLVO V70, 5-dr Estate, 00-03
VOLVO V70, 5-dr Wagon, *01-04

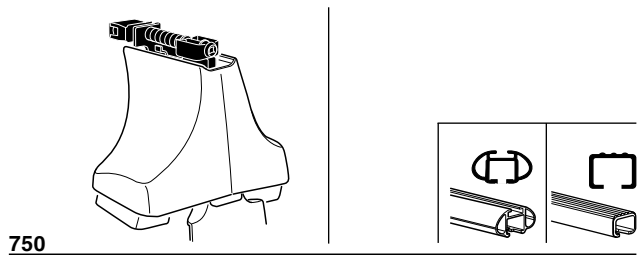
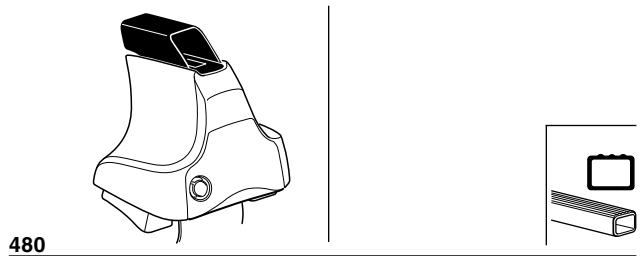
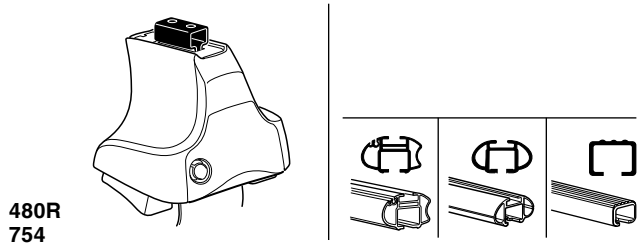

x2 x2 x2 x4	x2	x2 x2 x4 x4	x2 x2	x2	x2

Kit

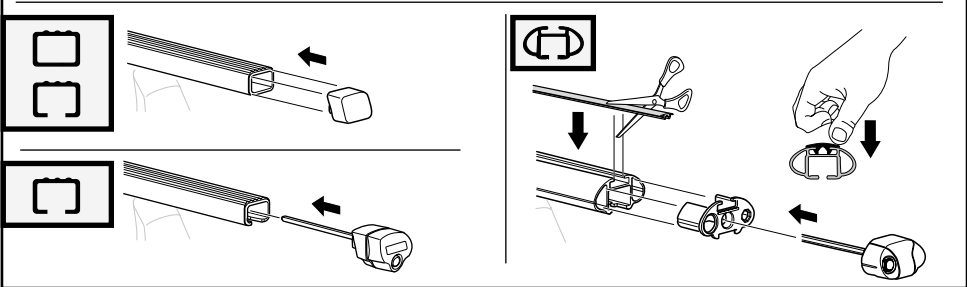
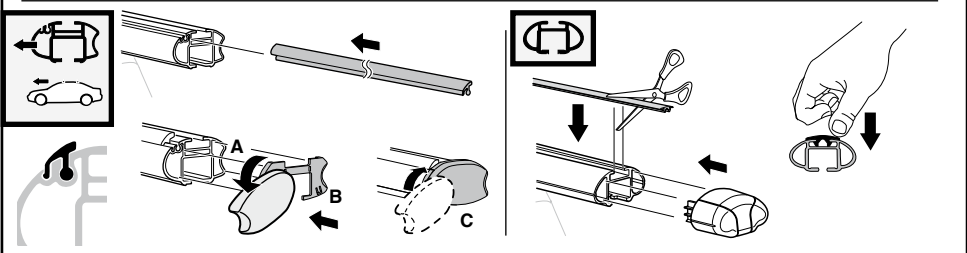
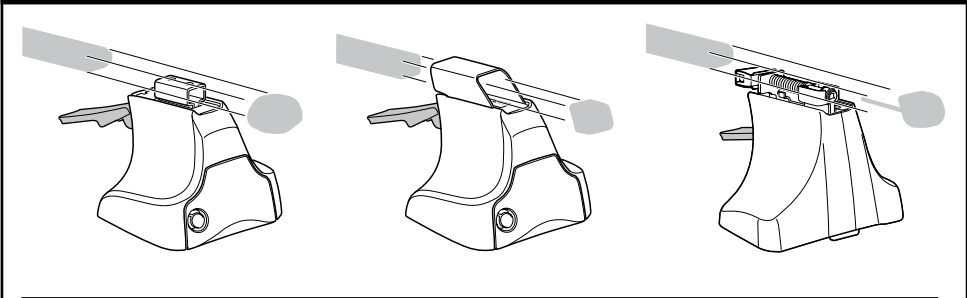
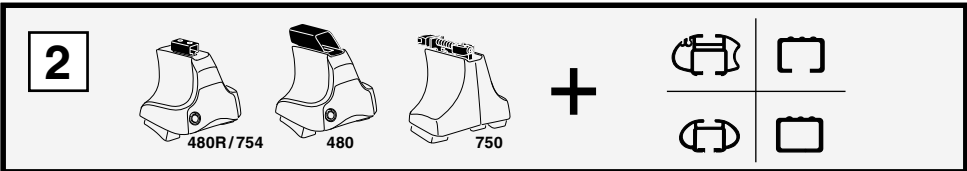
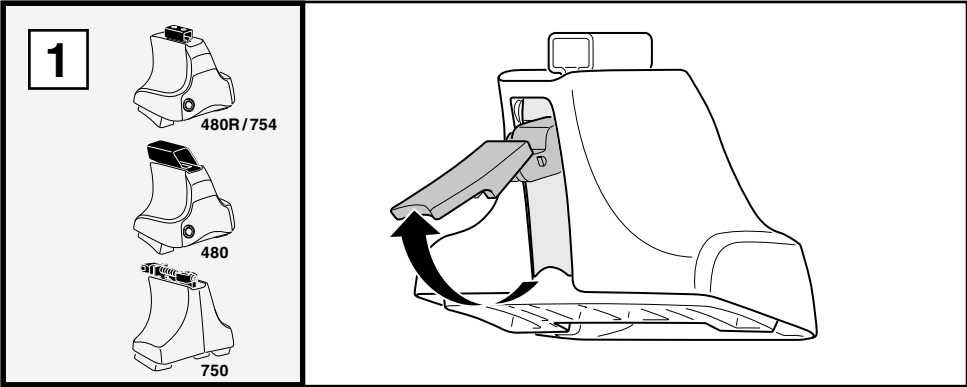

3

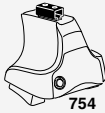

754

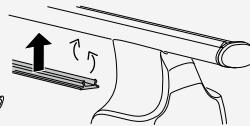
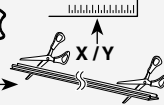

750



1

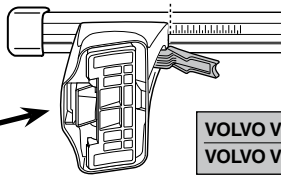
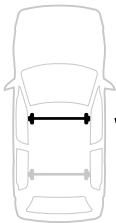

2

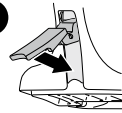

	X
VOLVO V70, 5-dr Estate, 00-03	36
VOLVO V70, 5-dr Wagon, *01-04	36

1

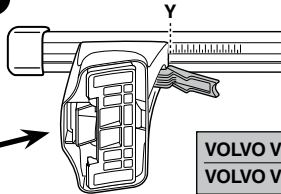

2

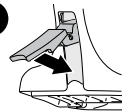

	Y
VOLVO V70, 5-dr Estate, 00-03	35
VOLVO V70, 5-dr Wagon, *01-04	35



480R



480

1

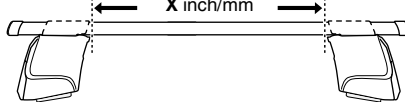
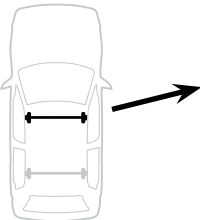

2

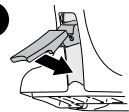

	X inch	X mm
VOLVO V70, 5-dr Estate, 00-03	39 3/4"	1011 mm
VOLVO V70, 5-dr Wagon, *01-04	39 3/4"	1011 mm

1

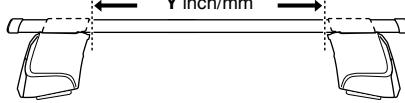
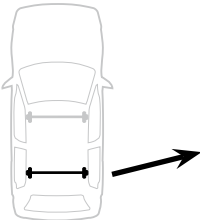

2

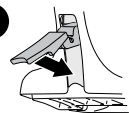

	Y inch	Y mm
VOLVO V70, 5-dr Estate, 00-03	39 3/8"	1001 mm
VOLVO V70, 5-dr Wagon, *01-04	39 3/8"	1001 mm

4

VOLVO V70, 5-dr Estate, 00-03

VOLVO V70, 5-dr Wagon, *01-04

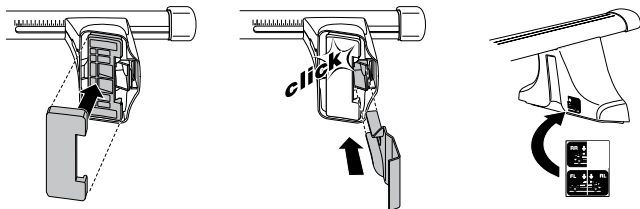
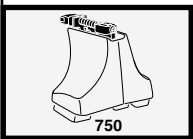
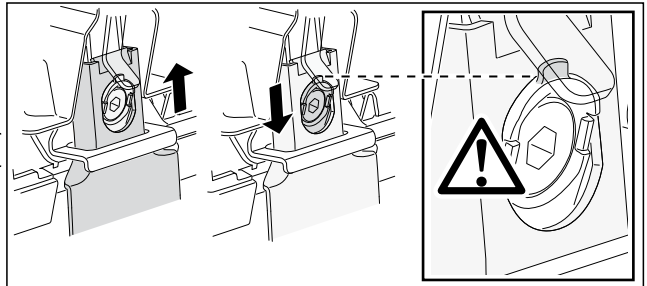
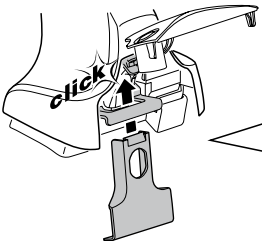
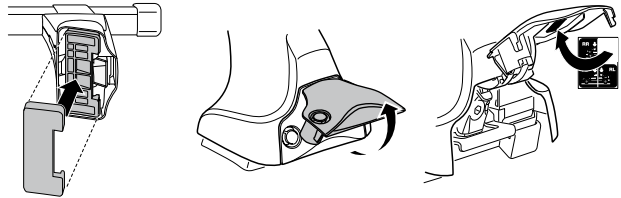
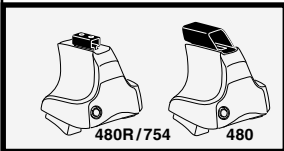
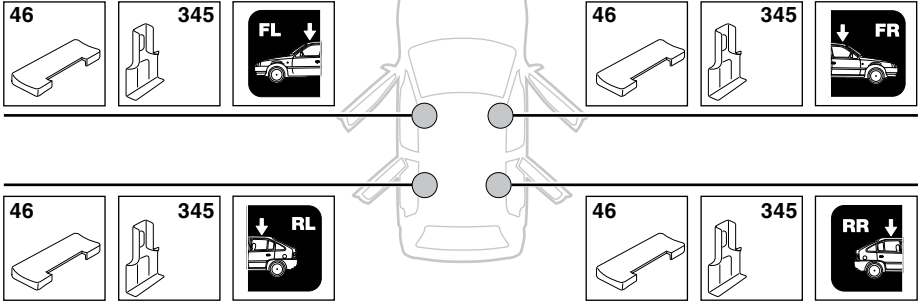

5

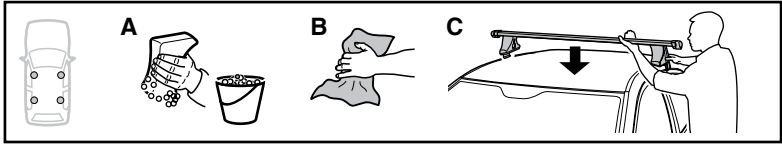

	X mm	Y mm	X inch	Y inch
VOLVO V70, 5-dr Estate, 00-03	460 mm	700 mm	18 1/8"	27 1/2"
VOLVO V70, 5-dr Wagon, *01-04	460 mm	700 mm	18 1/8"	27 1/2"

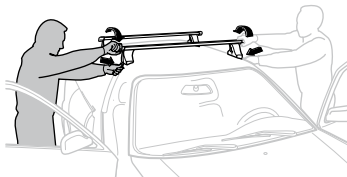
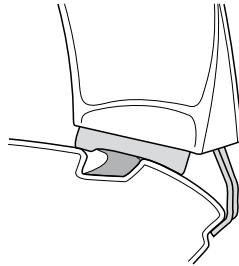
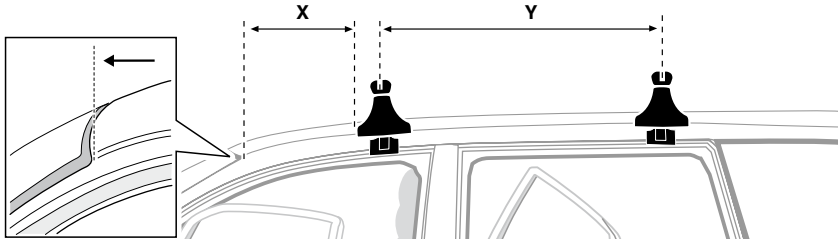

GB/US Tighten alternately

D Die Schrauben abwechselnd anziehen

F Serrer alternativement chaque côté

NL Afwisselend aan de linker- en de rechterkant aandraaien

I Alternare il serraggio delle viti

E Serrare alternativamente

PT Aperte alternadamente

S Dra åt växelvis

FIN Kierrä vuorotellen

EST Pinguldage vaheldumisi

LAT Pielieciet pamišus

LIT Užsukinėkite pakaitomis

PL Śruby dokręcaj naprzemiennie

RU Затягивайте попеременно

CZ Pokręťta багаžníka dokręcaj dokręcaj naprzemiennie.

SK Doťahujte striedavo

SLO Privijajte izmenično.

HR Naizmjenično zategnite

HU Egymástól függetlenül szorítandó

GR Σφιγγετε εναλλάξ

TR Dönüşümlü sıkın

中文 交替拧紧

한국어 번갈아 가며 조이십시오.

日本語 交互に締め付けてください。

ไทย ชั้นโนแบบสลับ

6



480R/754





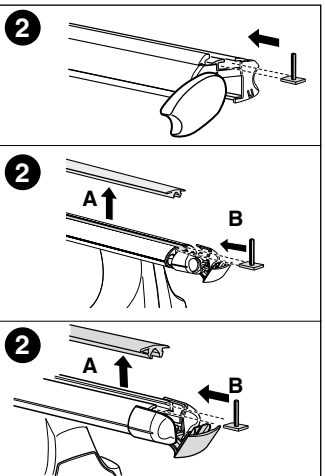
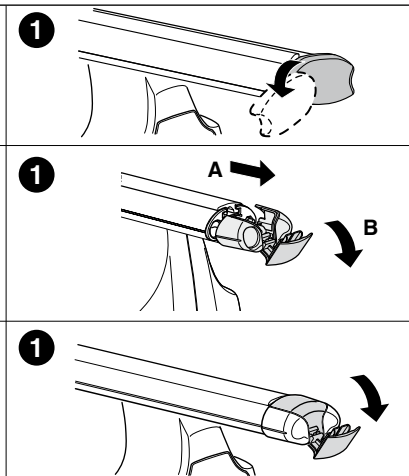
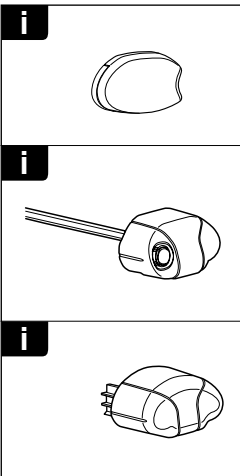
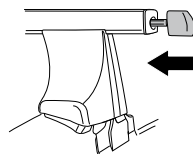
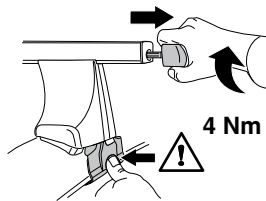
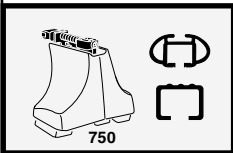
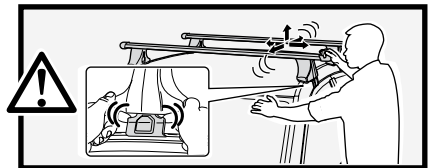
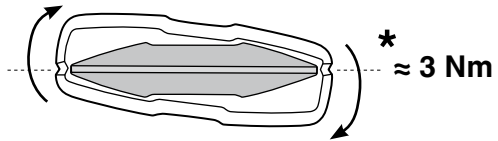
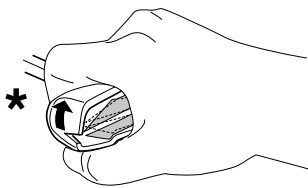
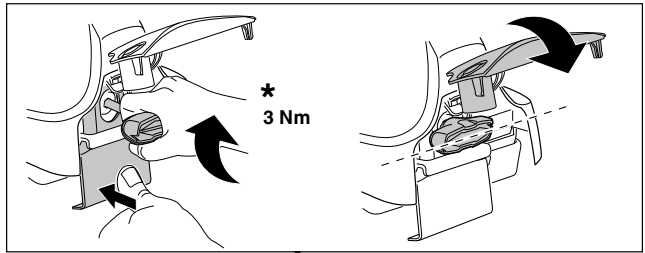
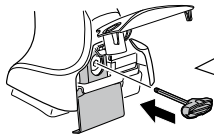

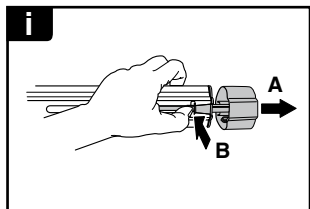
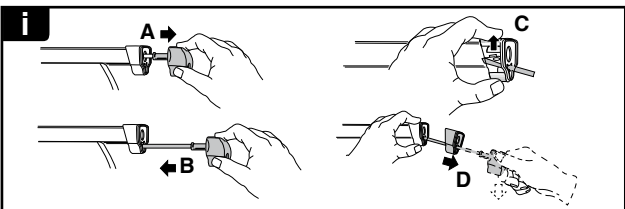
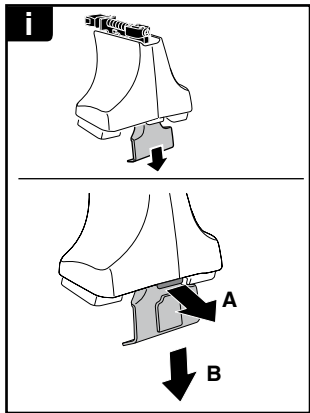
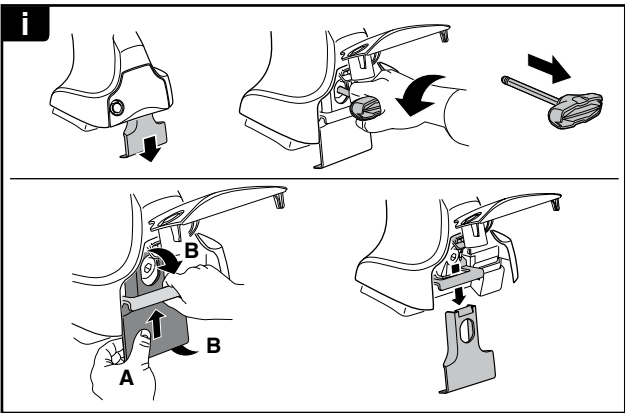
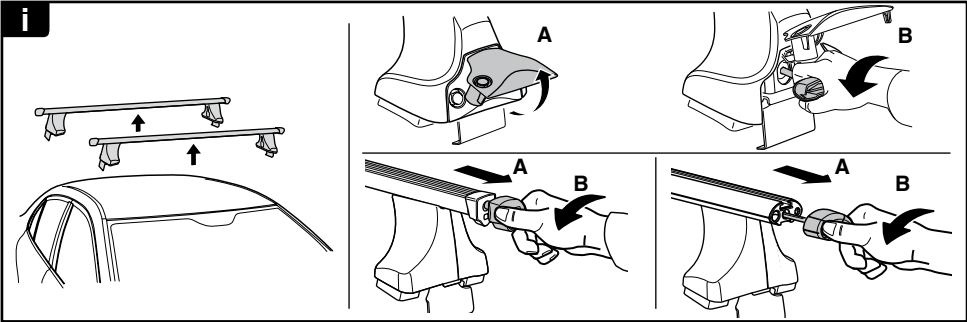
480



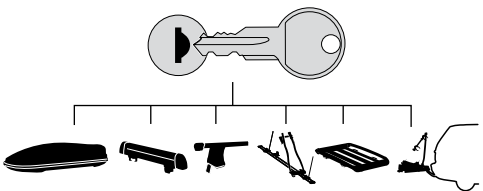

THULE
SWEDEN
**ONE
KEY
SYSTEM**

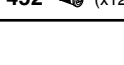
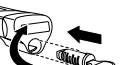

-  544 (x4)
-  596 (x6)
-  588 (x8)
- NA  510 (x10)
- EUR  452 (x12)
- ASIA 