

Kit 1172

SCION Xb, 5-dr SUV, *04-07

TOYOTA bB, 5-dr SUV, 00-05

480R
754

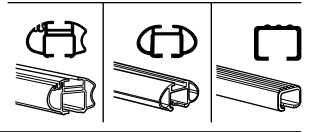
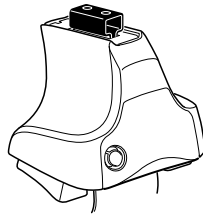

480

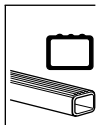
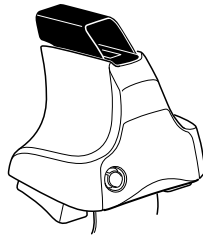

750

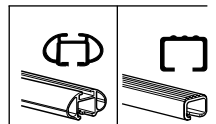
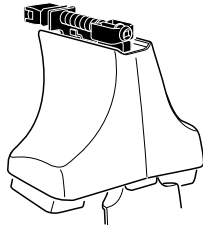

Kit

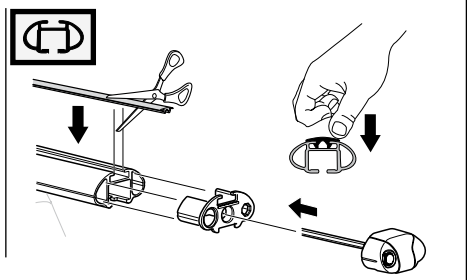
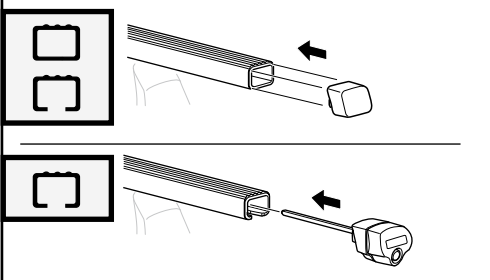
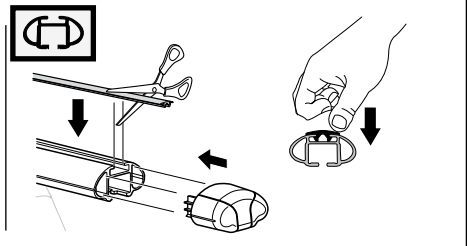
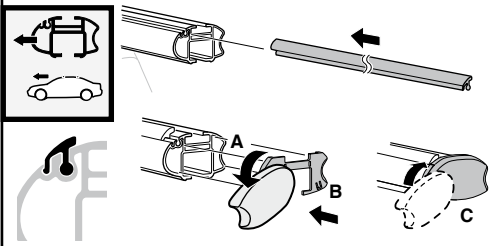
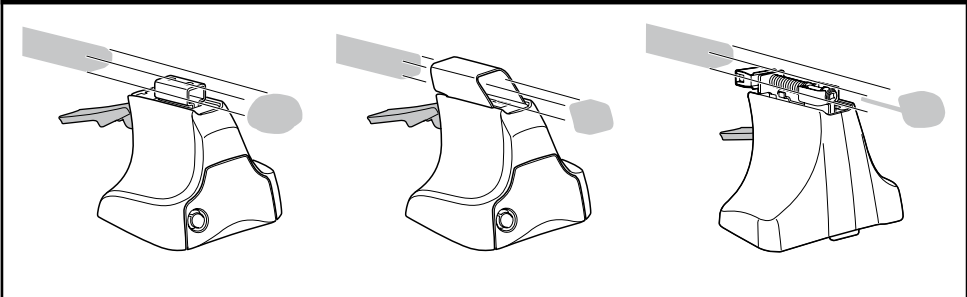
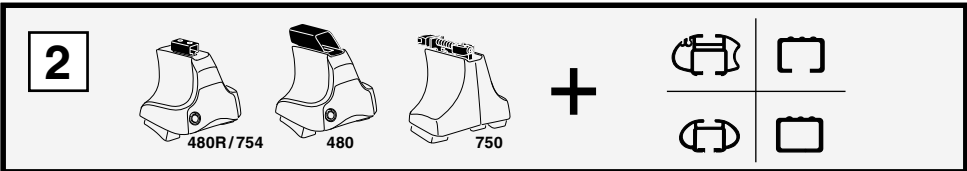
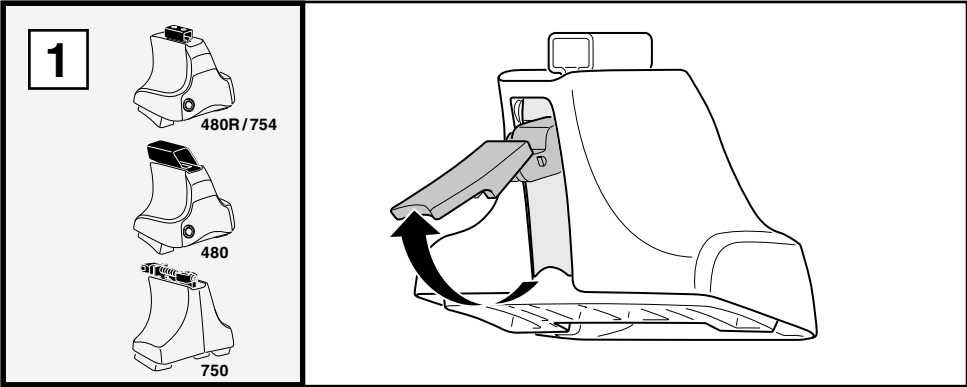

3

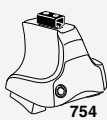

754

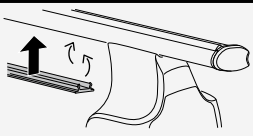
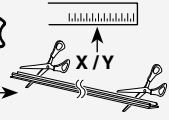

750

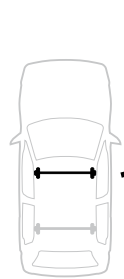

1

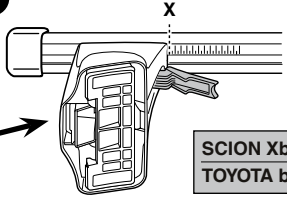

2

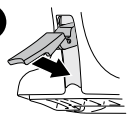

SCION Xb, 5-dr SUV, *04-07
TOYOTA bB, 5-dr SUV, 00-05

X
50
47,5

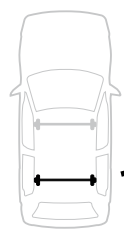

1

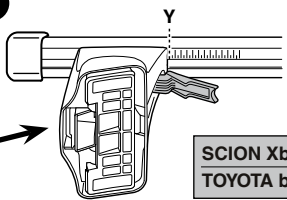

2

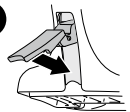

SCION Xb, 5-dr SUV, *04-07
TOYOTA bB, 5-dr SUV, 00-05

Y
50
47

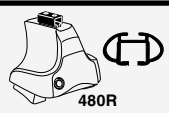

480R



480

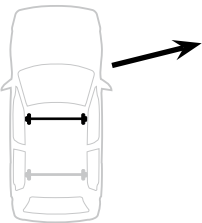

1

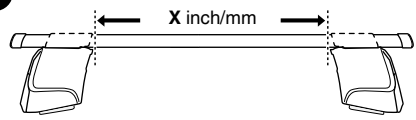

2

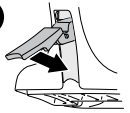

SCION Xb, 5-dr SUV, *04-07
TOYOTA bB, 5-dr SUV, 00-05

X inch	X mm
45 1/4"	1151 mm
44 3/8"	1126 mm

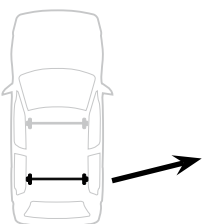

1

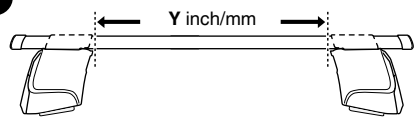

2

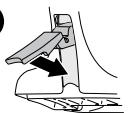

SCION Xb, 5-dr SUV, *04-07
TOYOTA bB, 5-dr SUV, 00-05

Y inch	Y mm
45 1/4"	1151 mm
44 1/8"	1121 mm

4

SCION Xb, 5-dr SUV, *04-07
TOYOTA bB, 5-dr SUV, 00-05

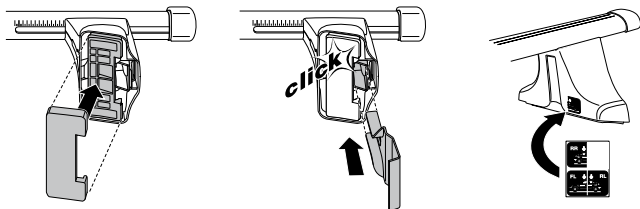
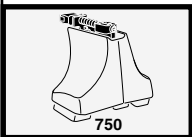
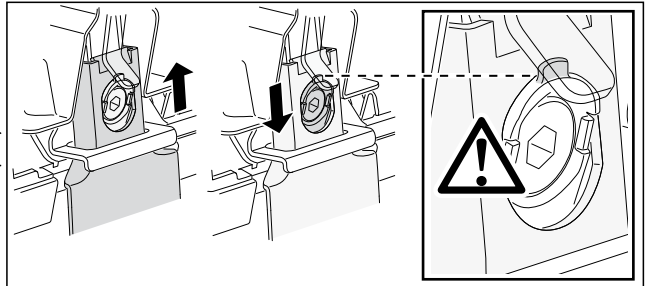
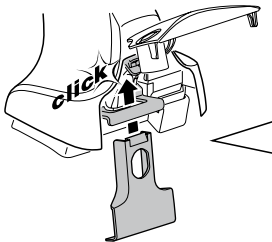
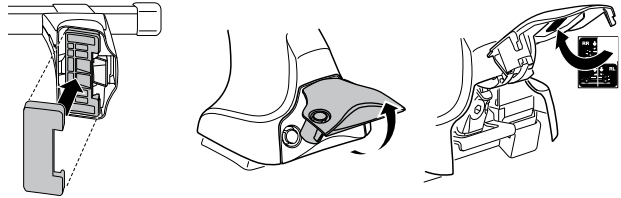
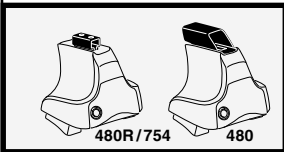
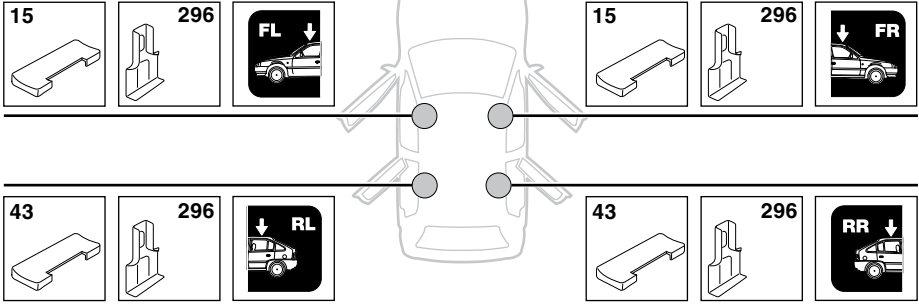

5

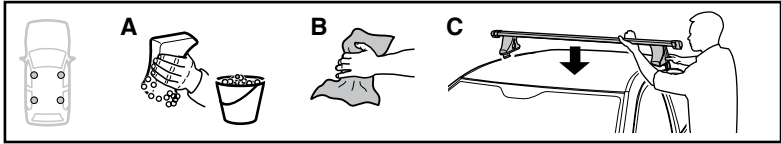

	X mm	Y mm	X inch	Y inch
SCION Xb, 5-dr SUV, *04-07	381 mm	711 mm	15 "	28 "
TOYOTA bB, 5-dr SUV, 00-05	400 mm	700 mm	15 ³ / ₄ "	27 ¹ / ₂ "

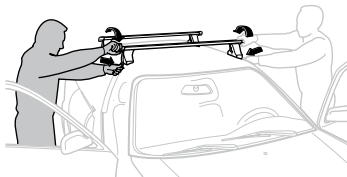
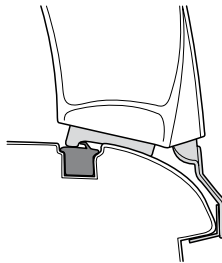
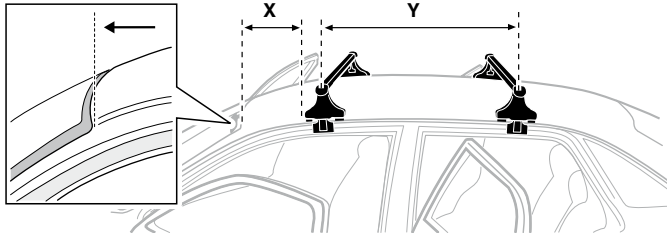

GB/US Tighten alternately

D Die Schrauben abwechselnd anziehen

F Serrer alternativement chaque côté

NL Afwisselend aan de linker- en de rechterkant aandraaien

I Alternare il serraggio delle viti

E Apertar alternativamente

PT Aperte alternadamente

S Dra åt växelvis

FIN Kierrä vuorotellen

EST Pinguldage vaheldumisi

LAT Pielieciet pamišus

LIT Užsukinėkite pakaitomis

PL Śruby dokręcaj naprzemiennie

RU Затягивайте попеременно

CZ Pokręťta багаžníka dokręcaj dokręcaj naprzemiennie.

SK Doťahujte striedavo

SLO Privijajte izmenično.

HR Naizmjenično zategnite

HU Egymástól függetlenül szorítandó

GR Σφιγγετε εναλλάξ

TR Dönüşümlü sıkın

中文 交替拧紧

한국어 번갈아 가며 조이십시오.

日本語 交互に締め付けてください。

ไทย ชั้นในแบบสลับ

6



480R/754



480

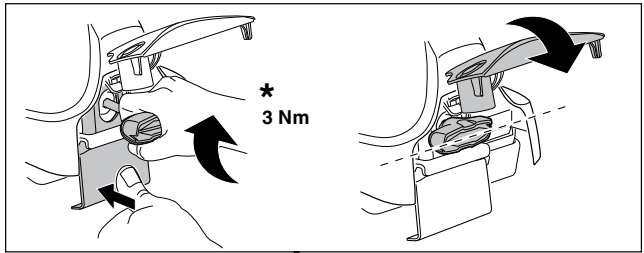
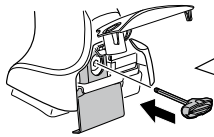

*
3 Nm

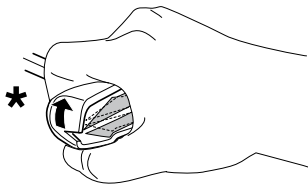

*

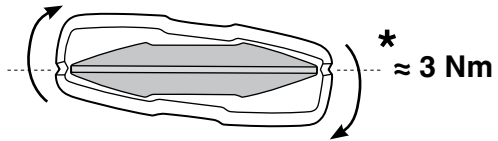

*
≈ 3 Nm

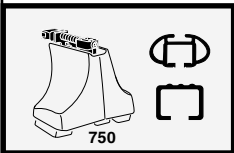
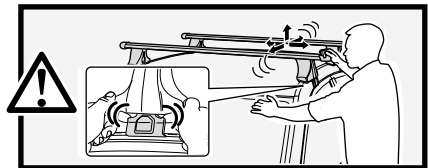

750

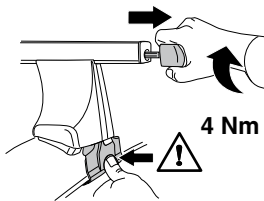

4 Nm

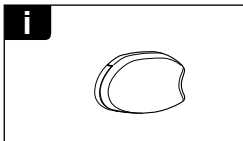
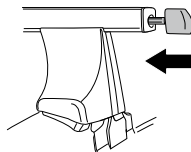

i

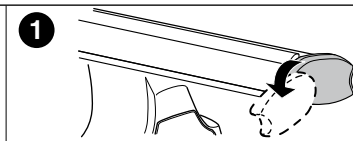

1

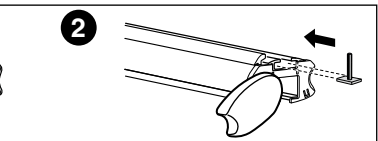

2

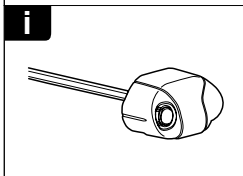

i

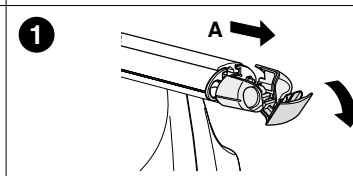

1

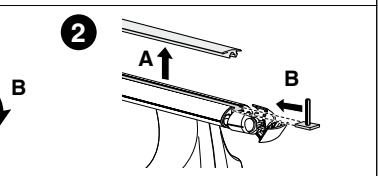

2

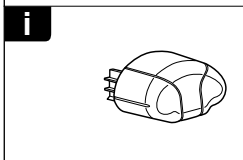

i

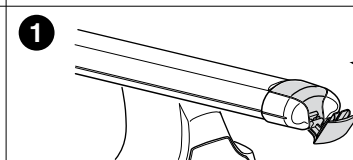

1

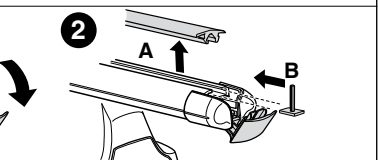

2

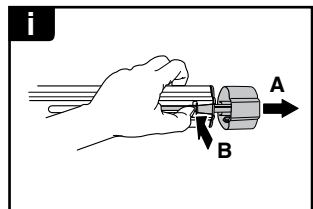
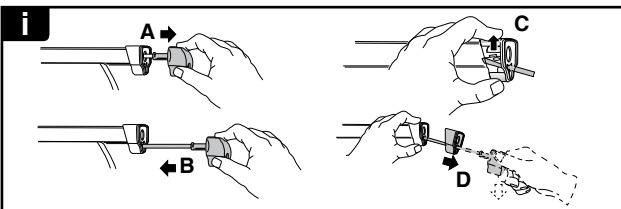
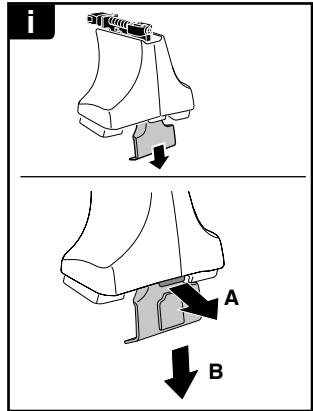
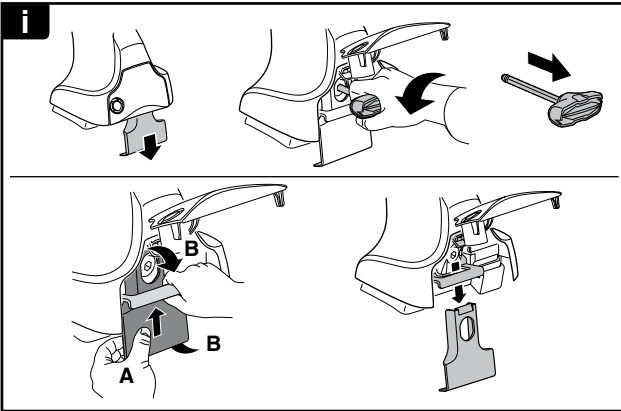
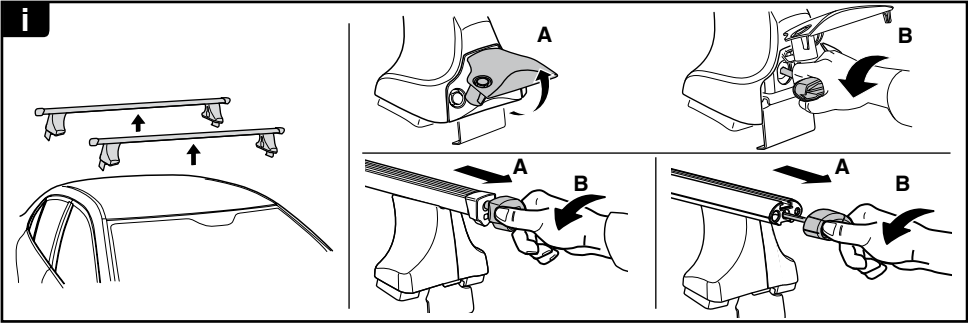

THULE
SWEDEN
**ONE
KEY
SYSTEM**

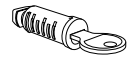
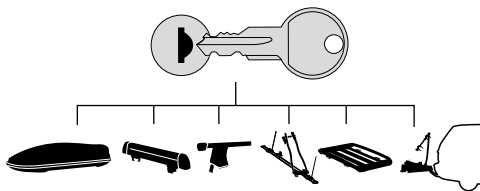

544 (x4)

596 (x6)

588 (x8)

NA **510** (x10)

EUR **452** (x12)

ASIA

