

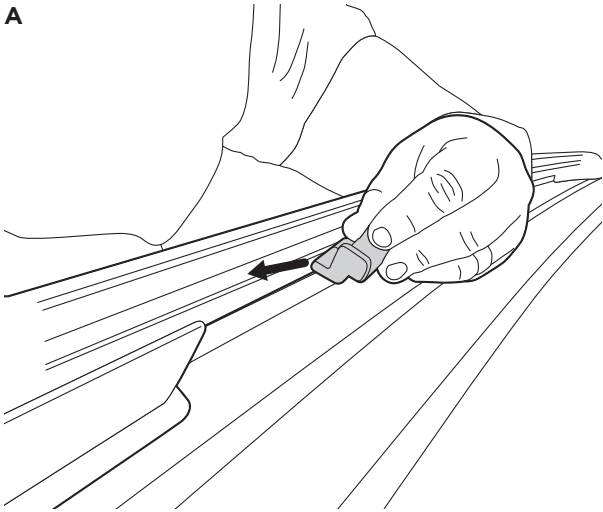

1

A



2011- FORD EXPLORER OWNERS ONLY:

A. Insert adapter into rail so that part number faces in and 'wings' face up.

B. Rotate adapter down towards roof. Adapter may click into place.

C. Adapter can slide side-to-side in rail to match desired foot position.

B

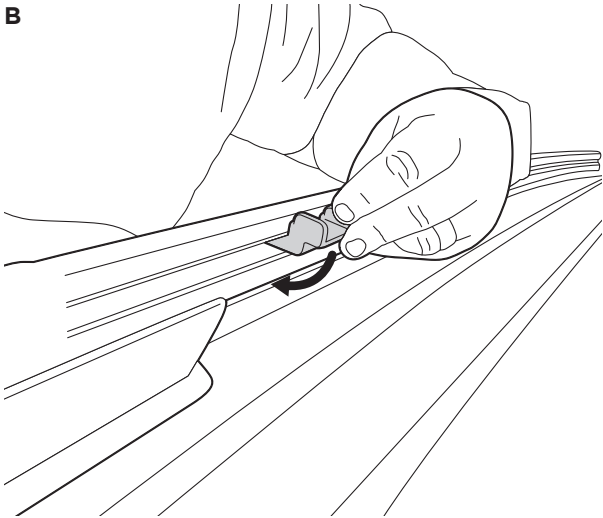

C

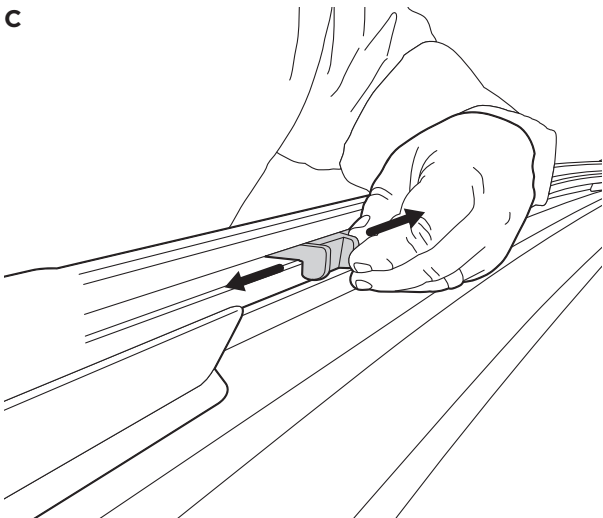

2

A

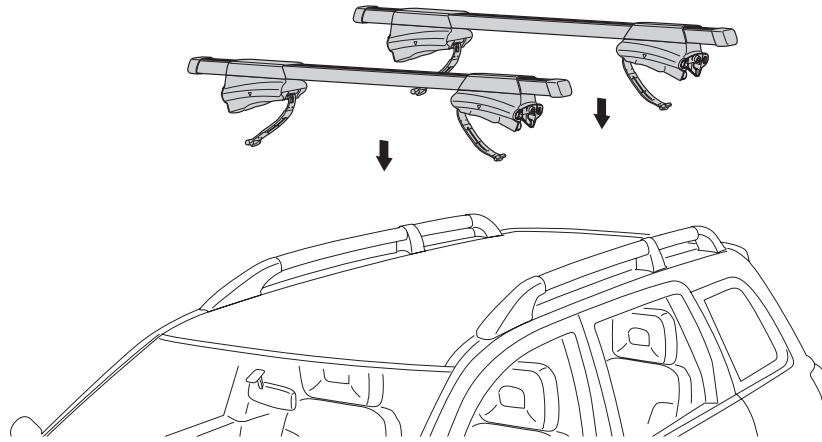

B

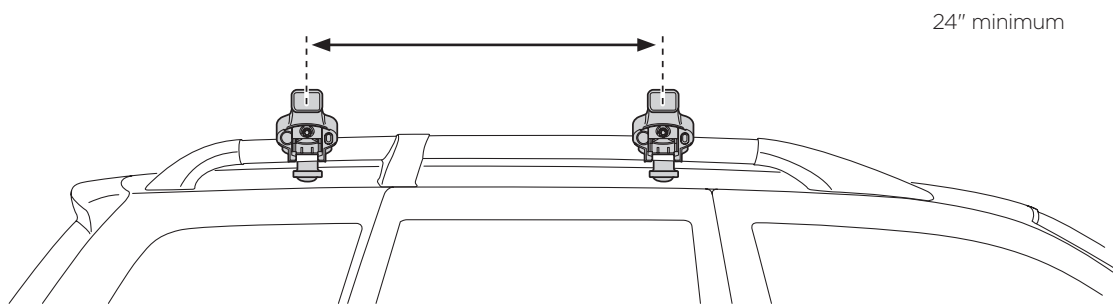

C

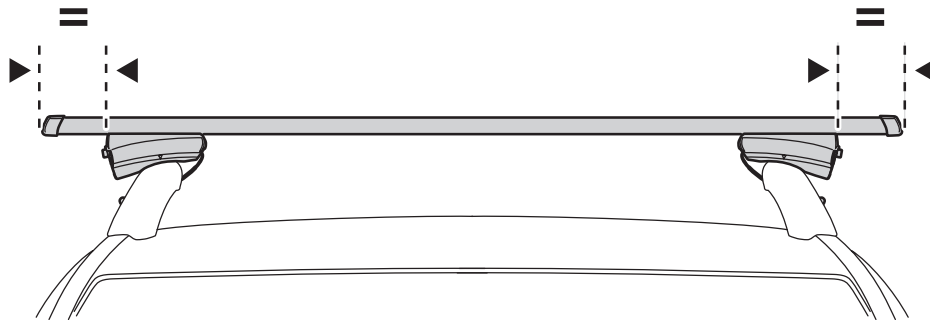

- A. Place load carrier on vehicle rails.
  - Use caution and do not let straps impact roof.
- B. Separate bars by a minimum of 24".
- C. Center feet on bars.

3

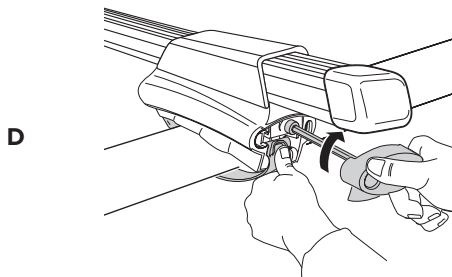
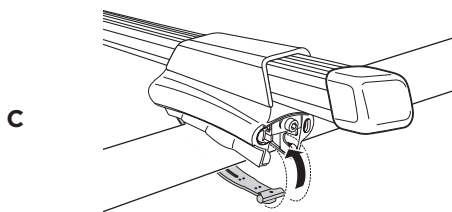
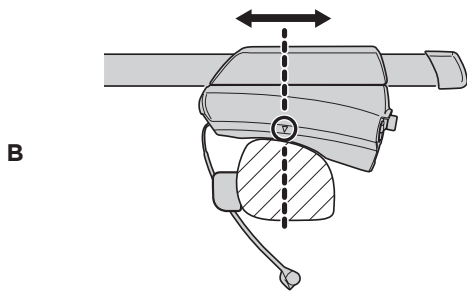
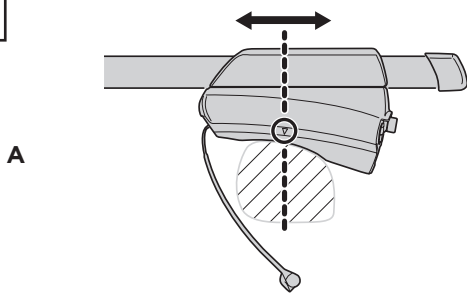

- A. Center foot and wrap strap around rail.
  - B. 2011- Ford Explorer owners ONLY: place adapter so that strap passes between adapter 'wings'.
  - C. Insert end of strap into foot.
    - If end of strap does not reach, increase length by loosening bolt with handle.
  - D. Hold strap in position and tighten foot with handle.
- NOTE: Grasp the carrier firmly and confirm it is securely fastened to the vehicles rails.

4

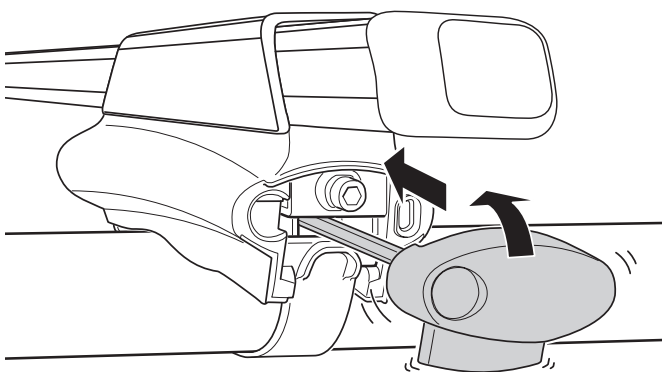

- Insert and snap handle into foot once rack is fully tightened.

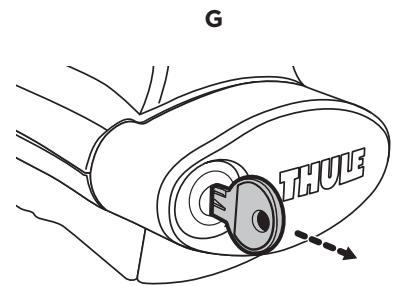
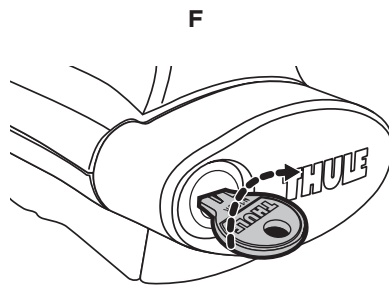
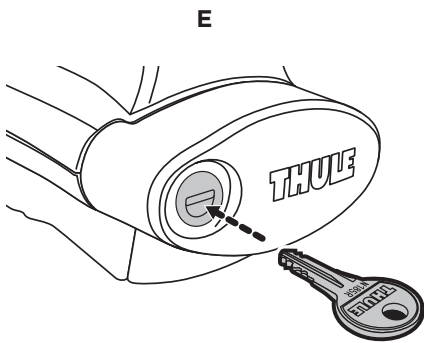
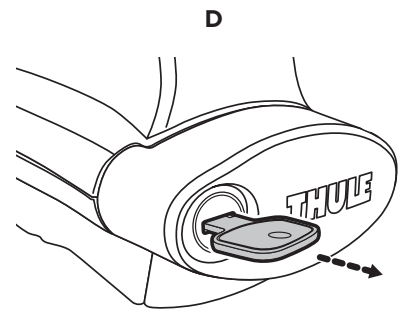
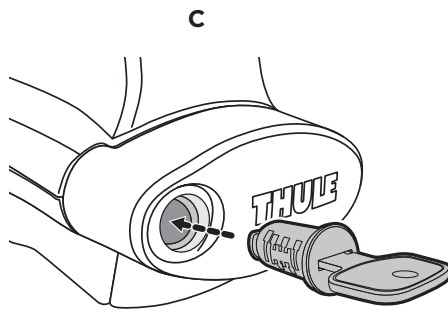
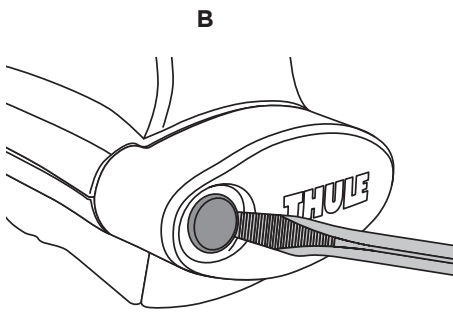
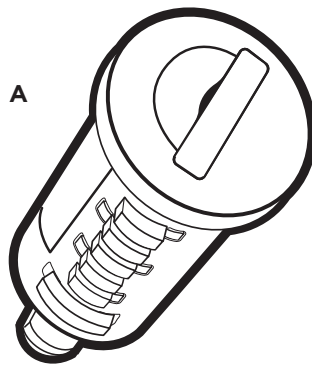

- Thule strongly recommends the use of locks to deter theft. As shown, follow these easy steps for installing the lock cylinders.