



JK TRANSIT MUD FLAP KIT

#4808500 JK Transit Mud Flap Kit



Important Notes:

The Transit Mud Flap Kit is intended for Jeeps that have an aftermarket rear bumper. The factory bumper does not allow room enough for the flap to be mounted the same way but one could mount them differently to get it to work for their particular application.

Prior to beginning this or any installation read these instructions to familiarize yourself with the required steps and evaluate if you are experienced and capable to personally perform these modifications. A factory service manual should be used in conjunction with these installation instructions.

Refer to the parts list to ensure that all necessary components and hardware has been included.

Tools needed:

- 16mm or 5/8 Wrench or Socket
- Ratchet for Sockets

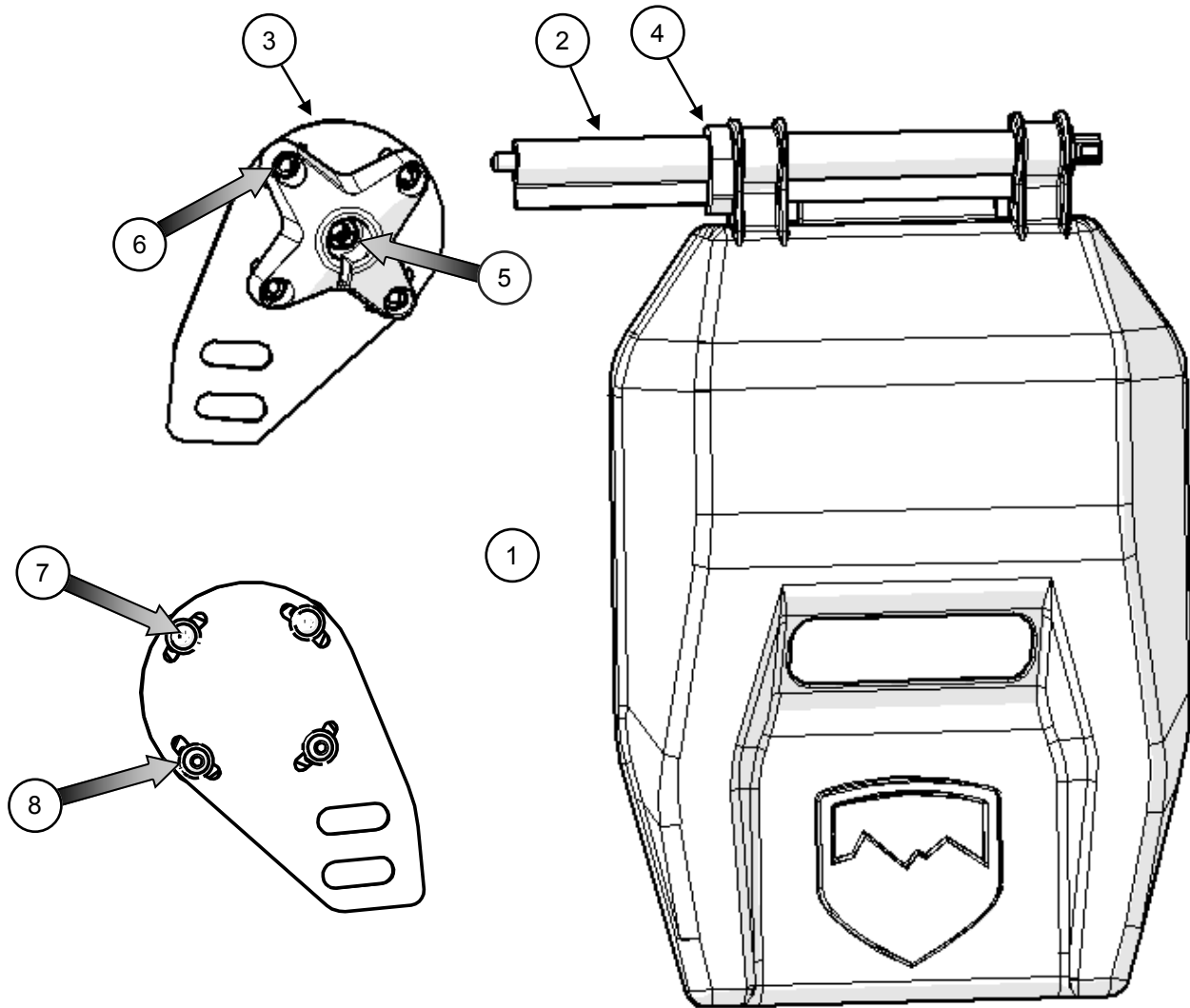

Item #	Part #	Description	Qty
1	808500	Transit Mud Flap	2
2	808515	Transit Mud Flap Rod Subassembly	2
3	808511	Transit Mud Flap Mount	2
4	808503	Transit Mud Flap Retaining Clamp	2
5	435	Hex Nut, Fine Thread / Stainless Steel, M10 X 1.25 mm Thread	2
6	70861	Lock Nut, Nylon Insert, 5/16" - 18 / 18-8 Stainless Steel	8
7	68	Bolt 5/16"-18 UNC x 1" Long Button Head Socket Cap Screw Stainless	8
8	433	Washer, Stainless Steel, 5/16" Screw/ 0.3440" ID,/0.7500" OD	8

Remove the four factory M10 bumper bolts with a 16mm or 5/8. These are the smaller of the bumper bolts that go through the frame. (two bolts per side)

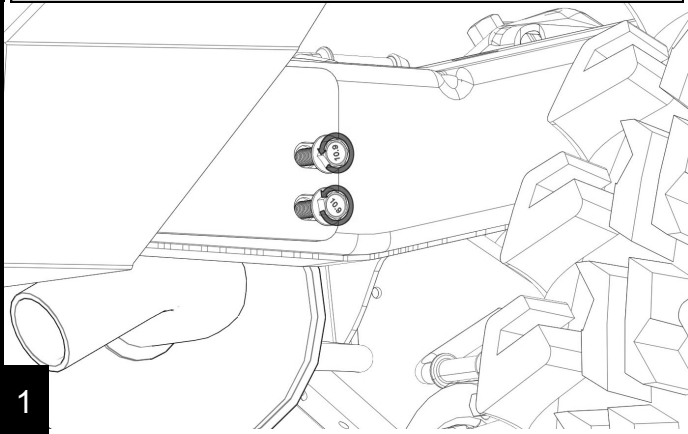

Position the Mud Flap Mount(3) facing forward and reinstall the factory M10 bumper bolts, **finger tight**, through the mount.

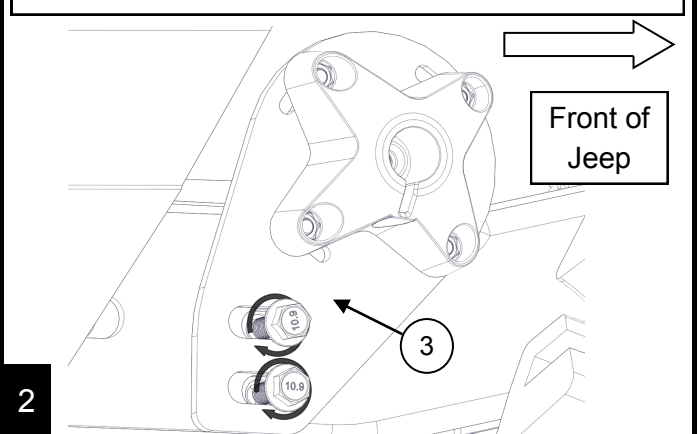

Install the Mud Flap Assembly(1) into the indexed Mud Flap Mount and turn the knob clockwise 3 to 4 times to make sure it will not fall out while adjusting the mount.

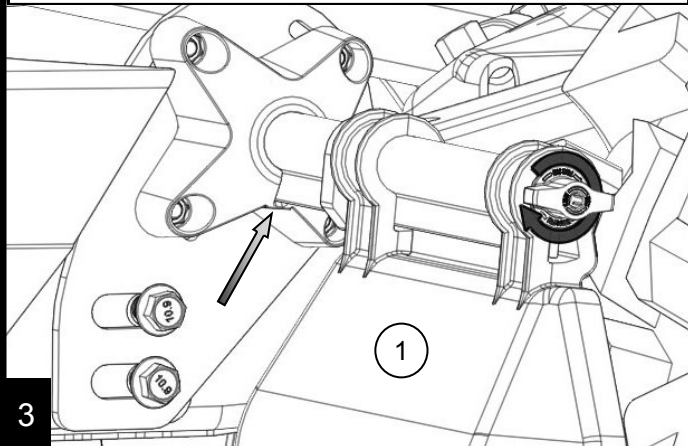

Adjust Mud Flap Mount for proper tire clearance and preferred angle and height, and **torque bumper bolts to 40 ft-lbs.** Then do the final tightening of the mud flap knob. Repeat steps for other side, and install is complete.

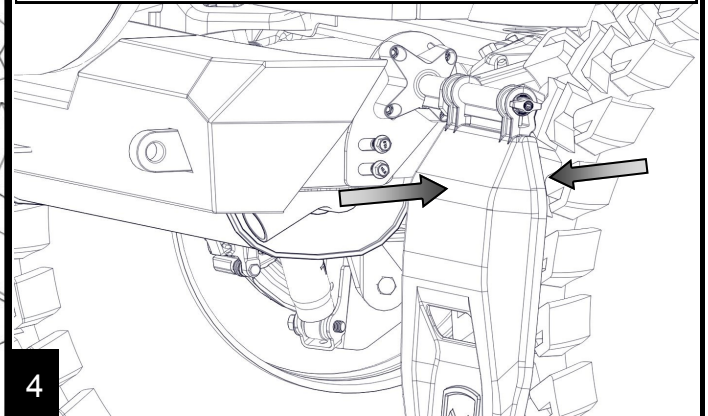

The Transit Mud Flaps are easily removable by simply unthreading it from the Mud Flap Mount using the Mud Flap's end Knob

Check on Transit Mud Flap Assemblies for the first 200-300 miles and after trial driving

Check torque of factory M10 bumper bolts after the first 400-500 miles

TERAFLEX

PRODUCT INFORMATION

MAINTENANCE INFORMATION:

It is the buyer's responsibility to have all suspension, drivetrain, steering, and other components checked for proper tightness and torque after the first 100 miles and every 3000 miles after that.

NOTICE TO INSTALLER:

The enclosed "Warning to Driver" sticker must be installed in the vehicle in driver's view. This sticker is to act as a constant safety reminder when operating the vehicle. It is your responsibility as the equipment installer to install the provided sticker and to forward the product instructions to the vehicle's owner for review. If a "Warning to Driver" sticker or product installation guide were not included in the kit, FREE replacement stickers and instructions are available by request. It is the installer's duty to ensure a safe and controllable vehicle after the modifications have been performed.

WARNING:

Neither the seller nor the manufacturer will be liable for any loss, damage, or injury directly or indirectly arising from the use of or inability to determine the use of these products. Before using, the user shall determine the suitability of the products for its intended use, and the user shall assume all responsibility and risk in connection therewith.

WARNING TO DRIVER:

This vehicle has been modified to enhance off road performance and has unique handling characteristics. Use in harsh environments can cause extreme stress on the components. Vehicle should be inspected after being off road to make sure that all the components are in working order and safe to travel on the highway. All fasteners should be checked so that they are at the correct torque specifications as the vibration and stresses from off roading may cause critical fasteners to work loose. Extra care should be taken to inspect the critical components, steering, and brake systems. During each oil change components such as arms, tie rod ends, etc should be greased and checked for excessive wear. Any worn components should be replaced. When returning to the pavement always set or restore tire air pressure to the factory recommendation and connect or engage any disabled sway bar mechanisms. Because of the higher center of gravity and larger tires, this vehicle handles and reacts differently than many passenger cars, both on and off road. You must drive it safely! Extreme care should be taken to prevent vehicle rollover or loss of control, which can result in serious injury or death. Avoid sudden sharp turns or abrupt maneuvers. Generally, braking performance and capabilities are decreased when significantly larger/heavier tires are used, especially when used in combination with transfer case low-range reduction kits. Take this into consideration while driving. Do not add, alter or fabricate any factory or aftermarket parts to increase vehicle height over the intended height of the TeraFlex product purchased. Mixing component brand is not recommended. TeraFlex Inc. will not be responsible for any altered product or any improper installation or use of our products. We will be happy to answer any questions concerning the design, function, and correct use of our products. It is ultimately the buyer's responsibility to have all bolts/nuts checked for tightness after the first 100 miles and then every 3000 miles. Wheel alignment, steering system, suspension and drive line systems must be inspected by a qualified professional mechanic at least every 3000 miles.

On our website you can discover more about mud flaps and splash guards.