



For ALL Your Air Suspension Needs!!!

1997-2002

***Ford Expedition
Lincoln Navigator***

53F-30-R

Rear Conversion kit





For ALL Your Air Suspension Needs!!!

WARNING:

BEFORE YOU BEGIN THE REMOVAL OR INSTALLATION, READ ALL INSTRUCTIONS THOROUGHLY! THE WARRANTY WILL BE VOID IF INSTRUCTIONS ARE NOT FOLLOWED EXACTLY. DO NOT WORK UNDER CAR UNDER A VEHICLE SUPPORTED BY A JACK. ALWAYS SUPPORT THE VEHICLE ON SAFETY STANDS.

WARNING: THE ELECTRICAL POWER TO THE AIR SUSPENSION SYSTEM MUST BE SHUT OFF PRIOR TO HOISTING, JACKING OR TOWING AN AIR SUSPENSION VEHICLE. THIS CAN BE ACCOMPLISHED BY TURNING "OFF" THE AIR SUSPENSION SWITCH LOCATED IN THE RH PASSENGER COMPARTMENT. FAILURE TO DO SO MAY RESULT IN UNEXPECTED INFLATION OR DEFLATION OF THE AIR SPRINGS. THIS MAY RESULT IN SHIFTING OF THE VEHICLE DURING THESE OPERATIONS.

- 1 Remove both the wheel and tire assemblies.
- 2 Remove air springs. (see 11-15)
- 3 Disconnect stabilizer bar from the rear axle.
- 4 Unhook the shock from the axle bracket (both sides). This will allow the rear axle to drop down a few inches.
- 5 Pull down on the axle and push the coil spring on the axle seat.
- 6 Place the coils that are closer together looking up. Place the coil spring top into the frame seat. (Push all the wires and hose back.)
- 7 Jack up the axle and replace shock bolts. Tighten up the nuts.
- 8 Replace the stabilizer bar.
- 9 Tie the wires and hose around the top of the coil spring. This will prevent the wires from touching the exhaust or any moving part.
NOTE: DO NOT CUT THE WIRES AND HOSES.
- 10 Replace the wheels and lower the vehicle.

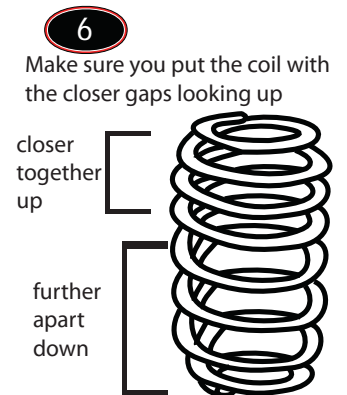

- 11 Bleed the air from the air suspension system. Raise and support the vehicle.

WARNING: THE ELECTRICAL POWER TO THE AIR SUSPENSION SYSTEM MUST BE SHUT OFF PRIOR TO HOISTING, JACKING OR TOWING AN AIR SUSPENSION VEHICLE. THIS CAN BE ACCOMPLISHED BY TURNING "OFF" THE AIR SUSPENSION SWITCH LOCATED IN THE RH PASSENGER COMPARTMENT. FAILURE TO DO SO MAY RESULT IN UNEXPECTED INFLATION OR DEFLATION OF THE AIR SPRINGS. THIS MAY RESULT IN SHIFTING OF THE VEHICLE DURING THESE OPERATIONS.

- 12 Remove the rear air spring retainer.
- 13 Lift the bottom of the air spring off of the rear axle.
- 14 Disconnect the air line from the air spring. (Push the green ring in and hold finely to release and remove the air line.)
- 15 Disconnect the solenoid electrical connector and remove air spring.

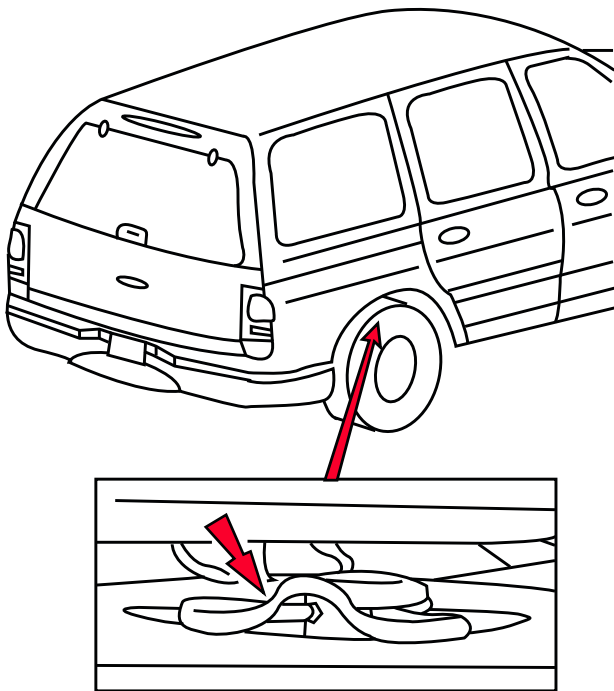

12

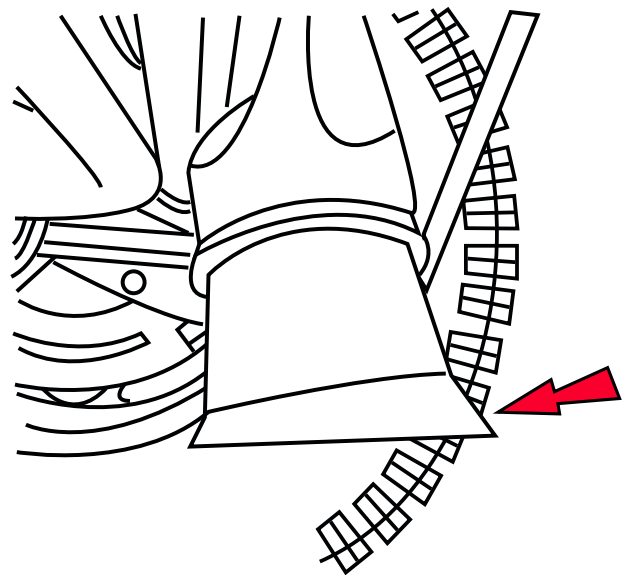

13

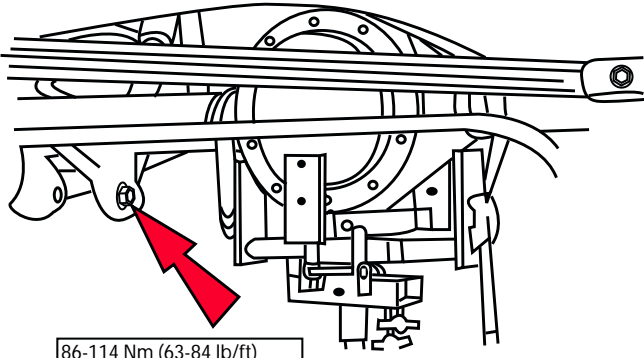

7

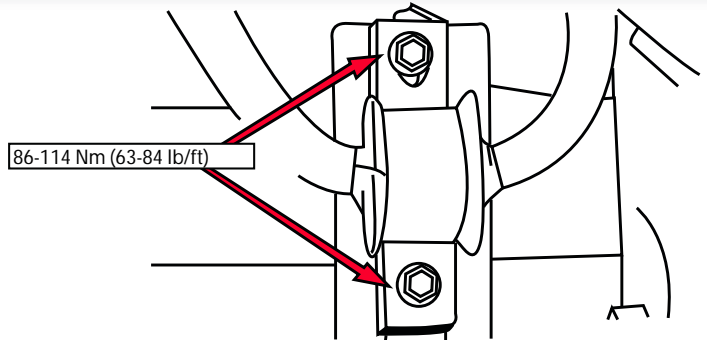

8

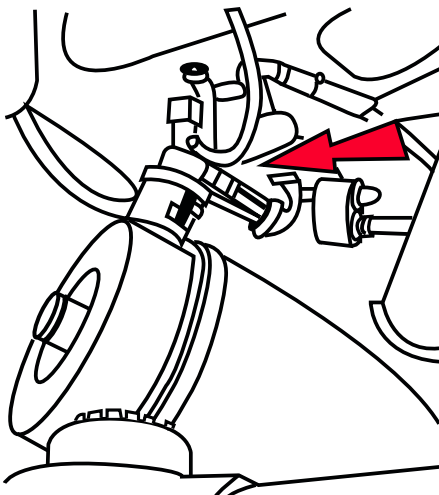

14

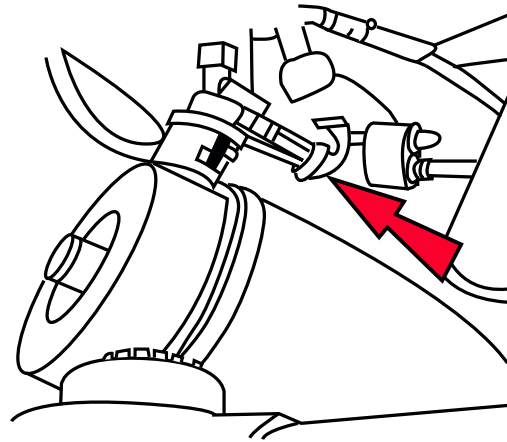

15

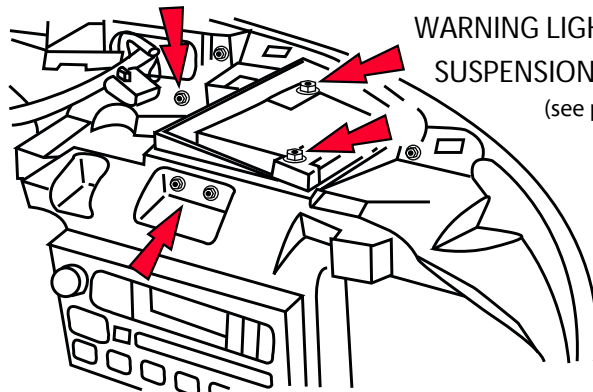

Remove the instrument panel cluster panel.



For ALL Your Air Suspension Needs!!!

Option 1: Leave the solenoid connected

Option 2: Cut the following wires-

EXPEDITION/ NAVIGATOR
WARNING LIGHT DISARM
C296F (BLACK or WHITE)
4 WHEEL AIR SUSPENSION MODULE

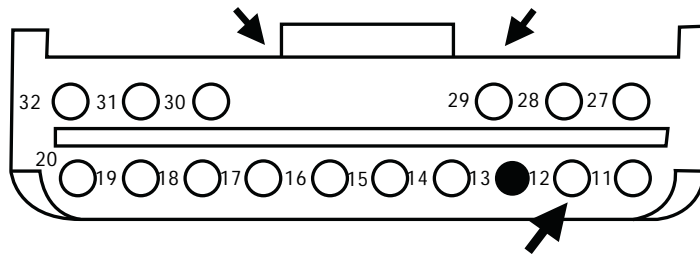

ON BLACK or WHITE PLUG CUT #12 PIN WIRE

Turn suspension switch off (located in RH passenger compartment)

C296 (black or white) 4 WHEEL AIR SUSPENSION MODULE		
PIN	CIRCUIT	CIRCUIT FUNCTION
11	784 (LB/BK)	Generic Electronic Module
12	419 (DG/LG)	Power
13	-----	Not Used
14	1115 (T/W)	Right Rear Air Spring Solenoid
15	1195 (BR/O)	REAR Air Fill Solenoid
16	1178 (LB/BK)	Front Gate Solenoid
17	1114 (BR/PK)	Left Rear Air Spring Solenoid
18	420 (DB/Y)	Compressor Relay
19	1194 (Y/BK)	FRONT Air Fill Solenoid
20	432 (BK/PK)	Height Sensor Ground
27	933 (BK/O)	EVO Module
28	429 (P/LG)	Height Sensor
29	70 (LB/W)	Data Link Connector (DLC)
30	421 (PK)	Air Suspension Compressor/Vent Solenoid Control
31	900 (BK)	All Wheel Drive
32	57 (BK)	Ground