

- Using the included fit chart, adjust foot positions to the numbers for your vehicle. Use "Front" dimensions for front bar and "Rear" for rear bar.

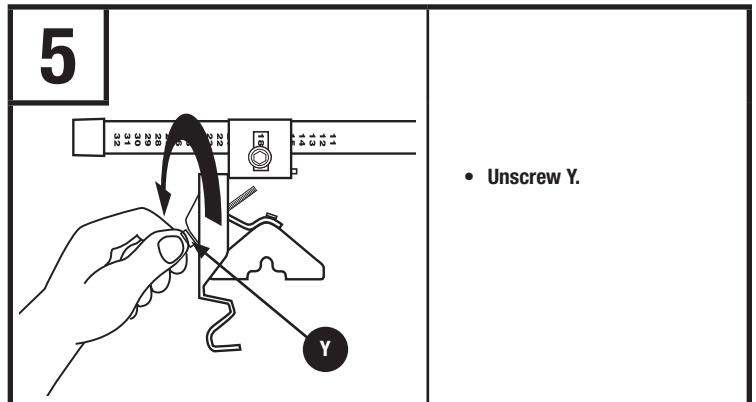

6

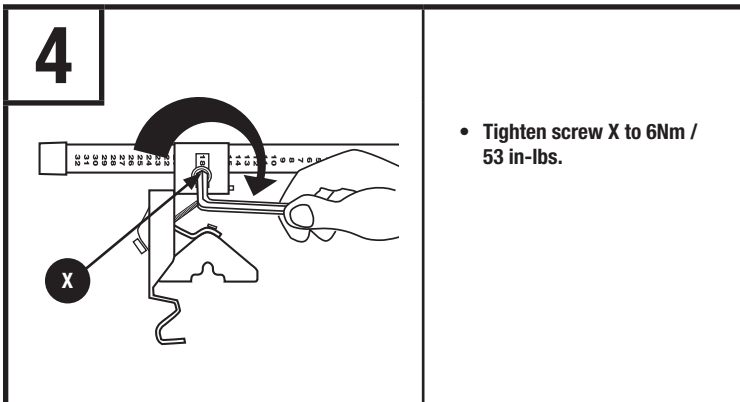
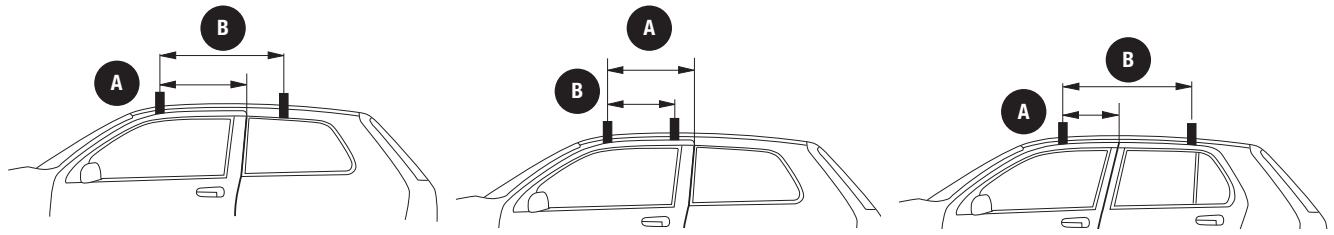

- Position the rack on your vehicle according to distance A and B indicated for your vehicle in the included fit chart.

7

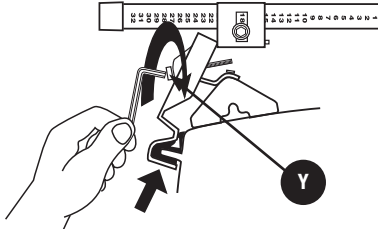

- Locate clamp plate and pad as shown. Tighten bolts Y alternately.

8

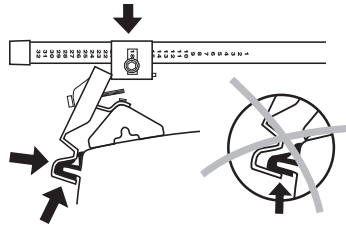

- Check all fittings are secure and correctly positioned.

9

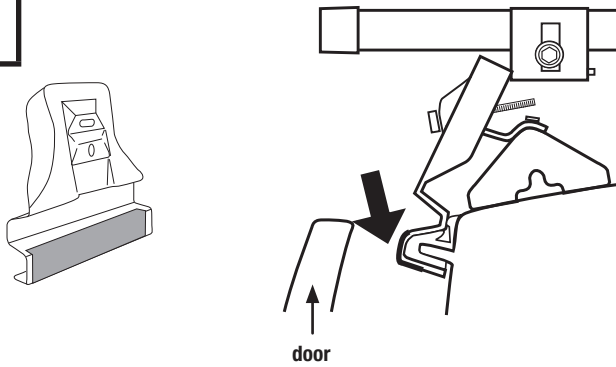

- Stick protective adhesive on the clamp plate.

10

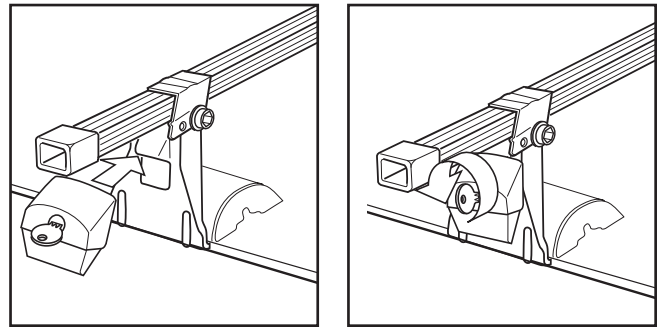



2013 COMPLETE ROOF RACK SYSTEM - SR1004 - FIT GUIDE

Vehicle Make and Model	Year	3D Adapter A21116									
			Front	Rear	A		B		Lbs	Kg	
					inch	mm	inch	mm			

ACURA											
Integra 3DR	86-89		18	17	19 3/4	502	17 3/4	451	130	59	1c
Integra 3DR	86-89	✓	17	17	20 1/2	521	16 1/2	419	130	59	3u, 9o
Legend 4DR	86-90		21	19	9 3/4	248	27 1/2	699	130	59	
ALFA ROMEO											
164 4dr	88-98		22	20	16 1/4	413	33 1/2	851	130	59	4i
CHEVROLET											
Lumina 4DR	95-99		25	23	11	279	26 3/4	679	130	59	
Monte Carlo 2DR	95-99		28	26	23 1/4	591	19 3/4	502	130	59	1c
Monte Carlo 2DR	95-99	✓	28	26	20 1/2	521	17 3/4	451	130	59	9o
Sprint 3DR	89-94		13	10	21 1/4	540	18 1/2	470	90	41	1c
Sprint 3DR	89-94	✓	13	13	19	483	13 3/4	349	90	41	9o
Sprint 4DR	89-94		12	11	11	279	24 3/4	629	130	59	
Sprint 5DR	89-94		12	11	11	279	24 3/4	629	90	41	
CHRYSLER											
Cirrus 4DR	95-00		28	25	10 1/4	260	22 3/4	578	130	59	
Daytona	84-93		21	21	18	457	16 1/2	419	130	59	1d
Daytona T-Top	84-93		31	31	18	457	16 1/2	419	130	59	1d, 3m
Dynasty 4DR	88-93		28	27	11 3/4	298	27 1/2	699	130	59	
Le Baron 2DR	87-95		16	14	20 3/4	527	17 3/4	451	130	59	1b, 1d
Le Baron 4DR	90-94		21	19	9 3/4	248	27 1/2	699	130	59	
Le Baron GTS	85-89		21	19	11 3/4	298	27 1/2	699	130	59	
Neon 4DR	00-04		18	15	12 1/2	318	23 1/2	597	130	59	
New Yorker 4DR	88-93		28	27	11 3/4	298	27 1/2	699	130	59	
New Yorker Fifth Avenue 4DR	90-93		28	27	11 3/4	298	27 1/2	699	130	59	
Sebring 4DR	01-06	✓	27	24	11 3/4	298	15 3/4	400	90	41	3x, 9o
Town & Country	96-01		26	26	5	127	31 1/2	800	130	59	1i
DODGE											
Caravan	96-01		26	26	5	127	31 1/2	800	105	48	1i
Caravan / Grand Caravan	96-01		26	26	5	127	31 1/2	800	130	59	1i
Colt 200 3DR	89-92		18	14	20 1/2	521	17 1/4	438	130	59	1c
Colt 200 3DR	89-92	✓	15	11	17	432	13	330	130	59	9o
Daytona 3DR	84-93		21	21	18	457	16 1/2	419	130	59	1d
Dynasty	88-93		28	27	11 3/4	298	27 1/2	699	130	59	
Lancer 5DR	85-89		21	19	11 3/4	298	27 1/2	699	130	59	
Neon 4DR	00-04		18	15	12 1/2	318	23 1/2	597	130	59	
Shadow 3DR	87-94	✓	22	21	19 3/4	502	17 3/4	451	130	59	1c
Shadow 3DR	87-94		20	22	19 3/4	502	15 1/4	387	130	59	9o
Shadow 5DR	87-94		21	19	10 1/4	260	24 3/4	629	130	59	
Spirit 4DR	88-95		21	19	9 3/4	248	27 1/2	699	130	59	
Stratus 4DR	95-99		28	25	10 1/4	260	22 3/4	578	130	59	
SX 2.0 4DR	03-05		18	15	12 1/2	318	23 1/2	597	130	59	



2013 COMPLETE ROOF RACK SYSTEM - SR1004 - FIT GUIDE

Vehicle Make and Model	Year	3D Adapter A21116									
			Front	Rear	A		B		Lbs	Kg	
			inch	mm	inch	mm					

EAGLE											
Summit 3DR	89-92		18	14	20 1/2	521	17 1/4	438	130	59	1c
Summit 3DR	89-92	✓	15	11	17	432	13	330	130	59	9o
GEO											
Metro 3DR	89-94		13	10	21 1/4	540	18 1/2	470	130	59	1c
Metro 3DR	89-94	✓	13	13	19	483	13 3/4	349	130	59	9o
Metro 4DR	89-94		12	11	11	279	24 3/4	629	130	59	
Metro 5DR	89-94		12	11	11	279	24 3/4	629	130	59	
HONDA											
Accord 2DR	86-89	✓	19	19	19 3/4	502	15 3/4	400	130	59	9o
Accord 3DR	86-89	✓	18	18	20 1/2	521	13	330	130	59	9o
Accord 4DR	86-89		20	20	9 3/4	248	27 1/2	699	130	59	
Passport	90-97		28	28	14 1/4	362	31 1/2	800	130	59	1b, 1i
HYUNDAI											
Elantra 4DR	92-95		17	15	9 3/4	248	23 1/2	597	105	48	
Excel 3DR	86-89	✓	10	10	20 1/2	521	11 3/4	298	105	48	9o
Excel 4DR	90-94		12	12	11 3/4	298	27 1/2	699	105	48	1b, 3u
Excel 5DR	86-89		11	11	11	279	27 1/2	699	130	59	
Sonata 4DR	89-93		21	19	11 3/4	298	27 1/2	699	105	48	
INFINITI											
G20 4DR	91-96		22	20	13 3/4	349	25 1/2	648	130	59	
ISUZU											
Hombre	96-97		29	29					130	59	
Pickup	81-95		29	29					130	59	
Rodeo 5DR	90-97		28	28	14 1/4	362	31 1/2	800	130	59	1b, 1i
Stylus 4DR	92-95		21	18	9 1/4	235	23 1/4	591	130	59	4i
MAZDA											
929 4DR	88-91		25	24	11 3/4	298	27 1/2	699	130	59	
MITSUBISHI											
Colt 3DR	89-92		18	14	20 1/2	521	17 1/4	438	130	59	1c
Colt 3DR	89-92	✓	15	11	17	432	13	330	130	59	9o
Mirage 3DR	89-92		18	14	20 1/2	521	17 1/4	438	130	59	1c
Mirage 4DR	89-92	✓	15	11	17	432	13	330	130	59	9o
NISSAN											
200 SX 2DR	95-98		19	18	19 3/4	502	15 3/4	400	130	59	1d
Axxess 5DR	89-95		24	23	9 3/4	248	27 1/2	699	130	59	4i
Costaud	87-97		29	28	19 3/4	502	17	432	130	59	1d
Costaud King Cab	87-97		29	28	19 3/4	502	17	432	130	59	1c
Costaud King Cab	87-97	✓	30	29	18 1/2	470	13 3/4	349	130	59	9o
Frontier 4DR Crew Cab	00-04		29	28	11 3/4	298	27 1/2	699	105	48	4i
Maxima 4DR	89-94		25	23	11 3/4	298	25 1/2	648	90	41	
Multi 5DR	82-88		28	27	7 3/4	197	27 1/2	699	130	59	
Pathfinder 5DR	90-96		32	32	20 1/2	521	17 3/4	451	80	36	1b, 1i



## 2013 COMPLETE ROOF RACK SYSTEM - SR1004 - FIT GUIDE

Vehicle Make and Model	Year	3D Adapter A21116									
			Front	Rear	A		B		Lbs	Kg	
					inch	mm	inch	mm			

### NISSAN (continued - suite - consecuencia)

Pickup	87-97		29	28	19 3/4	502	17	432	130	59	1d
Pickup King Cab	87-97		29	28	19 3/4	502	17	432	130	59	1c
Pickup King Cab	87-97	✓	30	29	18 1/2	470	13 3/4	349	130	59	9o
Sentra 2DR	91-95		17	15	19 3/4	502	17 3/4	451	130	59	1c
Sentra 2DR	91-95	✓	18	14	19 3/4	502	15	381	90	41	4i, 9o
Sentra 4DR	95-99		17	17	11 3/4	298	23 1/2	597	90	41	
Sentra 4DR	91-94		16	15	11 3/4	298	24 3/4	629	130	59	

### OLDSMOBILE

Alero 2DR	99-05		20	20	25 1/2	648	21 3/4	552	105	48	
Alero 4DR	99-05		19	21	9 3/4	248	23 1/2	597	105	48	

### PLYMOUTH

Acclaim 4DR	88-95		21	19	9 3/4	248	27 1/2	699	130	59	
Breeze 4DR	96-99		28	25	10 1/4	260	22 3/4	578	130	59	
Colt 200 3DR	89-92		18	14	20 1/2	521	17 1/4	438	130	59	1c
Colt 200 3DR	89-92	✓	15	11	17	432	13	330	130	59	9o
Duster 3DR	87-94		22	21	19 3/4	502	17 3/4	451	130	59	1c
Duster 3DR	87-94	✓	20	22	19 3/4	502	15 1/4	387	130	59	9o
Duster 5DR	87-94		21	19	10 1/4	260	24 3/4	629	130	59	
Grand Voyager	96-99		26	26	5	127	31 1/2	800	130	59	1i
Laser 3DR	84-86		21	21	18	457	16 1/2	419	130	59	1d
Neon 4DR	00-01		18	15	12 1/2	318	23 1/2	597	130	59	
Sundance 3DR	87-94		22	21	19 3/4	502	17 3/4	451	130	59	1c
Sundance 3DR	87-94	✓	20	22	19 3/4	502	15 1/4	387	130	59	9o
Sundance 5DR	87-94		21	19	10 1/4	260	24 3/4	629	130	59	
Voyager	96-00		26	26	5	127	31 1/2	800	105	48	1i

### PONTIAC

Firefly 3DR	89-94		13	10	21 1/4	540	18 1/2	470	90	41	1c
Firefly 3DR	89-94	✓	13	13	19	483	13 3/4	349	90	41	9o
Firefly 4DR	89-94		12	11	11	279	24 3/4	629	90	41	
Firefly 5DR	89-94		12	11	11	279	24 3/4	629	130	59	
Grand Am 2DR	99-05		19	19	23 1/2	597	21 1/4	540	105	48	
Grand Am 2DR	99-04	✓	19	19	21 3/4	552	13 3/4	349	130	59	
Grand Am 4DR	99-05		19	21	9 3/4	248	23 1/2	597	105	48	

### SAAB

9000 4DR	84-97		22	20	16 1/4	413	33 1/2	851	130	59	4i
9000 5DR	84-98		22	20	16 1/4	413	33 1/2	851	130	59	4i

### SUZUKI

Swift 3DR	89-94		13	10	21 1/4	540	18 1/2	470	90	41	1c
Swift 3DR	89-94	✓	13	13	19	483	13 3/4	349	130	59	9o
Swift 4DR	89-94		12	11	11	279	24 3/4	629	90	41	
Swift 5DR	89-94		12	11	11	279	24 3/4	629	130	59	



2013 COMPLETE ROOF RACK SYSTEM - SR1004 - FIT GUIDE

Vehicle Make and Model	Year	3D Adapter A21116										
			Front	Rear	A		B		Weight Limit		Fit Tips	
					inch	mm	inch	mm	Lbs	Kg		

TOYOTA											
4Runner 5DR	90-02		27	27	11 3/4	298	27 1/2	699	90	41	
Corolla GTS 2DR	85-91		13	13	17 3/4	451	15	381	130	59	1c
Corolla GTS 2DR	85-91	✓	11	13	14 1/4	362	11 1/2	292	130	59	9o
Corolla SR5 2DR	85-91		13	13	17 3/4	451	15	381	130	59	1c
Corolla SR5 2DR	85-91	✓	11	13	14 1/4	362	11 1/2	292	130	59	9o
Pickup Xtra Cab	89-95		24	24	19 1/4	489	15 3/4	400	130	59	1c
Pickup Xtra Cab	89-95	✓	27	26	15 3/4	400	11 3/4	298	130	59	9o