



F-15/F-16A/F-16S/F-18
(FN65DA/FN65RHA/FN65RHS/FN55AX)

Fusion Cordless Finish Nailers

Operating Instructions

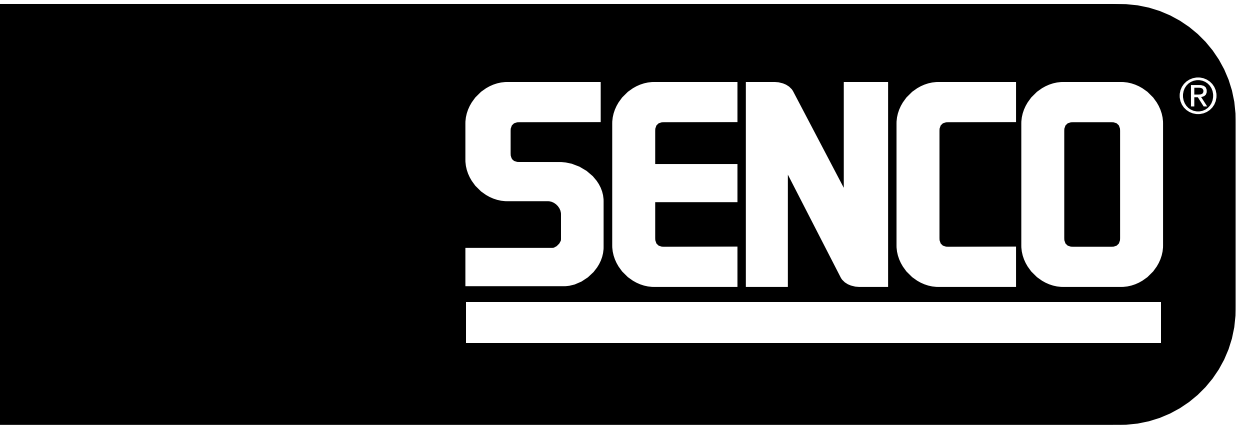

TABLE OF CONTENTS	
Employer's Responsibilities.....	2
Safety Warnings	3
Functional Description	14
Tool Operation	16
Maintenance	22
Battery Charger Label Reference.....	23
Battery Specifications	23
Charger Specifications	23
Technical Specifications	24
Fastener Specifications	25
Accessories	26
Troubleshooting	26
Limited Warranty.....	28



EMPLOYER'S RESPONSIBILITIES

Employer must enforce compliance with the safety warnings and all other instructions which accompany this tool as shipped from the manufacturer.

Keep this manual available for use by all people assigned to the use of this tool.

For personal safety and proper operation of this tool, read and understand all of these instructions carefully.

General Safety Rules (For all Battery Operated Tools)

SAFETY WARNINGS



Warning!

- **Read all safety warnings and instructions.** Failure to follow the warnings and instructions may result in electric shock, fire and/or serious personal injury.
- **Save all warnings and instructions for future reference.** The term "power tool" in the warnings refers to your mains-operated (corded) power tool or battery-operated (cordless) power tool.

Work Area Safety

- **Keep work area clean and well lit.** Cluttered or dark areas invite accidents.

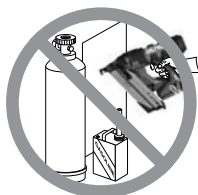
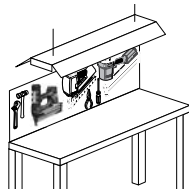

- **Do not operate power tools in explosive atmospheres, such as in the presence of flammable liquids, gases, or dust.** Power tools create sparks which may ignite the dust or fumes.



- **Keep children and bystanders away while operating a power tool.** Distractions can cause you to lose control.

Electrical Safety

- **Power tool plugs must match the outlet. Never modify the plug in any way. Do not use any adapter plugs with earthed (grounded) power tools.** Unmodified plugs and matching outlets will reduce risk of electric shock.

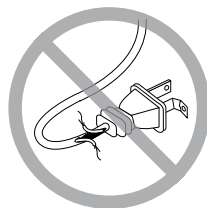

- **Avoid body contact with earthed or grounded surfaces such as pipes, radiators, ranges and refrigerators.** There is an increased risk of electric shock if your body is earthed or grounded.



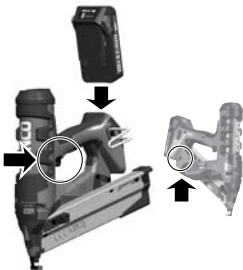
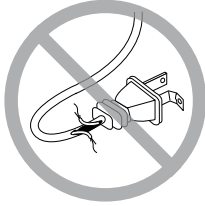

SAFETY WARNINGS

- **Do not expose power tools to rain or wet conditions.** Water entering a power tool will increase the risk of electric shock.
- **Do not abuse the cord. Never use the cord for carrying, pulling or unplugging the power tool. Keep cord away from heat, oil, sharp edges or moving parts.** Damaged or entangled cords increase the risk of electric shock.
- **When operating a power tool outdoors, use an extension cord suitable for outdoor use.** Use of a cord suitable for outdoor use reduces the risk of electric shock.
- **If operating a power tool in a damp location is unavoidable, use a residual current device (RCD) protected supply.** Use of an RCD reduces the risk of electric shock.

Personal Safety

- **Stay alert, watch what you are doing, and use common sense when operating a power tool. Do not use a power tool while you are tired or under the influence of drugs, alcohol, or medication.** A moment of inattention while operating power tools may result in serious personal injury.
- **Use personal protective equipment. Always wear eye protection.** Protective equipment such as dust mask, no-skid safety shoes, hard hat, or hearing protection used for appropriate conditions will reduce personal injuries.
- **Prevent unintentional starting. Ensure the switch is in the off-position before connecting to power source and/or battery pack, picking up or carrying the tool.** Carrying power tools with your finger on the switch or energising power tools that have the switch on invites accidents.

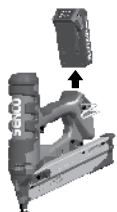
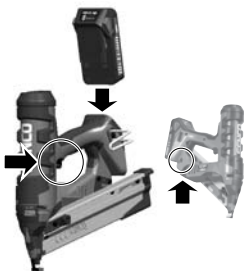

SAFETY WARNINGS

- **Remove any adjusting key or wrench before turning the power tool on.** A wrench or a key left attached to a rotating part of the power tool may result in personal injury.

- **Do not overreach. Keep proper footing and balance at all times.** This enables better control of the power tool in unexpected situations.

- **Dress properly. Do not wear loose clothing or jewelry. Keep your hair, clothing, and gloves away from moving parts.** Loose clothes, jewelry, or long hair can be caught in moving parts.

- **If devices are provided for the connection of dust extraction and collection facilities, ensure these are connected and properly used.** Use of dust collection can reduce dust-related hazards.

Power Tool Use and Care

- **Do not force the power tool. Use the correct power tool for your application.** The correct power tool will do the job better and safer at the rate for which it is designed.

- **Do not use the power tool if the switch does not turn it on and off.** Any power tool that cannot be controlled with the switch is dangerous and must be repaired.

- **Disconnect the plug from the power source and/or the battery pack from the power tool before making any adjustments, changing accessories, or storing power tools.** Such preventive safety measures reduce the risk of starting the power tool accidentally.

SAFETY WARNINGS



- **Store idle power tools out of the reach of children and do not allow persons unfamiliar with the power tool or these instructions to operate the tool.** Power tools are dangerous in the hands of untrained users.



- **Maintain power tools. Check for misalignment or binding of moving parts and any other condition that may affect the power tool's operation.** Many accidents are caused by poorly maintained power tools.

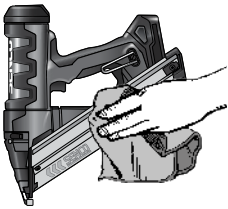

- **Keep cutting tools sharp and clean.** Properly maintained cutting tools with sharp cutting edges are less likely to bind and are easier to control.



- **Use the power tool, accessories and tool bits etc, in accordance with these instructions, taking into account the working conditions and the work to be performed.** Use of the power tool for operations different from those intended could result in a hazardous situation.

Battery Tool Use And Care



- **Recharge only with the charger specified by the manufacturer.** A charger that is suitable for one type of battery pack may create a risk of fire when used with another battery pack.

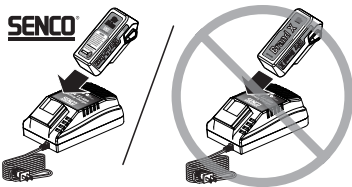

- **Use power tools only with specifically designated battery packs.** Use of any other battery packs may create a risk of injury and fire.

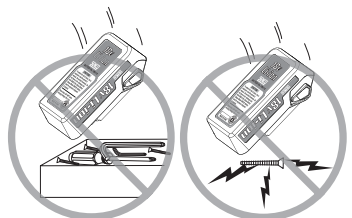

- **When battery pack is not in use, keep it away from other metal objects, like paper clips, coins, keys, nails, screws, or other small metal objects that can make a connection from one terminal to another.** Shorting the battery terminals together may cause burns or a fire.

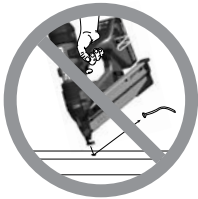
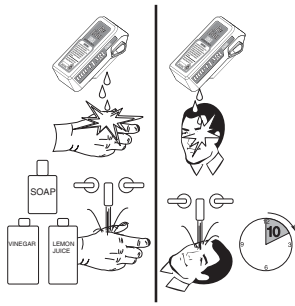

SAFETY WARNINGS

- Under abusive conditions, liquid may be ejected from the battery; avoid contact. If contact accidentally occurs, flush with water. If liquid contacts eyes, additionally seek medical help. Liquid ejected from the battery may cause irritation or burns.

Service

- Have your power tool serviced by a qualified repair person using only identical replacement parts. This will ensure that the safety of the power tool is maintained.

Safety instructions for tackers

Tacker Safety Warnings

- Always assume the tool contains fasteners. Careless handling of the tacker can result in unexpected firing of fasteners and personal injury.

- Do not point the tool towards yourself or anyone nearby. Unexpected triggering will discharge the fastener causing an injury.

- Do not actuate the tool unless the tool is placed firmly against the workpiece. If the tool is not in contact with the workpiece, the fastener may be deflected away from your target.

- Disconnect the tool from the power source when the fastener jams in the tool. While removing a jammed fastener, the tacker may be accidentally activated if it is plugged in.

- Use caution while removing a jammed fastener. The mechanism may be under compression and the fastener may be forcefully discharged while attempting to free a jammed condition.

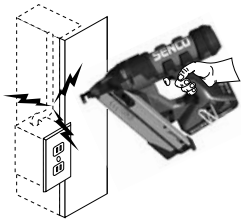

SAFETY WARNINGS

- **Do not use this tacker for fastening electrical cables.** It is not designed for electric cable installation and may damage the insulation of electric cables thereby causing electric shock or fire hazards.

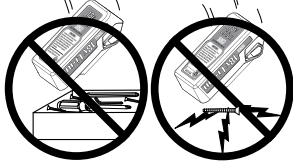

- A battery short can cause a large current flow, overheating, possible burns and even a breakdown.
 - ❑ Do not touch the terminals with any conductive material.
 - ❑ Avoid storing battery cartridge in a container with other metal objects such as nails, coins, etc.
 - ❑ Do not expose battery cartridge to water or rain.

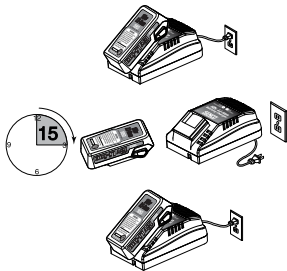

- Consecutive charging may cause overheating. If you need to re-charge batteries consecutively, wait about 15 minutes for the charger to cool.

Fusion

Additional Safety Instructions



- To prevent eye injuries, always wear OSHA required "Z87" safety glasses with permanently attached rigid, hard plastic side shields. These safety glasses must have "Z87" printed or stamped on them. Be sure everyone in your work area is wearing the same type of safety glasses.



DANGER:

- The Fusion tool is charged with compressed air in a factory sealed chamber. **DO NOT** attempt to open the air chamber supported within the tool housing.
- The driver assembly contains no user-serviceable parts. Major components such as the piston/driver assembly, gearbox, piston stop and guide body are all part of the drive assembly.
- Deliberate tampering with the drive assembly may result in the release of the driver.
- Any repair or upgrade requiring access to the pressure chamber should be handled by an authorized Senco dealer or service center.

SAFETY WARNINGS

- Disconnect tool from battery when:
 - ❑ Outside of the operator's supervision or control.
 - ❑ Performing maintenance or repair
 - ❑ Clearing a jam
 - ❑ Moving the tool to a new location

- With battery disconnected, make daily inspection to assure free movement of workpiece contact element and trigger. Do not use tool if workpiece contact element or trigger sticks or binds.

- Always remove finger from trigger when not driving fasteners. Never carry the tool with finger on or under trigger. Tool will eject a fastener if the workpiece contact element is bumped and the trigger is pulled.

- Drive fasteners into work surface only; never into materials too hard to penetrate.

- Do not drive fasteners on top of other fasteners or with the tool at too steep of an angle; the fasteners can ricochet and hurt someone.

- When using tool, care should be taken due to possibility of tool recoil after a fastener is driven. If workpiece contact element is unintentionally allowed to re-contact work surface following a recoil, an unwanted fastener may be driven. Therefore, allow tool to recoil completely off work surface after a fastener is driven to avoid this condition. Do not push workpiece contact element on work surface until a second fastener is desired.

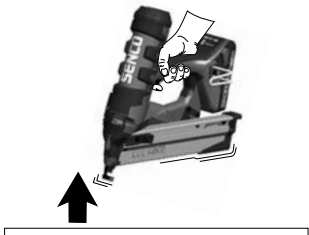
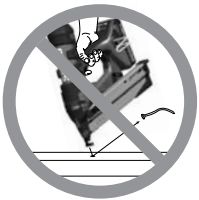
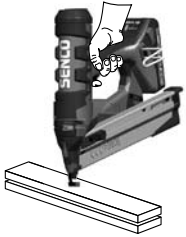
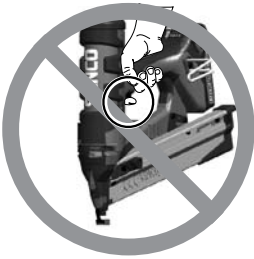

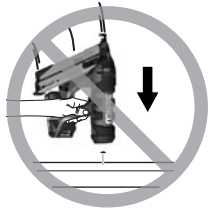
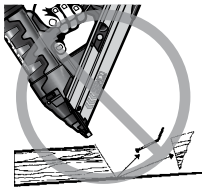

SAFETY WARNINGS

- Do not drive fasteners close to the edge of the work surface. The workpiece is likely to split and the fastener could fly or ricochet and hit someone.
- Never use any part of the tool (i.e., the cap or mainbody) as a hammer. The tool may activate or become damaged and result in an unsafe condition.
- Keep hands and other body parts away from the area shown in the circle to avoid possible injury during operation.
- Do not use tool without Danger Label on tool. If label is missing, damaged or unreadable, contact your Senco representative to obtain a new label at no cost.

Tool Use

- » Read tool manual
- » Lea el manual de la herramienta
- » Lisez le manuel d'outil
- » Wear eye protection
- » Use protección ocular
- » Verres de sûreté d'usage
- » Personal Injury
- » Lesiones personales
- » Blessures

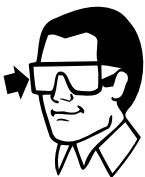

- Read and understand tool labels and manual. Failure to follow warnings could result in DEATH or SERIOUS INJURY.
- Operators and others in work area MUST wear safety glasses with side shields.
- Keep fingers AWAY from trigger when not driving fasteners, to avoid accidental firing.
- Choice of triggering method is important. See page 16 for triggering options.
- Never point tool at yourself or others in work area.

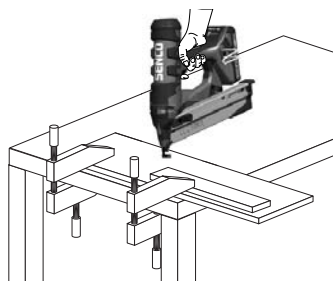

- Tools shall not be modified without written approval of the manufacturer.
- Use clamps or other practical ways to secure and support the workpiece to a stable platform. Holding the work by hand or against your body is unstable and may lead to loss of control.

SAFETY WARNINGS

Battery Use

ADDITIONAL SAFETY RULES FOR CHARGER & BATTERY CARTRIDGE

SAVE THESE INSTRUCTIONS

- This manual contains important safety and operating instructions for Senco battery charger VB0120 (US) and VB0131 (AUS/NZ). Use with approved Senco batteries stated on the charger label.
- Before using Senco battery charger VB0120 (US) and VB0131 (AUS/NZ), read all instructions and cautionary markings on (1) battery charger, (2) battery, and (3) product using battery.

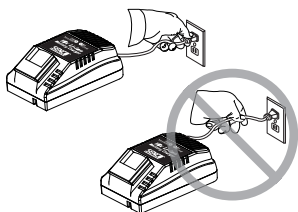
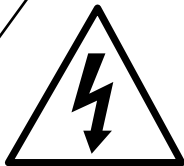

- Do not expose charger to water, rain, or snow.

- Use indoors.

- Use of an attachment not recommended or sold by the battery charger manufacturer may result in a risk of fire, electric shock, or injury to persons.

- To reduce risk of damage to electric plug and cord, pull by plug rather than cord when disconnecting charger.

- Make sure cord is located so that it will not be stepped on, tripped over, or otherwise subjected to damage or stress.

Length of Cord (Feet)			
25	50	100	150
16	16	16	14

Largo del Cable (m [pies])			
7,5	15	30	45
16	16	16	14

Longueur du Cordon (en m)			
7,5	15	30	45
16	16	16	14

Taille AWG du Cordon			
----------------------	--	--	--

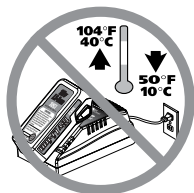
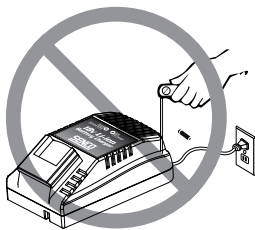
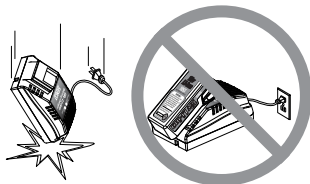
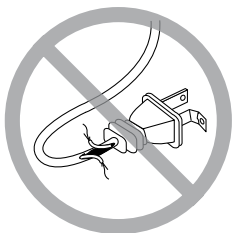

SAFETY WARNINGS

RECOMMENDED MINIMUM AWG SIZE FOR EXTENSION CORDS FOR BATTERY CHARGERS

- An extension cord should not be used unless absolutely necessary. Use of improper extension cord could result in a risk of fire and electric shock.
- If extension cord must be used, make sure:
 - That pins on plug of extension cord are the same number, size, and shape as those of plug on charger;
 - That extension cord is properly wired and in good electrical condition; and
 - That wire size is at least as large as the one specified in the table.

- Do not operate charger with damaged cord or plug. If damaged, have replaced immediately by a qualified serviceman.

- Do not operate charger if it has received a sharp blow, been dropped, or otherwise damaged in any way; take it to a SENCO Authorized Service Center.

- Do not disassemble charger or battery cartridge; take it to a SENCO Authorized Service Center when service or repair is required. Incorrect reassembly may result in a risk of electric shock or fire.

- To reduce risk of electric shock, unplug charger from outlet before attempting any maintenance or cleaning.

- Do not charge battery cartridge when temperature is BELOW 0°C (32°F) or ABOVE 40°C (104°F).

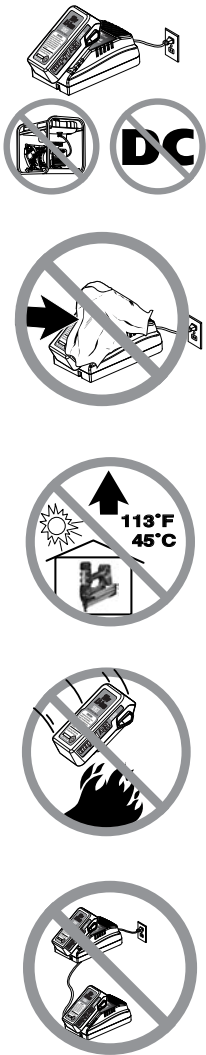

SAFETY WARNINGS

- Do not attempt to use a step-up transformer, an engine generator or DC power receptacle.
- Do not recharge non-rechargeable batteries.

- Do not allow anything to cover or clog the charger vents.

- Do not store the tool and battery cartridge in locations where the temperature may reach or exceed 45°C (113° F).

- Do not incinerate the battery cartridge even if it is severely damaged or is completely worn out. The battery cartridge can explode in a fire.

- Never attempt to connect two (2) chargers together.

- This appliance is not intended for use by young children or infirm persons unless they have been adequately supervised by a responsible person to ensure that they do not play with the appliance.
- This appliance is not intended for use by persons (including children) with reduced physical, sensory or mental capabilities, or lack of experience and knowledge, unless they have been given supervision or instruction concerning use of the appliance by a person responsible for their safety. Children should be supervised to ensure that they do not play with the appliance.

SAFETY

⚠ WARNING

This product contains chemicals, including lead, known to the State of California to cause cancer, and birth defects or other reproductive harm.
Wash hands after handling.

Angled Tool

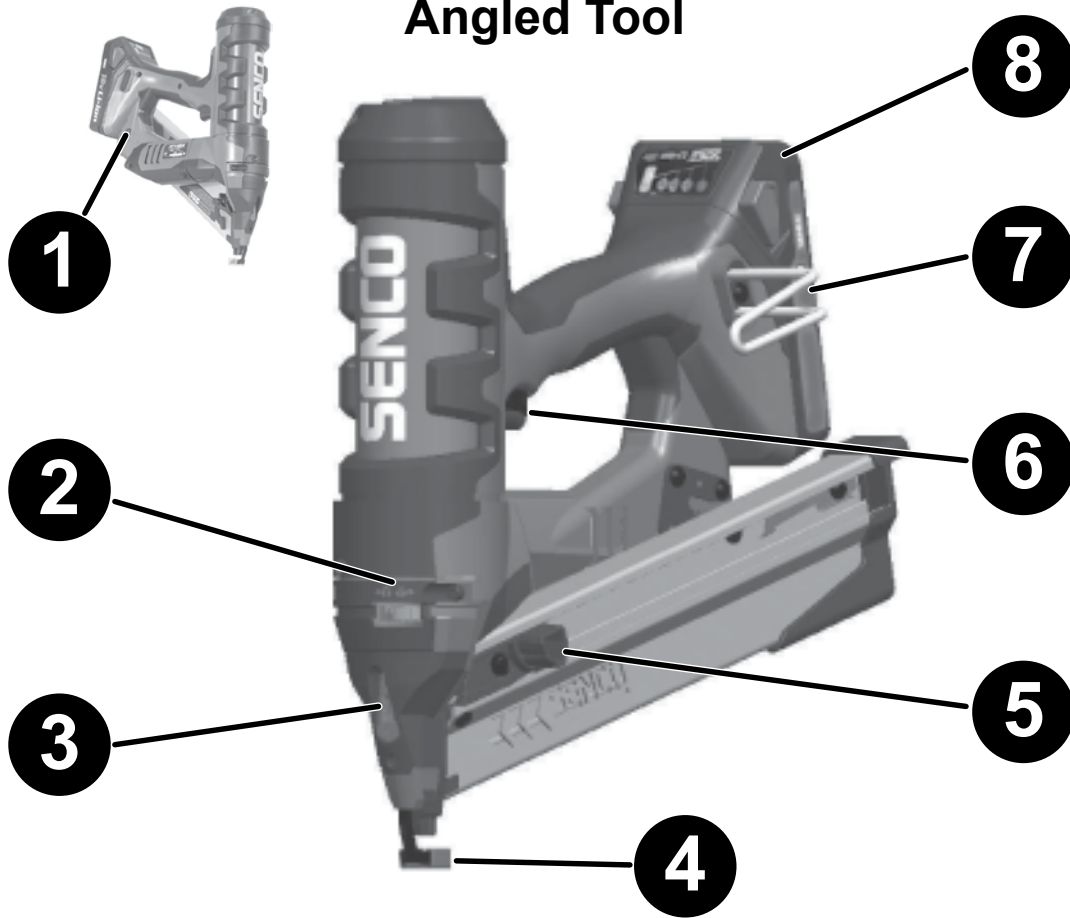

- ❶ On/Off and Selective Actuation Button
- ❷ Depth of drive control
- ❸ Workpiece Illumination/ Status Indicator
- ❹ Workpiece contact (safety) element
- ❺ Feeder shoe
- ❻ Trigger / On Switch
- ❼ Belt Hook
- ❽ Battery Pack

Loading the tool:

- Insert strip of nails into rear of magazine.
 - ❑ Use only genuine Senco fasteners (see Fastener Specifications).
 - ❑ **Do not load with workpiece contact (safety element) or trigger depressed.**
- Pull feeder shoe back.

Unloading the tool:

- Push Button on feeder shoe to release feeder from strip. Pull fastener strip out past sheet metal nail detainer.

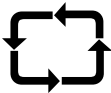
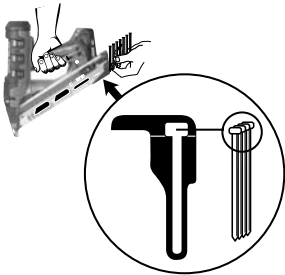

Straight Tool

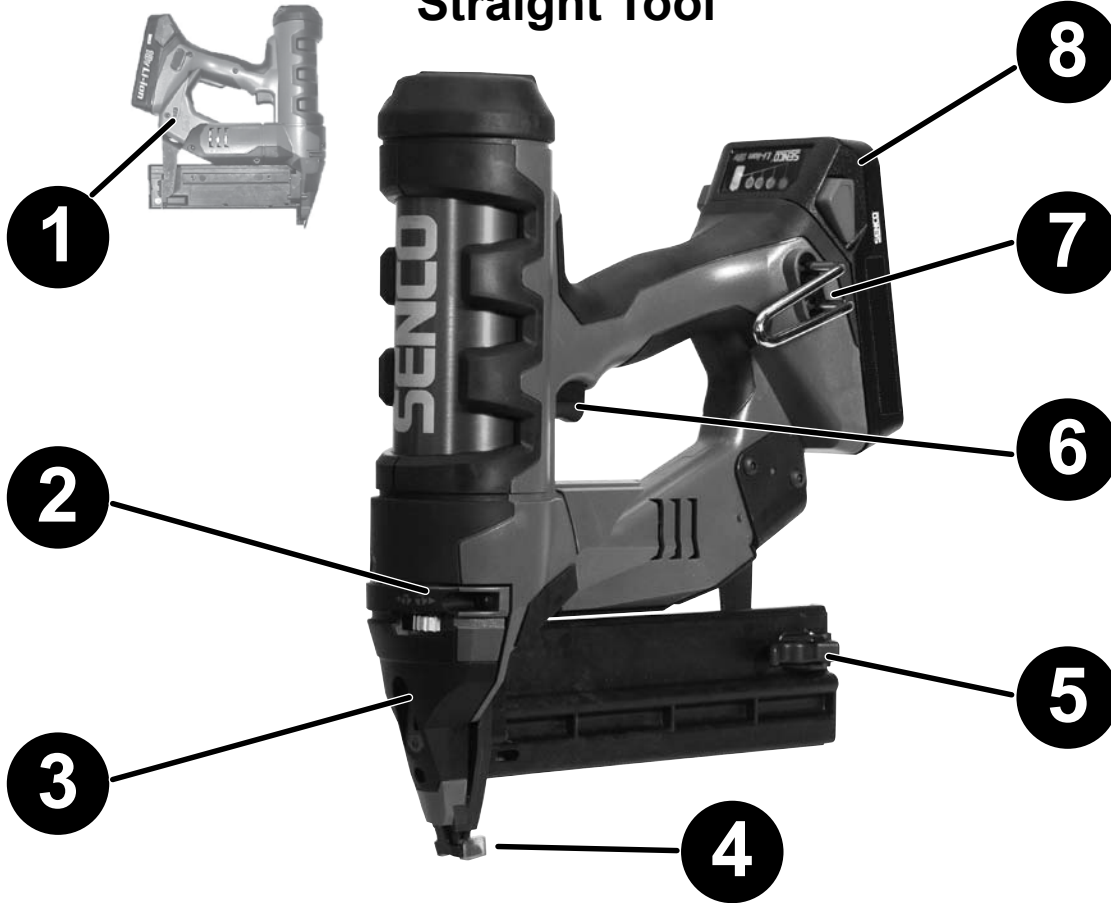

- ❶ On/Off and Selective Actuation Button
- ❷ Depth of drive control
- ❸ Workpiece Illumination/ Status Indicator
- ❹ Workpiece contact (safety) element
- ❺ Magazine Latch
- ❻ Trigger/On Switch
- ❼ Belt Hook
- ❽ Battery Pack

Loading the tool:

- Pull magazine latch back to open access door. Load strip of fasteners with points resting on fastener guide and then push the door back toward the front of the tool. An audible click will indicate that the strip is properly loaded.

Unloading the tool:

- Pull magazine latch back to open access door. Grasp fastener strip and remove.



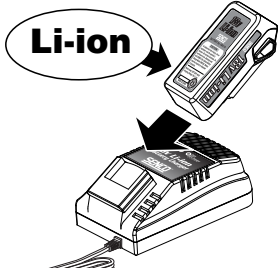
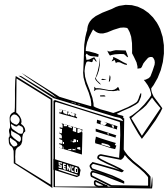

- » Indicator LED OFF
- » LED indicador- Apagado
- » Voyant DEL- éteint

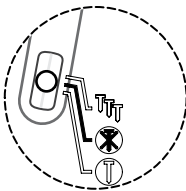

- » Indicator LED ON – Flashing
- » LED indicador- Encendido y titilando
- » Voyant DEL- clignotant

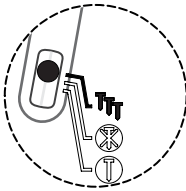

- » Indicator LED ON Solid
- » LED indicador- En modo secuencial sólido
- » Voyant DEL- non clignotant

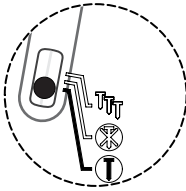

TOOL OPERATION

- Read section titled “Safety Warnings,” before using tool.
- For best results, charge new battery before using. (see “To Charge Battery” page 20).
- The tool should be switched off when not in use. Hold down either side of the selector switch for 1 second to turn the tool off. If left on, the tool will automatically turn off after 35 minutes.
- All Fusion tools are equipped with selective-actuation triggering. This allows the user to choose between the following modes of operation:

Contact Actuation

- Pressing the side of the selector switch toward the  symbol (as shown) for 0.5 sec. will turn the tool on in contact-actuation mode. This is indicated by the flashing green LED of the selector switch.

Sequential

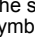
- Pressing the side of the selector switch toward the  symbol (as shown) for 0.5 sec. will turn the tool on in sequential mode. This is indicated by the solid green LED of the selector switch.

TOOL OPERATION

- In the "contact-actuation" mode, nails can be driven in two ways:

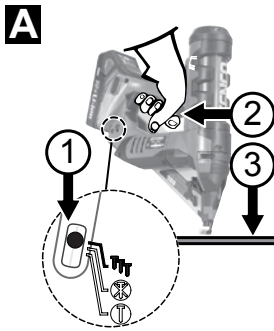

- A** The first way:
- ① Press the  side of the selector switch. This will be indicated by the flashing green LED on the selector switch.
 - ② Press the workpiece contact (safety) element against the work surface.
 - ③ Pull the trigger and the fastener is driven.

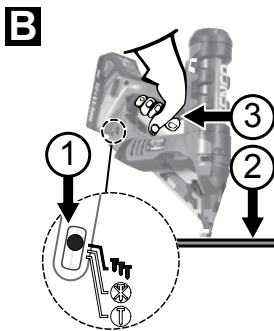

- B** The second way:
- ① Press the  side of the selector switch for 0.5 seconds. This will be indicated by the flashing green LED on the selector switch.
 - ② Pull trigger.
 - ③ Depress workpiece contact element against work surface and drive a fastener.
- This mode of operation is preferred when you desire high production, rapid fastener placement.

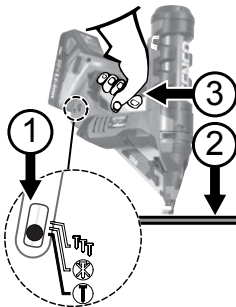

- In the "sequential-actuation" mode, nails can only be driven one way:

 - ① Press the  side of the selector switch. This will be indicated by the solid green LED on the selector switch.
 - ② Position workpiece contact (safety) element against work surface and depress the safety.
 - ③ Pull trigger to turn on the motor and drive a fastener.

 - This mode of operation is helpful when you require precise fastener placement.



- The Fusion tool may retract the driver partially when the battery charge is very low. If this happens, place a freshly charged battery on the tool, depress the safety and trigger to allow it to automatically adjust to position the driver correctly. The self adjustment will sound like a series of short pulses; this is normal and it is not caused by any defect in the tool.
- Once the tool resets, it will function normally.

TOOL OPERATION

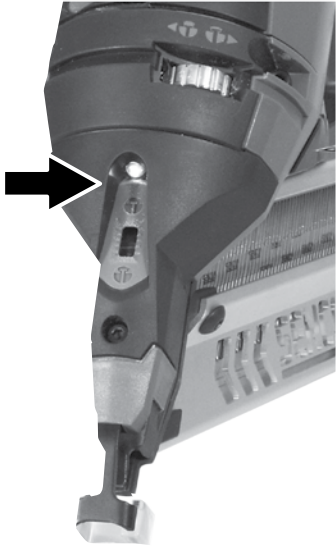

- This tool is equipped with a dual-purpose light on the nosepiece. The light will indicate that the electronic controls are energized while providing illumination of the workpiece in low light situations. The light will flash three times when the selection switch is switched to either sequential or contact actuation. This lets the user know that the tool is ready to fire a fastener. The light will remain on for ten seconds when the trigger is pulled or the work contact element is depressed.

Note:

- When the tool is in the *sequential mode*, a fastener cannot be driven by pulling the trigger before activating the work piece contact element.
- When the tool is in *contact actuation mode*, if the operator holds the trigger on for more than 3 seconds, the light will go out and the trigger must be released to start over.

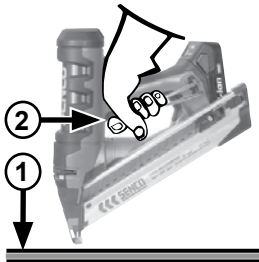
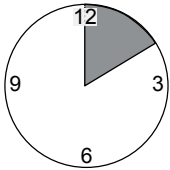

- This tool is equipped with an electronic "Time-Out" feature. This tool will temporarily be disabled under any of the following conditions:
 - ① Workpiece contact element is depressed against the work piece, but the trigger is not pressed within approximately 10 seconds.
 - ② Trigger is pressed, but work piece contact element is not depressed within approximately 3 seconds. (Contact-Actuation mode only.)
- Simply release trigger and release workpiece contact element to resume normal operation.



- The 15ga and 16ga tools are equipped with a **fastener lock-out**; the tool will not fire the last 3-5 fasteners. The 18ga tool is equipped with a **last fastener lockout**. This feature prevents unnecessary wear on the tool. When the tool locks out, load an additional strip and continue.



- This tool is equipped with depth-of-drive dial. Turning the dial to the right will countersink the fastener, turning the dial to the left will leave the fastener up or raised. Drive a fastener into a scrap piece of wood to test depth.

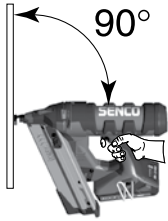
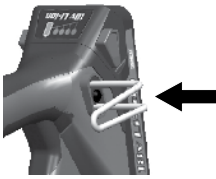

- » Indicator LED OFF
- » LED indicador Apagado
- » Voyant DEL-éteint

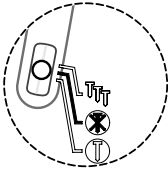

TOOL OPERATION

- This tool is equipped with an adjustable belt hook. Remove the knurled fastener to raise or lower the hook. Switch the position of the mounting plate on the opposite side for left-handed operators.

- Whenever possible, hold the tool at a right angle to the work surface.

- Always turn the tool off before storing. As an added protection feature, the tool will automatically turn off 35 minutes after the last activation.

Should a nail jam occur

- Turn the tool off by depressing the selector switch towards either mode symbol for approximately 1 second, then remove battery.
- Wear safety glasses when opening the E-Z clear latch.

Angled Tool

- Release the feeder shoe and slide it forward. Remove fasteners from the tool.
- Release E-Z Clear latch and pull magazine away. Magazine will completely disengage.

Straight Tool

- Pull magazine door latch back to reveal fastener strip.
- Remove strip.

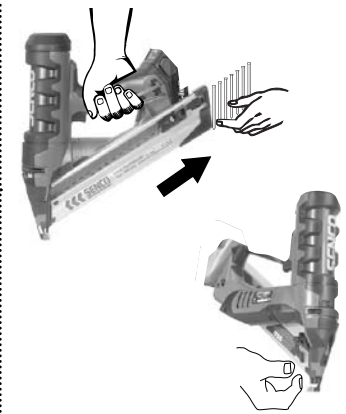

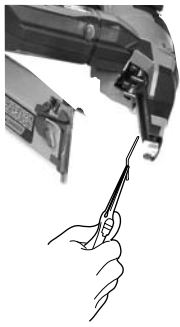

TOOL OPERATION

- Remove jammed fastener. Attach the magazine and latch.
- Remember! The Fusion tool is charged with compressed air in a factory sealed chamber.
- Do not tamper with the drive assembly.

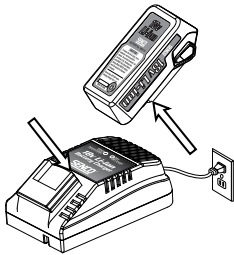

To Charge Battery

- Place battery pack in charger. Align raised ribs on battery pack with groove in charger.



- Press down on battery pack to be sure contacts on battery pack engage properly with contacts in charger.
- When properly connected, red light will turn on. Red light indicates fast charging mode.

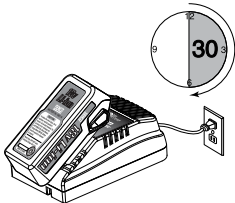

- Red and green light flashing indicates defective battery pack. Return battery pack to your nearest Senco Authorized Service Center for inspection or replacement.
- Flashing Red indicates an over-heated battery. Charging will begin after battery cools.

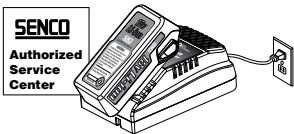

- Solid red indicates that the battery is charging.
- When battery pack is fully charged, the red light will turn off and the green light will turn on.

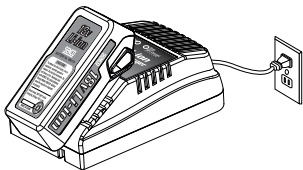

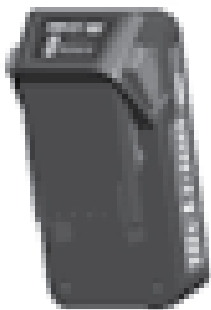
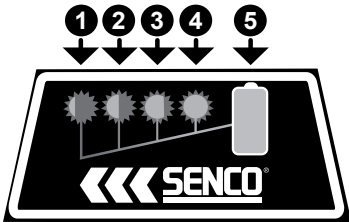
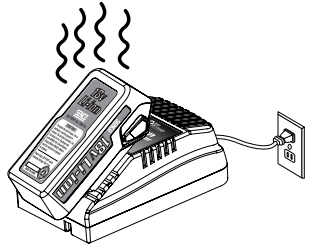
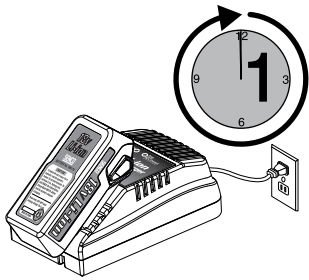

TOOL OPERATION

- After normal usage, 45 minutes of charge time is required to be fully charged. A maximum charge time of 1 hour or less is required to recharge a completely discharged battery pack.
- Maintenance charge is indicated when the red light turns off while the green light flashes.

- The battery pack will become slightly warm to the touch while charging. This is normal and does not indicate a problem.

- Battery is constructed with 4 LED lights built into a panel on the battery pack. These 4 LEDs reveal the state of charge and indicate possible problems inside the battery pack.

- ❶ Red
- ❷ Yellow
- ❸ Green 1
- ❹ Green 2
- ❺ Push-button

State of Charge:

- Press raised green button on battery pack ❺ to check charge.
- ❶ Flashing = 0-15% charge
- ❶ On = 16-25% charge
- ❶ ❷ On = 26-50% charge
- ❶ ❷ ❸ On = 51-75% charge
- All On = 76-100% charge

Tips for Maintaining Maximum Battery Life

- Charge the battery pack before it is completely discharged. Always stop tool operation and charge the battery when you notice less tool power.
- Never recharge a fully charged battery cartridge. Overcharging shortens the battery service life.
- Charge the Lithium-ion battery cartridge after 4-6 months from previous charge.



Li-Ion



TOOL OPERATION

Battery Disposal

- To preserve natural resources, please recycle or dispose of properly.
- This product contains Li-ion. Local state or federal laws may prohibit disposal of Li-ion batteries in ordinary trash. Consult your local waste authority for information regarding available recycling and/or disposal options.
- For more information on battery recycling call 1-800-8BATTERY.

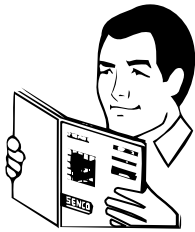

MAINTENANCE

WARNING

- Repairs other than those described here should be performed only by trained, qualified personnel. Contact SENCO for information at: 1-800-543-4596.

- Read section titled "Safety Warnings" before maintaining tool.

- The employer and tool operator are responsible for assuring that the tool is kept in safe working order as described in the tool operating/safety instructions.



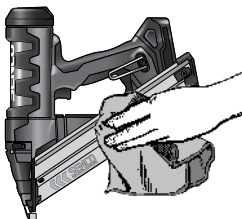

- With battery disconnected, make daily inspection to assure free movement of workpiece contact element and trigger. Do not use tool if workpiece contact element or trigger sticks or binds.

- Routine lubrication is not necessary. Do not oil.

- Wipe tool clean daily and inspect for wear. Use non-flammable cleaning solutions only if necessary.
- **DO NOT SOAK.**
- **Caution:** Such solutions may damage other tool parts.

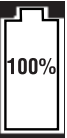

BATTERY CHARGER LABEL REFERENCE

MODE	CHARGER LABEL ICON	BATTERY PACK INSERTED?	RED LIGHT GREEN LIGHT
<i>Standby</i>	--	No	OFF OFF
<i>Evaluate</i>	Evaluating / HOT	Yes	Flash OFF
<i>Charging</i>		Yes	ON OFF
<i>80% Charge</i>		Yes	ON Flash
<i>Fully Charged</i>		Yes	OFF ON
<i>Maintenance</i>	--	Yes	OFF Flash
<i>Defective</i>		Yes	Flash Flash

BATTERY SPECIFICATIONS

Gen 1	**Gen 2
VB0118 (US)	*VB0155 (US)
VB0129 (EU)	VB0160 (EU)
1 AHr	1.5 AHr
Li-ION	Li-ION
6 — Cells/Elementos/Éléments	5 — Cells/Elementos/Éléments
18V	18V

*Requires Gen 2 Charger

CHARGER SPECIFICATIONS

Gen 1	**Gen 2
VB0120 (US)	VB0156 (US)
VB0130 (EU)	VB0157 (EU)
VB0131 (AU)	VB0158 (AU)
VB0132 (UK)	VB0159 (UK)

** • Gen 2 Charger will charge all SENCO Li-Ion batteries

	F-15 / FN65DA	F-16-A / FN65RHA	F-16S / FN65RHS	F-18 / FN55AX
TECHNICAL SPECIFICATIONS				
Voltage	18 volts Li-ion	18 volts Li-ion	18 volts Li-ion	18 volts Li-ion
Weight	6.2 lbs. (2.81 kg)	6.2 lbs. (2.81 kg)	6 lbs. (2.72 kg)	6 lbs. (2.72 kg)
Height	13" (330 mm)	13" (330 mm)	13" (330 mm)	13" (330 mm)
Length	13" (330 mm)	13" (330 mm)	11" (276 mm)	11" (276 mm)
Width	3" (76 mm)	3" (76 mm)	3" (76 mm)	3" (76 mm)
Recharge Time	45 minutes	45 minutes	45 minutes	45 minutes
Fastener Capacity	110 15 Ga. Nails	110 16 Ga. Nails	110 15 Ga. Nails	110 18 Ga. Nails
Fastener Range	.75"-2.50" Length	1.25"-2.50" Length	1.25"-2.50" Length	.62"-2.12" Length
Collation Angle	34°	20°	0°	0°

FASTENER SPECIFICATIONS

F15 / FN65A

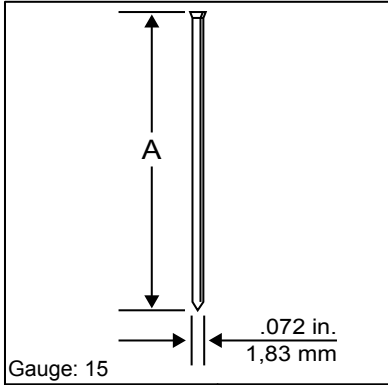

SENCO Fastener Code	A	
	inches	mm
DA15	1-1/4	32
DA17	1-1/2	38
DA18	1-5/8	41
DA19	1-3/4	45
DA21	2	50
DA23	2-1/4	57
DA25	2-1/2	64

F16-A / FN65RHA

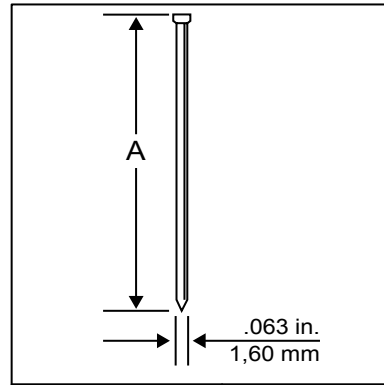

SENCO Fastener Code	A	
	inches	mm
RHA15	1-1/4	32
RHA17	1-1/2	38
RHA19	1-3/4	45
RHA21	2	50
RHA23	2-1/4	57
RHA25	2-1/2	65

F16-S / FN65RHS

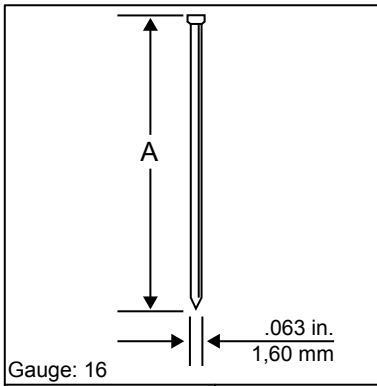

SENCO Fastener Code	SENCO Fastener Code	A	
		inches	mm
M001002	A401259	1-1/4	32
M001003	A401509	1-1/2	38
M001004	A401759	1-3/4	45
M001005	A402009	2	50
M001007	A402509	2-1/2	65

F18 / FN55AX

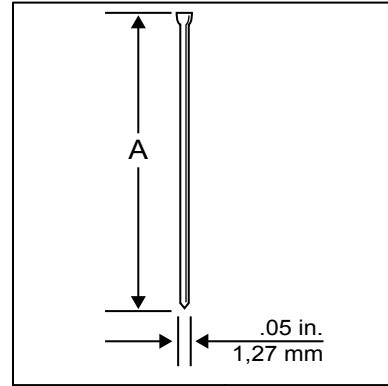

SENCO Fastener Code	A	
	inches	mm
AX10	5/8	16
AX11	3/4	19
AX13	1	25
AX15	1-1/4	32
AX17	1-1/2	38
AX18	1-5/8	41
AX19	1-3/4	45
AX21	2	50
AX22	2-1/8	54

ACCESSORIES

SENCO offers a full line of accessories for your SENCO tools, including:

- Battery
- Belt Hook
- Battery Charger
- Case
- Safety Glasses

For more information or a complete illustrated catalogue of SENCO accessories, ask your representative for #MK336.

TROUBLESHOOTING		
Problem or Symptom	Probable Cause	Corrective Action
• Tool will not start or runs slowly.	<ul style="list-style-type: none"> • Battery is discharged or has dead cell. • Workpiece contact element is jammed • Workpiece contact element or trigger switches are damaged. 	<ul style="list-style-type: none"> • Replace or recharge battery. • Remove battery, then inspect tool to assure free movement of workpiece contact element. • Return tool to authorized SENCO service representative.
• Tool does not drive fastener to desired depth.	<ul style="list-style-type: none"> • Improper depth-of drive setting. • Tool not pressed firmly against the workpiece. • Drive application is too rigorous. 	<ul style="list-style-type: none"> • Refer to operators manual for proper adjustment. • Hold tool firmly in place when driving fastener. • Refer to operators manual for appropriate applications.
• Tool runs but will not drive fastener.	<ul style="list-style-type: none"> • Battery is discharged or has a dead cell. • Nail jam in guidebody. • Mechanism requires adjustment. • Tool is overheated. • Driver tip not located above fastener. 	<ul style="list-style-type: none"> • Recharge or replace with fresh battery. • Refer to operators manual for jam-clearing instructions. • Return tool to authorized SENCO service representative. • Allow tool to cool and insert fresh battery. • Recharge battery and allow tool to automatically retract driver.
• Poor feed/ tool jamming.	<ul style="list-style-type: none"> • Debris build-up in mechanism. • Driver tip not located above fastener. 	<ul style="list-style-type: none"> • Clean tool, lubricate magazine or install Parts Kit
• Broken or worn driver.		<ul style="list-style-type: none"> • Return tool to authorized SENCO service representative.
• Tool does not fully return.	<ul style="list-style-type: none"> • Weak battery. 	<ul style="list-style-type: none"> • Recharge battery and allow tool to automatically retract driver.

Ensuring the Long Life of Your Cordless Finish Tool

Welcome to SENCO's family of products. SENCO brings 50 years of commitment to our customers and to power fastening systems. We are dedicated to making sure your tools are performing at their best, and we understand that ensuring the long life of your tools is important. Here are some operational and service tips.

- Start with fully charged batteries at the beginning of each work day.
- Set the depth of drive on your SENCO tool so fasteners are not over-driven.
- To maximize battery life, follow storage recommendations and charging recommendations in this manual.
- Keep your Cordless Finish Tool as clean and free of debris as possible.
- Service your SENCO tool periodically to insure your tool is productive and helping you earn money on the job. See the service guide below for recommended service intervals.

If your Cordless Finish Tool does require service, dedicated SENCO servicing dealers are available for you. For the location nearest you, call SENCO's Action line at 1-800-543-4596 or visit SENCO's website (www.senco.com).

Recommended Service Includes

- Check Electrical System
- Check Feed System
- Check Drive Track