

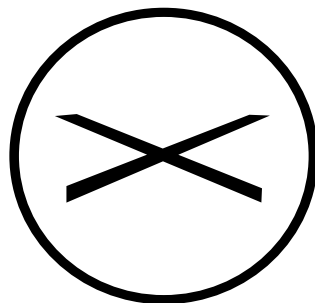

HELMETS FOR LIFE

SWITZERLAND



THE  
WHEEL



## INSTRUCTION MANUAL

Please read this manual very carefully before wearing your helmet and keep it in a safe place. For a correct use and your safety, please pay attention to following instructions. The main function of helmet is to protect your head in case of impact. This helmet is made to absorb some of the energy of a blow by partial destruction of it's component parts and, even though damage may not be apparent, any helmet which has suffered an impact in an accident or received a similarly severe blow or other abuse should be replaced. To maintain the full efficiency of this helmet, there must be no alteration to the structure of the helmet or it's component parts.

FOR BETTER UNDERSTANDING



**LEFT SIDE**



**RIGHT SIDE**

HOW TO USE THE VENTILATIONS?

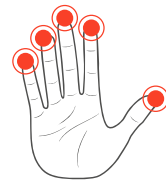

**1** MOVEMENT  
**5** VENTILATIONS OPEN

## HOW TO USE THE SUN VISOR?

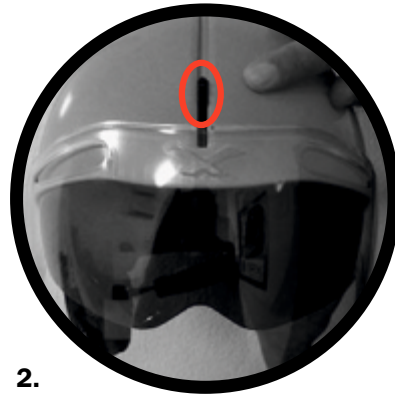
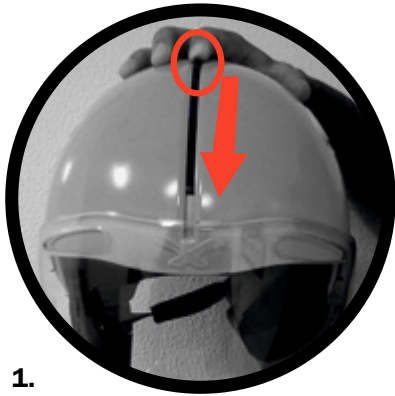

OR



## HOW TO PUT IN THE SIDE BUTTON?



## HOW TO CHANGE THE COVER?

REMOVE

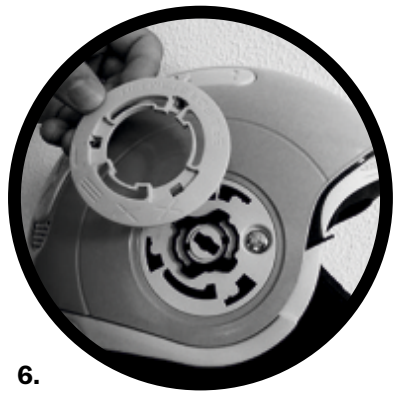
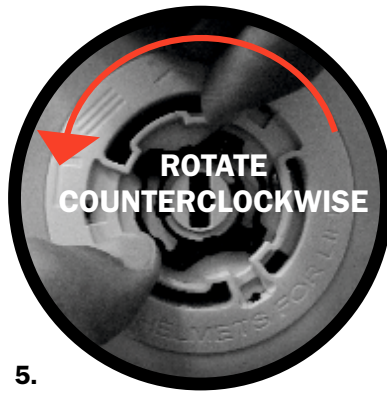

PUT IN

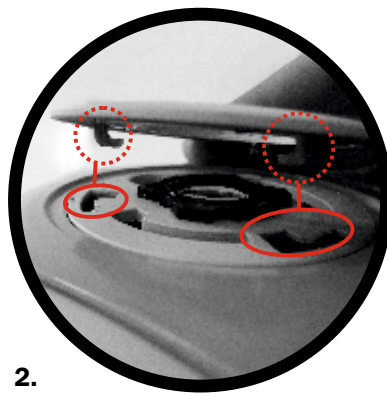

This high quality helmet is made with the most advanced European technology. The helmets are produced for the protection of motorcyclists. The helmets are designed for motorcycle riding only. The specifications of this helmet are subject to change without notice.

HOW TO CHANGE THE SUN VISOR?

REMOVE



PUT IN

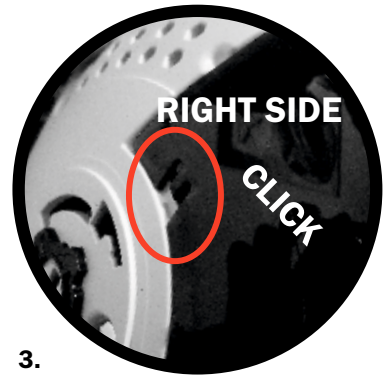
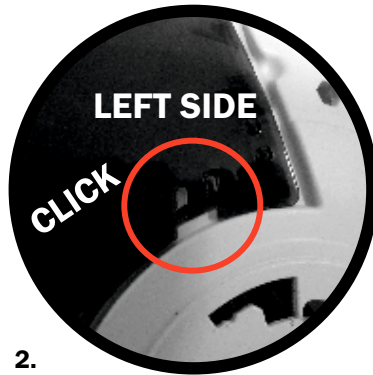

**REMOVE**

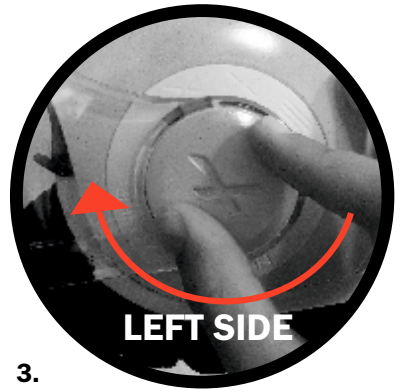
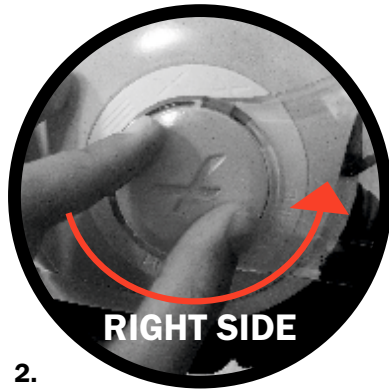

**PUT IN**

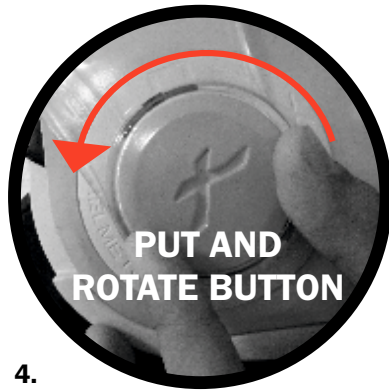
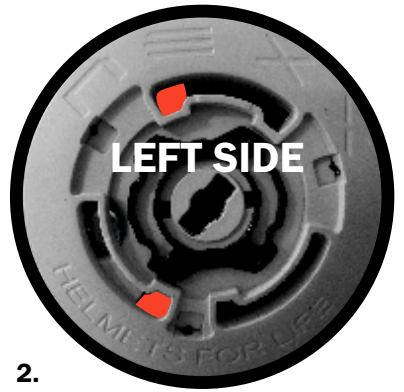
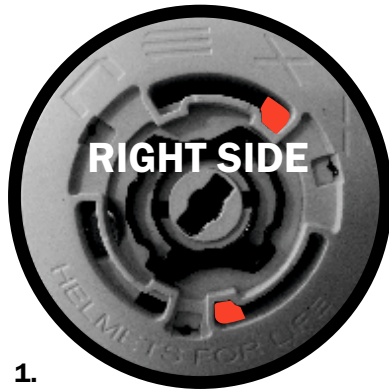

## HOW TO CLEAN THE VISOR?

To clear the Visor without affecting its characteristics use only warm, soapy water (preferably distilled) and soft, lint-free cloth. If the helmet is very dirty (e.g. covered in insect remains) you may add a little washing-up liquid to the water to clean the shell. Remove the Visor from the helmet before carrying out a deeper cleaning.

## SPECIFIC CARE



DO NOT EXPOSE THE HELMET TO ANY TYPE OF LIQUID SOLVENT;

Light colors require extra care as they are naturally more exposed to dust, fumes, compounds or other types of impurities.



