



*FF 100 / FF 200 / FF 300*

*Mounting Instructions*  
*Driving lamps*



Kit includes (with sets)

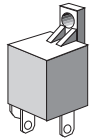
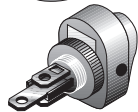
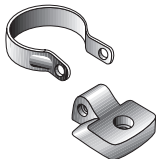

11 x 

4 x 

4 x 

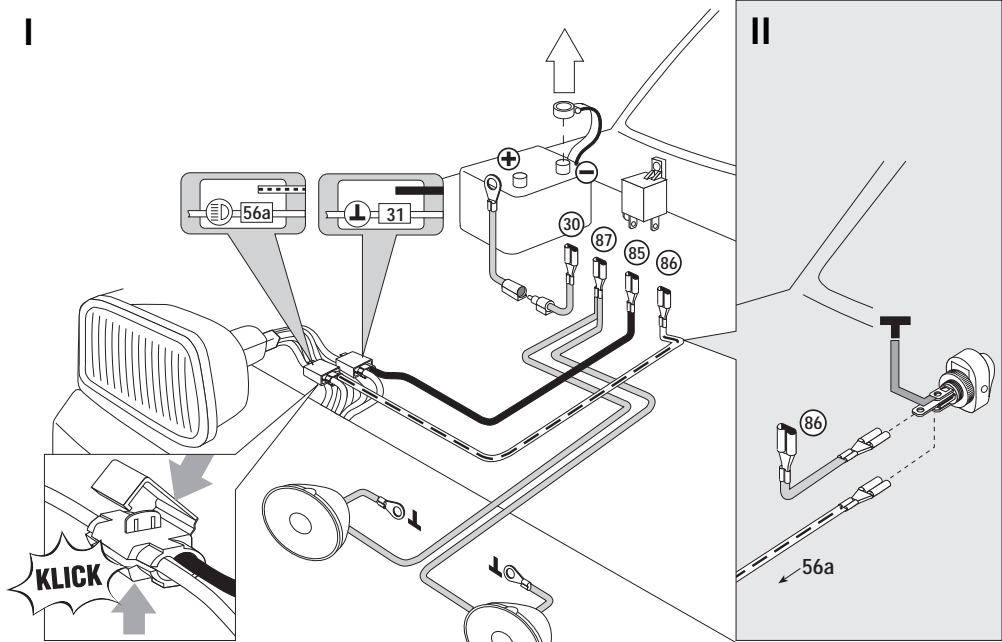
**I**

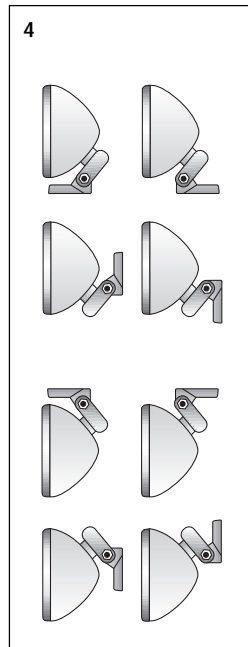
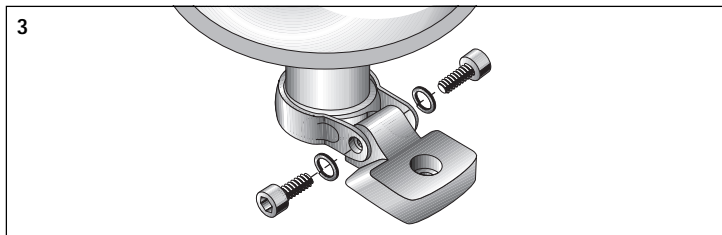
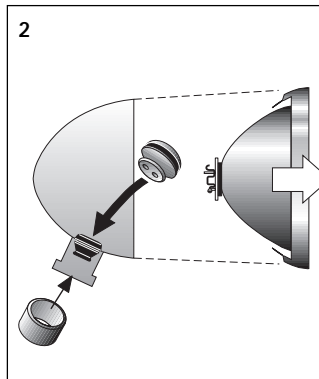
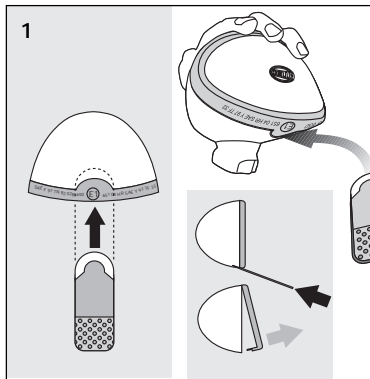

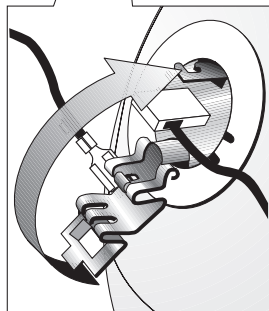
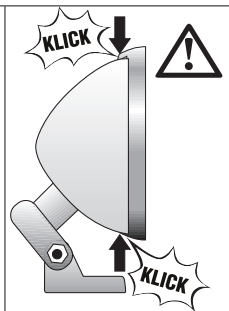
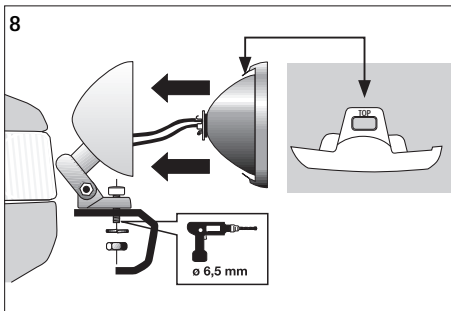
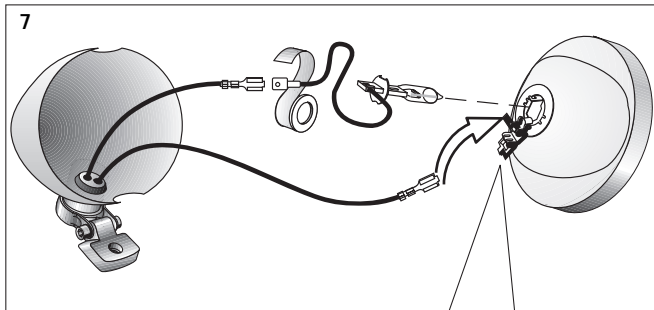
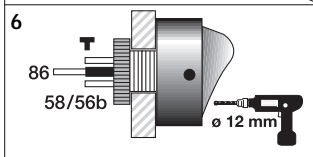
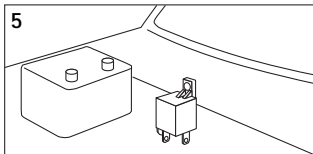

## Accessories

8 HG 116 741-801

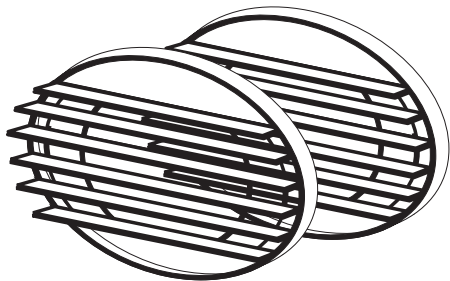
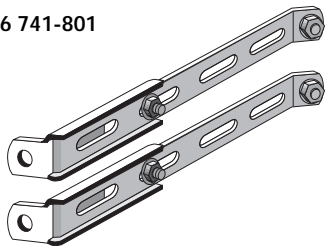

8 KA 002 309-811

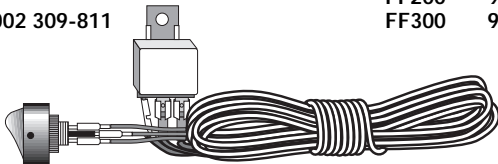

FF100	9HG 150 260-001
FF200	9HG 150 259-001
FF300	9HG 150 261-001

Subject to alteration without  
notice

## Accessories, see Fig. page 6

(not included with kit)

1. Two-point mount
2. Wiring harness with relay
3. Protective grille

## Tools required:

- Ruler
- Combination pliers
- 10 mm open end or box wrench
- 5 mm Allen Keys
- Drill with 3/ 6,5/ 12 mm dia. bits
- Insulating tape

## Mounting steps:

### Please Note:

For a satisfactory paint finish, please have the headlamp housing (material PC) painted in a specialist paint shop.

For mounting pendant/upright above or below bumper. Lamp should not vibrate or extend above the bonnet and must be attached symmetrically.

1. Determine mounting position and mark mounting points.
2. Drill pilot hole with 3 mm dia. bit and then bore out to 6,5 mm. Protect drilled metal parts with rust protection paint.

3. Remove lamp set, press rubber grommet in from inside and install stabilization ring (Fig.1; 2).

4. Preinstall bracket (Fig. 3) and assemble with housing depending on desired position (Fig. 4). Tighten bolts hand-tight.



## Electrical connection:

Install relay with connection terminals pointing downwards so that they are protected against splashing water (Fig. 5).

If required, install switch in dashboard: Either switch supplied with set or special switch for your vehicle (Fig. 6).

Disconnect earth lead (-) from battery for safety.

Lay and connect wires according circuit diagram (page 3).

According to circuit diagram I the auxiliary lamps are switched on together with the existing main beams.

According to circuit diagram II the auxiliary lamps can be switched on in addition to the main beams with a separate switch.

## Final installation:

1. Lay ends of wires to lamps, insert into lamp housing through rubber grommet and crimp on cable terminal (Fig. 7).

2. Install bulb (do not touch glass with bare fingers).

3. Connect wire to bulb connection and insulate. Attach earth lead to retaining spring.

4. **Arrest headlamp insert in housing in proper position (Fig. 8).**  
*("TOP" mark always upwards)!*

5. Bolt lamp to vehicle, (if necessary with 2-point mount).

6. Align lamps, tighten all bolts.

7. Reconnect battery earth lead (-). Check lights. Fasten connection securely.

**Have the driving lamps adjusted at a workshop or service station. Only properly adjusted lamps provide optimum illumination.**

**The use of the enclosed protective caps is not permissible in areas governed by German Traffic Laws. However it is permissible to use protective grilles.**

## One more tip:

Keep the lenses clean. Dirt can absorb up to 80 % of the light. You drive more safely when you can see and be seen well.

Do you have spare bulbs and fuses in your vehicle?

If you have any questions or installation problems: Ring the Hella service department.