



GC-30 GAS CADDY

INSTRUCTIONS - PARTS DRAWING - PARTS LIST

ITEM # 12652

⚠ WARNING: READ INSTRUCTIONS BEFORE OPERATING



**DO NOT USE TO TRANSPORT FUEL
IN ANY VEHICLE OR TRAILER**

ASSEMBLY

1. Remove all packaging and check carefully for concealed shipping damage.
2. Take the handle arm and place on pump with slot end on pump shaft. The use supplied nut and tighten securely.
Take the black handle and bolt, and thread into handle and arm far enough that there is thread sticking through the backside and use supplied nut on backside of handle arm to lock black handle in place. Remove the red plugs from pump and insert steel hex bushing into bottom side of pump. Be sure to apply teflon tape to the threads of hex bushing.
3. Slide wheels onto axle and snap on the retaining rings.
4. Install pump and hose. Refer to parts illustration.
5. If desired, mount caddy identification label (Unleaded, Gasoline, Diesel or Mixed Fuels) on front or side of caddy.
6. Always have ground wire clamp attached to a known ground.

OPERATION

1. This pump is furnished with a hose to transfer fuel.
2. Rotate pump handle briskly to obtain initial prime.
3. Rotate pump handle clockwise to draw from the caddy – Counter clockwise rotation for suction.

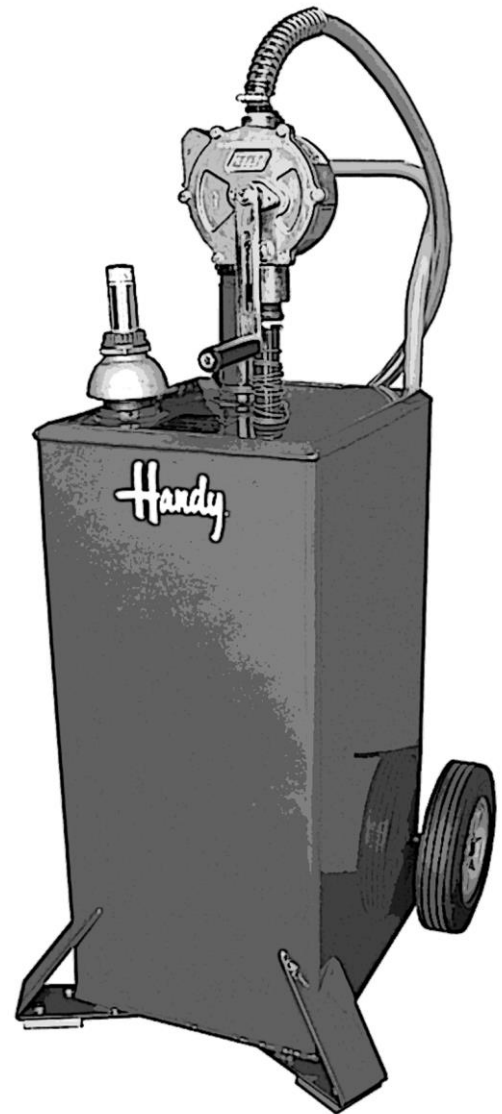

NOTE: The arrow which is on base plate inside gauge, must point to opposite corner of gas caddy. This is necessary to prevent gauge float arm from binding against tank sides.

GC-30 GAS CADDY PARTS LIST

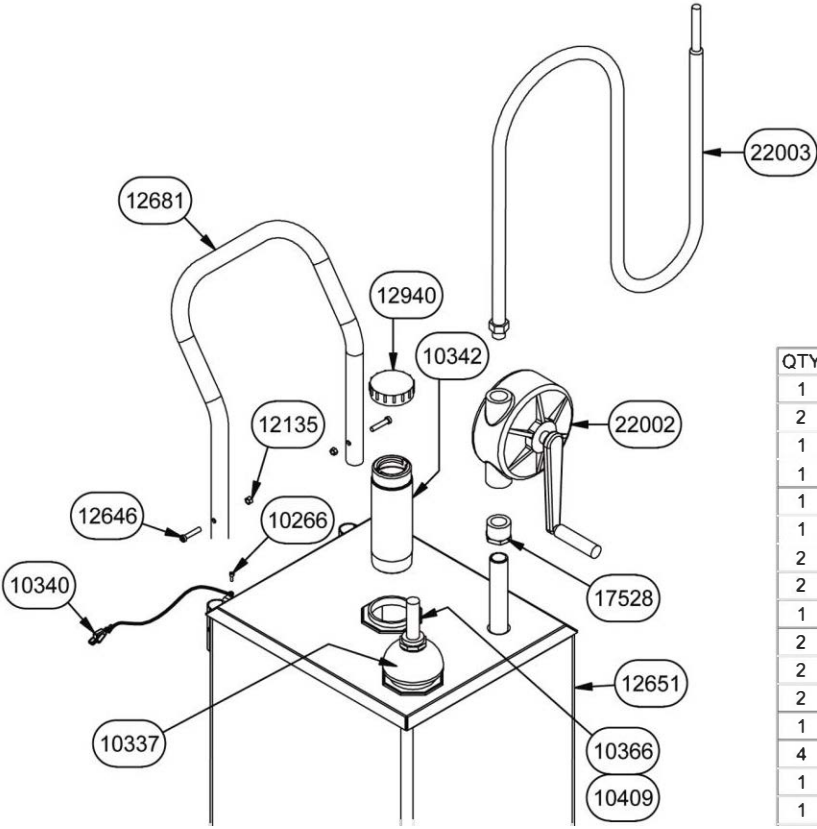

QTY	PART No.	DESCRIPTION
1	10266	SCREW 10-32 X 3/8 TCS TYPE F
2	10327	ALUMINUM FOOT PAD
1	10337	VENT DOME ASSEMBLY
1	10340	GROUND WIRE ASSEMBLY
1	10342	FILL TUBE ASSEMBLY
1	10366	TANK GAUGE
2	10367	WHEEL
2	10372	RING RETAINING 3/4
1	10409	GAUGE REPAIR KIT
2	12135	NUT KEP 1/4-20 HH
2	12463	RETAINING RING G2000
2	12646	SCREW 1/4-20 X 1 1/4 SHCS PLATED
1	12651	CADDY TANK ASSEMBLY
4	12653	1/4-20 X 3/4 FLAT HEAD CAP SCREW
1	12681	CADDY HANDLE
1	12940	NON VENTED CAP
1	17528	3/4 NPT TO 1 NPT BUSHING
1	22002	GPI PUMP
1	22003	3/4 x 8' CADDY HOSE

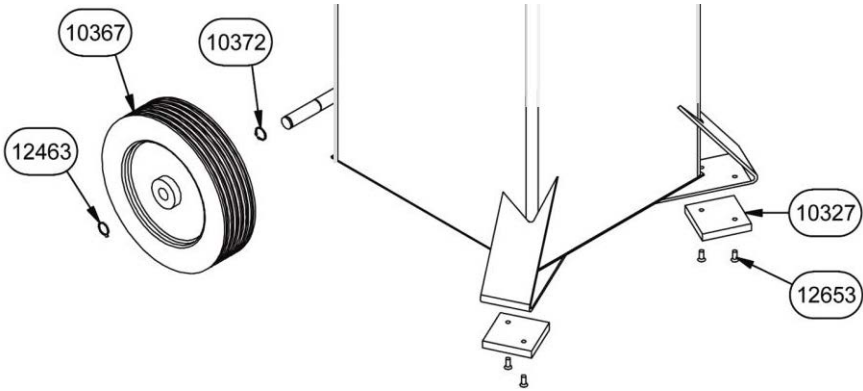

GAUGE ASSEMBLY & VENT DOME DETAIL
 10409 Gauge Repair Kit (Gauge only)
 10366 Gauge Assembly
 10337 Dome (Not included in Gauge Assembly Kit)

