



Ready2Grow™
Click Connect™
Owner's Manual

WARNING

Failure to follow these warnings and the assembly instructions could result in serious injury or death.

- **PLEASE SAVE OWNER'S MANUAL FOR FUTURE USE.**
- **ADULT ASSEMBLY REQUIRED.**
- **NEVER LEAVE** child unattended. Always keep child in view while in stroller.
- **AVOID SERIOUS INJURY** from falling or sliding out. Always use seat belt. After fastening buckles, adjust belts to get a snug fit around your child.
- **AVOID FINGER ENTRAPMENT:** Use care when folding and unfolding the stroller. Be certain the stroller is fully erected and latched before allowing your child near the stroller.
- **AVOID STRANGULATION.** DO NOT place items with a string around your child's neck, suspend strings from this product, or attach strings to toys.
- **NEVER USE STROLLER ON STAIRS** or escalators. You may suddenly lose control of the stroller or your child may fall out. Also, use extra care when going up or down a step or curb.
- **STROLLER TO BE USED** only at walking speed. Product not intended for use while jogging, skating, etc.
- **USE OF THE [front seat](#),** bench seat or standing platform with a child weighing more than 50 lbs (22.7 kg) or taller than 45 in. (114.3 cm) will cause excessive wear and stress on the stroller.
- **USE OF THE** elevated rear seat with a child weighing more than 40 lbs (18.1 kg) or taller than 43 in. (109.2 cm) will cause excessive wear and stress on the stroller.
- **TIPPING HAZARD! DO NOT OVERLOAD BENCH SEAT, ELEVATED SEAT, FRONT SEAT OR STANDING PLATFORM PAST THE MANUFACTURERS RECOMMENDED WEIGHT RATING.**
- **TO PREVENT TIPPING,** do not place more than 3 lbs (1.4 kg) on the parent's tray.
- **TO AVOID BURNS,** never put hot liquids in the parent's tray.
- **TO PREVENT A HAZARDOUS, UNSTABLE CONDITION,** never place purses, shopping bags, parcels or accessory items on the handle or canopy.
- **TO PREVENT A HAZARDOUS, UNSTABLE CONDITION,** do not place more than 10 lbs (4.5 kg) in the storage basket and more than 2 lbs (0.9 kg) in the canopy pockets (on certain models).
- **DO NOT** use storage basket as a child carrier.
- **NEVER ALLOW YOUR STROLLER** to be used as a toy.
- **DISCONTINUE USING YOUR STROLLER** should it become damaged or broken.



WARNING

USING GRACO® INFANT CAR SEAT WITH STROLLER:

- **USE ONLY A GRACO® SNUGRIDE® CLICK CONNECT™ CAR SEAT** with this travel system. (Not intended for use with SnugRide®, SnugRide® 30, SnugRide® 32, SnugRide® 35, Infant Safeseat™, AUTOBABY, LOGICO S, JUNIORBABY and ASSURA infant car seats.)
Improper use of this stroller with other manufacturers' car seats may result in serious injury or death.
- **READ THE MANUAL** provided with your Graco car seat before using it with your stroller.
- Front tray **MUST** be installed in the front location to be used for the car seat.
- **ALWAYS SECURE** your child with the car seat harness when using the car seat in the stroller. If your child is already in the car seat, check that the child is secured with the harness.

TO PUT CHILDREN IN THE STROLLER:

- You may use this stroller with two infant car seats. Refer to the section "To Attach Graco® Infant Car Seat" pages 36-43. Only use a **GRACO® SNUGRIDE® CLICK CONNECT™ CAR SEAT** only.

To Open Stroller

1

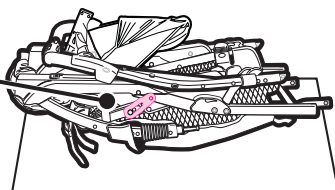
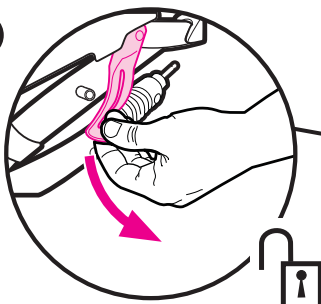

2

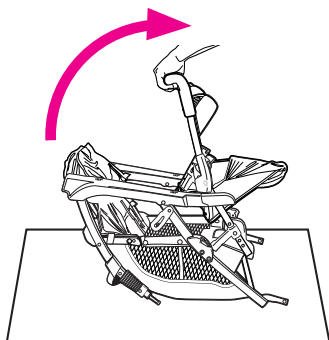

3

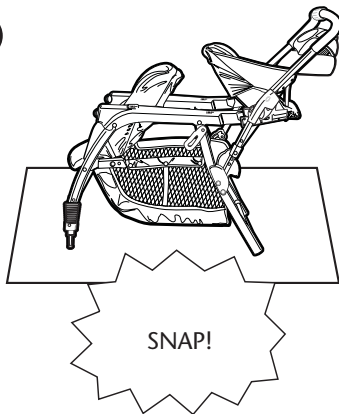

CHECK that the stroller is completely latched open every time you open the stroller and before continuing with the rest of the assembly steps.

Parents Tray

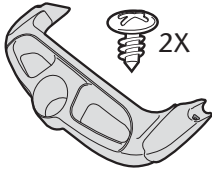

Attach tray by sliding onto mounts as shown.

1

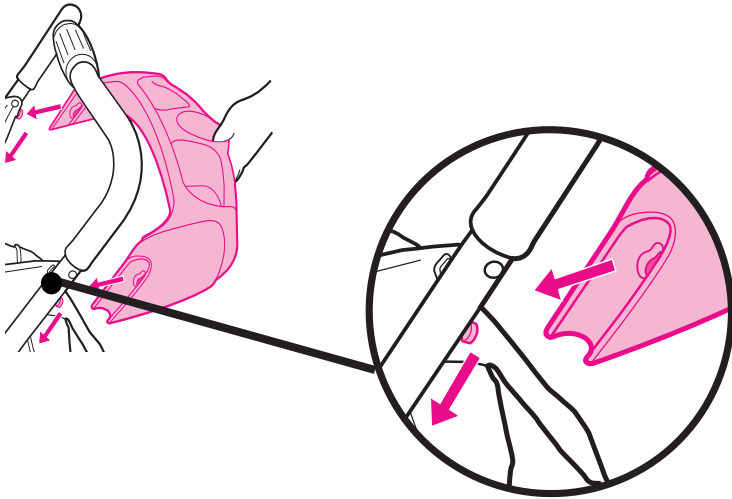

2

Secure tray to the stroller with the 2 screws provided.

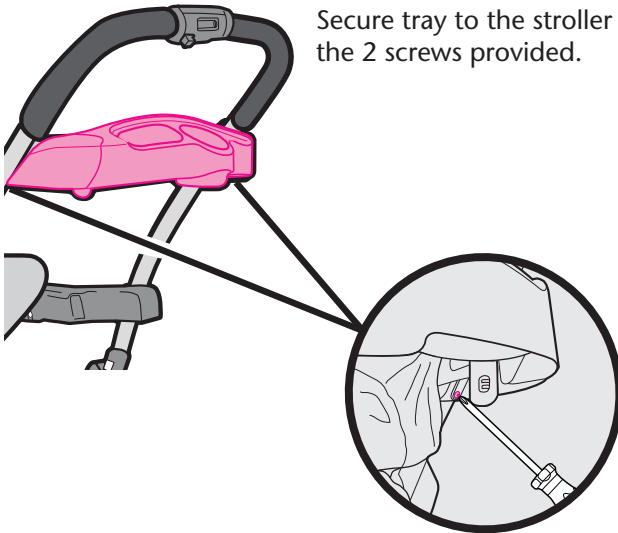

3

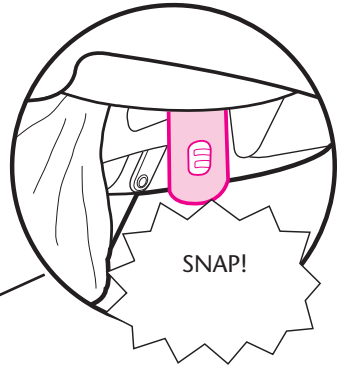
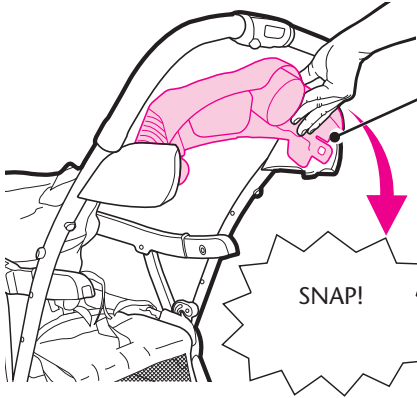

Rotate tray down until it snaps into place.

Never use stroller without the parent tray completely latched into place.

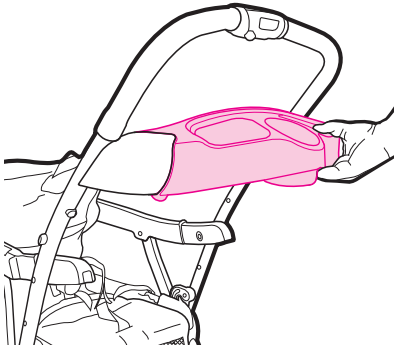

Rear Axle

BEFORE attaching wheel: Be sure to place stroller on top of a piece of card board or some other protective cover to prevent any damage to floor.

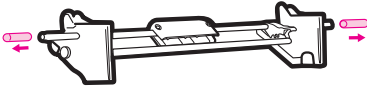

⚠WARNING Choking Hazard: Remove and immediately discard foam on the rear axle.

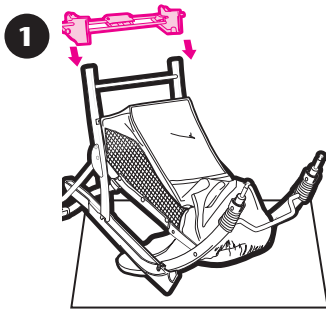

Insert brake assembly onto rear legs. Brake pedal must point towards the rear of stroller.

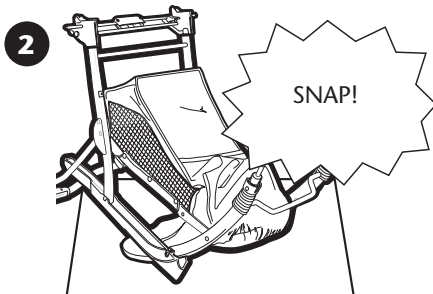

Standing Platform

Hooks

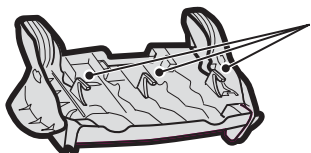

1

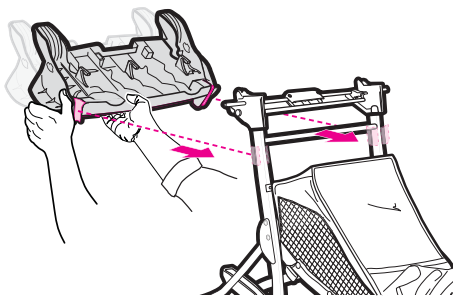

Slide the sides of the standing platform onto the frame legs as shown.

2

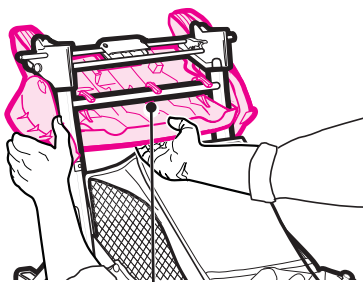

Lift the standing platform up and make sure the 3 hooks latch onto the crossbrace as shown.

3

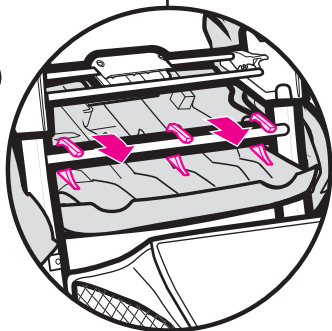

4

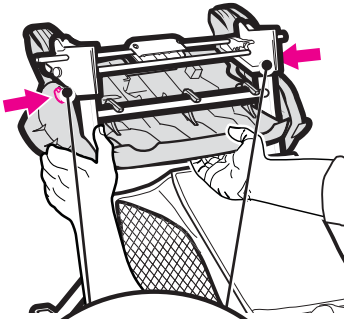

Check that the tabs on both sides of the standing platform are snapped in place.

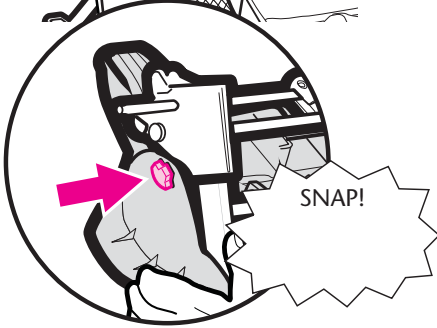

Rear Wheels

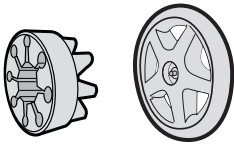

1

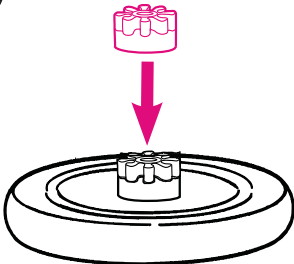

Firmly attach hub adapter onto wheel.

2

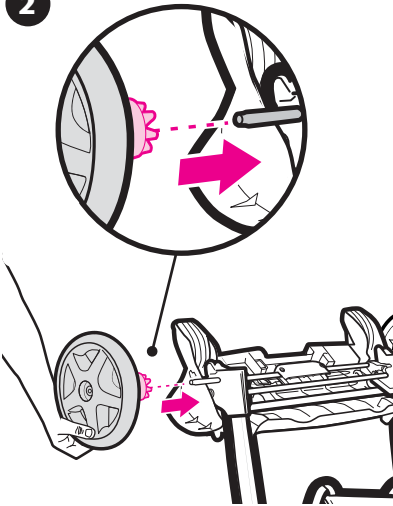

Place wheel on axle.

3

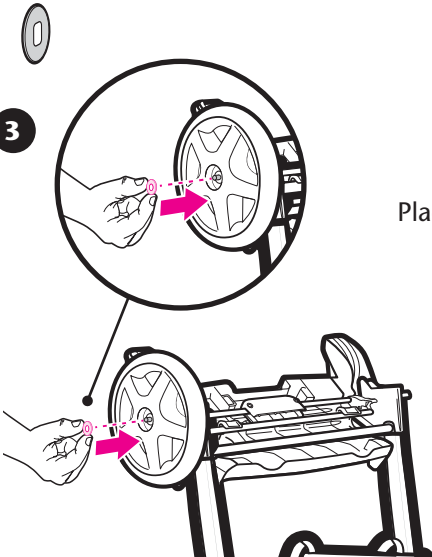

Place washer on axle.

4



Push straight side of pin through axle hole. *Pin will separate around the axle.* Curved end of pin **MUST** face up as shown.

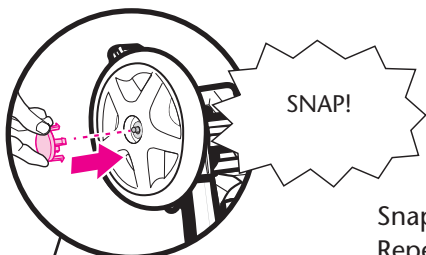
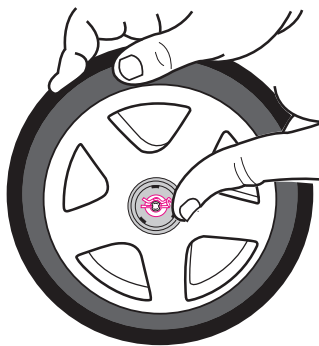

5

Snap hubcap over pin as shown. Repeat steps 1-5 (Rear Wheels) on other side.

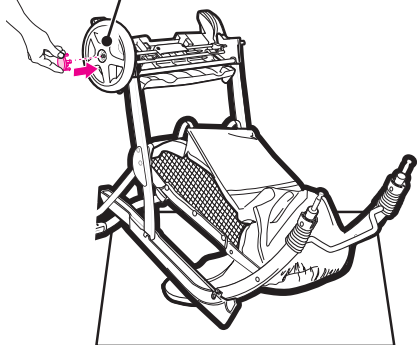

Footrest

Attach footrest as shown.

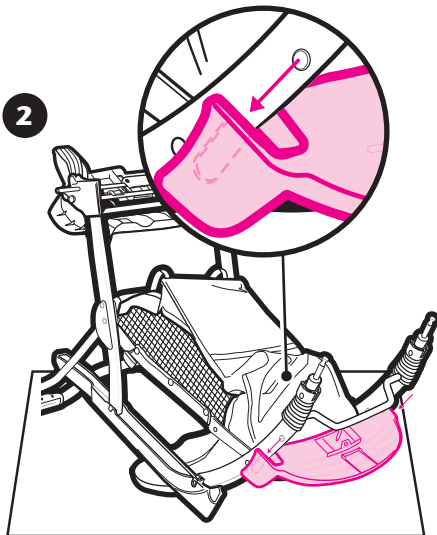
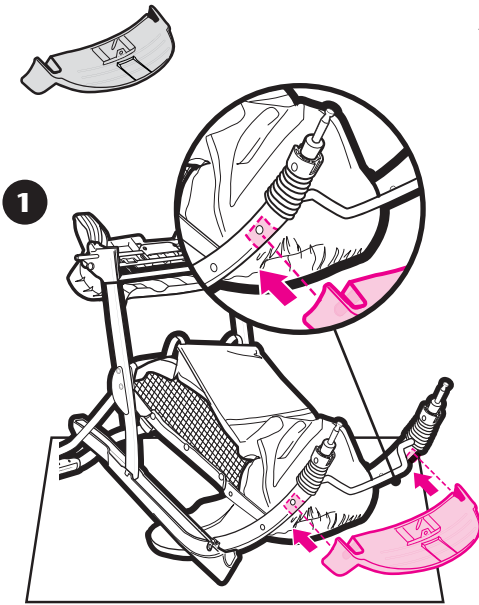

Make sure to slide the peg into the channel of the footrest.

3

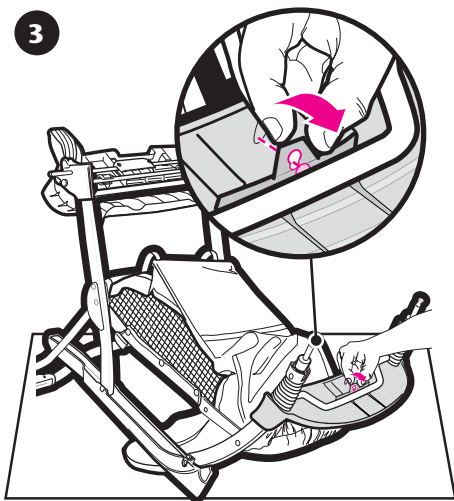

Insert the tab over the footrest pin as shown.

Front Wheels

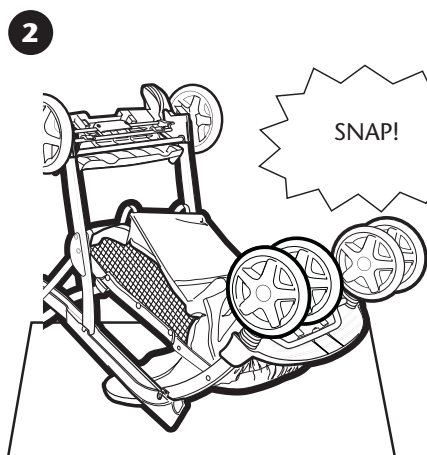
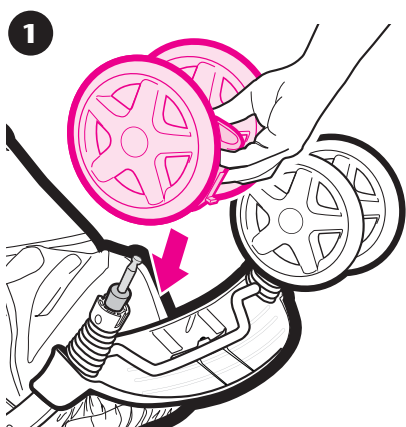
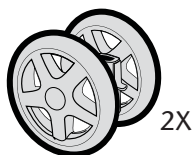

Check that wheels are securely attached by pulling on wheel assemblies.

Canopy



Small canopy

Insert small canopy into the canopy mounts on each side of the stroller, with the padded edge facing towards the front as shown.

1

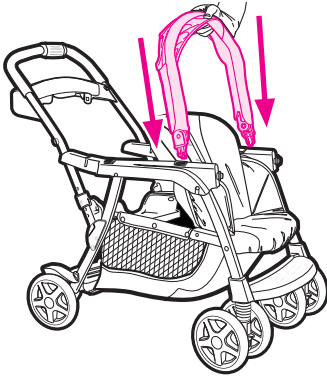

Large canopy

Insert large canopy into the canopy mounts on each side of the stroller, with the padded edge facing towards the rear as shown.

2



3

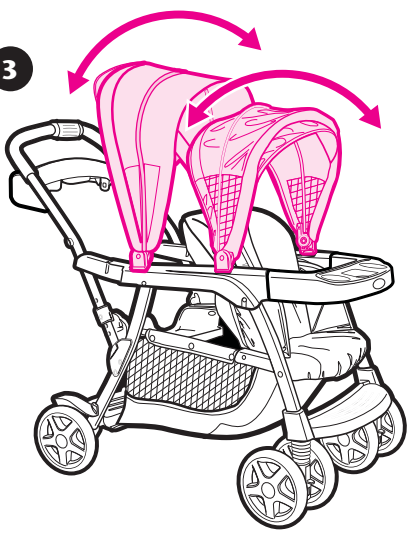

To adjust.

Child's Tray

⚠WARNING Always secure your child with the seat belt. The tray is not a restraint device. **DO NOT** lift the stroller by the child's tray. Use care when snapping the tray on the stroller with a child in the stroller.

1

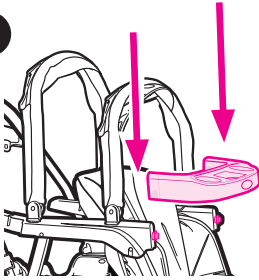

2

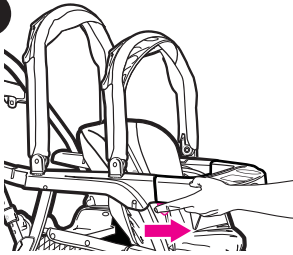

To open the tray.

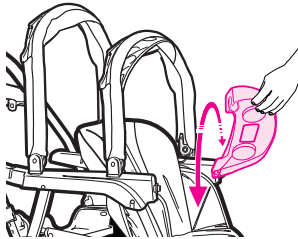

Elevated Rear Seat

⚠WARNING Do not allow child to stand on seat.
Never use seat in vehicle or in any other product.

1

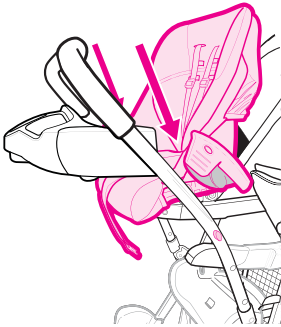

Attach seat as shown.

2

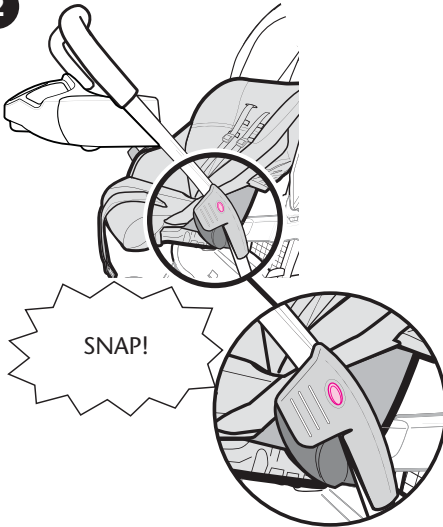

Make sure seat is snapped securely onto pegs on each side of the frame.

3

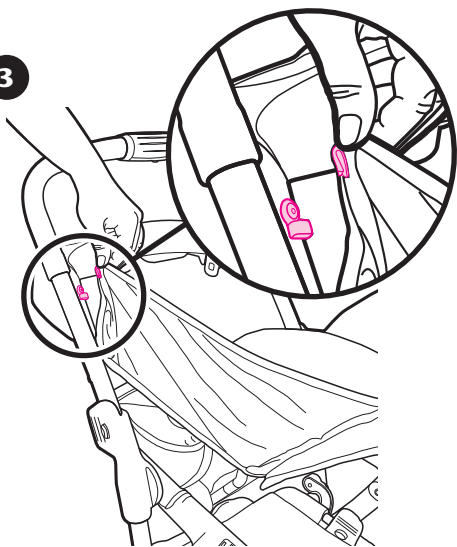

You must first attach the hook on the flap to the stroller frame before fastening the snap.

4

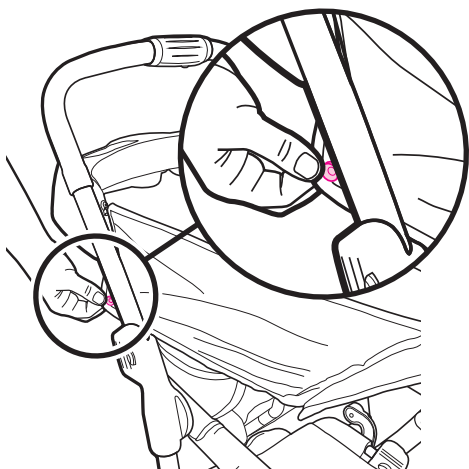

Fasten the snap button to the stroller frame as shown. Repeat on other side.

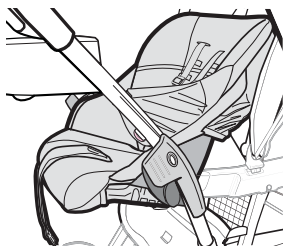

5

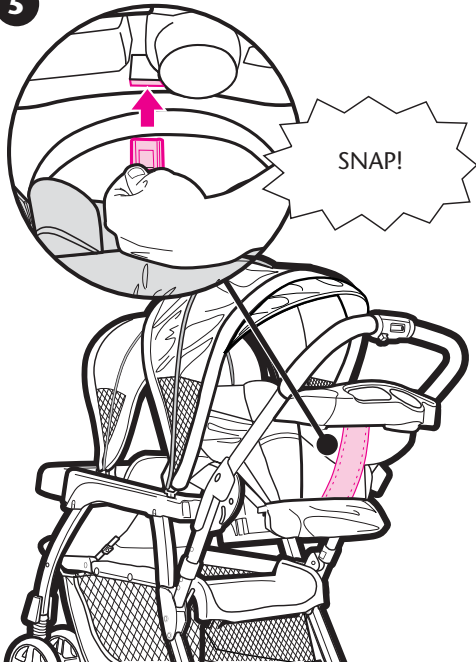

Insert the crotch strap buckle into the underside of the parent tray.

6

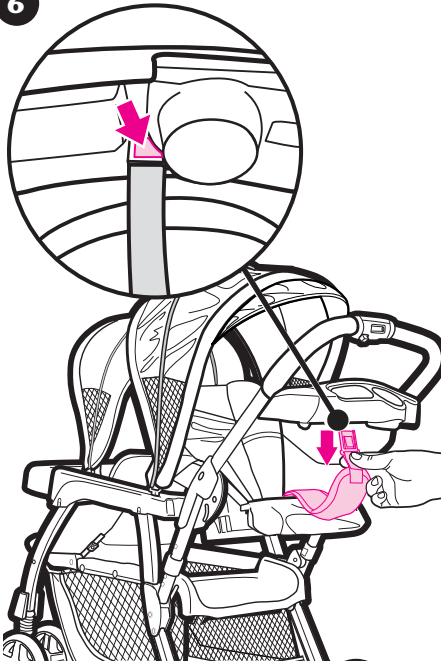

To release crotch strap, press button as shown.
To remove elevated seat, reverse steps.

Bench Seat

Do not allow child to stand on seat. Never use seat in motor vehicle or on any other product.

1

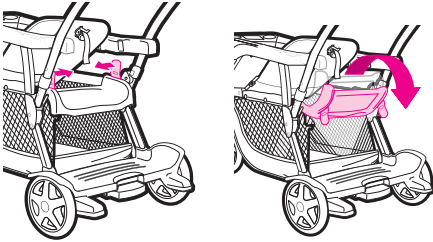

To access basket, push tabs toward the middle of seat and rotate forward as shown.

2

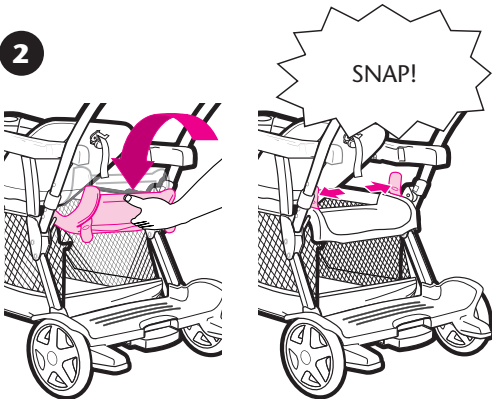

To close: Push seat up and snap the side tabs into place as shown.

To Secure Child

5 Point Harness

1

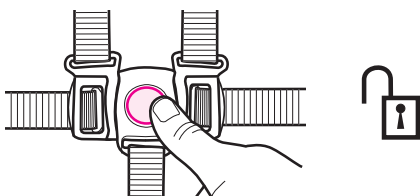

2

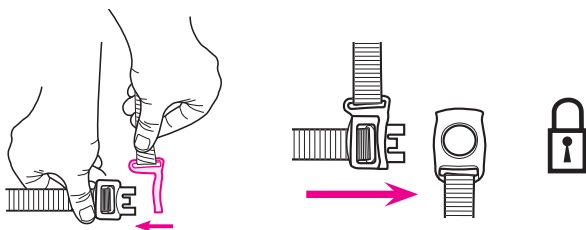

3

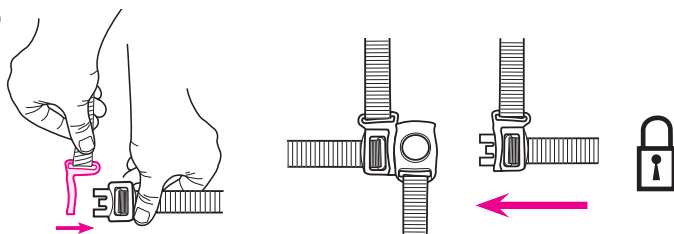

4

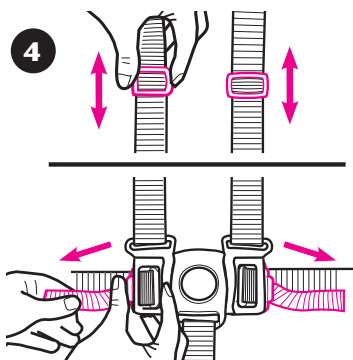

Use slide adjuster at shoulder and wait for tighter adjustment. To change shoulder harness slots.

3 Point Buckle

1

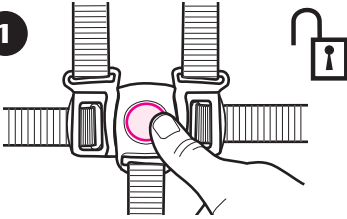

To convert to 3-pt harness.

2

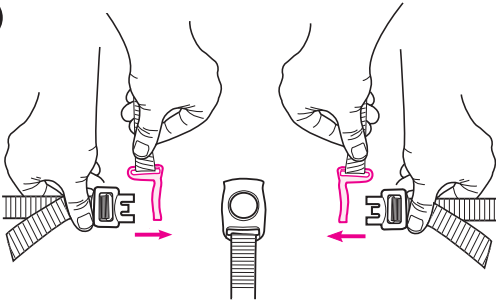

3

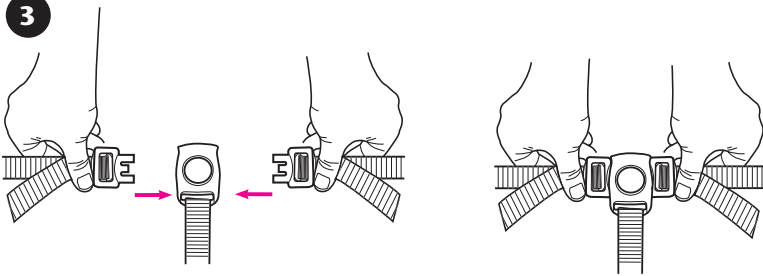

4

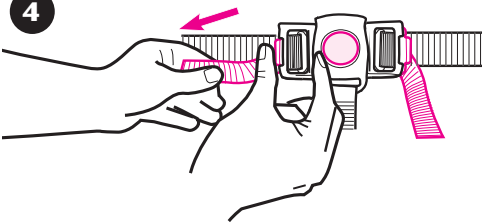

Use slide adjuster at waist for tighter adjustment. When using bench seat, follow steps 3-5 on this page.

5

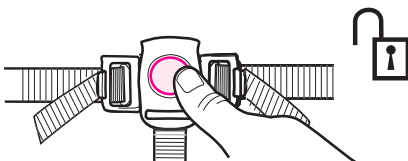

To Change Shoulder Harness Slots

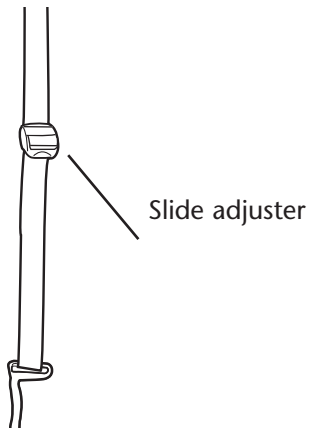

1

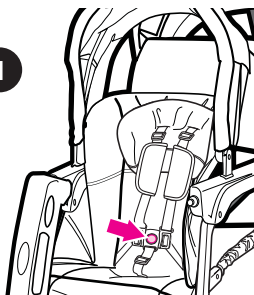

2

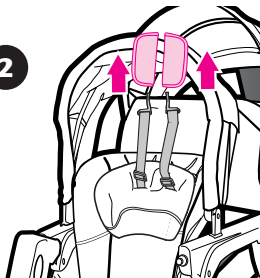

Remove harness covers as shown.

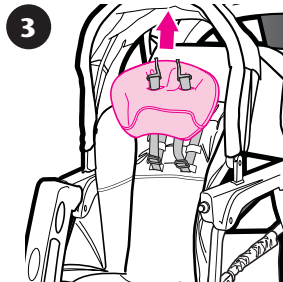

3 Remove head support as shown.

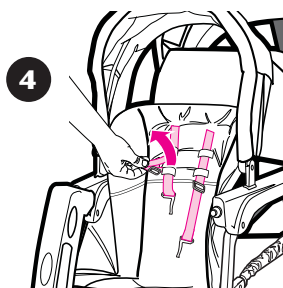

4 Remove both shoulder harness straps as shown.

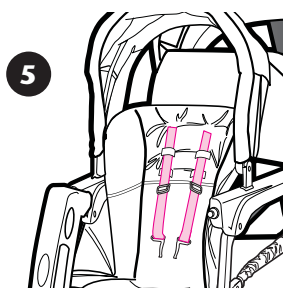

5

To Recline Front Seat

▲WARNING When making adjustments to the stroller seat, make sure child's head, arms, and legs are clear of moving seat parts and stroller frame.

1

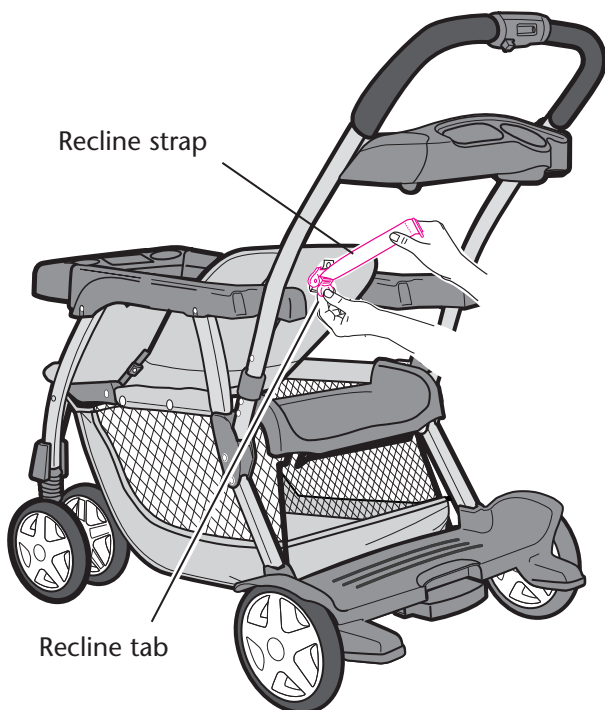

2

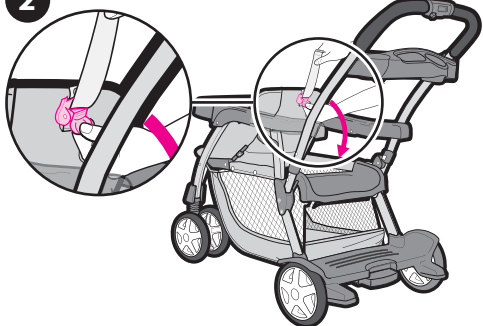

To recline, pull recline tab down.



3

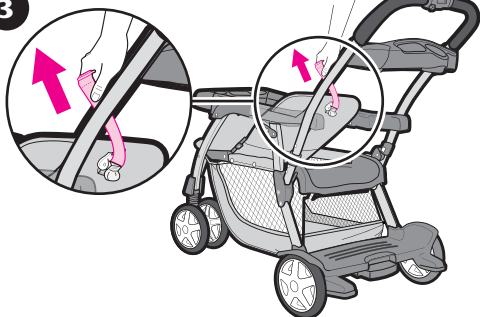

To raise, pull recline strap up.

Head Support (on certain models)

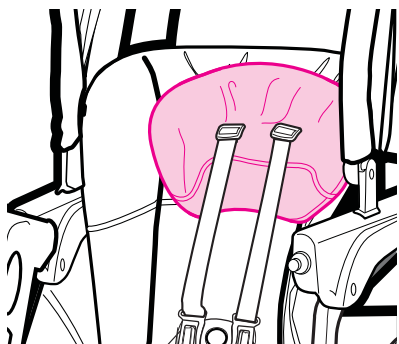

Only use this head support on this stroller. Never use this head support on any other product.

Brake

⚠WARNING

CHECK that brake is on by trying to push stroller.

1

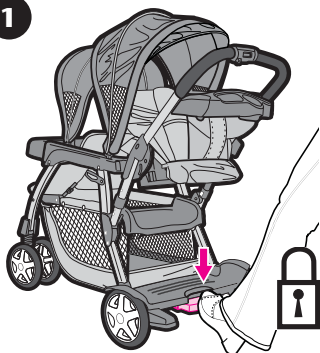

2

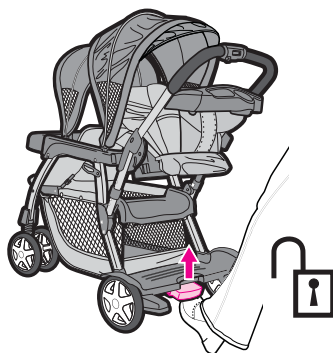

Swivel Wheels

1

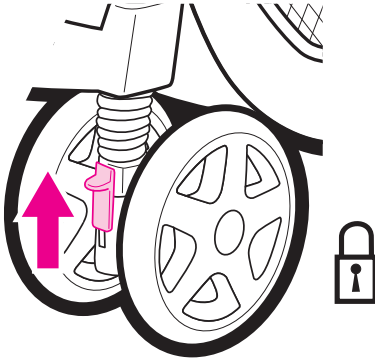

Front swivel wheels lock for use on uneven surfaces such as grass, stones or gravel.

2

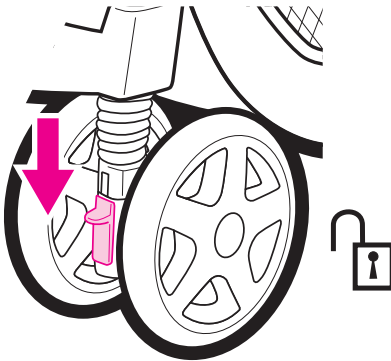

To Fold Stroller

Before folding stroller:(1) remove infant carrier if in use; (2) adjust seat back to upright position; (3) lock brake. (4) fold canopies

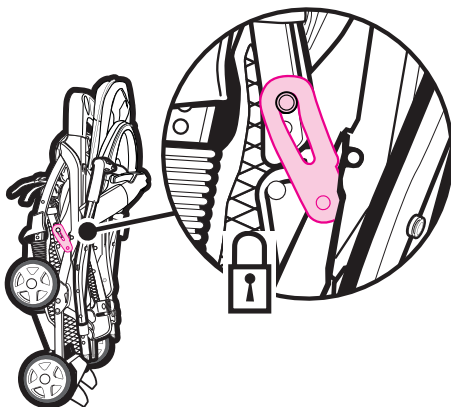
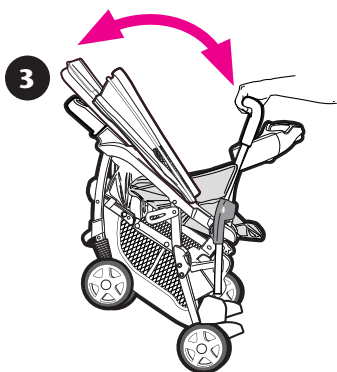
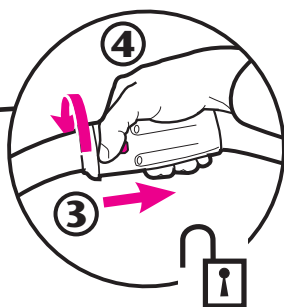
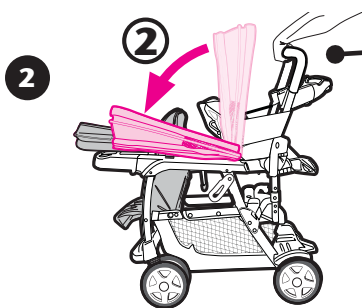
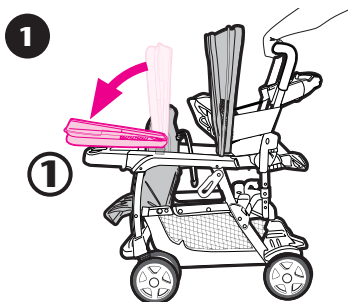

To Attach Graco® Infant Car Seat on Elevated Rear Seat

⚠WARNING Do not allow child to stand on seat.
Never use seat in vehicle or in any other product.

Flaps

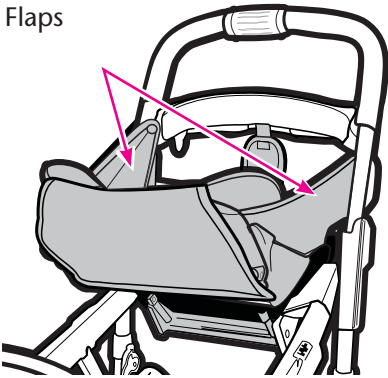

Check to make sure the flaps are installed before beginning to attach infant car seat to the elevated rear seat.

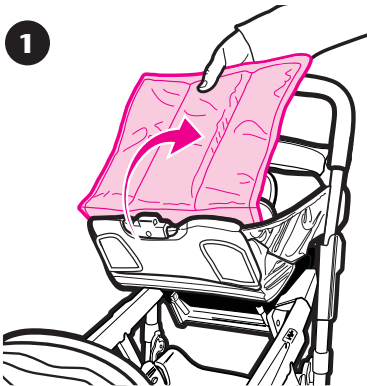

1 Pull flap over the seat pad as shown.

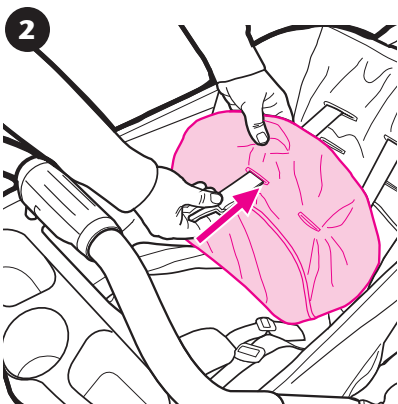

Remove head support and harness covers.

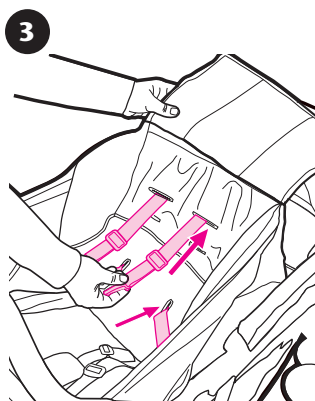

Remove both shoulder harness straps and the waist straps as shown.

4

Mounts

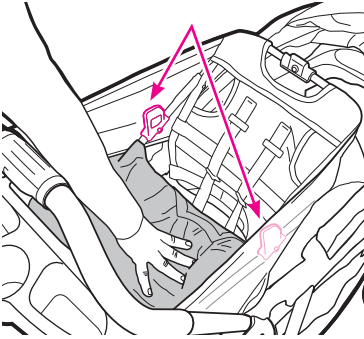

Push seat pad down into the seat to expose the Click Connect™ mounts on either side of the seating area.

5

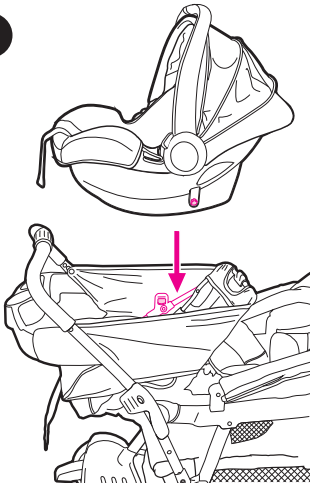

Insert car seat into stroller and push down on car seat until the latches snap into the Click Connect™ mounts.

Check that infant car seat is securely attached by pulling up on it.

6

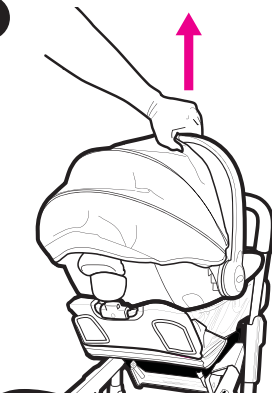

7

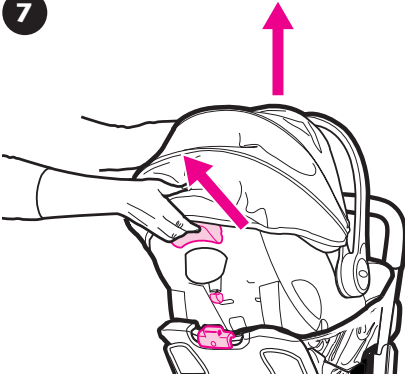

- **To remove car seat:** squeeze release handle at back of car seat, and lift car seat out of the stroller.

To Attach Graco® Infant Car Seat to Front Seat

1

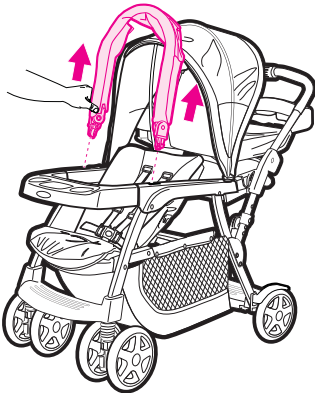

Remove small canopy.

2

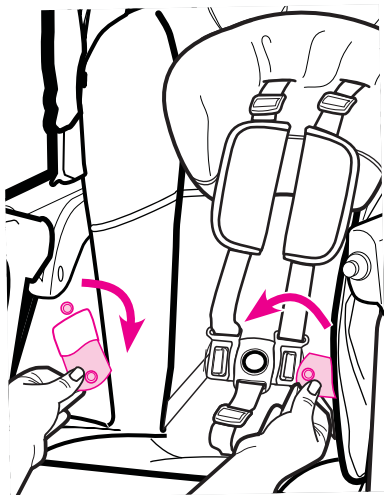

Open flaps inside seating area to expose Click Connect™ mounts.

3

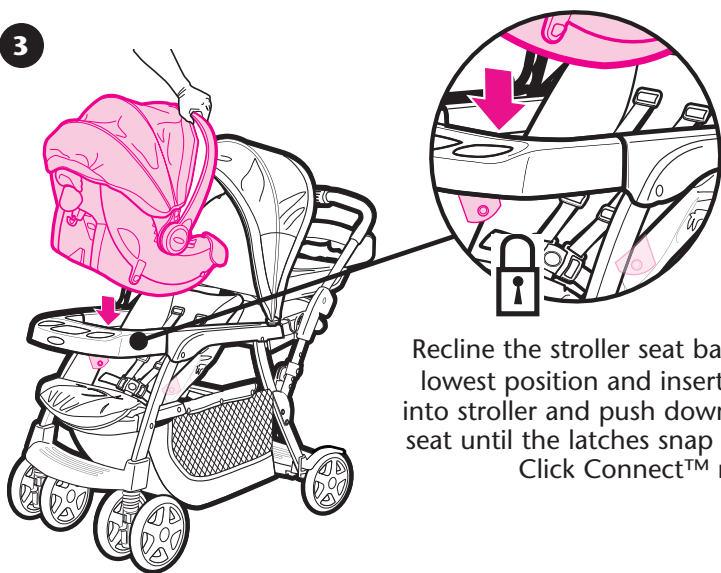

Recline the stroller seat back to its lowest position and insert car seat into stroller and push down on car seat until the latches snap into the Click Connect™ mounts.

4



Check that infant car seat is securely attached by pulling up on it.

5

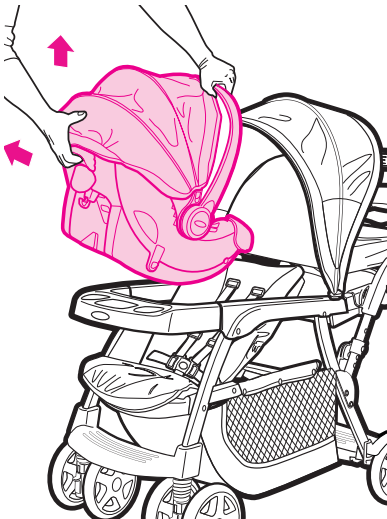

- **To remove car seat:** squeeze release handle at back of car seat, and lift car seat out of the stroller.

READY2GROW™ CLICK CONNECT™ Use Positions

▲WARNING DO NOT allow child to stand on platform, facing backwards. To avoid falling, child must hold onto stroller frame.



Care and Maintenance

- **DO NOT MACHINE WASH SEAT.** It should only be wiped with a mild soap, taking care not to soak the material. **NO BLEACH.**
- **REMOVABLE SEAT PAD** (if so equipped) refer to your care tag on your seat pad for washing instructions. **NO BLEACH.**
- **TO CLEAN STROLLER FRAME,** use only household soap and warm water. **NO BLEACH** or detergent.
- **FROM TIME TO TIME CHECK YOUR STROLLER** for loose screws, worn parts, torn material or stitching. Replace or repair the parts as needed. Use only Graco replacement parts.
- **EXCESSIVE EXPOSURE TO SUN OR HEAT** could cause fading or warping of parts.
- **IF STROLLER BECOMES WET,** open canopy and allow to dry thoroughly before storing.
- **IF WHEEL SQUEAKS,** use a light oil (e.g., WD-40, 3-in-1, or sewing machine oil). It is important to get the oil into the axle and wheel assembly as illustrated.
- **WHEN USING YOUR STROLLER AT THE BEACH** completely clean your stroller afterward to remove sand and salt from mechanisms and wheel assemblies.

