

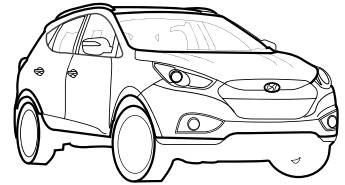

HYUNDAI IX35 / TUCSON

(2010 Production Onwards)

INTEGRATED SIDE STEP INSTALLATION INSTRUCTION



Accessory Part No.
STEP0001



60 Minutes

Approx Product Weight:
15kg/33 lb

IMPORTANT - PLEASE READ INSTRUCTIONS BEFORE COMMENCING INSTALLATION

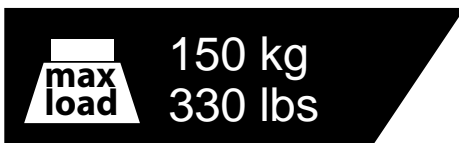

- Do not use this product in any other motor vehicle for which it is not designed.
- Do not use any other mounting location / method other than described in this instruction.
- It is advisable to seek assistance of another person when installing this product.
- Do not repair or modify the product and / or its mounting bracket in any way - repair or modification may effect proper operation of the airbag resulting in serious injury.

Place these instructions in the vehicle's glovebox after installation is complete

MAINTENANCE



To maintain your product properly, wash regularly with car wash detergent, hose off & chamois dry. Stubborn grime can be removed with kerosene.

REQUIRED TOOLS | EQUIPMENT

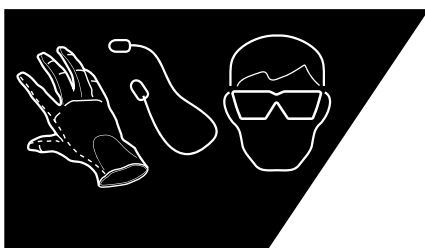
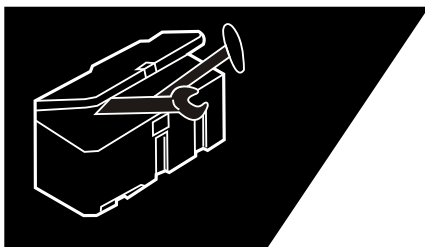

- 13mm and 17mm Socket
- ½" Drive Ratchet
- 10mm, 13mm and 17mm Wrench / Spanner
- 10mm Socket
- 6mm Allen Key
- Cleaning Materials
- Personal Protective Equipment: Safety Glasses, Ear Plugs, Gloves

PARTS LIST

BOM FOR HYUNDAI IX35 2011 INTEGRATED SIDE STEP ASSEMBLY

STEP0001

ITEM	DESCRIPTION	MATERIAL/FINISH	PART No	QTY
1	END CAP FRONT LHS	POLYPROPYLENE - BLACK (GRAINED)	STEP0001-1	1
2	END CAP FRONT RHS	POLYPROPYLENE - BLACK (GRAINED)	STEP0001-2	1
3	SIDE STEP EXTRUSION - LENGTH 1554.0mm	ALUMINIUM ALLOY 6063SF-T6	ALUM0053-1	2
4	INSERT RUBBER EXTRUSION - LENGTH 1524.0mm	RUBBER BLACK	EXTR0025-1	4
5	END CAP REAR LHS	POLYPROPYLENE - BLACK (GRAINED)	STEP0001-3	1
6	END CAP REAR RHS	POLYPROPYLENE - BLACK (GRAINED)	STEP0001-4	1
7	SUPPORT BRACKET FRONT	5.0 THK MILD STEEL - BLACK POWDER COATED	STEP0001-5	2
8	SUPPORT BRACKET OUTER - REAR	5.0 THK MILD STEEL - BLACK POWDER COATED	STEP0001-6	2
9	SUPPORT BRACKET OUTER - FRONT	5.0 THK MILD STEEL - BLACK POWDER COATED	STEP0001-7	2
10	SUPPORT BRACKET INNER FRONT	5.0 THK MILD STEEL - BLACK POWDER COATED	STEP0001-8	2
11	SUPPORT BRACKET REAR - LHS	5.0 THK MILD STEEL - BLACK POWDER COATED	STEP0001-9	1
12	SUPPORT BRACKET REAR - RHS	5.0 THK MILD STEEL - BLACK POWDER COATED	STEP0001-10	1
13	SUPPORT BRACKET INNER REAR	5.0 THK MILD STEEL - BLACK POWDER COATED	STEP0001-11	2
14	M8 x 25 HEX HEAD BOLT	304 STAINLESS STEEL	-	20
15	8.5 ID x 25.0 OD x 3.0 FLAT WASHER	304 STAINLESS STEEL	-	24
16	M8 SPRING WASHER	304 STAINLESS STEEL	-	24
17	M8 HEX NUT	304 STAINLESS STEEL	-	24
18	M10 x 25 HEX HEAD BOLT	304 STAINLESS STEEL	-	12
19	10.85 ID x 25.0 OD x 2.0 FLAT WASHER	304 STAINLESS STEEL	-	30
20	M10 SPRING WASHER	304 STAINLESS STEEL	-	18
21	M10 HEX NUT	304 STAINLESS STEEL	-	18
22	M10 x 30 T-BOLT (20x60)	304 STAINLESS STEEL	-	6
23	M8 x 20 T-BOLT (14x35)	304 STAINLESS STEEL	-	2
24	REAR END-CAP BRACE	2.0 THK MILD STEEL - BLACK POWDER COATED	STEP0001-12	2
25	M8 x 20 BUTTON HEAD ALLEN SCREW	304 STAINLESS STEEL	-	2

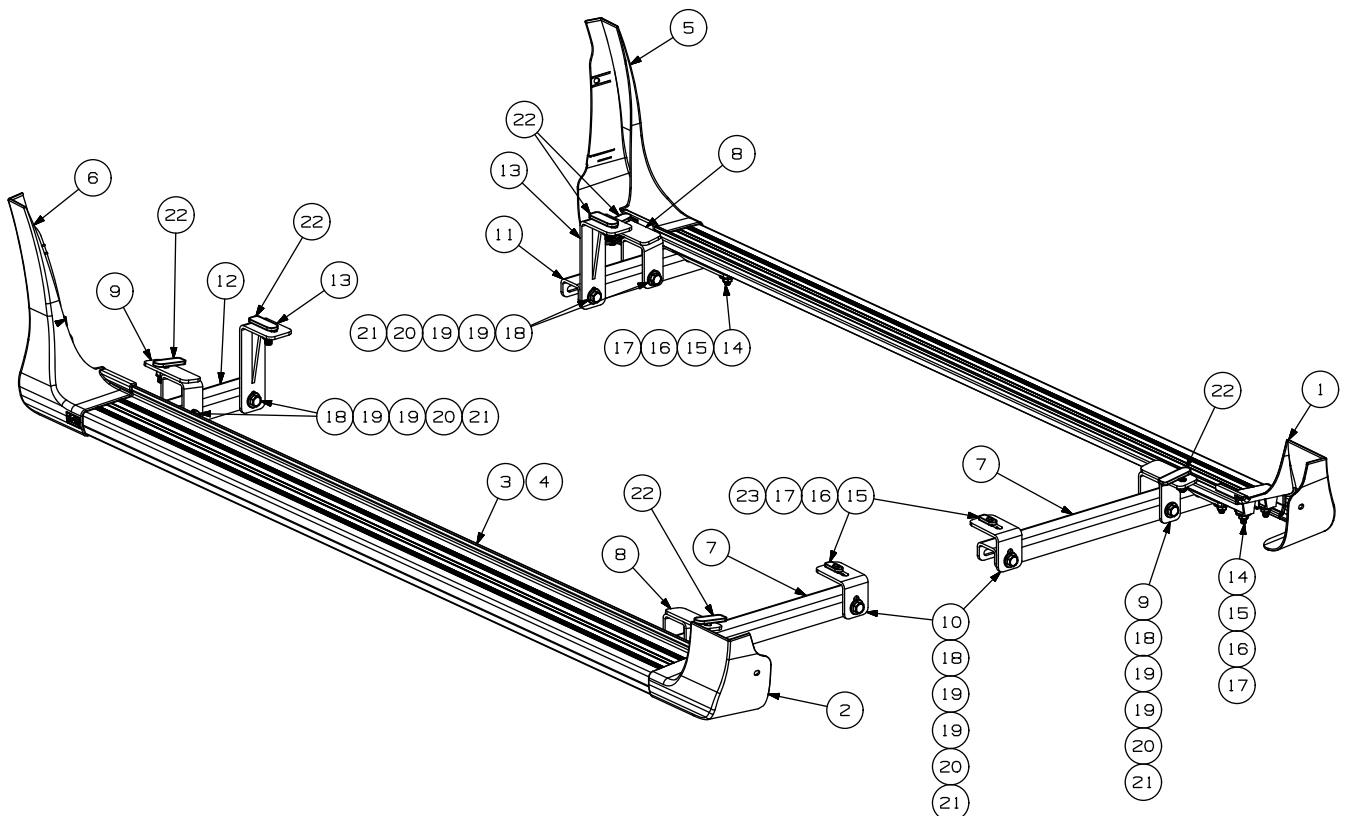

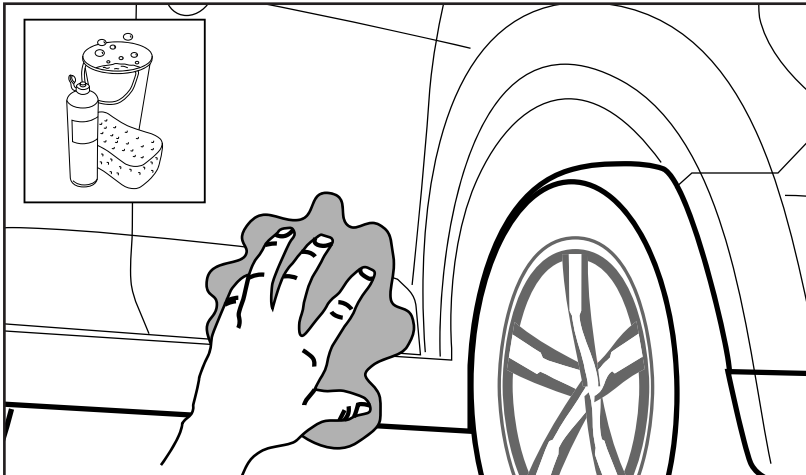
**STEP 1****CLEAN INSTALLATION AREA**

1. Remove mudflaps if fitted and thoroughly clean & dry the installation area.

Repeat process on the other side of the vehicle.

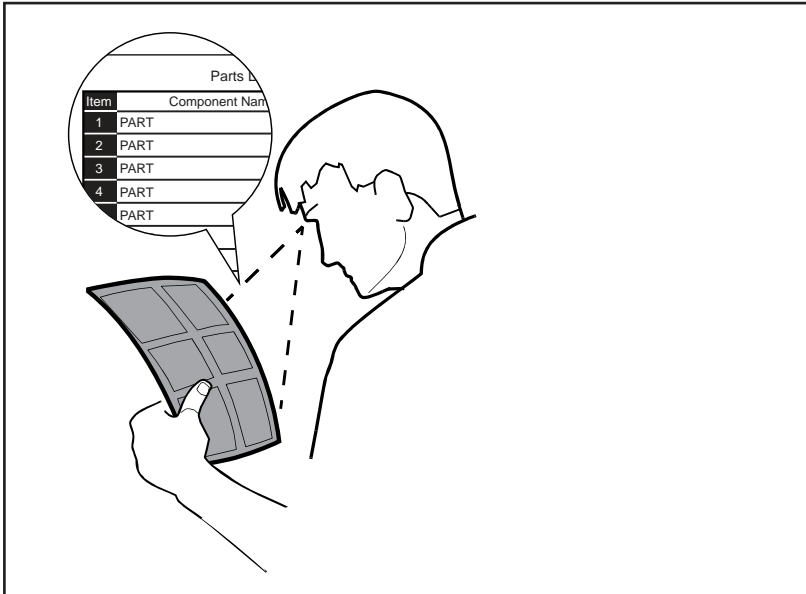

REMOVE ALL MUDFLAPS, IF FITTED

**STEP 2****STOCKTAKE OF PARTS**

Check supplied parts and fasteners against Parts List, before commencing fitment.

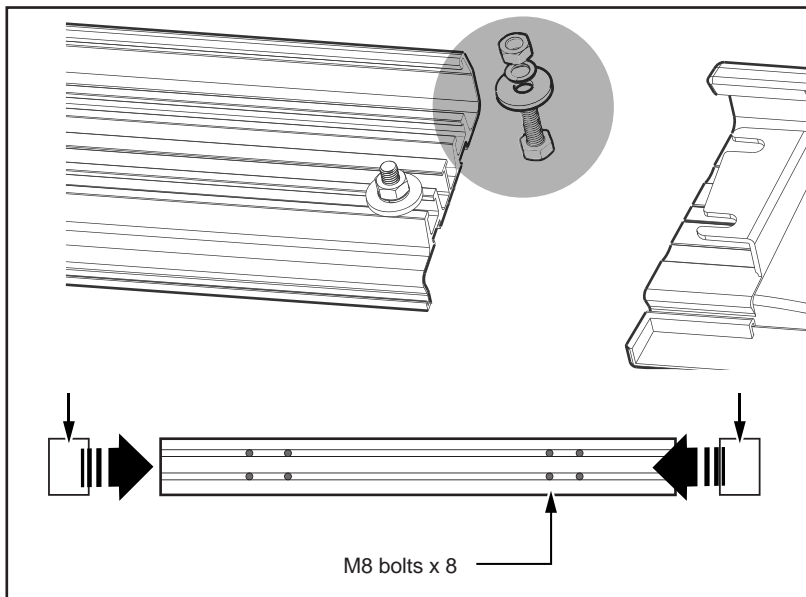
**STEP 3****FIT BOLTS AND ENDCAPS**

Slide in M8 bolts as per diagram.

Fit front and rear end caps to both aluminium extrusions.

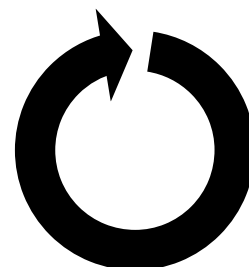

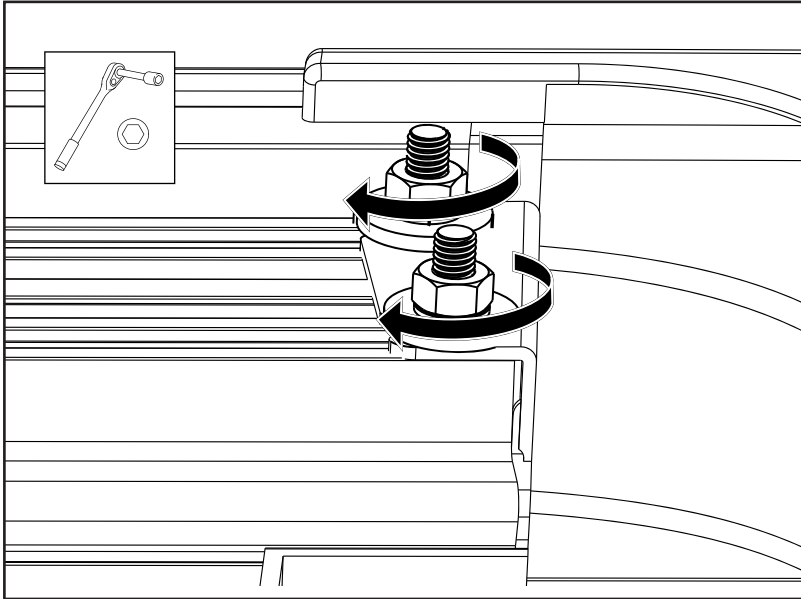
**STEP 4****TIGHTEN FASTENERS TO
SECURE END CAPS TO
EXTRUSION**

Tighten M8 nuts firmly with ratchet
to secure endcap.

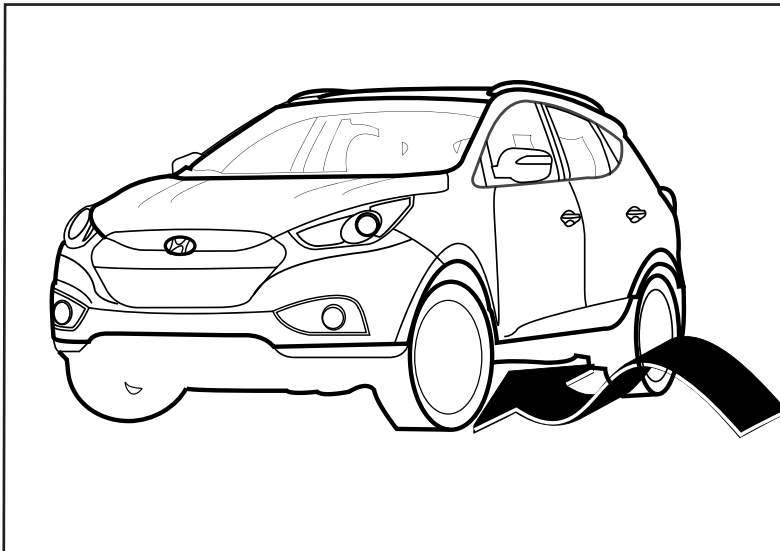
**STEP 5****ACCESS THE UNDERSIDE OF
CHASSIS**

LH Front Brackets shown as example

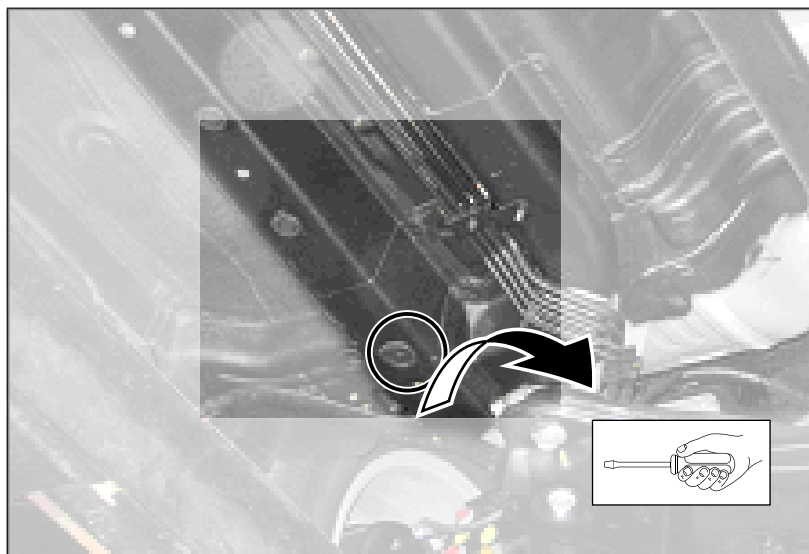
**Removal of Rubber Plug - Front LHS Shown****STEP 6**

Carefully remove the front Inner rubber plug as shown using a Flat Head Screwdriver.

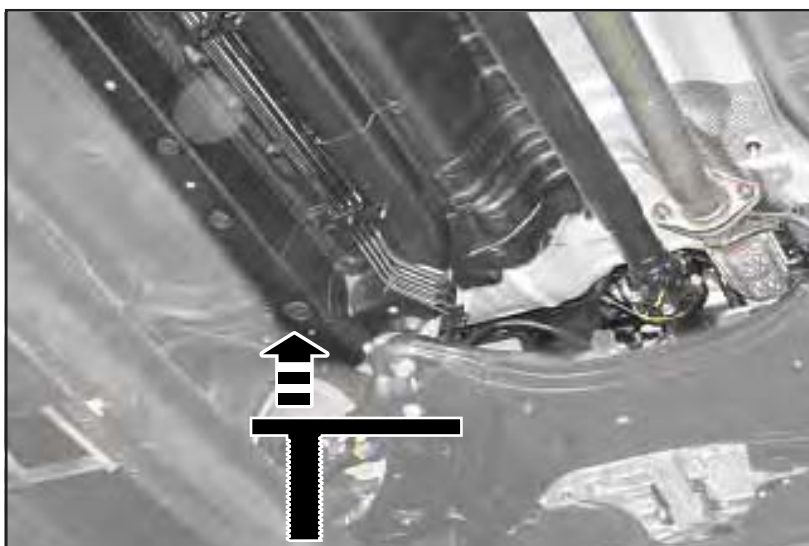
**Install the M8 T-bolt****STEP 7**

Install the M8 T-bolt in the hole.

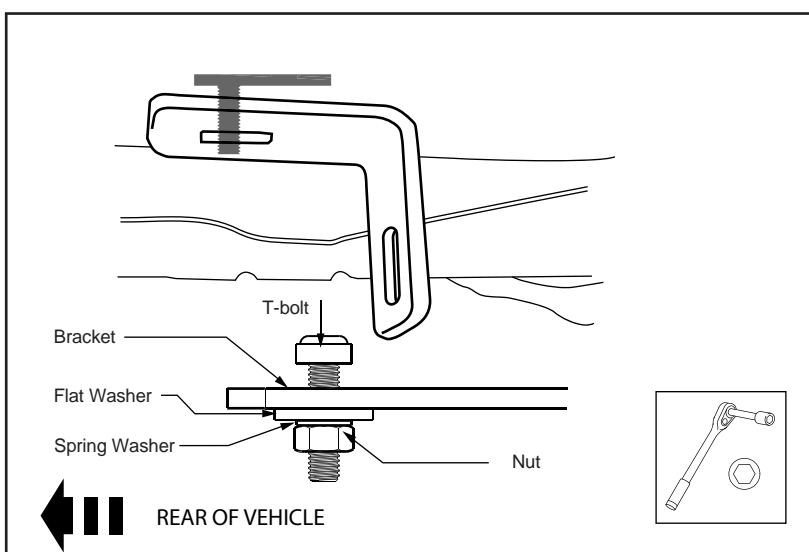
**Fit the Front Inner Support Bracket****STEP 8**

Fit the Front Inner Support Bracket (10) using the M8 T-Bolt (14) 8,5 ID x 25 OD x 3MM flat washer (15), and M8 Spring Washer (16). Do not fully tighten at this point.

**Removal of outer rubber plug****STEP 9**

Carefully remove the inner front Outer rubber plug as shown using a Flat Head Screwdriver.

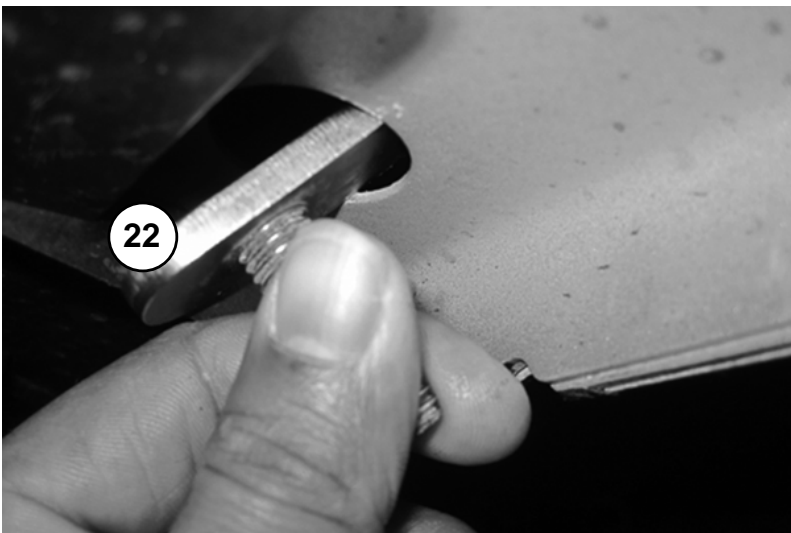
**Fit the M10 x 60 T-Bolt****STEP 10**

Fit the M10 x 60 T-Bolt in the hole.

**Fit the Front Outer Support Bracket****STEP 11**

Fit the Front Outer Support Bracket (9) using the M10 Hex Nut (21), Spring Washer(20) and Flat Washer (19). Do not tighten at this point.

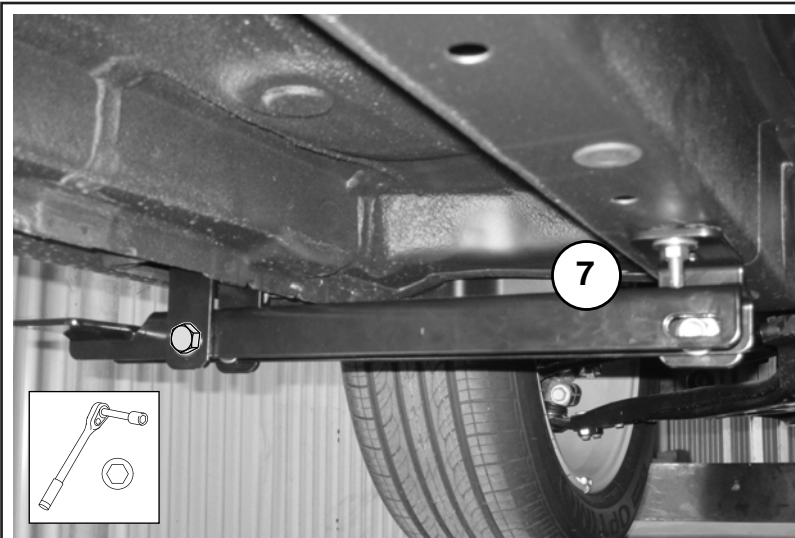

**Fit the Front Support Bracket****STEP 12**

Fit the front support bracket between the outer and inner brackets using M10 hex head bolts (18), Flat Washers (19), M10 Spring Washers (20) and M10 Hex Nuts (21). Do not tighten the bolts and nuts at this point.

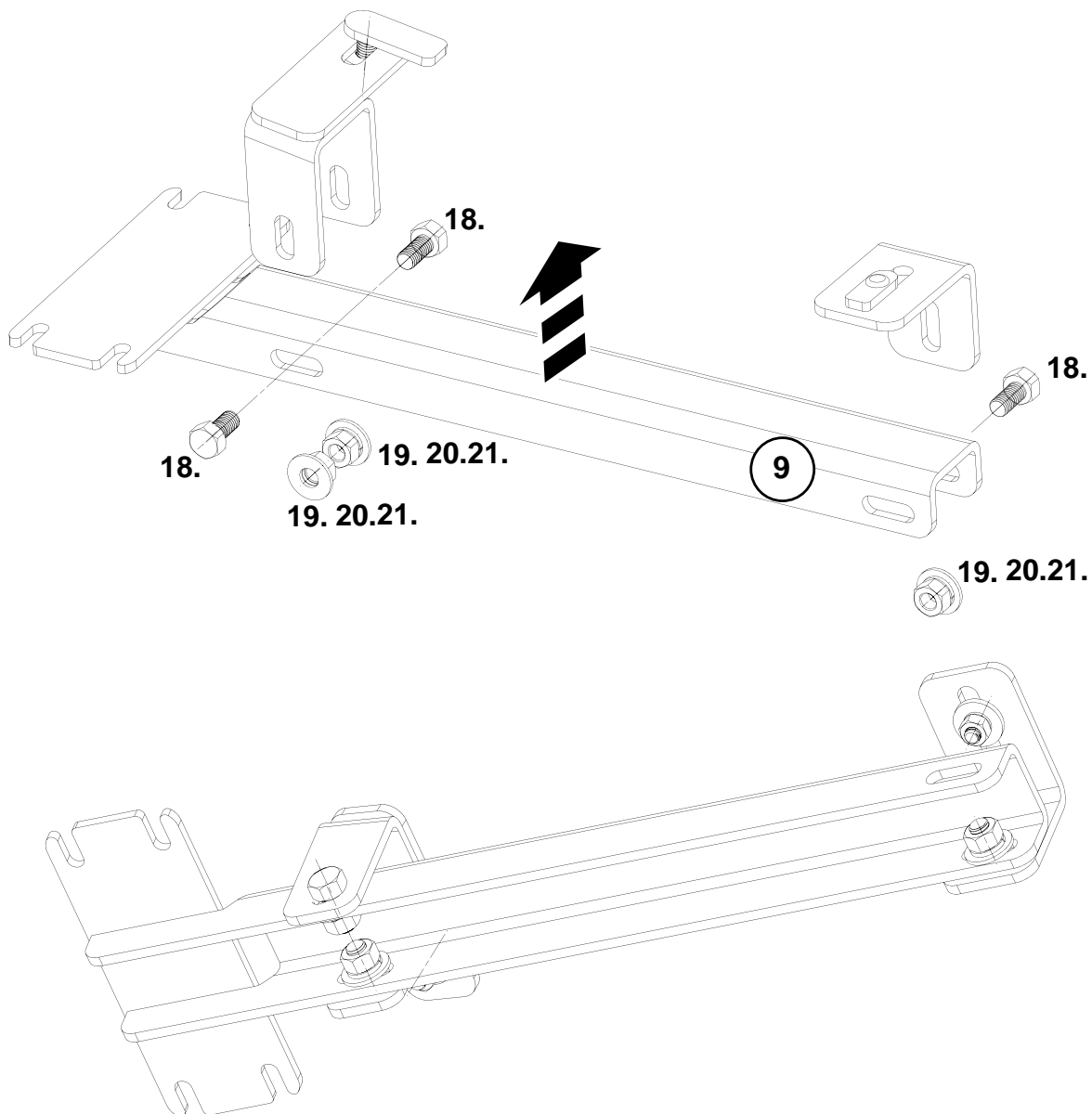
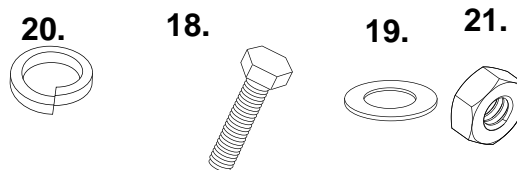

**Remove rubber plug****STEP 13**

Remove rubber plug.

**Install the M10 x 60 T-bolt****STEP 14**

Install the M10 x 60 T-bolt (22) in the hole as shown.

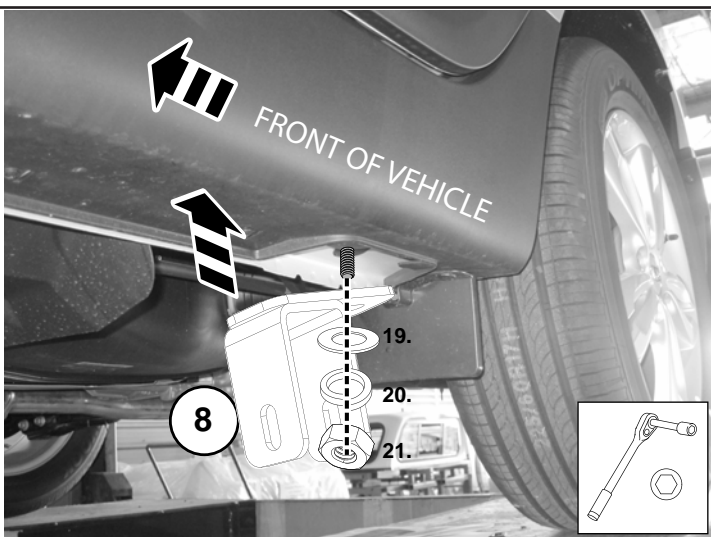
**Fit the Rear Outer Support Bracket****STEP 15**

Fit the Rear Outer Support Bracket (8) using the M10 Hex Nut (21), Spring Washer(20) and Flat Washer (19). Do not tighten at this point.

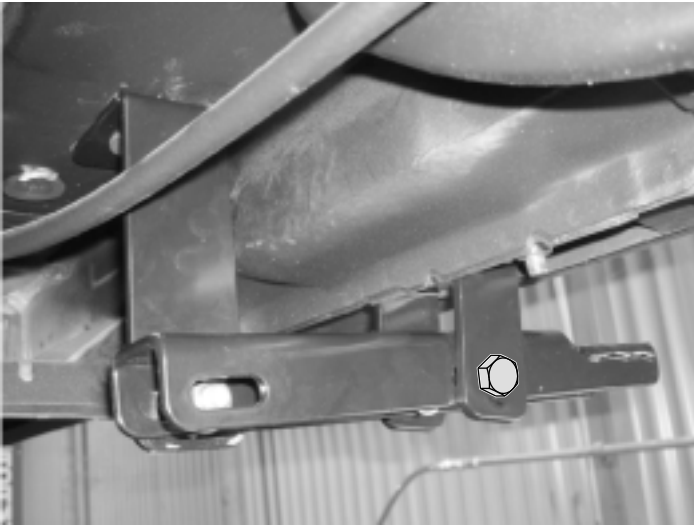

**Rear Support Bracket - LHS****STEP 16**

Fit the rear support bracket (11) using the M10x25 hex head bolt(18), 10.85 ID x25 ODx2.0 Flat washer (19), M10 spring washer (16) and M10 hex nut (17).

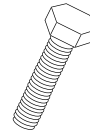
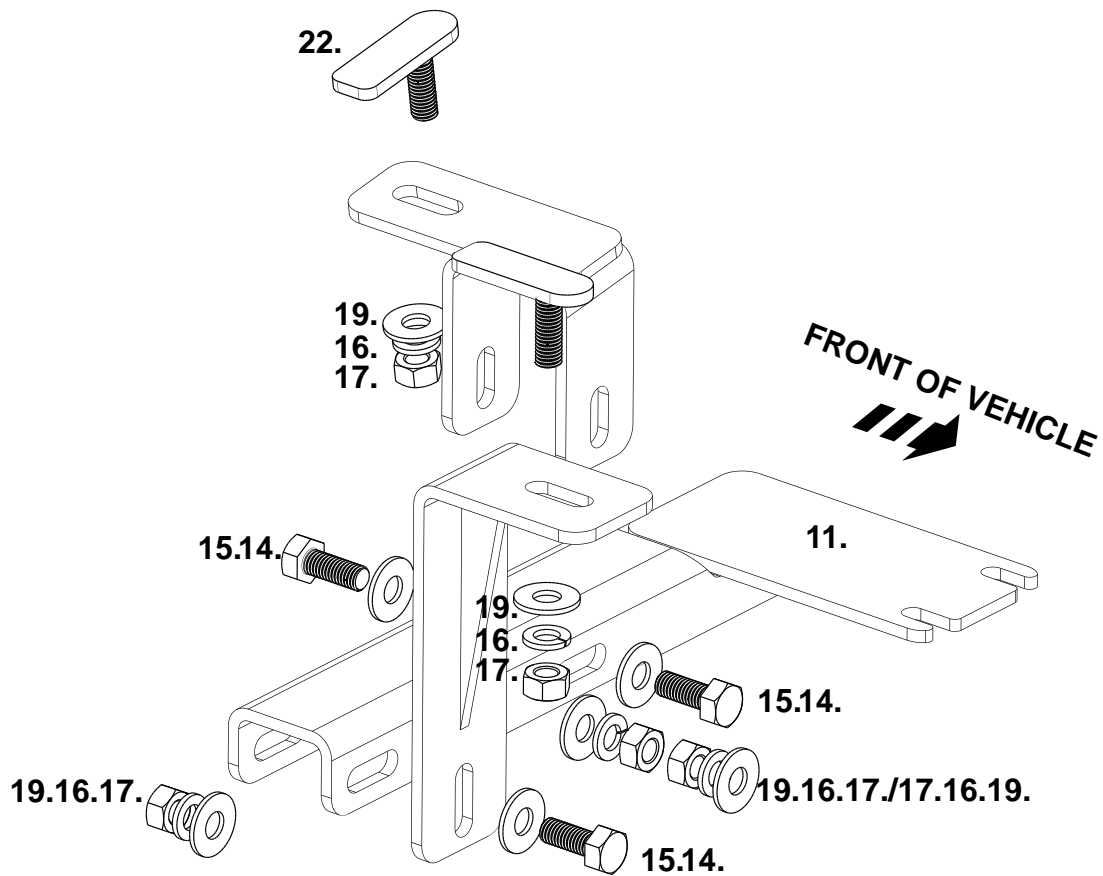
20.**18.****19.****21.**

**Remove screws****STEP 17**

Remove screws from the front mud flap - using a small star screw driver.

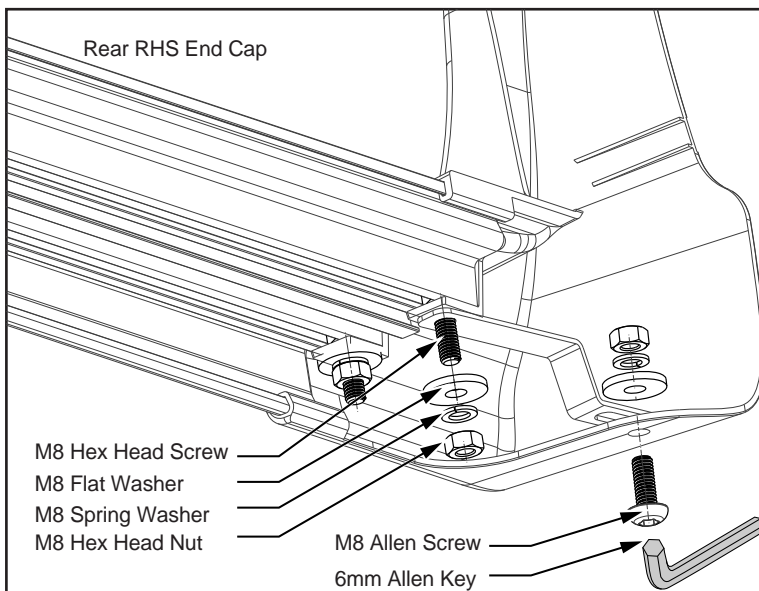

Rear RHS End Cap

M8 Hex Head Screw
M8 Flat Washer
M8 Spring Washer
M8 Hex Head NutM8 Allen Screw
6mm Allen Key**STEP 18**

Fit the end cap brace between extrusion and end cap, and loosely fasten internal bracket hole with M8 Hex Head Screw, M8 Flat Washer, M8 Spring Washer, and M8 Hex Head Nut. Loosely fasten outer bracket hole to end cap with M8 Allen Screw, M8 Flat Washer, M8 Spring Washer, and M8 Hex Head Nut.

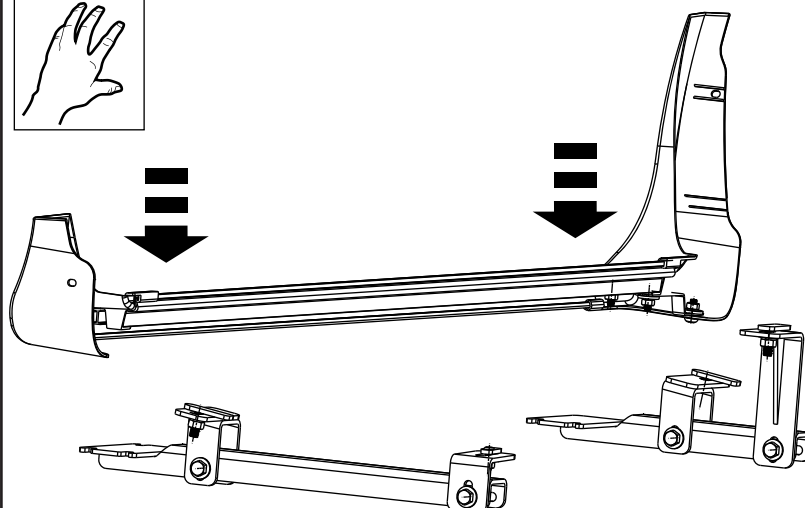
**STEP 19**

Carefully place the Aluminium Side Step on front and rear brackets.

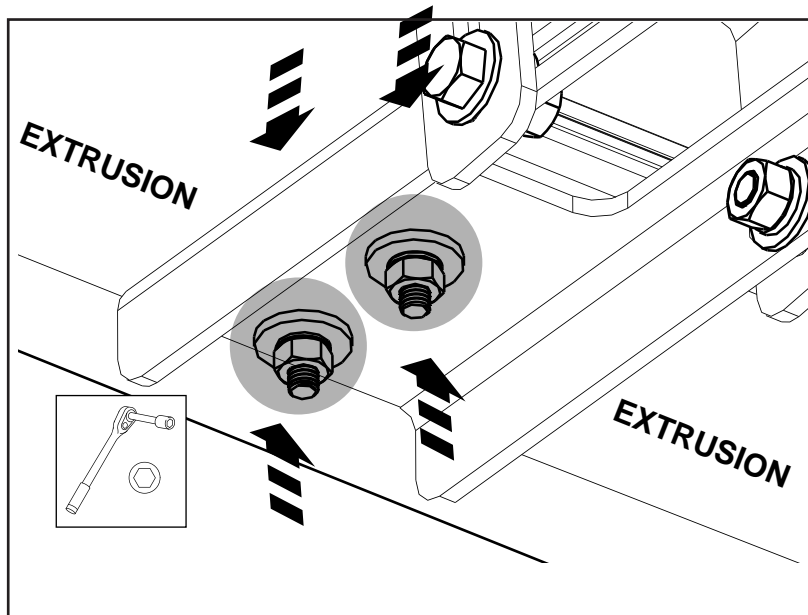
**STEP 20**

Tighten M8 Bolts, M8 Flat Washers, M8 Spring Washers and M8 nuts to brackets.

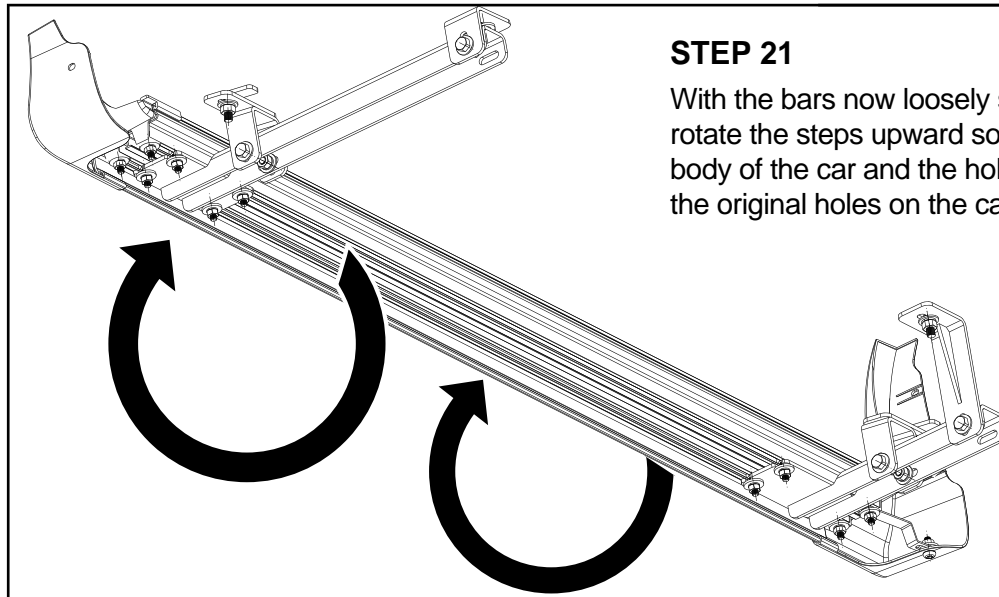
**STEP 21**

With the bars now loosely secured to the brackets, rotate the steps upward so that the end caps meet the body of the car and the holes in the caps line up with the original holes on the car.

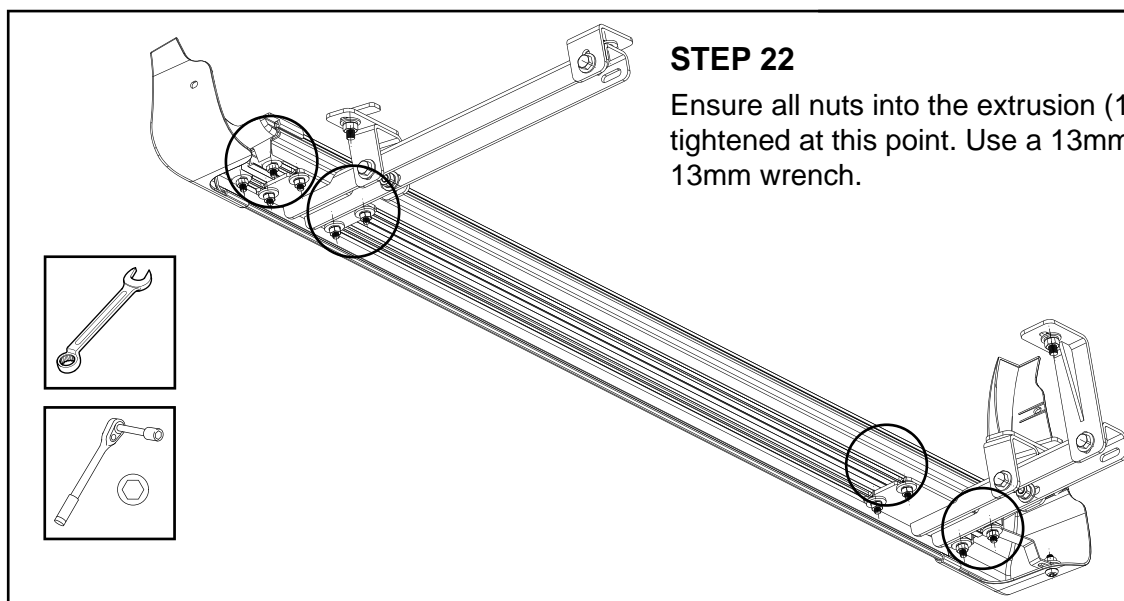
**STEP 22**

Ensure all nuts into the extrusion (10 off) are fully tightened at this point. Use a 13mm socket and 13mm wrench.

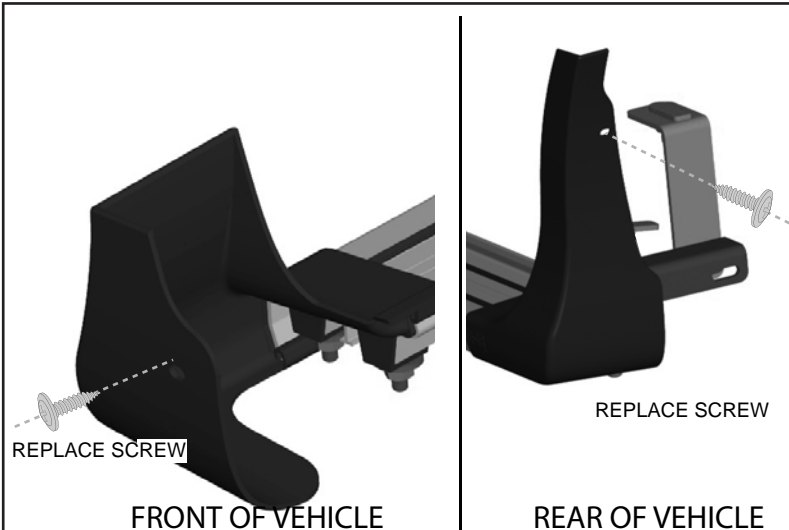
**Secure Front and Rear End Caps****STEP 23**

Once the Side Step is centralised, and the End Caps are fitting flush to the vehicle, replace the screws in the Front End Cap and Rear End Cap, and tighten all nuts.

Note: The additional bracket on the rear end cap is there to assist in insuring gaps to the vehicle are closed.

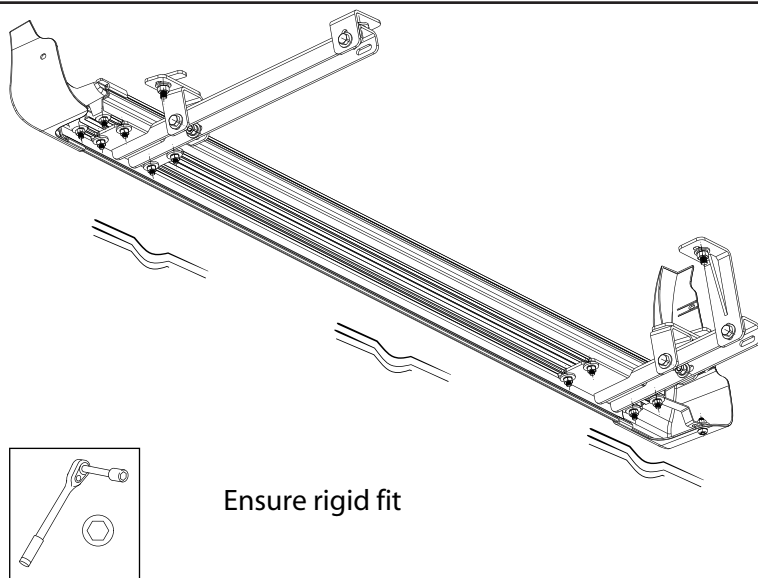
**STEP 24**

Re-check all fasteners have been tightened and there is no movement. Carefully place weight on the step for the first time to ensure that all fasteners and brackets are secure.

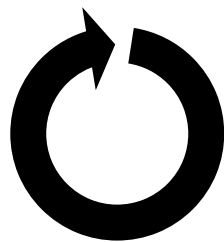

FOR
OPPOSITE SIDE

STEP 25

As brackets are identical, repeat steps 6-16 at the bracket locations for the opposite hand of the vehicle.

PRODUCT CARE INFORMATION



IMPORTANT:
CUT-OUT AND STAPLE IN A SUITABLE LOCATION IN VEHICLE'S OWNER MANUAL

HYUNDAI IX35 / TUCSON INTEGRATED SIDE STEPS

EGR

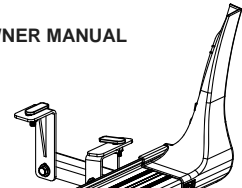

APPEARANCE AND PRODUCT CARE:

Wash regularly with car wash detergent, rinse with clean water and chamois. Stubborn grime can be removed with kerosene.

