

**BUYER'S  
GUIDE**



**PERFORMANCE CAT-BACK EXHAUST**

Stainless Steel Race Bullet Welded Muffler Assemblies  
 4-in. outlet, double wall, buffed and polished, 6-in. OAL Stainless Steel slant cut tips  
 3-in. Mandrel bent Stainless Steel system

**APPLICATIONS 39496**

2013-10 Camaro SS 6.2L V8 - Exc. Convertible  
 Single tailpipe models only

**15 HORSEPOWER**  
**15 LB.-FT. TORQUE**  
**IMPROVEMENT**

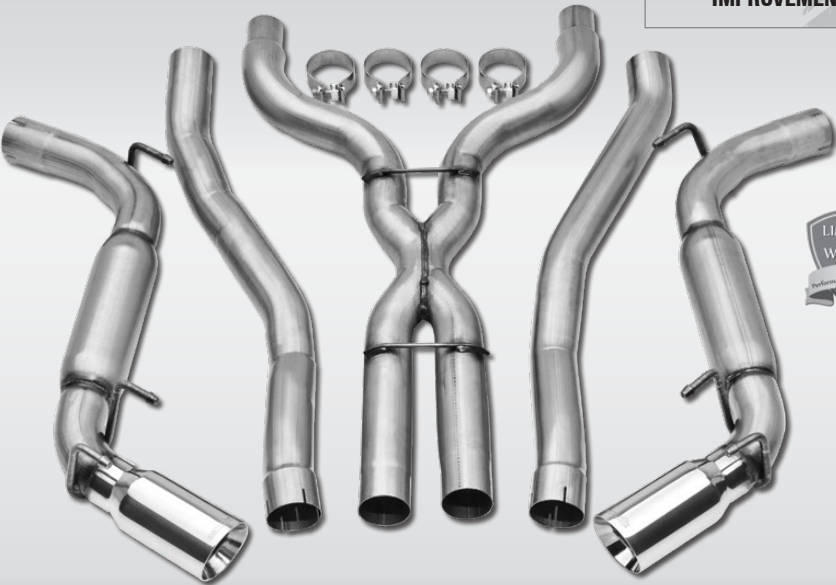

**PERFORMANCE AXLE-BACK EXHAUST**

Stainless Steel Ultra Flo™ Welded Muffler Assemblies  
 4-in. outlet, double wall, buffed and polished, 6-in. OAL Stainless Steel slant cut tips  
 2.5-in. Mandrel bent Stainless Steel system

**APPLICATIONS 39494**

2013-10 Camaro SS 6.2L V8 - Exc. Convertible  
 Single tailpipe models only

**14 HORSEPOWER**  
**15 LB.-FT. TORQUE**  
**IMPROVEMENT**

**APPLICATIONS 39493**

2014-10 Camaro 3.6L V6 - Exc. Convertible

**16 HORSEPOWER**  
**21 LB.-FT. TORQUE**  
**IMPROVEMENT**

**APPLICATIONS 39527**

2013-10 Camaro 6.2L V8 - Convertible only  
 Exc. Supercharger

**APPLICATIONS 39526**

2013-10 Camaro 3.6L V6 - Convertible only

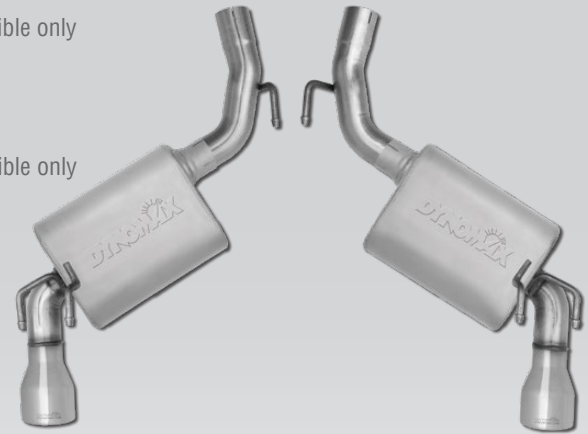

PART NO. F839527







## PERFORMANCE CAT-BACK EXHAUST

Stainless Steel Ultra Flo™ Polished Mufflers  
 3-in. outlet, double wall, buffed and polished, 6-in. OAL Stainless Steel quad tips  
 2.5-in. Mandrel bent Stainless Steel system

### APPLICATIONS **39462**

2013-08 Corvette 6.2L V8 LS3 Engine - Exc. 2011-09 ZR-1  
 2007-05 Corvette 6.0L V8 LS2 Engine

**8 HORSEPOWER**  
**11 LB.-FT. TORQUE**  
**IMPROVEMENT**

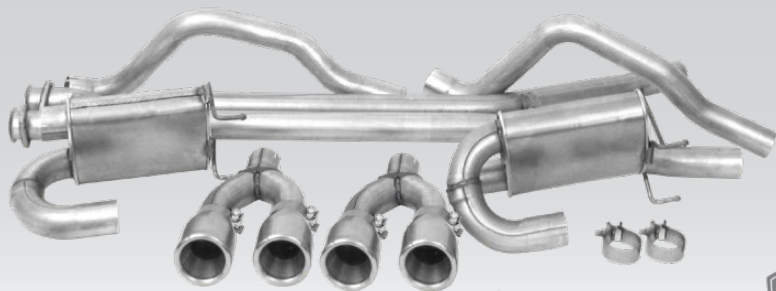

## PERFORMANCE CAT-BACK EXHAUST

Aluminized Steel Super Turbo™ Mufflers  
 Dual - 2.5-in. Aluminized system

### APPLICATIONS **19465**

1981-78 Corvette 5.7L  
 1980 Corvette 5.0L

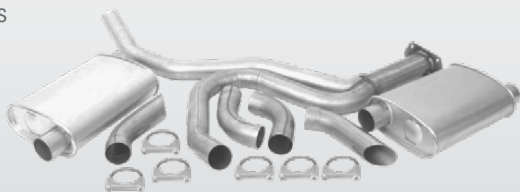

## PERFORMANCE CAT-BACK EXHAUST

Aluminized Steel Super Turbo™ Mufflers  
 2.5-in. outlet, double wall, buffed and polished, 12-in. OAL SS slant cut tips  
 Dual - 2.25 / 2.5-in. Aluminized system

### APPLICATIONS **19363**

2005-00 Monte Carlo 3.8L  
 - Inc. Supercharged  
 2005 Grand Prix 5.3LGXP  
 2005-97 Grand Prix 3.8LGTP  
 2004-97 Grand Prix 3.8LGT

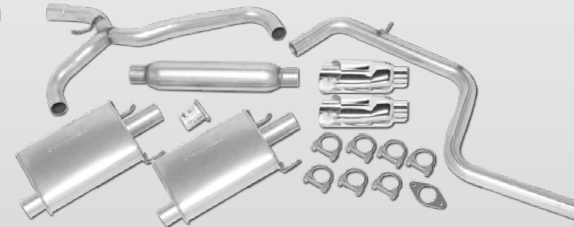

## PERFORMANCE CAT-BACK EXHAUST

Stainless Steel Ultra Flo™ Welded Mufflers  
 2.75-in. outlet, single wall, buffed and polished,  
 4x7-in. Stainless Steel slant cut tips  
 3-in. Mandrel bent Stainless Steel system

### APPLICATIONS **39484**

2014-08 SRT8 Challenger 6.1L, 6.4L HEMI

**24 HORSEPOWER**  
**23 LB.-FT. TORQUE**  
**IMPROVEMENT**

### APPLICATIONS **39490**

2014-09 R/T Challenger 5.7L HEMI

**11 HORSEPOWER**  
**24 LB.-FT. TORQUE**  
**IMPROVEMENT**

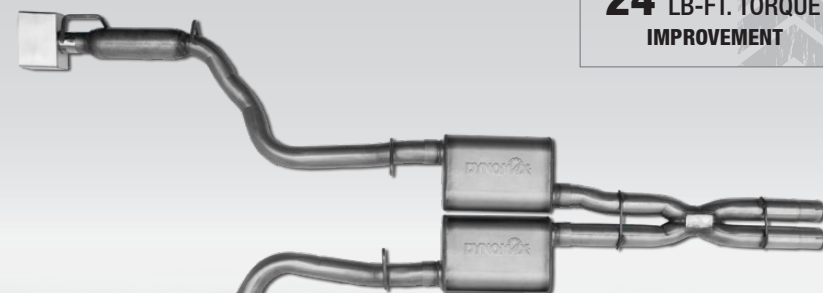

**PERFORMANCE CAT-BACK EXHAUST**

Stainless Steel Super Turbo™ Mufflers  
2.5-in. Mandrel bent Stainless Steel system

**APPLICATIONS 39518**

2014-11 R/T Charger 5.7L HEMI V8  
2014-11 R/T 300C 5.7L HEMI V8

**APPLICATIONS 39525**

2014-11 R/T Charger 3.6L V6  
2014-11 R/T 300 3.6L V6

**13** HORSEPOWER  
**24** LB-FT. TORQUE  
IMPROVEMENT

**9** HORSEPOWER  
**9** LB-FT. TORQUE  
IMPROVEMENT

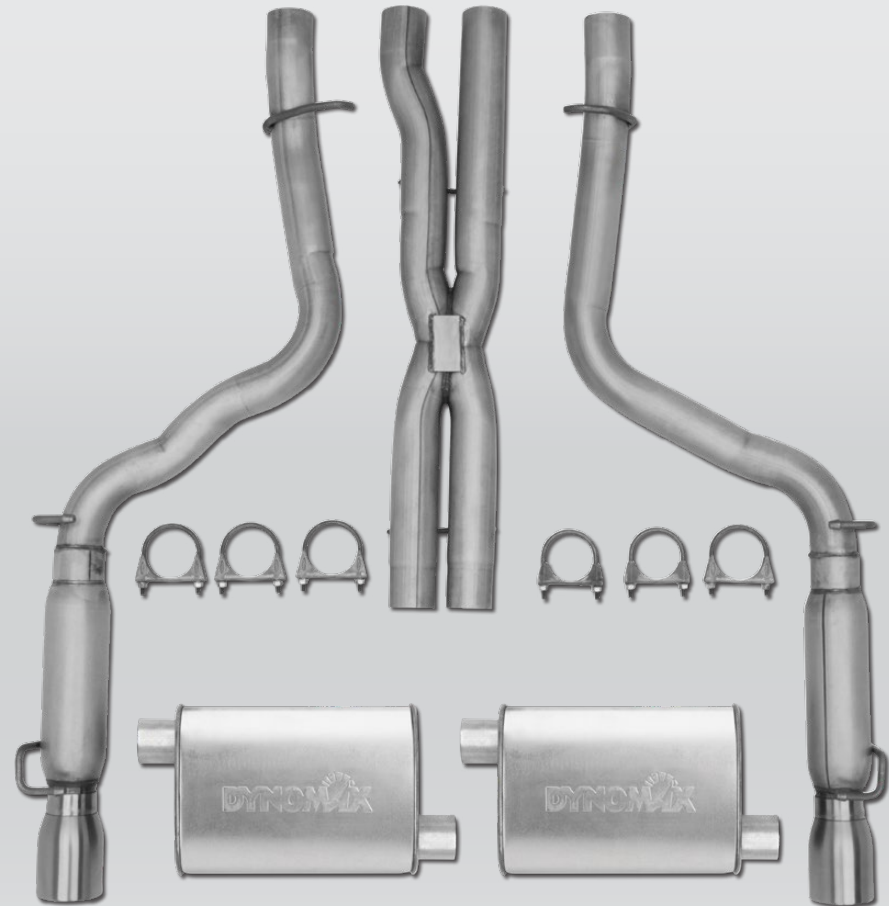
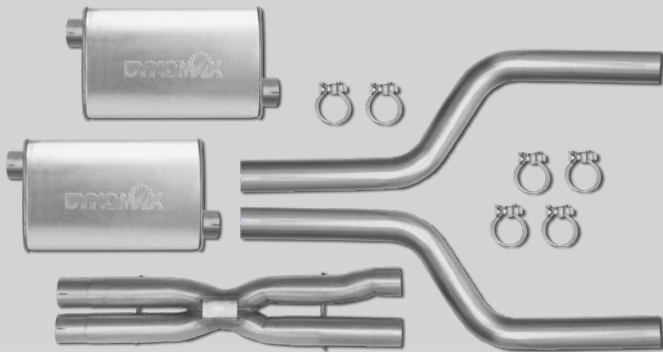

**PERFORMANCE CAT-BACK EXHAUST**

Aluminized Steel Super Turbo™ Mufflers  
3-in. outlet, double wall, buffed and polished, 6-in. OAL SS slant cut tips  
2.5-in. Aluminized system

**APPLICATIONS 19412**

2010-06 R/T Charger 5.7L HEMI V8  
2010-05 R/T 300C 5.7L HEMI V8  
2010-05 R/T Magnum 5.7L HEMI V8

**APPLICATIONS 19422**

2010-06 Charger 3.5L V6  
2010-05 300 3.5L V6





## PERFORMANCE CAT-BACK EXHAUST

Stainless Steel Race Bullet Welded Muffler Assemblies  
 4-in. outlet, double wall, buffed and polished, 9-in. OAL Stainless Steel slant cut tips  
 3-in. Mandrel bent Stainless Steel system

### APPLICATIONS **39505**

2014-12 Mustang BOSS 302 5.0L V8  
 2014-11 Mustang GT 5.0L V8  
 2013-11 Mustang Shelby GT500 5.4L, 5.8L V8  
 Single tailpipe models only

**16** HORSEPOWER  
**16** LB.-FT. TORQUE  
 IMPROVEMENT

### APPLICATIONS **39460**

2009-08 Mustang 4.6L  
 2009-05 Mustang 4.6L - GT  
 2008-07 Mustang 4.6L - Shelby GT  
 2009-07 Mustang 5.4L - Shelby GT500

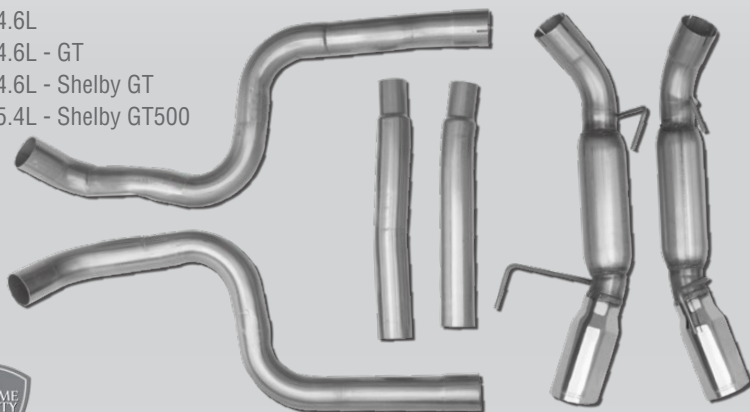

## PERFORMANCE AXLE-BACK EXHAUST

Stainless Steel Ultra Flo™ Welded Muffler Assemblies  
 3.5-in. outlet, double wall, buffed and polished, 10-in. OAL SS slant cut tips  
 2.75-in. Mandrel bent Stainless Steel tubing with O.E. spherical flare connection

### APPLICATIONS **39504**

2014-12 Mustang BOSS 302 5.0L V8  
 2014-11 Mustang GT 5.0L V8  
 2013-11 Mustang Shelby GT500 5.4L, 5.8L V8  
 Single tailpipe models only

**13** HORSEPOWER  
**13** LB.-FT. TORQUE  
 IMPROVEMENT

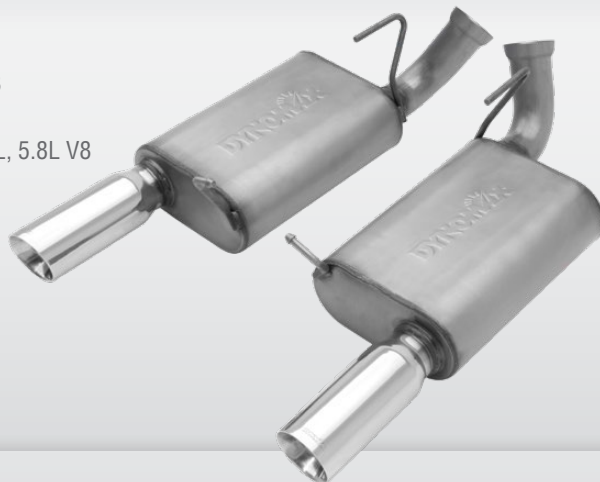

## PERFORMANCE CAT-BACK EXHAUST

Stainless Steel Ultra Flo™ Welded Muffler Assemblies  
 3.5-in. outlet, double wall, buffed and polished, 10-in. OAL Stainless Steel slant cut tips  
 2.5-in. Mandrel bent Stainless Steel system

### APPLICATIONS **39507**

2014-11 Mustang 3.7L V6



**11** HORSEPOWER  
**10** LB.-FT. TORQUE  
 IMPROVEMENT

### APPLICATIONS **39414**

2009-08 Mustang 4.6L  
 2009-05 Mustang 4.6L - GT  
 2009-07 Mustang 4.6L - Shelby GT  
 2009-07 Mustang 5.4L - Shelby GT500

### APPLICATIONS **39434**

2009-05 Mustang 4.0L

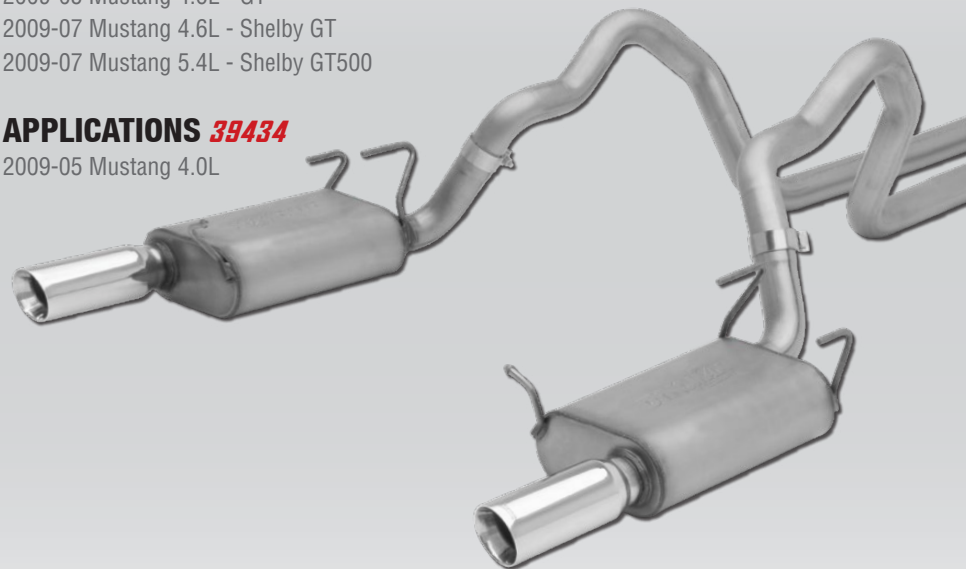





**2.5-IN. MANDREL BENT  
Stainless Steel System**

**SUPER TURBO™ MUFFLER**

**STAINLESS STEEL TIPS**

## **PERFORMANCE AXLE-BACK EXHAUST**

If you're looking for the perfect way to put a dual exit exhaust system on your Jeep® Wrangler JL look no further. Our Axle-Back system is easy to install, provides a fantastic sound, and looks great with the dual Stainless Steel tips.

- Super Turbo™ Muffler with 304 Stainless Steel polished cover
- 4-in. outlet, double wall, buffed and polished, 6-in. OAL Stainless Steel tips
- 2.5-in. Mandrel bent Stainless Steel system

### **APPLICATIONS 39536**

2018 Jeep® Wrangler JL  
2.0L Turbo I4, 3.6L V6



## **STAINLESS STEEL ELIMINATION PIPE**

The Jeep JL® Muffler Elimination Pipe makes quick and easy work of removing your vehicle's muffler. This muffler elimination pipe is easy to install, and delivers a deep performance tone. It is manufactured with mandrel bent, Stainless Steel pipe that will last for years to come. The Jeep JL Muffler Elimination Pipe is engineered to provide optimal ground clearance along with an improvement in horsepower & torque. This kit is designed to function with aftermarket suspension systems and frame/body protection accessories.

- Straight through design ensures unrestricted exhaust flow and reduces back pressure
- 2.5-in. Mandrel bent Stainless Steel tubing for lifelong protection
- Engineered for high ground clearance
- Provides increased sound and tone

### **APPLICATIONS 39537**

2018 Jeep® Wrangler JL 2.0L Turbo I4, 3.6L V6





## PERFORMANCE CAT-BACK EXHAUST

Stainless Steel Ultra Flo™ Welded Muffler  
3-in. outlet, single wall, buffed and polished, 12-in. OAL Stainless Steel slant cut tip  
2.5-in. Mandrel bent Stainless Steel system

### APPLICATIONS 39517

2018-12 Jeep® JK 4 Door 3.6L V6

### APPLICATIONS 39515

2018-12 Jeep® JK 2 Door 3.6L V6

### APPLICATIONS 39456

2011-07 Jeep® JK 4 Door 3.8L V6

### APPLICATIONS 39446

2011-07 Jeep® JK 2 Door 3.8L V6

**13** HORSEPOWER  
**12** LB-FT. TORQUE  
IMPROVEMENT



## EVOLUTION COMPETITION PERFORMANCE EXHAUST

Stainless Steel Ultra Flo™ Polished Muffler  
2.5-in. Mandrel bent Stainless Steel system  
Two Stainless Steel 2.5-in. band clamps



### APPLICATIONS 39522

2018-12 Jeep® JK 4 Door 3.6L V6

### APPLICATIONS 39516

2011-07 Jeep® JK 4 Door 3.8L V6



### EVOLUTION COMPETITION SYSTEM

For off-road use only - exhaust exits under vehicle



## PERFORMANCE CAT-BACK EXHAUST

Stainless Steel Ultra Flo™ Polished Muffler  
High-clearance off-road "Rockcrawler" design  
3-in. outlet, single wall, buffed and polished, 6-in. OAL Stainless Steel slant cut tip  
2.5-in. Mandrel bent Stainless Steel system

### APPLICATIONS 39523

2018-12 Jeep® JK 4 Door 3.6L V6

### APPLICATIONS 39524

2018-12 Jeep® JK 2 Door 3.6L V6

### APPLICATIONS 39459

2011-07 Jeep® JK 4 Door 3.8L V6

### APPLICATIONS 39464

2011-07 Jeep® JK 2 Door 3.8L V6



HIGH CLEARANCE OFF-ROAD  
"ROCKCRAWLER" DESIGN

## STAINLESS STEEL EXHAUST PIPE KIT

Prevents contact between the exhaust crossover pipe and front drive-shaft  
Clearance is optimized for 2 - 5-in. lifted 2018-12 Jeep® Wranglers equipped with the 3.6L V6  
Allows more drive-shaft clearance and suspension down travel than exhaust spacers  
Includes all necessary clamps, hardware, and detailed installation instructions  
Mandrel-bent 409 Stainless Steel tubing  
Retains equalized OEM down pipe

### APPLICATIONS 88347

2018-12 Jeep® JK 2/4 Door 3.6L V6  
with 2 - 5-in. lift height





## **PERFORMANCE AXLE-BACK EXHAUST**

Aluminized Steel Super Turbo™ Muffler Assembly  
3-in. outlet, single wall, buffed and polished, 5.5-in. OAL Stainless Steel slant cut tips  
2.5-in. Mandrel bent Stainless Steel tubing

### **APPLICATIONS 39510**

2018-07 Jeep® JK 2/4 Door 3.6L, 3.8L V6

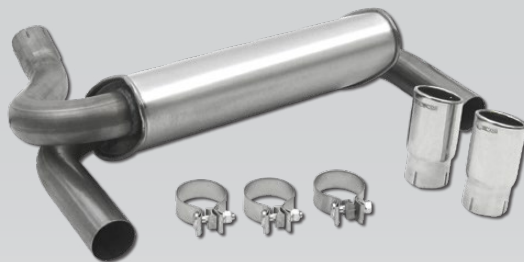

## **PERFORMANCE AXLE-BACK EXHAUST**

Super Turbo™ Muffler with 304 Stainless Steel polished cover  
4-in. outlet, double wall, buffed and polished, 6-in. OAL Stainless Steel slant cut tips  
2.5-in. Mandrel bent Stainless Steel tubing

### **APPLICATIONS 39528**

2018-07 Jeep® JK 2/4 Door 3.6L, 3.8L V6



## **PERFORMANCE CAT-BACK EXHAUST**

Stainless Steel Ultra Flo™ Welded Mufflers  
4-in. outlet, double wall, buffed and polished, 6-in. OAL Stainless Steel slant cut tips  
2.5-in. Mandrel bent Stainless Steel system

### **APPLICATIONS 39513**

2014-11 Jeep® Grand Cherokee 5.7L V8

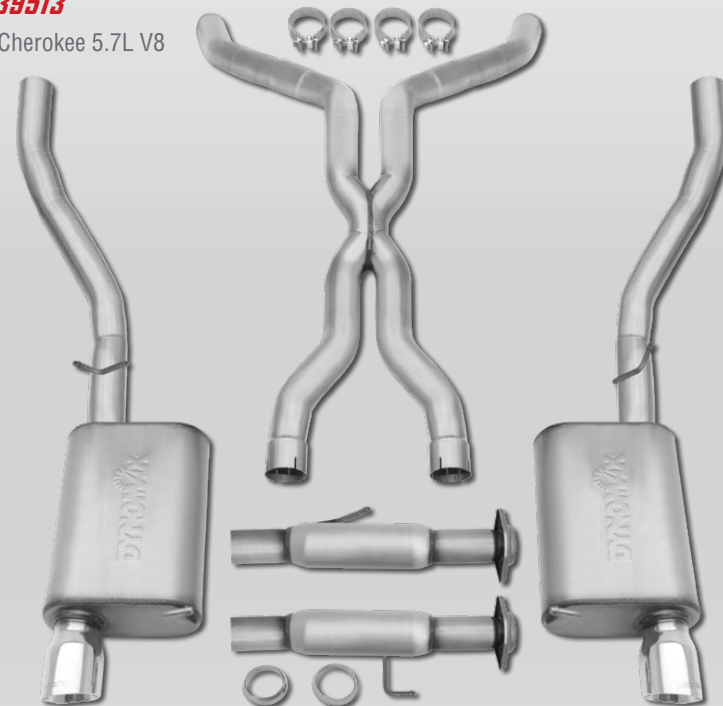



**PERFORMANCE CAT-BACK EXHAUST**

Aluminized Steel Super Turbo™ Muffler  
 3-in. 304 Stainless Steel spout on tailpipe  
 2.5-in. Aluminized system

**APPLICATIONS 19392**

2004-02 Jeep® Liberty 3.7L

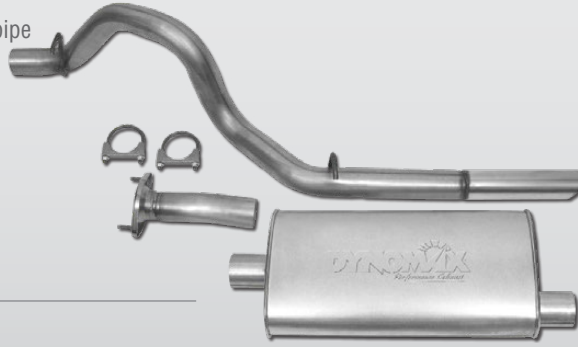

**PERFORMANCE CAT-BACK EXHAUST**

Aluminized Steel Super Turbo™ Muffler  
 3-in. 304 Stainless Steel spout on tailpipe  
 2.5 / 2.25-in. Aluminized system

**APPLICATIONS 19312**

2001-99 Jeep® Cherokee 4.0L, 4.7L

**APPLICATIONS 17340**

2001-93 Jeep® Cherokee 4.0L



**PERFORMANCE CAT-BACK EXHAUST**

Steel Super Turbo™ Muffler  
 Single - 2.25-in. Aluminized system

**APPLICATIONS 17463**

1992-87 Jeep® Cherokee/Wagoneer 2.5L, 4.0L

**APPLICATIONS 17403**

1997-93 Jeep® Cherokee/Wagoneer 4.0L, 5.2L



**PERFORMANCE CAT-BACK EXHAUST**

Steel Ultra Flo™ Welded Muffler  
 4-in. outlet, single wall, buffed and polished,  
 12-in. OAL Stainless Steel slant cut tip  
 Single - 2.5-in. Aluminized system

**APPLICATIONS 19421**

2006-05 Jeep® Cherokee/Commander  
 3.7, 4.7 and 5.7L



**PERFORMANCE CAT-BACK EXHAUST**

Steel Super Turbo™ Muffler  
 2.5-in. 304 Stainless Steel spout on tailpipe  
 2.5-in. Mandrel bent Stainless Steel system

**APPLICATIONS 19391**

2006-00 Jeep® TJ 4.0L - After 1-24-2000  
 - Exc. Unlimited



**PERFORMANCE CAT-BACK EXHAUST**

Steel Super Turbo™ Muffler  
 2.5-in. 304 Stainless Steel spout on tailpipe  
 Single - 2.25-in. Aluminized system

**APPLICATIONS 17345**

2000-97 Jeep® TJ 2.5L, 4.0L



**PERFORMANCE CAT-BACK EXHAUST**

Steel Super Turbo™ Muffler  
 2.5-in. 304 Stainless Steel spout on tailpipe  
 2.25-in. Aluminized system

**APPLICATIONS 17309**

1996-91 Jeep® YJ 4.0L

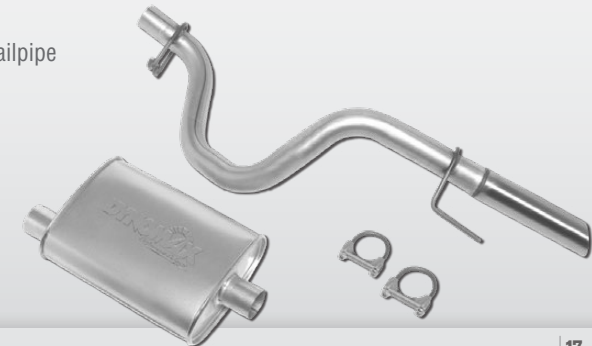



**PERFORMANCE CAT-BACK EXHAUST**

Stainless Steel Ultra Flo™ Welded Muffler  
 3-in. outlet, single wall, buffed and polished, 12-in. OAL Stainless Steel slant cut tips  
 2.5-in. Mandrel bent Stainless Steel system

**APPLICATIONS 39530**

2018-14 Silv./Sierra 1500 5.3L V8 -  
 143.5-in. and 153-in. WB.

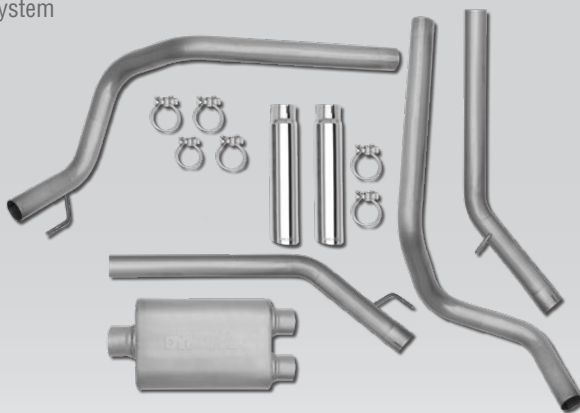

**24 HORSEPOWER**  
**32 LB.-FT. TORQUE**  
**IMPROVEMENT**

**APPLICATIONS 39499**

2013-09 Silv./Sierra 1500 4.8L, 5.3L V8 - 143-in. WB.



**PERFORMANCE CAT-BACK EXHAUST**

Stainless Steel Ultra Flo™ Welded Muffler  
 4-in. outlet, single wall, buffed and polished,  
 12-in. OAL Stainless Steel slant cut tip  
 Single - 3-in. Mandrel bent Stainless Steel system

**APPLICATIONS 39529**

2018-14 Silv./Sierra 1500 5.3L V8 -  
 143.5-in. and 153-in. WB.

YEAR	PART NUMBER	MODEL	SYSTEM INFO
13-09	39495	Silverado/Sierra 1500 4.8L, 5.3L V8 143-in. WB.	Single 3-in. Ultra Flo™ Welded Cat-Back system. 4-in. Tip
13-09	39497	Silverado/Sierra 1500 4.8L, 5.3L V8 133-in. WB.	Single 3-in. Ultra Flo™ Welded Cat-Back system. 4-in. Tip

**PERFORMANCE CAT-BACK EXHAUST**

Steel Super Turbo™ Muffler  
 Single - 3-in. Aluminized system

**APPLICATIONS 17380**

1995-94 C/K 1500/2500 4.3L, 5.0L, 5.7L - 141.5-in. WB. Under 8500 G.V.W.R.

**APPLICATIONS 17381**

1995-94 C/K 1500/2500 4.3L, 5.0L, 5.7L - Std. cab, long bed. Under 8500 G.V.W.R.

**APPLICATIONS 17382**

1995-94 C/K 1500 4.3L, 5.0L, 5.7L - 117.5-in. WB.



**PERFORMANCE CAT-BACK EXHAUST**

Steel Super Turbo™ Muffler  
 Single - 2.5-in. Aluminized system

**APPLICATIONS 17450**

1993-88 C/K 1500/2500 4.3L, 5.0L - Std cab, short bed; Std cab, long bed.



**PERFORMANCE CAT-BACK EXHAUST**

Stainless Steel Ultra Flo™ Welded Muffler  
 4-in. outlet, double wall, buffed and polished, 12-in. OAL Stainless Steel slant cut tip  
 3-in. Mandrel bent Stainless Steel system

**APPLICATIONS 39501**

2012-09 Colorado/Canyon 5.3L V8



**22 HORSEPOWER**  
**26 LB.-FT. TORQUE**  
**IMPROVEMENT**





## PERFORMANCE CAT-BACK EXHAUST

Stainless Steel Ultra Flo™ Welded Muffler  
 5-in. outlet, single wall, buffed & polished, 18-in. OAL SS slant cut tip  
 4-in. Mandrel bent Stainless Steel system  
 System covers all wheel bases

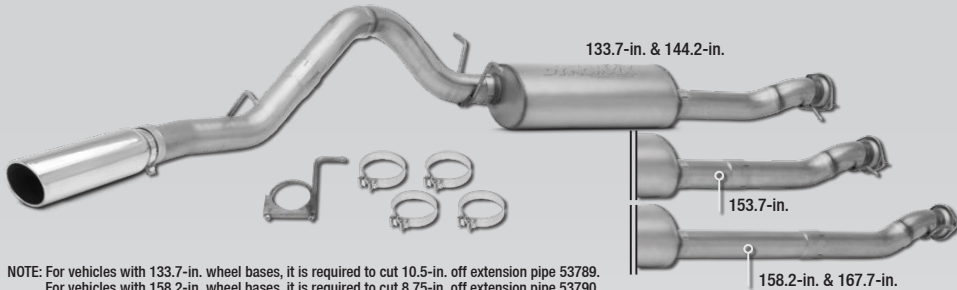

NOTE: For vehicles with 133.7-in. wheel bases, it is required to cut 10.5-in. off extension pipe 53789.  
 For vehicles with 158.2-in. wheel bases, it is required to cut 8.75-in. off extension pipe 53790.  
 (see installation instructions)

### APPLICATIONS 39511

2014-11 Silverado/Sierra  
 2500HD/3500HD 6.0L V8

**24 HORSEPOWER**  
**32 LB.-FT. TORQUE**  
**IMPROVEMENT**



YEAR	PART NUMBER	MODEL	SYSTEM INFO
10-07	39432	Silv./Sierra 2500/3500 6.0L, 8.1L V8 - Exc. Classic	Single 4-in. Ultra Flo™ Welded Cat-Back system. 5-in. Tip
07-00	39379	Silv./Sierra 2500HD/3500HD 6.0L, 8.1L V8 143-in. WB. - Exc Light duty	Single 4-in. Ultra Flo™ Welded Cat-Back system. 5-in. Tip
07-00	39378	Silv./Sierra 2500HD/3500HD 6.0L, 8.1L V8 153-in. WB. - Exc Light duty	Single 4-in. Ultra Flo™ Welded Cat-Back system. 5-in. Tip
07-99	39310	Silv./Sierra 2500 4.3L, 4.8L, 5.3L V8 143-in. WB. - Classic under 8600 G.V.W.R.	Dual 3/2.5-in. Ultra Flo™ Welded Cat-Back system. 3-in. Tips
07-99	39311	Silv./Sierra 2500 5.3L V8 143-in. WB. - Classic under 8600 G.V.W.R.	Single 3-in. Ultra Flo™ Welded Cat-Back system. 3-in. Tip
06-01	39375	Silv./Sierra 2500HD/3500 6.6L, Duramax 153-in. WB. - Exc. 6.6L LLY Engine	Single 4-in. Ultra Flo™ Welded Turbo-Back system. 5-in. Tip

## PERFORMANCE CAT-BACK EXHAUST

Steel Super Turbo™ Muffler  
 Single - 2.5-in. Aluminized system

### APPLICATIONS 19331

2004-00 S10 Blazer 4.3L 4 Door  
 2001-00 S10/S15 Blazer/Jimmy 4.3L 4 Door  
 2001-00 Bravada 4.3L 4 Door

### APPLICATIONS 17366

1999-95 S10/S15 Blazer/Jimmy  
 4.3L 4 Door

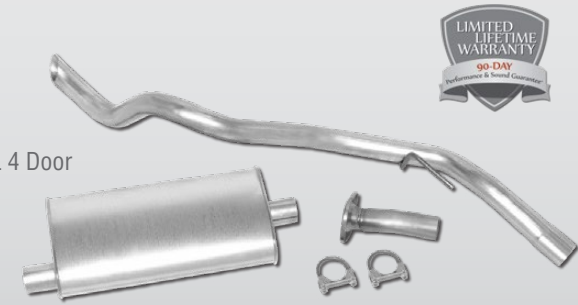

## PERFORMANCE CAT-BACK EXHAUST

Stainless Steel Ultra Flo™ Polished Muffler  
 3-in. outlet, double wall, buffed and polished, 6-in. OAL SS slant cut tips  
 2.5-in. Mandrel bent Stainless Steel system

### APPLICATIONS 39425

2009-06 H3 3.5L, 3.7L

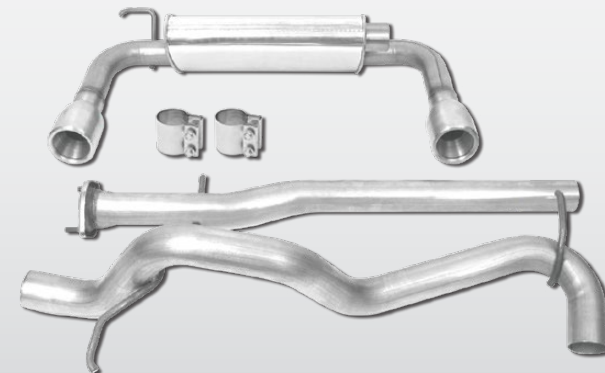

**PERFORMANCE CAT-BACK EXHAUST**

Stainless Steel Ultra Flo™ Polished Muffler  
 4-in. outlet, single wall, buffed and polished,  
 12-in. OAL SS slant cut tips  
 2.5-in. Mandrel bent Stainless Steel system

**APPLICATIONS 39480**

2017-09 Ram 1500 4.7L, 5.7L V8  
 Must be equipped with factory dual exhaust

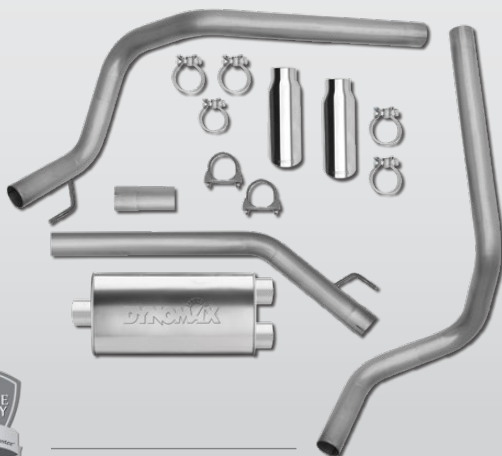

**9 HORSEPOWER**  
**13 LB.-FT. TORQUE**  
**IMPROVEMENT**

**PERFORMANCE CAT-BACK EXHAUST**

Stainless Steel Ultra Flo™ Welded Muffler  
 4-in. outlet, double wall, buffed and polished, 9-in. OAL SS slant cut tip  
 3-in. Mandrel bent Stainless Steel system

**APPLICATIONS 39498**

2017-09 Ram 1500 4.7L, 5.7L V8  
 120-in., 140-in. Wheel base

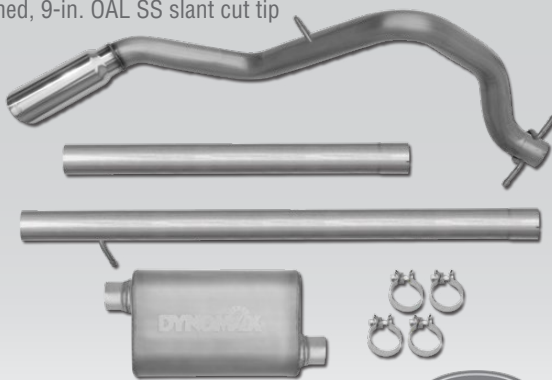

**10 HORSEPOWER**  
**15 LB.-FT. TORQUE**  
**IMPROVEMENT**

**PERFORMANCE CAT-BACK EXHAUST**

Steel Ultra Flo™ Welded Muffler  
 4-in. outlet slant cut tip  
 Single - 3-in. Aluminized system

**APPLICATIONS 19370**

2005-02 Ram 1500 3.7L, 4.7L, 5.9L -  
 Std. cab long bed; Quad cab, short bed



**PERFORMANCE CAT-BACK EXHAUST**

Steel Super Turbo™ Muffler  
 Dual - 2.5-in. Aluminized system

**APPLICATIONS 17322**

1999-94 Ram 1500 3.9L, 5.2L, 5.9L - Std. cab short/long  
 bed; Ext. cab short/long bed; Under 8800 G.V.W.R.



**PERFORMANCE DPF-BACK EXHAUST**

Stainless Steel Ultra Flo™ Welded Muffler  
 6-in. outlet, single wall, buffed and polished,  
 14-in. OAL Stainless Steel slant cut cooling tip  
 5-in. Mandrel bent Stainless Steel system

**APPLICATIONS 39491**

2013-07 Ram 2500/3500 6.7L V8



**PERFORMANCE TURBO-BACK EXHAUST**

Stainless Steel Ultra Flo™ Welded Muffler  
 5-in. outlet, single wall, buffed and polished,  
 18-in. OAL Stainless Steel slant cut tip  
 4-in. Mandrel bent Stainless Steel system

**APPLICATIONS 39461**

2008-04 Ram 2500/3500 5.9L Turbo Diesel



**PERFORMANCE TURBO-BACK EXHAUST**

Stainless Steel Ultra Flo™ Welded Muffler  
 5-in. outlet, single wall, buffed and polished,  
 18-in. OAL Stainless Steel slant cut tip  
 4-in. Mandrel bent Stainless Steel system

**APPLICATIONS 39377**

2002-94 Ram 2500HD/3500 5.9L Turbo Diesel



**PERFORMANCE CAT-BACK EXHAUST**

Stainless Steel Ultra Flo™ Welded Muffler  
 4-in. outlet, double wall, buffed and polished,  
 12-in. OAL Stainless Steel slant cut tip  
 3-in. Mandrel bent Stainless Steel system  
 System covers all wheel bases

**APPLICATIONS 39397**

2009-03 Ram 2500/3500 5.7L V8, 8.0L V10





**PERFORMANCE CAT-BACK EXHAUST**

Stainless Steel Ultra Flo™ Welded Muffler  
4-in. outlet, single wall, buffed and polished,  
12-in. OAL SS slant cut tip  
3-in. Mandrel bent Stainless Steel system  
System covers all wheel bases

**APPLICATIONS 39508**

2015-11 F150 5.0L V8

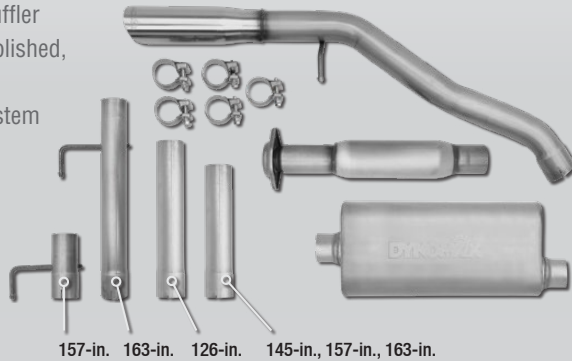

157-in. 163-in. 126-in. 145-in., 157-in., 163-in.



**PERFORMANCE CAT-BACK EXHAUST**

Stainless Steel Ultra Flo™ Welded Muffler  
3-in. outlet, single wall, buffed and polished,  
12-in. OAL SS slant cut tips  
Single - 2.5-in. Mandrel bent Stainless Steel system

**APPLICATIONS 39500**

2013-09 F150 4.6L, 5.4L V8  
144.5-in. Wheel Base



**PERFORMANCE CAT-BACK EXHAUST**

Stainless Steel Ultra Flo™ Polished Muffler  
Single - 2.5-in. Mandrel bent Stainless Steel system

**APPLICATIONS 39315**

12-98 Ranger 2.3L, 2.5L, 3.0L, 4.0L 126-in. WB.

YEAR	PART NUMBER	MODEL	SYSTEM INFO
10-09	39486	F150 4.6L, 5.4L V8 All Wheel Bases	Single 3-in. Ultra Flo™ Welded Cat-Back system. 4-in. Tip
08-05	39450	F150 4.2L V6, 5.4L V8 All Wheel Bases	Dual 2.5-in. Ultra Flo™ Welded Cat-Back system. 3-in. Tips
04-97	39321	F150 4.2L V6, 4.6L, 5.4L V8 120-in., 138-in., 157-in. Wheel base (Under 8500 GVW)	Dual 3/2.5-in. Ultra Flo™ Welded Cat-Back system. 3-in. Tips
97-95	17320	Ranger 2.3L, 3.0L, 4.0L Standard cab, short bed	2.25-in. Super Turbo™ Muffler Cat-Back system

**PERFORMANCE CAT-BACK EXHAUST**

Stainless Steel Ultra Flo™ Welded Muffler  
5-in. outlet, single wall, buffed and polished, 18-in. OAL Stainless Steel slant cut tip  
4-in. Mandrel bent SS system - "Y", tail and three extension pipes  
System covers all wheel bases

**APPLICATIONS 39506**

2016-11 F250/F350 Superduty 6.2L

**13 HORSEPOWER**  
**14 LB-FT. TORQUE**  
**IMPROVEMENT**

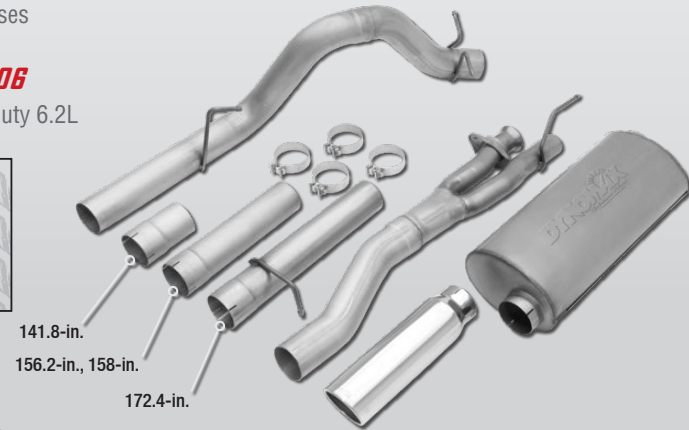

141.8-in.  
156.2-in., 158-in.  
172.4-in.



**PERFORMANCE DPF-BACK EXHAUST**

O.E. system has no muffler but a Diesel particulate filter  
6-in. outlet, single wall, buffed and polished,  
14-in. OAL stainless steel slant cut cooling tip  
5-in. Mandrel bent Stainless Steel system  
System covers all wheel bases

**APPLICATIONS 39509**

2014-11 F250/F350 Superduty 6.7L

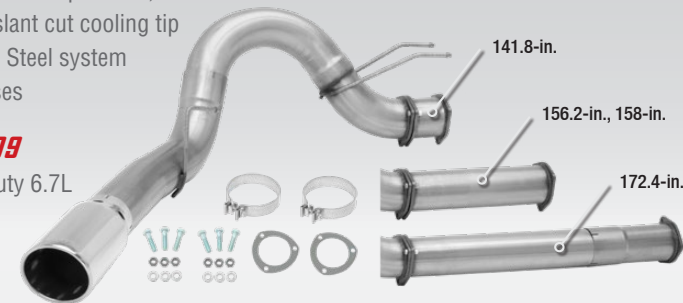

141.8-in.  
156.2-in., 158-in.  
172.4-in.

YEAR	PART NUMBER	MODEL	SYSTEM INFO
10-08	39492	F250/350 Superduty 6.4L	Single 5-in. Ultra Flo™ Welded DPF-Back system. 6-in. Tip
10-08	39469	F250/350 Superduty 5.4L V8, 6.8L V10	Single 3-in. Ultra Flo™ Welded Cat-Back system. 4-in. Tip
03-99	39376	F250/F350 Superduty 7.3L Power Stroke Turbo Diesel 137-in., 141.8-in., 156.2-in., 158-in., 172.4-in. Wheel Base	Single 4-in. Ultra Flo™ Welded Turbo-Back system. 5-in. Tip
04-97	39321	F250 4.2L V6, 4.6L, 5.4L V8 120-in., 138-in., 157-in. Wheel base (Under 8500 GVW)	Dual 3/2.5-in. Ultra Flo™ Welded Cat-Back system. 3-in. Tips
04-99	17313	F250/F350 5.4L, 6.8L Std. cab/Short bed, Crew/Short bed, Ext. cab/Long bed, Crew/Long bed	Dual 3/2.5-in. Super Turbo™ Cat-Back system.



**PERFORMANCE CAT-BACK EXHAUST**

Stainless Steel Ultra Flo™ Welded Muffler  
 3-in. outlet, single wall, buffed and polished, 12-in. OAL SS slant cut tips  
 2.5-in. Mandrel bent Stainless Steel system

**APPLICATIONS 39471**

2008-07 Tundra 5.7L V8 - 147.5-in. Wheel Base

**37 HORSEPOWER**  
**44 LB.-FT. TORQUE**  
**IMPROVEMENT**



**PERFORMANCE CAT-BACK EXHAUST**

Steel Super Turbo™ Muffler  
 3-in. 304 Stainless Steel spout on tailpipe  
 Single - 2.5-in. Aluminized system

**APPLICATIONS 19330**

2006-00 Tundra 3.4L, 4.7L



**PERFORMANCE CAT-BACK EXHAUST**

Steel Super Turbo™ Muffler  
 Single - 2-in. Aluminized system

**APPLICATIONS 17418**

1994-89 4Runner 2.4L, 3.0L - From 4-1-89;  
 Exc. 93-94 Calif. Intermediate pipe not included



**PERFORMANCE CAT-BACK EXHAUST**

Stainless Steel Ultra Flo™ Welded Muffler  
 3-in. outlet, single wall, buffed and polished, 12-in. OAL SS slant cut tip  
 2.5-in. Mandrel bent Stainless Steel system

**APPLICATIONS 39447**

2014-05 Tacoma 4.0L  
 Access cab, Double cab



**PERFORMANCE CAT-BACK EXHAUST**

Steel Super Turbo™ Muffler  
 3-in. outlet slant cut tip  
 Single - 2.25-in. Aluminized system

**APPLICATIONS 19481**

2000-96 Tacoma 2.7L - 103-in. wheel base,  
 4WD, Federal Emissions





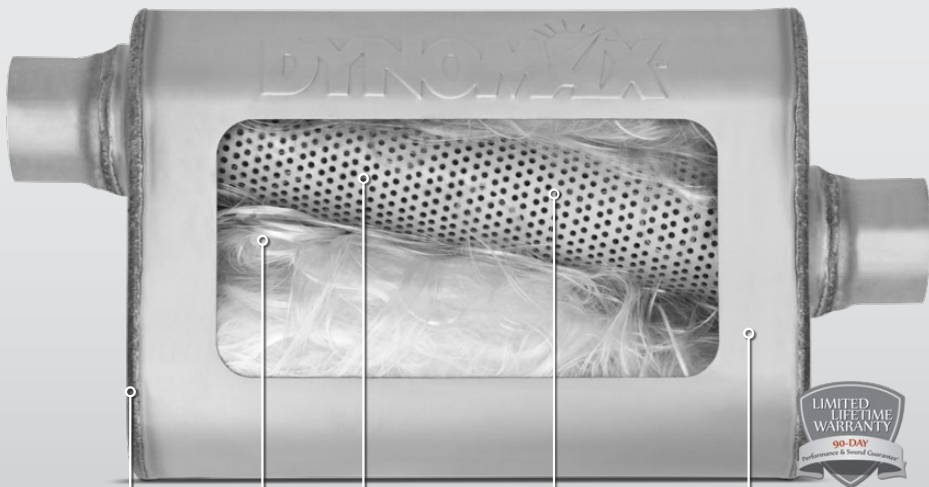

100-PERCENT WELDED

CRF TECHNOLOGY  
(Continuous Roving Fiberglass)

CONTINUOUS PERFORATED TUBE

STRAIGHT-THROUGH DESIGN

MICRO-FINISH STAINLESS STEEL CONSTRUCTION



## ULTRA FLO™ WELDED

Sound Level | DEEP PERFORMANCE TONE



CONFIGURATION CENTER - CENTER

PART NO. 17218  
17220  
17517



CONFIGURATION OFFSET - CENTER

PART NO. 17514  
17217  
17512  
17219  
17513  
17236  
17221  
17233  
17235



CONFIGURATION OFFSET - OFFSET

PART NO. 17226  
17222  
17229  
17547  
17557



CONFIGURATION CROSSFLOW

PART NO. 17227 17536 17577

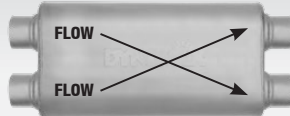

CONFIGURATION DUAL INLET - DUAL (X-TYPE)

PART NO. 17552  
17553  
17554



CONFIGURATION CENTER - DUAL

PART NO. 17234 17228



CONFIGURATION DUAL INLET - DUAL

PART NO. 17231



CONFIGURATION 6-in. ROUND

PART NO. 17230 17223  
17224 17225  
17537 21172  
22572



100-PERCENT WELDED

CRF TECHNOLOGY  
(Continuous Roving Fiberglass)

CONTINUOUS PERFORATED TUBE

MICRO-FINISH STAINLESS STEEL CONSTRUCTION



STRAIGHT-THROUGH DESIGN

## ULTRA FLO™ WELDED ROUND

Sound Level | DEEP PERFORMANCE TONE



SPUN-LOCK HEADS

POLISHED FINISH

CRF TECHNOLOGY  
(Continuous Roving Fiberglass)

CONTINUOUS PERFORATED TUBE

STRAIGHT-THROUGH DESIGN



STAINLESS STEEL CONSTRUCTION

## ULTRA FLO™ STAINLESS STEEL POLISHED

Sound Level | DEEP PERFORMANCE TONE



CONFIGURATION 6-in. ROUND

PART NO. 17263 17267 17296



CONFIGURATION OFFSET - CENTER

PART NO. 17282 17283 17289



CONFIGURATION CROSSFLOW

PART NO. 17266



CONFIGURATION CENTER - DUAL

PART NO. 17519 17273

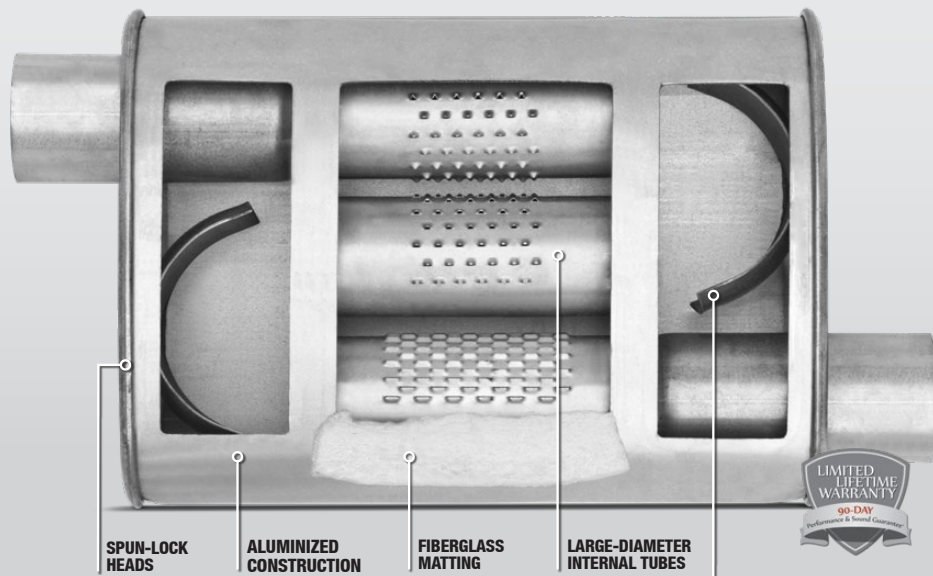

SPUN-LOCK HEADS

ALUMINIZED CONSTRUCTION

FIBERGLASS MATTING

LARGE-DIAMETER INTERNAL TUBES

FLOW DIRECTOR TECHNOLOGY



## SUPER TURBO™

Sound Level | MELLOW PERFORMANCE TONE



CONFIGURATION CAMARO STYLE

PART NO. 17739  
17670



CONFIGURATION CENTER - CENTER

PART NO. 17673



CONFIGURATION CENTER - DUAL

PART NO. 17758  
17674X  
17776



CONFIGURATION CROSSFLOW

PART NO. 17786



CONFIGURATION OFFSET - CENTER

PART NO. 17762 17733  
17730 17748  
17731 17797  
17767 17744★  
17747 17793  
17741 17769



CONFIGURATION OFFSET - OFFSET

PART NO. 17777  
17763  
17736  
17742  
17783#  
17729X  
17732  
17629X\*  
17662X



CONFIGURATION INLET/OUTLET SAME SIDE

PART NO. 17676



SLOTTED BUSHING ENDS

CRF TECHNOLOGY  
(Continuous Roving Fiberglass)

ALUMINIZED OR 409 STAINLESS STEEL CONSTRUCTION

100-PERCENT WELDED

STRAIGHT-THROUGH DESIGN

## RACE SERIES BULLET

Sound Level | DEEP RACE TONE



CONFIGURATION 4-in. ROUND

PART NO. 24215 24236  
24219 24234  
24222 24238  
24234 24246\*  
24235 24248\*



CONFIGURATION 5-in. ROUND

PART NO. 24216  
24217  
24243  
24244  
24245\*  
24247\*



CONFIGURATION 6-in. ROUND

PART NO. 24233\*



Sound Level | DEEP RACE TONE

## RACE SERIES MINI BULLET

AVAILABLE IN:

3.5-in. and 4-in. round mufflers  
3.5-in. and 6-in. shell length  
6.5-in. and 9-in. overall length

3-in., 3.5-in. and 4-in. inlet diameter  
3-in. and 3.5-in. OD outlet diameter



CONFIGURATION 3.5-in. ROUND

PART NO. 24249\*



CONFIGURATION 4-in. ROUND

PART NO. 24250\* 24251\* 24252\*

\* Stainless Steel Construction. ★ 2 1/2-in. Dia. Flow Tubes. # Includes Inlet Flange. ✕ No Flow Directors.

\* Stainless Steel Construction.