



Safety glasses should be worn at all times while installing this product.

YEARS: 2014-PRESENT

MAKE: NISSAN

MODEL: VERSA NOTE

STYLE: HATCHBACK







**WARNING: NEVER EXCEED YOUR VEHICLE MANUFACTURER'S RECOMMENDED TOWING CAPACITY**

**WEIGHT CARRYING:**  
 TRAILER WEIGHT: 2,000 LBS.  
 TONGUE WEIGHT: 200 LBS.

**PRO INSTALL TIME: 15 MIN.**  
**NOVICE INSTALL TIME: 30 MIN.**

IF YOU ARE HESITANT TO UNDERTAKE THIS TASK ON YOUR OWN, CONTACT AN AUTHORIZED CURT INSTALLER FOR ADDITIONAL ASSISTANCE.



**INSTALLATION REQUIRES:**

 RATCHET	 TORQUE WRENCH	 11/16" 3/4" SOCKET
 SCREW DRIVER	 ROTARY TOOL	 SAFETY GLASSES

**INSTALLATION TIPS:**

- BEFORE YOU BEGIN INSTALLATION, READ ALL INSTRUCTIONS THOROUGHLY.
- TO EASE INSTALLATION, 2 PEOPLE MAY BE REQUIRED.
- USING PROPER TOOLS WILL GREATLY IMPROVE THE QUALITY OF THE INSTALL AND REDUCE THE TIME REQUIRED.

**LEVEL OF DIFFICULTY: MODERATE**

<i>EASY</i>	<i>MODERATE</i>	<i>CHALLENGING</i>
	- NO DRILLING REQUIRED	
	- FASCIA TRIMMING REQUIRED	

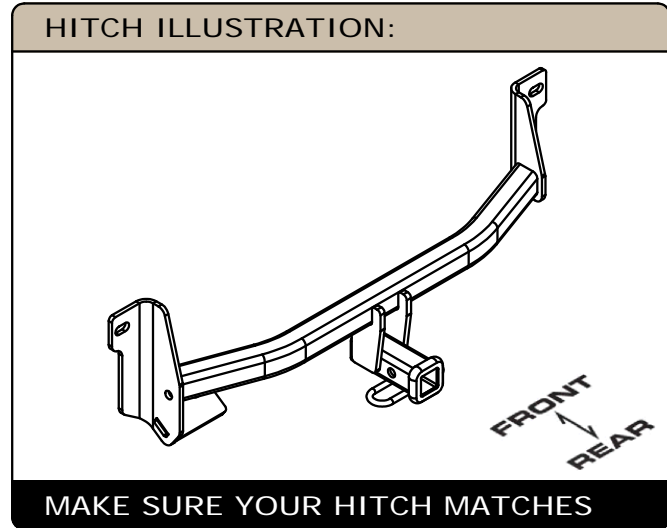

## INSTALLATION WALKTHROUGH:

Parts List

ITEM	QTY	PART NUMBER	DESCRIPTION
1	4	CM-SP16	.250 x 1.50 x 2.00" ROUND HOLE SPACER
2	1	1/2-13 x 1 3/4, GR8	CARRIAGE BOLT
3	2	7/16-14 x 1 1/2	CARRIAGE BOLT
4	1	HFN 1213, GR8	HEX FLANGE NUT
5	2	7/16-14	HEX FLANGE NUT

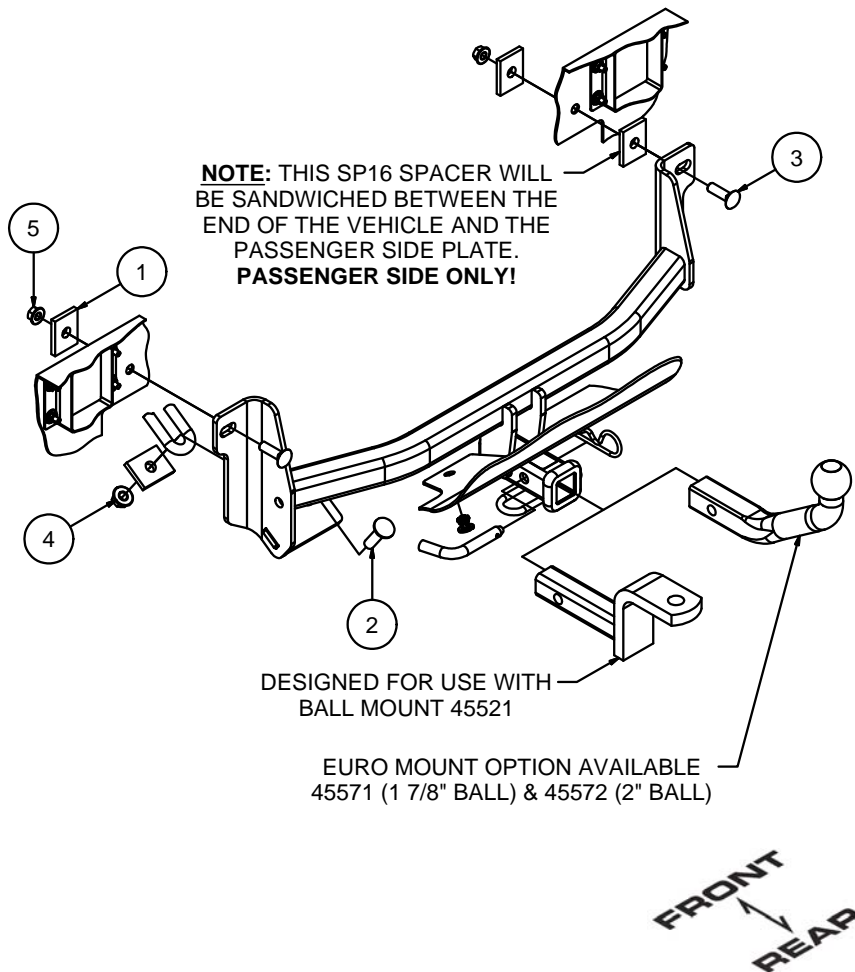

1. Remove (3) fascia fasteners. Retain fasteners for reinstallation.



2. Mark and trim rear fascia. **Note:** Dimensions are approximate, confirm fit prior to trimming. See Fascia Trim Diagram

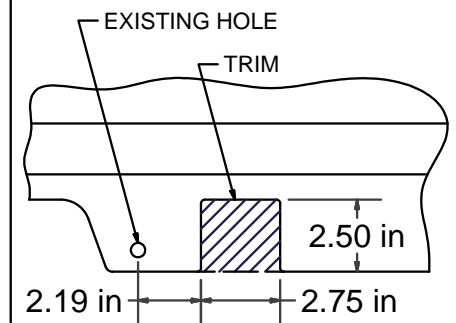
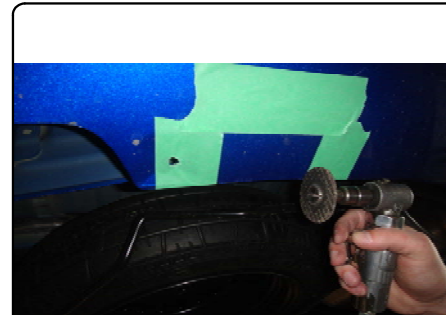

## INSTALLATION WALKTHROUGH:

3. Gently flex the bottom of the rear fascia back and raise hitch into position. Insert a 7/16"-14 x 1 1/2" carriage bolt through the driver side plate and out the existing hole. Insert a 7/16"-14 x 1 1/2" carriage bolt through the passenger side plate, a SP16 spacer, and out the existing hole. Secure both sides with a SP16 spacer and a 7/16"-14 hex flange nut.

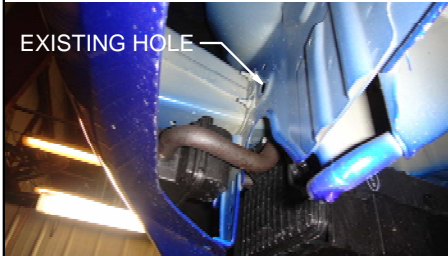

4. Insert a 1/2"-13 x 1 3/4" carriage bolt through the tow loop plate and out the tow loop. Secure with a SP16 spacer and a 1/2"-13 hex flange nut.



5. Torque all 7/16" hardware to 70 ft-lbs.  
Torque all 1/2" hardware to 110 ft-lbs.  
Reinstall (3) fascia fasteners removed in Step (1).

INSTALLATION COMPLETE



11378

NISSAN VERSA NOTE

GROSS LOAD CAPACITY WHEN USED AS A WEIGHT CARRYING HITCH: 2,000 LBS. TRAILER WEIGHT & 200 LBS. TONGUE WEIGHT.

\*\*\*DO NOT EXCEED VEHICLE MANUFACTURER'S RECOMMENDED TOWING CAPACITY.\*\*\*

WARNING: ALL NON-TRAILER LOADS APPLIED TO THIS PRODUCT MUST BE SUPPORTED BY 18050 STABILIZING STRAPS.

\*\* FAILURE TO PROPERLY SUPPORT NON-TRAILER LOADS WILL VOID PRODUCT WARRANTY\*\*

Parts List				
ITEM	QTY	PART NUMBER	DESCRIPTION	
1	4	CM-SP16	.250 x 1.50 x 2.00" ROUND HOLE SPACER	
2	1	1/2-13 x 1 3/4, GR8	CARRIAGE BOLT	
3	2	7/16-14 x 1 1/2	CARRIAGE BOLT	
4	1	HFN 1213, GR8	HEX FLANGE NUT	
5	2	7/16-14	HEX FLANGE NUT	

TOOLS REQUIRED
RATCHET
TORQUE WRENCH
11/16" SOCKET
3/4" SOCKET
SCREW DRIVER
ROTARY TOOL
SAFETY GLASSES

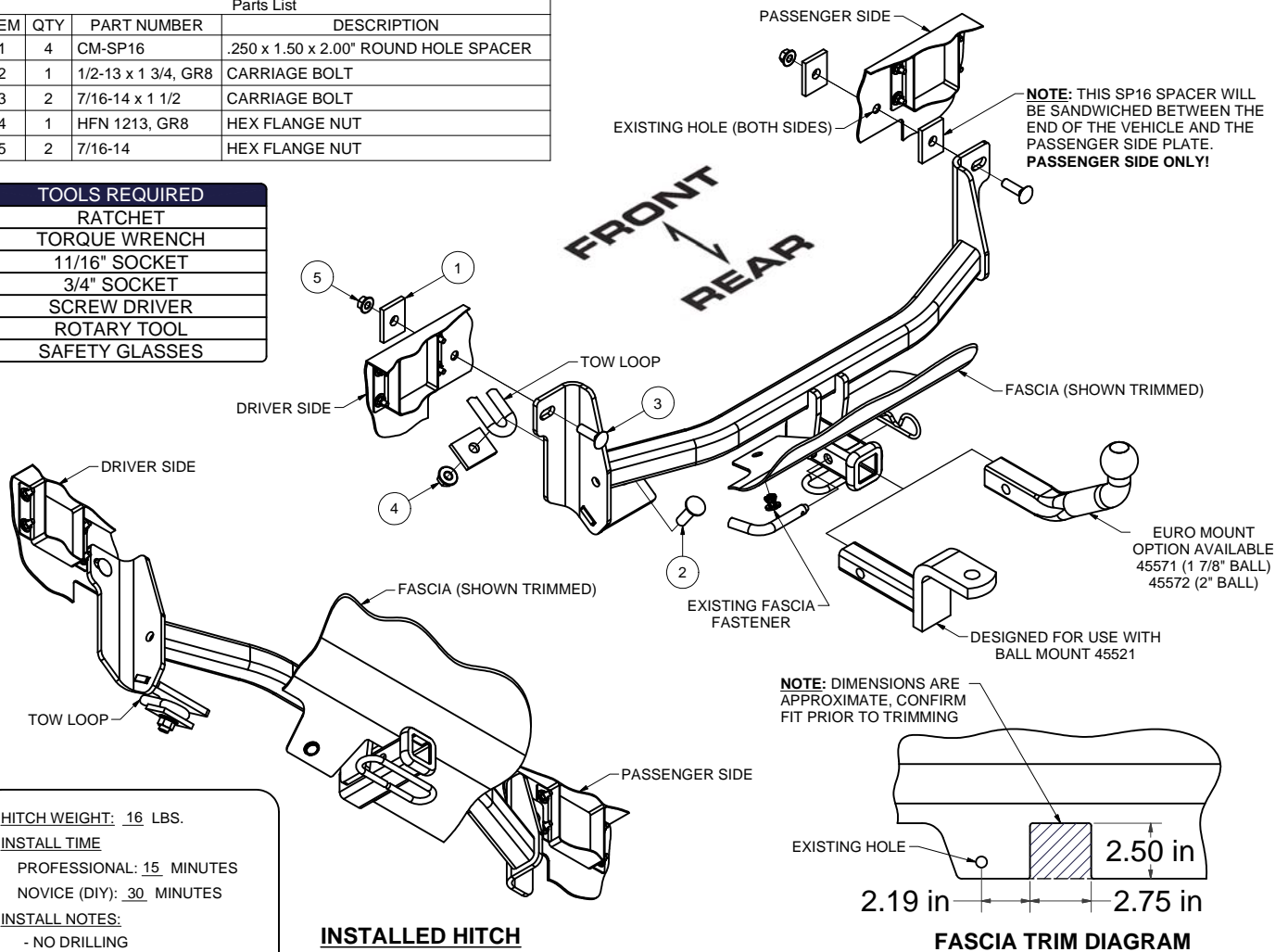

HITCH WEIGHT: 16 LBS.

INSTALL TIME

PROFESSIONAL: 15 MINUTES

NOVICE (DIY): 30 MINUTES

INSTALL NOTES:

- NO DRILLING
- FASCIA TRIMMING REQUIRED

INSTALLED HITCH

INSTALLATION STEPS

1. Remove (3) fascia fasteners. Retain fasteners for reinstallation.
2. Mark and trim rear fascia. **Note:** Dimensions are approximate, confirm fit prior to trimming. See Fascia Trim Diagram
3. Gently flex the bottom of the rear fascia back and raise hitch into position. Insert a 7/16"-14 x 1 1/2" carriage bolt through the driver side plate and out the existing hole. Insert a 7/16"-14 x 1 1/2" carriage bolt through the passenger side plate, a SP16 spacer, and out the existing hole. Secure both sides with a SP16 spacer and a 7/16"-14 hex flange nut.
4. Insert a 1/2"-13 x 1 3/4" carriage bolt through the tow loop plate and out the tow loop. Secure with a SP16 spacer and a 1/2"-13 hex flange nut.
5. Torque all 7/16" hardware to 70 ft-lbs.  
Torque all 1/2" hardware to 110 ft-lbs.
6. Reinstall (3) fascia fasteners removed in Step (1).

PERIODICALLY CHECK THIS RECEIVER HITCH TO ENSURE THAT ALL FASTENERS ARE TIGHT AND THAT ALL STRUCTURAL COMPONENTS ARE SOUND.