

CRUISER

ACCESSORIES

#1 IN FRAMES



2019 CATALOG

TABLE OF CONTENTS

Vault _____ 3

Adjustability _____ 4

Engineered _____ 5

Core _____ 6-8

Emblem/Licensed _____ 9

Graphics _____ 10

Lifestyle _____ 11

Fashion _____ 12-17

Motorcycle _____ 18-19

Combos _____ 20-21

Shields _____ 22

Hardware _____ 23-25

3d-Cals™ _____ 26-27

Display Racks _____ 28

CRUISER ACCESSORIES

"Passionately pursuing perfection to bring the ultimate value to the customer."

OUR PHILOSOPHY IS:

E A S Y

EXCELLENCE

- Attention to Detail
- Efficient
- Knowledgeable

ACCESSIBILITY

- Real People
- Listen
- Open Communications

SOLUTIONS

- Flexibility
- Integrity
- Values
- Positive

YES

- Relationships
- Teamwork
- "Can Do!" Attitude

EMPOWERMENT

IS IT RIGHT FOR THE CUSTOMER?

IS IT RIGHT FOR OUR COMPANY?

IS IT ETHICAL?

IS IT SOMETHING FOR WHICH YOU ARE WILLING TO BE

ACCOUNTABLE?

IS IT CONSISTENT WITH OUR COMPANY'S BASIC BELIEFS?

EASY

IF THE ANSWER IS "YES" TO ALL FIVE QUESTIONS,
DON'T ASK-

JUST DO IT!

CRUISER
ACCESSORIES
#1 IN FRAMES

VAULT®

TOTAL PROTECTION

VAULT®

62700 Black/Clear Patented

62730 Chrome/Clear Patented

62736 Red/Clear Patented



EASY SNAP ON/OFF SHIELD!

THEFT DETERRENT!

SKULL

58530 Chrome/Chrome/Black
Patent Pending

ADJUSTABILITY... A Cruiser Accessories' Innovation



BOTTOM Mount

MC SKULL



77130 Chrome/Chrome/Black w/fastener caps
Patent Pending



BOTTOM Mount



Look for this Exclusive Cruiser Accessories' Logo on the package.

ENGINEERED TO[®]

SHOW MORE PLATE



- Over 90% of the Cruiser Accessories' product line has been "Engineered To Show More Plate.[®]"
- Cruiser Accessories offers slotted holes allowing maximum frame adjustability on your vehicle to ensure state names and registration tags are not obstructed.
- Cruiser Accessories offers our Perimeter frame; allowing the entire license plate to fit INSIDE the frame.
- We have recently designed a frame where a removeable emblem can be installed on top or bottom of the frame allowing maximum plate visibility.

STAINLESS

21110 Stainless Steel Pg. 8



BEFORE



AFTER

COLORADO

19
0723

CHAIN

20530 Chrome Pg. 14



BEFORE



AFTER

PERIMETER

30630 Chrome Pg. 8



Plate sits INSIDE frame,
**SHOWING ENTIRE
PLATE!**



NEO

15030 Chrome



15050 Black



NEO CLASSIC

15330 Chrome



15350 Black



NEO SPORT

15130 Chrome



15180 Black Chrome



15190 Brushed Nickel



CLASSIC LITE

20030 Chrome



20050 Black



CLASSIC

20130 Chrome



CRUISE ACCESSORIES #1 IN FRAMES

*Keepin' it Simple.
Keepin' it Simple.
Keepin' it Simple.
Keepin' it Simple.
Keepin' it Simple.
Keepin' it Simple.
Keepin' it Simple.*

NOUVEAU

20630 Chrome w/fastener caps



20650 Black w/fastener caps



20680 Black Chrome w/fastener caps



ILLUSION

22000 Black/Chrome Patented



22005 White/Chrome Patented



NOUVEAU

TWO FRAME VALU-PAK

20642 Black Plastic



NOUVEAU

20640 Black Plastic



SLIM RIM

21330 Chrome



20643 Chrome Plastic



21350 Black



ELITE STAINLESS

21010 Stainless Steel



PERIMETER

30630 Chrome



STAINLESS

21110 Stainless Steel



30650 Black



CADILLAC

10330 Chrome w/fastener caps
Design & Utility Patented



DODGE

11036 Chrome/Red Utility Patented



CHEVY

10437 Chrome/Gold Design Patented



RAM

11135 Chrome/Black
Design & Utility Patented



USA FLAG

23003 Chrome



CAMO

23095 Black w/fastener caps



PAWS

23033 Chrome



RED REFLECTOR II

30436 Red/Chrome



BUTTERFLY

23053 Chrome w/fastener caps



FIBER

59053 Black/Chrome



CAMO-GIRL

23093 Chrome w/fastener caps



UNITED WE STAND

31030 Chrome Patent Pending



LIFESTYLE

GOLF CLUB

19509 Chrome/Painted Patented



HUNTING

19656 Matte Black/Orange w/fastener cap Patented



FISHING

19783 Black Chrome/Chrome Patented



FIREFIGHTER

30936 Chrome/Black/Red w/fastener caps Patented



QUEEN

22630 Chrome/Clear w/fastener caps Patented



PRINCESS

22635 Chrome/Black Patented



NEO DIAMONDESQUE

15000 Rose Gold Patented



15001 Gold Patented



15002 Titanium Patented



15530 Chrome Patented



HOPE

15003 Chrome/Pink w/fastener caps Patented



PEARLESQUE

18250 Chrome/Clear Patent Pending



DIAMONDESQUE

18000 Rose Gold/Clear Patented



18130 Chrome/Clear Patented



18150 Matte Black/Clear Patented



18156 Matte Black/Pink Patented



LEOPARD BLING

18517 Chrome/Gold/Black/Clear Patented



BUTTON TUCK BLING

18525 Chrome/Black/Clear Patented



RIBBON BLING

18545 Chrome/Black/Clear Patented



ANGEL & DEVIL®

19000 Black/White Patent Pending



PALM TREE

19003 Chrome Patented



DAISY

19130 Chrome/Painted Patented



TWINS

20230 Chrome



CHAIN

20500 Matte Black w/fastener caps



20530 Chrome



TWIST

20730 Chrome



STILETTO

22001 White/Black Patented



ANODIZED

20800 Blue



20820 Gray



20840 Silver



DIESEL POWER

22003 Chrome Patented



BLADES

22004 Flat Black w/fastener caps



22013 Chrome



TRIBAL II

22135 Chrome/Black Patented



BARBED WIRE II

22230 Chrome



EAGLE

22330 Chrome Patented



HEART

22456 Glossy Black/Pink Patented



FLEUR DE LIS

22835 Chrome/Black Patented



SKULL & BONE

25231 Chrome Patented



ICHTHUS

29003 Chrome



DIAMOND PLATE

30830 Chrome



30850 Matte Black



BAMBOO

58000 Bamboo/Black Chrome



CARBON FIBER II

58098 Carbon Fiber/Black Chrome



BILLET

58300 Flat Black/Matte Gold w/fastener caps



INDUSTRIAL

58150 Matte Black Patented



58350 Chrome/Black



DEFENDER

58153 Matte Black/Chrome Patented



HYPERSONIC

58453 Black Patent Pending



CONTOUR

58200 Gray w/fastener caps Patented



TWO TONE

63350 Chrome/Black w/fastener caps



58230 Chrome Patented



MC ELITE

77000 Stainless Steel



MC NEO

77050 Black



MC SPIKES

77015 Black/Chrome Patented



MC CARBON FIBER II

77198 Carbon Fiber/Black Chrome



MC EAGLE

77023 Chrome Patented



MC USA FLAG

77203 Chrome



MC NEO

77030 Chrome



MC NEO CLASSIC

77330 Chrome



MC NEO CLASSIC

77350 Black



MC DIAMONDESQUE

77730 Chrome/Clear Patented



MC BARBED WIRE

77430 Chrome



MC TWINS

77930 Chrome



MC CHAIN

77500 Matte Black



77530 Chrome



NEW ARRIVAL

NEW ARRIVAL

COMBO

Frame and U.V. Acrylic Bubble Shield

- 60310 Chrome/Clear
- 60320 Chrome/Smoke
- 60510 Black/Clear
- 60520 Black/Smoke

TUF UNBREAKABLE COMBO

Frame and Unbreakable U.V. Polycarbonate
Tuf Bubble Shield

- 62031 Chrome/Clear
- 62032 Chrome/Smoke
- 62034 Chrome/Blue
- 62051 Black/Clear
- 62052 Black/Smoke



LEGAL DISCLAIMER

Laws concerning shields vary from State/Province to State/Province. Please check your State/Provincial and Local/Municipal Laws and Regulations.

ULTIMATE TUF COMBO



Includes Frame, Unbreakable U.V. Polycarbonate Tuf Bubble Shield, 2 sets of Locking Stainless Star Pin® Fasteners (Standard & Metric) and 1 set of Fastener Caps

62310 Chrome/Clear



62510 Black/Clear



62320 Chrome/Smoke



62520 Black/Smoke



TUF UNBREAKABLE COMBO

Fits on Frame Like a **GLOVE!**



LEGAL DISCLAIMER

Laws concerning shields vary from State/Province to State/Province. Please check your State/Provincial and Local/Municipal Laws and Regulations.

BUBBLE SHIELD

U.V. ACRYLIC

72100 Clear
72200 Smoke



DOUBLE BUBBLE VALU-PAK

72101 Clear



TUF UNBREAKABLE BUBBLE SHIELD

UNBREAKABLE U.V. POLYCARBONATE

73100 Clear
73200 Smoke
73400 Blue



TUF UNBREAKABLE FLAT SHIELD

UNBREAKABLE U.V. POLYCARBONATE

76100 Clear
76200 Smoke
76400 Blue



LEGAL DISCLAIMER

Laws concerning shields vary from State/Province to State/Province. Please check your State/Provincial and Local/Municipal Laws and Regulations.

TUF TRUNK GRIP®

79001 Clear



SUCTION CUPS

78410 Clear (4) Pack



UNIVERSAL LICENSE PLATE MOUNT*

79000 Clear Patent Pending



FASTENERS

80150 Metric-Nylon, Black

80230 Standard-Steel

80330 Metric-Steel

80553 Black Nylon w/chrome fastener caps

LICENSE PLATE BRACKET*

79050 Black



MOUNTING PLATE*

79150 Black



80430 Tapping Stainless Steel

80630 Stainless Steel

80733 Anti-Theft



* USE FOR:

- Mounting license plate on new vehicles with contoured bumpers if factory bracket did not come with vehicle.
- Mounting license plate to any trailer.
- Mounting an additional novelty plate to any vehicle.



LOCK IT DOWN! WITH LOCKING FASTENERS

- Uniquely designed to deter the removal of any Cruiser Accessories' license plate frame or plate
- Star Pin® in the center with the special key makes it impossible to remove with a typical Allen wrench
- Locking Stainless Star Pin® fasteners are available for most American and Import vehicles
- Registered trademark on the "Star Pin® Anti-Theft System"

81200 Standard - Stainless Star Pin®
81300 Metric - Stainless Star Pin®



81400 Rattle Stop® - Stainless Star Pin® Patented

81420 Stainless Rattle Stop® Kit - Standard Patented
81430 Stainless Rattle Stop® Kit - Metric Patented



Only 2 Bolt Holes? No Problem... How it Works:

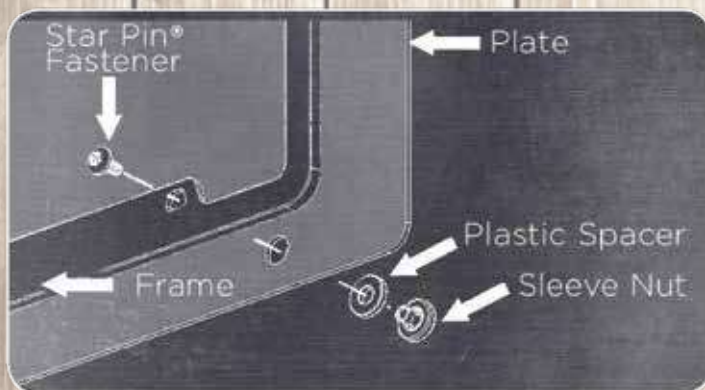

- Prevent rattling with the Rattle Stop® Fasteners
- Securely attaches your license plate and frame together on the lower two bolt holes
- Made of high quality Stainless Steel
- Star Pin® Anti-theft Fastener system
- Registered trademarks on both Rattle Stop® and Star Pin®
- Patented

ULTIMATE KIT

81500 Standard/Metric - Stainless Star Pin® Patented
"One Kit Fits All!"



FASTENER CAPS

82530 Paws Patent Pending

82550 Skull Patent Pending



82630 Chrome

82650 Black

82670 Gold

82680 Black Chrome

FASTENER CAPS

82226 Reflector II, Red

82300 USA Flag



82730 Diamond Bling

82000 Pink Ribbon Patented

82431 Chrome/Clear Pave

82432 Chrome/Smoke Pave

82456 Matte Black/Pink Pave



83003 HULA FLOPS, Chrome



83013 TURTLE, Chrome



83023 HIBISCUS, Chrome



83030 THIN LINE, Chrome



83033 PLUMERIA, Chrome

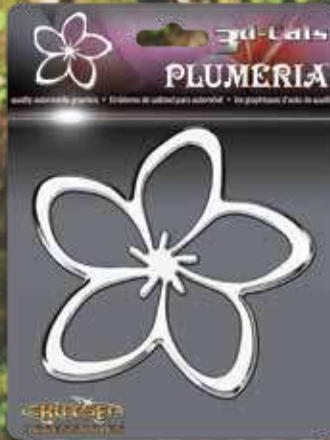

83043 SHAKA, Chrome



83053 GECKO, Chrome



83703 BEAR PAW, Chrome



3d-Cals



83063 PEACE, Chrome



83083 AMERICAN FLAG, Chrome



83103 ICHTHUS, Chrome



83130 PAW, Chrome



83153 SKULL, Chrome/Black



83203 BIOHAZARD, Chrome



83303 BUTTERFLY, Chrome



83403 ROSE, Chrome



83453 PRINCESS, Chrome/Black



83503 CROSS & DOVE, Chrome



83803 GRENADE, Chrome Patented



83850 GRENADE, Matte Black Patented



90020 VERTICAL 2 POCKET, BLACK (INCLUDES 2 SKU TABS)



90035 MOTORCYCLE 3 POCKET, BLACK (WITH METAL TABS)

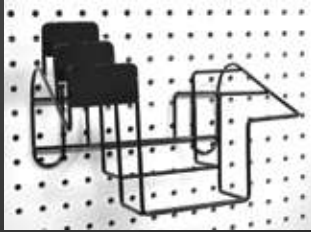

90200 FLOOR STANDING 20 POCKET, BLACK (INCLUDES 20 SKU TABS)



Ideal for use in places with limited available space. The footprint of this rack takes up approximately 2 sq. ft. It will not obstruct the view across your store, as rack height is below eye level. It also features 20 hooks to display fasteners down the side.

90700 HORIZONTAL 4 POCKET, BLACK (INCLUDES 4 SKU TABS)

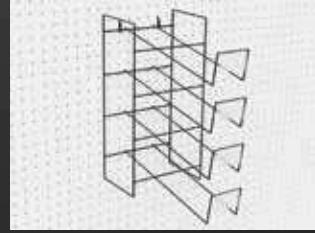

90600 HORIZONTAL 6 POCKET, BLACK (INCLUDES 6 SKU TABS)

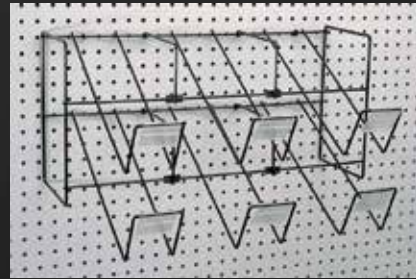

90800 HORIZONTAL 8 POCKET, BLACK (INCLUDES 8 SKU TABS)

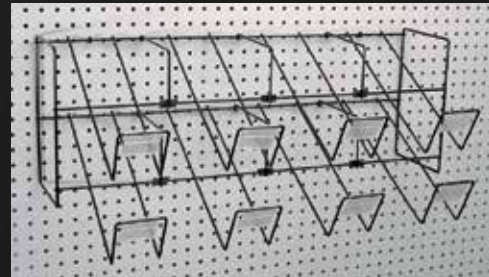

56 POCKET DISPLAY

90500 VERTICAL 6 POCKET, BLACK (INCLUDES 6 SKU TABS)

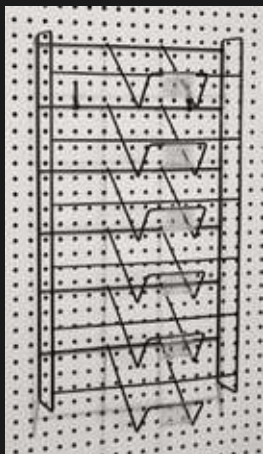

56 POCKET DISPLAY consists of the following:

- 4 - (90800) Horizontal 8 Pocket, Black
- 4 - (90600) Horizontal 6 Pocket, Black
- 1 - (90035) Motorcycle 3 Pocket, Black



(Shown on a standard 48" wide x 60" tall gondola display fixture.)

ROCK TAMERS[®]

MUDFLAP SYSTEM



**EASY ON
AND OFF!**

*Use it when you're towing,
take it off when you're not-*



**PROTECT WHAT
YOU TOW!** [®] **FROM ROCKS,
MUD, DEBRIS
& ROAD TAR**



PART# 00108
Rock Tamers 2" Hub
Mudflap System
Matte Black w/Stainless Steel Trim Plates

FITS
2"
DRAWBAR/RECEIVER

FITS
2 1/2"
DRAWBAR/RECEIVER

PART# 00110
Rock Tamers 2.5" Hub
Mudflap System
Matte Black w/Stainless Steel Trim Plates

ADJUSTABLE WIDTH & HEIGHT TO FIT MOST VEHICLES



- > UV PROTECTED FORGED ALUMINUM HUBS & ARMS
- > 3/8" THICK; 24" X 24" WIDE FIBER REINFORCED RUBBER MUDFLAPS
- > STAINLESS SLEEVED STEEL RODS; STAINLESS STEEL, ZINC-NICKEL & CHROME PLATED HARDWARE



Minimum horizontal Space
Requirement 67.5"



DISPLAY STAND - PART #00400
Requires Standard 2" Hitch
Drawbar Mount for Display
(Not Included)



Center Hub Requires
Minimum 1" Clearance

ROCK TAMERS®

EXHAUST OUTLET

**ALLOWS
EXHAUST
HEAT TO
ESCAPE!**

**EASY
TO INSTALL
ON MOST MUDFLAPS**



RT200
EXHAUST
ACCESSORY
Patent Pending



ROCK TAMERS®

HEAT SHIELD

**PROTECTS
FLAP FROM
HEAT AND
EXHAUST
GASSES**

RT230
HEAT SHIELD
Patent Pending



**EASY
TO INSTALL
ON THE BACK OF
MOST MUDFLAPS**



ROCK TAMERS®

TAIL LIGHT BARS



RT240
TAIL LIGHT BARS

EASY TO INSTALL!

INCLUDES 4 WIRE FLAT
CONNECTOR!



- HIGH INTENSITY LED ILLUMINATION
- RUNNING, BRAKE AND TURN SIGNALS
- SECURELY BOLTS TO ROCK TAMERS® MUDFLAP SYSTEM

ROCK TAMERS®

BOLT BUMPERS

RT220
BOLT BUMPERS, Black



**COVER YOUR
HARDWARE
FOR A SLEEK,
PROTECTED
FINISH!**

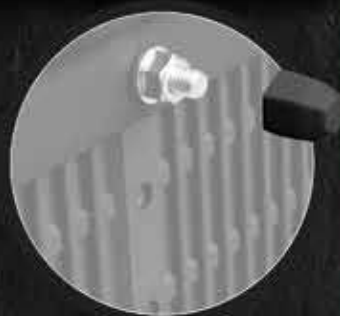

**EASILY
SLIDES OVER
MOUNTING HARDWARE**



ROCK TAMERS®

HANGER

RT410
HANGER



INCLUDES: 2 arms and center
drawbar resting pad

**HANG YOUR
MUDFLAP
SYSTEM WHEN
NOT IN USE!**



**EASILY
MOUNTS TO
MOST VERTICAL SURFACES**



Check out the collection of license plates and frames we offer.