

FITTING INSTRUCTIONS

**ARB WINCH/NON WINCH BUMPER TO SUIT FORD F250/350 PICKUPS
2000 MODELS ON.**

PRODUCT No. 3936120

FITTING KIT No. 6172410

TOP TUBE & BUFFER KITS:

5100175: Top Tube Kit

5100171: Buffer Kit – With hole (required when fitting Top Tube)

5100172: Buffer Kit – With No Hole

WARNING

FOR VEHICLES EQUIPPED WITH SRS AIRBAG

**WHEN INSTALLED IN ACCORDANCE WITH THESE INSTRUCTIONS, THE FRONT
PROTECTION BAR DOES NOT AFFECT OPERATION OF THE SRS AIRBAG.**

TAKE NOTE OF THE FOLLOWING:

- **THIS PRODUCT MUST BE INSTALLED EXACTLY AS PER THESE INSTRUCTIONS USING ONLY THE HARDWARE SUPPLIED.**
- **IN THE EVENT OF DAMAGE TO ANY BULL BAR COMPONENT, CONTACT YOUR NEAREST AUTHORISED ARB STOCKIST. REPAIRS OR MODIFICATIONS TO THE IMPACT ABSORPTION SYSTEM MUST NOT BE ATTEMPTED.**
- **DO NOT USE THIS PRODUCT FOR ANY VEHICLE MAKE OR MODEL, OTHER THAN THOSE SPECIFIED BY ARB.**
- **DO NOT REMOVE LABELS FROM THIS BULL BAR.**
- **THIS PRODUCT OR ITS FIXING MUST NOT BE MODIFIED IN ANY WAY.**

Note :

- 1 If fitting optional fog lights, fitting kit no. 9381FCK is required.**
- 2 This winch bumper is suitable for Warn 15,000lb winch only.**

Tools Required

Metric Spanner and Socket set, Phillips head screwdriver, 12.5mm & 10mm drill bit and drill.

USE	PART No	QTY	DESCRIPTION
BUFFER FITTMENT (5100171 REQUIRED IF FITTING TOP TUBE)	6151128	12	NUT FLANGE M6
	3162153	1	BUFFER LHS
	3162154	1	BUFFER RHS
BUFFER FITTMENT (5100172 REQUIRED IF NOT FITTING TOP TUBE)	6151128	12	NUT FLANGE M6
	3162471L	1	BUFFER LHS
	3162471R	1	BUFFER RHS
TOP TUBE FITTMENT (5100175)	6151255	2	BOLT M12 X 40mm
	4581049	2	WASHER FLAT M12
	4581050	2	WASHER SPRING M12
	6131232	1	TOP TUBE
LOWER BUFFER FITTMENT	3162175	1	BUFFER LOWER
	6151128	5	NUT FLANGE M6
MOUNT BRACKETS TO VEHICLE	3756501L	1	BRACKET BAR MOUNT LHS
	3756501R	1	BRACKET BAR MOUNT RHS
	3193695	4	PLATE
	6151321	8	M10 FLANGED NUT
	4581011	8	WASHER M12 X 4mm THICK
	6151232	8	BOLT M10 X 30mm
	4581048	8	WASHER M10 SPRING
	6151255	6	M12 x 40 BOLTS
	4581049	12	FLAT WASHER M12
	4581050	6	WASHER SPRING M12
	6151305	6	NUT CAGED M12
	WINCH	4581044	4
180302		4	CABLE TIE
BLB850		2	BATTERY LEAD BLACK
BLR850		1	BATTERY LEAD RED
TOW HOOK REPLACEMENT	4581049	6	M12 WASHER FLAT
	4581050	6	M12 WASHER SPRING
	6151255	6	BOLT M12 X 40
	6151189	4	NUT M12
CONTROL BOX FITTMENT	3756499	1	CONTROL BOX BRACKET
	6151021	2	BOLT M8 X 20mm
	4581044	2	WASHER, FLAT M8 x 17 x 1.2
	180302	4	CABLE TIE
	6151132	2	NUT FLANGE M8
NUMBER PLATE FITTMENT	EG50	2	GROMMET RUBBER
	6151017	2	BOLT M6 X 16mm
	6151128	2	NUT FLANGE M6
AIR DEFLECTOR FITTMENT	6781408	1	TAPE DOUBLE SIDED
	6151022	3	BOLT M8 x 25
	4581063	3	WASHER FLAT M8 x 25.4 x 3
	6151301	3	NUT M8 CAGED
	6522022	1	AIR DEFLECTOR PANEL
	4581046	3	WASHER M8 SPRING

TENSION BRACKET	3756432	2	TENSION BRACKET
	6151255	4	BOLT M12 X 40mm
	4581050	4	WASHER SPRING M12
	4581007	8	WASHER FLAT M12 LARGE
	6151189	4	NUT M12
WINCH COVER FITTMENT	6151128	2	NUT FLANGE M6
	6151256	2	SCREW M6 S/STEEL BUTTON HEAD
	6191006	1	WINCH COVER EXTRUSION
	6522023	1	WINCH COVER
	6151046	2	WASHER M6
BAR TO MOUNT ASSEMBLY	6151255	4	BOLT M12 X 40mm
	4581050	4	WASHER SPRING M12
	4581007	4	WASHER FLAT M12 LARGE
	4581048	4	WASHER SPRING M10
	6151321	4	NUT M10 FLANGED
	6151232	4	BOLT M10 X 30mm
	4581040	4	WASHER FLAT 3/8"
LIGHT SURROUNDS TO BAR	3162456	1	LIGHT SURROUND LHS
	3162457	1	LIGHT SURROUND RHS
CB	3162152	2	PLASTIC PLUG DIA16

ASSEMBLY SEQUENCE FOR WINCH BUMPER.

1.

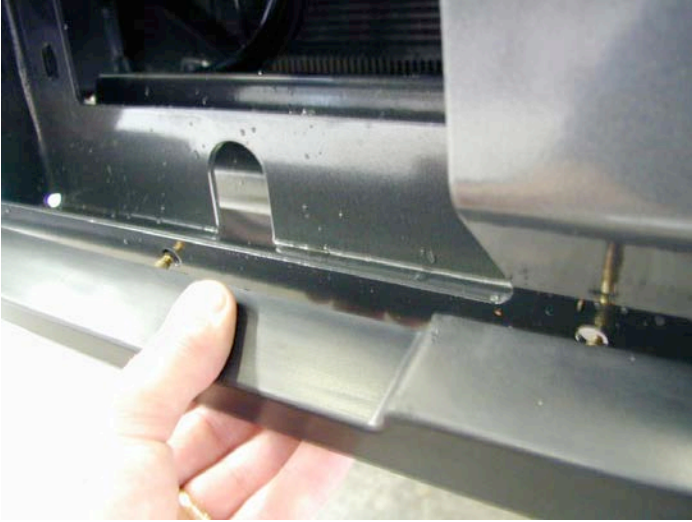

Position the lower buffer on the winch bumper and assemble using the M6 flange nuts. (do not over-tighten)

2.



Insert the side buffers through the holes and fix using the M6 flange nuts. (do not overtighten)

If fitting optional fog lights, do so now.

Refer to the instructions provided in the fog light kit.

3.



Push the top tube through the hole in the buffer and fasten using the M12 x 40mm bolts, washers and spring washers.

Go to step 4 if not fitting top tube

4.



Remove the bumper and two recovery hooks.

Fit M12 cage nuts to slots on each mount bracket as shown and fit mount brackets onto chassis ends, gusset should locate inside chassis end.

Using M12 x 40mm bolts, flat washers, spring washers, re-fasten through the holes where the recovery hooks were removed, *do not tighten bolts.*

5.



Fasten brackets with the M10 bolts, large 4mm thick washers, M10 spring washers, M10 flange nuts and plates, finger tight only.

Note: The plates mount to the front face of the bull bar mounting bracket as shown.

6.



With the bull bar mounting brackets now in place (but not tightened) bolt the tension strap to the chassis using the hole next to the horizontal slot.

Using the M12 bolt, thick washers, spring washer and nut bolt up the tension strap as shown.

The tension strap will need to be bent out slightly, to pass alongside the bull bar mounting bracket.

As the bolt is tightened the bracket will bend slightly to allow the strap to sit flat against the chassis.

7.



Bend the end of the strap inward, as shown, to allow the strap to sit against the bull bar mounting bracket.

Drill through the strap and bracket using a 12.5mm drill bit and bolt up using the same hardware as described in the above step.

IMPORTANT: STRAP POSITION MUST BE AS LOW AS PRACTICAL ON MOUNT BRACKET AS SHOWN.

8.

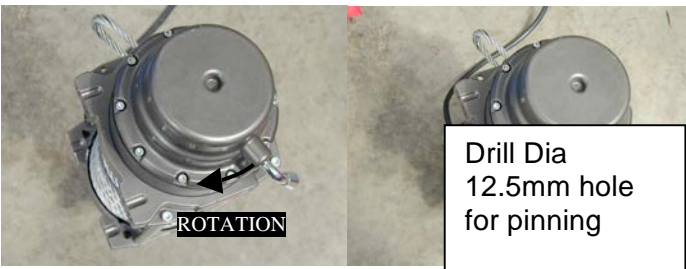

ORIGINAL POSITION	NEW POSITION
-------------------	--------------

If fitting winch.

The clutch handle must be repositioned so it is in a convenient location when mounted to bar.

Place the winch on its end and remove all gearbox bolts.

Gently raise the motor just enough to rotate it. Viewing from the gearbox end, rotate the gearbox 72deg clockwise.

Do not completely remove the motor and avoid damaging the gasket.

Refit and tighten all bolts.

Note: Take care not to lift the assembly more than a couple of millimeters while rotating to the desired position to avoid un-meshing the gears.

9.

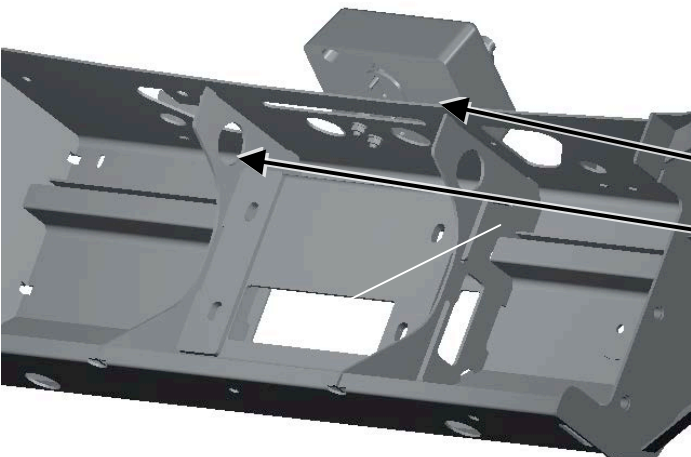

If fitting winch.

The three control box leads, which connect to winch, need to be replaced with the longer leads supplied in the fitting kit. Replace the leads with the same colours.

Bolt the control box bracket to the control box, refer photo.

Fit the two grommets into the round holes then thread the cable through.

Mount the control box bracket onto the top pan, using M8 bolts, flat washers and flanged nuts. Use the cables ties to ensure the winch cables are secure, tying them together.

10.

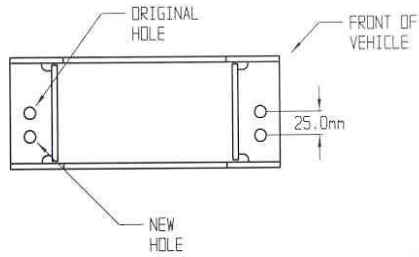

The roller fair lead must be drilled prior to fitment.

Using a 13.0 mm drill bit drill two holes as shown in diagram.

11.

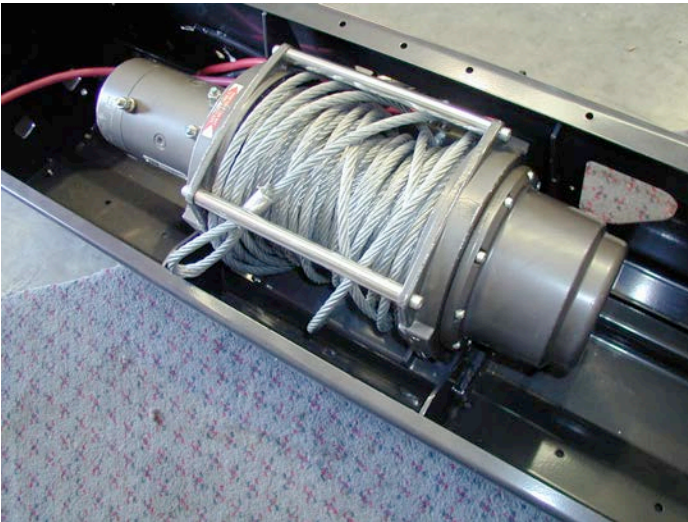

If fitting winch.

Viewed from front of vehicle the winch clutch must be positioned on the LH side. Cable spools from the bottom. Bolt in position with the roller fair lead in place. Draw off some cable so cable crimp can be pulled through roller fairlead.

If crimp is too large to fit through, remove a circlip from a horizontal roller, partially remove the shaft so roller gap is increased and feed cable and crimp through. Refit shaft and circlip. Bolt in position with the roller fair lead in place.

Note; To increase access to mount bolts in front of roller fairlead, remove circlips from bottom of each vertical roller shaft, push shaft up so roller can be dislodged sideways. Do up bolts in fairlead and winch, then refit circlip.

Connect the winch control box cables to the winch motor. Refer to the Warn handbook for additional information. Connect the long winch + & - cables to the vehicle after the bar is installed. **Refer to the Warn winch manual for vehicle wiring instructions.**

12.



Fitting with winch



Fitting without winch

If fitting with winch.

Peel off one side of the double sided tape and adhere to the top rear side of the number plate. Note: Clean the adhering surfaces before applying tape with an alcohol solvent.

Peel off the other side of the tape and bolt to the winch bumper with the M6 X 16mm bolts and M6 flange nuts through the lower holes of the number plate.

Press firmly to the top of the number plate so the tape can properly adhere.

If not fitting with winch.

Bolt the number plate through the top holes using M6 X 16mm bolts and M6 flange nuts.

If desired the double sided tape can be used down the sides of the number plate.

13.



If not fitting winch.

Wrap rubber extrusion around winch cover.

Place washers over the winch cover fixing holes located on the top middle face of the winch bumper.

Place the winch cover on top of the winch bumper inline with the mount holes.

Bolt together using the M6 button head stainless steel screws and M6 nuts.

14.

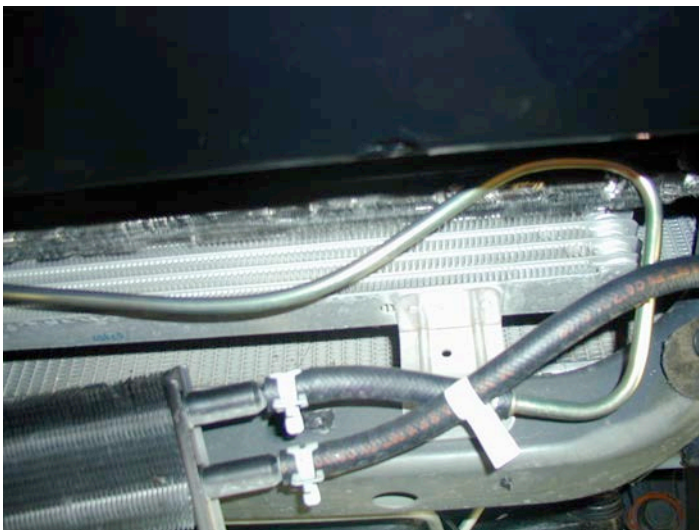

Remove the rubber air guide and discard.

IMPORTANT :- When fitting a winch, on some models the top power steering cooler line (steel) will interfere with the winch and must be bent down to provide clearance as shown .

Take care when bending the cooler line tube that you don't kink it.

Leave the power steering cooler in its original position.

15.

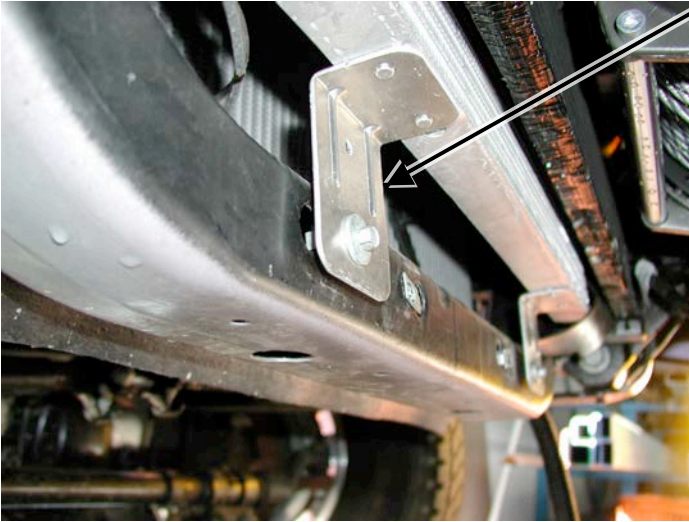

Bolt the deflector to the original bolts located in the chassis cross member.

Tie the power steering lines to the chassis away from sharp edges and moving parts with cable ties provided.

16.



Using two people, three if winch fitted, position the bar assembly on the vehicle mounts. Make sure the deflector is held down for the bar to be pushed back.

17.

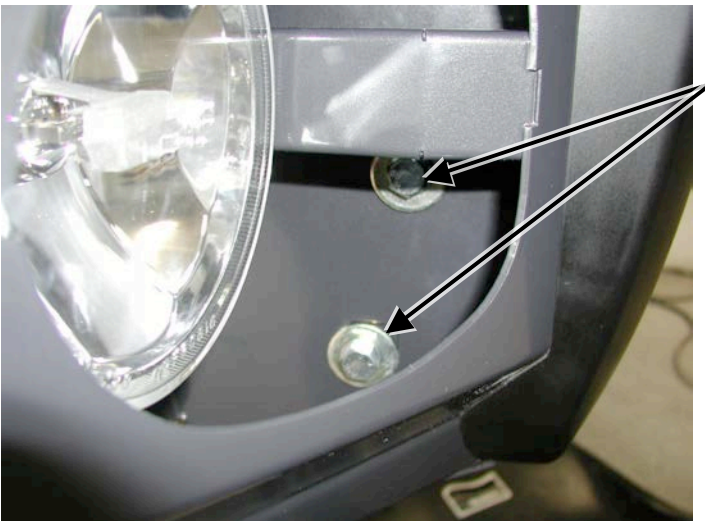

Bolt the bar to the mounts using M12 bolts, large flat washers and spring washers. Align the bar to the profile of the guards and tighten all bolts including the mount brackets.

18.



The bar must be pin bolted to the mount brackets. Using a drill and 10mm drill bit, drill through the upper and lower Ø10mm holes located in the mount brackets.

Fasten the holes using M10 bolts, flat washers and spring washers.

19.

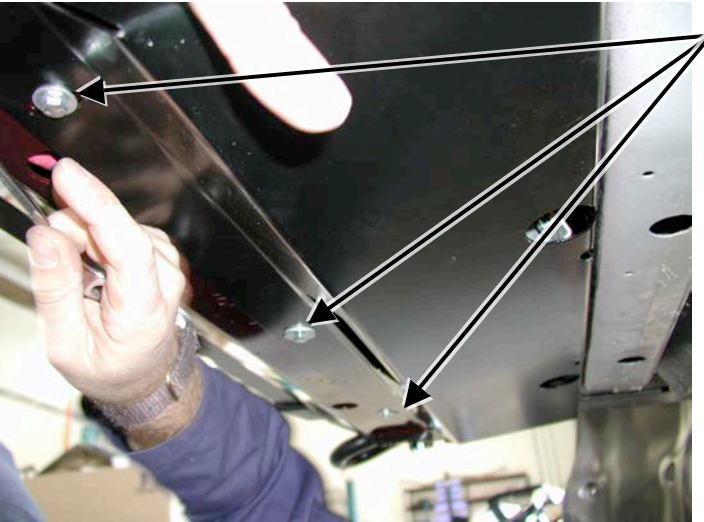

Fit three M8 cage nuts to square holes inside the bar. Bolt the deflector to the bar using M8 bolts, large M8 flat washers and spring washers.

20.



Bolt the tow hooks to the mount brackets using the M12 x 40mm bolts, flat washers and spring washers.

21.



If fitting with winch

Feed the winch cable through the roller fair lead. Mount the hook to the end of the cable.

22.



If you have fitted the optional fog lights, the base of the fog light surround must be removed. Carefully cut the 4 retaining tabs with a knife.

Glue the light surrounds to the bar using a silicone based rubber adhesive. Run the bead along the cavity on the rear side of the part. Position the surround to align the inside edge with the buffer and concentric to the light.

Wipe off any adhesive on the front face of the bar. Allow adhesive to cure before continuing.

23.



There are two Ø16 holes located on the top face of the bar. If no CB aerials are fitted the holes can be covered with the plastic plugs provided in the fitting kit.

Place the ARB logo on the front face of the bar in the indentation.

24. If fitting fog lights, wire the fog lights as described in the fog light fitting instructions.

The fog lights can be adjusted to desired angles by the adjustment bolts located at the back of the light insert. When adjustment is finalized, be sure to retighten the fog light bolts.

If fitting with winch.

25. Connect the long winch + & - cables to the vehicle after the bar is installed.

Refer to the Warn winch manual for vehicle wiring instructions.

Ensure that these cables are installed well clear of sharp, hot or moving objects. Secure the winch cables to the vehicle and winch bumper with the supplied cable ties.