

07-09 JK Wrangler Light Bar

Contents:

1. Light Bar (1)
2. Left Side Bracket (1)
3. Right Side Bracket (1)
4. M12 Hex Bolt (4)
5. M12 Flat Washer (4)
6. M12 Lock Washer (4)
7. Nut Plate (2)
8. M8 Button Head Bolts (4)
9. M8 Flat Washer (8)
10. M8 Nylock Nut (4)
11. Hex Key (not shown) (1)

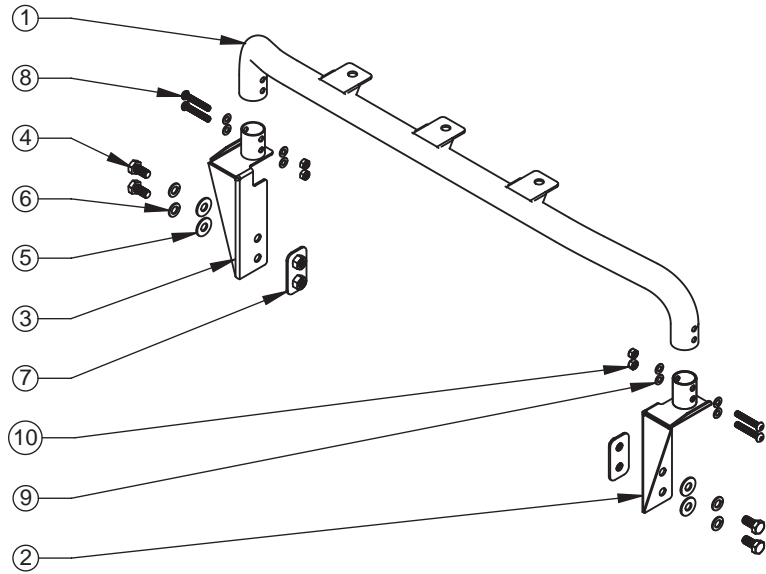

1. 07-09 JK: Locate the two frame mounting holes behind the bumper on the left side of the vehicle. Slide the Nut Plate behind the two holes. Use the M12 Hex Bolts, Lock Washers and M12 Flat Washers to secure the Left Side Bracket to the frame as shown. Do not fully tighten the bolts at this time. Repeat for right side.

2010 JK: Install the Left Side bracket using its bottom hole and hand tightening only. Align the bracket vertically and mark the upper hole location. Remove the bracket and drill 1/2" hole. Install bracket as noted above. Do not fully tighten the bolts at this time. Repeat for right side.

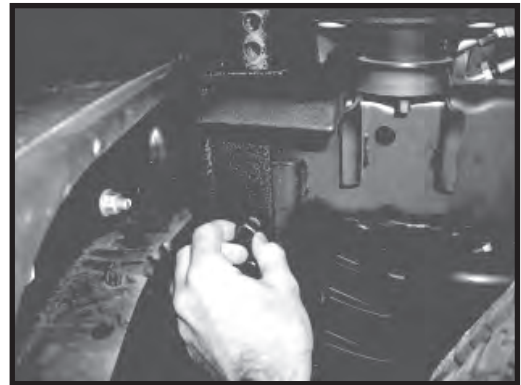

2. Place light bar over the tube sleeves of both the Left and Right Side Brackets. Adjust the brackets as necessary to accommodate the tube.

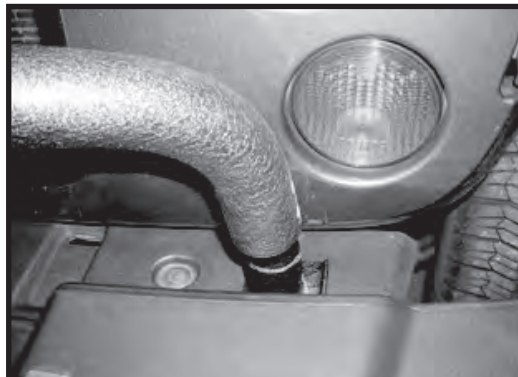

3. Use the M8 Button Head Bolts, M8 Flat Washers, and M8 Nylock Nuts to secure the Light Bar to the Mounting Brackets. Install and tighten the lower bolts first, then install the upper ones. Tighten to 20 ft-lbs.



4. Tighten all hardware. Install lighting per manufacturer's instructions.



Rugged Ridge Limited Warranty

Applies to Rugged Ridge Products by Omix-ADA Inc.

**Please find warranty card supplied with product for more information.
Warranty card should be filled out and returned to address listed below.**

07-10 JK Wrangler Light Bar

Contents:

1. Light Bar (1)
2. Left Side Bracket (1)
3. Right Side Bracket (1)
4. M12 Hex Bolt (4)
5. M12 Flat Washer (4)
6. M12 Flange Nut (4)
8. M8 button Head Bolts (4)
9. M8 Flat Washer (8)
10. M8 Lock Nut (4)
11. Hex Key (not shown) (1)

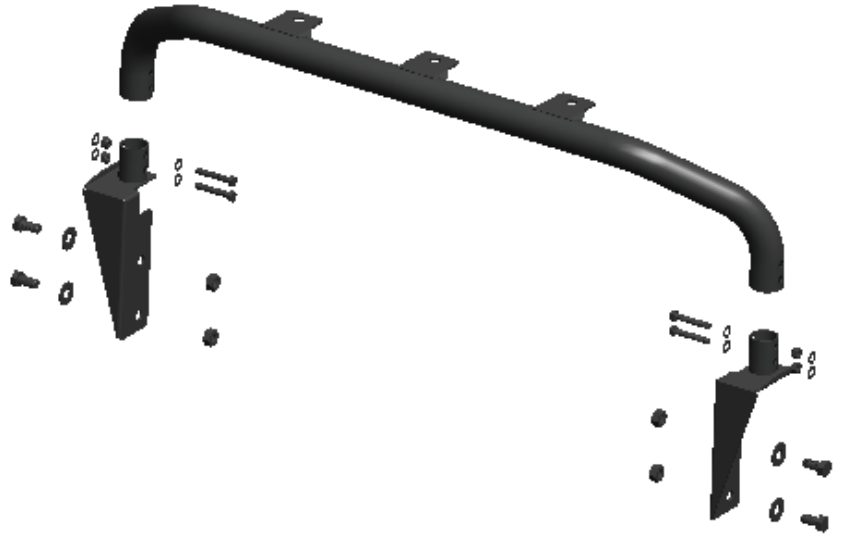

1. Locate frame mounting holes behind the bumper on the left side of the vehicle. Slide one M12 flange nut behind the lower frame hole to attach the Left Side Bracket as shown. Use this nut to secure the bottom of the Left Side Bracket in position with a M12 Hex Bolt and M12 Flat Washer. Place a M12 Flange Nut on the supplied Allen Key. Lower the nut behind the upper frame mount hole. Insert a M12 Hex Bolt and M12 Flat Washer to secure the top of the bracket. Do not fully tighten the bolts at this time. Repeat for Right Side Bracket.

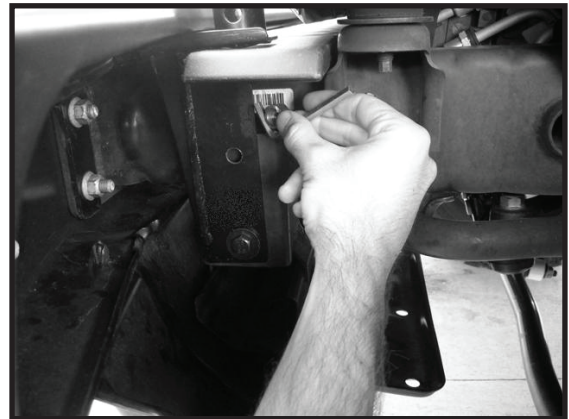
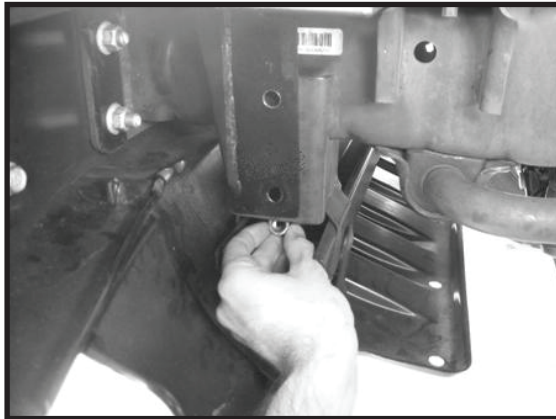

2. Place light bar over the tube sleeves of both the Left and Right Side Brackets. Adjust the brackets as necessary to accommodate the tube.

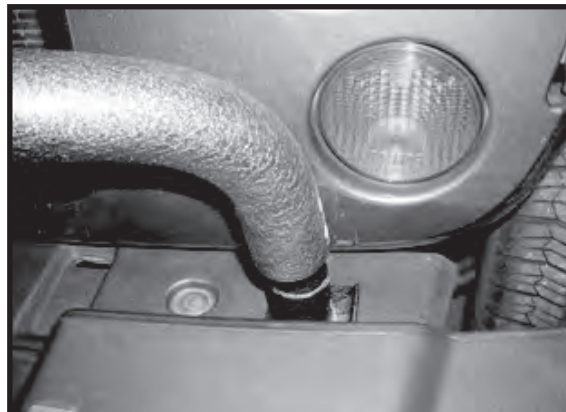

3. Use the M8 Button Head Bolts, M8 Flat Washers, and M8 Nylock Nuts to secure the Light Bar to the Mounting Brackets. Install and tighten the lower bolts first, then install the upper ones. Tighten to 20 ft-lbs.



4. Tighten all hardware. Install lighting per manufacturer's instructions.

