

EDMAN HUSLER EDDERS

**MADE
in the
USA!**



TABLE OF CONTENTS

HEDDERS

DRAG RACING	
Altered, T-Buckets.....	13
Dragster Zoomies.....	16
Econorail Dragster Heddere.....	14
Engine Dyno Hedder Weld-Up Kits.....	15
Pro-Stock/Pro-Mod Heddere.....	16
Street & Strip Race Heddere (Sportsman Doorslammers).....	8
Street Roadsters.....	13
MUSCLE RODS™ LS Swap Heddere & Conversion Mount Kits.....	
	3
OVAL TRACK RACE HEDDERS	
ASPHALT Oval.....	18
DIRT Oval.....	21
RACE TRUCK HEDDERS.....	17
EXHAUST CUT-OUTS.....	27
HEDDER COMPONENTS	
Collector Extensions.....	27
Collectors.....	27
Fasteners.....	27
Gaskets.....	25
Hedder Flanges.....	25
Mandrel Bends.....	26
RACE MUFFLERS.....	24
TAILPIPE SAVERS.....	24



HEDMAN HUSLER HEDDER ONE YEAR LIMITED WARRANTY

HEDMAN MANUFACTURING warrants each new Hedman Husler Hedder to be free from defects in materials and workmanship, including tube cracks and welds for a period of ONE year from the date of purchase.

This warranty covers the replacement/repair of the product only, and DOES NOT cover the cost of removal and installation or customer applied aftermarket coatings.

Damage or defects resulting from collision, improper installation, road hazards, the use of exhaust insulating wrap or like products, or RUST occurring after installation, IS NOT covered by this warranty. This warranty extends only to the original purchaser.

Hedman Husler Heddere were specifically designed to fit the applications as listed in this catalog. Unless otherwise noted, any modifications to the vehicle such as engine set backs or offsets, transmission changes, frame changes or any other modifications, can affect the fit of your heddere. Hedman will not be held responsible for fit problems due to any such modifications.

This warranty is in lieu of all other warranties, expressed or implied.



RACE HEDDER QUESTIONS & ANSWERS

“WHAT IS THE BEST WAY TO CHOOSE A HEDDER TO FIT AFTERMARKET HEADS?”

Before choosing an aftermarket head, begin by finding a set of heddere that is designed to fit the chassis, and the heads you plan on using. Most aftermarket heads have different exhaust port locations, different plug angles, and sometimes, even have different bolt patterns. For this reason, and to ensure that you choose the best performing hedder for your specific application, it is highly recommended that you consult with the Husler Technical department before committing to a specific hedder number. Some applications will require special shorter “peanut” spark plugs for maximum hedder clearance. Also, some applications may require special sockets or wrenches for spark plug installation.

“HOW SHOULD HEDMAN HUSLER HEDDER COATINGS BE MAINTAINED?”

All Husler race heddere are available with Hedman’s Hi-Tech ceramic coating, which will protect your heddere against the elements, and lower under hood temperatures. However, if not properly maintained, the finish will lose its shiny luster, much like the paint on your car. To clean your heddere, we recommend using a light polish, such as aluminum or chrome polish. Also, parking a vehicle on a bare, unpainted concrete floor, or continuous driving on muddy or salty roads may create rust due to moisture in areas that cannot be cleaned.

CHOOSING THE CORRECT PRIMARY TUBE SIZE:

The tube size requirement for an engine is a function of; the horsepower output of the cylinders, exhaust port quality, intake manifold pressure, and the most critical part of the RPM range. Factors such as cylinder volume, camshaft, and overall CFM should all be considered when choosing your heddere.

WHAT ARE SUB-FLANGES?

Sub-flanges, or adapter plates, are used to allow small port heads to accept large port heddere. Sub-flanges, or adapter plates, are shipped from the factory with small exhaust ports. This allows the flange to be custom ported to match your existing race head with modified ports.

WHAT ARE STEPPED HEDDERS?

Most Hedman Husler Heddere are available in our Stepped tube configuration. The steps increase torque throughout the entire torque range. Stepped Heddere evacuate exhaust gasses from the combustion chamber faster with less reversion, and more thoroughly than stock manifolds, or standard tube heddere. The increase in available chamber volume allows for more fresh air/fuel mixture to be drawn in to create a more potent charge.

WHAT ARE ADJUSTABLE COLLECTORS?

Adjustable collectors help to fine tune your heddere for maximum performance. By altering the relationship between the primary tube length, collector diameter and length, it is possible to increase or decrease the torque and horsepower output at a specific R.P.M. level. For a slick track, the hedder primaries and collectors can be shortened to decrease the low-end torque for better traction. Larger diameter collectors will also reduce low-end torque. On a good track with lots of bite, extending the primaries or collectors will pick up bottom end power for a harder launch, and awesome e.t.’s. Smaller collector diameters will also increase low-end torque.

ALL HEDMAN HUSLER HEDDERS NOW AVAILABLE IN THREE FINISHES:

RAW UNCOATED

Hedman Husler Heddere are available Raw and unfinished. This option is ideal for vehicle builders and owners who plan on making alterations to a hedder after purchase, or coating the hedder on their own. Although heddere can be run uncoated, it will significantly reduce the life expectancy of the heddere, and is not recommended for long term use. Please refer to the RAW columns in this catalog to order your heddere uncoated (bare steel).

HTC CERAMIC COATING

Introduced in 1984, HEDMAN’S HTC Ceramic-Metallic coating is the original, and still the best hedder coating you can run. HTC offers thermal protection up to 1300°F, and the hand finishing leaves a shiny silver finish that is easy to maintain, and will last for many seasons. Please refer to the HTC columns in this catalog to order heddere with our HTC coating.

BLACK MAXX CERAMIC COATING

All Hedman Husler Heddere are now available in HUSLER’S ALL NEW BLACK MAXX Ceramic-Coating. This flat black finish offers the same protection as our HTC coating, only with a slightly different chemistry to give it a “sleeper” black finish. Please refer to the BLACK MAXX columns in this catalog to order heddere with our BLACK MAXX Finish.



NEW



45656 Long Tube Heddors & #03853 T-56 Conversion kit

- Heddors, Engine & Transmission Mount Kits Developed TOGETHER and designed specifically for your LS Swap Project.
- Mid & Full Length Models
- Available for GM Cars & Trucks ...and Fox Body Mustangs Too!
- MADE IN THE USA!

Husler's MUSCLE RODS Heddors and LS Conversion Kits have been developed together on the car or truck they are intended for. This means they work, right out of the box. We've done all the trial and error work, so you don't waste time performing unnecessary modifications, or returning parts that don't work together.

Muscle Rods Heddors and LS conversion mount kits are available for nearly 2 dozen 50's, 60's, 70's, 80's and 90's vehicles, each with mid-length, long tube and stepped tube options. All MUSCLE RODS Heddors are available uncoated, or with Hedman's original HTC or Husler's NEW BLACK MAXX Coating (see page 2 for description of coatings).

CHOOSING THE CORRECT HEDDORS & CONVERSION KIT

Each section lists the heddors available for your project, followed by the LS conversion kits for your vehicle. Locate the appropriate section for your vehicle and choose the tube length and diameter that works best for you. Then, select the correct conversion kit based on the transmission you will be using during your project. Heddors and conversion kits are sold separately, so please provide BOTH the heddor part number and the conversion kit part number when ordering.

TUBE SIZE	HEDDOR DESIGN	UNCOATED PART #	HTC COATED PART #	BLACK MAXX PART #	APPLICATION & INSTALLATION FOOTNOTES (see page 7)	A/C	P/S	TRANSMISSION			COLLECTOR SIZE & STYLE	
								AUTOMATIC COL.	STANDARD FLR.	STANDARD COL. FLR.		
1955-1957 Belair, Biscayne, Delray, 150, 210 [Heddors and conversion kits sold separately]												
1 3/4"	MID-LENGTH	45600	45606	45603	M7, M12, M14, M21, M22, M29, M33, M34, M35	YES	YES	NO	YES	NO	YES	3" Ball & Socket Style
1 3/4"	LONG TUBE	45610	45616	45613	M7, M12, M14, M21, M22, M29, M33, M35	YES	YES	NO	YES	NO	YES	3" Slip-on Race Style
1 3/4" x 1 7/8"	STEPPED LONG TUBE	45620	45626	45623	M7, M12, M14, M21, M22, M29, M33, M35	YES	YES	NO	YES	NO	YES	3" Slip-on Race Style
1 7/8"	LONG TUBE	45630	45636	45633	M7, M12, M14, M21, M22, M29, M33, M35	YES	YES	NO	YES	NO	YES	3" Slip-on Race Style
1 7/8" x 2"	STEPPED LONG TUBE	45640	45646	45643	M7, M12, M14, M21, M22, M29, M33, M35	YES	YES	NO	YES	NO	YES	3" Slip-on Race Style
2"	LONG TUBE	45650	45656	45653	M7, M12, M14, M21, M22, M29, M33, M35	YES	YES	NO	YES	NO	YES	3" Slip-on Race Style
LS CONVERSION KITS (Sold separately) designed specifically for use with the above Muscle Rods Heddors.		Contains: Frame Brackets, Motor Mounts, Transmission Crossmember, All Polyurethane Bushings, Hardware, Detailed Instructions.										
		03853	Conversion Kit for T-56 Transmissions: For use with above 1955-57 passenger car Muscle Rods Heddors.									
		03854	Conversion Kit for 4L60E / 65E Transmissions: For use with above 1955-57 passenger car Muscle Rods Heddors.									
1958-64 X FRAME CARS: (Bel Air, Impala) [Heddors and conversion kits sold separately]												
1 3/4"	MID-LENGTH	45420	45426	45423	M7, M12, M14, M16, M28, M34	YES	YES	NO	YES	NO	YES	3" Ball & Socket Style
1 3/4"	LONG TUBE	45430	45436	45433	M7, M12, M14, M16, M28	YES	YES	NO	YES	NO	YES	3" Slip-on Race Style
1 3/4" x 1 7/8"	STEPPED LONG TUBE	45440	45446	45443	M7, M12, M14, M16, M28	YES	YES	NO	YES	NO	YES	3" Slip-on Race Style
1 7/8"	LONG TUBE	45450	45456	45453	M7, M12, M14, M16, M28	YES	YES	NO	YES	NO	YES	3" Slip-on Race Style
1 7/8" x 2"	STEPPED LONG TUBE	45460	45466	45463	M7, M12, M14, M16, M28	YES	YES	NO	YES	NO	YES	3" Slip-on Race Style
2"	LONG TUBE	45470	45476	45473	M7, M12, M14, M16, M28	YES	YES	NO	YES	NO	YES	3" Slip-on Race Style
LS CONVERSION KITS (Sold separately) designed specifically for use with the above Muscle Rods Heddors.		Contains: Frame Brackets, Motor Mounts, Transmission Crossmember, All Polyurethane Bushings, Hardware, Detailed Instructions.										
		03812	Conversion Kit for T-56 Transmissions: For use with above 1958-64 X-Frame car Muscle Rods Heddors.									
		03813	Conversion Kit for 4L60E / 65E Transmissions: For use with above 1958-64 X-Frame car Muscle Rods Heddors.									



MUSCLE RODS™ LS ENGINE SWAP PRODUCTS



TUBE SIZE	HEDDER DESIGN	UNCOATED PART #	HTC COATED PART #	BLACK MAXX PART #	APPLICATION & INSTALLATION FOOTNOTES (see page 7)	A/C	P/S	TRANSMISSION				COLLECTOR SIZE & STYLE
								AUTOMATIC COL.	STANDARD COL.	FLR.	FLR.	
1964-67 A-BODIES: (Chevelle, El Camino, Le Mans, GTO, Cutlass, Skylark, GS, Tempest) [Hedders and conversion kits sold separately]												
1 3/4"	MID-LENGTH	45180	45186	45183	M12, M14, M19, M34, M36, M41	YES	YES	NO	YES	NO	YES	3" Ball & Socket Style
1 3/4"	LONG TUBE	45190	45196	45193	M12, M14, M19, M36, M41	YES	YES	NO	YES	NO	YES	3" Slip-on Race Style
1 3/4" x 1 7/8"	STEPPED LONG TUBE	45200	45206	45203	M12, M14, M19, M36, M41	YES	YES	NO	YES	NO	YES	3" Slip-on Race Style
1 7/8"	LONG TUBE	45210	45216	45213	M12, M14, M19, M36, M41	YES	YES	NO	YES	NO	YES	3" Slip-on Race Style
1 7/8" x 2"	STEPPED LONG TUBE	45220	45226	45223	M12, M14, M19, M36, M41	YES	YES	NO	YES	NO	YES	3" Slip-on Race Style
2"	LONG TUBE	45230	45236	45233	M12, M14, M19, M36, M41	YES	YES	NO	YES	NO	YES	3" Slip-on Race Style

LS CONVERSION KITS (Sold separately) designed specifically for use with the above Muscle Rods Hedders.

Contains: Frame Brackets, Motor Mounts, Transmission Crossmember, All Polyurethane Bushings, Hardware, Detailed Instructions.

03814	Conversion Kit for 1964-67 Coupes; T-56 Transmissions: For use with above Muscle Rods Hedders.
03815	Conversion Kit for 1964-67 Coupes; 4L60E / 65E Transmissions: For use with above Muscle Rods Hedders.
03816	Conversion Kit for 1966-67 El Caminos & Convertibles; T-56 Transmissions: For use with above Muscle Rods Hedders.
03817	Conversion Kit for 1966-67 El Caminos & Convertibles; 4L60E / 65E Transmissions: For use with above Muscle Rods Hedders.

1968-72 A-BODIES: (Chevelle, El Camino, Le Mans, GTO, Cutlass, Skylark, GS, Tempest) [Hedders and conversion kits sold separately]												
1 3/4"	MID-LENGTH	45540	45546	45543	M12, M14, M19, M34, M36, M41	YES	YES	NO	YES	NO	YES	3" Ball & Socket Style
1 3/4"	LONG TUBE	45550	45556	45553	M12, M14, M19, M36, M41	YES	YES	NO	YES	NO	YES	3" Slip-on Race Style
1 3/4" x 1 7/8"	STEPPED LONG TUBE	45560	45566	45563	M12, M14, M19, M36, M41	YES	YES	NO	YES	NO	YES	3" Slip-on Race Style
1 7/8"	LONG TUBE	45570	45576	45573	M12, M14, M19, M36, M41	YES	YES	NO	YES	NO	YES	3" Slip-on Race Style
1 7/8" x 2"	STEPPED LONG TUBE	45580	45586	45583	M12, M14, M19, M36, M41	YES	YES	NO	YES	NO	YES	3" Slip-on Race Style
2"	LONG TUBE	45590	45596	45593	M12, M14, M19, M36, M41	YES	YES	NO	YES	NO	YES	3" Slip-on Race Style

LS CONVERSION KITS (Sold separately) designed specifically for use with the above Muscle Rods Hedders.

Contains: Frame Brackets, Motor Mounts, Transmission Crossmember, All Polyurethane Bushings, Hardware, Detailed Instructions.

03818	Conversion Kit for 1968-72 Coupes; T-56 Transmissions: For use with above Muscle Rods Hedders.
03819	Conversion Kit for 1968-72 Coupes; 4L60E / 65E Transmissions: For use with above Muscle Rods Hedders.
03855	Conversion Kit for 1968-72 El Caminos & Convertibles; T-56 Transmissions: For use with above Muscle Rods Hedders.
03856	Conversion Kit for 1968-72 El Caminos & Convertibles; 4L60E / 65E Transmissions: For use with above Muscle Rods Hedders.

1970-72 A-BODY Monte Carlo [Hedders and conversion kits sold separately]												
1 3/4"	MID-LENGTH	45180	45186	45183	M12, M14, M19, M34, M36, M41	YES	YES	NO	YES	NO	YES	3" Ball & Socket Style
1 3/4"	LONG TUBE	45190	45196	45193	M12, M14, M19, M36, M41	YES	YES	NO	YES	NO	YES	3" Slip-on Race Style
1 3/4" x 1 7/8"	STEPPED LONG TUBE	45200	45206	45203	M12, M14, M19, M36, M41	YES	YES	NO	YES	NO	YES	3" Slip-on Race Style
1 7/8"	LONG TUBE	45210	45216	45213	M12, M14, M19, M36, M41	YES	YES	NO	YES	NO	YES	3" Slip-on Race Style
1 7/8" x 2"	STEPPED LONG TUBE	45220	45226	45223	M12, M14, M19, M36, M41	YES	YES	NO	YES	NO	YES	3" Slip-on Race Style
2"	LONG TUBE	45230	45236	45233	M12, M14, M19, M36, M41	YES	YES	NO	YES	NO	YES	3" Slip-on Race Style

LS CONVERSION KITS (Sold separately) designed specifically for use with the above Muscle Rods Hedders.

Contains: Frame Brackets, Motor Mounts, Transmission Crossmember, All Polyurethane Bushings, Hardware, Detailed Instructions.

03820	Conversion Kit for T-56 Transmissions: For use with above 1970-72 A-BODY Monte Carlo Muscle Rods Hedders.
03821	Conversion Kit for 4L60E / 65E Transmissions: For use with above 1970-72 A-BODY Monte Carlo Muscle Rods Hedders.

1973-77 A-BODIES: (Chevelle, Can-Am, Cutlass, Grand Am, Laguna, Le Mans, Monte Carlo) [Hedders and conversion kits sold separately]												
1 3/4"	MID-LENGTH	45780	45786	45783	M11, M13, M14, M18, M29, M34, M36, M39	YES	YES	NO	YES	NO	YES	3" Ball & Socket Style
1 3/4"	LONG TUBE	45790	45796	45793	M11, M13, M14, M18, M29, M36, M39	YES	YES	NO	YES	NO	YES	3" Slip-on Race Style
1 3/4" x 1 7/8"	STEPPED LONG TUBE	45800	45806	45803	M11, M13, M14, M18, M29, M36, M39	YES	YES	NO	YES	NO	YES	3" Slip-on Race Style
1 7/8"	LONG TUBE	45810	45816	45813	M11, M13, M14, M18, M29, M36, M39	YES	YES	NO	YES	NO	YES	3" Slip-on Race Style
1 7/8" x 2"	STEPPED LONG TUBE	45820	45826	45823	M11, M13, M14, M18, M29, M36, M39	YES	YES	NO	YES	NO	YES	3" Slip-on Race Style
2"	LONG TUBE	45830	45836	45833	M11, M13, M14, M18, M29, M36, M39	YES	YES	NO	YES	NO	YES	3" Slip-on Race Style

LS CONVERSION KITS (Sold separately) designed specifically for use with the above Muscle Rods Hedders.

Contains: Frame Brackets, Motor Mounts, Transmission Crossmember, All Polyurethane Bushings, Hardware, Detailed Instructions.

03822	Conversion Kit for T-56 Transmissions: For use with above 1973-77 A-BODIES Muscle Rods Hedders.
03823	Conversion Kit for 4L60E / 65E Transmissions: For use with above 1973-77 A-BODIES Muscle Rods Hedders.

1978-83 A-BODY Malibu & 1978-87 A-BODY El Camino [Hedders and conversion kits sold separately]												
1 3/4"	MID-LENGTH	45000	45006	45003	M7, M12, M14, M21, M28, M33, M34, M35	YES	YES	NO	YES	NO	YES	3" Ball & Socket Style
1 3/4"	LONG TUBE	45010	45016	45013	M7, M12, M14, M21, M28, M33, M35	YES	YES	NO	YES	NO	YES	3" Slip-on Race Style
1 3/4" x 1 7/8"	STEPPED LONG TUBE	45020	45026	45023	M7, M12, M14, M21, M28, M33, M35	YES	YES	NO	YES	NO	YES	3" Slip-on Race Style
1 7/8"	LONG TUBE	45030	45036	45033	M7, M12, M14, M21, M28, M33, M35	YES	YES	NO	YES	NO	YES	3" Slip-on Race Style
1 7/8" x 2"	STEPPED LONG TUBE	45040	45046	45043	M7, M12, M14, M21, M28, M33, M35	YES	YES	NO	YES	NO	YES	3" Slip-on Race Style
2"	LONG TUBE	45050	45056	45053	M7, M12, M14, M21, M28, M33, M35	YES	YES	NO	YES	NO	YES	3" Slip-on Race Style

LS CONVERSION KITS (Sold separately) designed specifically for use with the above Muscle Rods Hedders.

Contains: Frame Brackets, Motor Mounts, Transmission Crossmember, All Polyurethane Bushings, Hardware, Detailed Instructions.

03824	Conversion Kit for T-56 Transmissions: For use with the above 1978-83 A-BODY Muscle Rods Hedders.
03825	Conversion Kit for 4L60E / 65E Transmissions: For use with the above 1978-83 A-BODY Muscle Rods Hedders.

1991-96 B-BODIES: (Roadmaster, Caprice, Impala SS) [Hedders and conversion kits sold separately]												
1 3/4"	MID-LENGTH	45480	45486	45483	M9, M13, M14, M18, M25, M30, M34, M35	YES	YES	NO	YES	NO	YES	3" Ball & Socket Style
1 3/4"	LONG TUBE	45490	45496	45493	M6, M9, M13, M14, M18, M25, M30, M35	YES	YES	NO	YES	NO	YES	3" Flat Style
1 3/4" x 1 7/8"	STEPPED LONG TUBE	45500	45506	45503	M6, M9, M13, M14, M18, M25, M30, M35	YES	YES	NO	YES	NO	YES	3" Flat Style
1 7/8"	LONG TUBE	45510	45516	45513	M6, M9, M13, M14, M18, M25, M30, M35	YES	YES	NO	YES	NO	YES	3" Flat Style
1 7/8" x 2"	STEPPED LONG TUBE	45520	45526	45523	M6, M9, M13, M14, M18, M25, M30, M35	YES	YES	NO	YES	NO	YES	3" Flat Style
2"	LONG TUBE	45530	45536	45533	M6, M9, M13, M14, M18, M25, M30, M35	YES	YES	NO	YES	NO	YES	3" Flat Style

LS CONVERSION KITS (Sold separately) designed specifically for use with the above Muscle Rods Hedders.

Contains: Frame Brackets, Motor Mounts, Transmission Crossmember, All Polyurethane Bushings, Hardware, Detailed Instructions.

03826	Conversion Kit for T-56 Transmissions: For use with the above 1991-96 B-BODY Muscle Rods Hedders.
03827	Conversion Kit for 4L60E / 65E Transmissions: For use with the above 1991-96 B-BODY Muscle Rods Hedders.
03829	Conversion Kit for 4L80E Transmissions: For use with the above 1991-96 B-BODY Muscle Rods Hedders.

HEDDERS ON THIS PAGE ARE NOT LEGAL FOR SALE OR USE ON POLLUTION CONTROLLED MOTOR VEHICLES.



MUSCLE RODS™ LS ENGINE SWAP PRODUCTS



TUBE SIZE	HEDDER DESIGN	UNCOATED PART #	HTC COATED PART #	BLACK MAXX PART #	APPLICATION & INSTALLATION FOOTNOTES (see page 7)	A/C	P/S	TRANSMISSION			COLLECTOR SIZE & STYLE	
								AUTOMATIC COL. FLR.	STANDARD COL. FLR.	NO. YES		
1967-69 F-BODIES 1st Gen: (Camaro, Firebird, Trans-Am) [Hedders and conversion kits sold separately]												
1 3/4"	MID-LENGTH	45060	45066	45063	M7, M11, M13, M14, M21, M26, M32, M34, M35	YES	YES	NO	YES	NO	YES	3" Ball & Socket Style
1 3/4"	LONG TUBE	45070	45076	45073	M7, M11, M13, M14, M21, M26, M32, M35	YES	YES	NO	YES	NO	YES	3" Slip-on Race Style
1 3/4" x 1 7/8"	STEPPED LONG TUBE	45080	45086	45083	M7, M11, M13, M14, M21, M26, M32, M35	YES	YES	NO	YES	NO	YES	3" Slip-on Race Style
1 7/8"	LONG TUBE	45090	45096	45093	M7, M11, M13, M14, M21, M26, M32, M35	YES	YES	NO	YES	NO	YES	3" Slip-on Race Style
1 7/8" x 2"	STEPPED LONG TUBE	45100	45106	45103	M7, M11, M13, M14, M21, M26, M32, M35	YES	YES	NO	YES	NO	YES	3" Slip-on Race Style
2"	LONG TUBE	45110	45116	45113	M7, M11, M13, M14, M21, M26, M32, M35	YES	YES	NO	YES	NO	YES	3" Slip-on Race Style

LS CONVERSION KITS (Sold separately) designed specifically for use with the above Muscle Rods Hedders.

03830 Conversion Kit for T-56 Transmissions: For use with the above 1st GEN F-BODY Muscle Rods Hedders.
03831 Conversion Kit for 4L60E / 65E Transmissions: For use with the above 1st GEN F-BODY Muscle Rods Hedders.
03832 Conversion Kit for 4L80E Transmissions: For use with the above 1st GEN F-BODY Muscle Rods Hedders.

1970-81 F-BODIES 2nd Gen: (Camaro, Firebird, Trans-Am) [Hedders and conversion kits sold separately]												
1 3/4"	MID-LENGTH	45120	45126	45123	M12, M14, M17, M30, M31, M34, M35	YES	YES	NO	YES	NO	YES	3" Ball & Socket Style
1 3/4"	LONG TUBE	45130	45136	45133	M12, M14, M17, M30, M31, M35	YES	YES	NO	YES	NO	YES	3" Slip-on Race Style
1 3/4" x 1 7/8"	STEPPED LONG TUBE	45140	45146	45143	M12, M14, M17, M30, M31, M35	YES	YES	NO	YES	NO	YES	3" Slip-on Race Style
1 7/8"	LONG TUBE	45150	45156	45153	M12, M14, M17, M30, M31, M35	YES	YES	NO	YES	NO	YES	3" Slip-on Race Style
1 7/8" x 2"	STEPPED LONG TUBE	45160	45166	45163	M12, M14, M17, M30, M31, M35	YES	YES	NO	YES	NO	YES	3" Slip-on Race Style
2"	LONG TUBE	45170	45176	45173	M12, M14, M17, M30, M31, M35	YES	YES	NO	YES	NO	YES	3" Slip-on Race Style

LS CONVERSION KITS (Sold separately) designed specifically for use with the above Muscle Rods Hedders.

03833 Conversion Kit for T-56 Transmissions: For use with above 2nd GEN F-BODY Muscle Rods Hedders.
03834 Conversion Kit for 4L60E / 65E Transmissions: For use with above 2nd GEN F-BODY Muscle Rods Hedders.

1982-92 F-BODIES 3rd Gen: (Camaro, Firebird, Trans-Am) [Hedders and conversion kits sold separately]												
1 3/4"	MID-LENGTH	45720	45726	45723	M7, M12, M14, M16, M29, M34, M36	YES	YES	NO	YES	NO	YES	3" Ball & Socket Style
1 3/4"	LONG TUBE	45730	45736	45733	M7, M12, M14, M16, M29, M36	YES	YES	NO	YES	NO	YES	3" Flat Style
1 3/4" x 1 7/8"	STEPPED LONG TUBE	45740	45746	45743	M7, M12, M14, M16, M29, M36	YES	YES	NO	YES	NO	YES	3" Flat Style
1 7/8"	LONG TUBE	45750	45756	45753	M7, M12, M14, M16, M29, M36	YES	YES	NO	YES	NO	YES	3" Flat Style
1 7/8" x 2"	STEPPED LONG TUBE	45760	45766	45763	M7, M12, M14, M16, M29, M36	YES	YES	NO	YES	NO	YES	3" Flat Style
2"	LONG TUBE	45770	45776	45773	M7, M12, M14, M16, M29, M36	YES	YES	NO	YES	NO	YES	3" Flat Style

LS CONVERSION KITS (Sold separately) designed specifically for use with the above Muscle Rods Hedders.

03835 Conversion Kit for T-56 Transmissions: For use with above 3rd GEN F-BODY Muscle Rods Hedders.
03836 Conversion Kit for 4L60E / 65E Transmissions: For use with above 3rd GEN F-BODY Muscle Rods Hedders.

1982-88 G-BODIES: (Cutlass, Monte Carlo) [Hedders and conversion kits sold separately]												
1 3/4"	MID-LENGTH	45000	45006	45003	M7, M12, M14, M21, M29, M34, M36, M43	YES	YES	NO	YES	NO	YES	3" Ball & Socket Style
1 3/4"	LONG TUBE	45010	45016	45013	M7, M12, M14, M21, M29, M36, M43	YES	YES	NO	YES	NO	YES	3" Slip-on Race Style
1 3/4" x 1 7/8"	STEPPED LONG TUBE	45020	45026	45023	M7, M12, M14, M21, M29, M36, M43	YES	YES	NO	YES	NO	YES	3" Slip-on Race Style
1 7/8"	LONG TUBE	45030	45036	45033	M7, M12, M14, M21, M29, M36, M43	YES	YES	NO	YES	NO	YES	3" Slip-on Race Style
1 7/8" x 2"	STEPPED LONG TUBE	45040	45046	45043	M7, M12, M14, M21, M29, M36, M43	YES	YES	NO	YES	NO	YES	3" Slip-on Race Style
2"	LONG TUBE	45050	45056	45053	M7, M12, M14, M21, M29, M36, M43	YES	YES	NO	YES	NO	YES	3" Slip-on Race Style

LS CONVERSION KITS (Sold separately) designed specifically for use with the above Muscle Rods Hedders.

03837 Conversion Kit for T-56 Transmissions: For use with the above 1982-88 G-BODY Muscle Rods Hedders.
03838 Conversion Kit for 4L60E / 65E Transmissions: For use with the above 1982-88 G-BODY Muscle Rods Hedders.

1962-67 CHEVY II/NOVA: [Hedders and conversion kits sold separately]												
1 3/4"	LONG TUBE	45310	45316	45313	M2, M7, M12, M14, M20, M24, M28, M34, M41, M45, M46	YES	YES	NO	YES	NO	YES	3" Slip-on Race Style
1 3/4" x 1 7/8"	STEPPED LONG TUBE	45320	45326	45323	M2, M7, M12, M14, M20, M24, M28, M41, M45, M46	YES	YES	NO	YES	NO	YES	3" Slip-on Race Style

LS CONVERSION KITS (Sold separately) designed specifically for use with the above Muscle Rods Hedders.

03857 Conversion Kit for T-56 AND 4L60E Transmissions: For use with the above 1962-67 CHEVY II & NOVA Muscle Rods Hedders.

1968-74 X-BODIES: (Nova, Ventura II) [Hedders and conversion kits sold separately]												
1 3/4"	MID-LENGTH	45360	45366	45363	M7, M11, M13, M14, M21, M27, M32, M34, M35	YES	YES	NO	YES	NO	YES	3" Ball & Socket Style
1 3/4"	LONG TUBE	45370	45376	45373	M7, M11, M13, M14, M21, M27, M32, M35	YES	YES	NO	YES	NO	YES	3" Slip-on Race Style
1 3/4" x 1 7/8"	STEPPED LONG TUBE	45380	45386	45383	M7, M11, M13, M14, M21, M27, M32, M35	YES	YES	NO	YES	NO	YES	3" Slip-on Race Style
1 7/8"	LONG TUBE	45390	45396	45393	M7, M11, M13, M14, M21, M27, M32, M35	YES	YES	NO	YES	NO	YES	3" Slip-on Race Style
1 7/8" x 2"	STEPPED LONG TUBE	45400	45406	45403	M7, M11, M13, M14, M21, M27, M32, M35	YES	YES	NO	YES	NO	YES	3" Slip-on Race Style
2"	LONG TUBE	45410	45416	45413	M7, M11, M13, M14, M21, M27, M32, M35	YES	YES	NO	YES	NO	YES	3" Slip-on Race Style

LS CONVERSION KITS (Sold separately) designed specifically for use with the above Muscle Rods Hedders.

03830 Conversion Kit for T-56 Transmissions: For use with the above 1968-74 X-BODY Muscle Rods Hedders.
03831 Conversion Kit for 4L60E / 65E Transmissions: For use with the above 1968-74 X-BODY Muscle Rods Hedders.
03832 Conversion Kit for 4L80E Transmissions: For use with the above 1968-74 X-BODY Muscle Rods Hedders.



FOX BODY LS SWAP HEDDERS

The Fox Body Mustang is among the most popular cars used for drag racing today, and the LS engine is among the most popular, and abundant, engines around. Given the LS engine's power potential, it was only a matter of time before these two platforms would merge into one. Muscle Rods for your Bowtie into Pony swap have been designed using a CTS-V oil pan and the STOCK K-member, so there's no need to cut and weld the oil pan for crossmember clearance.

TUBE SIZE	HEDDER DESIGN	UNCOATED PART #	HTC COATED PART #	BLACK MAXX PART #	APPLICATION & INSTALLATION FOOTNOTES (see page 7)	A/C	P/S	TRANSMISSION			COLLECTOR SIZE & STYLE	
								AUTOMATIC COL. FLR.	STANDARD COL. FLR.	YES		
1982-93 FORD MUSTANG [Hedders and conversion kits sold separately]												
1 3/4"	MID-LENGTH	45840	45846	45843	M1, M2, M12, M14, M18, M29, M34, M35	YES	YES	NO	YES	NO	YES	3" Ball & Socket Style
1 3/4"	LONG TUBE	45850	45856	45853	M1, M2, M12, M14, M18, M29, M35	YES	YES	NO	YES	NO	YES	3" Slip-on Race Style
1 3/4" x 1 7/8"	STEPPED LONG TUBE	45860	45866	45863	M1, M2, M12, M14, M18, M29, M35	YES	YES	NO	YES	NO	YES	3" Slip-on Race Style
1 7/8"	LONG TUBE	45870	45876	45873	M1, M2, M12, M14, M18, M29, M35	YES	YES	NO	YES	NO	YES	3" Slip-on Race Style
1 7/8" x 2"	STEPPED LONG TUBE	45880	45886	45883	M1, M2, M12, M14, M18, M29, M35	YES	YES	NO	YES	NO	YES	3" Slip-on Race Style
2"	LONG TUBE	45890	45896	45893	M1, M2, M12, M14, M18, M29, M35	YES	YES	NO	YES	NO	YES	3" Slip-on Race Style

LS CONVERSION KITS (Sold separately) designed specifically for use with the above Muscle Rods Hedders.

Contains: Frame Brackets, Motor Mounts, Transmission Crossmember, All Polyurethane Bushings, Hardware, Detailed Instructions.
03839 Conversion Kit for T-56 Transmissions: For use with the above 1982-93 FOX BODY Muscle Rods Hedders.
03840 Conversion Kit for 4L60E / 65E Transmissions: For use with the above 1982-93 FOX BODY Muscle Rods Hedders.



S-10 LS SWAP HEDDERS

The Hedman Performance Group has been manufacturing SB Chevy and LS engine swap products for S-10 and related vehicles for several years. Muscle Rods from Hedman Husler take the transplant to the next level by offering tube sizes and combinations that will meet the needs of high output LS engine builds. When used with the available conversion kits, Muscle Rods will help make your engine swap project go much smoother.

TUBE SIZE	HEDDER DESIGN	UNCOATED PART #	HTC COATED PART #	BLACK MAXX PART #	APPLICATION & INSTALLATION FOOTNOTES (see page 7)	A/C	P/S	TRANSMISSION			COLLECTOR SIZE & STYLE	
								AUTOMATIC COL. FLR.	STANDARD COL. FLR.	YES		
1982-93 CHEVY S-10 (2WD only) Not for Blazers [Hedders and conversion kits sold separately]												
1 5/8"	MID-LENGTH	45240	45246	45243	M4, M5, M7, M11, M13, M14, M21, M23, M34, M35, M37, M38, M40	NO	YES	NO	YES	NO	YES	3" Ball & Socket Style
1 3/4"	LONG TUBE	45250	45256	45253	M4, M5, M7, M11, M13, M14, M21, M23, M35, M37, M38, M40	NO	YES	NO	YES	NO	YES	3" Slip-on Race Style
1 3/4" x 1 7/8"	STEPPED LONG TUBE	45260	45266	45263	M4, M5, M7, M11, M13, M14, M21, M23, M35, M37, M38, M40	NO	YES	NO	YES	NO	YES	3" Slip-on Race Style
1 7/8"	LONG TUBE	45270	45276	45273	M4, M5, M7, M11, M13, M14, M21, M23, M35, M37, M38, M40	NO	YES	NO	YES	NO	YES	3" Slip-on Race Style
1 7/8" x 2"	STEPPED LONG TUBE	45280	45286	45283	M4, M5, M7, M11, M13, M14, M21, M23, M35, M37, M38, M40	NO	YES	NO	YES	NO	YES	3" Slip-on Race Style
2"	LONG TUBE	45290	45296	45293	M4, M5, M7, M11, M13, M14, M21, M23, M35, M37, M38, M40	NO	YES	NO	YES	NO	YES	3" Slip-on Race Style

LS CONVERSION KITS (Sold separately) designed specifically for use with the above Muscle Rods Hedders.

Contains: Frame Brackets, Motor Mounts, Transmission Crossmember, All Polyurethane Bushings, Hardware, Detailed Instructions.
03841 Conversion Kit for T-56 Transmissions: For use with the above 1982-93 CHEVY S-10 (2WD only) Muscle Rods Hedders.
03842 Conversion Kit for 4L60E / 65E Transmissions: For use with the above 1982-93 CHEVY S-10 (2WD only) Muscle Rods Hedders.

1994-03 CHEVY S-10 (2WD only) Not for Blazers

TUBE SIZE	HEDDER DESIGN	UNCOATED PART #	HTC COATED PART #	BLACK MAXX PART #	APPLICATION & INSTALLATION FOOTNOTES (see page 7)	A/C	P/S	TRANSMISSION	COLLECTOR SIZE & STYLE
1 3/4"	LONG TUBE	45900	45906	45903	M4, M5, M11, M13, M14, M21, M23, M35, M38	YES	YES	YES	Slip-on Race Style

LS CONVERSION KITS (Sold separately) designed specifically for use with the above Muscle Rods Hedders.

Contains: Frame Brackets, Motor Mounts, Transmission Crossmember, All Polyurethane Bushings, Hardware, Detailed Instructions.
03843 Conversion Kit for T-56 Transmissions: For use with the above 1994-03 CHEVY S-10 (2WD only) Muscle Rods Hedders.
03844 Conversion Kit for 4L60E / 65E Transmissions: For use with the above 1994-03 CHEVY S-10 (2WD only) Muscle Rods Hedders.

1982-00 CHEVY S-10, BLAZER (4WD only)

TUBE SIZE	HEDDER DESIGN	UNCOATED PART #	HTC COATED PART #	BLACK MAXX PART #	APPLICATION & INSTALLATION FOOTNOTES (see page 7)	A/C	P/S	TRANSMISSION	COLLECTOR SIZE & STYLE
1 3/4"	MID-LENGTH	45300	45306	45303	M3, M4, M5, M7, M10, M14, M21, M34, M37, M42	YES	YES	YES	3" Ball & Socket Style

LS CONVERSION KITS (Sold separately) designed specifically for use with the above Muscle Rods Hedders.

Contains: Frame Brackets, Motor Mounts, Transmission Crossmember, All Polyurethane Bushings, 2" Lift Kit, crank spacer, Hardware, Detailed Instructions.
03845 Conversion Kit for 700R4 Transmissions: For use with the above 1982-00 CHEVY S-10 (4WD only) Muscle Rods Hedders.



EARLY MODEL CHEVY TRUCK LS SWAP HEDDERS

If you're restoring an early model Chevy truck, the chances are very good that you have chosen to install an up-to-date, more efficient LS Series engine. If so, Muscle Rods LS Swap hedders and conversion kits will eliminate much of the guess work, when it comes to bolting the engine to the chassis and routing your exhaust out the rear.

TUBE SIZE	HEDDER DESIGN	UNCOATED PART #	HTC COATED PART #	BLACK MAXX PART #	APPLICATION & INSTALLATION FOOTNOTES (see page 7)	A/C	P/S	TRANSMISSION			COLLECTOR SIZE & STYLE	
								AUTOMATIC COL. FLR.	STANDARD COL. FLR.	YES		
1967-72 GM 1/2 TRUCKS (2WD Only) [Hedders and conversion kits sold separately]												
1 3/4"	MID-LENGTH	45660	45666	45663	M7, M11, M13, M14, M21, M24, M29, M34, M35	YES	YES	NO	YES	NO	YES	3" Ball & Socket Style
1 3/4"	LONG TUBE	45670	45676	45673	M7, M11, M13, M14, M21, M24, M29, M35	YES	YES	NO	YES	NO	YES	3" Slip-on Race Style
1 3/4" x 1 7/8"	STEPPED LONG TUBE	45680	45686	45683	M7, M11, M13, M14, M21, M24, M29, M35	YES	YES	NO	YES	NO	YES	3" Slip-on Race Style
1 7/8"	LONG TUBE	45690	45696	45693	M7, M11, M13, M14, M21, M24, M29, M35	YES	YES	NO	YES	NO	YES	3" Slip-on Race Style
1 7/8" x 2"	STEPPED LONG TUBE	45700	45706	45703	M7, M11, M13, M14, M21, M24, M29, M35	YES	YES	NO	YES	NO	YES	3" Slip-on Race Style
2"	LONG TUBE	45710	45716	45713	M7, M11, M13, M14, M21, M24, M29, M35	YES	YES	NO	YES	NO	YES	3" Slip-on Race Style

LS CONVERSION KITS (Sold separately) designed specifically for use with the above Muscle Rods Hedders.

Contains: Frame Brackets, Motor Mounts, Transmission Crossmember, All Polyurethane Bushings, Hardware, Detailed Instructions.
03846 Conversion Kit for 4L60E / 65E Transmissions: For use with the above 1967-72 GM 1/2 TRUCKS (2WD Only) Muscle Rods Hedders.
03847 Conversion Kit for 4L80E Transmissions: For use with the above 1967-72 GM 1/2 TRUCKS (2WD Only) Muscle Rods Hedders.

HEDDERS ON THIS PAGE ARE NOT LEGAL FOR SALE OR USE ON POLLUTION CONTROLLED MOTOR VEHICLES.



MUSCLE RODS™ LS ENGINE SWAP PRODUCTS



EARLY MODEL CHEVY TRUCK LS SWAP HEDDERS (continued)

TUBE SIZE	HEDDER DESIGN	UNCOATED PART #	HTC COATED PART #	BLACK MAXX PART #	APPLICATION & INSTALLATION FOOTNOTES (See Below)	A/C	P/S	TRANSMISSION			COLLECTOR SIZE & STYLE	
								AUTOMATIC COL. FLR.	STANDARD COL. FLR.	YES		
1 3/4"	MID-LENGTH	45660	45666	45663	M7, M9, M13, M14, M21, M24, M29, M34, M35	YES	YES	NO	YES	NO	YES	3" Ball & Socket Style
1 3/4"	LONG TUBE	45670	45676	45673	M7, M9, M13, M14, M21, M24, M29, M35	YES	YES	NO	YES	NO	YES	3" Slip-on Race Style
1 3/4" x 1 7/8"	STEPPED LONG TUBE	45680	45686	45683	M7, M9, M13, M14, M21, M24, M29, M35	YES	YES	NO	YES	NO	YES	3" Slip-on Race Style
1 7/8"	LONG TUBE	45690	45696	45693	M7, M9, M13, M14, M21, M24, M29, M35	YES	YES	NO	YES	NO	YES	3" Slip-on Race Style
1 7/8" x 2"	STEPPED LONG TUBE	45700	45706	45703	M7, M9, M13, M14, M21, M24, M29, M35	YES	YES	NO	YES	NO	YES	3" Slip-on Race Style
2"	LONG TUBE	45710	45716	45713	M7, M9, M13, M14, M21, M24, M29, M35	YES	YES	NO	YES	NO	YES	3" Slip-on Race Style

LS CONVERSION KITS (Sold separately)
designed specifically for use with the above Muscle Rods Heddres.

Contains: Frame Brackets, Motor Mounts, Transmission Crossmember, All Polyurethane Bushings, Hardware, Detailed Instructions.
03848 Conversion Kit for 4L60E / 65E Transmissions: For use with the above 1973-87 GM 1/2 TON TRUCKS & SUVs (2WD Only) Muscle Rods Heddres.
03849 Conversion Kit for 4L80E Transmissions: For use with the above 1973-87 GM 1/2 TON TRUCKS & SUVs (2WD Only) Muscle Rods Heddres.

1988-98 GM 1/2 TON TRUCKS & SUVs (2WD Only) [Heddres and conversion kits sold separately]

TUBE SIZE	HEDDER DESIGN	UNCOATED PART #	HTC COATED PART #	BLACK MAXX PART #	APPLICATION & INSTALLATION FOOTNOTES (See Below)	A/C	P/S	TRANSMISSION			COLLECTOR SIZE & STYLE	
								AUTOMATIC COL. FLR.	STANDARD COL. FLR.	YES		
1 3/4"	MID-LENGTH	45660	45666	45663	M7, M11, M13, M14, M21, M24, M29, M34, M35	YES	YES	NO	YES	NO	YES	3" Ball & Socket Style
1 3/4"	LONG TUBE	45670	45676	45673	M7, M11, M13, M14, M21, M24, M29, M35	YES	YES	NO	YES	NO	YES	3" Slip-on Race Style
1 3/4" x 1 7/8"	STEPPED LONG TUBE	45680	45686	45683	M7, M11, M13, M14, M21, M24, M29, M35	YES	YES	NO	YES	NO	YES	3" Slip-on Race Style
1 7/8"	LONG TUBE	45690	45696	45693	M7, M11, M13, M14, M21, M24, M29, M35	YES	YES	NO	YES	NO	YES	3" Slip-on Race Style
1 7/8" x 2"	STEPPED LONG TUBE	45700	45706	45703	M7, M11, M13, M14, M21, M24, M29, M35	YES	YES	NO	YES	NO	YES	3" Slip-on Race Style
2"	LONG TUBE	45710	45716	45713	M7, M11, M13, M14, M21, M24, M29, M35	YES	YES	NO	YES	NO	YES	3" Slip-on Race Style

LS CONVERSION KITS (Sold separately)
designed specifically for use with the above Muscle Rods Heddres.

Contains: Frame Brackets, Motor Mounts, Transmission Crossmember, All Polyurethane Bushings, Hardware, Detailed Instructions.
03850 Conversion Kit for 4L60E / 65E Transmissions: For use with the above 1988-98 GM 1/2 TON TRUCKS & SUV (2WD Only) Muscle Rods Heddres.
03851 Conversion Kit for 4L80E Transmissions: For use with the above 1988-98 GM 1/2 TON TRUCKS & SUV (2WD Only) Muscle Rods Heddres.
03852 Conversion Kit for T-56 Transmissions: For use with the above 1988-98 GM 1/2 TON TRUCKS & SUV (2WD Only) Muscle Rods Heddres.



APPLICATION & INSTALLATION FOOTNOTES

- M1 98-02 F-body Camaro/Firebird A/C compressor requires a 3/4" spacer underneath both sides of the sway bar.
- M2 98-02 F-body Camaro/Firebird alternator clears frame without modifications.
- M3 A 2" body lift is required to allow the transmission to be positioned high enough to bolt up to the engine.
- M4 A Kwik Performance top mount A/C bracket will be needed to run A/C.
- M5 A low mount A/C compressor will not clear the frame.
- M6 These long tube Heddres have the flat style collector.
- M7 Heddres are designed around a floor shifter linkage. Column shift linkage may require modifications for clearance.
- M9 Designed for use with 4L60E, 4L65E, 4L80E transmissions.
- M10 Designed for use with stock 700R4 transmissions.
- M11 Designed for use with T-56, 4L60E, 4L65E, 4L80E transmissions.
- M12 Designed for use with T-56, 4L60E, 4L65E transmissions.
- M13 If using a 4L80 transmission, the bell housing tabs must be trimmed for hedder clearance.
- M14 In some installations starter, valve cover, and/or spark plugs may need to be removed.
- M16 Designed for use with a GM 98-02 F-body oil pan.
- M17 Designed for use with a GM 98-02 F-body, or Cadillac CTS-V oil pan.
- M18 Designed for use with a Cadillac CTS-V oil pan.
- M19 Designed for use with a GM LH-8 or Cadillac CTS-V oil pan.
- M20 Designed to work with 2004-06 GTO Oil Pan
- M21 Designed for use with a GM LH-8 oil pan.
- M22 May need to bend transmission tunnel seam lip over to clear T-56 transmission.
- M23 Modifications to the A/C box will be needed for passenger's side coil pack clearance.
- M24 NO notching of the frame is required when using the 98-02 Camaro/Firebird A/C compressor and alternator.
- M25 NO notching of frame required when 98-02 Camaro/Firebird A/C compressor.
- M26 NO transmission tunnel modifications are required on a 67-69 Camaro/Firebird when running the 4L60E. If running a T-56 transmission, splitting the transmission tunnel may be required.

- M27 NO transmission tunnel modifications are required when running a 4L60E. If running a T-56 transmission in a 68-74 Nova, splitting the transmission tunnel may be required.
- M28 NO transmission tunnel modifications required when running a 4L60E. T-56 transmission set-ups require splitting the transmission tunnel.
- M29 NO transmission tunnel modifications required.
- M30 NO transmission tunnel modifications required. Heddres are designed around a floor shifter linkage. Column shift linkage may require modifications for clearance.
- M31 Notching of the frame is required when using the 98-02 Camaro/Firebird F-body A/C compressor lines (compressor itself clears). To avoid this notching, use a top mount A/C Kwik performance bracket.
- M32 Notching of the frame is required when using the 98-02 Camaro/Firebird F-body A/C compressor lines. To avoid this notching, use a top mount A/C Kwik performance bracket.
- M33 Notching of the frame is required when using the 98-02 Camaro/Firebird F-body A/C compressor.
- M34 Mid-length Heddres have a weld-on ball and socket type collectors with O2 sensor bungs.
- M35 Clears the factory OEM A/C box, power steering box, and power brakes.
- M36 Clears the factory OEM A/C box, power steering box, and power brakes.
- M36 Notching of the frame is required when using the 98-02 Camaro/Firebird F-body A/C compressor.
- M37 Requires Truck or Corvette accessories with power steering pump on bottom driver's side.
- M38 Steering shaft needs to be removed and re-installed for hedder installation
- M39 A 98-02 F-body Camaro/Firebird alternator clears the frame, but the A/C compressor will require notching of the K-member to fit. To avoid K-member notching, use a Kwik Performance top mount A/C bracket.
- M40 The cab, fenders, and core support must be loosened and raised up to allow for installation of the motor and transmission as a single unit (attached to each other).
- M41 Transmission tunnel modifications are required when running a T-56 transmission. Heddres are designed around a floor shifter linkage. Column shift linkage may require modifications for clearance.
- M42 This installation requires the truck be lifted 2", as well as, a crank spacer. A 2" lift kit and crank spacer are included in Muscle Rods Conversion kit #03845.
- M43 Non-overdrive frame requires modification.
- M45 Works with OEM front sub-frame ONLY.
- M46 Works with factory slave cylinder power assisted steering.

THE CHOICE OF CHAMPIONS SINCE 1954!

Hedman Husler Hedders is the longest standing hedder brand on the track today. With racing pedigree that go back more than five decades, our designers know how to design and build hedders that ensure you get every bit of power out of your engine.

We offer an extensive lineup of American Muscle Car hedders, most with a selection of tube sizes to meet any racer's performance needs. With Husler's legendary good quality and championship winning performance, it's no wonder the Husler Name continues to be the first choice among drag racers at every level of the sport.



APPLICATION	YEAR	ENGINE	RAW PART #	FOOTNOTES (SEE PAGE 9)	A/C	P/S	TRANSMISSION		TUBE & COLLECTOR SIZE	REPLACEMENT GASKET		
							AUTOMATIC COL. FLR.	STANDARD COL. FLR.				
CHEVROLET												
Camaro	67-69	283-400	65018	32, 51, 68, 69, 105	N	Y	N	Y	N	Y	1 5/8", 3"	18066
Camaro	67-69	283-400	65019	32, 51, 68, 69, 105	N	Y	N	Y	N	Y	1 3/4", 3"	18166
Camaro	67-69	283-400	65020	32, 51, 68, 69, 80, 105	N	Y	N	Y	N	Y	1 7/8", 3 1/2"	18068 & 18069
Camaro	67-69	283-400	65021	32, 51, 68, 69, 105	N	Y	N	Y	N	Y	1 3/4"x1 7/8", 3 1/2" Stepped	18166
Camaro	67-69	283-400	65022	32, 51, 68, 69, 80, 105	N	Y	N	Y	N	Y	1 7/8"x2", 3 1/2" Stepped	18068 & 18069
Camaro	67-69	283-400	65023	32, 51, 68, 69, 105 (Spread Port)	N	Y	N	Y	N	Y	1 7/8", 3 1/2"	18088
Camaro	67-69	283-400	65024	32, 51, 68, 69, 105 (Spread Port)	N	Y	N	Y	N	Y	2", 3 1/2"	18088
Camaro	67-69	283-400	65025	32, 51, 68, 69, 80, 105	N	Y	N	Y	N	Y	2", 3 1/2"	18068 & 18069
Camaro	67-69	283-400	65026	32, 51, 68, 69, 105 (Spread Port)	N	Y	N	Y	N	Y	1 7/8"x2", 3 1/2" Stepped	18088
Camaro	67-69	283-400	65027	32, 51, 68, 69, 105 (GM 18° Heads)	N	Y	N	Y	N	Y	1 7/8", 3 1/2"	N/A
Camaro	67-69	283-400	65028	32, 51, 68, 69, 105 (GM 18° Heads)	N	Y	N	Y	N	Y	2", 3 1/2"	N/A
Camaro	67-69	283-400	65029	32, 51, 68, 69, 105 (GM 18° Heads)	N	Y	N	Y	N	Y	1 7/8"x2", 3 1/2" Stepped	N/A
Camaro	67-69	396-454	65040	32, 39, 51, 68, 69, 208, 238	N	Y	N	Y	N	Y	2", 3 1/2"	18048
Camaro	67-69	396-454	65050	32, 39, 51, 68, 69, 208, 238	N	Y	N	Y	N	Y	2 1/8", 3 1/2"	18048
Camaro	67-69	396-454	65051	32, 39, 51, 68, 69, 208, 238	N	Y	N	Y	N	Y	2"x2 1/8", 3 1/2" Stepped	18048
Camaro	67-69	396-454	65070	32, 39, 51, 68, 69, 208, 238	N	Y	N	Y	N	Y	2 1/8", 4"	18048
Camaro	67-69	396-454	65071	32, 39, 51, 68, 69, 208, 238	N	Y	N	Y	N	Y	2"x2 1/8", 4" Stepped	18048
Camaro	67-69	396-454	65090	32, 39, 51, 68, 69, 208, 238	N	Y	N	Y	N	Y	2 1/4", 4"	18048
Camaro	67-69	396-454	65091	32, 39, 51, 68, 69, 208, 238	N	Y	N	Y	N	Y	2 1/8"x2 1/4", 4" Stepped	18048
Camaro	67-69	502-572	65576	32, 51, 56, 76, 208 (GM Crate)	N	Y	N	Y	N	Y	2 1/8", 3 1/2"	18048
Camaro	67-69	502-572	65577	32, 51, 56, 208 (GM Crate)	N	Y	N	Y	N	Y	2 1/8"x2 1/4", 4" Stepped	18048
Camaro	67-69	502-572	65578	32, 51, 56, 208 (GM Crate)	N	Y	N	Y	N	Y	2 1/4", 4"	18048
Camaro	70-81	283-400	65119	32, 51, 68, 69, 105	N	Y	N	Y	N	Y	1 3/4", 3"	18066
Camaro	70-81	283-400	65120	32, 51, 68, 69, 80, 105	N	Y	N	Y	N	Y	1 7/8", 3 1/2"	18068 & 18069
Camaro	70-81	283-400	65121	32, 51, 68, 69, 105	N	Y	N	Y	N	Y	1 3/4"x1 7/8", 3 1/2" Stepped	18166
Camaro	70-81	283-400	65122	32, 51, 68, 69, 105 (Spread Port)	N	Y	N	Y	N	Y	1 7/8", 3 1/2"	18088
Camaro	70-81	283-400	65123	32, 51, 68, 69, 105 (GM 18° Heads)	N	Y	N	Y	N	Y	1 7/8", 3 1/2"	N/A
Camaro	70-81	396-454	65130	32, 51, 65, 68, 69, 71, 73	N	Y	N	Y	N	Y	2 1/8", 3 1/2"	18048
Camaro	70-81	396-454	65131	32, 51, 68, 69, 73	N	Y	N	Y	N	Y	2"x2 1/8", 3 1/2" Stepped	18048
Camaro	70-81	396-454	65140	32, 51, 65, 68, 69, 71, 73	N	Y	N	Y	N	Y	2 1/8", 4"	18048
Camaro	70-81	396-454	65141	32, 51, 68, 69, 73	N	Y	N	Y	N	Y	2"x2 1/8", 4" Stepped	18048
Camaro	70-81	396-454	65150	32, 51, 65, 68, 69, 71, 73	N	Y	N	Y	N	Y	2 1/4", 4"	18048
Camaro	70-81	396-454	65152	32, 51, 68, 69, 73	N	Y	N	Y	N	Y	2 1/8"x2 1/4", 4" Stepped	18048
Camaro	83-92	283-400	65160	32, 51, 65, 66, 68, 69, 105, 151	N	Y	N	Y	N	N	1 5/8", 3"	18066
Camaro	83-92	283-400	65165	32, 51, 65, 66, 68, 69, 105, 151	N	Y	N	Y	N	N	1 3/4", 3"	18166
Camaro	83-92	283-400	65170	32, 51, 65, 66, 68, 69, 80, 105, 151	N	Y	N	Y	N	N	1 7/8", 3 1/2"	18068 & 18069
Camaro	83-92	283-400	65171	32, 51, 65, 66, 68, 69, 105, 151	N	Y	N	Y	N	N	1 3/4"x1 7/8", 3 1/2" Stepped	18166
Camaro	83-92	283-400	65172	32, 51, 65, 66, 68, 69, 80, 105, 151	N	Y	N	Y	N	N	1 7/8"x2", 3 1/2" Stepped	18068 & 18069
Camaro	83-92	283-400	65173	32, 51, 65, 66, 68, 69, 105, 151, (Spread Port)	N	Y	N	Y	N	N	1 7/8", 3 1/2"	18088
Camaro	83-92	283-400	65174	32, 51, 65, 66, 68, 69, 105, 151, (Spread Port)	N	Y	N	Y	N	N	2", 3 1/2"	18088
Camaro	83-92	283-400	65175	32, 51, 65, 66, 68, 69, 105, 151, (Spread Port)	N	Y	N	Y	N	N	1 7/8"x2", 3 1/2" Stepped	18088

UNLESS OTHERWISE NOTED, HUSLER HEDDERS ARE DESIGNED FOR STOCK MOTOR MOUNTS IN STOCK LOCATION (NO MID PLATES). MUST USE STOCK WIDTH OIL PAN (NO KICK OUTS). FOR ADDITIONAL OIL CAPACITY, USE A DEEP PAN.



APPLICATION	YEAR	ENGINE	RAW PART #	FOOTNOTES (SEE PAGE 11)	A/C	P/S	TRANSMISSION			TUBE & COLLECTOR SIZE	REPLACEMENT GASKET	
							AUTOMATIC COL.	STANDARD COL.	FLR.			
DODGE, CHRYSLER, PLYMOUTH												
A-Body	67-76	340 W-2	75130	54, 56, 59, 68, 69, 80, 90, 156	N	N	56	Y	56	Y	2", 3 1/2"	18087
A-Body	67-76	340 W-2	75131	54, 56, 59, 68, 69, 80, 90, 156	N	N	56	Y	56	Y	1 7/8"x2", 3 1/2" Stepped	18086 & 18087
A-Body	67-76	340-360	75133	54, 56, 59, 68, 69, 156	N	N	56	Y	56	Y	1 3/4"x1 7/8", 3 1/2" Stepped	18081
A-Body	67-76	340-360	75134	54, 56, 59, 68, 69, 156	N	N	56	T	56	Y	1 3/4", 3"	18081
A-Body	67-76	340 W-2	75135	54, 56, 59, 68, 69, 80, 90, 156	N	N	56	Y	56	Y	1 7/8", 3 1/2"	18087
A-Body	67-76	340-360	75140	54, 56, 59, 68, 69, 156	N	N	56	Y	56	Y	1 7/8", 3 1/2"	18081
A-Body	67-76	340-360	75141	54, 56, 59, 68, 69, 156	N	N	56	Y	56	Y	1 7/8"x2", 3 1/2" Stepped	18081
A-Body	67-76	383-440	75160	52, 68, 69, 106, 156 232	N	N	Y	Y	Y	Y	2", 3 1/2"	18079
A-Body	67-76	383-440	75161	52, 68, 69, 106 (Indy), 232	N	N	Y	Y	Y	Y	2", 3 1/2"	N/A
B-Body only	62-65	383-440	75320	51, 54, 68, 69, 106, 156	N	N	Y	Y	Y	Y	2", 3 1/2"	18079
B-Body only	62-65	440 Only	75325	51, 54, 68, 69, 106, 156, Indy heads (Stock 440 Bolt Pattern)	N	N	Y	Y	Y	Y	2", 3 1/2"	18079
B & E Body	66-76	383-440	75340	51, 56, 68, 69, 156	N	N	56	Y	56	Y	2", 3 1/2"	18079
B & E Body	66-76	440 Only	75345	51, 56, 68, 69, 156, Indy heads (Stock 440 Bolt Pattern)	N	N	56	Y	56	Y	2", 3 1/2"	18079
B & E Body	66-73	426 Hemi	75350	51, 56, 67, 156	N	N	56	Y	56	Y	2", 3 1/2"	18080
B & E Body	66-73	426 Hemi	75360	35, 51, 56, 66, 68, 69, 156	N	N	56	Y	56	Y	2 1/8", 3 1/2"	18080

UNLESS OTHERWISE NOTED, HUSLER HEDDERS ARE DESIGNED FOR STOCK MOTOR MOUNTS IN STOCK LOCATION (NO MID PLATES).
MUST USE STOCK WIDTH OIL PAN (NO KICK OUTS). FOR MORE OIL CAPACITY, USE A DEEP PAN.

MOPAR TERMINOLOGY

Dodge/Plymouth Body Type Terminology:

- A BODY = 64-76 Valiant, 64-69 Barracuda, 64-76 Dart, All Duster, Demon, Sport, Scamp, & Swinger.
- B BODY = Coronet, Satellite, Road Runner, Charger, GTX, R/T, Belvedere, Super Bee, Cordoba, 76-78 Fury, 77-78 Monaco, and 78-79 Magnum.
- E BODY = 70-74 Barracuda, All Challengers, 83-84 Dodge 600. (R.W.D.-U.S. Made).
- F BODY = 76-80 Volare and Aspen, Road Runner and R/T.
- K BODY = 81-90 Aries and Reliant, Dodge 400, LeBaron (F.W.D.).
- L BODY = 74-84 Omni, Horizon, TC-3, 024, Charger, Turismo, Scamp (F.W.D.).

Dodge/Plymouth Engine Type: Four Cylinder = 1700 & 2200 (Chrysler) 1400, 1600, 2000, 2600 (Mitsubishi) Six Cylinder = 170, 198, 225 A Engine = 273, 318 (67 & Later), 340, 360 B Engine = 361, 383, 400 RB Engine = 413, 426 Wedge, 440 HEMI = 426
© Chrysler Corp.



STREET & STRIP RACE HEDDERS

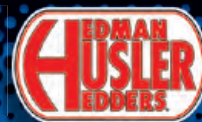

APPLICATION	YEAR	ENGINE	RAW PART #	FOOTNOTES (SEE BELOW)	A/C	P/S	TRANSMISSION				TUBE & COLLECTOR SIZE	REPLACEMENT GASKET
							AUTOMATIC COL.	FLR.	STANDARD COL.	FLR.		
FORD & MERCURY												
Mustang	65-70	289,302,351W,GT40	85002	51, 68, 69, 76, 106, 233 Stepped	N	N	N	Y	N	N	1 1/8"x1 3/4", 3" Stepped	18050
Mustang	65-70	289,302,351W,GT40	85003	51, 68, 69, 76, 106, 233	N	N	N	Y	N	N	1 3/4", 3"	18050
Mustang	65-70	289,302,351W,GT40	85004	51, 68, 69, 76, 106, 233 Stepped	N	N	N	Y	N	N	1 3/4", 1 7/8", 3" Stepped	18050
Mustang/Cougar	67-70	390-428	85120	51, 56, 74, 76, 114	Y	Y	56	Y	56	Y	1 3/4", 3"	18052
Mustang/Cougar	67-70	390-428	85140	51, 68, 69, 73	N	N	Y	Y	Y	Y	2", 3 1/2"	18052
Mustang/Cougar	67-70	390-428	85141	51, 68, 69, 73, (Hi-Riser)	N	N	Y	Y	Y	Y	2", 3 1/2"	18052
Mustang/Cougar	67-70	390-428	85150	51, 68, 69, 73	N	N	Y	Y	Y	Y	2 1/8", 3 1/2"	18052
Mustang/Cougar	67-70	390-428	85151	51, 68, 69, 73, (Hi-Riser)	N	N	Y	Y	Y	Y	2 1/8", 3 1/2"	18052
Mustang/Cougar	1970	351C	85180	51, 66, 68, 69, 73, 75, 76, 106	N	N	Y	Y	Y	Y	2 1/8", 3 1/2"	18051
Mustang/Cougar	71-72	429-460	85200	51, 56, 76	Y	Y	56	Y	56	N	1 3/4", 3"	18053
Mustang/Cougar	71-72	429-460	85210	54, 56, 68, 69, 73, (Cobra Jet)	N	N	56	Y	56	N	2", 3 1/2"	18053
Mustang/Cougar	71-72	351C	85230	51, 68, 69, 73, 75	N	N	Y	Y	Y	Y	2 1/8", 3 1/2"	18151
Torino/Cyclone	66-69	352-428	85120	51, 56, 74, 76, 114, 151	Y	Y	56	Y	56	Y	1 3/4", 3"	18052
Torino/Cyclone	70-76	429-460	85200	51, 56, 76	Y	Y	56	Y	N	N	1 3/4", 3"	18053
Pass Cars	65-76	390-428	85250	51, 76, 114 (No convertibles)	Y	Y	Y	Y	Y	Y	1 3/4", 3"	18052
FORD ENGINE SWAP												
Passenger Car	55-59	Ford FE **	85245	51, 56, 76, 114	N	N	N	Y	N	Y	1 3/4", 3"	18052
Mustang/Capri	79-93	302W GT40	85621	51, 68, 69, 76	Y	Y	Y	Y	Y	Y	1 5/8", 3"	18050
Mustang/Capri	79-93	351W GT40	85622	51, 68, 69, 77	Y	Y	Y	Y	Y	Y	1 5/8", 3"	18050
Mustang/Capri	79-93	302 (4V) Boss	85605	51, 66, 68, 69, 75, 76	Y	Y	N	Y	N	Y	1 7/8", 3"	18051
Mustang/Capri	79-93	302 GT40	85616	51, 68, 69, 76	N	Y	N	Y	N	Y	1 3/4", 3"	18050
Mustang/Capri	79-93	302 GT40	85617	51, 68, 69, 76, Stepped	N	Y	N	Y	N	Y	1 5/8"x1 3/4", 3" Stepped	18050
Mustang/Capri	79-93	351W GT40	85618	51, 68, 69, 76, Stepped	N	Y	N	Y	N	Y	1 5/8"x1 3/4", 3" Stepped	18050
Mustang/Capri	79-93	351C (2V)	85619	51, 66, 68, 69, 76	Y	Y	N	Y	N	Y	1 7/8", 3"	18058
Mustang/Capri	79-93	351C (4V)	85620	51, 66, 68, 69, 75, 76	Y	Y	N	Y	N	Y	1 7/8", 3"	18051
Mustang/Capri	79-93	351W GT40	85625	51, 68, 69, 77	Y	Y	Y	Y	Y	Y	1 3/4", 3"	18157
FORD (World Products Windsor Jr.)												
Mustang	65-70	289, 302, 351W	85006	51, 68, 69, 76, 106, 233 Stepped	N	N	N	Y	N	N	1 5/8"x1 3/4", 3" Stepped	18150
Mustang	65-70	289, 302, 351W	85007	51, 68, 69, 76, 106, 233	N	N	N	Y	N	N	1 3/4", 3"	18150
Mustang	65-70	289, 302, 351W	85008	51, 68, 69, 76, 106, 233 Stepped	N	N	N	Y	N	N	1 3/4"x1 7/8", 3" Stepped	18150
Mustang/Capri	79-Up	351W	85722	51, 58, 68, 69, 77	Y	Y	Y	Y	Y	Y	1 5/8", 3"	18150
Mustang/Capri	79-Up	302W	85721	51, 58, 68, 69, 77	Y	Y	Y	Y	Y	Y	1 5/8", 3"	18150
Mustang/Capri	79-Up	302W	85723	51, 58, 68, 69, 77	Y	Y	Y	Y	Y	Y	1 3/4", 3"	18150
Mustang/Capri	79-Up	351W	85724	51, 58, 68, 69, 77	Y	Y	Y	Y	Y	Y	1 3/4", 3"	18150
Mustang/Capri	79-Up	302W	85725	51, 58, 68, 69, 77, Stepped	Y	Y	Y	Y	Y	Y	1 5/8"x1 3/4", 3" Stepped	18050
Mustang/Capri	79-Up	351W	85726	51, 58, 68, 69, 77, Stepped	Y	Y	Y	Y	Y	Y	1 5/8"x1 3/4", 3" Stepped	18050
FORD SPECIALTY HEDDERS (Street Rod Flathead V8)												
Car	38-48	Flathead V8	85660	None	N	N	N	N	Y	Y	1 3/4", 1 3/4"	18158
Car	49-51	Flathead V8	85661	None	N	N	N	N	Y	Y	1 3/4", 1 3/4"	18158

UNLESS OTHERWISE NOTED, HUSLER HEDDERS ARE DESIGNED FOR STOCK MOTOR MOUNTS IN STOCK LOCATION (NO MID PLATES). MUST USE STOCK WIDTH OIL PAN (NO KICK OUTS). FOR MORE OIL CAPACITY, USE A DEEP PAN.

FOOTNOTES:

- 1 Without smog injection or injection heads.
- 8 Spark plug clearance limited.
- 35 One tube over frame.
- 51 Under chassis exit.
- 52 All tubes fenderwell exit.
- 54 One tube one side over frame.
- 56 Column shift must be modified on some models or converted to floor shift.
- 58 World Products Windsor Jr. flanges.
- 59 Must use 60° oil filter from Mopar Perf.
- 66 Race Car Hedder - with flat style collector.
- 67 Race Car Hedder - not adjustable.
- 68 Race Car Hedder - with slip-on collector.

- 69 Flange may need to be cut between ports to install hedd-ers. Do not cut between twin ports.
- 72 Designed without use of 60o oil filter adapter. Filter must screw directly to block.
- 73 It will be necessary on most models to use a Trans-Dapt Performance remote oil filter.
- 74 Clutch linkage must be modified on some.
- 75 4 barrel heads only.
- 76 Hedd-ers come with street hook-ups.
- 77 Hedd-ers come w/ street hook-ups for O2 sensors.
- 80 Hedd-ers comes with sub-flange.
- 90 Comes with standard/wide sub-flanges (4 3/4" center bolt spacing) Special order if econo/ narrow (4" center bolt spacing) are needed.
- 96 Hedder only - must use motor mount plate #56066.

- 100 Won't fit steering damper inside front crossmember.
- 106 Will not fit power brakes.
- 114 Hedd-ers come with weld-on collectors.
- 151 Must use mini starter with motor windings recessed over toward block.
- 152 Made in and shipped from California.
- 156 Will not with 11", 143 tooth flywheel.
- 201 Must use Powermaster #9506 mini starter.
- 232 No drop spindles.
- 233 Modify pass. side shock tower on 351 apps.



APPLICATION	YEAR	ENGINE	RAW PART #	FOOTNOTES (SEE BELOW)	A/C	P/S	TRANSMISSION				TUBE & COLLECTOR SIZE	REPLACEMENT GASKET
							AUTOMATIC COL.	STANDARD COL.	STANDARD FLR.	FLR.		
PONTIAC												
Firebird	67-69	400-455	35131	51, 76, 114, (Edelbrock Heads)	Y	Y	N	Y	N	Y	1 3/4", 3"	18074
Firebird	67-69	400-455	35132	51, 76, 114, (Standard Port)	Y	Y	N	Y	N	Y	1 3/4", 3"	18073
Firebird	67-69	400-455	35170	54, 68, 69, (Edelbrock Heads)	N	N	Y	Y	Y	Y	1 7/8", 3 1/2"	18074
Firebird	67-69	400-455	35171	54, 68, 69, (Edelbrock Heads)	N	N	N	Y	N	Y	1 3/4"x1 7/8", 3 1/2" Stepped	18074
Firebird	67-69	400-455	35135	51, 76, 114, (Edelbrock Heads)	Y	Y	N	Y	N	Y	1 3/4"x1 7/8", 3 1/2" Stepped	18074
Firebird	67-69	326-455	35175	54, 68, 69, 80, (Standard Port)	N	N	Y	Y	Y	Y	1 7/8", 3 1/2"	18076-77
Firebird	67-69	400-455	35176	54, 68, 69, (Standard Port)	N	N	N	Y	N	Y	1 3/4"x1 7/8", 3 1/2" Stepped	18073
Firebird	67-69	400-455	35180	54, 68, 69, (Edelbrock Heads)	N	N	N	Y	N	Y	2", 3 1/2"	18074
Firebird	67-69	400-455	35181	54, 68, 69, (Edelbrock Heads)	N	N	N	Y	N	Y	1 7/8"x2", 3 1/2" Stepped	18074
Firebird	67-69	400-455	35190	54, 68, 69, 80, (Standard Port)	N	N	N	Y	N	Y	2", 3 1/2"	18076-77
Firebird	67-69	400-455	35191	54, 68, 69, 80, (Standard Port)	N	N	N	Y	N	Y	1 7/8"x2", 3 1/2" Stepped	18076-77
Firebird	70-81	400-455	35010	51, 76, 114, (Standard Port)	N	Y	Y	Y	N	N	1 3/4", 3"	18073
Firebird	70-81	400-455	35130	51, 76, 114, (Edelbrock Heads)	Y	Y	Y	Y	N	N	1 3/4", 3"	18074
Firebird	70-81	400-455	35133	51, 76, 114, (Edelbrock Heads) (4 Speed)	Y	Y	N	Y	N	Y	1 3/4", 3"	18074
Firebird	70-81	400-455	35140	51, 68, 69, (Edelbrock Heads)	N	N	Y	Y	N	N	1 7/8", 3 1/2"	18074
Firebird	70-81	400-455	35141	51, 68, 69, (Edelbrock Heads)	N	N	N	Y	N	N	1 3/4"x1 7/8", 3" Stepped	18074
Firebird	70-81	400-455	35136	51, 76, 114, (Edelbrock Heads)	Y	Y	N	Y	N	Y	1 3/4"x1 7/8", 3" Stepped	18074
Firebird	70-81	400-455	35145	51, 68, 69, 80, (Standard Port)	N	N	Y	Y	N	N	1 7/8", 3 1/2"	18076-77
Firebird	70-81	400-455	35146	51, 68, 69, (Standard Port)	N	N	N	Y	N	N	1 3/4"x1 7/8", 3" Stepped	18073
Firebird	70-81	400-455	35150	51, 68, 69, (Edelbrock Heads)	N	N	Y	Y	N	N	2", 3 1/2"	18074
Firebird	70-81	400-455	35151	51, 68, 69, (Edelbrock Heads)	N	N	N	Y	N	N	1 7/8"x2", 3 1/2" Stepped	18074
Firebird	70-81	400-455	35160	51, 68, 69, 80, (Standard Port)	N	N	Y	Y	N	N	2", 3 1/2"	18076-77
Firebird	70-81	400-455	35161	51, 68, 69, 80, (Standard Port)	N	N	N	Y	N	N	1 7/8"x2", 3 1/2" Stepped	18076-77
GTO/Tempest	64-71	350-455	35010	51, 76, 114, (Standard Port)	N	Y	Y	Y	N	N	1 3/4", 3"	18073
GTO/Tempest	64-71	400-455	35130	51, 76, 114, (Edelbrock Heads)	Y	Y	Y	Y	N	Y	1 3/4", 3"	18074
GTO/Tempest	64-71	400-455	35137	51, 76, 114, (Edelbrock Heads)	Y	Y	129	Y	N	N	1 3/4"x1 7/8", 3" Stepped	18074
GTO/Tempest	66-67	400-455	35030	54, 66, 68, 69, (Edelbrock Heads)	N	N	Y	Y	N	N	2", 3 1/2"	18074
GTO/Tempest	66-67	400-455	35031	54, 66, 68, 69, (Edelbrock Heads)	N	N	N	Y	N	N	1 7/8"x2", 3 1/2" Stepped	18074
GTO/Tempest	66-67	400-455	35040	54, 66, 68, 69, 80, (Standard Port)	N	N	Y	Y	N	N	2", 3 1/2"	18076-77
GTO/Tempest	66-67	400-455	35041	54, 66, 68, 69, 80, (Standard Port)	N	N	N	Y	N	N	1 7/8"x2", 3 1/2" Stepped	18076-77

UNLESS OTHERWISE NOTED, HUSLER HEDDERS ARE DESIGNED FOR STOCK MOTOR MOUNTS IN STOCK LOCATION (NO MID PLATES). MUST USE STOCK WIDTH OIL PAN (NO KICK OUTS). FOR MORE OIL CAPACITY, USE A DEEP PAN.

FOOTNOTES:

- | | | |
|--------------------------------------------------------------------------------------------------------------------------------------------------------------------------------------------------------------------------------------------------------------------------------------------------------------------------------------------------------------------------------------------------------------------------------------------------------------------------------------------------------------------------------------------------------------------------------------------------------------------------------------------------------------------------------------------------------------|------------------------------------------------------------------------------------------------------------------------------------------------------------------------------------------------------------------------------------------------------------------------------------------------------------------------------------------------------------------------------------------------------------------------------------------------------------------------------------------------------------------------------------------------------------------------------------------------------------------------------------------------------------------------------------------------------------------------------------------------------------------|-------------------------------------------------------------------------------------------------------------------------------------------------------------------------------------------------------------------------------------------------------------------------------------------------------------------------------------------------------------------------------------------------------------------------------------------------------------------------------------------------------------------------------------------------------------------------------------------------------------------------------------------------------------------------------------------------------------------------------------------------------|
| <p>10 Except round port.</p> <p>22 Fits standard 429-460 heads only.</p> <p>23 Some heads require drilling and tapping of end holes.</p> <p>45 Not legal for sale or use in California on pollution controlled motor vehicles.</p> <p>47 Some vehicles may encounter clutch shaft interference when cross shaft location is located under or behind driver's side rear exhaust port. Use Hedman #69092 (no A.I.R.), #69093 (w/A.I.R.), or Hedman Elite #69892.</p> <p>51 Under chassis exit.</p> <p>52 All tubes fenderwell exit.</p> <p>53 One tube both sides over frame.</p> <p>54 One tube one side over frame.</p> <p>56 Column shift must be modified on some models, or converted to floor shift.</p> | <p>58 World Products Windsor Jr. flanges.</p> <p>66 Race Car Hedder - with flat style collector.</p> <p>68 Race Car Hedder - with slip-on collector.</p> <p>69 Flange may need to be cut between ports to install hedders. Do not cut between twin ports.</p> <p>73 It will be necessary on most models to use a Trans-Dapt Performance remote oil filter.</p> <p>75 4 barrel heads only.</p> <p>76 Hedders come with street hook-ups.</p> <p>77 Hedders come with street hook-ups for oxygen sensors.</p> <p>80 Hedders come with sub-flange.</p> <p>90 Comes with standard/wide sub-flanges (4 3/4" center bolt spacing) Special order if econo/narrow (4" center bolt spacing) are needed.</p> <p>91 Collector Type Hedder.</p> <p>92 Zoomie Type Hedder.</p> | <p>96 Hedder only - must use mount plate #56066.</p> <p>97 Must use Trans-Dapt #9906 conversion motor mounts.</p> <p>105 Fits new angle plug heads, w/ raised exhaust ports.</p> <p>114 Hedders come with weld-on collectors.</p> <p>129 Modification to shifter linkage may be required.</p> <p>151 Must use mini starter with motor windings recessed over toward block.</p> <p>152 Made in and shipped from California.</p> <p>153 Must use Classic Chevrolet steering box.</p> <p>155 Must use small, 153 tooth flywheel.</p> <p>157 Designed for 4x4 trucks with engines moved forward and hydraulic steering.</p> <p>166 Not for Dual Shocks applications.</p> <p>201 Must use Powermaster #9506 mini starter.</p> <p>232 No drop spindles.</p> |
|--------------------------------------------------------------------------------------------------------------------------------------------------------------------------------------------------------------------------------------------------------------------------------------------------------------------------------------------------------------------------------------------------------------------------------------------------------------------------------------------------------------------------------------------------------------------------------------------------------------------------------------------------------------------------------------------------------------|------------------------------------------------------------------------------------------------------------------------------------------------------------------------------------------------------------------------------------------------------------------------------------------------------------------------------------------------------------------------------------------------------------------------------------------------------------------------------------------------------------------------------------------------------------------------------------------------------------------------------------------------------------------------------------------------------------------------------------------------------------------|-------------------------------------------------------------------------------------------------------------------------------------------------------------------------------------------------------------------------------------------------------------------------------------------------------------------------------------------------------------------------------------------------------------------------------------------------------------------------------------------------------------------------------------------------------------------------------------------------------------------------------------------------------------------------------------------------------------------------------------------------------|



**ALTERED, T-BUCKET & BANTAM
CHASSIS HEDDERS:**

- Tube Diameters up to 2³/₈"
- Standard & Stepped Tube Models Available
- 3/8" Surface Ground, Laser Cut Flanges for an optimum seal
- Slip-On Collector for Maximum Adjustability
- 32" Primaries
- 18g Primary Tubes
- Welded Inside & Out



#65305



ALTEREDS, T-BUCKETS, BANTAMS

TUBE DIAMETER >>	1 ¹ / ₈ "	1 ⁷ / ₈ " x 2" Stepped	2"	2" x 2 ¹ / ₈ " Stepped	2 ¹ / ₈ "	2 ¹ / ₈ " x 2 ¹ / ₈ " Stepped	2 ¹ / ₄ "	2 ¹ / ₄ " x 2 ³ / ₈ " Stepped	2 ³ / ₈ "	
COLLECTOR SIZE >>	3 ¹ / ₂ "	3 ¹ / ₂ "	3 ¹ / ₂ "	4"	4"	4"	4"	4 ¹ / ₂ "	4 ¹ / ₂ "	
ENGINE	SB CHEVY W/SUB-FLANGES	65301	65331	65302	-	-	-	-	-	
	SB CHEVY (Spread Port)	65332	65334	65333	-	-	-	-	-	
	SB CHEVY (GM 18")	65335	65337	65336	-	-	-	-	-	
	BB CHEVY	-	-	65303	-	65304	65338	65305	-	65306
	MOPAR 440	-	-	75335	-	-	-	-	-	-
	MOPAR 440 (INDY Heads)	-	-	75336	-	-	-	-	-	-

**STREET ROADSTER
HEDDERS:**

- Tube Diameters up to 2³/₈"
- Standard & Stepped Tube Models Available
- 3/8" Surface Ground, Laser Cut Flanges for an optimum seal
- Slip-On Collector for Maximum Adjustability
- 32" Primaries
- 18g Primary Tubes
- Welded Inside & Out



#65312



STREET ROADSTERS (Street Roadster Heddlers are Routed Over the Top of The Fenders.)

TUBE DIAMETER >>	1 ¹ / ₈ "	1 ⁷ / ₈ " x 2" Stepped	2"	2" x 2 ¹ / ₈ " Stepped	2 ¹ / ₈ "	2 ¹ / ₈ " x 2 ¹ / ₈ " Stepped	2 ¹ / ₄ "	2 ¹ / ₄ " x 2 ³ / ₈ " Stepped	2 ³ / ₈ "	
COLLECTOR SIZE >>	3 ¹ / ₂ "	3 ¹ / ₂ "	3 ¹ / ₂ "	4"	4"	4"	4"	4 ¹ / ₂ "	4 ¹ / ₂ "	
ENGINE	SB CHEVY W/SUB-FLANGES	65311	65339	65312	-	-	-	-	-	
	SB CHEVY (Spread Port)	65341	65343	65342	-	-	-	-	-	
	SB CHEVY (GM 18")	65344	65346	65345	-	-	-	-	-	
	BB CHEVY	-	-	65313	65347	65314	65348	65315	65349	65316
	MOPAR 440	-	-	75341	-	-	-	-	-	-
	MOPAR 440 (INDY Heads)	-	-	75342	-	-	-	-	-	-

DOWNSWEPT ECONORAIL DRAGSTER HEDDERS:

VARIETY THAT MEETS YOUR PERFORMANCE NEEDS

- Conventional & Merge Collector configurations
- 1 7/8" TO 2 1/2" Diameters
- Standard & Stepped Tubes
- Three Finishes

PERFORMANCE MAXIMIZING DESIGN FEATURES

- True Firing Order Design
- Ultra-Smooth Flowing Mandrel Bent Primary Tubes.
- Slip-on Race Collectors
- 3/8" Flanges

MERGE COLLECTOR MODELS

- Merge Collector adds 10-15 Horsepower.
- True Firing Order Design.
- Standard & Stepped Tube Models Available.
- Four Finishes to Choose From.



"Island" Style Head Flanges Reduce Hedder Weight.



No Swedges Or Collars For A Smooth, Clean Look.



MERGE COLLECTOR Provides 10-15 Additional HP!



CONVENTIONAL DESIGN DOWNSWEPT MODELS

		TUBE DIAMETER >>									
		1 7/8"	1 7/8" x 2" Stepped	2"	2" x 2 1/8" Stepped	2 1/8"	2 1/8" x 2 1/4" Stepped	2 1/4"	2 1/4" x 2 3/8" Stepped	2 3/8"	
		COLLECTOR SIZE >>									
		3 1/2"	3 1/2"	3 1/2"	4"	4"	4"	4"	4 1/2"	4 1/2"	
ENGINE & FINISH	SB CHEVY W/SUB-FLANGES	RAW	65221	65261	65222	65262	65223	-	-	-	-
		HTC	66221	66261	66222	66262	66223	-	-	-	-
		BLACK MAXX	63221	63621	63222	63262	63223	-	-	-	-
	SB CHEVY (Spread Port)	RAW	65231	65233	65232	65235	65234	-	-	-	-
		HTC	61236	66233	66232	66235	66234	-	-	-	-
		BLACK MAXX	63231	63233	63232	63235	63234	-	-	-	-
	SB CHEVY (GM 18")	RAW	-	-	65236	65237	-	-	-	-	-
		HTC	-	-	66236	67236	-	-	-	-	-
		BLACK MAXX	-	-	63236	63237	-	-	-	-	-
	BB CHEVY	RAW	-	-	-	-	65224	65238	65225	65239	65226
		HTC	-	-	-	-	66224	66238	66225	66239	66226
		BLACK MAXX	-	-	-	-	63224	63238	63225	63239	63226
MOPAR 440	RAW	-	-	75232	75235	-	-	-	-	-	
	HTC	-	-	76232	76235	-	-	-	-	-	
	BLACK MAXX	-	-	73232	73235	-	-	-	-	-	
MOPAR 440 (INDY Heads)	RAW	-	-	75233	75236	-	-	-	-	-	
	HTC	-	-	76233	76236	-	-	-	-	-	
	BLACK MAXX	-	-	73233	73236	-	-	-	-	-	
MOPAR 440 (Standard & Indy Heads)	RAW	-	-	-	-	75234	-	-	-	-	
	HTC	-	-	-	-	76234	-	-	-	-	
	BLACK MAXX	-	-	-	-	73234	-	-	-	-	

MERGE COLLECTOR DOWNSWEPT MODELS

		TUBE DIAMETER >>			
		2 1/4"	2 1/4" x 2 3/8" Stepped	2 3/8"	2 3/8" x 2 1/2" Stepped
		COLLECTOR SIZE >>			
		4"	4"	4 1/2"	4 1/2"
BB CHEVY	CHROME	65970	65971	65972	65973
	RAW	65270	65271	65272	65273
	HTC	65276	66271	66272	66273
	BLACK MAXX	56273	63271	63272	63273

UPSWEPT ECONORAIL DRAGSTER HEDDERS:

- 1 7/8" to 2 3/8" Diameters
- Standard & Stepped Tubes
- Three Finishes
- Ultra-Smooth Flowing Mandrel Bent Primary Tubes.
- Slip-on Race Collectors



UPSWEPT DESIGN ECONO-RAIL DRAGSTER HEDDERS

		TUBE DIAMETER >>									
		1 7/8"	1 7/8" x 2" Stepped	2"	2" x 2 1/8" Stepped	2 1/8"	2 1/8" x 2 1/4" Stepped	2 1/4"	2 1/4" x 2 3/8" Stepped	2 3/8"	
		COLLECTOR SIZE >>									
		3 1/2"	3 1/2"	3 1/2"	4"	4"	4"	4"	4 1/2"	4 1/2"	
ENGINE & FINISH	SB CHEVY W/SUB-FLANGES	RAW	65201	65254	65202	65256	65203	-	-	-	-
		HTC	66201	66254	66202	66256	66203	-	-	-	-
		BLACK MAXX	63201	63254	63202	63256	63203	-	-	-	-
	SB CHEVY (Spread Port)	RAW	65241	65243	65242	65246	65245	-	-	-	-
		HTC	66241	66243	66242	66426	66245	-	-	-	-
		BLACK MAXX	63241	63243	63242	63246	63245	-	-	-	-
	SB CHEVY (GM 18")	RAW	65247	-	65248	65249	-	-	-	-	-
		HTC	66247	-	66248	66249	-	-	-	-	-
		BLACK MAXX	63247	-	63248	63249	-	-	-	-	-
	BB CHEVY	RAW	-	-	-	-	65204	65251	65205	65252	65206
		HTC	-	-	-	-	66204	66251	66205	66252	66206
		BLACK MAXX	-	-	-	-	63204	63251	63205	63252	63206
MOPAR 440	RAW	-	-	75202	-	75203	-	75205	-	-	
	HTC	-	-	76202	-	76203	-	76205	-	-	
	BLACK MAXX	-	-	73202	-	73203	-	73205	-	-	
FORD 429-460 (CobraJet)	RAW	-	-	-	-	-	-	85251	85253	85252	
	HTC	-	-	-	-	-	-	86251	86253	86252	
	BLACK MAXX	-	-	-	-	-	-	83251	83253	83252	
FORD 429-460 (SVO)	RAW	-	-	-	-	-	-	85254	85255	-	
	HTC	-	-	-	-	-	-	86254	86255	-	
	BLACK MAXX	-	-	-	-	-	-	83254	83255	-	

HEDDERS ON THIS PAGE ARE NOT LEGAL FOR SALE OR USE ON POLLUTION CONTROLLED MOTOR VEHICLES.

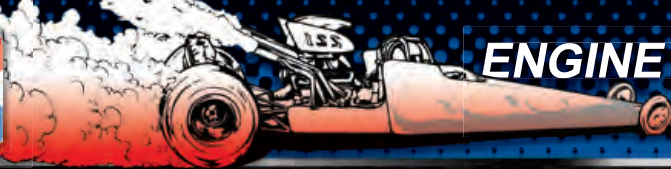

**ENGINE DYNO
HEDDER WELD-UP KITS:**



#65671

Please see page 26 for a general dimensions guide for Dyno Hedder weld-up kits.

ENGINE DYNO HEDDER WELD-UP KITS

ENGINE	TUBE SIZE	COLLECTOR SIZE	COLLECTOR TYPE	PART #
CHEVROLET				
Small Block Chevy	1½"	3"	Slip On	65596
Small Block Chevy	1½"	3"	Weld On	65595
Small Block Chevy	1¾"	3"	Slip On	65601
Small Block Chevy	1¾"	3"	Weld On	65600
Small Block Chevy with sub-flanges	1⅞"	3½"	Slip On	65631
Small Block Chevy with sub-flanges	1⅞"	3½"	Weld On	65630
Small Block Chevy with sub-flanges	2"	3½"	Slip On	65643
Small Block Chevy with sub-flanges	2"	3½"	Weld On	65642
Small Block Chevy with sub-flanges	2⅛"	3½"	Slip On	65673
Small Block Chevy with sub-flanges	2⅛"	3½"	Weld On	65672
Small Block Chevy with sub-flanges	2¼"	4"	Slip On	65678
Small Block Chevy with sub-flanges	2¼"	4"	Weld On	65677
Small Block Chevy Brodix Spreadport	1⅞"	3½"	Slip On	65621
Small Block Chevy Brodix Spreadport	1⅞"	3½"	Weld On	65620
Small Block Chevy Brodix Spreadport	2"	3½"	Slip On	65645
Small Block Chevy Brodix Spreadport	2"	3½"	Weld On	65644
Big Block Chevy	1¾"	3"	Slip On	65603
Big Block Chevy	1¾"	3"	Weld On	65602
Big Block Chevy	1⅞"	3½"	Slip On	65633
Big Block Chevy	1⅞"	3½"	Weld On	65632
Big Block Chevy	2"	3½"	Slip On	65641
Big Block Chevy	2"	3½"	Weld On	65640
Big Block Chevy	2⅛"	4"	Slip On	65671
Big Block Chevy	2⅛"	4"	Weld On	65670
Big Block Chevy	2¼"	4"	Slip On	65676
Big Block Chevy	2¼"	4"	Weld On	65675
Big Block Chevy	2⅝"	4½"	Slip On	65681
Big Block Chevy	2⅝"	4½"	Weld On	65680
Big Block Chevy	2½"	5"	Slip On	65686
Big Block Chevy	2½"	5"	Weld On	65685

*The rear tubes on this hedder kit must be cut and rotated.

Hedman Husler's Dyno Hedder Weld-Up Kits have everything you need to build your own, one of a kind set of custom hedders for use on your in-house engine dyno set up. The kits contain the same high quality components Husler uses to build all its hedders in the factory.

Every kit include seamless, mandrel bent, 18 gauge tubing, 3/8" thick flanges, collectors, gaskets and bolts. As with all Hedman Hedders, these kits are made in the USA to ensure consistency set after set, season after season. Please refer to page 26 for general dimensions information for Husler Engine Dyno Hedder weld-up kits.

ENGINE DYNO HEDDER WELD-UP KITS (Continued)

ENGINE	TUBE SIZE	COLLECTOR SIZE	COLLECTOR TYPE	PART #
CHRYSLER				
Small Block Chrysler	15/8"	3"	Slip On	75596
Small Block Chrysler	15/8"	3"	Weld On	75595
Small Block Chrysler	1¾"	3"	Slip On	75601
Small Block Chrysler	1¾"	3"	Weld On	75600
Big Block Chrysler	1¾"	3"	Slip On	75611
Big Block Chrysler	1¾"	3"	Weld On	75610
Big Block Chrysler	1⅞"	3½"	Slip On	75621
Big Block Chrysler	1⅞"	3½"	Weld On	75620
Big Block Chrysler	2"	3½"	Slip On	75645
Big Block Chrysler	2"	3½"	Weld On	75644
Big Block Chrysler	2⅛"	4"	Slip On	75673
Big Block Chrysler	2⅛"	4"	Weld On	75672
Big Block Chrysler	2¼"	4"	Slip On	75678
Big Block Chrysler	2¼"	4"	Weld On	75677
W2 Chrysler w/sub-flange (Specify narrow or wide)	1⅞"	3½"	Slip On	75631
W2 Chrysler w/sub-flange (Specify narrow or wide)	1⅞"	3½"	Weld On	75630
W2 Chrysler w/sub-flange (Specify narrow or wide)	2"	3½"	Slip On	75643
W2 Chrysler w/sub-flange (Specify narrow or wide)	2"	3½"	Weld On	75642

CHRYSLER W2 WELD-UP KITS:

All W2 weld-up kits come with STANDARD/WIDE sub-flanges. ECONO/NARROW flanges will gladly be provided upon request.



Shown assembled and in use.

This set of SB CHEVY Dyno Hedders has endured OVER FOUR years of busy engine dyno abuse!

PRO-STOCK / PRO-MOD FUNNY CAR DESIGN:



- HEMI Engines
- Single & Double Wall Tubes Available
- Compatible With Andy M^coy Race Chassis

FUNNY CAR DESIGN

		TUBE DIAMETER >>	2 1/2"	2 3/4"
HEAD DESIGN & HEDDER FINISH	BRAD FAT HEAD	RAW	75410	75510
		HTC	75416	75516
		BLACK MAXX	75413	75513
BRAD V	RAW	75420	75520	
	HTC	75426	75526	
	BLACK MAXX	75423	75523	
BRAD 6	RAW	75430	75530	
	HTC	75436	75536	
	BLACK MAXX	75433	75533	
BRAD 8	RAW	75440	75540	
	HTC	75446	75546	
	BLACK MAXX	75443	75543	
AJ2 THROUGH AJ5	RAW	75450	75550	
	HTC	75456	75556	
	BLACK MAXX	75453	75553	
AJ6	RAW	75460	75560	
	HTC	75466	75566	
	BLACK MAXX	75463	75563	



PRO-STOCK / PRO-MOD SIDE EXIT EXHAUST:



- Pro-Stock / Pro-Mod
- BB Chevy With 5.2 Or 5.3 Bore
- Compatible With Andy M^coy Race Chassis

SIDE EXIT DESIGN

		TUBE DIAMETER >>	2-3/8"	2-3/8" x 2-1/2"	2-3/8" x 2-1/2"	2-1/2"
FINISH	COLLECTOR SIZE >>	4-1/2"	4-1/2"	5"	5"	
	RAW	75240	75250	75260	75270	
	HTC	75246	75256	75266	75276	
	BLACK MAXX	75243	75253	75263	75273	



NOSTALGIA DESIGN TOP FUEL DRAGSTER HEDDERS:

- Old School 6" Radius.
- Chevy & HEMI Models
- Available Unfinished, or with HTC or BLACK MAXX Finish



NOSTALGIA TOP FUEL HEDDERS

		TUBE DIAMETER >>	2"	2 1/4"
ENGINE	SB CHEVY	Raw	65740	65741
		HTC	66740	66741
		BLACK MAXX	63740	63741
BB CHEVY	Raw	65742	65743	
	HTC	66742	66743	
	BLACK MAXX	63742	63743	
HEMI 392	Raw	75744	75745	
	HTC	76744	76745	
	BLACK MAXX	73744	73745	

TOP FUEL DRAGSTER STYLE ZOOMIES:

- Single Wall Tubes
- Specify Your Tube Diameter



FUNNY CAR ZOOMIES:

- Specify Head Requirements
- Single & Double Wall Tubes Available
- Specify Tube Diameter



TOP FUEL / ECONORAIL ZOOMIES

ENGINE		
	MOST	65209
	SB CHEVY W/SUB-FLANGES	65700
	BB CHEVY	65211
	CHEVY BRODIX (Spread Port)	65705
	MOPAR (Specify Engine)	75211
	FORD (Specify Engine)	85211

FUNNY CAR ZOOMIES

NITRO	65207
ALCOHOL	65208

HEDDERS ON THIS PAGE ARE NOT LEGAL FOR SALE OR USE ON POLLUTION CONTROLLED MOTOR VEHICLES.



TRUCK & TRACTOR RACE HEDDERS



CHEVY C/K RACE HEDDERS:

- Fit Angle Plug Heads With Raised Exhaust Ports.
- Under Chassis Design.
- Up To 1 3/4" Tubes.
- Standard & Stepped Tube Designs Available.

CHEVY S10 RACE HEDDERS:

- Standard & Stepped Tube Designs Available.
- Fenderwell Style Up To 2" Tubes.
- Run Strong On Aluminum Heads.



APPLICATION	YEAR	ENGINE	MFG. PART #	FOOTNOTES (SEE PAGE 12)	A/C	P/S	TRANSMISSION				TUBE & COLLECTOR SIZE	REPLACEMENT GASKET	
							AUTOMATIC COL.	STANDARD COL.	FLR.	FLR.			
CHEVROLET TRUCKS													
CHEVY S10 2WD ONLY	82-Up	283-400	65851	45, 52, 68, 69, 97, 105, 232	N	Y	N	Y	N	Y	1 1/8", 3"	18066	
	82-Up	283-400	65852	45, 52, 68, 69, 97, 105, 232	N	Y	N	Y	N	Y	1 1/8"x1 3/4", 3" Stepped	18066	
	82-Up	283-400	65853	45, 52, 68, 69, 97, 105, 232	N	Y	N	Y	N	Y	1 3/4", 3"	18166	
	82-Up	283-400	65854	45, 52, 68, 69, 97, 105, 232	N	Y	N	Y	N	Y	1 3/4"x1 7/8", 3 1/2" Stepped	18166	
	FENDERWELL EXIT	82-Up	283-400	65855	45, 52, 68, 69, 80, 97, 105, 232	N	Y	N	Y	N	Y	1 7/8", 3 1/2"	18068 & 18069
		82-Up	283-400	65856	45, 52, 68, 69, 80, 97, 105, 232	N	Y	N	Y	N	Y	1 7/8"x2", 3 1/2" Stepped	18068 & 18069
		82-Up	283-400	65857	45, 52, 68, 69, 80, 97, 105, 232	N	Y	N	Y	N	Y	2", 3 1/2"	18068 & 18069
		82-Up	283-400	65858	45, 52, 68, 69, 97, 105, 232 (Spread Port)	N	Y	N	Y	N	Y	2", 3 1/2"	18088
CHEVY / GM C10 / K10 C1500 / K1500 2WD & 4WD IN-FRAME EXIT	82-Up	283-400	65859	45, 52, 68, 69, 97, 105, 232 (GM 18")	N	Y	N	Y	N	Y	2", 3 1/2"	N/A	
	67-87	283-400	65866	45, 47, 51, 68, 69, 76, 105 (2WD & 4x4)	Y	Y	Y	Y	Y	Y	1 5/8", 3"	18066	
	67-87	283-400	65867	45, 47, 51, 68, 69, 76, 105 (2WD & 4x4)	Y	Y	Y	Y	Y	Y	1 5/8"x1 3/4", 3" Stepped	18066	
	67-87	283-400	65868	45, 47, 51, 68, 69, 76, 105 (2WD & 4x4)	Y	Y	Y	Y	Y	Y	1 3/4", 3"	18166	
	88-99	283-400	65861	45, 47, 51, 68, 69, 76, 105 (4x4 Only)	Y	Y	Y	Y	Y	Y	1 5/8", 3"	18066	
	88-99	283-400	65862	45, 47, 51, 68, 69, 76, 105 (4x4 Only)	Y	Y	Y	Y	Y	Y	1 5/8"x1 3/4", 3" Stepped	18066	
	88-99	283-400	65863	45, 47, 51, 68, 69, 76, 105 (4x4 Only)	Y	Y	Y	Y	Y	Y	1 3/4", 3"	18166	
	FORD 4WD TRUCKS												
1/2 & 3/4 TON FENDERWELL EXIT	73-79	429-460	85650	22, 52, 76, 114	AUTOMATIC ONLY NO DUAL SHOCKS	N	Y	Y	Y	N	N	1 3/4", 3"	18053
	73-79	429-460	85652	22, 52, 76, 114		N	Y	Y	Y	N	N	1 3/4"x1 7/8", 3" Stepped	18053
	73-79	429-460	85653	22, 52, 76, 114, 166		N	Y	Y	Y	N	N	1 3/4"x1 7/8"x2", 3 1/2" Double Stepped	18053
	73-79	429-460	85651	52, 76, 114 (Cobra Jet)				Y	Y	N	N	2", 3 1/2"	18153

UPRIGHT PULLING HEDDERS:

- Collector & Zoomies Styles
- Adjustable & Non-Adjustable Models Available.
- Available In 1 3/4 To 2 1/8" Tube Diameter
- "You Build It" Kits Also Available
- 3/8" Flanges
- 18g Tubes

Up-Right Pulling Heddgers are Designed For 4x4's with Engines Moved Forward and Hydraulic Steering.



PART NUMBER	DESCRIPTION	TUBE SIZE	COLLECTOR SIZE	COLLECTOR TYPE
UPRIGHT PULLING HEDDER "WELD YOURSELF" KITS CHEVROLET				
65940	Small Block Chevy	1 3/4"	3"	Weld On
65941	Small Block Chevy	1 7/8"	3 1/2"	Weld On
65942	Small Block Chevy	2"	3 1/2"	Weld On
65943	Big Block Chevy	2 1/8"	4"	Weld On
65944	Big Block Chevy	2 1/4"	4"	Weld On

NON ADJUSTABLE MODEL	ADJUSTABLE MODEL	FOOTNOTES (SEE PAGE 12)	ENGINE	TUBE & COLLECTOR SIZE
UPRIGHT PULLING HEDDERS CHEVROLET				
65900	65800	91	302-350	1 3/4", 3"
65901	-	91, 105	302-350	1 3/4", 1 7/8", 3 1/2" Stepped
65905	-	92	302-350	1 3/4"
65920	65820	80, 91	302-350	1 7/8", 3 1/2"
65925	-	80, 92	302-350	1 7/8"
65945	-	80, 92	302-350	2"
65921	65821	91, 105 (Spread Port)	302-350	1 7/8", 3 1/2"
65922	65822	91, 105 (Spread Port)	302-350	1 7/8", 2", 3 1/2" Stepped
65826	-	92, 105 (Spread Port)	302-350	1 7/8"
65827	-	92, 105 (Spread Port)	302-350	2"
65923	65823	91, 105 (GM 18")	302-350	1 7/8", 3 1/2"
65924	65824	91, 105 (GM 18")	302-350	1 7/8", 2", 3 1/2" Stepped
65828	-	92, 105 (GM 18")	302-350	1 7/8"
65829	-	92, 105 (GM 18")	302-350	2"
65960	65860	91, 157	396-454	2 1/8", 4"
65961	65871	91, 157	396-454	2 1/4", 4"
65962	65872	91, 157	396-454	2 1/4", 2 3/8", 4 1/2" Stepped
65967	-	92, 157	396-454	2 1/4", 2 3/8" Stepped
65966	-	92, 157	396-454	2 1/4"
65965	-	92, 157	396-454	2 1/8"
CHRYSLER				
75900	75800	91	340	1 7/8", 3 1/2"
75905	-	92	340	1 7/8"
75920	75820	91	440	2 1/8", 4"
75940	75840	80, 90, 91	340 (W2)	2", 3 1/2"
75945	-	80, 90, 92	340 (W2)	2"
FORD				
85900	85800	91	351 C	2 1/8", 3 1/2"
85905	-	92	351 C	2 1/8"
85920	85820	91, 157 (Cobra Jet)	429-460	2 1/8", 4"
85921	85821	91, 157 (Cobra Jet)	429-460	2 1/4", 4"
85925	-	92, 157 (Cobra Jet)	429-460	2 1/8"
85826	-	92, 157 (Cobra Jet)	429-460	2 1/4"
85923	85823	91, 157 (SVO)	429-460	2 1/4", 4"
85924	85824	91, 157 (SVO)	429-460	2 1/4", 2 3/8", 4 1/2" Stepped
85828	-	92, 157 (SVO)	429-460	2 1/4"

HEDDERS ON THIS PAGE ARE NOT LEGAL FOR SALE OR USE ON POLLUTION CONTROLLED MOTOR VEHICLES.



The **RIGHT CHOICE** for **"LEFT TURN"** Racing Heddertoppers

Hedman Husler's rise to the top of the oval track heddertopper food chain has come quickly and swiftly. By allying ourselves with some of the oval track industry's most successful teams and engine builders, we have been able to apply their invaluable on track feedback to our new line of dirt and asphalt products. The result is a new, higher standard for quality and performance in oval track race heddertoppers.

We may be newer to the "Left turn" race scene, but when it comes designing quality heddertoppers that get more power to the wheels, no heddertopper company has been doing it longer, or better than Hedman Husler Heddertoppers.

"The Choice Of Champions In All Forms Of Motorsport."



NEW

ASPHALT SUPER LATE MODELS:

- Complete Conventional & Tri-Y Systems Available
- Slip-On Style Race Collector
- Heddertoppers, Malleable Graphite Gaskets & Hardware Included
- 3/8" Flanges
- 18g Tubes

Hedman Husler's LATE MODEL & SUPER LATE MODEL race heddertoppers have been designed using feedback from some of oval track's biggest, and most successful teams. The result was the best possible performance output from a set of race heddertoppers.

Super smooth mandrel bent primary tubes, clean, port matched flanges and non-restrictive collectors ensure that your Chevy or Ford engine can expel its waste gasses, and release additional torque to clear the competition. Husler's Asphalt Heddertoppers haven't only been proven to work, they've been proven to win. Just ask real Huslers like, Chase Elliott and Paul Kelley.

ASPHALT SUPER LATE MODELS

▲ This part number is for ALUMINUM HEADS ONLY!

TUBE CONFIGURATION>>>		CONVENTIONAL DESIGN Heddertoppers Only	CONVENTIONAL DESIGN Complete System	TRI-Y DESIGN Heddertoppers Only		TRI-Y DESIGN Complete System		
		1 1/4" X 1 7/8" STEPPED	1 1/4" X 1 7/8" STEPPED	1 1/4" X 1 7/8" STEPPED	1 7/8" X 2" STEPPED	1 1/4" X 1 7/8" STEPPED	1 7/8" X 2" STEPPED	
GARC CHASSIS								
ENGINE TYPE & HEDDERTOPPER FINISH	SB CHEVY (with OVAL PORTS)	RAW	64440	64450	64460	64570▲	64470	64560▲
		HTC	64446	64456	64466	64576▲	64476	64566▲
		BLACK MAXX	64443	64453	64463	64573▲	64473	64563▲
	SB CHEVY (18° Heads)	RAW	-	-	64490	64530	64480	64520
		HTC	-	-	64496	64536	64486	64526
		BLACK MAXX	-	-	64493	64533	64483	64523
	FORD RACING 374	RAW	-	-	-	84290	-	84280
		HTC	-	-	-	84296	-	84286
		BLACK MAXX	-	-	-	84293	-	84283
	FORD CRATE MOTOR (with N351 or Brodix Spec Heads)	RAW	84300	84310	84320	-	84330	-
		HTC	84306	84316	84326	-	84336	-
		BLACK MAXX	84303	84313	84323	-	84333	-
PORT CITY CHASSIS								
SB CHEVY (with OVAL PORTS)	RAW	64090	64100	64120	64590▲	64130	64580▲	
	HTC	64096	64106	64126	64596▲	64136	64586▲	
	BLACK MAXX	94093	64103	64123	64593▲	64133	64583▲	
SB CHEVY (18° Heads)	RAW	-	-	64510	64550	64500	64540	
	HTC	-	-	64516	64556	64506	64546	
	BLACK MAXX	-	-	64513	64553	64503	64543	
FORD RACING 374	RAW	84200	84210	84220	84510	84230	84500	
	HTC	84206	84216	84226	84516	84236	84506	
	BLACK MAXX	84203	84213	84223	84513	84233	84503	
FORD CRATE MOTOR (with N351 or Brodix Spec Heads)	RAW	84240	84250	84260	-	84270	-	
	HTC	84246	84256	84266	-	84276	-	
	BLACK MAXX	84243	84253	84263	-	84273	-	

HEDDERTOPPERS ON THIS PAGE ARE NOT LEGAL FOR SALE OR USE ON POLLUTION CONTROLLED MOTOR VEHICLES.

**MADE
in the
USA!**

ASPHALT LATE MODEL & SUPER LATE MODELS



NEW

ASPHALT LATE MODELS:

- Conventional And Tri-Y Systems Available
- Complete Systems And Hedders Only Available
- 3" Slip-On Style Race Collector
- Hedders, Malleable Graphite Gaskets & Hardware Included
- 3/8" Flanges
- 18g Tubes



ASPHALT LATE MODELS

TUBE CONFIGURATION >>	CONVENTIONAL DESIGN Hedders Only	CONVENTIONAL DESIGN Complete System	TRI-Y DESIGN Hedders Only		TRI-Y DESIGN Complete System	
TUBE DIAMETER >>	1 5/8" X 1 1/4" STEPPED	1 5/8" X 1 1/4" STEPPED	1 5/8" X 1 1/4" STEPPED	1 1/4" X 1 7/8" STEPPED	1 5/8" X 1 1/4" STEPPED	1 1/4" X 1 7/8" STEPPED

GARC CHASSIS

ENGINE TYPE & HEDDER FINISH	SB CHEVY (with D PORTS)		FORD CRATE MOTOR											
	RAW	HTC	RAW	HTC										
	BLACK MAXX		BLACK MAXX											
	64010	64016	84010	84016	64020	64026	84020	84026	64030	64036	84030	84460	64040	84470
	64013	64019	84013	84019	64023	64029	84023	84463	64033	64039	84463	84043	84473	

PORT CITY CHASSIS

ENGINE TYPE & HEDDER FINISH	SB CHEVY (with D PORTS)		SB CHEVY (with OVAL PORTS)		FORD M-60075347JR (ACT SPEC)		SB FORD CRATE MOTOR									
	RAW	HTC	RAW	HTC	RAW	HTC	RAW	HTC								
	BLACK MAXX		BLACK MAXX		BLACK MAXX		BLACK MAXX									
	64050	64056	64190	64196	84350	84356	84370	84376	64060	64066	64200	64206	64070	64076	64080	64170
	64053	64059	64193	64199	84353	84359	84373	84379	64063	64069	64203	64209	64073	64079	64083	64173

ASPHALT MODIFIEDS:

- Weld-On Style Race Collectors
- Hedders, Malleable Graphite Gaskets & Hardware Included
- 3/8" Flanges
- 18g Tubes



ASPHALT MODIFIEDS

TUBE DIAMETER >>	1 5/8" X 1 1/4" STEPPED	1 1/4" X 1 7/8" STEPPED
COLLECTOR SIZE >>	3"	3 1/2"

LEFTHANDER CHASSIS

ENGINE TYPE & HEDDER FINISH	SB CHEVY (with D PORTS)		SB CHEVY (with OVAL PORTS)					
	RAW	HTC	RAW	HTC				
	BLACK MAXX		BLACK MAXX					
	65766	65666	65762	65662	65768	65668	65764	65664
	65366	65366	65362	65362	65368	65368	65364	65364

PEARSON CHASSIS

ENGINE TYPE & HEDDER FINISH	SB CHEVY (with D PORTS)		SB CHEVY (with OVAL PORTS)					
	RAW	HTC	RAW	HTC				
	BLACK MAXX		BLACK MAXX					
	65767	65667	65763	65663	65769	65669	65765	65665
	65367	65367	65363	65363	65369	65369	65365	65365

HEDDERS ON THIS PAGE ARE NOT LEGAL FOR SALE OR USE ON POLLUTION CONTROLLED MOTOR VEHICLES.

BUILT TO BEAT THE COMPETITION!

Husler's new line of Asphalt and Dirt Sprint Car heddere set a new standard in sprint car heddere. Designed from the dirt up, Husler's Research & Development team built these new heddere with one goal in mind, build them better than the competition, and that is just what they did.

The Asphalt and dirt sprint car heddere in this catalog are a culmination of nearly two years of design and testing. Our team worked closely with long time sprint car builder and owner, Alan Barton, configuring, testing, and tweaking the design until they performed optimally.

- Each Set Includes Malleable Graphite Gaskets & Hardware
- All Sprint Car Models Are Available Uncoated, Or With Husler's HTC or BLACK MAXX Ceramic Coating
- Weld-On Race Collectors



NEW

DIRT SPRINT CARS:

- Chevy 360 & 410 Motor Models
- Various Head Patterns
- Standard & Forward Tube Designs Available
- Weld-On Race Collector
- 3/8" Flanges
- 18g Tubes

360 MOTORS



DIRT SPRINT CAR Heddere- Classic & Forward Design

TUBE DESIGN >>	STANDARD Design		FORWARD Design		
	TUBE DIAMETER >>	1 5/8" X 1 1/4" STEPPED	1 3/4" X 1 1/8" STEPPED	1 5/8" X 1 1/4" STEPPED	1 3/4" X 1 1/8" STEPPED
COLLECTOR SIZE >>	3"	3 1/2"	3"	3 1/2"	
CHEVY 360 MOTOR					
FINISH	RAW	65500	65520	65510	65530
	HTC	65506	65526	65516	65536
	BLACK MAXX	65503	65523	65513	65533

⚠ Spread port models have 1/4" flanges.

HEDDERE ON THIS PAGE ARE NOT LEGAL FOR SALE OR USE ON POLLUTION CONTROLLED MOTOR VEHICLES.



DIRT SPRINT CARS (continued): 410 MOTORS



Muffler not included.

DIRT SPRINT CAR Hedders- CLASSIC DESIGN

TUBE DIAMETER >>	2"	1 7/8" X 2" STEPPED	1 7/8" X 2 1/8" STEPPED	2" X 2 1/8" STEPPED
COLLECTOR SIZE >>	3 1/2"	3 1/2"	3 1/2"	3 1/2"

CHEVY 410 MOTOR

HEAD STYLE & FINISH	CHEVY 410 (18 DEGREE Heads)	RAW	65757	65751	65754	65760
		HTC	65657	65651	65654	65660
		BLACK MAXX	65357	65351	65354	65360
	CHEVY 410 (SPREAD PORT Heads)	RAW	65758	65752	65755	65761
		HTC	65658	65652	65655	65661
		BLACK MAXX	65358	65352	65355	65361

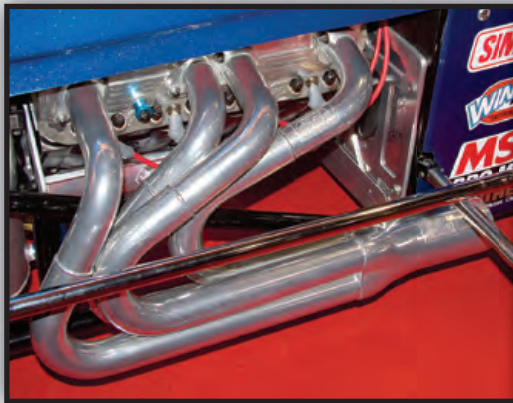

DIRT SPRINT CAR Hedders- FORWARD DESIGN

TUBE DIAMETER >>	2"	1 7/8" X 2" STEPPED	1 7/8" X 2 1/8" STEPPED
COLLECTOR SIZE >>	3 1/2"	3 1/2"	3 1/2"

CHEVY 410 MOTOR

HEAD STYLE & FINISH	CHEVY 410 (18 DEGREE Heads)	RAW	-	65690	66750
		HTC	-	65696	66756
		BLACK MAXX	-	65693	66753
	CHEVY 410 (SPREAD PORT Heads)	RAW	65780	65790	65810
		HTC	65786	65796	65816
		BLACK MAXX	65783	65793	65813

**ASPHALT
SPRINT CARS:**



- For Use on SB FORD CRATE MOTORS with Yates style or Edelbrock #7722 Ford 351 Windsor Heads
- Standard & Stepped Tube TRI-Y Models Available
- 3 1/2" Weld-On Race Collector
- Compatible with Maxim, Beast & J&J Chassis
- 3/8" Flanges
- 18G Tubes

ASPHALT SPRINT CAR Hedders

TUBE DIAMETER >>	2"	1 7/8" X 2" STEPPED	1 7/8" X 2 1/8" STEPPED	2" X 2 1/8" STEPPED
COLLECTOR SIZE >>	3 1/2"	3 1/2"	3 1/2"	3 1/2"

SB FORD CRATE MOTOR

FINISH	RAW	85942	85940	85941	85943
	HTC	85642	85640	85641	85643
	BLACK MAXX	85342	85340	85341	85343

NEW**DIRT
MODIFIEDS:**

- Fits G.R.T. Style Chassis
- Choose Between Conventional and TRI-Y Designs.
- Two Stepped Tube Designs Available
- Three Finishes Available
- Weld-on Style Race Collector
- Heddgers, Malleable Graphite Gaskets & Hardware Included.
- 3/8" Flanges
- 18G Tubes

Concrete Pumping &
636.942.14**DIRT
LATE MODELS:**

- Compatible with Rayburn, Warrior, Barry Wright Style Chassis
- Stepped & Standard Tube Designs
- Conventional and TRI-Y Designs to Choose From
- Slip-on Style Race Collector
- Available for Chevy & Ford Motors
- Three Finishes Available
- Heddgers, Malleable Graphite Gaskets & Hardware Included
- 3/8" Flanges
- 18G Tubes

NEW

HEDDERS ON THIS PAGE ARE NOT LEGAL FOR SALE OR USE ON POLLUTION CONTROLLED MOTOR VEHICLES.



DIRT MODIFIEDS & LATE MODELS



DIRT MODIFIEDS HEDDERS

HEDDER STYLE >>		CONVENTIONAL DESIGN		TRI-Y DESIGN		
		1 5/8" X 1 3/4" STEPPED	1 3/4" X 1 7/8" STEPPED	1 5/8" X 1 3/4" STEPPED	1 3/4" X 1 7/8" STEPPED	
TUBE DIAMETER >>		3"	3 1/2"	3"	3 1/2"	
COLLECTOR SIZE >>		3"	3 1/2"	3"	3 1/2"	
CHEVY						
ENGINE TYPE & HEDDER FINISH	SB CHEVY (with D PORTS)	RAW	46580	46590	46600	46610
		HTC	46586	46596	46606	46616
		BLACK MAXX	46583	46593	46603	46613
	SB CHEVY (with OVAL PORTS)	RAW	46500	46510	46520	46530
		HTC	46506	46516	46526	46536
		BLACK MAXX	46503	46513	46523	46533
FORD						
SB FORD CRATE MOTOR (with N351 or Brodix Style HEADS)	RAW	46540	46550	46560	46570	
	HTC	46546	46556	46566	46576	
	BLACK MAXX	46543	46553	46563	46573	

DIRT LATE MODEL HEDDERS

HEDDER STYLE >>		CONVENTIONAL DESIGN				TRI-Y DESIGN					
		1 3/4"	1 5/8" X 1 3/4" STEPPED	1 3/4" X 1 7/8" STEPPED	1 7/8" X 2" STEPPED	1 3/4"	1 5/8" X 1 3/4" STEPPED	1 3/4" X 1 7/8" STEPPED	1 3/4" X 1 7/8" STEPPED	1 7/8" X 2" STEPPED	
TUBE DIAMETER >>		3"	3"	3 1/2"	3 1/2"	3"	3"	3"	3 1/2"	3 1/2"	
COLLECTOR SIZE >>		3"	3"	3 1/2"	3 1/2"	3"	3"	3"	3 1/2"	3 1/2"	
CHEVY											
ENGINE TYPE & HEDDER FINISH	SB CHEVY (with D PORTS)	RAW	46040	46000	46090	-	46230	46190	-	46280	-
		HTC	46046	46006	46096	-	46236	46196	-	46286	-
		BLACK MAXX	46043	46003	46093	-	46233	46193	-	46283	-
	SB CHEVY (with OVAL PORTS)	RAW	46050	46010	46100	-	46240	46200	-	46290	-
		HTC	46056	46016	46106	-	46246	46206	-	46296	-
		BLACK MAXX	46053	46013	46103	-	46243	46203	-	46293	-
	SB CHEVY (with SPREAD PORTS)	RAW	46060	46020	46110	46160	46250	46210	-	46300	46350
		HTC	46066	46026	46116	46166	46256	46216	-	46306	46356
		BLACK MAXX	46063	46023	46113	46163	46253	46213	-	46303	46353
	SB CHEVY (with 18" HEADS)	RAW	46070	-	46120	46170	46260	-	-	46310	46360
		HTC	46076	-	46126	46176	46266	-	-	46316	46366
		BLACK MAXX	46073	-	46123	46173	46263	-	-	46313	46363
	SB CHEVY (with SB2 HEADS)	RAW	46080	-	46130	46180	46270	-	-	46320	46370
		HTC	46086	-	46136	46186	46276	-	-	46326	46376
		BLACK MAXX	46083	-	46133	46183	46273	-	-	46323	46373
	GM LS SERIES	RAW	-	-	-	-	-	-	46620	46630	46640
		HTC	-	-	-	-	-	-	46626	46636	46646
		BLACK MAXX	-	-	-	-	-	-	46623	46633	46643
FORD											
SB FORD CRATE MOTOR (with 374 Style HEADS)	RAW	46390	-	46410	46430	46450	-	-	46470	46490	
	HTC	46396	-	46416	46436	46456	-	-	46476	46496	
	BLACK MAXX	46393	-	46413	46433	46453	-	-	46473	46493	
SB FORD CRATE MOTOR (with N351 or Brodix Style HEADS)	RAW	46380	-	46400	46420	46440	-	-	46460	46480	
	HTC	46386	-	46406	46426	46446	-	-	46466	46486	
	BLACK MAXX	46383	-	46403	46423	46443	-	-	46463	46483	

HEDDERS ON THIS PAGE ARE NOT LEGAL FOR SALE OR USE ON POLLUTION CONTROLLED MOTOR VEHICLES.

TAILPIPE SAVERS:

NEW

- Protects Your Race Car's Body From the Damage Caused By High Exhaust Temperatures.
- Available In Single & Dual Outlet Models.
- Three Finishes To Choose From.

TAILPIPE SAVERS				
FINISH >>		RAW	HTC CERAMIC COATED	BLACK MAXX CERAMIC COATED
SINGLE OUTLET				
OUTLET SIZE	4"	95170	95176	95173
	5"	95180	95186	95183
DUAL OUTLET				
	3 1/2"	95150	95156	95153



#95176

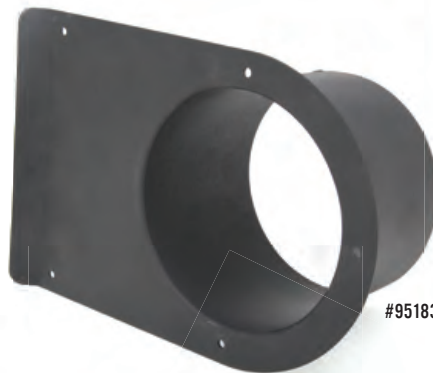

#95183



#95153

RACE CAR MUFFLERS:

NEW

- Straight Through Race Design
- Weld-on Installation

RACE CAR MUFFLERS				
FINISH >>		RAW	HTC CERAMIC COATED	BLACK MAXX CERAMIC COATED
CRATE LATE MODELS				
INLET / OUTLET SIZE	4"	92271	92276	92273
	SUPER LATE MODELS			
	5"	92281	92286	92283
DIRT LATE MODELS				
	3"	92261	92266	92263
	3 1/2"	92251	92256	92253
SPRINT CARS				
	3"	92161	92166	92163
	3 1/2"	92151	92156	92153





HEDDER FLANGES & GASKETS



HEDDER FLANGES:

Hedman Husler Hedder flanges are the same high quality, port matched flanges we use to build all of our off the shelf race hedders. Both basic flanges and flanges with stubs are available. Manufactured from mild steel and the perfect companion to Husler's mandrel bend tubes and collectors.

- ** Wide Pattern
- *** Dual Bolt Pattern
- **** Brodix non-spread port for standard SB Chevy. #10045 Sub-Flange must be used.

ENGINE	TUBE SIZE	PORT SHAPE	FLANGE THICKNESS	WITHOUT STUBS	WITH STUBS
Chevy 265-400	1-3/4"	Oval	3/8"	10050	11050
Chevy 265-400; Sub-Flange	Inner	SAP	5/16"	10045	-
Chevy 265-400 (Outer)****	1-7/8"	Round	3/8"	10052	11052
Chevy 265-400 (Outer)****	2"	Round	3/8"	10055	11055
Chevy 265-400 (Outer)****	2-1/8"	Round	3/8"	10060	11060
Chevy 265-400 (Outer)****	2-1/4"	Round	3/8"	10061	11061
Chevy 265-400 Spread Port	1-7/8"	Round	3/8"	10075	11075
Chevy 265-400 Spread Port	2"	Round	3/8"	10080	11080
Chevy 265-400 Spread Port	2-1/8"	Round	3/8"	10081	11081
Chevy 265-400 Spread Port	2-1/4"	Round	3/8"	10082	11082
Chevy D-Port	1-3/4"	SAP	3/8"	10032	11032
Chevy LS1	1-3/4"	Round	3/8"	10495	11495
Chevy LS1	17/8"	Round	3/8"	10496	11496
Chevy LS1	2"	Round	3/8"	10497	11497
Chevy 396-454	1-3/4"	Round	1/4"	10092	11092
Chevy 396-454	2"	Round	3/8"	10095	11095
Chevy 396-454	2-1/8"	Round	3/8"	10100	11100
Chevy 396-454	2-1/4"	Round	3/8"	10105	11105
Chevy 396-454	2-3/8"	Round	3/8"	10110	11110
Chevy 396-454	2-1/2"	Round	3/8"	10115	11115
Chevy V8 18°	2"	SAP	3/8"	10492	11492
Ford 289-351W	1- 5/8"	Square	3/8"	-	11288
Ford 289-351W	1-3/4"	Square	3/8"	10300	11300
Ford 351-400M (2V)	1-7/8"	Oval	3/8"	10301	11301
Ford 352-428 (FE Engine)	1-3/4"	SAP	3/8"	10305	11305
Ford 352-428 (FE Engine)	1-7/8"	SAP	3/8"	10310	11310
Ford 352-428 (FE Engine)	2"	SAP	3/8"	10315	11315
Ford 352-428 (FE Engine)	2-1/8"	SAP	3/8"	10320	11320
Ford 302-351C (2BBL)	1-3/4"	SAP	3/8"	-	11340
Ford 302-351C (2BBL)	1-7/8"	SAP	3/8"	10345	11345
Ford 302-351C (4BBL)	1-7/8"	SAP	3/8"	-	11325
Ford 302-351C (4BBL)	2"	SAP	3/8"	-	11330
Ford 302-351C (4BBL)	2-1/8"	SAP	3/8"	10335	11335
Ford 429-460 CJ	2"	SAP	3/8"	-	11360
Ford 429-460 CJ	2-1/8"	SAP	3/8"	10365	11365

ENGINE	TUBE SIZE	PORT SHAPE	FLANGE THICKNESS	WITHOUT STUBS	WITH STUBS
Ford 429-460 CJ	2-1/4"	SAP	3/8"	10370	11370
Ford 429-460 CJ	2-3/8"	SAP	3/8"	10375	11375
Ford 429-460 EFI	1- 3/4"	SAP	3/8"	10387	11387
Ford 429-460 (Standard)	1-3/4"	SAP	3/8"	-	11385
Ford 429-460 (Standard)	1-7/8"	SAP	3/8"	10386	11386
Ford 351 (Yates Style)	2"	SAP	3/8"	10430	11430
Ford Dart II 302-351W**	1-3/4"	Square	3/8"	10445	11445
Ford Dart II 302-351W**	1-7/8"	Square	3/8"	10446	11446
Ford SVO 460*** A, B, C	2"	Square	3/8"	-	11470
Ford SVO 460*** A, B, C	2-1/8"	Square	3/8"	-	11475
Ford SVO 460*** A, B, C	2-1/4"	Square	3/8"	10480	11480
Mopar 273-360	1-3/4"	SAP	3/8"	10205	11205
Mopar 273-360 (Will not seal on Magnum V8 Heads)	1-7/8"	SAP	3/8"	10210	11210
Mopar W2 Wide (4-3/4" on center)	Inner	D	5/16"	10215	-
Mopar W2 Narrow (4" on center)	Inner	D	5/16"	10220	-
Mopar W2 (Outer)	1-7/8"	Round	3/8"	-	11230
Mopar W2 (Outer)	2"	Round	3/8"	10235	11235
Mopar 383-440	1-3/4"	SAP	3/8"	10245	11245
Mopar 383-440	1-7/8"	SAP	3/8"	-	11250
Mopar 383-440	2"	SAP	3/8"	10255	11255
Mopar 383-440	2"	SAP	3/8"	10256	11256
Mopar 383-440- Indy Heads	2-1/8"	SAP	3/8"	10260	11260
Mopar 383-440- Indy Heads	2-1/4"	SAP	3/8"	10265	11265
Mopar 426 Hemi	2"	SAP	3/8"	-	11270
Mopar 426 Hemi	2-1/8"	SAP	3/8"	-	11275
Mopar 426 Hemi	2-1/4"	SAP	3/8"	-	11280
Mopar 426 Hemi	2-3/8"	SAP	3/8"	10285	11285
Pontiac 350-455 D-Port	1-3/4"	SAP	3/8"	10140	11140
Pontiac 350-455 D Port Sub-Flange	Inner	SAP	5/16"	10170	-
Pontiac 350-455 D Port (Outer)	1-7/8"	Round	3/8"	10175	11175
Pontiac 350-455 D Port (Outer)	2"	Round	3/8"	10180	11180
Pontiac 400 Ram Air 4	13/4"	Round	3/8"	10145	11145
Pontiac 400 Ram Air 4	17/8"	Round	3/8"	10150	11150
Pontiac 400 Ram Air 4	2"	Round	3/8"	10155	11155

HEDDER & COLLECTOR FLANGE GASKETS:

STANDARD HEDDER GASKETS

Husler's STANDARD gaskets are made of a special, reinforced gasket material developed for Hedman. Hedman Gaskets are available for most hedder applications listed in this catalog. These gaskets are specially made for Hedman to be exact matches for our hedder flanges. Hedman Gaskets must be used with all Hedman Hedders to insure a proper fit and seal.

GRAPHITE HEDDER GASKETS (For oval track race hedders)

Husler's malleable GRAPHITE hedder gaskets are premium quality gaskets that compress when installed to provide optimum port sealing. These graphite gaskets are included with all Husler's Modifieds, Late Model, Super Late Model and Sprint Car hedders.

ENGINE / HEADS	PART #
COLLECTOR GASKETS	
3" 3-Bolt Triangle	18200
2 1/2" 3-Bolt Triangle	18201
3 1/2" 3-Bolt Triangle	18202

ENGINE / HEADS	STANDARD GASKET #	GRAPHITE GASKET #
CHEVROLET		
Chevy SB (Double Flange)- Inner	18068	-
Chevy SB (Double Flange)- Outer	18069	-
Chevy 265-400- OVAL Port	18166	18566
Chevy 265-400- D Port	-	18567
Chevy 265-400- ROUND Port	18066	-
Chevy 18°	18492	18592
Chevy LS	18495	-
Chevy 396-454 (Race)	18048	-
Chevy 396-454 (Street)	18119	-
Chevy Brodix Spread Port	18088	18588
Chevy Spread Port (individual ports)	18088	18588
FORD		
Ford Dart II (wide bolt pattern)	18150	18550
Ford 302-351W Oval	18050	-
Ford 351C (2bbl) & 400M (2bbl)	18058	-
Ford 351C (4bbl) & Boss 302	18051	-
Ford 352-428 (FE motors)	18052	-
Ford 429-460	18053	-
Ford 429-460 (CJ)	18153	-
Ford Flathead V8	18158	-

ENGINE / HEADS	STANDARD GASKET #	GRAPHITE GASKET #
MOPAR		
Ford Pinto 2300cc 4-Cylinder	18056	-
Ford SVO Round Port (Early A Head)	18115	-
MOPAR		
Mopar 340-360	18081	-
Mopar 383-440	18079	-
Mopar 426 Hemi	18080	-
Mopar 340 W-2 Double Flange (Outer)	18087	-
Mopar Double Flange 340 W-2 Std. Inner (4-3/4" center to center)	18086	-
Mopar Double Flange 340 W-2 Econo Inner (4" center to center)	18300	-
PONTIAC		
Pontiac 326-400 "D" Port	18073	-
Pontiac 400-455 Round Port	18074	-
Pontiac Dual Flange "D" Port Inner	18076	-
Pontiac Dual Flange "D" Port Outer	18077	-

MANDREL BENDS:

Having Hedman Husler's Mandrel Bends in your shop is like having a CNC mandrel tube bending machine on the premises.

A variety of angles are available so you can custom fabricate heddgers and exhaust systems with better flowing, less restrictive mandrel bent curves... not kinked, power robbing ones. All Husler mandrel bends are manufactured using 18 gauge tubing.



90° Bend



120° Bend



180° Bend

90° MANDREL BENDS

TUBE DIAMETER (Outside Diameter)	BEND RADIUS	LEG LENGTHS	PART #
1½"	2¼"	3½" & 17½"	12010
1¾"	2½"	3½" & 17½"	12011
1¾"	3"	3½" & 16"	12012
1¾"	3"	3½" & 16½"	12013
2"	3"	3½" & 16"	12014
2½"	3¼"	4" & 15½"	12015
2¼"	3¾"	5" & 14½"	12016
2¾"	3¾"	4½" & 11"	12017
2½"	4"	9" & 16"	12018
3"	6"	6½" & 8½"	12007
3½"	6"	8" & 8"	12006

120° MANDREL BENDS ("J" Bends)

TUBE DIAMETER (Outside Diameter)	BEND RADIUS	LEG LENGTHS	PART #
1½"	2¼"	3½" & 16"	12073
1¾"	2½"	3½" & 16"	12074
1¾"	3"	3½" & 14½"	12075
1¾"	3"	3½" & 14½"	12076
2"	3"	3½" & 14½"	12077
2½"	3¼"	4" & 14"	12078
2¼"	3¾"	5" & 12½"	12079
2¾"	3¾"	4½" & 12½"	12080
2½"	4"	6" & 8½"	12081
3"	6"	6½" & 5½"	12083
3½"	7"	9½" & 9½"	12084

180° MANDREL BENDS ("U" Bends)

TUBE DIAMETER (Outside Diameter)	BEND RADIUS	LEG LENGTHS	PART #
1½"	2¼"	3½" & 14"	12053
1¾"	2½"	3½" & 13½"	12054
1¾"	3"	3½" & 11½"	12055
1¾"	3"	3½" & 12"	12056
2"	3"	3½" & 12"	12057
2½"	3¼"	4" & 11"	12058
2¼"	3¾"	5" & 10"	12059
2¾"	3¾"	4½" & 8½"	12060
2½"	4"	7½" & 11"	12061
3"	6"	6½" & 6½"	12063

BOX OF MANDREL BENDS

TUBE DIAMETER (Outside Diameter)	NUMBER OF TUBES PER BOX			PART #
	90° BENDS	120° BENDS	180° BENDS	
1½"	4	4	10	12033
1¾"	4	4	10	12020
1¾"	4	4	10	12021
1¾"	4	4	10	12022
2"	4	4	10	12023
2½"	4	4	10	12024
2¼"	4	4	10	12025
2¾"	4	4	10	12026
2½"	4	4	10	12027
3"	4	4	10	12029

ENGINE DYNO HEDDER WELD-UP KIT DIMENSIONS GUIDE.

- SMALL BLOCK CHEVY
- SMALL BLOCK FORD
- CHRYSLER

These diagrams provide you with important dimensions for the engine dyno weld-up kits on page 15.

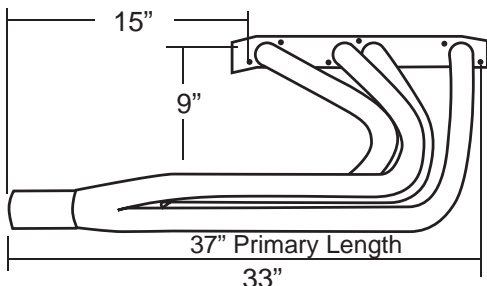
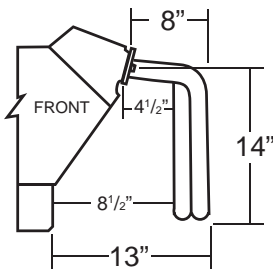

- BIG BLOCK CHEVY
- 351 CLEVELAND
- 460 FORD
- F.E. FORD

These diagrams provide you with important dimensions for the engine dyno weld-up kits on page 15.

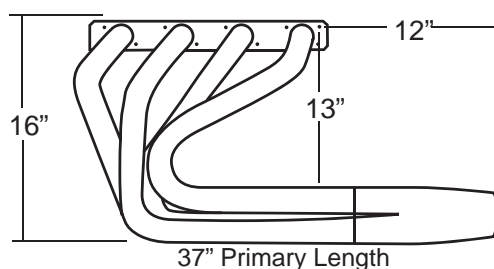
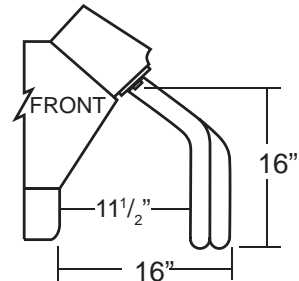

HEDDER COLLECTORS:



All Collectors Sold In Pairs.

TUBE SIZE	COLLECTOR O.D.	SLIP-ON STYLE	WELD-ON STYLE
FOR V8 HEDDERS			
1½"	2½"	14041	14009
1½"	3"	14042	14010
1½"	3"	14043	14011
1¾"	3"	14044	14012
1¾"	3½"	14045	14013
1¾"	3½"	14046	14014
2"	3½"	14047	14015
2½"	3½"	14048	14016
2½"	4"	14049	14017
2¼"	4"	14151	14018*
2¼"	4½"	14146	-
2¾"	4½"	14055	14023
2¾"	5"	14056	14024
2½"	4½"	14150	14025
2½"	5"	14057	14026
2½"	4½"	14149	14029
2½"	5"	14148	14030

*Part #14018 has a collector length of 8".

**EXHAUST
TURN-OUTS:**
Sold In Pairs.



EXHAUST SYSTEM DIAMETER	INSTALLATION METHOD	PART #
3"	Slip On	92061
3½"	Slip On	92051
4"	Slip On	92071

MISCELLANEOUS COMPONENTS:

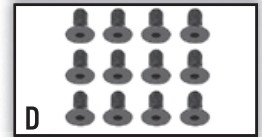
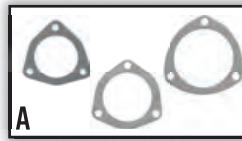

PHOTO	DESCRIPTION	PART #
(A)	2½" Collector Ring, each	15212
(A)	3" Collector Ring, each	15300
(A)	3½" Collector Ring, each	15312
(C)	Collector Tabs (set of 8)	15200
(B)	5/16" Hedder Bolt, each	15206
(D)	5/16" Countersunk Sub-Flange Bolts (each)	15207
(B)	3/8" Hedder Bolt, each	15208
(D)	3/8" Countersunk Sub-Flange Bolts (each)	15209

**COLLECTOR
EXTENSIONS:**
Sold In Pairs.



TUBE SIZE	O.D.	LENGTH	WELD-ON STYLE
FOR V8 HEDDERS			
2½"	3-Bolt Triangle Flange	12"	15010
2½"	Slip On	12"	15011
3"	3-Bolt Triangle Flange	12"	15019
3"	Slip On	12"	15012
3"	Slip On	18"	15013
3½"	3-Bolt Triangle Flange	12"	15014
3½"	Slip On	12"	15015
3½"	Slip On	18"	15016
4"	Slip On	12"	15017
4"	Slip On	18"	15018

**STREET
HOOK-UPS:**



Sold In Pairs.

TUBE SIZE	O.D.	COLLECTOR LENGTH	WELD-ON STYLE
2"	2½"	O ₂ Triangle Ring	16020
2"	2½"	Triangle Ring with O ₂ Sensor	16060
2¼"	3"	Triangle Ring	16010
2¼"	3"	Triangle Ring with O ₂ Sensor	16040
2¼"	3"	Unifit with O ₂ Sensor	16050
2½"	3½"	Triangle Ring	16012
2½"	3½"	Triangle Ring With O ₂ Sensor	16030