



## **3" Nerf Bars Installation Instructions**

**Part: # 205008/205013/205014/328078/205016/205017**

**Dodge Ram 2002-2010**

### **# 205008**

2002-2009 Dodge Ram P/U Quad Cab 1500/2500HD/3500HD

### **# 205013**

2002-UP Dodge Ram Standard Cab 2DR 1500

### **# 205014**

2003-UP Dodge Ram Standard Cab 2DR 2500/3500

### **# 328078**

2009 Dodge Ram 1500 Regular Cab

### **# 205016**

2009-2010 Dodge Ram Quad Cab 1500

### **# 205017**

2009-2010 Dodge Ram Quad Cab 2500/3500



## 3" Nerf Bars Installation Instructions

**PART #328078/205016/205017**

**Dodge Ram 2009-2010**

**#328078**

2009 Dodge Ram 1500 Regular Cab

### PARTS LIST:

Qty	Description	Qty	Description
1	Driver/Left Sidebar	4	12mm x 40mm Bolt/10mm Nut Plates
1	Passenger/Right Sidebar	2	12mm x 40mm Bolt Plates
1	Driver/Left Front Mounting Bracket	6	12mm x 32mm OD x 3mm Flat Washers
1	Passenger/Right Front Mounting Bracket	6	12mm Lock Washers
1	Driver/Left Rear Mounting Bracket	6	12mm Hex Nuts
1	Passenger/Right Rear Mounting Bracket	6	11mm Plastic Retainers
4	1/2" x 2" Hex Bolts	4	10-1.50mm x 35mm Hex Bolts
4	1/2" Lock Washers	4	10mm x 30mm OD x 2.5mm flat washers
4	1/2" X 1-1/2" OD x 1/8" flat washers	4	10mm Lock Washers

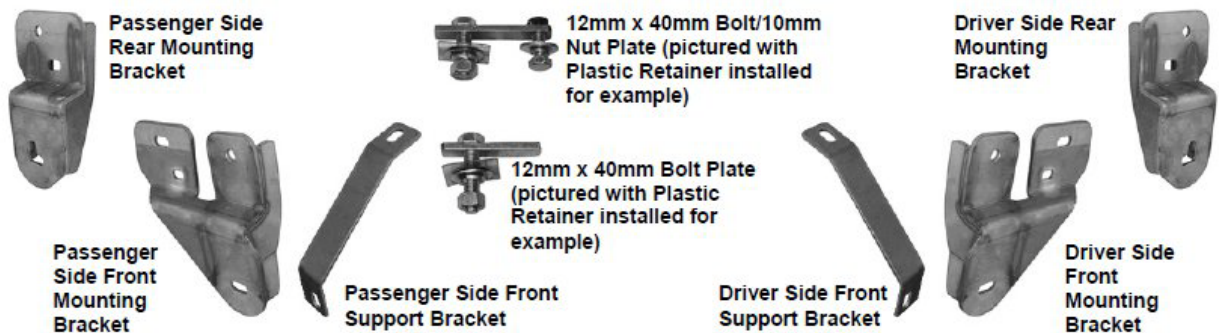

## PROCEDURE:

**1. REMOVE CONTENTS FROM BOX. VERIFY ALL PARTS ARE PRESENT. READ INSTRUCTIONS CAREFULLY BEFORE STARTING INSTALLATION.**

**2.** Starting at the passenger side-front of the vehicle, remove the tape covering the factory oval holes in the passenger side inner panel located by the front tire.

**3.** Next, partially thread a Plastic Retainer onto the threaded end of a Bolt and Nut Plate, **(Fig 1B)**.

**4.** Once you have assembled the Plastic Retainer onto the Bolt and Nut Plate, insert the Bolt and Nut Plate into the factory oval hole. Once the Bolt and Nut Plate is inserted, hold the Bolt end

with one hand and tighten the Plastic Retainer with your other hand. **NOTE:** Tighten the Plastic Retainer until it reaches the side panel, **(Figure 2)**.

**5.** Next, select (1) 12mm Bolt Plate and partially thread a Plastic Retainer onto it. Insert the Bolt Plate into the oval hole and install in the forward, smaller oval hole as per step 4, **(Fig 1A)**.

**6.** Select the passenger side front Mounting Bracket. Position the Mounting Bracket onto the installed Bolt Plates. Secure it with (2) 12mm Flat Washers, (2) 12mm Lock Washers and (2) 12mm Hex Nuts, **(Figure 3)**. Do not tighten at this time. Rotate the Bolt and Nut plate until the Nut end lines up with the remaining hole in the Mounting Bracket and body. Thread (1) 10mm x 35mm Hex Bolt, (1) 10mm Flat Washer and (1) 10mm Lock Washer into the threaded nut. Snug but do not tighten hardware at this time.

**7.** Remove the passenger side front factory body bolt. Select the passenger side Front Support Bracket. Insert the factory body bolt through the Support Bracket and up into its original position, **(Figure 3)**. Line the other end of the Support Bracket up with the oval hole in the Front Mounting Bracket. Snug but do not tighten hardware.

**8.** Moving to the passenger side rear of the vehicle, remove the tape covering the factory oval hole in the inner body panel. Thread a Plastic Retainer onto the threaded end of a Bolt and Nut Plate, **(Figure 1A)**. Insert the Bolt and Nut Plate into the factory hole. Once the Bolt and Nut Plate is inserted, hold the Bolt end with one hand and tighten the Plastic Retainer with your

other hand, **(Figure 4)**. **NOTE:** Tighten the Plastic Retainer until it reaches the side panel.

**9.** Select the passenger side rear Mounting Bracket. Position the Mounting Bracket onto the installed Bolt and Nut Plate. Secure it with (1) 12mm Flat Washer, (1) 12mm Lock Washer and (1) 12mm Hex Nut, **(Figure 5)**. Do not tighten at this time. Rotate the Bolt and Nut plate until

the Nut end lines up with the remaining hole in the Mounting Bracket and body. Thread (1) 10mm x 35mm Hex Bolt, (1) 10mm Flat Washer and (1) 10mm Lock Washer into the threaded nut. Snug but do not tighten hardware at this time.

**10.** Next, select the passenger sidebar and fasten it to the front Mounting Bracket and Support

Bracket with the included (1) 1/2" x 2" Hex Head Bolt, (1) 1/2" Lock Washer, and (1) 1/2" Flat

Washer **(Figure 6)**. Do not tighten at this time. Repeat this step for rear Sidebar mounting.

**11.** Level and align Sidebar properly; then tighten all hardware at this time.

**12.** Repeat steps 2-11 for driver Sidebar.

**13.** Do periodic inspections to the installation to make sure all hardware is secure and tight.

**To protect your investment**, wax this product after installing. Regular waxing is recommended to

add a protective layer over the finish. Do not use any type of polish or wax that may contain abrasives that could damage the finish.

**For stainless steel:** Aluminum polish may be used to polish small scratches and scuffs on the finish. Mild soap may be used also to clean the Sidebar. **For gloss black finishes:** Mild soap may be used to clean the Sidebar.

**PASSENGER SIDE INSTALLATION PICTURED**

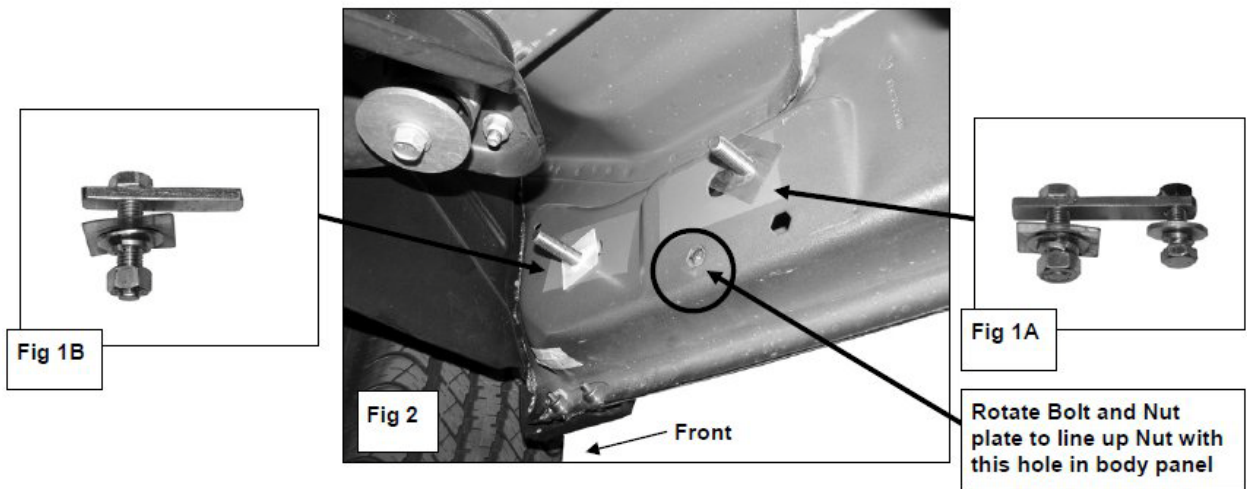

**PASSENGER SIDE INSTALLATION PICTURED**

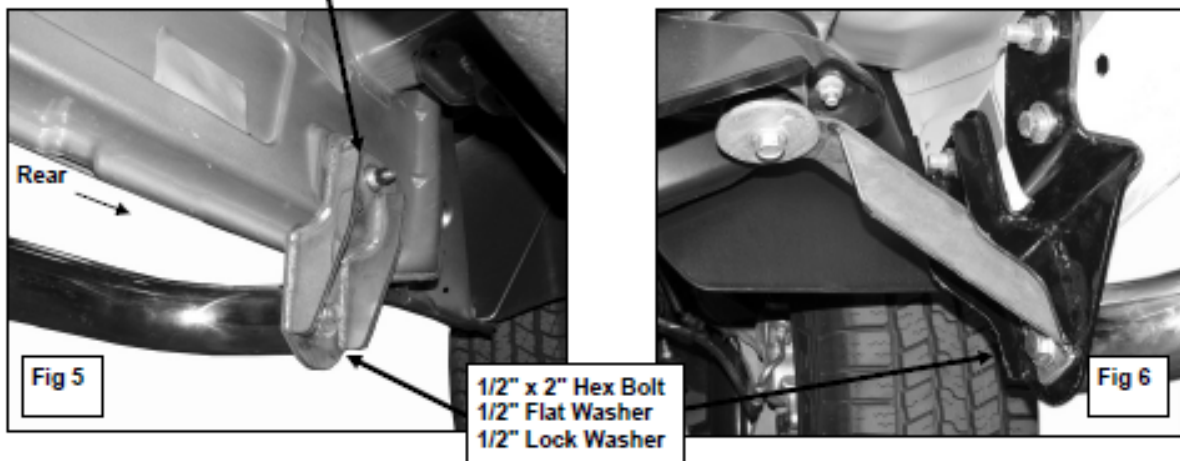
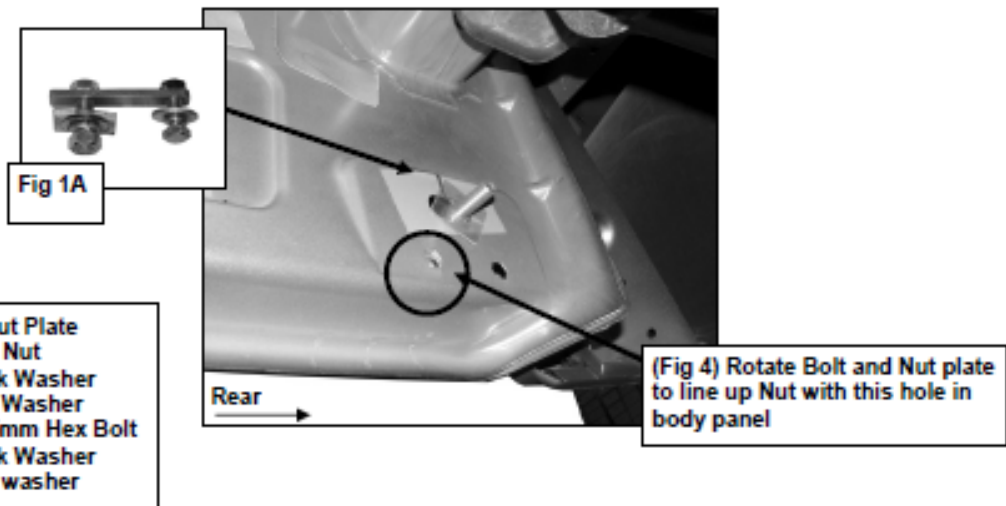
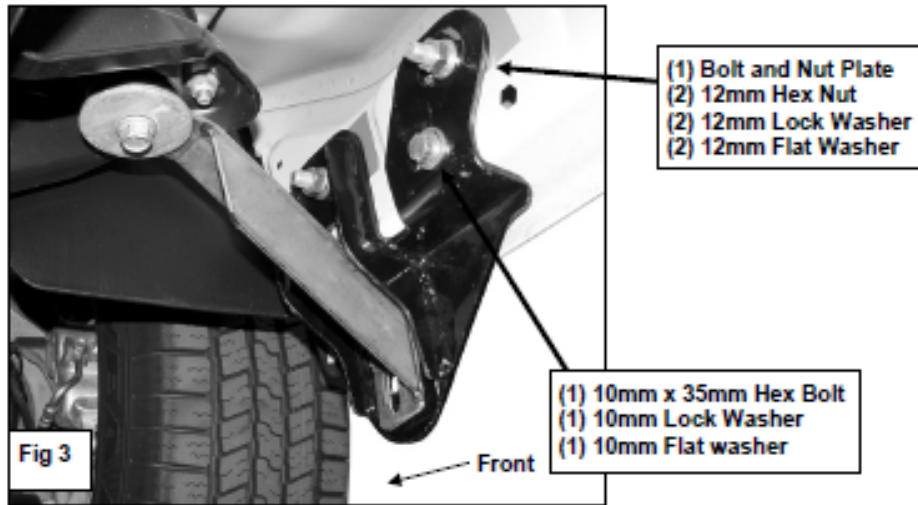

# #205016

2009-2010 Dodge Ram Quad Cab 1500

# #205017

2009-2010 Dodge Ram Quad Cab 1500

## PARTS LIST:

Qty	Description	Qty	Description
1	Driver/Left Side Bar	6	10mm Flat Washer
1	Passenger/Right Side Bar	4	10mm Lock Washer
1	Driver/Left Front Mounting Bracket	4	10mm Hex Nut
1	Passenger/Right Front Mounting Bracket	2	10mm x 30mm Hex Bolt
1	Driver/Left Rear Mounting Bracket	4	12mm x 120mm Hex Bolt
1	Passenger/ Rear Mounting Brace Bracket	4	12mm x 44 OD Flat Washer
1	Driver/Left Front Brace Bracket 02-2010 1500 Quad Cab	8	12mm Lock Washer
1	Passenger/ Front Brace Bracket 02-2010 1500 Quad Cab	4	12mm x 60mm Hex Bolt
1	Driver/Left Front Brace Bracket 02-2005 2500/3500 Quad Cab	4	12mm x 37 OD Flat Washer
1	Passenger/ Front Brace Bracket 02-2005 2500/3500 Quad Cab	2	10mm x 35mm Bolt Plate
1	Driver/Left Front Brace Bracket 06-2010 2500/3500 Quad Cab		
1	Passenger/ Front Brace Bracket 06-2010 2500/3500 Quad Cab		

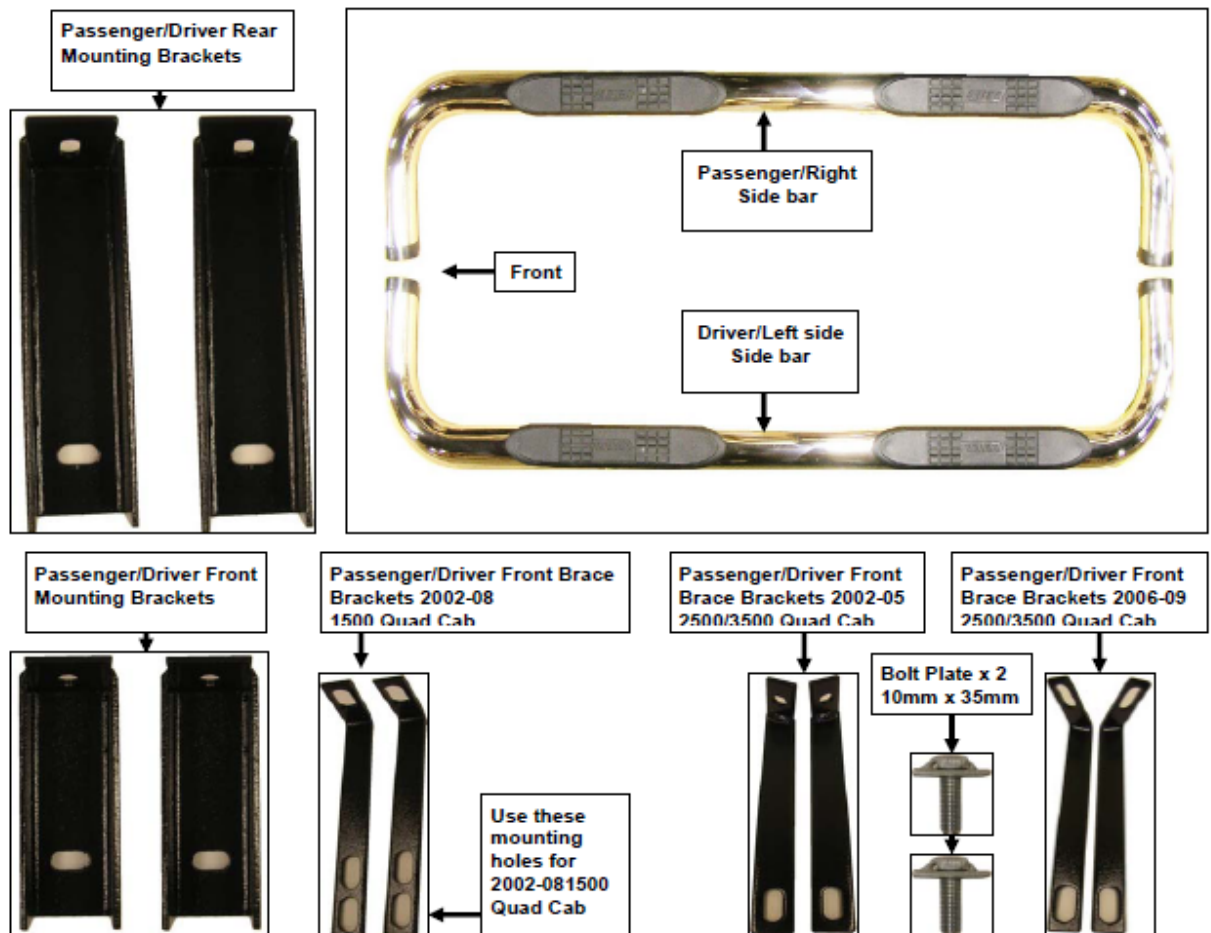

## PROCEDURE:

**1. REMOVE CONTENTS FROM BOX. VERIFY ALL PARTS ARE PRESENT.**

### READ

**INSTRUCTIONS CAREFULLY BEFORE STARTING INSTALLATION.**

**(Note depending on your Vehicles year & model your mounting kit may include brackets not needed, discard these if not used).**

**2.** Starting at the Passenger/Right side-front of the vehicle, remove the front factory body bolt & washer.(not re-used) **(Fig 1)**, From the list above select the Passenger/Right side front mounting bracket and secure it with (1) 12mm x 120mm Hex Bolt, (1) 12mm x 44 OD Flat Washer, (1) 12mm Lock Washers **(Fig 1A)**. Snug but do not tighten hardware at this time.

**3.** Moving to the passenger/Right side rear of the vehicle, remove the rear factory body bolt & Isolator plate.(not re-used) **(Fig 2)**, From the list above select the Passenger/Right side rear mounting bracket and secure it with (1) 12mm x 120mm Hex Bolt, (1) 12mm x 44 OD Flat Washer, (1) 12mm Lock Washers **(Fig 2A)**. Snug but do not tighten hardware at this time.

**4.** Next, select the Bolt Plate from the list of parts above, and place the Bolt Plate into the opening on the Passenger/Right side bottom front frame rail **(Fig 3)** shows Bolt plate placed into frame rail.

**5.** Select the Passenger/Right side bar fasten to the front mounting bracket and brace bracket with the included (1) 12mm x 60mm hex bolt, (1) 12mm lock washer, and (1) 12mm flat washer, Secure Brace Bracket to Bolt Plate with (1) 10mm flat washer, (1) 10mm lock washer and (1) 10mm nut. **(Fig 3A)** shows bolt plate attached to brace bracket and sidebar. Snug but do not tighten hardware at this time.

**6.** Install rear of Sidebar to the rear mounting bracket with (1) 12mm x 60mm hex bolt, (1) 12mm lock washer, and (1) 12mm flat washer. Snug but do not tighten hardware at this time.

**7.** Level and align Sidebar properly; then tighten all hardware at this time.

**8.** Repeat steps 2-7 for driver Sidebar.

**9.** Do periodic inspections to the installation to make sure all hardware is secure and tight.

**To protect your investment**, wax this product after installing. Regular waxing is recommended to

add a protective layer over the finish. Do not use any type of polish or wax that may contain abrasives

that could damage the finish.

**For stainless steel:** Aluminum polish may be used to polish small scratches and scuffs on the finish.

Mild soap may be used also to clean the Sidebar.

**For gloss black finishes:** Mild soap may be used to clean the Sidebar.

**PASSENGER SIDE INSTALLATION PICTURED**

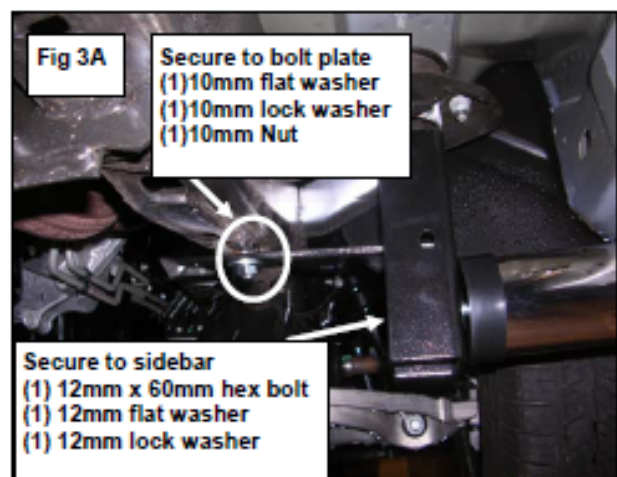
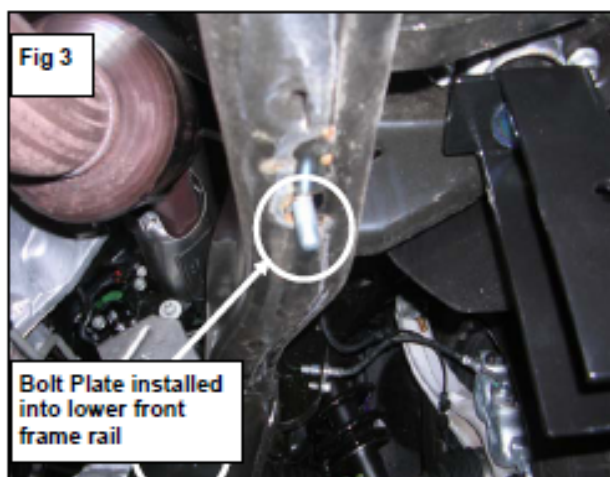
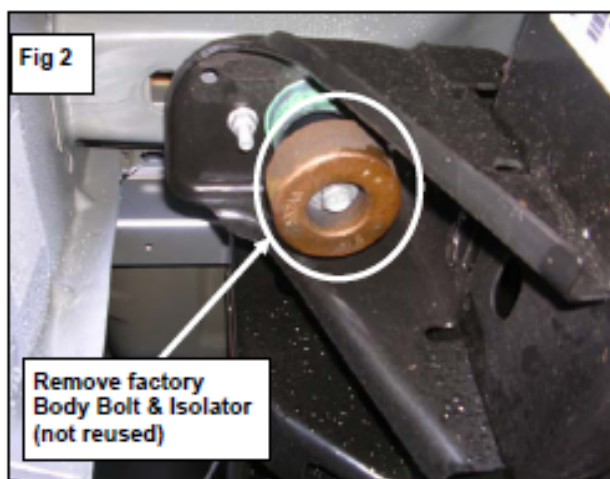







## 3" Nerf Bars Installation Instructions

**PART #205008/205013/205014**

**DODGE RAM 1500/2500HD/3500HD 2002-2009**

**#205008**

2002-2009 DODGE RAM P/U QUAD CAB 1500/2500HD/3500HD

### Qty Description Qty Description

1 Driver/Left Side Bar	6 10mm Flat Washer
1 Passenger/Right Side Bar	4 10mm Lock Washer
1 Driver/Left Front Mounting Bracket	4 10mm Hex Nut
1 Passenger/Right Front Mounting Bracket	2 10mm x 30mm Hex Bolt
1 Driver/Left Rear Mounting Bracket	4 12mm x 120mm Hex Bolt
1 Passenger/ Rear Mounting Brace Bracket	4 12mm x 44 OD Flat Washer
1 Driver/Left Front Brace Bracket 02-2010 1500 Quad Cab	8 12mm Lock Washer
1 Passenger/ Front Brace Bracket 02-2010 1500 Quad Cab	4 12mm x 60mm Hex Bolt
1 Driver/Left Front Brace Bracket 02-2005 2500/3500 Quad Cab	4 12mm x 37 OD Flat Washer
1 Passenger/ Front Brace Bracket 02-2005 2500/3500 Quad Cab	2 10mm x 35mm Bolt Plate
1 Driver/Left Front Brace Bracket 06-2010 2500/3500 Quad Cab	
1 Passenger/ Front Brace Bracket 06-2010 2500/3500 Quad Cab	

### PROCEDURE:

**1. REMOVE CONTENTS FROM BOX. VERIFY ALL PARTS ARE PRESENT. READ INSTRUCTIONS CAREFULLY BEFORE STARTING INSTALLATION.**

**(Note depending on your vehicles year & model your mounting kit may include brackets not needed, discard these if not used).**

**2.** Begin installation by working on driver side of the vehicle (refer to Figures 1. 1- 1.5)

**3.** From underneath truck, loosen and remove body mount bolts that run upward through mounts

into floorboard. Attach and secure Front Mount Bracket to underside of vehicles front body mount

(see Figure 1.3), re-using isolator, but replacing factory bolt with (1) M12 – 1.75 x 120mm bolt, (1) 12mm lock washer, and (1) 12mm flat washer. Snug but do not tighten hardware at this time.

**4.** Attach and secure Rear Mount Bracket to underside of vehicles rear body mount in same manner as the front.

**5.** Next, select the Bolt Plate from the list of parts above, and place the Bolt Plate into the opening on the bottom front frame rail

**6. 1500 Series Ram 2002-08** select brackets from parts list above, (discard 2500/3500 brace brackets not needed). Secure Brace Bracket to Bolt Plate with (1) 10mm flat washer, (1) 10mm lock washer and (1) 10mm nut. (Fig 1.2) Snug but do not tighten hardware at this time.

**7. 2500/3500 Series Ram 2002-05** select brackets from parts list above, (discard 1500 & 2006-09.2500/3500 brace brackets not needed). (see Figure 1.1) Attach Brace Bracket to side of mountbracket using (1) 10mm x 30mm bolt, (2) 10mm flat washers, (1) 10mm lock washer and (1)10mm nut, (see Fig 1.5) secure Bolt Plate to bracket with (1) 10mm flat washer, (1) 10mm lockwasher and (1) 10mm nut. Snug but do not tighten hardware at this time.

**8. 2500/3500 Series Ram 2006-09** select brackets from parts list above, (discard 1500 & 2002-05).

2500/3500 brace brackets Note: that this is the shorter set of brackets). Follow the remaining steps from#7 above.

**9.** Attach Driver/Left sidebar to Front and Rear Brackets using (1) 12mm x 60mm hex bolt, (1) 12mm lock washer and (1) 12mm flat washer for each bracket and hand tighten.

**10.** Level and align Sidebar properly; once complete torque all M12 bolts first to 65 ft-lbs and then tighten all remaining fasteners to complete the Driver/Left side assembly.

**11.** Repeat steps 3-10 for Passenger/Right Sidebar.

**12.** Do periodic inspections to the installation to make sure all hardware is secure and tight. **To protect your investment**, wax this product after installing. Regular waxing is recommended to add a protective layer over the finish. Do not use any type of polish or wax that may contain abrasives that could damage the finish.

**For stainless steel:** Aluminum polish may be used to polish small scratches and scuffs on the finish.

Mild soap may be used also to clean the Sidebar.

**For gloss black finishes:** Mild soap may be used to clean the Sidebar.

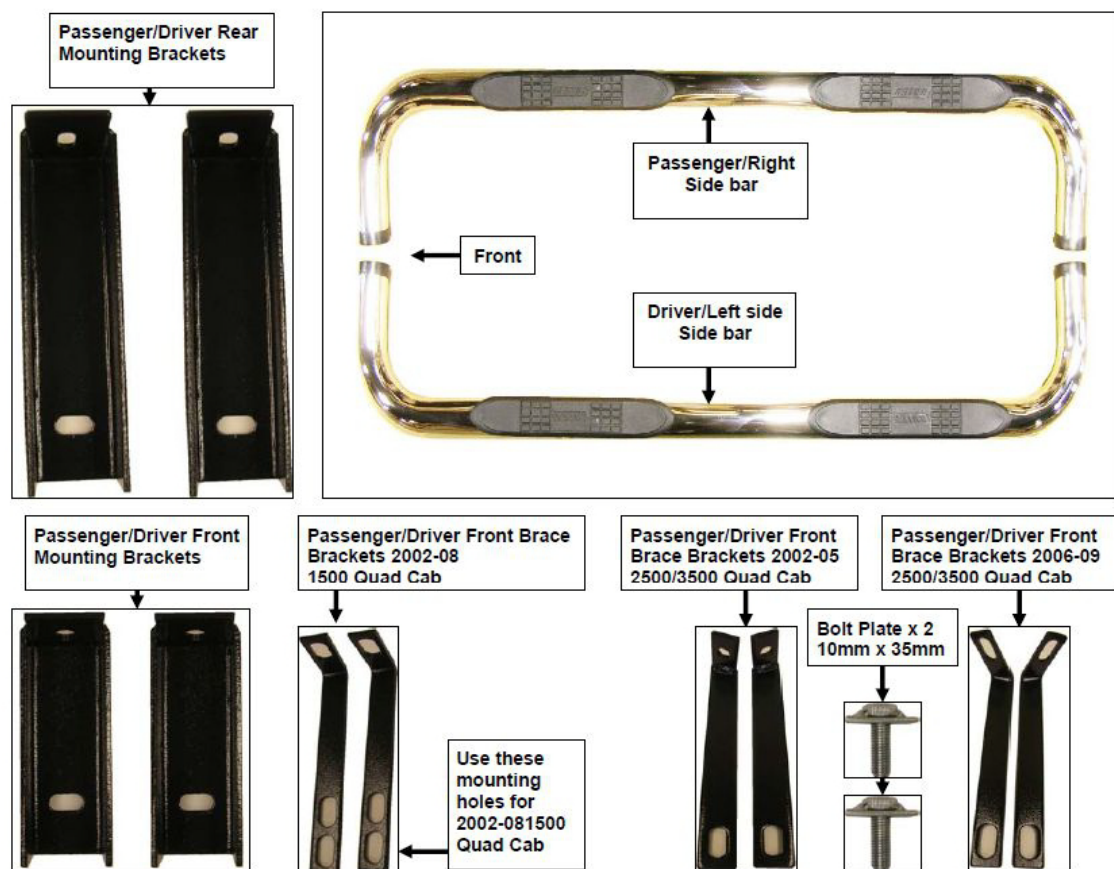

*DRIVER/LEFT SIDE INSTALLATION PICTURED*

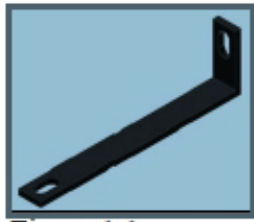

Figure 1.1 –  
1500 Front Brace



Figure 1.2  
2500/3500 Front Brace



Figure 1.2B  
2500/3500 Front Brace

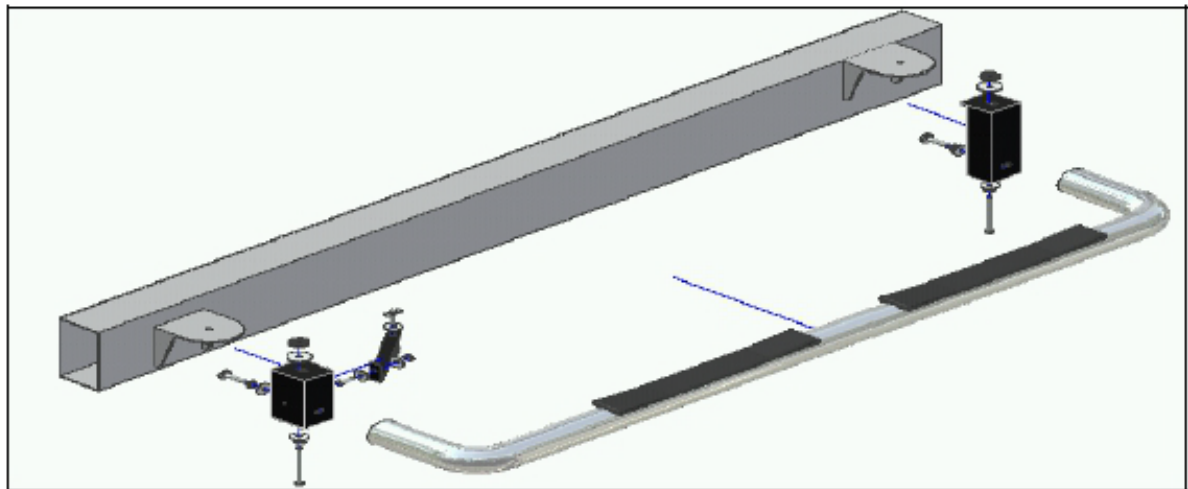

Figure 1.3 –Driver-Side Front Assembly View (2500/3500 Series set-up shown)

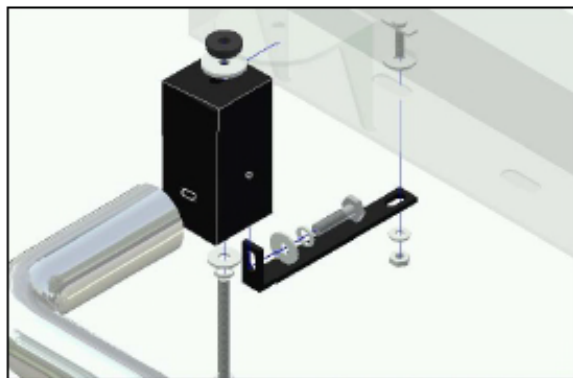

Figure 1.4 – 1500 Front Mount Assembly

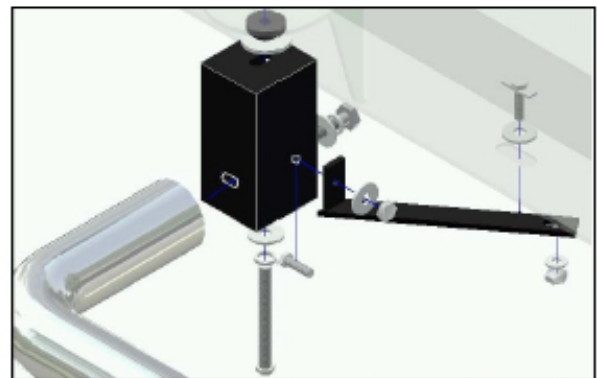

Figure 1.5 – 2500/3500 Front Mount Assembly

## #205013

2002-UP DODGE RAM STANDARD CAB 2DR 1500 & 2003-UP 2500/3500

### PARTS LIST

2- ARIES STEP BAR (1) DRIVER SIDE (1) PASSENGER SIDE  
2- FRONT MOUNTING BRACKETS: 3-WALL COLUMN  
2- REAR MOUNTING BRACKETS: LONG, 3-WALL COLUMN  
4- SUPPORT BRACKETS  
4- LONG HEX BOLTS; M12 X 120MM  
4- SHORT HEX BOLT; .” – 13 X 2”  
4- TAGGED BOLT PLATES; 3/8” - 16  
4- HEX BOLTS; 3/8” - 16 X 1.25”  
8- HEX NUTS; 3/8” – 16  
8- LARGE FLAT WASHERS; .”  
8- LARGE LOCK WASHERS; .”  
12- SMALL FLAT WASHERS; 3/8”  
8- SMALL LOCK WASHERS; 3/8”  
4- RING SPACERS; 1.88” O.D.  
4- PLASTIC RETAINER WASHERS

### INSTALLING NERF BARS

(1) BEFORE INSTALLING, REVIEW THE INSTRUCTIONS CAREFULLY. MAKE SURE YOU UNDERSTAND THE CONCEPT OF THE INSTALLATION. USE THE ILLUSTRATIONS AND PARTS LIST TO VERIFY THE PARTS INCLUDED. .

(2) UNDERNEATH THE ROCKER PANEL, LOCATE ALL THE L SHAPED TRUCK BODY BRACKETS NEEDED FOR THE INSTALLATION (SEE FIG. A). REMOVE THE ORIGINAL RETAINING BOLTS FROM THE BRACKETS, PUT ASIDE THE BOLTS AND KEEP THE RUBBER BUSHINGS (WITH THE WASHERS IF APPLICABLE) FOR A REINSTALLATION LATER.

(3) IDENTIFY THE FRONT MOUNTING BRACKETS (SHORT ONE) AND THE REAR MOUNTING BRACKET (LONG ONE). USE THE LONG (120MM) BOLTS TO ATTACH THE RUBBER BUSHINGS AND THE MOUNTING BRACKETS TO THE L SHAPED TRUCK BODY BRACKETS (HAVE THE SMALL WALL OF THE MOUNTING BRACKETS FACE UPWARD), APPLY THE 1.88” RING SPACERS BETWEEN THE BRUSHINGS AND MOUNTING BRACKETS (SEE FIG. A). HAND TIGHTEN THE BOLTS NOW. REPEAT ON OTHER SIDE.

(4) ON THE ROCKER PANEL ACROSS FROM THE MOUNTING BRACKET. LOCATE THE OPEN SLAT, INSERT THE BOLT PLATE AND ROTATE 90 DEGREES UNTIL THE PLATE IS VERTICAL, ATTACH THE PLASTIC RETAINER WASHER (SEE FIG.C). ATTACH THE SUPPORT BRACKET TO THE MOUNTING BRACKET AND TO THE BOLT PLATE USING THE SUPPLIES 3/8” HARDWARE (SEE FIG.C). HAND TIGHTEN THE BOLTS FOR NOW. REPEAT FOR ALL OTHER SUPPORT BRACKETS. REAR SUPPORT BRACKETS ARE FOR QUAD CAB ONLY. NOTE: THE SUPPORT BRACKETS WILL CONFORM INTO POSITION ONCE THE FINAL TIGHTENING IS APPLIED.

(5) IDENTIFY THE STEP BAR FOR THE DRIVER SIDE AND FOR THE PASSENGER SIDE. USE THE 2” BOLTS AND .” HARDWARE TO MOUNT THE TUBE ONTO THE MOUNTING BRACKETS (SEE FIG. A). LEVEL AND ALIGN THE BAR WITH THE FRONT EDGE OF THE ROCKER PANEL, THEN FIRMLY TIGHTEN ALL BOLTS AND NUTS. APPLY A PROPER TORQUE OF (600 FT-LBS FOR M12 AND 2” BOLT. 30FTLB FOR 3/8” BOLT) TO EACH BOLT TO INSURE PROPER INSTALLATION. REPEAT ON OTHER SIDE.

(6) CAREFULLY STEP ONTO THE TOP OS THE STEP BARS FOR THE FINAL INSPECTION

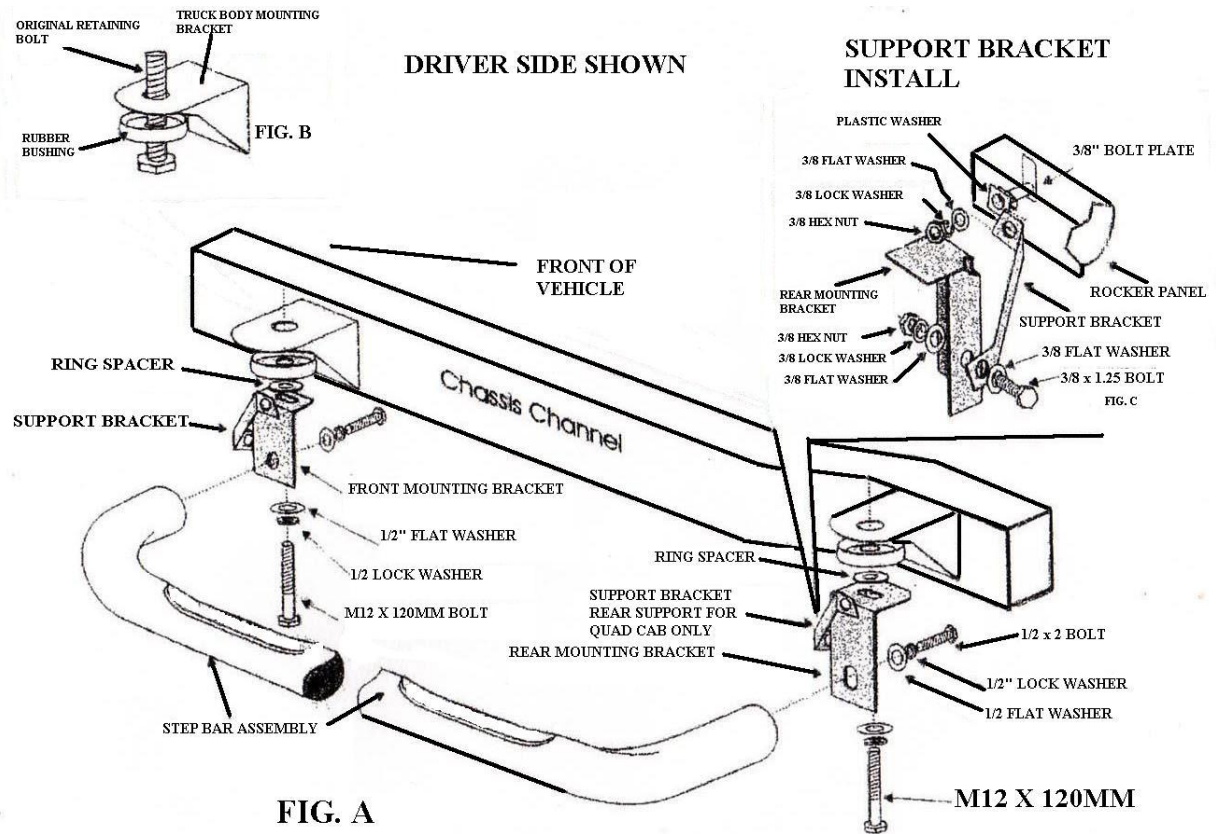

**CUSTOMER SERVICE/TECH. HELP – TOLL FREE (888) 800-ARIES**

**PARTS LIST**

- (2) SIDE TUBES WITH STEPS (16) M12 FLAT WASHER
- (2) FRONT MOUNT BRACKETS (16) M12 LOCK WASHER
- (2) REAR MOUNT BRACKETS (16) M10 FLAT WASHERS
- (2) FRONT BRACE BRACKETS (16) M10 LOCK WASHERS
- (2) CENTER BRACE BRACKETS (12) M10 HEX NUTS
- (4) M12 – 1.75 x 120mm HEX HEAD BOLT (2) M12 FLAT WASHERS (50mm O.D.)
- (4) M12X60mm HEX HEAD BOLT
- (2) M10X40mm HEX HEAD BOLT
- (2) M10x35mm HEX HEAD BOLT WITH METAL STRAP
- (2) M10X25mm HEX BOLTS
- (2) M10 BOLT PLATES

**PROCEDURE**

1. Begin installation by working on driver side of the vehicle (refer to Figures 1. 1- 1.5)
2. From underneath truck, loosen and remove body mount bolts that run upward through mounts into floorboard. Attach and secure Front Mount Bracket to underside of vehicles front body mount (see Figure 1.3), re-using isolator, but replacing factory bolt with (1) M12 – 1.75 x 120mm bolt, (1) 1/2" LOCK WASHER, and (1) M12 FLAT WASHER. Also,
3. Attach and secure Rear Mount Bracket to underside of vehicles rear body mount in same manner as the front.
4. Attach and secure Center Brace brackets. See Figure 1.3 to know where to install the Center Brace Brackets.

5. Attach Front Brace Bracket to side of Front Mount Bracket using (1) M10X40mm bolt, (2) M10 flat washers, and (1) M10 hex nut ,(1) lock washer (see Figure 1.5). Place (1) 3/8" x 1 ." bolt with welded strap and (1) M12 flat washer through cut out in frame rail. Line up slot on the long arm of the Brace Bracket with this bolt and secure using (1) M10 flat washer and (1) M10 lock nut,(1) lock washer. Hand tighten.

6. Attach Side Tube to Front and Rear Brackets using (1) M12 – 1.75 x 60mm HEX HEAD BOLT , (1) M12 split lock washer and (1) M12 flat washer for each bracket, and hand tighten. Torque M12 bolts first to

65 ft-lbs and then tighten all remaining fasteners to complete the driver-side assembly.

7. Repeat process for passenger side of vehicle to complete installation.

### 1500/2500HD/3500HD Front Brace

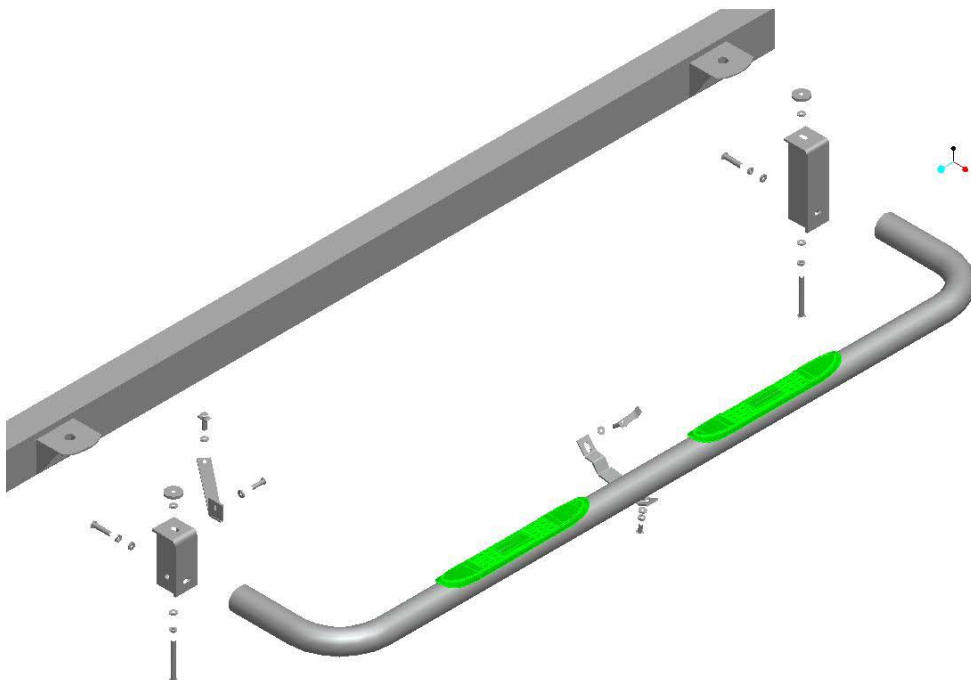

Figure 1.3 –Driver-Side Front Assembly View (1500/2500/3500 Series set-up shown)

