

GORRHINO 

JEEP® WRANGLER
JK | JL | JT GLADIATOR



BLAZE YOUR OWN
TRAIL 2019



It all started in 1975 with a dream and a goal; build the best accessories for trucks and Jeeps with the best mix of function and style. For drivers with passion and purpose, Go Rhino meets the challenge. Engineering unique products, Go Rhino can transform every trip into an adventure; from the beach to the mountains, from the store to off road destinations as far as you can go. Built with quality materials and workmanship to match, Go Rhino delivers the value and confidence to just say Blaze Your Own Trail and just **GO FOR IT.**



GO RHINO®

It comes down to three things we strive to get right every single time.

FIT.

Designed specifically to fit the contours of each Jeep®.

FUNCTION.

Functional, user-friendly. Designs that meet the distinctive needs of every Jeep® owner. Customize for maximum utility and appeal on the street, for on the trail and the everywhere in between.

STYLE.

Stand out with innovative engineering and timeless styling that makes a statement as unique as you.

**SO GO AHEAD. GO FOR IT.
GO RHINO.**



BLAZE YOUR OWN TRAIL



6-12 . . . ROCKLINE® BUMPERS

13 . . . SPARE TIRE RELOCATION KIT

14-19 . . . TRAILLINE® BUMPERS

20-21 . . . TIRE CARRIERS

22-35 . . . SIDE STEPS

36-37 . . . HITCH STEPS

38-45 . . . LIGHT MOUNTS

46-47 . . . WINDSHIELD LIGHT FRAMES

48-53 . . . ROOF RACKS KIT

54-57 . . . FENDERS

58 . . . JACK MOUNT

59 . . . EXHAUST TIPS

61-69 . . . APPLICATION GUIDE



ROCKLINE®





A Rockline® Front Stubby Bumper (Part #331101T)

B Rockline® Lower Skid Plate (Part #332110T)

C Rockline® Winch Fairlead Plate (Part #332000T)

D Hood Latch Light Mount (Part #730035T)

E Dominator D6 Side Steps (Part #D64506T)

F Windshield Cowl Light Mount (Part #730231T)

G Rockline® Stubby Rear Bumper (Part # 371100T)

H Hood Hinge Light Mount (Part #731060T)

I Hard Top Rear Light Mount (Part #599502T)



ROCKLINE® STUBBY FRONT WINCH BUMPER



Rockline® Stubby style front bumper is winch ready and designed for high clearance use (Available for JL and JK). There are no obstacles in your adventure with this tough yet compact full featured bumper. Whether your off-roading in steep rocky terrain and need a winch ready bumper and easy to reach patented (D790,408) Hook style D-Ring shackle mounts or just need some extra light mounts for your overlanding adventure, the Go Rhino Rockline® stubby is ready to meet those needs. Available with a center hoop for additional light mounting above the winch.

- Easy installation with no cutting or drilling
- Pre-slotted top mount area for winch (up to 12,000 lb capacity)
- Rockline® Bumper not rated for use with tow bars
- Constructed of 3/16" cold rolled steel
- Textured black powder coat finish
- 5 year limited warranty



Removable mesh frame

Signature rhino horn D-ring shackle mount (US Patent # D790,408)



Tubular center hoop with light mount area

Bumper only - Part #331100T
Bumper with welded 1.75" tubular center hoop - Part #331101T
Optional fairlead mount available (Sold separately) - Part #332000T
Optional lower steel skid plate (Sold separately) - Part #332100T



ROCKLINE® STUBBY FRONT WINCH BUMPER



- A** Rockline® Lower Skid Plate (Part #332100T)
- B** Rockline® Winch Fairlead Plate (Part #332000T)





ROCKLINE® FULL FRONT WINCH BUMPER



Rockline® Full front bumper is winch ready and designed for enhanced clearance use (Available for JL and JK). The side ends of the bumper are tapered upward to give extra tire clearance but still have same width as factory full fenders. There are no obstacles in your adventure with this tough full featured bumper. Whether your off-roading in steep trails and need a winch ready bumper and easy to reach patented (D790,408) Hook style D-Ring shackle mounts or just need some extra light mounts for your overlanding adventure, the Go Rhino Rockline® Full is ready to meet those needs. Available with a center hoop for additional light mount area above the winch.

- Easy installation with no cutting or drilling
- Pre-slotted top mount area for winch (up to 12,000 lb capacity)
- Rockline® Bumper not rated for use with tow bars
- Constructed of cold rolled steel
- Textured black powder coat finish
- 5 year limited warranty



Recessed light mount for 20" double row LED bar or four 3" cube LEDs

Removable mesh frame

Signature rhino horn D-ring shackle mount (US Patent # D790,408)



Tubular center hoop with light mount area

Bumper only - Part #331200T
Bumper with welded 1.75" tubular center hoop - Part #331201T
Optional fairlead mount available (Sold separately) - Part #332000T
Optional lower steel skid plate (Sold separately) - Part #332100T



ROCKLINE® FULL FRONT WINCH BUMPER



A Rockline® Lower Skid Plate (Part #332100T)

B Hood Latch Light Mount (Part #730035T) Lights not included



ROCKLINE® REAR BUMPER



The Rockline® rear bumper is a steel replacement bumper designed in two distinct styles. Rockline® Stubby style rear bumper is designed for high clearance use and ideal for weekend of road trails. Rockline® Full rear bumper replaces the limited function OE bumper with a full-width and wrap around design that offers extra protection for vehicle corner body panels (Available for JL and JK). The Go Rhino patented (D790,408) hook style D-ring shackle mounts allow the bumper to be used for quick recovery work while the drop center step helps with roof access-making this bumper the perfect choice for both rock crawling or overlanding.

- Easy installation with no cutting or drilling
- Patented rhino horn D-ring shackle mounts (US Patent #D790,408)
- Recessed light mount areas in bumper ends to protect 3" LED cube lights (Lights sold separately)
- Constructed of 3/16" cold rolled steel
- Textured black powder coat finish
- 5 Year limited warranty
- Bumper compatible with factory hitch receiver

ROCKLINE® STUBBY BUMPER

*Bumper - Part #371100T



ROCKLINE® FULL BUMPER

*Bumper - Part #371200T



Signature rhino horn D-ring shackle mount (US Patent # D790,408)

Drop center style bumper with step area, perfect for large tires

3" cube LED's can be mounted behind steal mesh covers

*JL Application Shown



SPARE TIRE RELOCATION KIT



Rear spare tire relocation bracket and accessory mount allows larger spare tires to be mounted on tailgate door without losing factory functionality. Accessories and trail tools like shovels and jacks can be mounted to side area of the bracket for the Wrangler (Available for JL and JK).

- Tire relocation bracket reuses factory tow hitch and raises spare tire up 2" and out 3", allowing use of larger tires
- Reuses factory backup camera and 3rd brake light (CHMSL)
- Easy installation with no cutting or drilling
- Textured black powder coat
- 5 year limited warranty

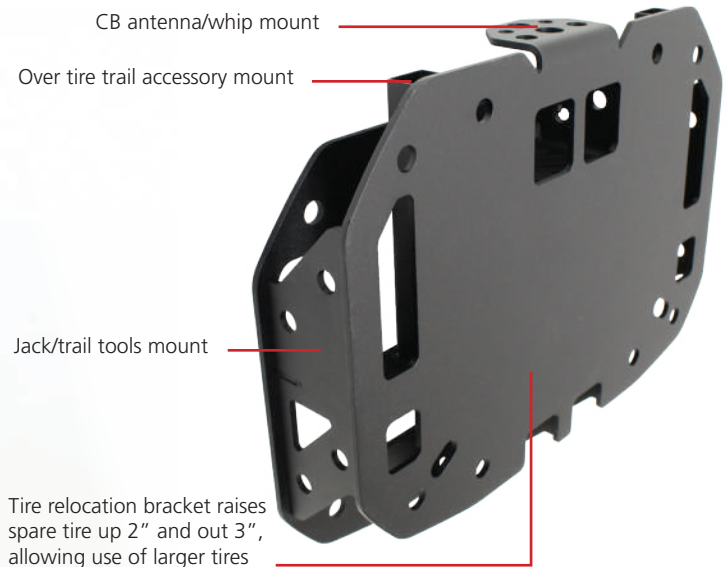

Part #372000T

TRAILLINE®





A Trailline® Front Winch Bumper
(Part #230121T)

B Hood Latch Light Mount
(Part #730035T)
Lights not included

C Windshield Cowl Mount
(Part #730231T)
Lights not included

D Dominator D1 Side Step
(Part #D14506T)



TRAILLINE® FRONT BUMPER

The Trailline® winch-ready front bumper is designed in 3 distinct styles to accommodate diverse adventures. The stubby bumper has an aggressive off road high clearance function for maximum tire clearance. The straight mid-width bumper is a perfect steel replacement for a factory width bumper. The full-width bumper ends lines up with factory fenders to fill out the front of the vehicle.



Features:

- 3 unique bumper styles with 3 optional light mount bar designs
- Grade 8 mounting fasteners coated in GEOMET Black for superior strength and corrosion resistance
- Fully welded 1" thick dual function patented rhino hook shackle mounts for up to 7/8" D-Ring pin (US Patent # D790,408)
- Front gear drawer with latch (optional locks for ignition keys available)
- Compatible with round factory lights
- Industry standard winch mounting slots, for up to 12,000 pound capacity winch, cut directly into the top surface
- Replaceable polymer rub plates help protect approach angle area of bumper
- CNC laser cut and formed 3/16" and 12 GA. thick steel and fully welded hand finished seams
- Textured black powder coat finish
- 5 year limited warranty

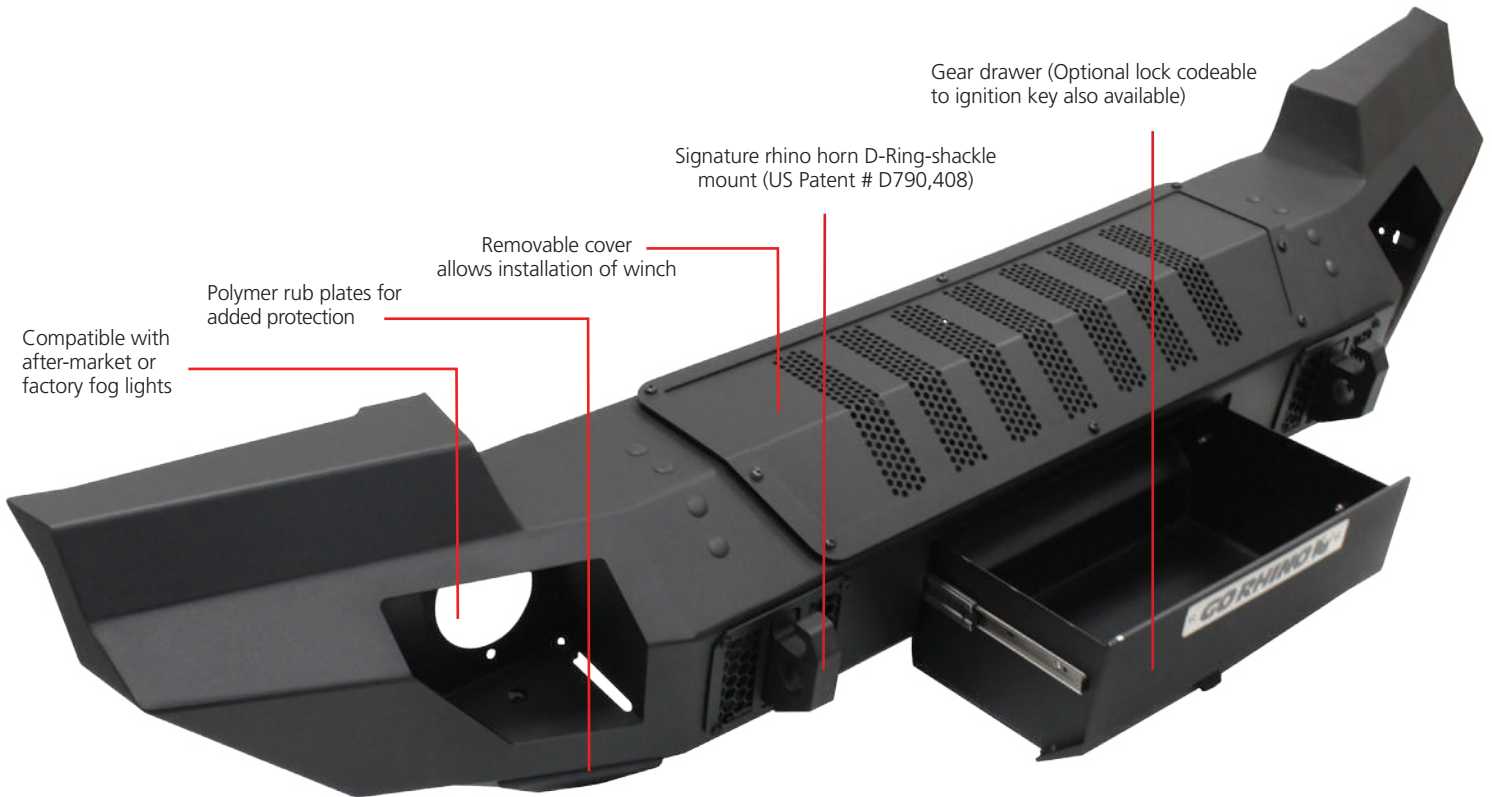



TRAILLINE® FRONT BUMPER



The Trailline® front winch bumper has 3 distinct styles, with something for everyone. The stubby bumper is an aggressive style made for maximum tire clearance, the straight bumper is most like the classic Jeep Wrangler look, and the full bumper fills out the front end and lines up with the stock fenders.

TRAILLINE® STUBBY BUMPER

Bumper - Part #230111T

High clearance end cap



Enhanced tire clearance

TRAILLINE® STRAIGHT BUMPER

Bumper - Part #230116T

End cap lines up with factory rear



TRAILLINE® FULL BUMPER

Bumper - Part #230121T





TRAILLINE® LIGHT MOUNT BARS



Add some more function and style to the Trailline® Front Bumper with the Trailline® series Light Mount Bars. 3 distinct styles offer multiple mounting points for lights above, below, or inside the light mount bar.



Trailline® 10
Light Mount Bar
Part #25101T



Trailline® 20
Light Mount Bar
Part #25102T



Trailline® 30
Light Mount Bar
Part #25103T

Light Plates for Straight and Full Bumpers

Optional light plates allow installation of 3" cube or 4" square LED lights in the Trailline® straight or full bumpers. Light plates are not necessary for LED light installation in stubby bumpers.

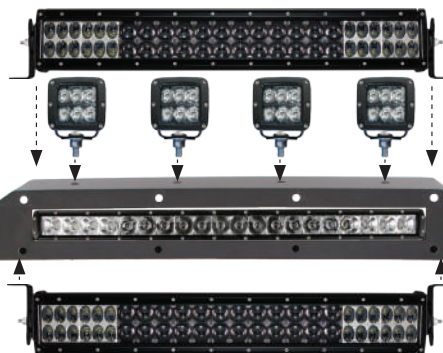

Trailline® Light Mount Bars

Mount up to 20" LED light bars above, below or inside light mount bars (10" max for Trailline 30). The top side also allows for installation of up to four 3" cube lights.

Compatible with aftermarket or factory fog lights

Light Mount Bar (US Patent # D757,316)



TRAILLINE® REAR BUMPERS

The Trailline® Rear Bumper complements the Trailline® front bumper with the same function and style for the Jeep Wrangler JK and JL.



Features:

- Fully welded 1" thick dual function patented rhino hook shackle mounts for up to 7/8" D-Ring pin (US Patent # D790,408)
- Allows for installation of SRQ or compatible flush-mount lights
- Bumper made from cold-rolled steel
- Compatible with factory hitch
- Provisions to add optional Go Rhino swing away tire carriers
- Grade 8 mounting fasteners coated in GEOMET Black for superior strength and corrosion resistance
- Drop center step for oversized tire clearance
- Texture black powder coat finish
- 5 year limited warranty

TRAILLINE® STUBBY REAR BUMPER

*Bumper - Part #27210T



TRAILLINE® STRAIGHT REAR BUMPER

*Bumper - Part #27215T



TRAILLINE® FULL REAR BUMPER

*Bumper - Part #27220T



Signature rhino horn D-ring shackle mount (US Patent # D790,408)

Drop center style bumper with step area, perfect for large tires

Mesh vent covers can be replaced with single row flush-mount lights

*JK Application Shown



TRAILLINE® LIFT ASSIST SWING AWAY TIRE CARRIER



Trailline lift assist swing away tire carrier is a back saving solution which allows JL and JK Wrangler owners with GR Rear bumpers to lower the spare tire with a provided hand crank or consumer provided cordless drill. The tire can be lowered or raised as needed without strain on the body. The added swing away feature makes it easy to access lift glass and tailgate as well. The Lift Assist Tire Carrier is perfect for use with larger and oversize tires and bolts onto Go Rhino Trailline® and Rockline® Rear Bumpers (sold separately).

Features:

- ◆ Bumper mounted lift assist swing away tire carrier comes paired up with choice of 3 Go Rhino rear bumper options
- ◆ Lift assist tire carrier mounts directly to bumper and swings away when needed
- ◆ Tire carrier can be raised or lowered with included hand crank or cordless drill
- ◆ Enclosed gears are protected from exterior elements
- ◆ Quick release pins allow ease of use when lowering tire or securing tire carrier when vehicle is moving
- ◆ Textured black powder coat finish
- ◆ 5 year limited warranty



Trailline® swing away tire carrier for tailgate hinges allows use with factory and aftermarket bumpers. The swing away feature makes it easy to access lift glass and tailgate as well. The Carrier is perfect for use with larger and oversize tires and bolts onto Go Rhino Trailline® and Rockline® Rear Bumpers (sold separately).

Features:

- Swing Away Tire Carrier allows for use with factory and aftermarket bumpers
- Swing Away Tire Carrier Tire Carrier mounts to factory tailgate hinges
- Tire carrier swings open with tailgate
- Textured black powder coat finish
- 5 year limited warranty

SIDE STEPS



A Dominator DS side step
(Part #DS4506T)

B RB20 Running Boards
(Part #69450568PC)

C Dominator D6 Side Steps with Drop Steps
(Part #D64505T, #D6410000T)

D WLF Windshield Light Frame
(Part #738300T)

E Hood Latch Light Mount
(Part #730035T)

F Windshield Cowl Light Mount
(Part #730066T)

G SRM100 Rack
(Part # 5916000T)



D

B

C



RB SERIES RUNNING BOARDS



Textured powder coat finish

RB10

Protective bedliner coating

RB10

Textured powder coat finish

RB20

Protective bedliner coating

RB20



RB SERIES RUNNING BOARDS



Go Rhino RB Series running boards give the Jeep® the latest raptor-inspired style and function; plus optional RB Series drop steps add style and function for Jeep® with larger wheels and tires or lifts.

FEATURES:

- ◆ Cab length running boards for 2 and 4 door Jeep®
- ◆ Sold in vehicle-specific sets. Includes mounting brackets for a simple, no-drill installation
- ◆ Constructed from galvanized steel for additional corrosion protection
- ◆ Available in two finishes: protective bedliner coating or textured powder coat for corrosion, impact and abrasion resistance
- ◆ Available with or without drop down steps
- ◆ 5 year limited warranty

RB SERIES DROP STEPS

OPTIONAL RB SERIES DROP STEPS

Optional 4" drop step (sold separately) is compatible with RB Series running boards and RB Series hitch step.



Part #6942000T

RB SERIES HITCH STEPS

FEATURES:

- ◆ Raptor-inspired style
- ◆ Fits 2" receivers
- ◆ Wide, secure step
- ◆ Complements the RB Series Running Boards



DOMINATOR





D

B

A Dominator D1 Side Step (Part #D14506T)

D Hood Latch Light Mount (Part #730035T)

B Rockline Full Front Bumper w/ override bar (Part #331201T)

E Windshield Cowl Light Mount (Part #730231T)

C Rockline Full Rear Bumper (Part #371200T)



DOMINATOR D6



Dominator D6 side steps allow for easy access in and out of the vehicle and provides slider protection along the rocker panel of vehicle. The step area is 6" wide and has a raised hex pattern for no slip grip. Optional bolt-on 4" drop steps are ideal for Jeep® Wranglers with lifts or larger wheels and tires.

FEATURES:

- ◆ Dual Purpose design and steel construction allows Dominator D6 to be used as a step and a rock slider
- ◆ Mounts tight to rocker panel for maximum ground clearance and protection
- ◆ Optional bolt-on 4" drop steps available for use with lifted vehicles and larger tires - sold in Pairs
- ◆ Punched steel step plate area has raised hex pattern to provide no slip grip
- ◆ Textured black powder coat finish
- ◆ 5 year limited warranty

Secure stepping Area

Punched step plate

4 door diagram shown
2 door models also available

67 3/4"

2 1/2"



DOMINATOR D6 HITCH STEP & DROP STEP

Dominator D6 hitch steps are available in Textured black powder coat finish with a 5-year warranty, and are compatible with 2" receiver hitches.

The Dominator D6 Drop Step accessory is perfect for all D6s installed on lifted or taller trucks.



Part #D6360T



Patented punched galvanized steel step pads for extra grip (US Patent # D717,708)

Part #D6410000T

DOMINATOR D6 SIDE STEPS





DOMINATOR DS



Dominator DS Sliders for Jeep® Wrangler with optional removable step pads that can be mounted in several positions along the length of the outer rub rail. Step has full length slider design on bottom surface. Removable steps can be positioned in several places between the outer run rail. Allows users to access raised vehicles more easily and provides rocker panel protection at the same time. No-drill brackets included.

FEATURES:

- Full length slider with outer rub rail and removable steel step pads
- Steel pads can be positioned in several locations along rub rail
- Great for high clearance use when step area is still needed
- Protects rocker panel from trail obstacles and road debris
- Easy Installation-No drilling required
- Uses OEM step and rock rail mount locations
- Textured black powder coat finish
- 5 year limited warranty



4 door diagram shown
2 door models also available



Dominator DSS Sliders W/ rub rail and optional full length step. Slider has full length slider design on bottom surface. Full length step area has raised steel surface for safe grip. Allows users to access raised vehicles more easily and provides rocker panel protection at the same time. No-drill brackets included.

FEATURES:

- ◆ Full length slider with outer rub rail and removable full length steel step
- ◆ Full length steel step can be removed
- ◆ Great for high clearance use when step area is still needed
- ◆ Protects rocker panel from trail obstacles and road debris
- ◆ Easy Installation-No drilling required
- ◆ Uses OEM step and rock rail mount locations
- ◆ Textured black powder coat finish
- ◆ 5 year limited warranty





DOMINATOR D1



Dominator D1 Side Steps with full length drop down steps and full length slider design on bottom surface. Allows users to access raised vehicles more easily and provides rocker panel protection at the same time. Full length step area has raised steel surface for safe grip and easy entry and exit.

FEATURES:

- ◆ Full length drop down step is 3 1/5" below outside edge of vehicle
- ◆ Provides sturdy full length step area for enhanced access
- ◆ Great for accessing vehicles with lift kits and oversize tires
- ◆ Protects rocker panel from trail obstacles and road debris
- ◆ Easy installation-no drilling required
- ◆ Uses OEM step and rock rail mount locations
- ◆ Textured black powder coat finish
- ◆ 5 Year Limited Warranty



4 door diagram shown
2 door models also
available

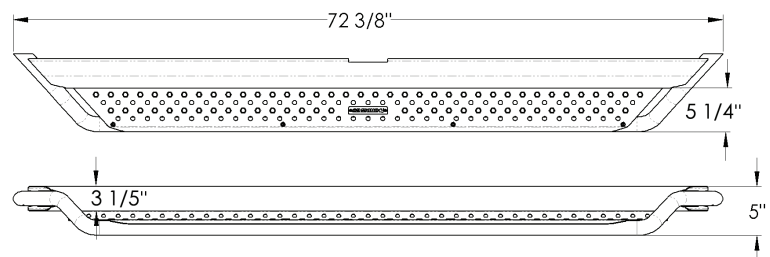



Go Rhino Dominator D2 hoop-step sidebars are available in cab length with welded hoop steps. Every Dominator features hoop-style drop steps to make entry and exit easy and deliver rugged style to any Jeep®. This classic hoop step design sits close to the body of the Jeep® to provide a wide, secure stepping point for entering and exiting a vehicle.

FEATURES:

- One-piece main bar made of fabricated steel
- Hoop steps on each side feature punched galvanized removable steel step pads for extra grip
- Easy, no-drill installation.
- Mounting brackets included
- Textured black powder coat (5 year limited warranty) or polished stainless finish (Limited lifetime warranty)

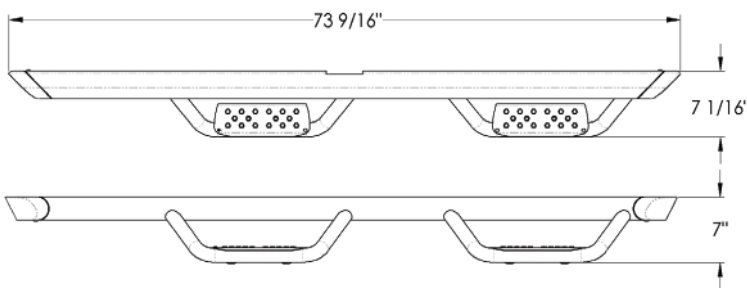

4 door diagram shown
2 door models also available



Patented punched galvanized steel step pads for extra grip (US Patent # D717,708)



1000 SERIES SIDE STEPS



Go Rhino 1000 Series side steps are built and designed for quality and value to dress up any Jeep®. These 4" and 5" wide oval side steps are OE-quality and available in polished stainless steel or textured black powder coat over galvanized steel for maximum corrosion resistance.

FEATURES:

- ◆ OE style side steps with OE quality construction
- ◆ Available in 4" and 5" styles
- ◆ Textured black powder coat (5 year limited warranty) or polished stainless steel finish (Limited lifetime warranty)
- ◆ Patent pending end caps are easily replaceable if damaged (US Patent # 9,511,716)
- ◆ Available for 2 door or 4 door applications





4000 SERIES SIDE STEPS



The Go Rhino 4000 Series Side Steps are crafted from massive 3" steel tubing and built tough enough for any punishment. These classic style steps help provide safe vehicle access and rocker protection.

FEATURES:

- ◆ 3" Round tube with a 15° bend on the front end
- ◆ High-traction composite step pads
- ◆ Simple, no-drill installation. Mounting brackets included
- ◆ Textured black powder coat, chrome (5 year limited warranty) or polished stainless steel finish (Limited lifetime warranty)
- ◆ Available for 2 door or 4 door applications

15° bend on the front end

High-traction composite step pads





HITCH STEPS

With unique designs Go Rhino Hitch Steps help ease the strain of climbing into your truck bed or loading cargo up to a roof rack while providing additional bumper protection.

Polished Stainless

Part No. D360PS

Textured Black

Part No. D360T

(Patent No. US D532,354 S)



DOMINATOR HITCH STEP

- ◆ Unique design provides a full-size 36" wide top step and a drop down lower step
- ◆ High-traction molded step pad on top, and galvanized step pad on lower step
- ◆ Heavy-duty steel construction for unmatched strength and durability
- ◆ Easily installed into standard 2" hitch receivers
- ◆ Includes hitch pin
- ◆ Includes anti-rattle device and convenient storage bag
- ◆ Textured black powder coat (5 year limited warranty) or polished stainless steel finish (Limited lifetime warranty)

Textured Black

Part No. D6360T



DOMINATOR D6 HITCH STEP

- ◆ D6 unique design with punched steel step area for extra grip
- ◆ 37" Wide, secure stepping platform
- ◆ Heavy-duty steel construction for unmatched strength and durability
- ◆ Easily installed into standard 2" hitch receivers
- ◆ Includes anti-rattle device and hitch pin
- ◆ Textured bedliner finish or black powder coat finish
- ◆ 5 year limited warranty

RB10

Hitch step - 34" wide

Protective Bedliner Coating

Part No. RB610T

Textured Powder Coat

Part No. RB610PC



RB10 & RB20 HITCH STEP

- ◆ Raptor-inspired style running board design
- ◆ Constructed from galvanized steel for additional corrosion protection
- ◆ Textured black powder coat or protective bedliner coating finish
- ◆ 5 year limited warranty
- ◆ Includes anti-rattle device and hitch pin
- ◆ Easily installed to 2" receiver

RB20

Hitch step - 34" wide

Protective Bedliner Coating

Part No. RB620T

Textured Powder Coat

Part No. RB620PC

HITCH STEP

- 2" Receiver step 36" wide
- 1-1/4" Receiver step 32" wide
- Built from heavy-duty 3" steel tubing
- Extra-wide, high-grip composite step pad
- Includes anti-rattle device and convenient storage bag
- Includes hitch pin
- Available in 1-1/4" or 2" hitch receivers
- Textured black powder coat (5-year limited warranty) or polished stainless steel finish (Limited lifetime warranty)

2" HITCH STEP

Chrome
Part No. 360C

Polished Stainless
Part No. 360PS

Textured Black
Part No. 360T



1 1/4" HITCH STEP

Black Powder Coat
Part No. 310B

Chrome
Part No. 310C

Polished Stainless
Part No. 310PS

RHINO STEP

- Provides a convenient standing spot when loading cargo
- Compact design measures 12" wide
- Heavy-duty 3" steel tubing
- High-traction perforated stainless steel step pad
- Easily installed into standard 2" hitch receivers
- Includes hitch pin
- Semi-gloss black powder coat (5 year limited warranty) or polished stainless steel finish (Limited lifetime warranty)



Black Powder Coat
Part No. 320B

Polished Stainless
Part No. 320PS

4" OVAL HITCH STEP

- Large 24" wide step
- High-traction molded step pad for sure footing
- Easily installed into standard 2" hitch receivers
- Anti-rattle shim included
- Semi-gloss black powder coat (5 year limited warranty) or polished stainless steel finish (Limited lifetime warranty)



Black Powder Coat
Part No. 460B

Polished Stainless
Part No. 460PS

XE SERIES LIGHT MOUNTS





JL XE SERIES LIGHT MOUNTS



Go Rhino Light mounts allow for installation of lights to the hood latch, hood hinges, center hood area, windshield cowl, or rear of hard top. Whether you are out for a weekend summer trip or overlanding all winter long, with longer nights these light mounts will help in lighting up your adventure. Corrosion resistant black geomet hardware included for easy installation.

◆ Hood Latch

These Wrangler JL and JLU hood latch pod style light mounts allow you to mount a 3" x 3" Cube LED Light on each Hood latch of your Jeep Wrangler JL for extra forward facing lighting. Lights not included.

◆ Hood Hinge

5 distinct hood hinge mounts for LED lights allows for a variety of Lights to be used for more forward facing lighting. Lights not included.

◆ Center Hood

These LED Light mounts replace the windshield bump stops and allow for a variety of LED light sizes to be mounted in the center area of hood. Windshield wiper nozzles are not affected by installation or use of the light mounts. Lights not included.

◆ Windshield Cowl

These Cowl mounted LED light mounts allow you to mount lights on each outer side of the windshield cowl of your Jeep Wrangler JL for extra forward facing lighting. Lights not included.

◆ Hard Top Rear

These hard top rear lift glass hood hinge light mounts allow you to mount up to two 3" x 3" cube LED lights or up to a 40" light bar on the rear of your Jeep Wrangler JL for extra rear facing lighting, perfect for trail rides and camping. Whether you are out for a weekend summer trip or overlanding all winter long, with longer nights these light mounts will help in lighting up your adventure.



XE SERIES LIGHT MOUNTS



E



Light Mount Locations

- A** Hood Latch
- B** Hood Hinge
- C** Center Hood
- D** Windshield Cowl
- E** Hard Top Rear



HOOD LATCH & HINGE LIGHT MOUNTS



HOOD LATCH

These Wrangler JL and JLU hood latch pod style light mounts allow you to mount a 3" x 3" Cube LED Light on each Hood latch of your Jeep Wrangler JL for extra forward facing lighting. Lights not included.



Hood Latch 3" Cube
Part #730035T
Sold in pairs

HOOD HINGE

5 distinct hood hinge mounts for LED lights allows for a variety of Lights to be used for more forward facing lighting. Lights not included.



Hood Hinge 30" Single Row - Part #731300T



Hood Hinge 20" Single Row - Part # 731200T



Hood Hinge Two 3" Cubes
Part # 731030T
Sold in pairs



Hood Hinge Two 3" Cubes Offset
Part # 731230T
Sold in pairs



Hood Hinge 6" Single Row Part
#731060T
Sold in pairs



CENTER HOOD LIGHT MOUNTS



CENTER HOOD

These LED Light mounts replace the windshield bump stops and allow for a variety of LED light sizes to be mounted in the center area of hood. Windshield wiper nozzles are not affected by installation or use of the light mounts. Lights not included.



Center Hood 10" Double Row
Part #732100T



Center Hood 10" Single Row
Part #732020T



Center Hood 20" Double Row
Part # 732200T



Center Hood 3" Cube
Part # 732230T
Sold in pairs



Center Hood Two 3" Cubes Offset
Part #732231T
Sold in pairs



Center Hood 20" Single Row
Part #732210T



Center Hood 6" Single Row
Part #732060T



WINDSHIELD COWL LIGHT MOUNTS



WINDSHIELD COWL

These Cowl mounted LED light mounts allow you to mount lights on each outer side of the windshield cowl of your Jeep Wrangler JL for extra forward facing lighting. Lights not included.



Windshield Cowl 3" Cube
Part # 730030T
Sold in pairs



Windshield Cowl Two 3" Cubes
Part #730230T
Sold in pairs



Windshield Cowl Two 3" Cubes
Offset Part #730231T
Sold in pairs



Windshield Cowl 6" Single
Row Part #730060T
Sold in pairs



Windshield Cowl 6" Square
Part #730066T
Sold in pairs

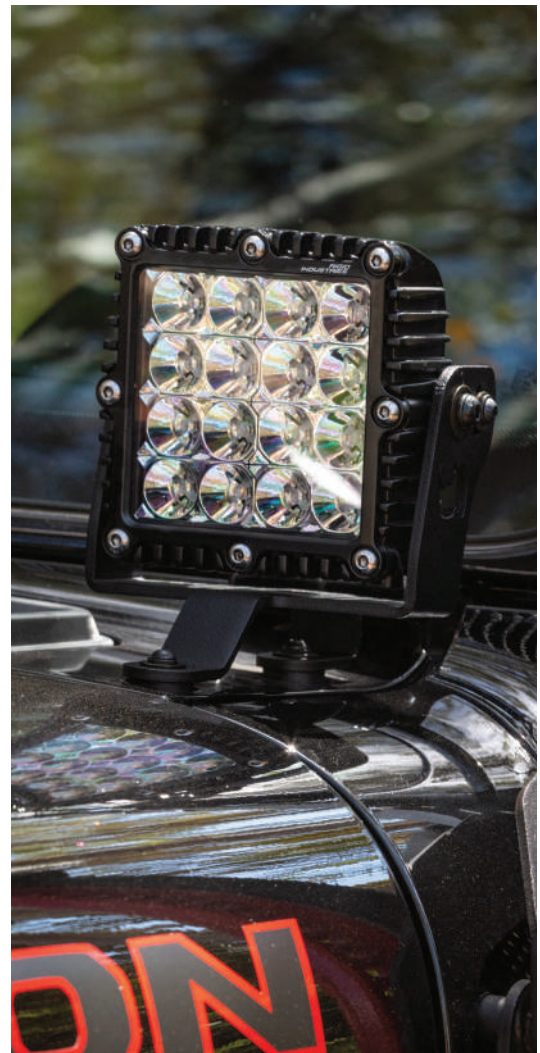



HARD TOP REAR LIGHT MOUNTS



HARD TOP REAR

Hard top rear lift glass hood hinge light mounts allow you to mount up to two 3" x 3" cube LED lights or up to a 40" light bar on the rear of your Jeep Wrangler JL for extra rear facing lighting making them ideal for trail rides and camping. Whether you are out for a weekend summer trip or overlanding all winter long, with longer nights these light mounts will help in lighting up your adventure.



Hard Top Rear Mount for 3" cube LED's Part #599502T
Sold in pairs



Hard Top Rear Mounts for 30", or 40" Light Bar Part #599501T
Sold in pairs





XE SERIES WINDSHIELD LIGHT FRAME



Light will never be a problem again with the XE Series Windshield Light Frame for the Jeep Wrangler JL. It allows the mounting of a 50" LED and light bar to the top of the windshield for superior lighting whenever it's required.



Features:

- Heavy duty uprights mount directly to A-pillar
- Low profile design increases stability
- Black geomet hardware
- Easy no-drill installation
- Textured black powder coat
- 5 year limited warranty



JEEP® WLF WINDSHIELD LIGHT FRAME

Part No. 738300T

Allows for installation of eight 3" cube lights



The Go Rhino WLF Windshield Light Frame for the 07-18 Jeep® JK Wrangler and JK Wrangler Unlimited offers a total lighting solution. Only Go Rhino allows you to choose from a broad range of lighting options both across the windshield and on the A-pillar with a product designed for strength, style, and full-frame protection.

Features:

- ◆ Heavy duty uprights mount directly to A-pillar
- ◆ 4 Different options protect a variety of lights and light bars
- ◆ Unique side-to-side lateral rack design increases stability and reduces vibration
- ◆ Exclusive vertical stacking tabs allow for additional lower lighting options
- ◆ Rubber-isolated mounting system
- ◆ Black geomet hardware
- ◆ Easy no-drill installation
- ◆ Textured black powder coat
- ◆ 5 year limited warranty



ROOF RACKS





A

E

A SRM100 48" Roof Rack
(Part #5914800T)

B Winch Front Stubby Bumper
(Part #331101T)

C Optional Winch Fairlead Plate
(Part #332000T)

D JL Hood Latch Light Mount
(Part #730035T)

E Windshield Cowl two 3" Cubes Offset
Mount (Part #730231T)

F Optional Lower Skid Plate
(Part #332100T)



SRM100 ROOF RACK

SRM100 roof rack shown on vehicle with cross bars and mounting brackets not included.



Go Rhino's SRM100 Series modular roof racks allows a whole new level of customization with optional light plates for virtually any vehicle. Both the front and rear face plates are replaceable with optional lighting arrays as well as optional side mounts for cube lights, making the possibilities virtually endless.

FEATURES:

- Available in 48", 60", and 72" options with classic straight design
- Multiple interchangeable front, rear, and side light plates for customization of light configurations (sold separately)
- Standard U-bolt mounting hardware included

- Stainless steel hardware
- Optional mounting kits available
- Textured black powder coat finish
- 5 year limited warranty

Note: Modular construction allows for parcel delivery

50" Light Bar Mounting Brackets
 Front - 5925001T
 Rear - 5925002T
 (sold separately)

Part No. 5914800T - **48" Rack**
 Part No. 5916000T - **60" Rack**
 Part No. 5917200T - **72" Rack**



Signature Go Rhino hexagonal mesh panel included

Side stability handle

Four Side Plate Set for 3" cube lights
 Part No. 5943003T
 (sold separately)



FRONT AND REAR LIGHT MOUNT PLATES



Shown with Six 6" Q-Style light plates Part numbers 5967001T and 5967002T shown (Light plates and lights sold separately)

SRM100 LIGHT MOUNT PLATES

Choose from a wide variety of optional light plates for the SRM100 Rack to get a truly custom rack. Seven different options for the front and rear as well as an option for side lighting allows anyone to dream up a custom rack that's only limited by their imagination.



Six 6" Q-Style Lights Front 5967001T | Rear - 5967002T

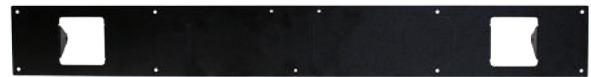

Two 3" Cubes Front - 5923001T | Rear - 5923002T



40" Light Bar Front - 5914001T | Rear - 5914002T



Four 3" Cubes Front - 5943001T | Rear - 5943002T



20" Light Bar & Two 3" Cubes
Front - 5912231T | Rear - 5912232T



Six 3" Cubes Front - 5963001T | Rear - 5963002T



Up to two 50" Light Bars
Front - 5925001T | Rear - 5925002T



Four 3" Cube lights
Part No. 5943003T



SRM RACK MOUNTING SYSTEMS



JL HARD TOP MOUNTING KIT

Hard top mount kits securely mount a Go Rhino SRM100 Rack over the roof of the Jeep Wrangler JL using factory rain rails. Proprietary design for use with SRM Rack eliminates need for cross bars. Clamp style design bolts directly to rain rails for an easy installation.

FEATURES:

- ◆ Clamps to factory rain rails
- ◆ No drill or cutting required
- ◆ Need for cross bars is eliminated providing low profile design
- ◆ Rubber gaskets protect hard top finish
- ◆ Geomet black hardware
- ◆ 5 year limited warranty



6 Bracket - Part #5910011T
4 Bracket - Part #5910010T

SRM RACK MOUNTING KITS

SRM Series Roof Rack Mounting Kits provide flexibility for mounting racks without the need for cross bars.

SRM Fixed Mounting Kit Part #5910001T

Features:

- ◆ Formed steel construction
- ◆ Textured black powder coat
- ◆ 5 year limited warranty
- ◆ Drilling required



SRM Multi-Axis Mounting Kit Part #5910000T

Features:

- ◆ Patent pending, secure, self-sealing mounting system
- ◆ Formed steel construction
- ◆ Textured black powder coat
- ◆ 5 year limited warranty
- ◆ Drilling required





OVERLAND RACKS FOR 2DR AND 4DR JEEP JK WRANGLER

Customize your adventure with the Go Rhino Overhead Overland Rack system. Overland Rack system combines overhead cargo management with front facing lighting options and rear taillight protection.

Overland Racks come complete with Go Rhino Windshield Light Frames and protective steel rear taillight covers. Overland Racks mount to windshield light frame in front and use taillight area to mount in rear of vehicle. Body to body mounting design improves load displacement integrity and makes for quieter driving and wheeling.

Mainframe is constructed of thick tubular steel and finished in a tough durable Textured black powder coating. Adjustable cross bars attach to steel C channel so cargo racks, tents, and gear boxes can be positioned as needed.

Go Rhino Overhead Overland racks require Go Rhino Windshield Light Frames to install and are sold complete with the WLF or without. Choose from 4 windshield light frames with 4 different lighting variations:

- 2 Door JK Wrangler Part #5992000T
- 4 Door JK Wrangler Unlimited Part #5994000T
- 4 Door JK Wrangler Unlimited with WLF mounting one 50" LED Light bar: Part #59941500T
- 4 Door JK Wrangler Unlimited with WLF mounting eight 3" cube lights: Part #59948300T
- 4 Door JK Wrangler Unlimited with WLF mounting four 3" cube lights and one 30" LED Light bar: Part #59941343T
- 4 Door JK Wrangler Unlimited with WLF mounting two 3" cube lights and one 40" LED Light bar: Part #59941423T
- 2 Door JK Wrangler with WLF mounting one 50" LED Light bar: Part #59921500T
- 2 Door JK Wrangler with WLF mounting eight 3" cube lights: Part #9928300T
- 2 Door JK Wrangler with WLF mounting four 3" cube lights and one 30" LED Light bar: Part #59921343T
- 2 Door JK Wrangler with WLF mounting two 3" cube lights and one 40" LED Light bar: Part #59921423T



The Trailline® fenders are stylish, high-angled steel fenders that come in two widths to enhance any JK adventure. The Trailline® fenders help increase tire clearance and articulation while increasing vehicle body protection. Fenders are constructed of steel with textured black powder coat finish. The unique smooth underside helps prevent mud and debris from accumulating in the wheel well. Easy Installation and fits perfectly with Go Rhino Inner Fender Liners- sold separately.

Features:

- Allows for the use of factory turn signal lenses
- Trailline® Series features unique curved design available in 3" and 6" widths
- Increases tire clearance while adding unique style
- Textured Black Powder coat finish
- 5 year limited warranty
- Trailline® Steel Fenders sold in pairs of front and pairs of rear fenders





ROADLINE® FENDERS



Roadline® steel fenders bring the classic flat-top design to enhance any JK or JL adventure and come in three widths. The Roadline® fenders help increase tire clearance and articulation while increasing vehicle body protection. Fenders are constructed of steel with textured black powder coat finish. The unique smooth underside helps prevent mud and debris from accumulating in the wheel well. Easy Installation and fits perfectly with Go Rhino Inner Fender Liners- sold separately.

Features:

- Stylish flat-top design
- Amber lens included for side marker light
- Increases tire clearance while adding unique style
- Textured Black Powder coat finish
- 5 year limited warranty
- Roadline® Steel Fenders sold in pairs of front and pairs of rear fenders

Front Roadline Fender



Rear Roadline Fender



Roadline Fender Width

Features multi-dimensional design in 3", 6" and 9" widths for front and 3 and 6" widths for rear





Rockline® steel fenders come in two widths to add an aggressive, off-road look to the Jeep Wrangler JL. The Rockline® fenders help increase tire clearance and articulation while increasing vehicle body protection. Fenders are constructed of steel with textured black powder coat finish. The unique smooth underside helps prevent mud and debris from accumulating in the wheel well. Easy Installation and fits perfectly with Go Rhino Inner Fender Liners sold separately.

Features:

- Adds style and function to JL Wranglers plus added body protection
- Allows for the use of factory turn signal
- Rockline® Series features unique curved design available in 3" and 6" widths for JL Wranglers for more tire clearance
- Increases tire clearance while adding unique style to JL Wranglers
- Jeep® JL Wrangler Steel Fenders sold in pairs of front and pairs of rear fenders
- Features multi-dimensional design in 3", 6" and 9" widths for front and 3 and 6" widths for rear
- Textured Black Powder coat finish
- 5 year limited warranty



INNER FENDER LINERS



Go Rhino Jeep Wrangler inner fender liners are custom formed and offer a finished look for wheel wells with enhanced protection for vehicle. Go Rhino liners help protect vehicle from rocks and debris inside the wheel well when driving on or off road. The liners are made of formed aluminum with a Textured black powder coat finish. They are sold in pairs. Front Inner fender liners feature a 2 piece design with a mesh vent to allow airflow to engine. Rear inner fender liners are 1 piece construction and form fit to vehicle. Front and Rear sets sold separately.

Features:

- Wheel well inner fender liners help provide enhanced protection for wheel wells, suspension and engine.
- Two-piece design allows for easy installation for front inner liners
- One-piece design allows for easy installation for rear inner liners
- Front Liners feature hex mesh vents to allow airflow to engine
- Helps protect inside of wheel wells and engine from rocks and debris
- Aluminum construction with Textured black powder coated finish
- Ships UPS or FedEx at standard rates-not oversize
- Go Rhino Inner Fender Liners are compatible with all Go Rhino Steel Fenders
- Textured Black Powder coat finish
- 5 year limited warranty



It is essential to have a tall jack mount when wheeling in a Jeep® Wrangler or if larger tires and lift kits are installed on the vehicle. The exterior jack mount from Go Rhino provides a convenient exterior mounting solution for these jacks. Mounting the jack on the exterior of the vehicle is crucial to having it ready at hand and also to free up precious cargo space inside the Jeep®.

Features:

- Exclusive triangular design and three point mounting system to eliminate rattling against the body of vehicle.
- Fits any height farm style tall jacks including major name brands.
- Exterior mounting frees up precious cargo space inside vehicle
- Strong Steel Construction
- No Drill Install uses factory side step mounts on lower rocker and cowl mounts on upper section
- Textured black powder coat
- 5 year limited warranty





CHROME

- Streamline, single wall design, rolled edge
- Stainless Steel Torca Accuseal™ clamp included
- Chrome over stainless steel
- Limited lifetime warranty



BLACK CHROME

- Streamline, single wall design, rolled edge
- Stainless Steel Torca Accuseal™ clamp included
- Black Chrome over stainless steel
- Limited lifetime warranty



BLACK TEXTURED

- Streamline, single wall design, rolled edge
- Stainless Steel Torca Accuseal™ clamp included
- Textured black powder coat
- Limited lifetime warranty



FAST STYLE

- New fast style design, double wall construction
- Stainless Steel Torca Accuseal™ clamp included
- Textured black powder coat
- Limited lifetime warranty



PRODUCT APPLICATION GUIDE

APPLICATION GUIDE

DESCRIPTION	YEAR	DOORS	JK	JL	PART NO.
BUMPERS					
ROCKLINE® FRONT BUMPER					
Rockline® Stubby Front Bumper	07-19	2 / 4	X	X	331100T
Rockline® Stubby Front Bumper w/ Override Bar	07-19	2 / 4	X	X	331101T
Rockline® Full Front Bumper	07-19	2 / 4	X	X	331200T
Rockline® Full Front Bumper w/ Override Bar	07-19	2 / 4	X	X	331201T
Rockline® Front Bumper Skid Plate	18-19	2 / 4		X	332100T
Rockline® Front Bumper Skid Plate	07-18	2 / 4	X		332110T
Rockline® Front Bumper Winch Fairlead Mount	18-19	2 / 4	X	X	332000T
Rockline® Front Bumper Winch Fairlead Mount	07-18	2 / 4	X		332010T
ROCKLINE® REAR BUMPER					
Rockline® Stubby Rear Bumper	18-19	2 / 4		X	371100T
Rockline® Full Rear Bumper	18-19	2 / 4		X	371200T
Rockline® Stubby Rear Bumper	07-18	2 / 4	X		371110T
Rockline® Full Rear Bumper	07-18	2 / 4	X		371210T
Spare Tire Relocation Kit	18-19	2 / 4		X	372000T
Spare Tire Relocation Kit	07-18	2 / 4	X		372003T
TRAILLINE® FRONT BUMPER					
Trailline® Stubby Front Bumper	07-19	2 / 4	X	X	230111T
Trailline® Straight Front Bumper	07-19	2 / 4	X	X	230116T
Trailline® Full Front Bumper	07-19	2 / 4	X	X	230121T
Trailline® 10 Light Mount Bar	07-19	2 / 4	X	X	25101T
Trailline® 20 Light Mount Bar	07-19	2 / 4	X	X	25102T
Trailline® 30 Light Mount Bar	07-19	2 / 4	X	X	25103T
Trailline® Front Bumper Winch Fairlead Mount	07-19	2 / 4	X	X	23200T
Front Light Plate for 3" Cube Lights (For Straight or Full Bumpers)	07-19	2 / 4	X	X	241742T
Front Light Plate for 4" Square Lights (For Straight or Full Bumpers)	07-19	2 / 4	X	X	241743T
Codeable Lock for Trailline® Front Gear Drawer	07-18	2 / 4	X		230100
Codeable Lock for Trailline® Front Gear Drawer	18-19	2 / 4		X	230105
TRAILLINE® REAR BUMPER					
Trailline® Stubby Rear Bumper	18-19	2 / 4		X	272110T
Trailline® Straight Rear Bumper	18-19	2 / 4		X	272115T
Trailline® Full Rear Bumper	18-19	2 / 4		X	272120T
Trailline® Stubby Rear Bumper	07-18	2 / 4	X		27210T
Trailline® Straight Rear Bumper	07-18	2 / 4	X		27215T
Trailline® Full Rear Bumper	07-18	2 / 4	X		27220T
TRAILLINE® SPARE TIRE CARRIER + LIFT ASSIST					
Trailline® Lift Assist Spare Tire Carrier	18-19	2 / 4		X	27135T
Trailline® Swing Away Spare Tire Carrier	18-19	2 / 4		X	27136T
Trailline® Lift Assist Spare Tire Carrier	07-18	2 / 4	X		27130T
Trailline® Swing Away Spare Tire Carrier	07-18	2 / 4	X		27131T
SIDE STEPS					
RB10 RUNNING BOARDS					
RB10 Running Boards (Protective Bedliner Coating)	18-19	4		X	63450673T
RB10 Running Boards (Protective Bedliner Coating)	18-19	2		X	63492748T
RB10 Running Boards (Textured Powder Coat)	18-19	4		X	63450673PC

APPLICATION GUIDE

DESCRIPTION

YEAR DOORS JK JL PART NO.

SIDE STEPS

RB10 RUNNING BOARDS

RB10 Running Boards (Textured Powder Coat)	18-19	2		X	63492748PC
RB10 Running Boards (Protective Bedliner Coating)	07-18	4	X		63450568T
RB10 Running Boards (Textured Powder Coat)	07-18	4	X		63450568PC
RB10 Running Boards (Protective Bedliner Coating)	07-18	2	X		63492648T
RB10 Running Boards (Textured Powder Coat)	07-18	2	X		63492648PC
RB10 Running Boards & 2 pairs of RB10 Drop Steps (Protective Bedliner Coating)	18-19	4		X	6345067320T
RB10 Running Boards & 1 Pair of RB10 Drop Steps (Protective Bedliner Coating)	18-19	2		X	6349274810T
RB10 Running Boards & 2 pairs of RB10 Drop Steps (Textured Powder Coat)	18-19	4		X	6345067320PC
RB10 Running Boards & 1 Pair of RB10 Drop Steps (Textured Powder Coat)	18-19	2		X	6349274810PC
RB10 Running Boards & 2 pairs of RB10 Drop Steps (Protective Bedliner Coating)	07-18	4	X		6345056820T
RB10 Running Boards & 1 Pair of RB10 Drop Steps (Protective Bedliner Coating)	07-18	2	X		6349264810T
RB10 Running Boards & 2 pairs of RB10 Drop Steps (Textured Powder Coat)	07-18	4	X		6345056820PC
RB10 Running Boards & 1 Pair of RB10 Drop Steps (Textured Powder Coat)	07-18	2	X		6349264810PC
Pair of RB Series Drop Steps (Protective Bedliner Coating)	07-19	2 / 4	X	X	69420000T
Pair of RB Series Drop Steps (Textured Powder Coat)	07-19	2 / 4	X	X	69420000PC

RB20 RUNNING BOARDS

RB20 Running Boards (Protective Bedliner Coating)	18-19	4		X	69450673T
RB20 Running Boards (Protective Bedliner Coating)	18-19	2		X	69492748T
RB20 Running Boards (Textured Powder Coat)	18-19	4		X	69450673PC
RB20 Running Boards (Textured Powder Coat)	18-19	2		X	69492748PC
RB20 Running Boards (Protective Bedliner Coating)	07-18	4	X		69450568T
RB20 Running Boards (Protective Bedliner Coating)	07-18	2	X		69492648T
RB20 Running Boards (Textured Powder Coat)	07-18	4	X		69450568PC
RB20 Running Boards (Textured Powder Coat)	07-18	2	X		69492648PC
RB20 Running Boards & 2 pairs of RB20 Drop Steps (Protective Bedliner Coating)	18-19	4		X	6945067320T
RB20 Running Boards & 1 Pair of RB20 Drop Steps (Protective Bedliner Coating)	18-19	2		X	6949274810T
RB20 Running Boards & 2 pairs of RB20 Drop Steps (Textured Powder Coat)	18-19	4		X	6945067320PC
RB20 Running Boards & 1 Pair of RB20 Drop Steps (Textured Powder Coat)	18-19	2		X	6949274810PC
RB20 Running Boards & 2 pairs of RB20 Drop Steps (Protective Bedliner Coating)	07-18	4	X		6945056820T
RB20 Running Boards & 1 Pair of RB20 Drop Steps (Protective Bedliner Coating)	07-18	2	X		6949264810T
RB20 Running Boards & 2 pairs of RB20 Drop Steps (Textured Powder Coat)	07-18	4	X		6945056820PC
RB20 Running Boards & 1 Pair of RB20 Drop Steps (Textured Powder Coat)	07-18	2	X		6949264810PC
Pair of RB Series Drop Steps (Protective Bedliner Coating)	07-19	2 / 4	X	X	69420000T
Pair of RB Series Drop Steps (Textured Powder Coat)	07-19	2 / 4	X	X	69420000PC

DOMINATOR SIDE STEPS

Dominator DS Side Steps	18-19	4		X	DS4506T
Dominator DS Side Steps	18-19	2		X	DS4927T
Dominator DS Side Steps	07-18	4	X		DS4505T
Dominator DS Side Steps	07-18	2	X		DS4926T
Dominator DSS Side Steps	18-19	4		X	DSS4506T
Dominator DSS Side Steps	18-19	2		X	DSS4927T
Dominator DSS Side Steps	07-18	4	X		DSS4505T
Dominator DSS Side Steps	07-18	2	X		DSS4926T
Dominator D1 Side Steps	18-19	4		X	D14506T

APPLICATION GUIDE

DESCRIPTION	YEAR	DOORS	JK	JL	PART NO.
DOMINATOR SIDE STEPS					
Dominator D1 Side Steps	18-19	2		X	D14927T
Dominator D1 Side Steps	07-18	4	X		D14505T
Dominator D1 Side Steps	07-18	2	X		D14926T
Dominator D2 Side Steps (Textured Black)	18-19	4		X	D24506T
Dominator D2 Side Steps (Textured Black)	18-19	2		X	D24927T
Dominator D2 Side Steps (Textured Black)	07-18	4	X		D24505T
Dominator D2 Side Steps (Polished Stainless)	07-18	4	X		D24505PS
Dominator D2 Side Steps (Textured Black)	07-18	2	X		D24926T
Dominator D2 Side Steps (Polished Stainless)	07-18	2	X		D24926PS
Dominator D6 Side Steps	18-19	4		X	D64506T
Dominator D6 Side Steps	18-19	2		X	D64927T
Dominator D6 Side Steps	07-18	4	X		D64505T
Dominator D6 Side Steps	07-18	2	X		D64926T
Pair of Dominator D6 Hoop Steps	07-19	2 / 4	X	X	D6410000T
1000 SERIES SIDE STEPS					
4" 1000 Series Side Steps (Textured Black)	18-19	4		X	104450673T
4" 1000 Series Side Steps (Polished Stainless)	18-19	4		X	104450673PS
5" 1000 Series Side Steps (Textured Black)	18-19	4		X	105450673T
5" 1000 Series Side Steps (Polished Stainless)	18-19	4		X	105450673PS
4" 1000 Series Side Steps (Textured Black)	07-18	4	X		104450573T
4" 1000 Series Side Steps (Polished Stainless)	07-18	4	X		104450573PS
5" 1000 Series Side Steps (Textured Black)	07-18	4	X		105450573T
5" 1000 Series Side Steps (Polished Stainless)	07-18	4	X		105450573PS
4000 SERIES SIDE STEPS					
4000 Series Side Steps (Textured Black)	18-19	4		X	4506T
4000 Series Side Steps (Black Powder Coat)	18-19	4		X	4506B
4000 Series Side Steps (Polished Stainless)	18-19	4		X	4506PS
4000 Series Side Steps (Chrome)	18-19	4		X	4506C
4000 Series Side Steps (Textured Black)	18-19	2		X	4927T
4000 Series Side Steps (Black Powder Coat)	18-19	2		X	4927B
4000 Series Side Steps (Polished Stainless)	18-19	2		X	4927PS
4000 Series Side Steps (Chrome)	18-19	2		X	4927C
4000 Series Side Steps (Textured Black)	07-18	4	X		4924T
4000 Series Side Steps (Black Powder Coat)	07-18	4	X		4924B
4000 Series Side Steps (Polished Stainless)	07-18	4	X		4924PS
4000 Series Side Steps (Chrome)	07-18	4	X		4924C
4000 Series Side Steps (Textured Black)	07-18	2	X		4926T
4000 Series Side Steps (Black Powder Coat)	07-18	2	X		4924B
4000 Series Side Steps (Polished Stainless)	07-18	2	X		4926PS
4000 Series Side Steps (Chrome)	07-18	2	X		4926C
HITCH STEPS					
RB10 Hitch Step - (Protective Bedliner Coating)	07-19	2 / 4	X	X	RB610T
RB10 Hitch Step (Textured Powder Coat)	07-19	2 / 4	X	X	RB610PC
RB20 Hitch Step - (Protective Bedliner Coating)	07-19	2 / 4	X	X	RB620T
RB20 Hitch Step (Textured Powder Coat)	07-19	2 / 4	X	X	RB620PC
RB20 Hitch Step - (Protective Bedliner Coating)	07-19	2 / 4	X	X	RB620T

APPLICATION GUIDE

DESCRIPTION	YEAR	DOORS	JK	JL	PART NO.
HITCH STEPS					
RB20 Hitch Step (Textured Powder Coat)	07-19	2 / 4	X	X	RB620PC
Dominator Hitch Step – Stainless	07-19	2 / 4	X	X	D360PS
Dominator Hitch Step – Textured	07-19	2 / 4	X	X	D360T
Dominator D6 Hitch Step	07-19	2 / 4	X	X	D6360T
GO RHINO! Step – Black	07-19	2 / 4	X	X	320B
GO RHINO! Step – Stainless	07-19	2 / 4	X	X	320PS
RHINO! Hitch Step – 1 1/4" Receivers – Black	07-19	2 / 4	X	X	310B
RHINO! Hitch Step – 1 1/4" Receivers – Chrome	07-19	2 / 4	X	X	310C
RHINO! Hitch Step – 1 1/4" Receivers – Stainless	07-19	2 / 4	X	X	310PS
RHINO! Hitch Step – 2" Receivers – Chrome	07-19	2 / 4	X	X	360C
RHINO! Hitch Step – 2" Receivers – Stainless	07-19	2 / 4	X	X	360PS
RHINO! Hitch Step – 2" Receivers – Textured	07-19	2 / 4	X	X	360T
4" Oval Hitch Step – Black	07-19	2 / 4	X	X	460B
4" Oval Hitch Step – Stainless	07-19	2 / 4	X	X	460PS
LIGHT MOUNTS					
XE SERIES LIGHT MOUNTS JK					
Hood Hinge Light Mounts - 20" Single Row	07-18	2 / 4	X		721200T
Hood Hinge Light Mounts - 30" Single Row	07-18	2 / 4	X		721300T
Hood Hinge Light Mounts - 6" Single Row	07-18	2 / 4	X		721060T
Hood Hinge Light Mounts - Two 3" Cubes	07-18	2 / 4	X		721030T
Hood Hinge Light Mounts - Two 3" Cubes Offset	07-18	2 / 4	X		721230T
Windshield Cowl Light Mounts - 3" Cube	07-18	2 / 4	X		720030T
Windshield Cowl Light Mounts - Two 3" Cubes	07-18	2 / 4	X		720230T
Windshield Cowl Light Mounts - Two 3" Cubes Offset	07-18	2 / 4	X		720231T
Windshield Cowl Light Mounts - 6" Single Row	07-18	2 / 4	X		720060T
Windshield Cowl Light Mounts - 6" Square	07-18	2 / 4	X		720066T
Center Hood Light Mounts - 10" Double Row	07-18	2 / 4	X		722100T
Center Hood Light Mounts - 10" Single Row	07-18	2 / 4	X		722020T
Center Hood Light Mounts - 20" Double Row	07-18	2 / 4	X		722200T
Center Hood Light Mounts - 20" Single Row	07-18	2 / 4	X		722210T
Center Hood Light Mounts - 6" Single Row	07-18	2 / 4	X		722060T
Center Hood Light Mounts - 3" Cube	07-18	2 / 4	X		722230T
Center Hood Light Mounts - Two 3" Cubes Offset	07-18	2 / 4	X		722231T
Hood Latch Light Mounts - 3" Cube	07-18	2 / 4	X		720035T
Hard Top Rear Light Mounts - Two 3" Cubes	07-18	2 / 4	X		599402T
Hard Top Rear Light Mounts - 20", 30", or 40" Light Bar	07-18	2 / 4	X		599401T
XE SERIES LIGHT MOUNTS JL					
Hood Hinge Light Mounts - 20" Single Row	18-19	2 / 4		X	731200T
Hood Hinge Light Mounts - 30" Single Row	18-19	2 / 4		X	731300T
Hood Hinge Light Mounts - 6" Single Row	18-19	2 / 4		X	731060T
Hood Hinge Light Mounts - Two 3" Cubes	18-19	2 / 4		X	731030T
Hood Hinge Light Mounts - Two 3" Cubes Offset	18-19	2 / 4		X	731230T
Windshield Cowl Light Mounts - 3" Cube	18-19	2 / 4		X	730030T
Windshield Cowl Light Mounts - Two 3" Cubes	18-19	2 / 4		X	730230T
Windshield Cowl Light Mounts - Two 3" Cubes Offset	18-19	2 / 4		X	730231T

APPLICATION GUIDE

DESCRIPTION	YEAR	DOORS	JK	JL	PART NO.
XE SERIES LIGHT MOUNTS JL					
Windshield Cowl Light Mounts - 6" Single Row	18-19	2 / 4		X	730060T
Windshield Cowl Light Mounts - 6" Square	18-19	2 / 4		X	730066T
Center Hood Light Mounts - 10" Double Row	18-19	2 / 4		X	732100T
Center Hood Light Mounts - 10" Single Row	18-19	2 / 4		X	732020T
Center Hood Light Mounts - 20" Double Row	18-19	2 / 4		X	732200T
Center Hood Light Mounts - 20" Single Row	18-19	2 / 4		X	732210T
Center Hood Light Mounts - 6" Single Row	18-19	2 / 4		X	732060T
Center Hood Light Mounts - 3" Cube	18-19	2 / 4		X	732230T
Center Hood Light Mounts - Two 3" Cubes Offset	18-19	2 / 4		X	732231T
Hood Latch Light Mounts - 3" Cube	18-19	2 / 4		X	730035T
Hard Top Rear Light Mounts - Two 3" Cubes	18-19	2 / 4		X	599502T
Hard Top Rear Light Mounts - 20", 30", or 40" Light Bar	18-19	2 / 4		X	599501T
ROOF RACKS					
SRM RACK					
SRM100 48" Rack	07-19	2 / 4	X	X	5914800T
SRM100 60" Rack	07-19	2 / 4	X	X	5916000T
SRM100 72" Rack	07-19	2 / 4	X	X	5917200T
SRM100 Front Plate - Two 3" Cube Lights	07-19	2 / 4	X	X	5923001T
SRM100 Rear Plate - Two 3" Cube Lights	07-19	2 / 4	X	X	5923002T
SRM100 Front Plate - Four 3" Cube Lights	07-19	2 / 4	X	X	5943001T
SRM100 Rear Plate - Four 3" Cube Lights	07-19	2 / 4	X	X	5943002T
SRM100 Front Plate - Six 3" Cube Lights	07-19	2 / 4	X	X	5963001T
SRM100 Rear Plate - Six 3" Cube Lights	07-19	2 / 4	X	X	5963002T
SRM100 Front Plate - 20" Light Bar & Two 3" Cube Lights	07-19	2 / 4	X	X	5912231T
SRM100 Rear Plate - 20" Light Bar & Two 3" Cube Lights	07-19	2 / 4	X	X	5912232T
SRM100 Front Mounting Kit - Up to two 50" Light Bars	07-19	2 / 4	X	X	5925001T
SRM100 Rear Mounting Kit - Up to two 50" Light Bars	07-19	2 / 4	X	X	5925002T
SRM100 Front Plate - 40" Light Bar	07-19	2 / 4	X	X	5914001T
SRM100 Rear Plate - 40" Light Bar	07-19	2 / 4	X	X	5914002T
SRM100 Front Pod Mounting Kit - Six 6" Q-Style Lights	07-19	2 / 4	X	X	5967001T
SRM100 Rear Pod Mounting Kit - Six 6" Q-Style Lights	07-19	2 / 4	X	X	5967002T
SRM100 Side Plates - Four 3" Cube Lights	07-19	2 / 4	X	X	5943003T
SRM Rack Universal, Adjustable Multi-Axis Mounting Kit	07-19	2 / 4	X	X	5910000T
SRM Rack Fixed Mounting Kit	07-19	2 / 4	X	X	5910001T
JL Hard Top Mounting Kit	18-19	2 / 4		X	5910010T
OVERLAND RACK/ROOF CAGE					
Overland Rack/Roof Cage	07-18	4	X		5994000T
Overland Rack/Roof Cage with WLF Windshield Light Frame for Eight 3" Cubes	07-18	4	X		59948300T
Overland Rack/Roof Cage with WLF Windshield Light Frame for 30" Light Bar & Four 3" Cubes	07-18	4	X		59941343T
Overland Rack/Roof Cage with WLF Windshield Light Frame for 40" Light Bar & Two 3" Cubes	07-18	4	X		59941423T
Overland Rack/Roof Cage with WLF Windshield Light Frame For 50" Light Bar	07-18	4	X		59941500T
Overland Rack/Roof Cage	07-18	2	X		5992000T
Overland Rack/Roof Cage with WLF Windshield Light Frame for Eight 3" Cubes	07-18	2	X		59928300T
Overland Rack/Roof Cage with WLF Windshield Light Frame for 30" Light Bar & Four 3" Cubes	07-18	2	X		59921343T

APPLICATION GUIDE

DESCRIPTION	YEAR	DOORS	JK	JL	PART NO.
OVERLAND RACK/ROOF CAGE					
Overland Rack/Roof Cage with WLF Windshield Light Frame for 40" Light Bar & Two 3" Cubes	07-18	2	X		59921423T
Overland Rack/Roof Cage with WLF Windshield Light Frame For 50" Light Bar	07-18	2	X		59921500T
WLF WINDSHIELD LIGHT FRAME					
XE Series Windshield Light Frame - 50" Light Bar	18-19	2 / 4		X	730500T
XE Series Windshield Light Frame - 50" Light Bar	07-18	2 / 4	X		730503T
WLF Windshield Light Frame - Eight 3" Cube Lights	07-18	2 / 4	X		738300T
WLF Windshield Light Frame - 30" Light Bar & Four 3" Cube Lights	07-18	2 / 4	X		731323T
WLF Windshield Light Frame - 40" Light Bar & Two 3" Cube Lights	07-18	2 / 4	X		731423T
WLF Windshield Light Frame - 50" Light Bar	07-18	2 / 4	X		731500T
FENDER KITS & LINERS					
ROCKLINE® FENDERS					
Rockline® 3" Front Fender	18-19	2 / 4		X	702031T
Rockline® 3" Rear Fender	18-19	2 / 4		X	702032T
Rockline® 6" Front Fender	18-19	2 / 4		X	702061T
Rockline® 6" Rear Fender	18-19	2 / 4		X	702036T
Rockline® 9" Front Fender	18-19	2 / 4		X	702091T
TRAILLINE® FENDERS					
Trailline® 3" Front Fender	07-18	2 / 4	X		701131T
Trailline® 3" Rear Fender	07-18	2 / 4	X		701132T
Trailline® 6" Front Fender	07-18	2 / 4	X		701161T
Trailline® 6" Rear Fender	07-18	2 / 4	X		701162T
ROADLINE® FENDERS					
Roadline® 3" Front Fender	18-19	2 / 4		X	702131T
Roadline® 3" Rear Fender	18-19	2 / 4		X	702132T
Roadline® 6" Front Fender	18-19	2 / 4		X	702161T
Roadline® 6" Rear Fender	18-19	2 / 4		X	702162T
Roadline® 9" Front Fender	18-19	2 / 4		X	702191T
Roadline® 3" Front Fender	07-18	2 / 4	X		701031T
Roadline® 3" Rear Fender	07-18	2 / 4	X		701032T
Roadline® 6" Front Fender	07-18	2 / 4	X		701061T
Roadline® 6" Rear Fender	07-18	2 / 4	X		701062T
Roadline® 9" Front Fender	07-18	2 / 4	X		701091T
FENDER LINERS					
Front Fender Liners	18-19	2 / 4		X	702011T
Rear Fender Liners	18-19	2 / 4		X	702012T
Front Fender Liners	07-18	2 / 4	X		702001T
Rear Fender Liners	07-18	2 / 4	X		702002T
JACK MOUNT					
Jack Mount	18-19	2 / 4		X	701001T
Jack Mount	07-18	2 / 4	X		701003T

APPLICATION GUIDE

DESCRIPTION	YEAR	DOORS	JK	JL	PART NO.
EXHAUST TIPS					
Double Wall Fast Style Black Chrome Exhaust Tip (10" Length, 3" Inside Diameter, 4" Outside Diameter)	18-19	2 / 4		X	GRT3410UFBC
Double Wall Fast Style Chrome Exhaust Tip (10" Length, 3" Inside Diameter, 4" Outside Diameter)	18-19	2 / 4		X	GRT3410UF
Rolled Edge Chrome Exhaust Tip (10" Length, 3" Inside Diameter, 4" Outside Diameter)	18-19	2 / 4		X	GRT3410
Rolled Edge Black Chrome Exhaust Tip (10" Length, 3" Inside Diameter, 4" Outside Diameter)	18-19	2 / 4		X	GRT3410BC
Rolled Edge Black Powder Coat Exhaust Tip (10" Length, 3" Inside Diameter, 4" Outside Diameter)	18-19	2 / 4		X	GRT3410B
Double Wall Fast Style Black Chrome Exhaust Tip (8" Length, 2.5" Inside Diameter, 4" Outside Diameter)	07-18	2 / 4	X		GRT21248UFBC
Rolled Edge Fast Style Black Chrome Exhaust Tip (8" Length, 2.5" Inside Diameter, 4" Outside Diameter)	07-18	2 / 4	X		GRT21248FBC
Rolled Edge Fast Style Black Exhaust Tip (8" Length, 2.5" Inside Diameter, 4" Outside Diameter)	07-18	2 / 4	X		GRT21248FB

DESCRIPTION	YEAR	DOORS	JT	PART NO.
GLADIATOR JEEP® TRUCK				
ROCKLINE® FRONT BUMPER				
Rockline® Stubby Front Bumper	2020	4	X	331100T
Rockline® Stubby Front Bumper w/ Override Bar	2020	4	X	331101T
Rockline® Full Front Bumper	2020	4	X	331200T
Rockline® Full Front Bumper w/ Override Bar	2020	4	X	331201T
Rockline® Front Bumper Skid Plate	2020	4	X	332100T
Rockline® Front Bumper Skid Plate	2020	4	X	332110T
Rockline® Front Bumper Winch Fairlead Mount	2020	4	X	332000T
Rockline® Front Bumper Winch Fairlead Mount	2020	4	X	332010T
TRAILLINE® FRONT BUMPER				
Trailline® Stubby Front Bumper	2020	4	X	230111T
Trailline® Straight Front Bumper	2020	4	X	230116T
Trailline® Full Front Bumper	2020	4	X	230121T
Trailline® 10 Light Mount Bar	2020	4	X	25101T
Trailline® 20 Light Mount Bar	2020	4	X	25102T
Trailline® 30 Light Mount Bar	2020	4	X	25103T
Trailline® Front Bumper Winch Fairlead Mount	2020	4	X	23200T
Front Light Plate for 3" Cube Lights (For Straight or Full Bumpers)	2020	4	X	241742T
Front Light Plate for 4" Square Lights (For Straight or Full Bumpers)	2020	4	X	241743T
Codeable Lock for Trailline® Front Gear Drawer	2020	4	X	230105
XE SERIES LIGHT MOUNTS				
Hood Hinge Light Mounts - 20" Single Row	2020	4	X	731200T
Hood Hinge Light Mounts - 30" Single Row	2020	4	X	731300T
Hood Hinge Light Mounts - 6" Single Row	2020	4	X	731060T
Hood Hinge Light Mounts - Two 3" Cubes	2020	4	X	731030T
Hood Hinge Light Mounts - Two 3" Cubes Offset	2020	4	X	731230T
Windshield Cowl Light Mounts - 3" Cube	2020	4	X	730030T
Windshield Cowl Light Mounts - Two 3" Cubes	2020	4	X	730230T
Windshield Cowl Light Mounts - Two 3" Cubes Offset	2020	4	X	730231T
Windshield Cowl Light Mounts - 6" Single Row	2020	4	X	730060T
Windshield Cowl Light Mounts - 6" Square	2020	4	X	730066T
Center Hood Light Mounts - 10" Double Row	2020	4	X	732100T
Center Hood Light Mounts - 10" Single Row	2020	4	X	732020T

APPLICATION GUIDE

DESCRIPTION	YEAR	DOORS	JT	PART NO.
XE SERIES LIGHT MOUNTS				
Center Hood Light Mounts - 20" Double Row	2020	4	X	732200T
Center Hood Light Mounts - 20" Single Row	2020	4	X	732210T
Center Hood Light Mounts - 6" Single Row	2020	4	X	732060T
Center Hood Light Mounts - 3" Cube	2020	4	X	732230T
Center Hood Light Mounts - Two 3" Cubes Offset	2020	4	X	732231T
Hood Latch Light Mounts - 3" Cube	2020	4	X	730035T
DOMINATOR SIDE STEPS				
Dominator D1 Side Steps (Black Textured Powder Coat)	2020	4	X	D14516T
Dominator D2 Side Steps (Black Textured Powder Coat)	2020	4	X	D24516T
Dominator D6 Side Steps (Black Textured Powder Coat)	2020	4	X	D64516T
Dominator DS Side Steps (Black Textured Powder Coat)	2020	4	X	DS4516T
Dominator DSS Side Steps (Black Textured Powder Coat)	2020	4	X	DSS4516T
Pair of Dominator D6 Hoop Steps (Black Textured Powder Coat)	2020	4	X	D6410000T
RB SERIES RUNNING BOARDS				
RB10 Running Boards (Protective Bedliner Coating)	2020	4	X	63451687T
RB10 Running Boards (Black Textured Powder Coat)	2020	4	X	63451687PC
RB20 Running Boards (Protective Bedliner Coating)	2020	4	X	69451687T
RB20 Running Boards (Black Textured Powder Coat)	2020	4	X	69451687PC
RB Series Drop Steps (Protective Bedliner Coating)	2020	4	X	69420000T
RB Series Drop Steps (Black Textured Powder Coat)	2020	4	X	69420000PC
1000 SERIES SIDE STEPS W/ MOUNTING BRACKETS				
4" 1000 Series Side Steps (Polished Stainless)	2020	4	X	104404787PS
4" 1000 Series Side Steps (Black Textured Powder Coat)	2020	4	X	104404787T
5" 1000 Series Side Steps (Polished Stainless)	2020	4	X	105404787PS
5" 1000 Series Side Steps (Black Textured Powder Coat)	2020	4	X	105404787T
OE XTREME SERIES SIDE STEPS W/ MOUNTING BRACKETS (SEE WEBSITE FOR DETAILS)				
4" OE Xtreme (Polished Stainless)	2020	4	X	684404787PS
4" OE Xtreme (Black Textured Powder Coat)	2020	4	X	684404787T
5" OE Xtreme Composite (Black)	2020	4	X	685404787CB
5" OE Xtreme Composite (Chrome)	2020	4	X	685404787CC
5" OE Xtreme Low Profile (Polished Stainless)	2020	4	X	685404787PS
5" OE Xtreme Low Profile (Black Textured Powder Coat)	2020	4	X	685404787T
6" OE Xtreme (Polished Stainless)	2020	4	X	686404787PS
6" OE Xtreme (Black Textured Powder Coat)	2020	4	X	686404787T
6" OE Xtreme II (Polished Stainless)	2020	4	X	6862404787PS
6" OE Xtreme II (Black Textured Powder Coat)	2020	4	X	6862404787T
JACK MOUNT				
Jack Mount	2020	4	X	701001T
EXHAUST TIPS				
Rolled Edge Fast Style Black Exhaust Tip (8" Length, 2.5" Inside Diameter, 4" Outside Diameter)	2020	4	X	GRT3410B
Rolled Edge Fast Style Black Chrome Exhaust Tip (8" Length, 2.5" Inside Diameter, 4" Outside Diameter)	2020	4	X	GRT3410BC
Rolled Edge Fast Style Chrome Exhaust Tip (8" Length, 2.5" Inside Diameter, 4" Outside Diameter)	2020	4	X	GRT3410

GO BLAZE YOUR
OWN TRAIL

GO OUTDOORS

GO WORK

GO PLAY

GO OFF ROADING

GO EXPLORE



GO FOR IT



GO RHINO® 

**FIT.
FUNCTION.
STYLE.**



Check out the collection of running boards and step bars we offer.