



# RHINO-RACK

Aerodynamic & Heavy Duty Roof Rack Systems

## Rhino 2500 Series - Two Bar Aero System.

**Important:** Please refer to your fitting instruction to ensure that the roof racks are installed in the correct locations. Check the contents of kit before commencing fitment and report any discrepancies. Place these instructions in the vehicle's glove box after installation is complete.

### Layout:

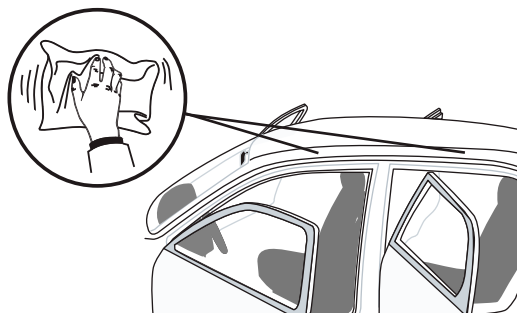
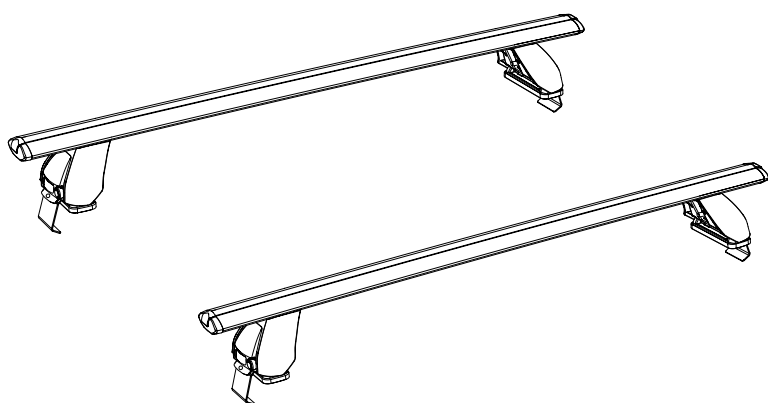

Wash vehicle roof prior to installation. Please read through instructions before fitting the racks to your vehicle.

### Important Information

**Maximum carrying capacity: 75kg (165lbs) evenly distributed over the cross bars. Please refer to your vehicle manufacturers handbook and DK Specification sheet for maximum roof loading. Always use the lower of the two figures.**

#### Recommendations:

It is essential that all bolt connections be checked after driving a short distance when you first install your cross bars. Bolt connections should be checked again at regular intervals (probably once a week is enough, depending on road conditions, usage, loads and distances travelled). You should also check the cross bars each time they are refitted. Make sure to fasten your load securely. Please ensure that all loads are evenly distributed and that the centre of gravity is kept as low as possible.

#### Use only non-stretch fastening ropes or straps.

**Caution:** The handling characteristics of the vehicle changes when you transport a load on the roof. For safety reasons we recommend you exercise extreme care when transporting wind-resistant loads. Special consideration must be taken into account when cornering and braking.

**Please remove cross bars when putting vehicle through an automatic car wash.**

#### Load Ratings:

Maximum permissible load is 75kg (165lbs) for two cross bars including the weight of the cross bars, 5kg (11lbs). When cross bars are to be used in off-road conditions, please build a safety factor of 1.5 into this load limit for off-road use, two cross bars = **50kg 110lbs**). Although the cross bars are tested and approved to AS1235-2000, Off road conditions can be much more rigorous. However, increasing the number of cross bars does not increase the vehicles maximum permissible roof loading.

#### Note for Dealers and Fitters:

It is your responsibility to ensure instructions are given to the end user or client.

Rhino-Rack  
3 Pike Street, Rydalmere,  
NSW 2116, Australia.  
(Ph) (02) 9638 4744  
(Fax) (02) 9638 4822

Document No: 2501  
Prepared By: Craig Jones  
Authorised By: Gary England

Issue No: 02  
Issue Date: 19/04/2010

These instructions remain the property of Rhino-Rack Australia Pty. Ltd. and may not be used or changed for any other purpose than intended.



# Rhino 2500 Series - Two Bar Aero System

**Parts List** Carrying Capacity: Refer to DK specification sheet for maximum carrying capacity of your particular vehicle.

Item	Component Name	Qty	Part No.
1	Rubber Buffer Strip	2	R011
2	Aero Cross Bar	2	A155
3	M8 Pivot Nut	4	N047
4	M8 x 50mm Security Bolt	4	B154
5	End Cap	4	M153
6	Bar Measurement Strip	4	M332
7	Leg	4	M310
8	Leg Cover Plate	4	M324
9	M6 Nut	4	N057
10	M6 Flat Washer	4	W003
11	M6 Spring Washer	4	W004
12	M6 x 25mm Security Screw	4	B137
13	Front Cover	4	M312
14	Front Cover Key	2	M314
15	Foot Plate	4	M311
16	Security Allen Key	1	SecKey-L
17	Leg Location Decals	4	S365
18	Arrow Positioning Decals	4	S364
19	Fitting Instruction	1	2501

### Tools Required:

- Security Allen key, provided in kit.
- Tape measure.
- Scissors.
- Rubber mallet.

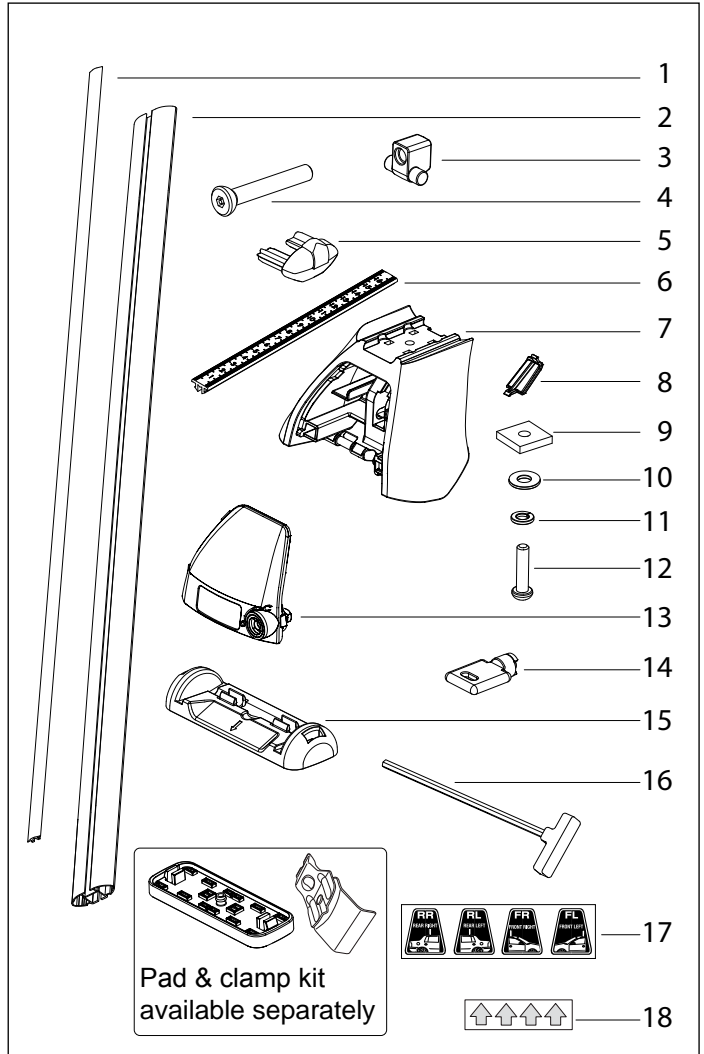

**NOTE :** Refer to the DK kit specification sheet for correct placement (Front & Rear, Left & Right) of the foot plate, rubber pad and metal strap. Also refer for sizes to cut the bar measurement strips.

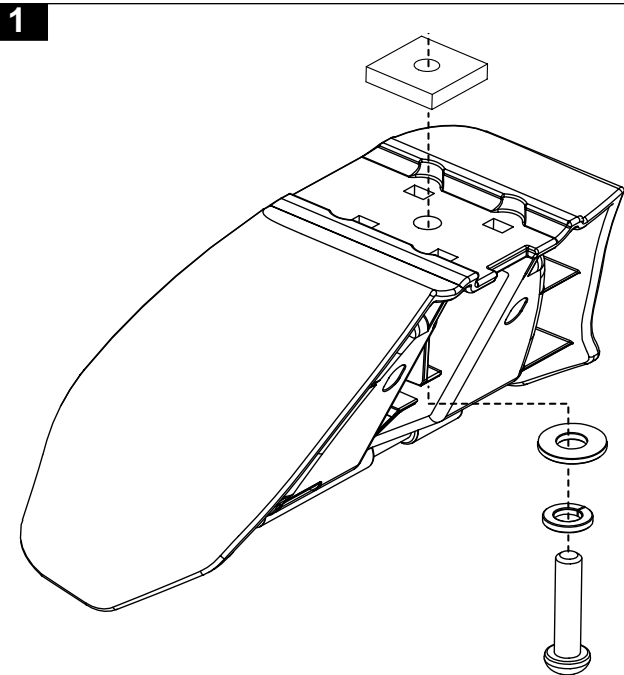

### Attach hardware:

Locate the M6 x 25mm security screw, spring washer and flat washer through top the leg and fasten to the M6 nut. Do not tighten at this stage.

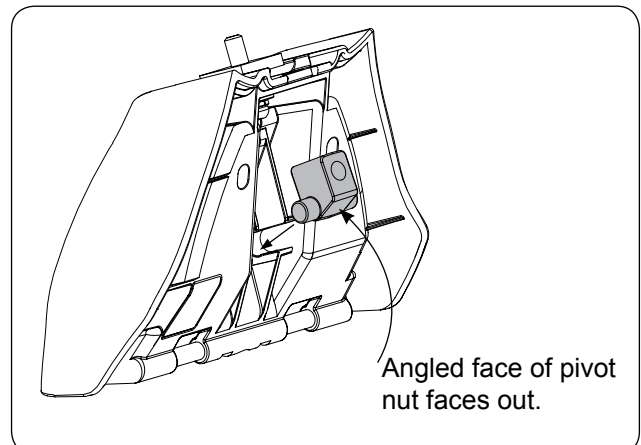



# Rhino 2500 Series - Two Bar Aero System

## 2 Attach pad to foot plate.

Clip the rubber pad onto the foot plate. Pad centre tube and end tabs must fully locate into the foot plate.  
*Note: Certain rubber pad sets have a DK supplement sheet to show correct orientation.*

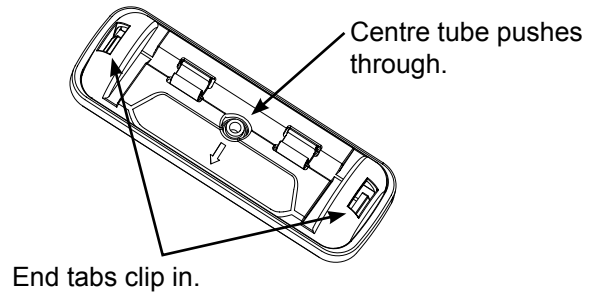
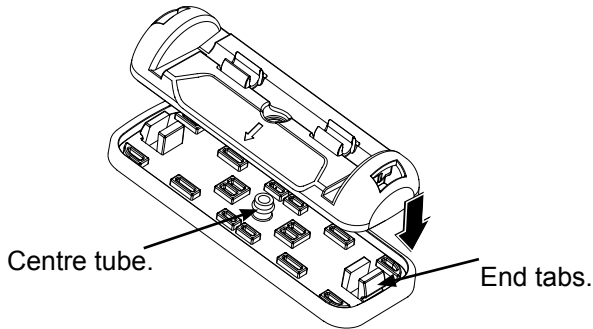

## 3

### Attach foot plate to leg.

Clip the foot plate onto base of the leg with the arrow facing **In** or **Out** according to your vehicle listed in the DK specification sheet. Diagram at left shows arrow facing **Out**.

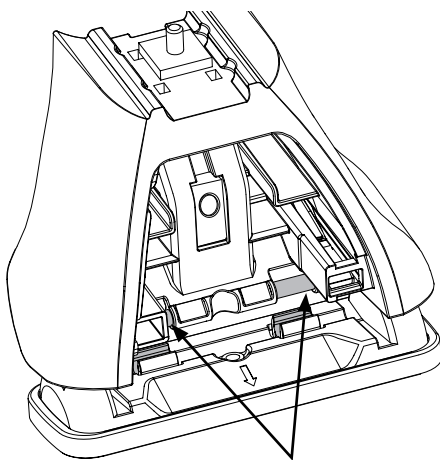

DK spec sheet.

Clamp	Foot Plate	Measureme
NSF	Arrow Dir.	Strip length
SUB0172	OUT	108mm

*example only.*

## 4 Measurement strip length:

Refer to DK instruction for cut length of bar measurement strips.

- a. Accurately cut measurement strips to length. Slide into each end of cross bar. Repeat for front & rear bar.
- b. Locate M6 nut into the cross bar then slide leg in to butt up against the measurement strip.
- c. The measurement strip must butt up against the end of the cross bar cut out. Tighten M6 security screw with the allen key provided. **Tighten to 3-4 Nm (2-3 lbs)**

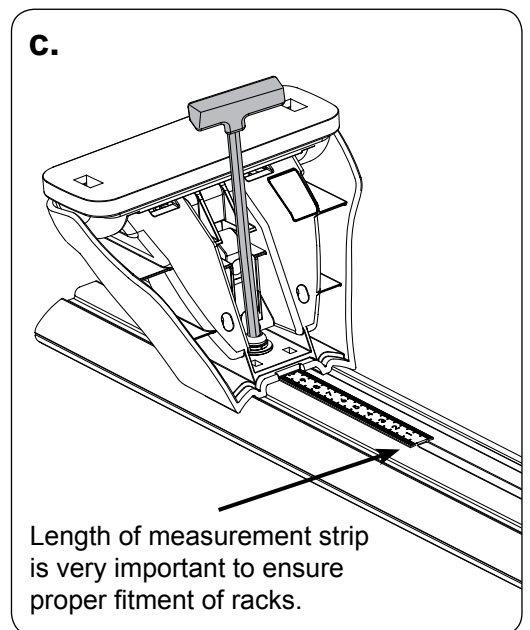
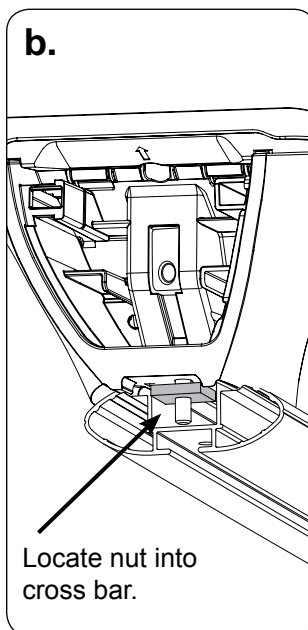
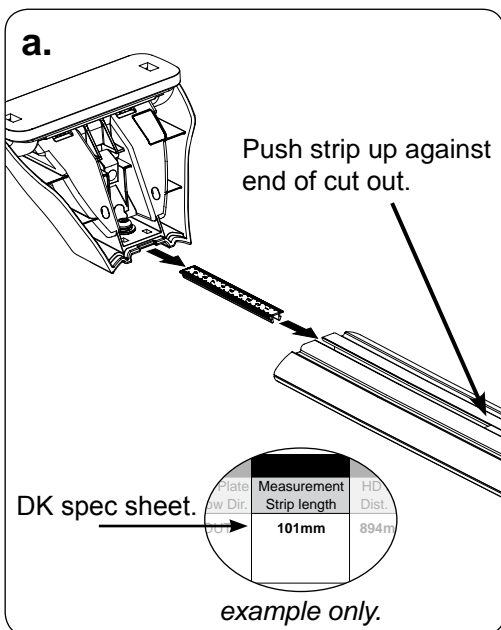



# Rhino 2500 Series - Two Bar Aero System

5

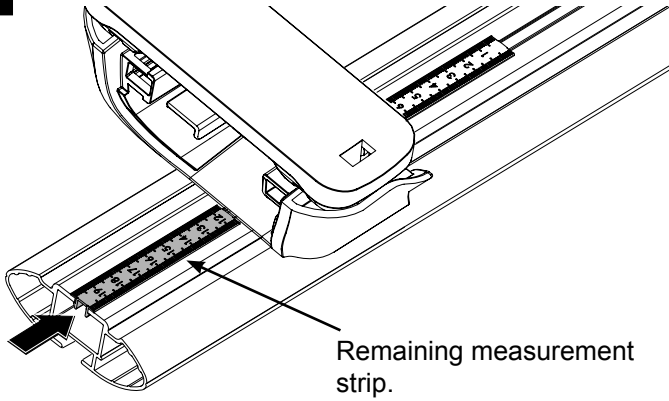

### Remaining measurement strip:

Slide the remaining measurement strip that corresponds to the inside length into the end of the cross bar.

Repeat this for front and rear cross bars.

6

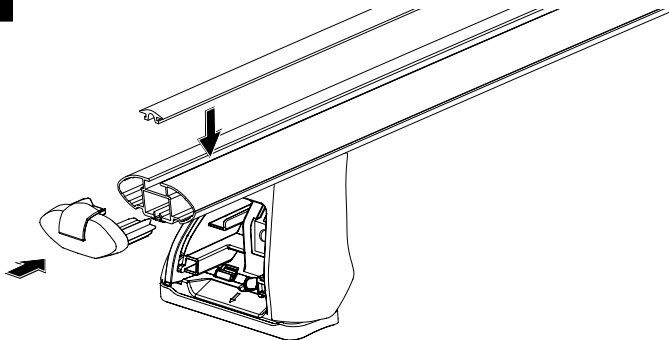

### Buffer strip and end cap:

- a. Insert rubber buffer strip into top of cross bar.
- b. Insert end cap into end of cross bar. A rubber mallet may be needed to knock the end cap in place.

NOTE: Flap on end cap to top.

7

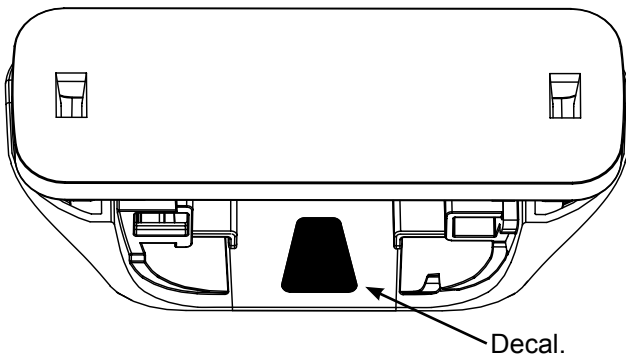

### Leg location decals:

Stick the leg position labels inside the leg. The labels identify the position of the leg on the vehicle roof. Use as a guide when re-fitting the cross bars after removal. Refer layout below.

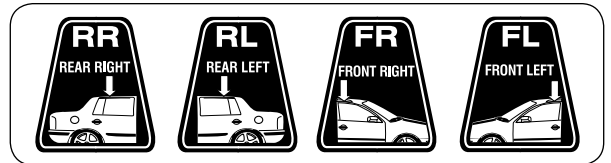

8

### Position roof racks:

Place racks onto the vehicle roof.

Refer to DK specification sheet for correct positioning of your roof racks.

**A.** Measure forward from where the front and rear doors meet/close.

**B.** Measure back to set distance between cross bars.

**A and B** measurements are to be in line with arrow in centre of foot plate.

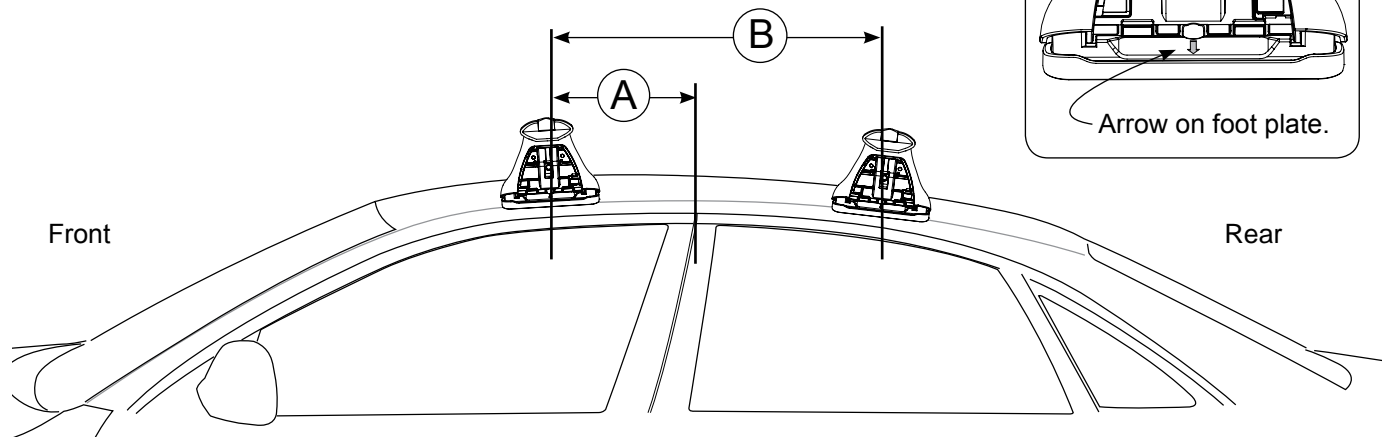
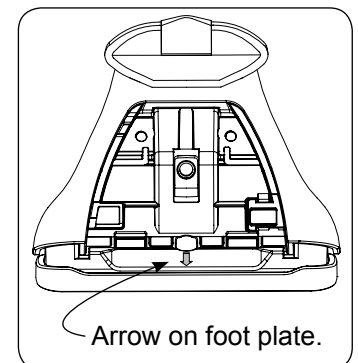



## Rhino 2500 Series - Two Bar Aero System

### 9 Positioning decals:

Stick the white arrow decals in line with foot plate arrows onto the body work inside the door jamb. This marks reference points for future use when racks are removed and then replaced.

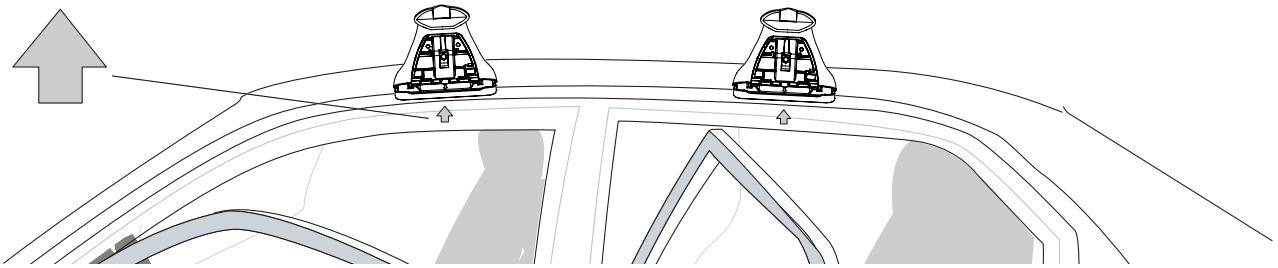

### 10 Attach clamps:

Hook the lower part of the metal clamp in at the top of the door jamb underneath any rubber seals that may be present. Fasten the M8 bolt to the pivot nut in the leg.

**Bolts must be tensioned evenly on each side of the vehicle to avoid pulling the rack to one side. Do not tighten one side at a time. Tighten to 12-14 Nm (9-11 ft lbs). DO NOT OVER TIGHTEN.**

Refer to DK instruction for correct clamp and pad combination for front and rear of vehicle.

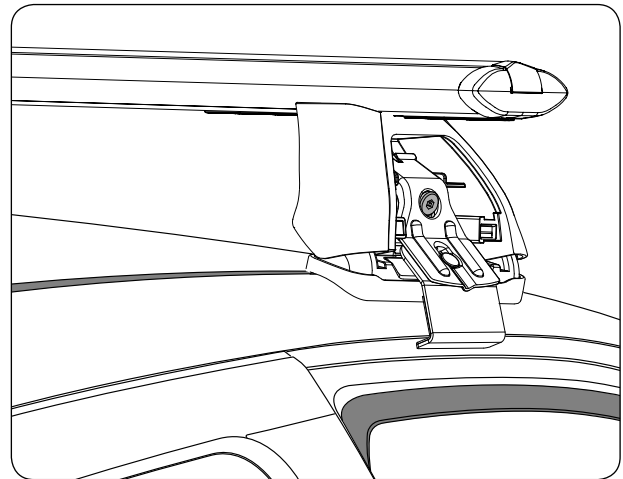
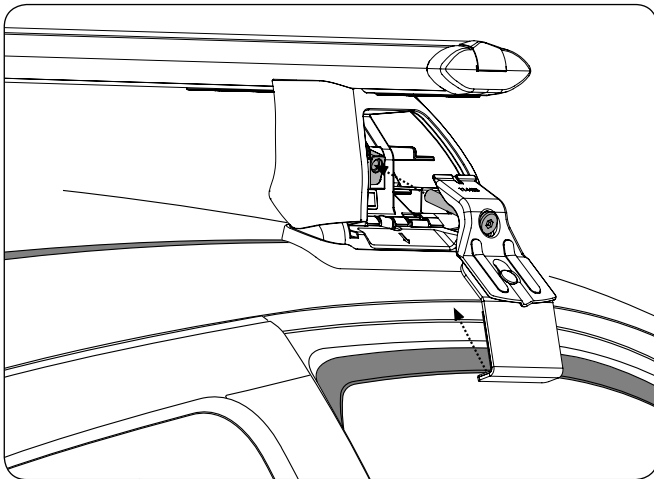

### 11

Front cover key.

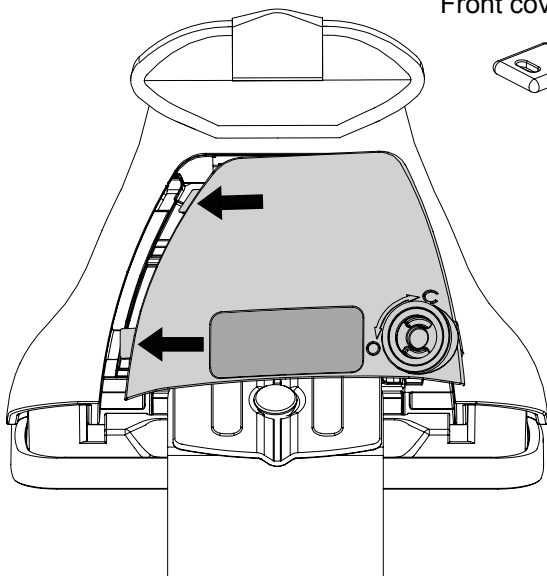
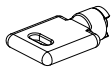

### Attach front cover.

Insert the two lugs on left side of front cover into the leg. Use key provided to turn lock barrel to the open position (O). Engage locking tab into leg. Turn to close (C).

