

# Installation Instructions



## Important Safety Information



- CAUTION - Before driving, ensure that the window cover is properly secured to vehicle.
- Do not use automatic "brush-style" car washes.
- Do not use cleaning solvents of any kind.
- Periodically check all components for tightness.

## Contents **NOTE:** Actual product may vary from illustration.

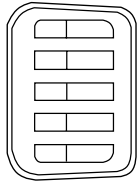

Drivers side window cover

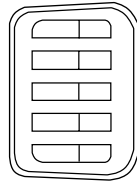

Passenger side window cover



Alcohol Pad x2

## Tools Required



Car Wash Supplies



Clean Towel

## Preparation Before Painting / Installation

- A trial fit is recommended to ensure proper positioning and fit.
- Check fit of parts before painting as we will not accept the return of modified or painted parts.
- Wash your vehicle to remove any debris and/or dirt from installation area.
- Dry the installation area with a clean towel.

## Installation Steps **NOTE:** Actual application may vary slightly from illustrations.



Clean the installation area with alcohol pad.

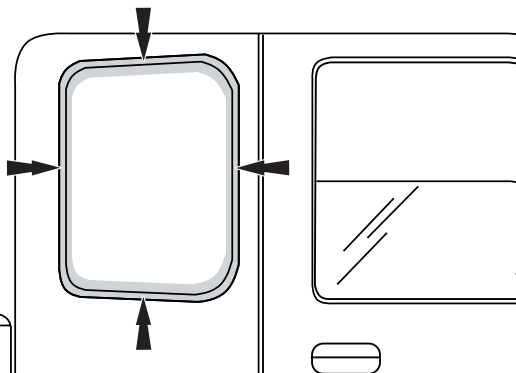

1

Peel back 2" (5 cm) of tape liner.

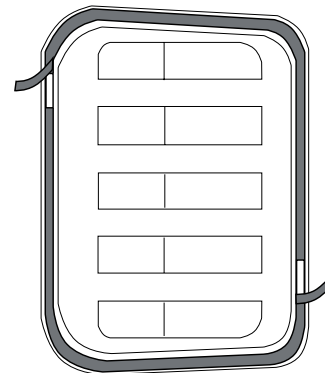

2

## Installation Steps **NOTE:** Actual application may vary slightly from illustrations.

Align window cover with the previously cleaned window trim.

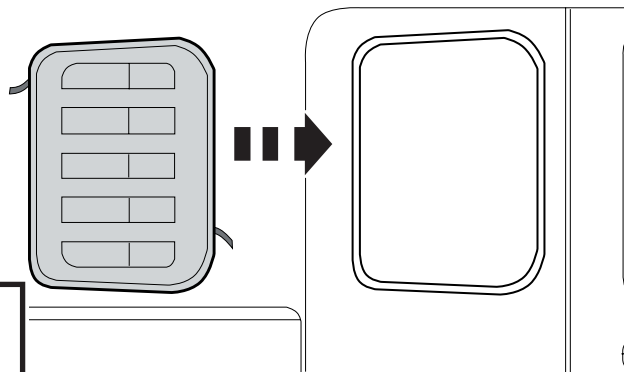

3

Press on exposed tape area to adhere to vehicle. Remove remainder of tape liner by pulling on free ends.

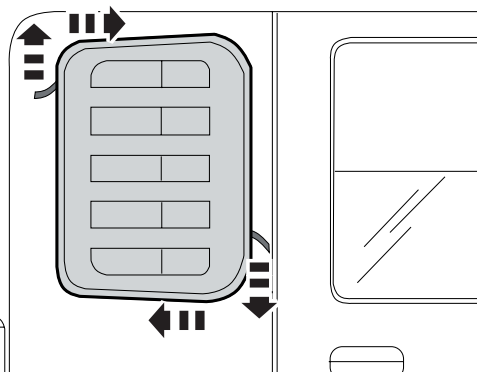

4

Press firmly along flanges to ensure proper adhesion to vehicle.

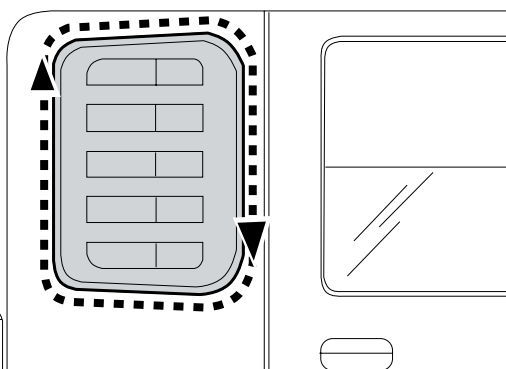

5

Repeat **Steps 1- 5** for passenger side window cover.

## Care and Cleaning

- Wash only with mild soap & dry with a clean cloth.

## Congratulations!

You have purchased one of the many quality Auto Ventshade™ branded products offered by Lund International, Inc. We take the utmost pride in our products and want you to enjoy years of satisfaction from your investment. We have made every effort to ensure that your product is top quality in terms of fit, durability, finish and ease of installation.

