



Equipped with AEM® Dryflow™ Filter
No Oil Required!

INSTALLATION INSTRUCTIONS

PART NUMBER: 21-8404

2005-2006 TOYOTA Tundra V8-4.7L

PARTS LIST

	Description	Qty.	Part Number
A	Air Filter Assy. 3.50 X 9" Dry Ele.	1	21-2049D
B	Nut, M6 Hex Serrated	1	444.460.04
C	Washer, 6mm Soft Mount	1	08160
D	Mount, Rubber 1" X 6mm	1	1228599
E	Inlet Pipe	1	2-84041
F	1/2" Bnd. Hose Clamp, 3.15"-4.00"	3	9456
G	Elbow, 3.50 Tight 90 Deg.	1	5-356
H	Washer, 1/4 SAE Flat	1	1-3028
I	Bolt, Hex/Flange M6-1 X 20	1	1-2038
J	Hose; 5/32" ID X 15"L	1	5-3015
K	Hose; 1/2" ID X 12"L	1 </td <td>5-5012</td>	5-5012
L	Bolt, Socket M4-.7 X 8mm	2	1-2105
M	Zip Tie, 8" Tree Push-Mnt.	1	1-127
N	Bracket	1	32-3056
O	Rubber Edge Trim 15"	1	8-3015
P	Edge Trim, 26"	1	8-4026
Q	Hose Clamp, 1"	2	08407
R	Heat Shield	1	20-8404

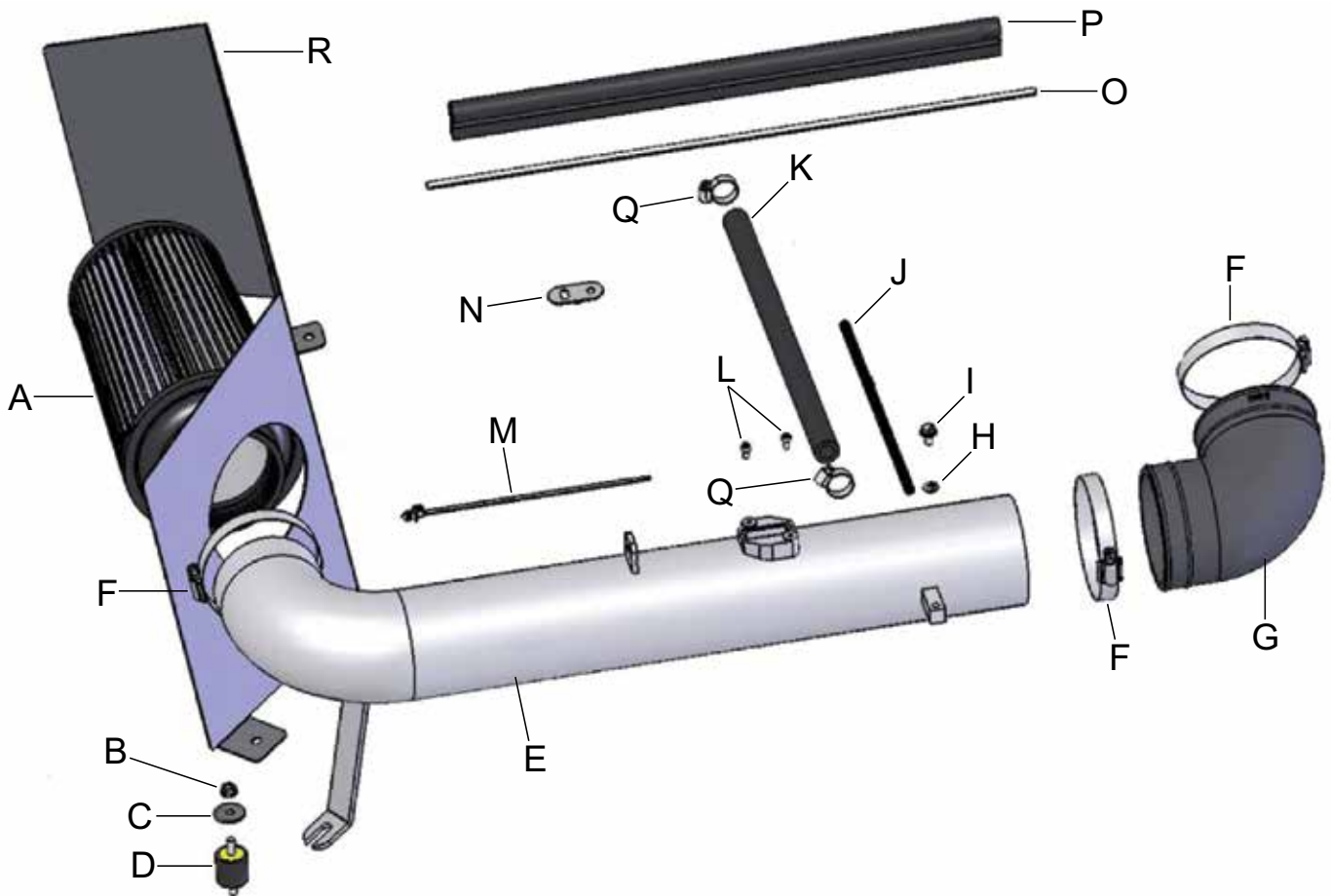

Read and understand these instructions **BEFORE** attempting to install this product. Failure to follow installation instructions and not using the provided hardware may damage the intake tube, throttle body and engine.

1. Preparing Vehicle

- a. Make sure vehicle is parked on level surface.
- b. Set parking brake.
- c. If engine has run in the past two hours, let it cool down.
- d. Disconnect negative battery terminal.
- e. Do not discard stock components after removal of the factory system.

2. Removal of stock system



a. Factory air box system.



b. Loosen the two bolts securing the engine cover to the engine. Then, remove the engine cover.



c. Remove the bolt that secures the line secured to the stock intake tube. Keep this bolt for later use.



d. Disconnect the Mass Air Flow (MAF) harness from the MAF sensor.



e. Disconnect the stock zip tie that is securing the MAF harness to the air box. Do not cut this zip tie it will be reused later.

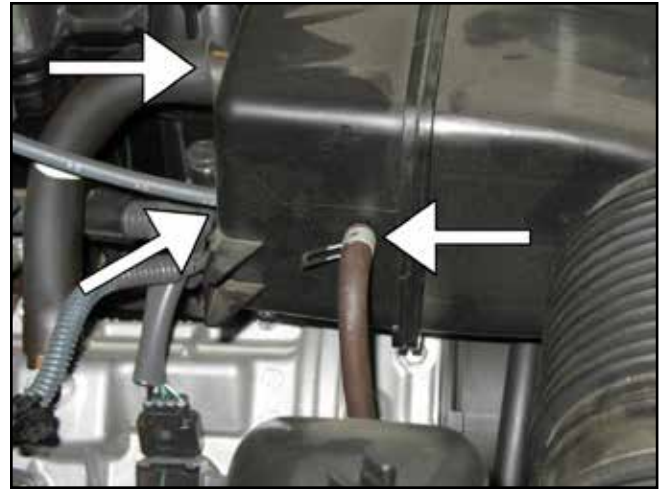

f. Remove the 3 breather hoses from the stock resonator.



g. Loosen the first two bolts securing the stock air box into the vehicle.



h. The final bolt to remove the stock air box is located behind the passenger side headlight.



i. Loosen the hose clamp securing the stock intake tube to the throttle body. Gently pull the stock intake tube toward the front of the vehicle.



j. After, pulling the intake tube away from the throttle body, the air box and intake tube, should be pulled out as an assembly as shown.

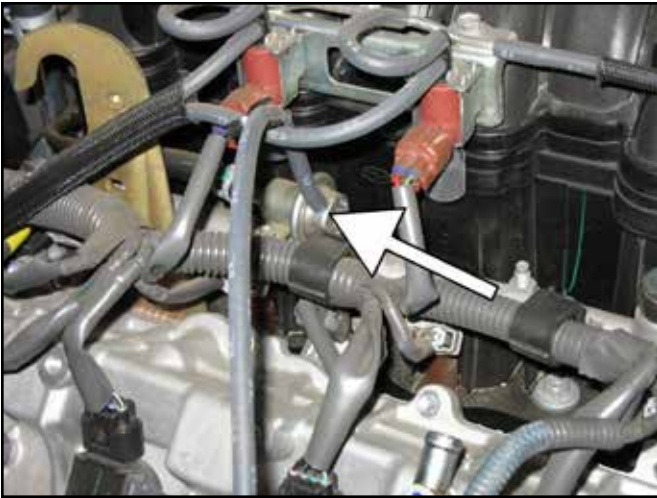

k. Disconnect the opposite end of the 5/32" ID hose disconnected in step 2f.



l. Disconnect the opposite end of the 5/8" ID hose disconnected in step 2f.



m. Remove the MAF sensor from the stock housing removed in step 2j. Be extra careful with this sensor.

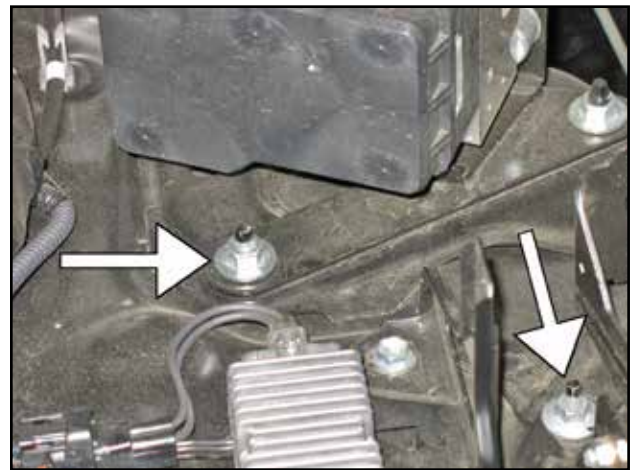

n. Remove the two nuts located on the passenger side fender well.

3. Installation of AEM® intake system.

- a. When installing the intake system, do not completely tighten the hose clamps or mounting hardware until instructed to do so.

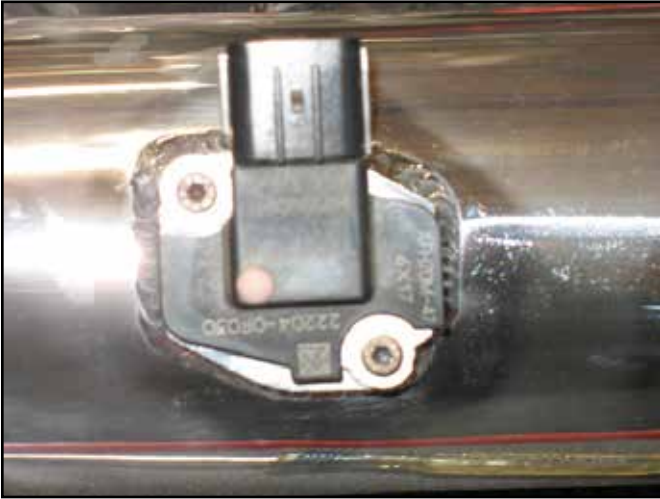

- b. Install the MAF sensor in the pipe and secure it with the two supplied bolts(1-2105).



- c. Insert the heatshield into the engine bay and align the mounting tabs with the studs exposed in step 2n.



- d. This is the another view of the heatshield and the second stud mentioned in the previous step.



- e. The final tab will be secured to the truck using the supplied rubber mount and threading it into the hold exposed in step 2h.



- f. Install the supplied coupler and #56 hose clamp supplied in the kit.



- g. Install the inlet pipe through the heatshield and align the bracket with the rubber mount installed in step 3e.



h. Loosely secure the pipe in the coupler with the supplied #56 hose clamp. Secure the 5/16" hose to the pipe using the stock clamp.

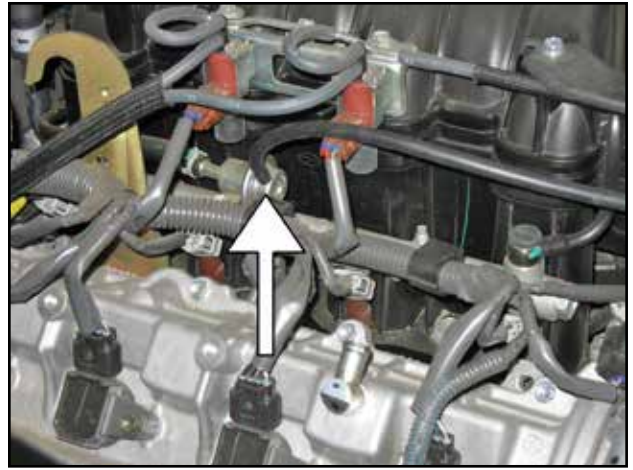

i. Install the supplied 5/32" OD hose on the valve shown.



j. Attach the hose installed in the previous step to the intake pipe nipple.



k. Attach the MAF wiring harness bracket to the valve cover using the bolt removed in step 2c.

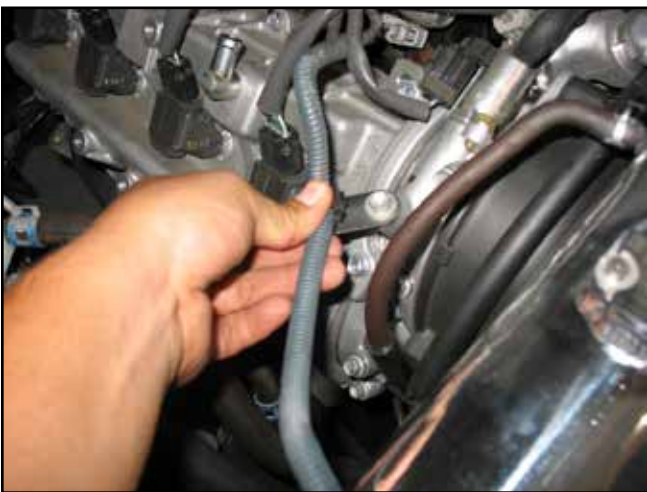

l. Snap the stock zip tie into the MAF wiring harness installed in the previous step.



m. Install the supplied tree mount zip tie to the intake pipe using the bracket on the pipe, and secure the wiring harness.



n. Plug the MAF wiring harness back into the MAF sensor.



o. Move the metal band that secured the A/C line to the stock intake tube down until it lines up with the bracket on the intake pipe.



p. Secure the metal band to the intake tube using the supplied bolt and washer.



q. Install the air filter onto the intake pipe and secure with hose clamp. Also secure the intake pipe bracket with supplied washer and nut to the rubber mount.



r. Install the 1/2" hose on the intake pipe secure with the supplied hose clamp and slide the other side on the breather elbow on the valve cover.



Factory intake system installed



AEM® intake system installed

4. Reassemble Vehicle

- a. Position the inlet pipes for the best fitment. Be sure that the pipes or any other components do not contact any part of the vehicle. Tighten the rubber mount, all bolts, and hose clamps.
- b. Check for proper hood clearance. Re-adjust pipes if necessary and re-tighten them.
- c. Inspect the engine bay for any loose tools and check that all fasteners that were moved or removed are properly tightened.
- d. Reconnect negative battery terminals and start engine. Let the vehicle idle for 3 minutes. Perform a final inspection before driving the vehicle.

5. CARB Sticker Placement

- a. The C.A.R.B. exemption sticker, (attached), must be visible under the hood so that an emissions inspector can see it when the vehicle is required to be tested for emissions. California requires testing every two years, other states may vary.

6. Service and Maintenance

- a. It is recommended that you service your AEM® Dryflow™ filter every 20,000 miles for optimum performance. Use AEM Dryflow cleaning kit part # 21-110.
- b. Use aluminum polish to clean your polished AEM® intake tube.
- c. Use window cleaner to clean your powder coated AEM® intake tube. **(NOTE: DO NOT USE aluminum polish on powder coated AEM intake tubes).**